



# 4 Wheel Electric Cart

## OWNER'S MANUAL



### **WARNING:**

Carefully read and understand all **ASSEMBLY AND OPERATION INSTRUCTIONS** before operating. Failure to follow the safety rules and other basic safety precautions may result in serious personal injury.

**Model# YTF-4WEC**

Thank you very much for choosing this product! For future reference, please complete the owner's record below:

Model:   # YTF-4WEC   Purchase Date: \_\_\_\_\_

Save the receipt, the warranty, and these instructions. It is important that you read the entire manual to become familiar with this product before you begin using it.

This product is designed for certain applications only. The manufacturer cannot be responsible for issues arising from modification. We strongly recommend that this product not be modified and/or used for any application other than that for which it was designed. If you have any questions relative to a particular application, DO NOT use the product until you have first contacted us to determine if it can, or should, be performed on the product.

For technical questions, please call **1-218-943-6290**.

## **INTENDED USE**

This Utility Wagon Cart Wheelbarrow is a 48V Lead Acid All Electric motor system, powered by 4 7Ah,336Wh Rechargeable Sealed Lead Acid Batteries and has the power/ability to haul loads at a Max 15° degree Upward Slope; A Max Working Load Capacity of 660 lbs (300kgs) / Hauling Capacity of 1000 lbs (460kgs) and 6 cu.ft of Capacity to load. Deep Cycle technology provides: fast charge times, spill-proof design, better in the cold, high power output and low internal/vibration resistance. Battery-powered units produce no smog and are quieter; Included is the All-Purpose Modular Cargo Bed can be used as a flatbed by removing or folding the cargo panels.

## **TECHNICAL SPECIFICATIONS**

<b>Item</b>	<b>Description</b>
Rating	48 Volt DC/500W
Loading Capacity	300kgs/660lbs
Battery Pack	48V,7Ah,336Wh Sealed Lead Acid
Speed	Forward:0-5km/h (0-3.1MPH) Variable, Reverse: 0-3.5km/h (0-2.2MPH) Variable

## **GENERAL SAFETY RULES**

### **WARNING:**

**DO NOT ride on the cart! No persons should ride on the cart.**

### **WARNING:**

**Read and understand all instructions.** Failure to follow all instructions listed below may result in serious injury.

1. Keep work area clean and well lit. Cluttered or dark areas invite accidents.
2. Wear shoes with non-slip treads. Do not use the electric cart while barefoot or wearing sandals or open toed shoes. Safety shoes or boots only.
3. Do not operate electric cart in explosive atmospheres, such as in the presence of flammable liquids, gases or dust. This electric cart can create sparks which may ignite the dust or fumes.
4. Never operate your power cart in the rain or in tall wet grass. Remember, this is an electric garden cart.
5. Keep children and bystanders away while operating this cart. Distractions can cause you to lose control.
6. When operating the machine, stand behind the machine and hold the handles firmly.

7. Do not operate the machine while riding on the machine.
8. Do not allow others to ride on the machine.
9. Do not use the machine when visibility is poor, because there is a risk of striking obstacles.
10. When operating the machine on rough ground, decrease speed and exercise caution.
11. When operating the machine in reverse and walking backward, watch behind you and be careful not to slip or trip.
12. When using the machine, avoid soft ground to prevent overturn due to the shoulder of the road collapsing.
13. Do not operate the machine on upward or downward slopes greater than 10°.
14. If you find an abnormality, stop the machine on flat ground. Before inspecting the machine, step the brake lever and lock the brake, and then turn the power off.
15. Before operating the machine, make sure that the lock lever is fully pulled down and completely locked. If the lock is incomplete, there is a risk of accident or injury as the carrier or bucket may be tilted and the objects fall when going downhill.
16. Be careful not to entangle the cords with the load or obstacles.
17. Use only manufacturer-recommended replacement parts and accessories.



### **CAUTION:**

**Do not allow persons to operate or assemble this Cart until they have read this manual and have developed a thorough understanding of how the Electric cart works.**



### **WARNING:**

**The warnings, cautions, and instructions discussed in this instruction manual cannot cover all possible conditions or situations that could occur.** It must be understood by the operator that common sense and caution are factors that cannot be built into this product, but must be supplied by the operator.

## **SAVE THESE INSTRUCTIONS**

### **WORK AREA**

- **Keep work area clean and well lit.** Cluttered or dark areas invite accidents.
- **Keep children and bystanders** away while operating the electric cart. Distractions can cause you to lose control.
- When operating the machine, **stand behind** the machine and hold the handles firmly.

### **PERSONAL SAFETY**

- This is not a toy. Children should not be allowed to operate it.
- Stay alert, watch what you are doing and use common sense when operating an electric cart. Do not use an electric cart while you are tired or under the influence of drugs, alcohol or medication.
- Use personal protective equipment. Always wear eye protection. Protective equipment such as dust mask, non-skid safety shoes, hard hat, heavy-duty working gloves, and hearing protection used for appropriate conditions will reduce personal injuries.
- Prevent unintentional starting. Ensure the switch is in the off-position before connecting to power source and/or BATTERY pack, picking up or carrying the tool.
- Do not overreach. Keep proper footing and balance at all times. This enables better control of the cart in unexpected situations.
- Dress properly. Do not wear loose clothing or jewelry. Keep your hair, clothing and gloves away from moving parts.
- Always wear protective goggles to protect your eyes from injury when using the electric cart.

## **OPERATION ON SLOPE WARNINGS**

- Be sure to decrease speed and exercise caution on slopes.
- Exercise caution when starting or stopping the machine on slopes.
- As the loads become less stable on slopes, firmly secure the load.
- As the machine becomes unstable depending on the condition of the road, keep the load to a minimum.
- As the view is obscured on slopes, keep the height of the load to a minimum
- Never park the machine on steep slopes. Park the machine on flat ground, pull the brake lever and lock the brake, and then turn the power off.
- Do not change the direction or speed mode on steep slopes.
- Do not release the switch trigger on upward slopes. The machine may go in reverse and cause an accident.
- Make sure that the remaining battery capacity is enough before operating on slopes. If the remaining battery capacity is not enough, charge the battery or replace it with a charged one.

## **LOADING OBJECTIVE WARNINGS**

- Do not overload objects. When loading objects, be sure to follow the instructions and load limits in the manual.
- Firmly secure the objects.
- Load the objects within the carrier or bucket. If the objects protrude from the carrier or bucket, there is a risk of accidents due to the objects falling or contact obstacles such as walls.
- Be sure that loaded objects are below eye level. If the load is too high, it is dangerous because the view is obscured. Also, there is a risk of overturning and injury because the load is likely to be unbalanced.
- Load the objects on the carrier or bucket evenly. If the objects are loaded unevenly, there is a risk of overturning and injury because the load is likely to be unbalanced.
- Before loading the objects or operating the machine, make sure that the lock lever is fully pulled down and completely locked.
- Load and unload objects on flat ground.
- When lifting and tilting the carrier or bucket, hold the handles and frame firmly, and work in a stable posture.

## **BATTERY POWER TOOL USE AND CARE WARNINGS**

- Ensure the switch is in the off position before inserting battery pack. Inserting the battery pack into the electric cart with the switch on may cause accidents.
- Recharge only with the charger specified by the manufacturer. A charger that is suitable for one type of battery pack may create a risk of fire when used with another battery pack.
- Use the electric cart only with specifically designated battery packs. Use of any other battery packs may create a risk of injury and fire.
- When battery pack is not in use, keep it away from other metal objects like paper clips, coins, keys, nails, screws, or other small metal objects that can make a connection from one terminal to another. Shorting the battery terminals together may cause burns or fire.
- Under abusive conditions, liquid may be ejected from the battery; avoid contact. If contact accidentally occurs, flush with plenty of soap and water. If liquid contacts eyes, immediately seek medical help. Liquid ejected from the battery may cause irritation or burns.

## ASSEMBLY WHEEL

1. Install the wheel(2), the wheel pad(4) and 4 elastic washer(5) into the axle(3), and the wheel pattern is as shown in the figure..
2. Use four cap nuts (1) to secure the wheel to the axle.
3. The other side is installed in the same way.  
**(See Figure 1)**

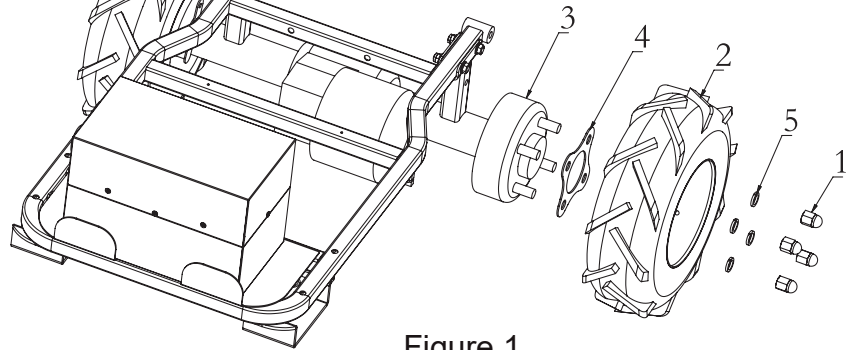

Figure 1

4. The steering wheel (1) is installed on the welding column of the base frame (3).
5. Attach the steering wheel (1) with 1 M8 nut (2) & 1 M8\*45 bolt (4).
6. The other side is installed in the same way.  
**(See Figure 2)**

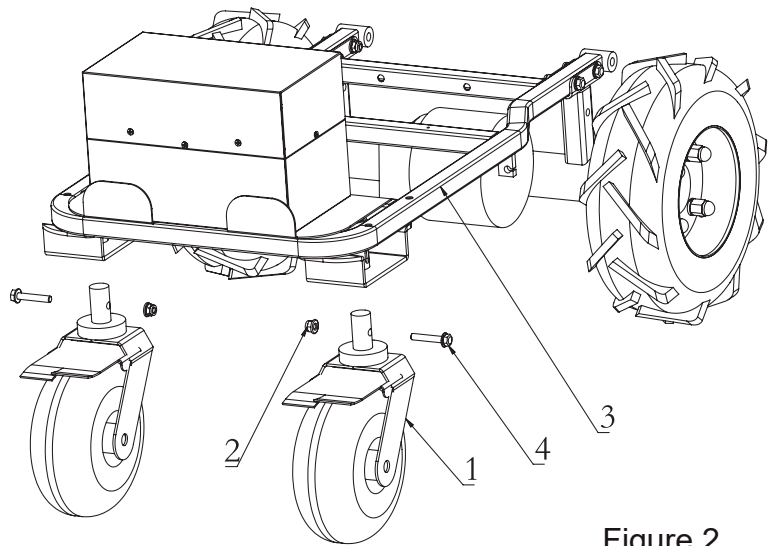

Figure 2

## ASSEMBLY- Main Handle

1. Use four M8\*70 bolts (3) and four M8 nuts (2) to fix the round handle (1) on the base frame.  
**(See Figure 3)**

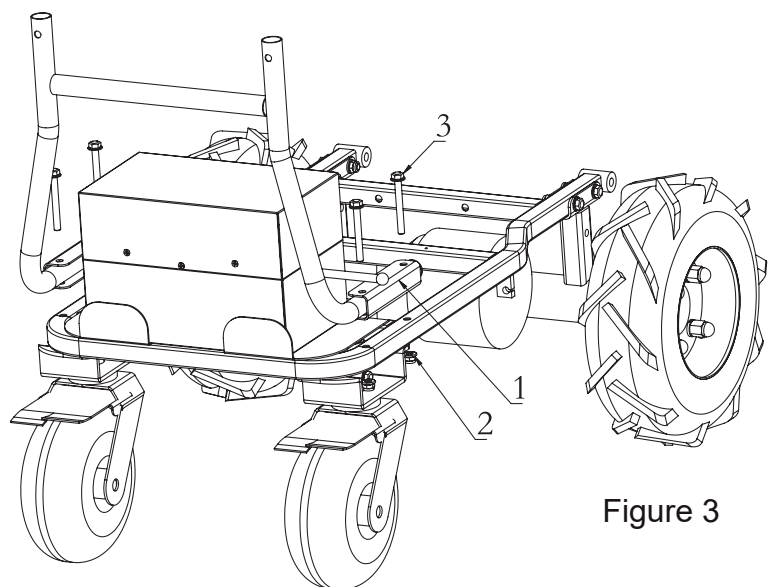
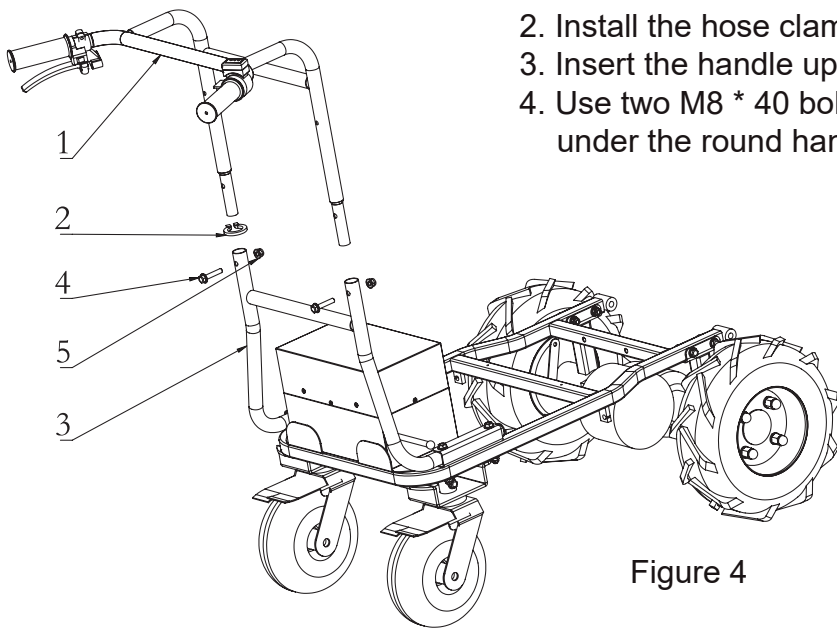

Figure 3





2. Install the hose clamp (2) onto the round handle (1).
3. Insert the handle up side (1) into the handle down (3).
4. Use two M8 \* 40 bolts (1) and two M8 nuts (5) to fix them under the round handle (3). **(See Figure 4)**

Figure 4

## ASSEMBLY- Frame

1. Place the main frame (1) on the base frame.
2. Insert the bolt (2) through an M10 flat washer (3), and the fixing hole, and then an M10 flatwasher (3), and use the b-pin (4) of 3.2 \* 62 to attach the bolt (2).
3. The other side is installed in the same way. **(See Figure 5)**

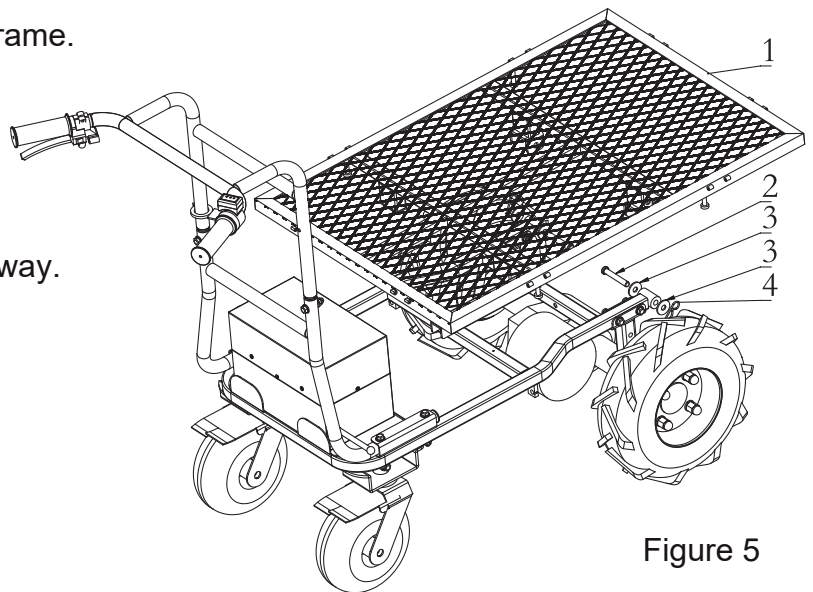

Figure 5

4. Attach the dumping handle(2) to the bottom wire deck(1), attached by Flange bolt (3) and nut (4). **(See Figure 6)**

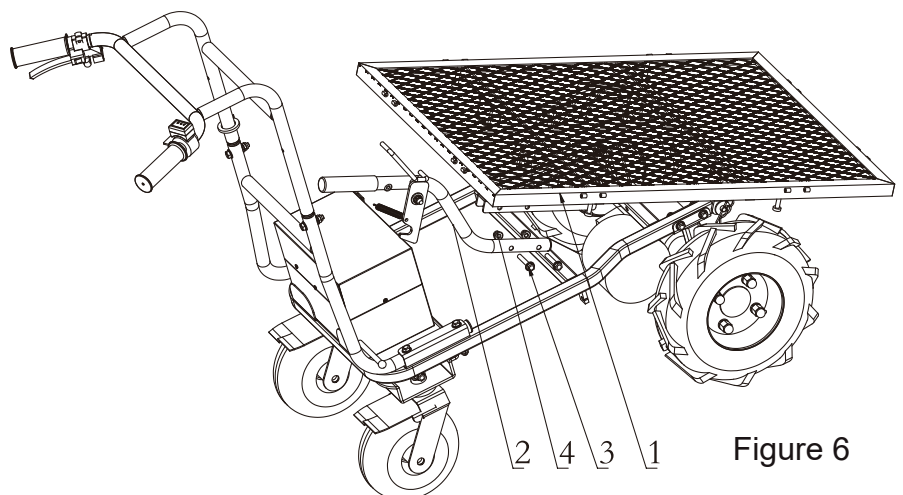

Figure 6

5. Assemble the left & right frame (3), and the front & back frame (4), locked by Pin (5).
6. Locking the entire frame by handle bar (1), the electric cart assembly is finished. (See Figure 7)

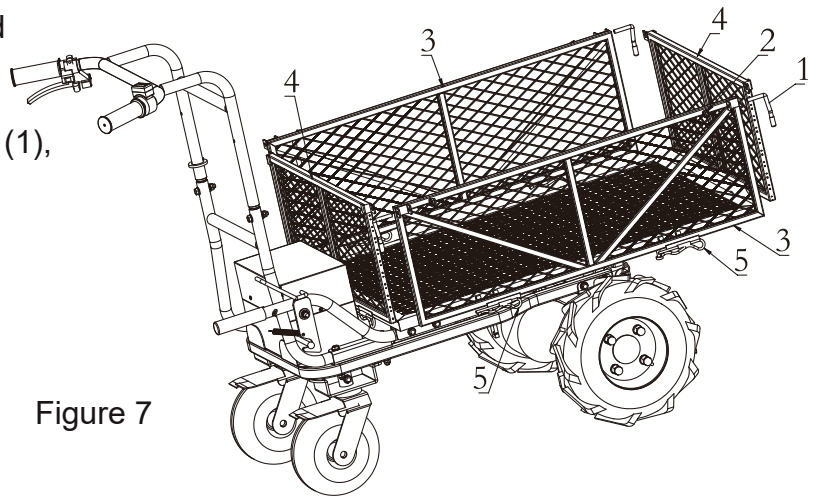

Figure 7

## OPERATION

1. Turn on the power switch (B). (See figure 8)

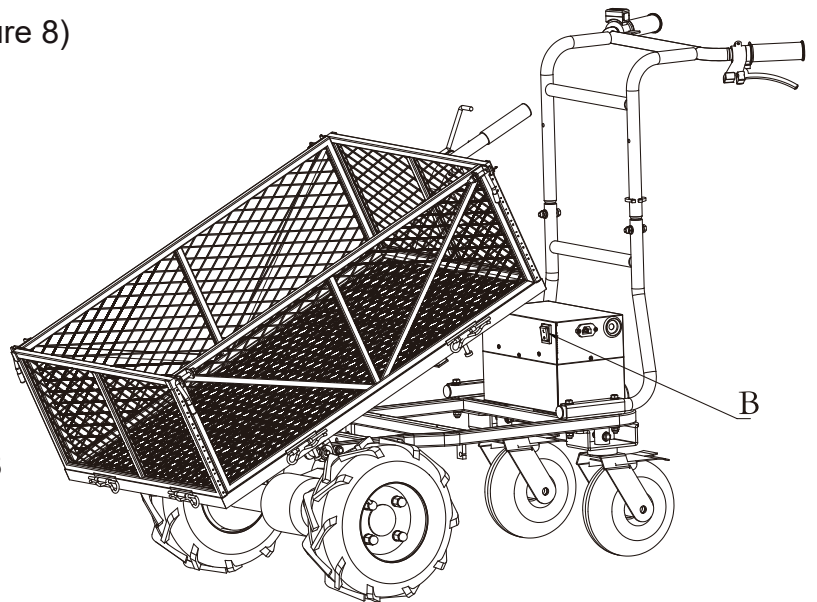

Figure 8

2. Press the start switch (C) on the right handle, then the battery indicator (D) will light up with all 3 LED lights and machine is ready for operation. Press and hold the Switch trigger (E) to start working. By pressing less or more will control the moving speed.

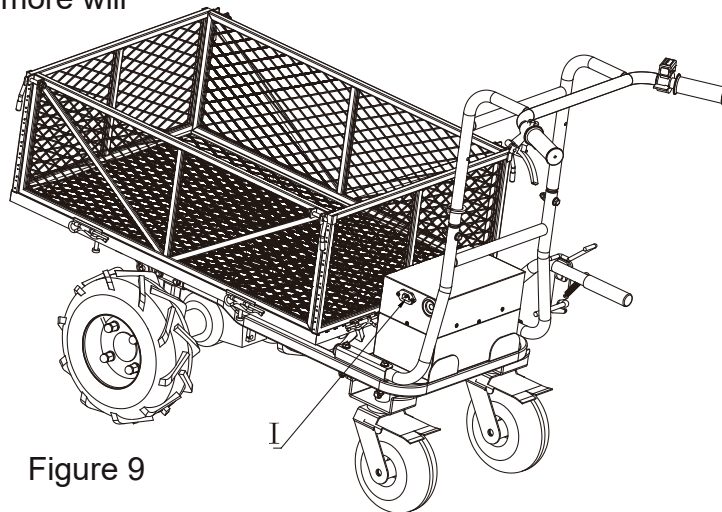
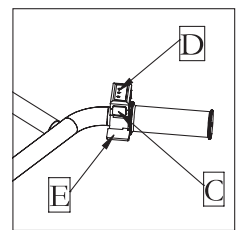

Figure 9

- 
3. Use the direction button (F) on the left handle for forward and reverse.

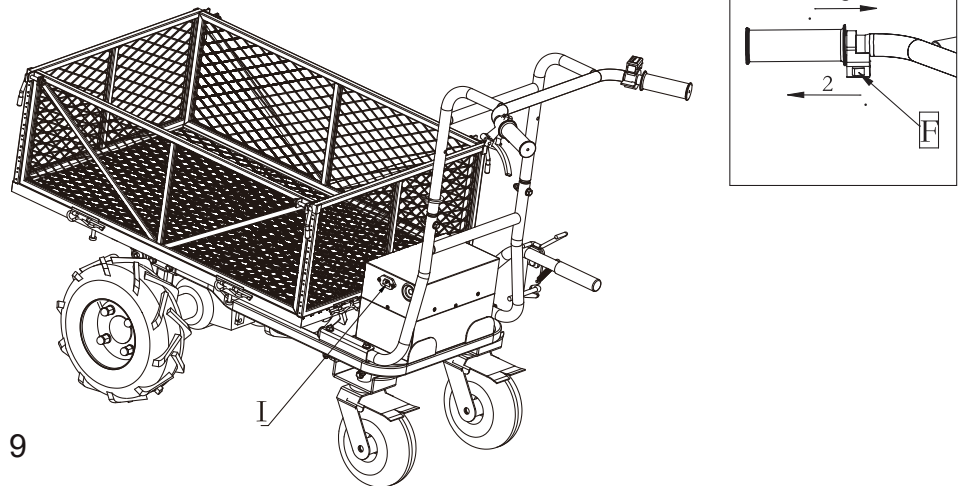

Figure 9

- 
4. Release the lock lever (1) out from the dumping handle holder, push the dumping handle to lift the cart for dumping.

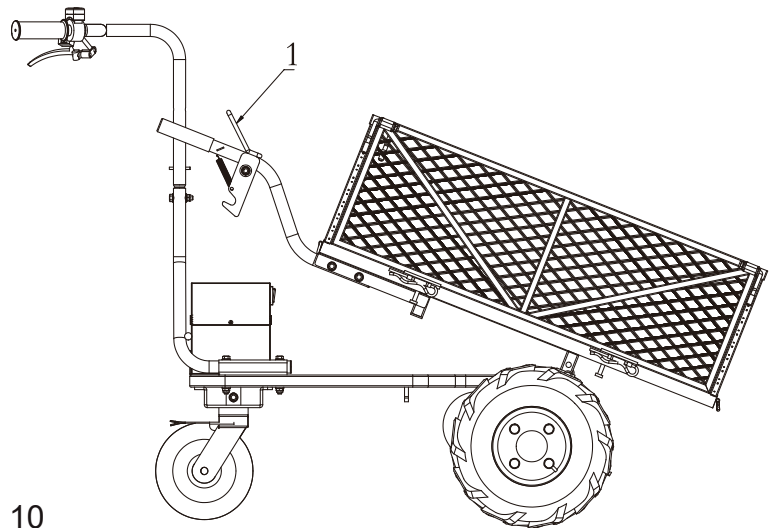

Figure 10

---

## OPERATION ON SLOPE WARNINGS

1. Be sure to decrease speed and exercise caution on slopes.
2. Exercise caution when starting or stopping the machine on slopes.
3. As the load becomes less stable on slopes, firmly secure the loads with straps.
4. As the machine becomes unstable depending on the conditions, keep the load to a minimum
5. As the view is obscured on slopes, keep the height of the load to a minimum
6. Never park the machine on steep slopes. Park the machine on flat ground, pull the brake lever and lock the brake, and then turn the power off.
7. Do not change the direction or speed mode on steep slopes
8. Do not release the switch trigger on upward slopes. The machine may go in reverse and cause an accident.
9. Make sure that the remaining battery capacity is enough before operating on slopes. If the remaining battery capacity is not enough, charge the battery or replace it with a charged one.

### CHECK REMAINING BATTERY CAPACITY

During normal operation, the 3 LED lights of the battery indicator are all on which means the battery is in full power. When the orange light in the middle starts to flash, it warns the power shortage and battery need to be charged or changed to a new one. If the lights turn to red, the machine stops automatically.



## BATTERY CHARGE

1. Battery charge: When the battery is in low capacity, please do recharge. Input the triplex receptor (G) into the battery box (I), and connect the charge plug (H) with electric power to start charging. Once the adaptor light (J) turns green, the battery is fully charged. It usually takes about 4-6 hours.

For a long service life of the battery, please recharge only with charger specified by the manufacturer. Disconnect battery when the cart is not in use.

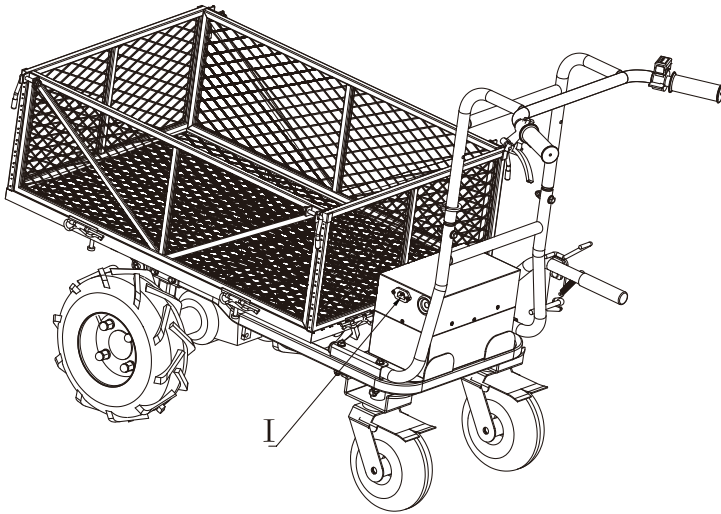

Figure 11

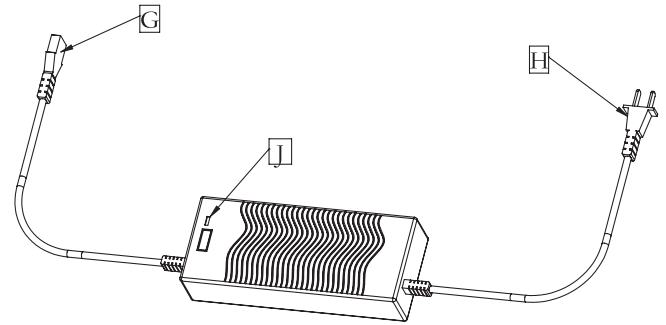

Figure 12

When the unit is not in use for an extended period of time, please open the battery box cover and unplug the positive output cable of the battery pack to ensure that the battery pack is physically disconnected to reduce self-discharge and extend battery life. Charge the battery pack once every 3-4 months during storage.

## TROUBLE SHOOTING

Problem(s)	Possible Cause	Corrective Action
The power cart does not run.	Battery is not charged.	Charge the battery pack according to the instructions included with your model.
	The wire is loose.	Check all the connectors to see if any parts are loose.
	The controller is damaged.	Replace the damaged controller.
The power cart runs sluggishly.	Battery volume is low.	See the battery indicator to check the volume. Charge the battery pack according to the instructions included with your model.
	The battery is old and does not accept full charge.	Replace the battery with a new one.
	The conditions are too stressful for your power cart.	The cart is intended for residential use. If slopes are too steep or the terrain too bumpy, your cart might experience a noticeable decrease in performance.

# DIAGRAM & PARTS LIST

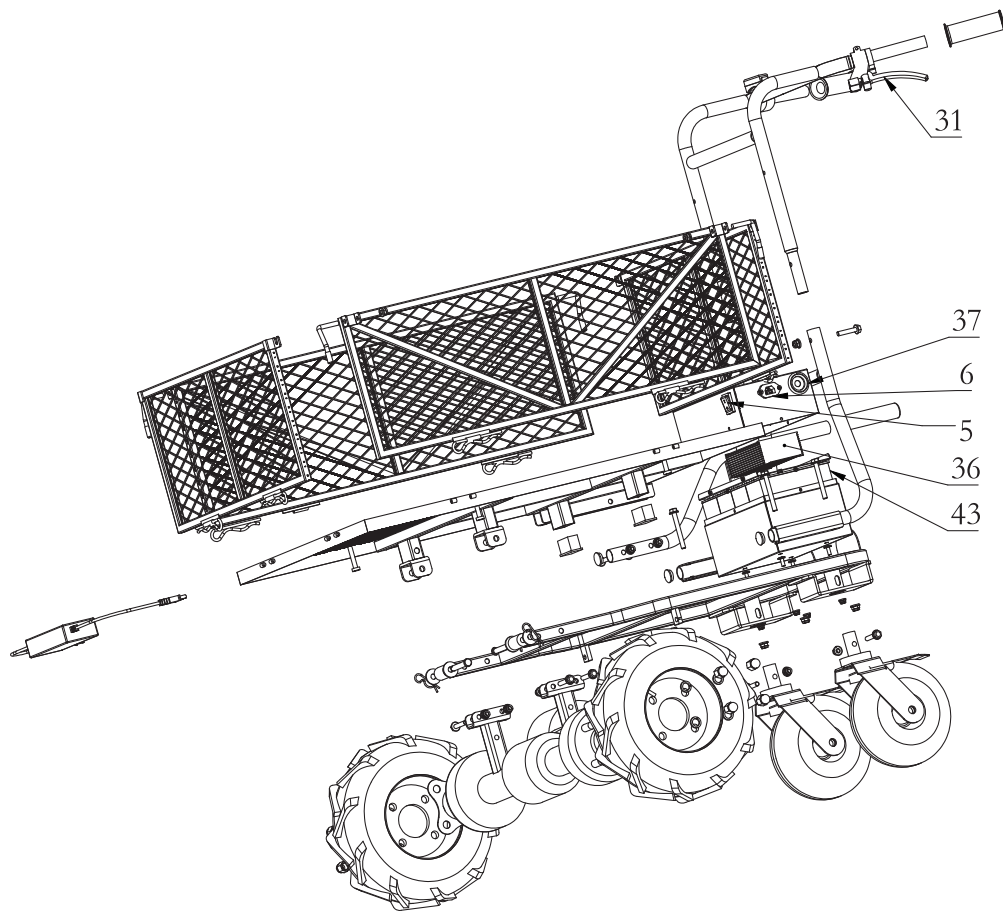
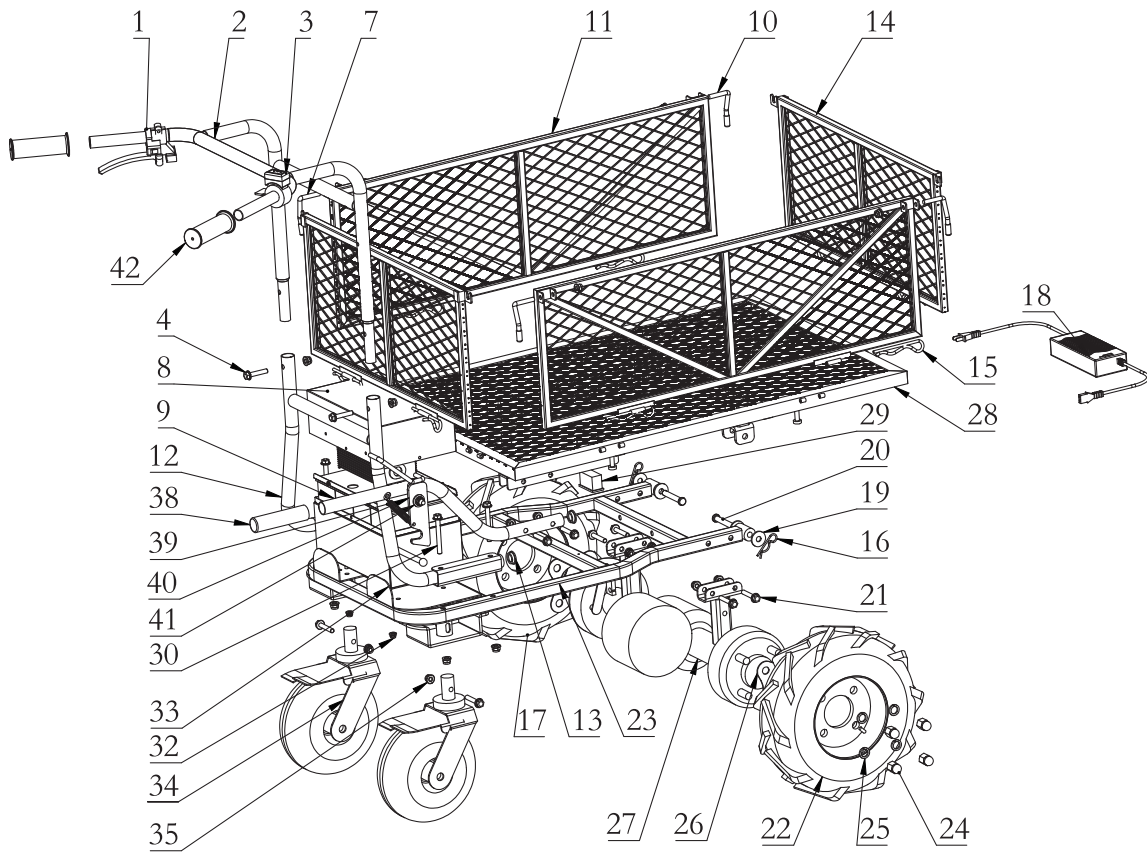

Part No.	Description	Q'ty	Part No.	Description	Q'ty
1	Left handle switch	1	23	Chassis Frame	1
2	Round tube handle (Up)	1	24	Hex Cap Nuts M14X1.5	8
3	Turn right handle	1	25	Elastic washer 14	8
4	Hexagon flange bolts M8x40	2	26	Flat key	2
5	Switch	1	27	Drive axle	1
6	Charging plug	1	28	Main Frame (Thick mesh)	1
7	Left handle	2	29	Rubber Plug	2
8	Battery Box	1	30	Hexagon flange bolts M8*70	4
9	Handle	1	31	Brake handle assembly	1
10	Right handle	2	32	Hexagon flange bolts M6	4
11	Left & Right guard bar (Thick mesh)	2	33	Cross Recessed Flat Head Screws M6*15	4
12	Round tube handle (Down)	1	34	Caster 8 inch	2
13	Round tube plug	3	35	Non-metallic insert lock nut M8	19
14	Front & Back guard bar (Thick mesh)	2	36	Controller	1
15	B type pin 5*110	8	37	Rubber Plug $\phi$ 30	1
16	Pin 2.5*45	2	38	Handle Sleeve	1
17	Left front wheel 13inch	1	39	Extension Spring	1
18	Charger	1	40	Hook	1
19	Large washer $\phi$ 10	4	41	Washer $\phi$ 8	2
20	Plug	2	42	Sleeve	2
21	Hexagon flange bolts M8*45	8	43	Lead-acid batteries 12V 7AH	4
22	Right front wheel 13inch	1			

**This item is not returnable. Please call 218-943-4290 for parts and technical assistance.**

## WARRANTY

12 months limited parts warranty.

BAC INDUSTRIES  
 PO BOX 155  
 Miltona, MN 56354  
 Made in China



