



**Instruction Manual
&
Parts List**

**Heavy-Duty
Ladder Rack
Model 110115**



Read and understand this entire manual before assembling, installing, operating, or servicing this product.

SAVE THIS MANUAL

Copyright© 2023 by AVITEC. All rights reserved. No portion of this manual or any artwork contained herein may be reproduced in any shape or form without the express written consent of AVITEC. Due to continuing improvements, actual product may differ slightly from the product described herein. Tools required for assembly and maintenance may not be included.

IMPORTANT SAFETY INFORMATION

This is a **SAFETY ALERT** symbol. It is used to alert you to potential personal injury hazards. Obey all safety messages that follow this symbol to avoid possible injury or death.

DANGER indicates a hazardous situation which, if not avoided, will result in death or injury.



WARNING indicates a hazardous situation which, if not avoided, could result in death or serious injury.



CAUTION indicates a hazardous situation which, if not avoided, could result in minor or moderate injury.



NOTICE indicates important information which, if not followed, may cause damage to equipment.

SAVE THIS MANUAL

Keep this manual for the safety warnings and precautions. The manual offers important information on how to assemble, use and maintain this product.

Write the product's model number and purchase date on the cover page of this manual.

Keep this manual (and your purchase receipt) in a safe place.

UNPACKING

The shipment should be thoroughly inspected as soon as it is received. The signed "bill of lading" is acknowledgement by the carrier of receipt in good condition or shipment covered by our invoice. For your own protection, if any of the goods called for on the bill of lading are shorted or damaged, do not accept them until the carrier makes a notation on the freight bill of the shorted or damaged goods.

Notify AVITEC immediately if any hidden loss or damage is discovered after receipt.

Definition of Symbols



WARNING concerning Risk of Eye Injury. Wear ANSI approved eye protection.



WARNING concerning Risk of Hearing Loss. Wear hearing protection.





IMPORTANT SAFETY INSTRUCTIONS

1.  **Read and understand all safety warnings and instructions.** Failure to follow the warnings and instructions may result in serious injury or death. Save all warnings and instructions for future reference.

2. Personal and Work Area Safety

A.  **Always wear ANSI approved safety goggles.**

B.  **Always wear hearing protection when working in noisy environments.** Prolonged exposure to high intensity noise can cause hearing loss.

C.  **Use safety equipment.** Safety shoes, hard hat and work gloves must be used for applicable conditions.

D. **Dress appropriately.** Never wear loose fitting clothing or jewelry when working. Contain long hair, and keep hair, clothing and gloves away from moving parts.

E. **Use common sense when working.** Stay alert and concentrate when setting up and using the Ladder Rack. Never work while under the influence of alcohol, drugs or medications.

Personal and Work Area Safety (continued)

F. While assembling and using the Ladder Rack keep work area clean and well lighted. Keep spectators and children out of the work area.

3. Use of the Ladder Rack

A. Do not modify the Ladder Rack and do not use this product for purposes that it was not designed for.

B. This Ladder Rack is designed to carry ladders, lumber, piping, rebar, sports equipment and other long materials.

C. Never exceed the maximum weight capacity of 250 Lbs. (this is front and back rack combined capacity).

D. Be aware of the danger of “dynamic loading”. This situation arises when a load is dropped onto the Ladder Rack, resulting in a short term excessive load. Dynamic loading can result in damage and failure of the Ladder Rack, damage to the truck, and personal injury to the person loading the Ladder Rack.

E. Never load people or animals onto the Ladder Rack. Keep children and spectators well clear when loading unloading and using this product.

F. Adhere to all Department of Transportation (D.O.T.) requirements when using this product. Always use ropes and tie downs to securely hold all cargo in place.

G. For the vehicle that will support the Ladder Rack, read all pertinent vehicle instructions and warnings provided in the owner’s manual. Make sure the vehicle is in a safe location, away from traffic. with engine OFF, and parking brake set, before assembly, set-up, and while loading or unloading the Ladder Rack.

H. The load on the Ladder Rack should be evenly distributed.

I. Before installing and drilling holes in the truck bed, verify that no electrical lines or gas tanks are in the drilling path. After drilling mounting holes and installing the Ladder Rack, recheck electrical lines and braking system to insure proper operation.

J. The Ladder Rack must be securely bolted into the rail and bed of the truck.

K. Maintain labels and nameplates on the Ladder Rack. They contain important information and must always remain readable. Contact AVITEC for replacements.

Keep in mind that the warnings previously discussed cannot cover all possible conditions or situations that could occur. It is important that the person setting up and using this product understand that common sense and caution are factors which cannot be built into this product, and must be supplied by the person(s) using this product.

Limited Warranty

AVITEC warrants to the original retail purchaser that the product is free of defects in material and workmanship at the time of shipment. This Ladder Rack is warranted for 90 days from the date of purchase. This warranty is expressly in lieu of all other warranties, express or implied.

Proof of purchase is required for warranty transactions; a copy of the original invoice or sales receipt is required.

Assembling and Setting Up the Ladder Rack



Always wear ANSI approved safety goggles.

WARNING

Setting up and mounting the Ladder Rack to the truckbed requires some complex assembly steps. Holes have to be drilled into the truckbed and component parts are heavy. If you are not experienced and capable of doing this type of setup work, the installation of the Ladder Rack should be done by a qualified service technician.

1. Refer to photo on cover page of this manual of an already set-up Ladder Rack, and to photo on opposite column of this page. Also see Assembly Diagram at end of this manual.

2. Carefully lay out the major components of the Ladder Rack as shown in photo above right.

3. The front and rear Ladder Racks are identical and can be set up on either the left or right side of the truck bed. For purposes of this manual, instructions are written for left hand side of truck bed installation.

4. Note how the **Mounting Bracket (2)** slides over the top of the **Base Bracket (14)**.

Hand tighten the Set Screw (9) for now to hold the Mounting Bracket in place. Plan the location of the Base Brackets (one in front, left hand side of the truck bed and the other in back, left hand side of truck bed).

The top of Base Bracket will be attached to the vehicle's upper bed rail with Bolt (10), Spring Washer (12), Flat Washer (11)

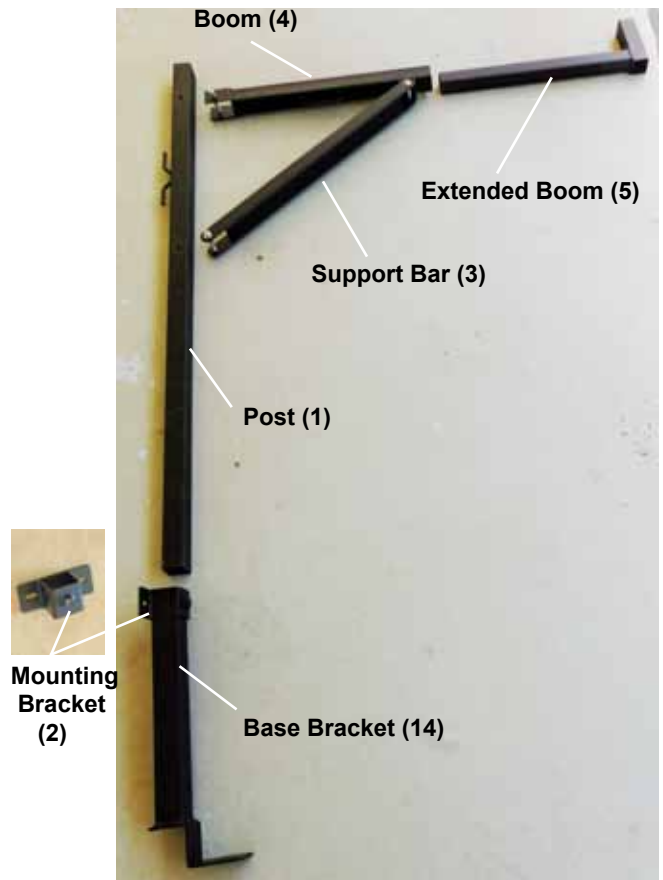
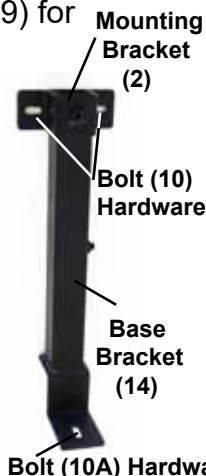

and Lock Nut (13A) through each of the 2 mounting holes on top of Mounting Bracket.

The foot of the Base Bracket must rest flat on a rib of the truck bed and is attached with one Bolt (10A), Spring Washer (12), Flat Washer (11) and Lock Nut (13A).

After adjusting the Mounting Bracket for proper height, tighten the Set Screw (9).

WARNING

Mark the 3 drill holes for each Mounting Bracket/Base Bracket and carefully drill the holes.

Make sure that there are no obstructions in the drilling path.

Using the hardware previously described, securely attach the Mounting Brackets/Base Brackets to the truck bed.

5. Assembling upper portion of Ladder Rack:

A. Assemble Boom (4) and Support Bar (3) to Post (1) using 2 sets of Bolt (6), Washer (7) and Lock Nut (7) - see photo below.

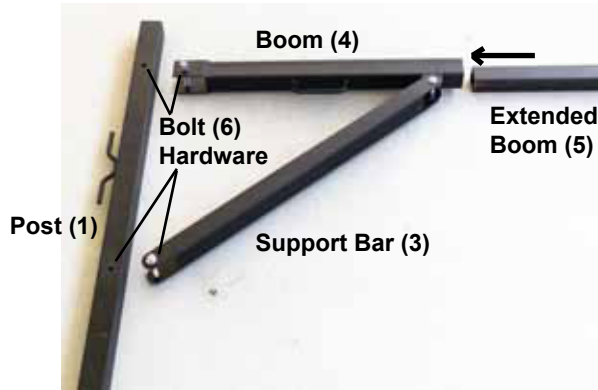

B. Slide Extended Boom (5) into end of Boom (4) and secure in place with Set Screw (9).

C. Repeat the above two steps to assembly the upper portion of the other Ladder Rack.

6. Assembling upper Ladder Rack to Base Bracket (14):

A. Place lower portion of Post (1) through Mounting Bracket (2) and slide Post (1) into bottom of Base Bracket (14); secure in place with Set Screw (9). See photo below.

B. Repeat the above steps to assemble the other upper Ladder Rack to a Base Bracket.

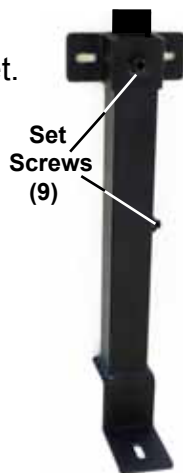

7. Using the Ladder Rack

A. Adhere to all Department of Transportation (D.O.T.) requirements when using this product. Use ropes and tie downs to securely hold all cargo in place.

B. When assembly is complete, check and test all vehicle systems including lights and brakes; make sure no damage occurred during product installation.

C. When adjusting the Extended Boom (5) for varying load widths, always leave at least 3" of the end of the Extended Boom inside the Boom (4).

D. Before and after each use, check to make sure that all hardware is tightly secured.

E. Make sure the vehicle is in a safe place for loading ladders and other cargo. Make sure the vehicle's engine is OFF, with parking brake set, before loading or unloading the Ladder Rack.

F.  **WARNING** Do not overload the Ladder Rack. Never exceed the maximum weight capacity of 250 Lbs. (this is front and back rack combined capacity)

8. Maintaining the Ladder Rack

A. Frequently check the condition of the Ladder Rack. Make sure all components are in good condition. If the Ladder Rack becomes damaged through accident, or if any weld damage is noted, the product should be replaced.

SPECIFICATIONS

Maximum Weight Capacity	250 Lbs. (front and back rack combined capacity)
Adjustable	Arms adjust from 19" to 34" to hold most ladders
Construction	All steel construction with powder coated finish
Hardware	Installation hardware included
Built-in cleats	Included to aid in safely securing cargo

Assembly Diagram

Parts List

Part	Description	Qty
1	Post	2
2	Mounting Bracket	2
3	Support Bar	2
4	Boom	2
5	Extended Boom	2
6	Bolt M8x60	6
7	Washer 8	6
8	Lock Nut 8	6
9	Set Screw 10	6
10	Bolt M8x35	4
10A	Bolt M8x70	2
11	Flat Washer 8	6
12	Spring Washer 8	6
13A	Lock Nut M8	6
14	Base Bracket	2
18	Sleeve	2
19	Allen key	1

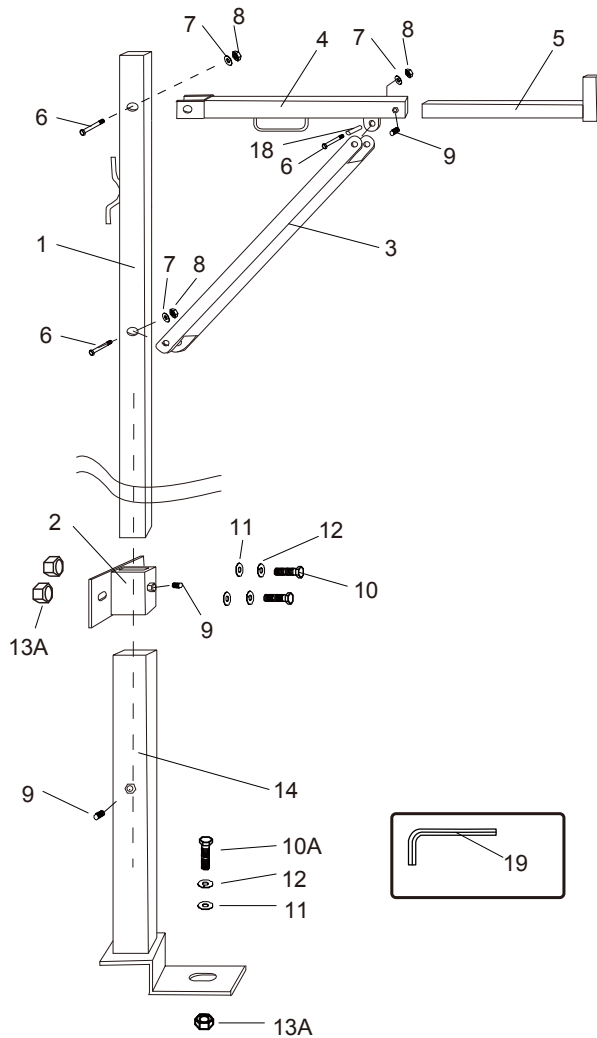

Note: The Parts List and Assembly Diagram is provided as a reference tool only. Some parts are listed and shown for illustration purposes only, and are not available as replacement parts. All repairs to this tool (including replacing parts) should only be done by a qualified service technician.

Manufactured and Distributed by: Avitec Towing and Garage Equipment
 Camarillo, CA 93012, U.S.A
www.avitecusa.com
 Customer service hours 9:00 am-4:00 pm, Monday-Friday, PST.,
 1-805-385-9888