



Hitch Mounted Aluminum Cargo Carrier

Instruction Manual
&
Parts Catalog

500 Lb. Capacity

Model 110111



Read and understand this entire manual before assembling, installing, operating, or servicing this product.

SAVE THIS MANUAL

Copyright© 2023 by AVITEC. All rights reserved. No portion of this manual or any artwork contained herein may be reproduced in any shape or form without the express written consent of AVITEC. Due to continuing improvements, actual product may differ slightly from the product described herein. Tools required for assembly and maintenance may not be included.

IMPORTANT SAFETY INFORMATION

This is a **SAFETY ALERT** symbol.



It is used to alert you to potential personal injury hazards. Obey all safety messages that follow this symbol to avoid possible injury or death.



DANGER indicates a hazardous situation which, if not avoided, will result in death or injury.



WARNING indicates a hazardous situation which, if not avoided, could result in death or serious injury.



CAUTION indicates a hazardous situation which, if not avoided, could result in minor or moderate injury.



NOTICE indicates important information which, if not followed, may cause damage to equipment.

SAVE THIS MANUAL

Keep this manual for the safety warnings and precautions. The manual offers important information on how to assemble, use and maintain this product.

Write the product's model number and purchase date on the cover page of this manual.

Keep this manual (and your purchase receipt) in a safe place.

UNPACKING

The shipment should be thoroughly inspected as soon as it is received. The signed "bill of lading" is acknowledgement by the carrier of receipt in good condition or shipment covered by our invoice. For your own protection, if any of the goods called for on the bill of lading are shorted or damaged, do not accept them until the carrier makes a notation on the freight bill of the shorted or damaged goods.

Notify AVITEC immediately if any hidden loss or damage is discovered after receipt.

Definition of Symbols



WARNING concerning Risk of Eye Injury. Wear ANSI approved eye protection.



WARNING concerning Risk of Hearing Loss. Wear hearing protection.





IMPORTANT SAFETY INSTRUCTIONS

1.  **Read and understand all safety warnings and instructions.** Failure to follow the warnings and instructions may result in serious injury or death. Save all warnings and instructions for future reference.

2. Personal and Work Area Safety

A.  **Always wear ANSI approved safety goggles.**

B.  **Always wear hearing protection when working in noisy environments.** Prolonged exposure to high intensity noise can cause hearing loss.

C.  **Use safety equipment.** Safety shoes, hard hat and work gloves must be used for applicable conditions.

D. **Dress appropriately.** Never wear loose fitting clothing or jewelry when working. Contain long hair, and keep hair, clothing and gloves away from moving parts.

E. **Use common sense when working.** Stay alert and concentrate when setting up and using the Cargo Carrier. Never work while under the influence of alcohol, drugs or medications.

Personal and Work Area Safety (continued)

F. **While assembling and using the Cargo Carrier keep work area clean and well lighted. Keep spectators and children out of the work area.**

3. Use of the Cargo Carrier

A. **The Cargo Carrier must be attached to a 2" x 2" Class III or Class IV hitch receiver.** The hitch must be properly installed by a qualified service technician and be certified to support the weight of this Cargo Carrier and its contents (500 Lbs. capacity).

B. This Cargo Carrier is designed to haul firewood, coolers and other similar loads. **Do not modify the Cargo Carrier and do not use this product for purposes that it was not designed for.**

C. **Never exceed the maximum weight capacity of 500 Lbs.**

D. **Be aware of the danger of "dynamic loading"**. This situation arises when a load is dropped onto the Cargo Carrier, resulting in a short term excessive load. Dynamic loading can result in damage and failure of the Cargo Carrier and/or hitch receiver, and personal injury to the person loading the Cargo Carrier.

E. **Never load people or animals into the Cargo Carrier.** Keep children and spectators well clear when loading and using this product.

F. **Adhere to all Department of Transportation (D.O.T.) requirements when using this product.** Use ropes and tie downs to securely hold all cargo in place.

G. For the vehicle that will support the Cargo Carrier, read all pertinent vehicle instructions and warnings provided in the owner's manual. **Make sure the vehicle's engine is**

OFF, with parking brake set, before loading or unloading the Cargo Carrier

H. **Weight inside the Cargo Carrier should be evenly distributed, with heavier items positioned towards the center of the Carrier.**

I. **Note the position of the vehicle's exhaust pipes before setting up the Cargo Carrier.** Make sure exhaust pipes are not in close proximity of the Cargo Carrier; flammable goods in the Cargo Carrier could catch on fire due to heat from exhaust. If this risk exists on your vehicle, do not use the Cargo Carrier

Keep in mind that the warnings previously discussed cannot cover all possible conditions or situations that could occur. It is important that the person loading/unloading and using this product understand that common sense and caution are factors which cannot be built into this product, and must be supplied by the person(s) using this product.

Limited Warranty

AVITEC warrants to the original retail purchaser that the product is free of defects in material and workmanship at the time of shipment. This Cargo Carrier is warranted for 90 days from the date of purchase. This warranty is expressly in lieu of all other warranties, express or implied.

Proof of purchase is required for warranty transactions; a copy of the original invoice or sales receipt is required.

Assembling and Setting Up the Cargo Carrier

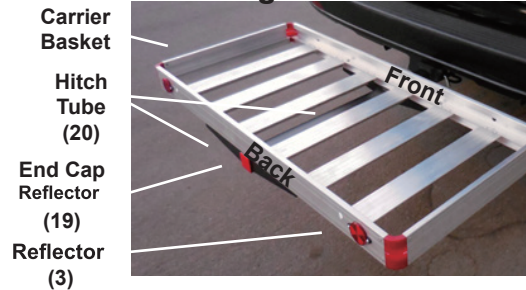

1. Refer to photo above of an already assembled Cargo Carrier, and to the Assembly Diagram at end of this manual.

2. Put two Reflectors (3) in place (reflective side facing the rear of cargo carrier), insert two Screws (2) through side of Reflector (3), and secure to back Long Edge (12) of carrier basket using Spring Washer (4) and Nut (5).

3. Align the hole openings on Support Plate(11) and Long Edge (12) of carrier basket, insert the Screw (9) with Washer (10) from both sides, fasten Screw (9) into the Rivet Nut mounted on the Support Plate (11). Repeat this step to connect six Support Plate (11) with two Long Edge (12) of Carrier Basket.

4. Insert the raised part of Short Edge (1) into the square holes on the Long Edge (12) of carrier basket, secure the Short Screw (6) and Long Screw (7) with Nut (8).

5. Using the Bolt(18) and Nut (17), fasten the Brace (16) and Hitch Tube (20).

6. Attach carrier basket to hitch tube. Find the two attachment holes on both the "front" and "back" edge of carrier basket. Inset the Screw (13) with Washer (14) from the top, through the Long Edge (12) and Brace (16). Secure the bolt with Washer (14) and Nylon Nut (15), Repeat this at the other 3 attachment points to secure the Carrier Basket to the Hitch Tube.

7. Place End Cap Reflector (19) onto end of Hitch Tube (20).

8. With all components now assembled make sure all hardware is securely tightened.

WARNING The Cargo Carrier must be attached to a 2" x 2" Class III or Class IV hitch receiver.

9. To place the Cargo Carrier on the vehicle's hitch receiver:

- A. First remove the Hitch Pin (21) attached to the Safety Clip (22).
- B. If needed, use a helper to lift the empty Cargo Carrier and slide the open end of the Hitch Tube (20) into the vehicle's 2" x 2" hitch receiver.
- C. Align the hole openings on hitch receiver and Hitch Tube (20), and put the Safety Clip (22) in place. Secure Hitch Pin with the Hitch Pin (21).

10. Load the Cargo Carrier as needed. Use ropes and tie downs to securely hold all cargo in place.

WARNING Do not exceed the 500 Lbs. maximum weight capacity. Weight inside the Cargo Carrier should be evenly distributed, with heavier items positioned towards the center of the Cargo Carrier.

Maintaining the Cargo Carrier

1. Frequently check the condition of the Cargo Carrier, the Hitch Pin, the Safety Clip and the vehicle's hitch receiver. Make sure all components are in good condition. If the Cargo Carrier or hitch receiver become damaged through accident, or if any weld damage is noted, the product should be replaced. Check to make sure that all hardware is tightly secured in place. Keep the Cargo Carrier clean.

SPECIFICATIONS

Maximum Weight Capacity	500 Lbs.
Construction	Extruded Aluminum
For Use With	2" x 2" Class III and IV Hitch Receivers
Carrier Platform Inside Dimensions	48.25" Long x 21.25" Wide x 2" Tall
Hitch Pin	5/8" Diameter with Safety Clip
Safety Reflectors	Included

Parts List

Part #	Description	Qty	Part #	Description	Qty
1	Short Edge	2	12	Long Edge	2
2	Screw	4	13	Screw	4
3	Reflector	2	14	Washer	8
4	Spring Washer	4	15	Nut	4
5	Nut	4	16	Brace	2
6	Short Screw	4	17	Nut	1
7	Long Screw	4	18	Bolt	1
8	Nut	8	19	End Cap Reflector	1
9	Screw	12	20	Hitch Tube	1
10	Washer	12	21	Hitch Pin	1
11	Support Plate	6	22	Safety Clip	1

Assembly Drawing

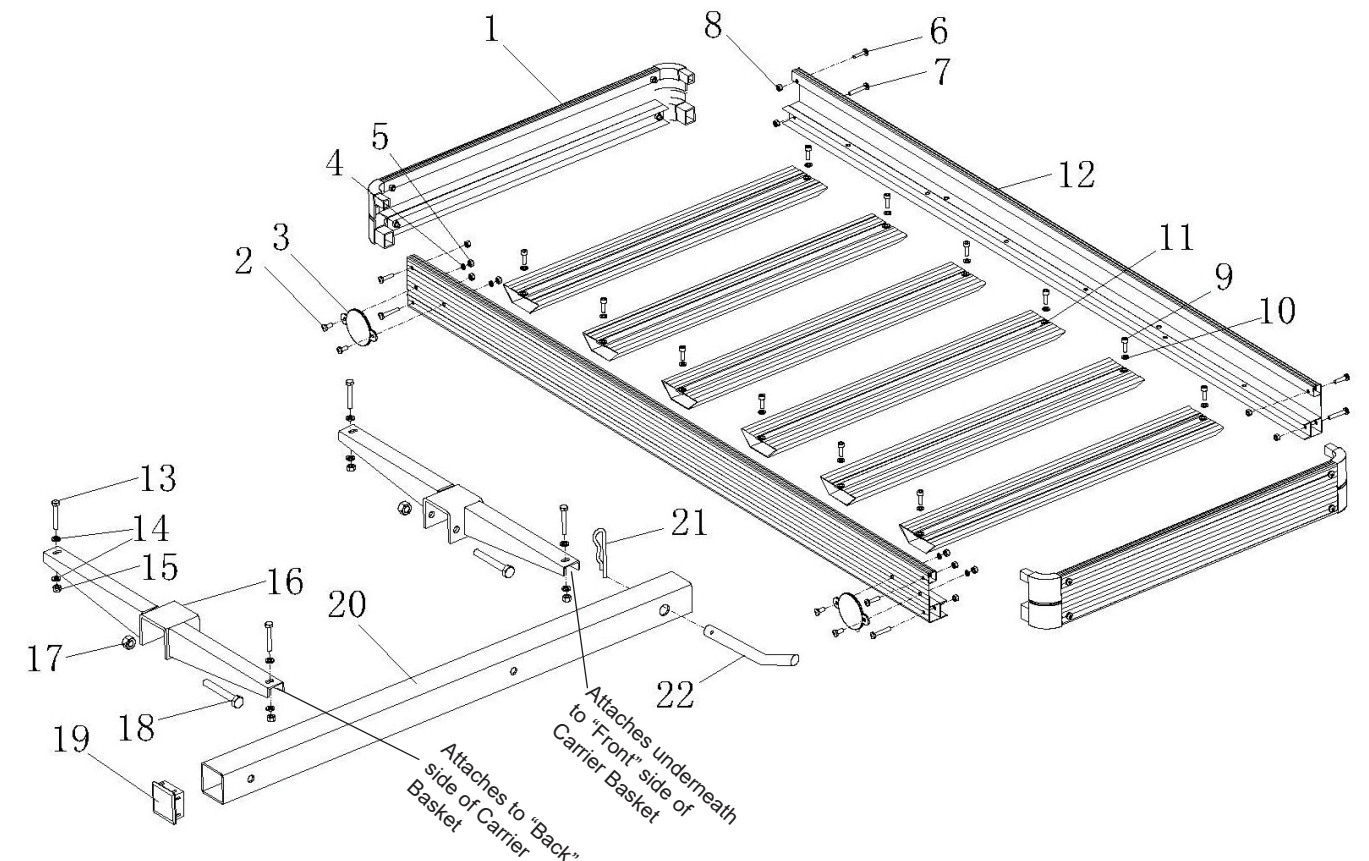

Note: Some parts are listed and shown for illustration purposes only; no replacement parts are available.

Manufactured for and distributed by:
 Avitec Towing and Garage Equipment
 Camarillo, CA 93012, U.S.A
 www.avitecusa.com
 Customer service hours 9:00 am-4:00 pm, Monday-Friday, PST.,
 1-805-385-9888