

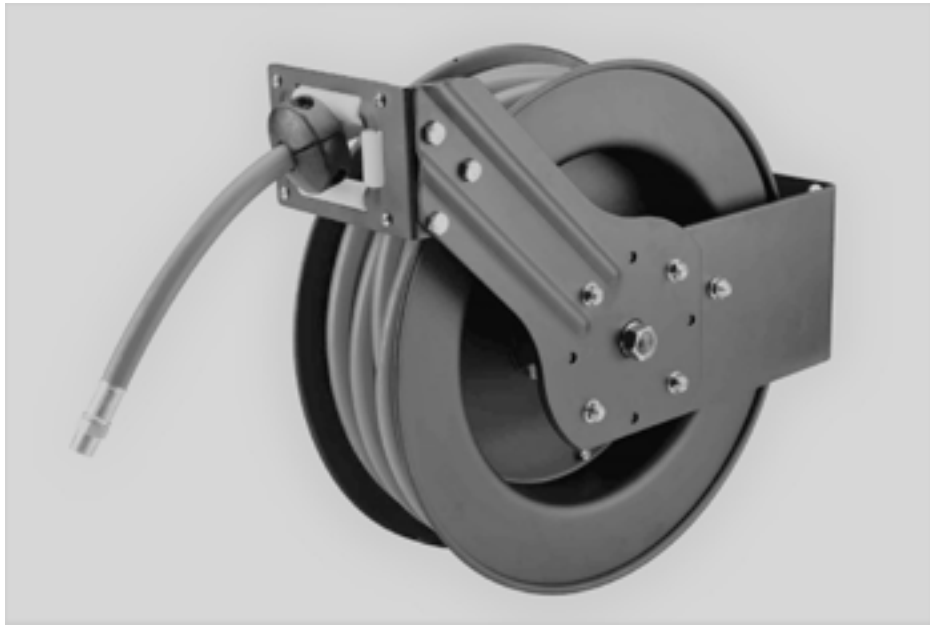

**Instruction Manual
&
Parts List**

**Professional
Hose Reel**

Model 110102



Read and understand this entire manual before assembling, installing, operating, or servicing this product.

SAVE THIS MANUAL

Copyright© 2023 by AVITEC. All rights reserved. No portion of this manual or any artwork contained herein may be reproduced in any shape or form without the express written consent of AVITEC. Due to continuing improvements, actual product may differ slightly from the product described herein. Tools required for assembly and maintenance may not be included.

IMPORTANT SAFETY INFORMATION

This is a **SAFETY ALERT** symbol.



It is used to alert you to potential personal injury hazards. Obey all safety messages that follow this symbol to avoid possible injury or death.



DANGER indicates a hazardous situation which, if not avoided, will result in death or serious injury.



WARNING indicates a hazardous situation which, if not avoided, could result in death or serious injury.



CAUTION indicates a hazardous situation which, if not avoided, could result in minor or moderate injury.



NOTICE indicates important information which, if not followed, may cause damage to equipment.

SAVE THIS MANUAL

Keep this manual for the safety warnings and precautions. The manual offers important information on how to assemble, use and maintain this product.

Write the product's model number and purchase date on the cover page of this manual.

Keep this manual (and your purchase receipt) in a safe place.

UNPACKING

The shipment should be thoroughly inspected as soon as it is received. The signed "bill of lading" is acknowledgement by the carrier of receipt in good condition or shipment covered by our invoice. For your own protection, if any of the goods called for on the bill of lading are shorted or damaged, do not accept them until the carrier makes a notation on the freight bill of the shorted or damaged goods.

Notify AVITEC immediately if any hidden loss or damage is discovered after receipt.

Definition of Symbols



WARNING concerning Risk of Eye Injury. Wear ANSI approved eye protection.





WARNING concerning Risk of Hearing Loss. Wear hearing protection.



IMPORTANT SAFETY INSTRUCTIONS

1.  **Read and understand all safety warnings and instructions.** Failure to follow the warnings and instructions may result in serious injury or death. Save all warnings and instructions for future reference.

2. Personal and Work Area Safety

- A.  **Always wear ANSI approved safety goggles.**
- B.  **Always wear hearing protection when working in noisy environments.** Prolonged exposure to high intensity noise can cause hearing loss.
- C.  **Use safety equipment.** Safety shoes, hard hat, dust mask and work gloves must be used for applicable conditions.

D. **Dress appropriately.** Never wear loose fitting clothing or jewelry when working. Contain long hair, and keep hair, clothing and gloves away from moving parts.

E. **Use common sense when working.** Stay alert and concentrate when assembling and using the Professional Hose Reel. Never work while under the influence of alcohol, drugs or medications.

Personal and Work Area Safety (continued)

F. **While assembling and setting up the Hose Reel keep work area clean and well lighted. Keep spectators and children out of the work area.**

3. Use of the Hose Reel

A. Do not modify this product and do not use this product for purposes that it was not designed for.

B.  **The Hose Reel has a maximum working pressure of 250 PSI (Pounds per Square Inch of pressure). Never connect this product to an air source that is capable of exceeding 250 PSI. Over-pressurizing the air tool may cause abnormal operation, tool breakage, hose bursting and/or serious injury to persons nearby.**

C. Before each use of the pneumatic tool, verify that the air source has been adjusted to the rated air pressure or within the rated air pressure range of the pneumatic tool.

D.  **Never use oxygen, carbon dioxide, combustible gases or any bottled gas as an air source for a pneumatic tool; explosions can occur with use of such gases.**

E. Always read and adhere to all safety warnings and instructions provided in the owner's manuals of the air compressor and pneumatic tools that are used with this Hose Reel.

F. It is recommended that a qualified service technician install an in-line shutoff valve for the air supply, so that in the event of an emergency, the air supply can be quickly turned off.

G. Only use clean, dry, regulated compressed air at the rated pressure, or within

the rated pressure range as marked on the pneumatic tool.

H.  This product should be located in an area away from children and out of reach of children. Do not allow children to play with air compressors, pneumatic tools or this Hose Reel.

I. Some product assembly is required. The Hose Reel must be mounted to a solid surface. The hose must be connected to an air supply source as well as a pneumatic air tool or nozzle. If you are not experienced or capable of doing this type of work safely, the Hose Reel should be set up by a qualified service technician.

J. Keep bystanders and children away while using this Hose Reel. Distractions can result in accidents and loss of control of the tools being used.

K. Before each use, check the overall condition of the Hose Reel. Make sure the hose is in good condition. Check the air connections with the air compressor and the pneumatic tool to insure that no air leaks are present. Make sure all hardware is tightened.

L. It is the responsibility of the owner of this Hose Reel to make sure that everyone using the Hose Reel reads and understands the warnings and instructions contained in this instruction manual, as well as the instruction manuals for the air compressor and pneumatic tools being used with this Hose Reel.

M.  The brass components of this product contain lead, a chemical known to the State of California to cause cancer and birth defects or other reproductive harm. (California Health & Safety Code 25249.5, et seq.)

N. Always disconnect the air tool from the air source before making adjustment, chang-

ing accessories, or storing the tool. Such action will reduce the risk of starting the pneumatic tool unintentionally.

O. Save packaging information, warnings and this manual. They contain important information and must always remain readable. Contact AVITEC for replacements.

Keep in mind that the warnings previously discussed cannot cover all possible conditions or situations that could occur. It is important that the person setting up and using this product understand that common sense and caution are factors which cannot be built into this product, and must be supplied by the person(s) using this product.

Limited Warranty

AVITEC warrants to the original retail purchaser that the product is free of defects in material and workmanship at the time of shipment. This Hose Reel is warranted for 90 days from the date of purchase. This warranty is expressly in lieu of all other warranties, express or implied. Proof of purchase is required for warranty transactions; a copy of the original invoice or sales receipt is required.

Note: Additional Warranty Information on Hose (7) is on Page 6.

Setting Up and Using the Hose Reel



Always wear ANSI approved safety goggles.



Use safety equipment.

Safety shoes, hard hat, dust mask and work gloves must be used for applicable conditions.



WARNING Exposure of skin directly to pressurized air, or fluids, can result in severe bodily injury.

Refer to the photo on Page 5, and to the Assembly Diagram and Parts List on Page 6.

A. Read all Personal and Work Area Safety Warnings on pages 2, 3, and on this page before setting up and using this product.

B. The Base (4) needs to be mounted on a solid, flat surface. Plan for the location of the Hose Reel. The Base (4) can be ceiling mounted (no more than 10 feet above the floor), or mounted on a solid wall surface, or floor mounted.

The mounting location must be free of obstructions and electrical wires. It must be sturdy enough to support the Hose Reel's weight and the force of the hose retracting and extending.

Note the 4 mounting holes (1/2" diameter) in the Base (4). Appropriate hardware (not included) must be acquired.



WARNING Before drilling mounting holes always check for hidden wires and cables in the drilling path.

C. The Arm (5) position of the hose guide Roller Bracket Assembly (27) may be changed depending on the Base (4) mounting position.

To make this position change, first pull out some Hose (7) and let the Reel latch. Remove Bolts (32) that attach the Arm (5) to the Base (4). Rotate Arm (5) to desired position and re-install Bolts (32).

D. With the Base (4) properly mounted, double check that hardware is tightened securely.

E. **Connect the Hose Reel to the air compressor:** Apply thread seal tape to the threads of the supply line from the air compressor. Attach a coupler (not included) to the supply line. Connect the coupler to the inlet fitting.

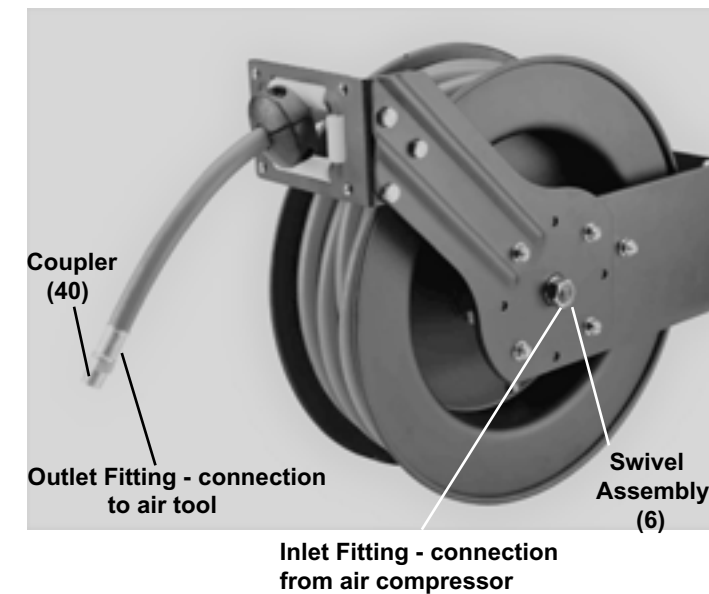

The air tool is connected to the outlet fitting (see photo above). First add thread seal tape, then attach Coupler (40) which will attach to the air tool.

Always read and adhere to all safety warnings and instructions provided in the owner's manuals of the air compressor and pneumatic tools that are used with this Hose Reel.

F. With set-up complete, test the Hose Reel for proper hose operation. Pull out the hose slowly; a clicking noise will occur every half revolution of the reel. To stop (or latch) the Hose in place, retract it after hearing the first, second or third click.

To unlatch, or rewind the Hose, pull on the Hose until the clicking noise stops, then let the Hose fully retract. To protect the Hose, hold on to it while it is retracting.

G. When work is done, disconnect the air tool and wind-up the Hose (7).

Maintaining and Adjusting the Hose Reel



WARNING Always detach air supply before performing maintenance, doing inspections or cleaning this product.

A. The general condition of this product should be checked before each use. Make sure that all hardware is tight. Check for structural damage to the Reel. Check the overall condition of the Hose (7). Check for air leaks and any other condition that might affect the safe operation of this tool. Use soap and water to check for air leaks.

B. Keep the product clean and free of dirt and grease.

C. Adjustment of Spring Tension:

1. Pull out approximately 6 feet of hose and allow the Drum to latch.
2. Remove Ball Stop (28) from the Hose (7) and slide the Hose out of the Roller Bracket (27) so the Hose is hanging loose.
 - to increase hose tension, wrap the loose Hose one time around the Drum (3).
 - to decrease Hose tension, unwrap the Hose one time from the Drum (3).
3. Put the Hose back through the Roller Bracket and re-assemble the Ball Stop.
4. Pull the Hose out and check the tension.

D. Replacement of Swivel Seal:

1. Turn off and disconnect air supply line from Swivel inlet.
2. Remove Swivel Assembly (6) from reel Axle (13).
3. Remove circlip from inside Swivel Assembly (6).
4. Replace the seals and re-assemble Swivel Assembly.

D. Replacement of Swivel Seal (continued):

5. Add thread seal tape to Swivel thread fitting and re-connect the Swivel Assembly (6) to the reel Axle (13).
6. Re-connect inlet air supply line.

E.  WARNING Spring Assembly (1)

If the rewind spring fails for any reason, do not attempt to fix or replace. **The replacement of the Spring Assembly should only be done by a qualified service technician.**

F. Replacement of Hose (7):

Note: The Hose (7), O-Rings, Plastic Rollers and Rubber Stopper are determined to be normal wear items, and as such, are not warranted.

Replacing the Hose (7) requires more effort and attention than normal maintenance. It is recommended that the Hose be replaced by a qualified service technician.

SPECIFICATIONS

Maximum Working Pressure	250 PSI (Pounds per square inch of pressure)
Inlet/Outlet Specifications	1/4" - 18 NPT
Hose	3/8" - 25' Length

Assembly Diagram

Part	Description	Qty
1	Spring Canister	1
2	Drum (air inlet side)	1
3	Drum (mounting bracket side)	1
4	Mounting Bracket	1
5	Guide Arm	1
6A	Air Inlet Valve Body	1
6B	Air Inlet Valve Swivel Collar	1
7	Hose	1
8	Spring Hose Guard	1
9	Hub Bearing Assembly	1
10	Bolt	1

Part	Description	Qty
11	Locking Cam	1
12	Spring	1
13	Axle	1
14	Lock Washer	1
15	Nut	1
16	Bolt	3
17	Nut	7
18	Clamp	1
20	Bolt	2
21	Washer	1
22	Nut	1
23	Washer	3
24	Bolt	3
25	Nut	2
26	Lock Nut	3

Part	Description	Qty
27	Roller Guide Bracket Assembly	1
28	Hose Stopper Assembly	1
29	Ratchet Locking Gear	2
30	Spacing Washer	1
31	Retaining Ring	1
32	Bolt	4
33	Lock Washer	4
34	Setscrew	1
35	Spacing Washer	1
36	Nut	4
37	Spacing Washer	1
38	Pin	1

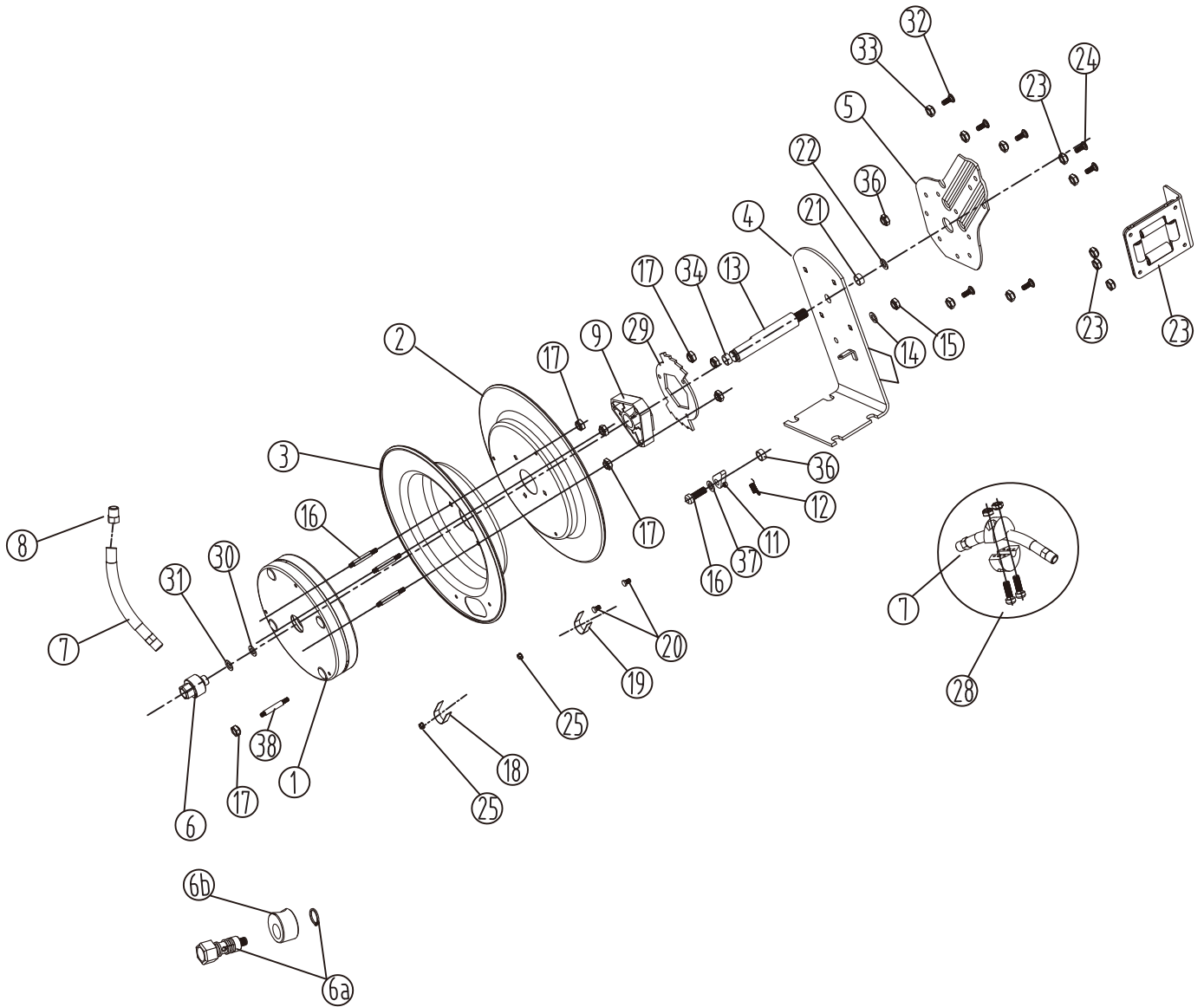

Note: Some parts are listed and shown for illustration purposes only; no replacement parts are available.

Manufactured for and distributed by:
 Avitec Towing and Garage Equipment
 Camarillo, CA 93012, U.S.A
 www.avitecusa.com
 Customer service hours 9:00 am-4:00 pm, Monday-
 Friday, PST., 1-805-385-9888