



MASSIMO



T-Boss 550, 550F, and 550X LUBRICATION GUIDE

Guide for checking Differential and Engine Oils

REAR DIFFERENTIAL

REMOVING THE DRAIN PLUG

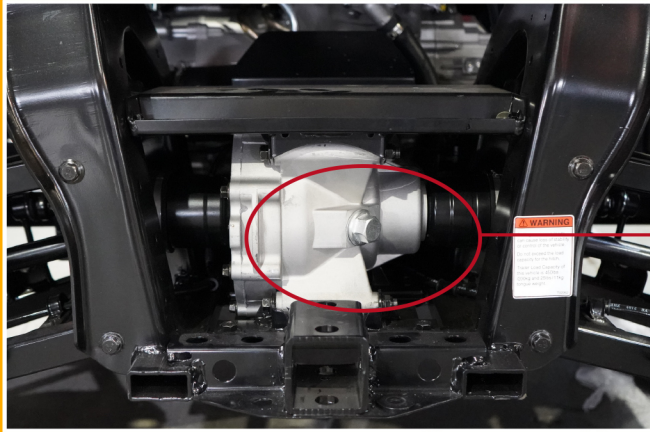

The Rear Differential drain plug is located here.

REAR DIFFERENTIAL

REMOVING THE DRAIN PLUG



Using a 17mm 6-sided socket (do not use 12-sided socket) loosen the Drain Plug.

Unscrew by hand to remove.

REAR DIFFERENTIAL

CHECK OIL LEVEL

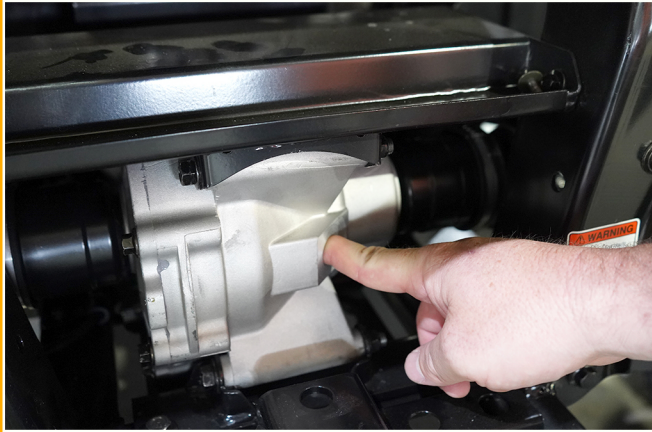

Check the oil level by placing your finger inside the drain plug.

If you cannot feel oil, you will need to add.

REAR DIFFERENTIAL

ADDING OIL

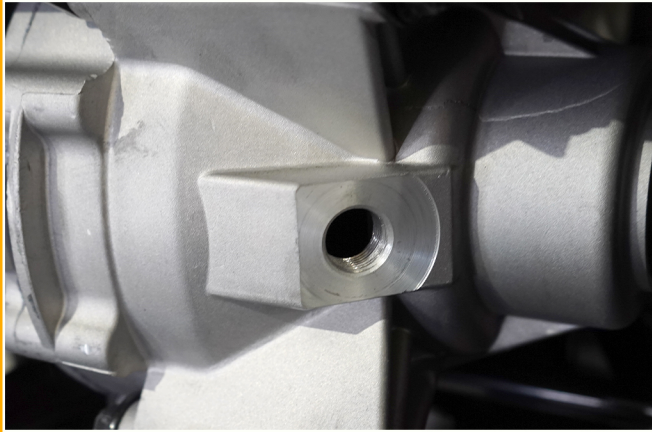

Fill oil until you reach the bottom thread.

Always use 80W 90 GL5 oil.

Replace Drain Plug. Do not exceed
19 ft.lb. of torque.

FRONT DIFFERENTIAL

LOCATING THE DRAIN PLUG



You will find the Front Differential under the Front Driver Side Wheel Well.

FRONT DIFFERENTIAL

LOCATING THE DRAIN PLUG - CLOSE UP

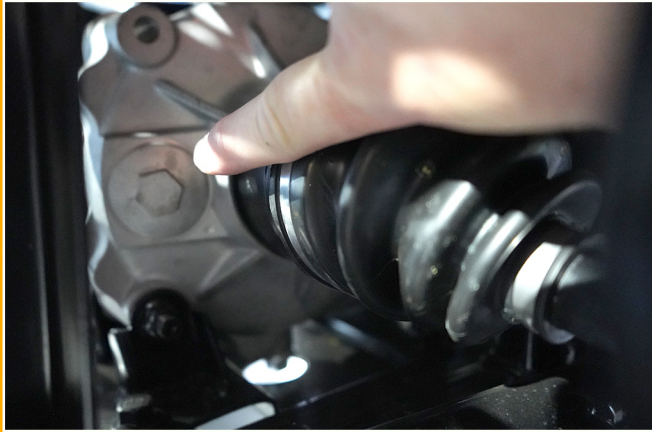

You will need an 18" extension with 17mm 6-sided socket. Remove Drain Plug.

Fill the oil to the bottom of the thread.

Always use 80W 90 GL5 oil.

ENGINE

LOCATING THE DRAIN PLUG

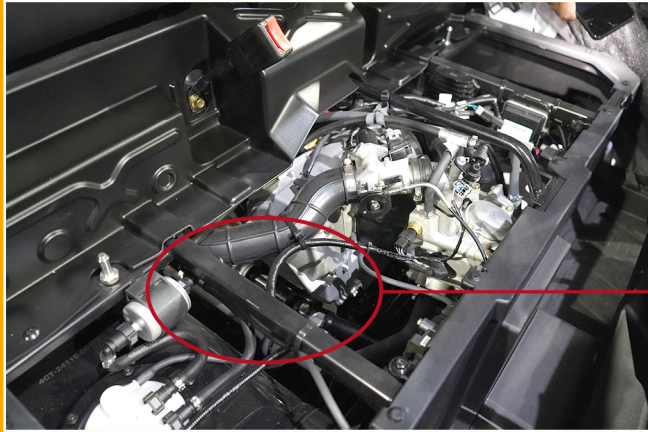

Lift up the bench seat and you will find the fuel location on the Passenger Side.

ENGINE

REMOVING THE DIP STICK



The Dip Stick will either be White or Silver, depending on the model you have.

Remove the Dip Stick by hand.

ENGINE

REMOVING THE DIP STICK



The Fill Port will hold 2.3 qts. of oil.
Use the levels on the Dip Stick to
determine how much oil to add.

Always use 10W 40 Synthetic Blend
designed for use with wet clutch.

SUPPORT

CONTACTING US



For additional assistance and technical support, our friendly technicians are available to help.

Give us a call at (877) 881-6376



MASSIMO

www.MassimoMotor.com