

HARDWARE IDENTIFIER

Illustrations on this page are to scale for faster identification of hardware during assembly.

DO NOT RETURN PRODUCT IF YOU ARE MISSING PARTS.

Please Call: 1 (877) 728-8224



14

Nut; Hex Lock, 5/16" (x25)

B-1674P

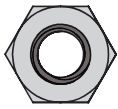

15

Nut; Nylon Lock, 5/16" (x21)

B-4786

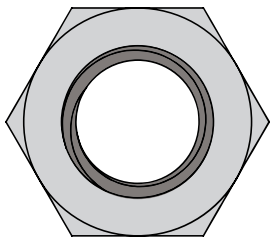

16

Nut; Nylon Lock, 5/8" (x1)

1020078

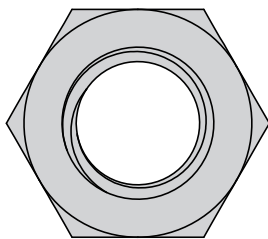

17

Nut; Hex, 5/8" (x4)

30M2000P

13

Bolt: Hex Head, 5/16 x 3/4" (x37).....

2M1012P

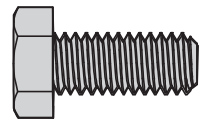

18

Bolt: Hex Head, 5/16 x 1" (x4).....

2M1016P

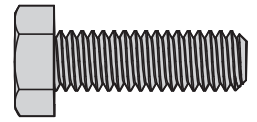

19

Bolt: Hex Head, 5/16 x 1 1/4" (x1).....

2M1020P

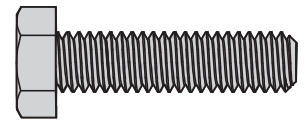

20

Bolt: Hex Head, 5/16 x 1 1/2" (x1).....

2M1024P

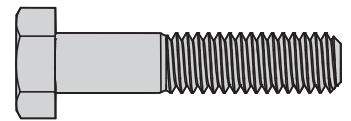

21

Bolt: Hex Head, 5/8 x 4" (x2).....

2M2064P



22

Carriage Bolt: 5/16 x 2 1/4" (x2).....

11M1036P

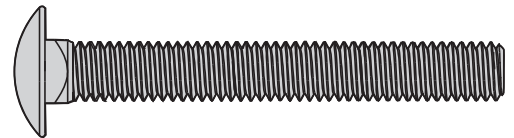

30

Transport Lock Pin (x1).....

1020346

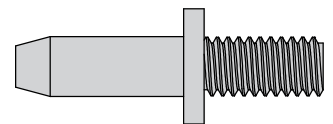

23

Washer: Flat 5/16" (x12)
45M1111P

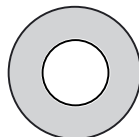

24

Washer: Flat 5/8" (x6)
45M2121P

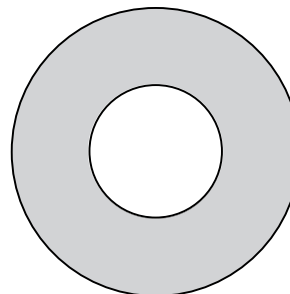

25

Washer: Lock 5/8" (x2)
40M2000P

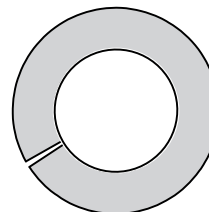

26

Bushing 3/4" (x8)
B-676P

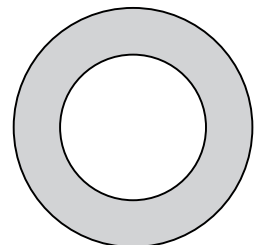

Exterior circumferences of washers can vary. These dimensions are a measurement of the internal diameter of the washer.

PART EXPLOSION

PA-42BH & PA-42BH-A

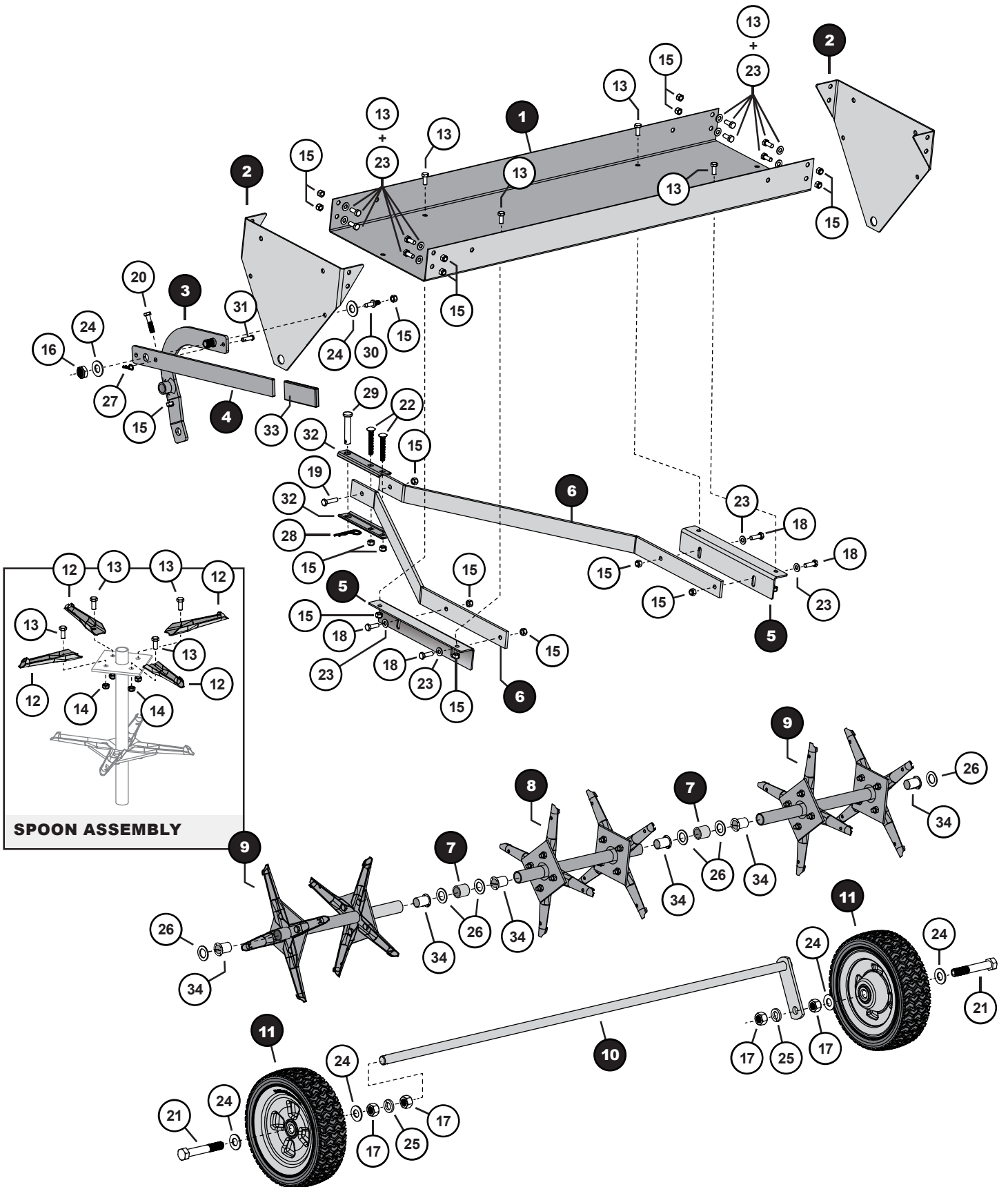

PART LIST

PA-42BH & PA-42BH-A

Ref. Part #	Description	Qty.
1 1019962-BH	Tray	1
2 B-4851-10	End Plate	2
3 1019974-10	Lift Handle, Lower	1
4 1019976-10	Lift Handle, Upper	1
5 B-6171-10	Mounting Bracket	2
6 B-6259-10	Tow Bars	2
7 1020360-01	Spacer	2
8 B-5311-10	Center Tube Assembly	1
9 B-5309-10	End Tube Assembly	2
10 1019965-10	Axle	1
11 1009097	Wheel	2

Z-1530		Spoon / Hardware Bag #1	1
12	B-4855-05	Aerator Spoons	24
Z-1530-A		Inner Hardware Bag	1
13	2M1012P	▪ Bolt; Hex Head, 5/16 x 3/4	25
14	B-1674P	▪ Nut; Lock, 5/16"-18	25

1020137		Hardware Bag #2	1
15	B-4786	Nut; Nylon Lock, 5/16" -18	21
16	1020078	Nut; Nylon Lock, Thin, 5/8" -18	1
17	30M2000P	Nut; Hex, 5/8" -11	4
13	2M1012P	Bolt; Hex Head, 5/16" x 3/4"	12
18	2M1016P	Bolt; Hex Head, 5/16" x 1"	4
19	2M1020P	Bolt; Hex Head, 5/16" x 1-1/4"	1
20	2M1024P	Bolt; Hex Head, 5/16" x 1-1/2"	1
21	2M2064P	Bolt; Hex Head, 5/8" x 4"	2
22	11M1036P	Bolt; Carriage, 5/16" x 2-1/4"	2
23	45M1111P	Washer; Flat, 5/16"	12
24	45M2121P	Washer; Flat, 5/8"	6
25	40M2000P	Washer; Lock, 5/8"	2
26	B-676P	Bushing, 0.765 ID x 0.250	8
27	B-983	Cotter; Hairpin	1
28	D-146P	Cotter; Hairpin, 1/8", #211	1
29	B-3861	Pin; Hitch, 1/2" x 2-1/2"	1
30	1020346	Pin, Transport Lock	1
31	1020077	Clevis Pin, 5/16", 1"	1
32	R-892-10	Clevis	2
33	B-4867	Grip	1

Z-1531-A		Bearing Bag	1
34	B-4866	Bearing, Nyliner-3/4"	6

NOTE: Extra Hardware Included

At the end of assembly, you may have the following hardware remaining:

- x1 Hex Head Bolt, 5/16 x 3/4 (13)
- x1 Lock Nut, 5/16"-18 (14)
- x2 Bushing, 0.765 ID x 0.250 (26)

Installation Questions?
Missing Parts?
Replacement Parts?



DON'T GO BACK TO THE STORE!

Please call our Customer Service Department,
Toll Free: 877-728-8224 or customerservice@brinly.com