



## 40-GALLON AUXILIARY DIESEL EXHAUST FLUID (DEF) TANK USER'S MANUAL

Part No. JDI-DEF40

**FOR WARRANTY INFORMATION, PLEASE CALL 800-433-0708**

DATE OF PURCHASE: \_\_\_\_\_

**READ AND SAVE THIS MANUAL**

**FOR SERVICE ASSISTANCE, CALL 800-433-0708 OR VISIT [JOHNDOW.COM](http://JOHNDOW.COM)**



## Important Safety Information

Read this manual and safety information before using this tank.

### **WARNING**

**WARNING** indicates a hazardous situation which, if not avoided, could result in death or serious injury.

#### **Use, transportation, and storage warnings.**

- Confirm all fittings and connections are tight and leak-free.
- Do not modify this product or its components. Modifying this product in any way will void the warranty.
- Use only Diesel Exhaust Fluid (DEF) in this tank to avoid possible damage to equipment.
- Perform the entire closure procedure after filling and before transporting.
- Do not place inside a vehicle trunk or inside passenger cabin.
- Do not store in direct sunlight.
- Avoid damage to the 12V transfer pump by:
  - only using a maximum of 30 minutes of continuous use in normal conditions
  - only use a maximum of 2 minutes in bypass mode
- Secure or strap tank to a trailer or truck bed with appropriate working load ratchet-style polyester cargo tie-down straps. Do not use Nylon straps.
- Use care when maneuvering to prevent injury or loss of control.
- It is the owner's/user's responsibility to review and comply with all building and fire codes regarding proper storage of Diesel Exhaust Fluid (DEF).
- The shut-off valve **MUST** be kept closed during transportation.
- Do not overfill the tank.
- Keep in a cool, dry place with a temperature between 12°F and 86°F. DEF may freeze if stored below 12°F and may damage tank.

### **CAPACITY AND DIMENSIONS**

Product	JDI-DEF40	Width:	38"
Capacity (Gallons)	40	Length:	23"
Weight (Empty):	66 lbs.	Height:	18"

### **GETTING STARTED**

If any parts are missing or damaged, contact JohnDow Industries for replacement.

# CONTENTS

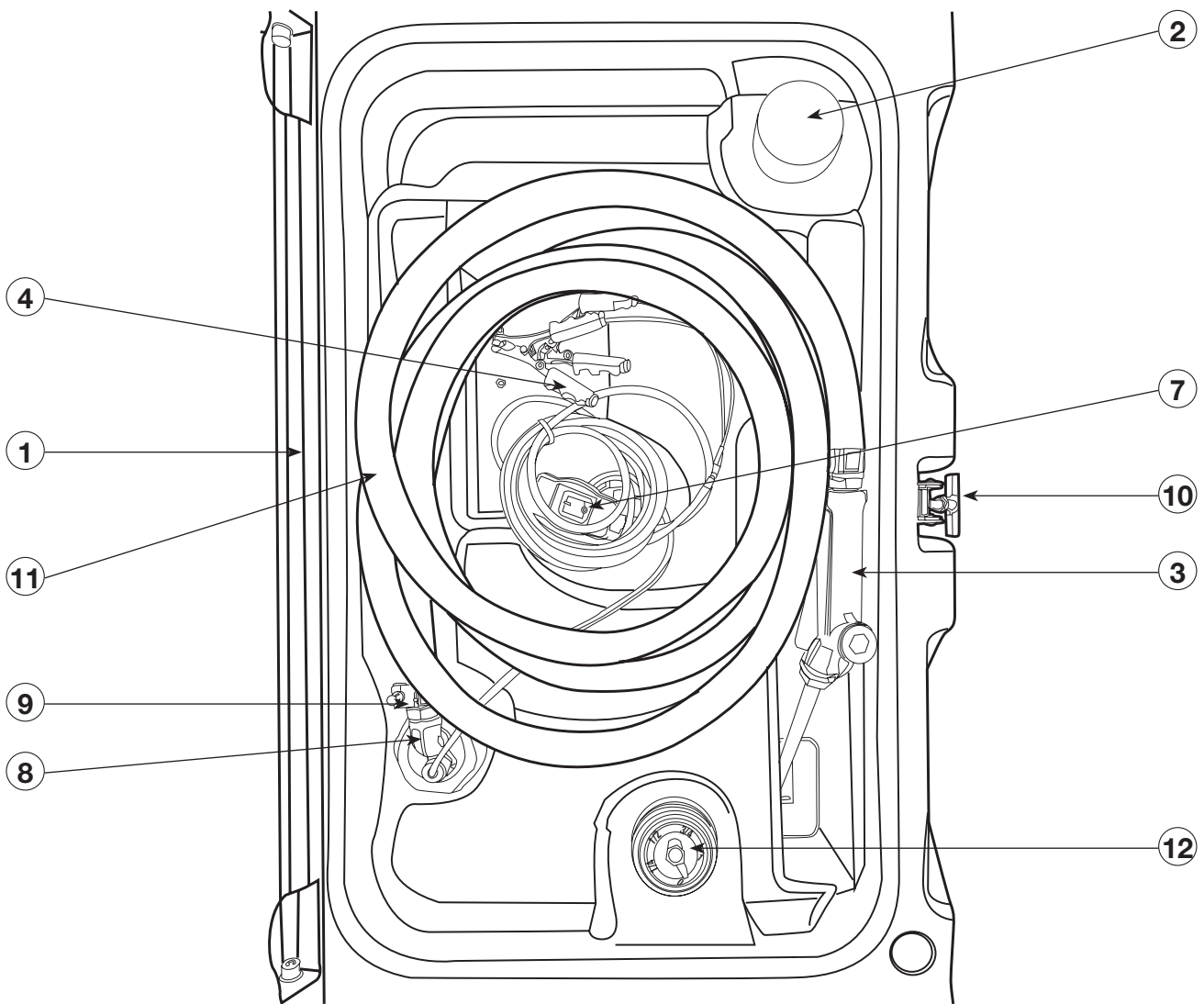

Item No.	Description
1	Locking Cover
2	Filler Cap with Vent
3	Automatic Dispensing Nozzle
4	Power Cable with Battery Terminal Clamps
5	Suction Hose Coupler with Filter
6	Ball Valve (Shut-off Valve)
7	12V Fuel Transfer Pump
8	Suction Hose, Clamp and Curved Tube
9	Swivel Joint
10	Lid Clasps
11	Delivery Hose
12	Level Gauge

## **OPERATION**

### **Filling the Tank with Diesel Exhaust Fluid (DEF)**

*Before use, read and follow all safety instructions on page 2 of this user's manual.*

1. Before filling, make sure the tank has no defects in the structure or equipment.
2. Keep in a cool, dry place with a temperature between 12°F and 86°F. DEF may freeze if stored below 12°F and may damage tank.

### **Securing and Transporting Filled Tank**

1. Properly secure the tank to a trailer or truck bed before transporting to avoid movement.
2. Use appropriate working load ratchet-style polyester cargo tie-down straps. Do not use Nylon straps.
3. DO NOT place the tank inside a trunk or passenger compartment.
4. ONLY transport in an open cargo area. Allow air to circulate around the tank to dissipate any flammable vapors.

## **FUEL TRANSFER**

### **To Transfer DEF from Tank**

*Before use, read and follow all safety instructions on page 2 of this user's manual.*

1. Make sure the switch on the transfer pump is in the OFF ("O") position [7].
2. Unroll the transfer hose and insert the nozzle into the destination tank with nozzle locked in the OPEN position [12].
3. Connect the Power Cable Battery Terminal Clamps [4] to a battery terminal.
4. Turn the ball valve to the OPEN position [6].
5. Start the transfer pump by placing the switch in the ON ("I") position.
6. Proceed with the transfer for a maximum of 30 minutes from the time the pump was turned ON. DO NOT run pump when not transferring fuel for more than two minutes.
7. Fill the tank to the desired level or wait until the automatic nozzle snaps CLOSED [9].

### **Closure Process before Transporting:**

1. Stop the transfer pump by placing the switch in the OFF ("O") position.
2. Turn the ball valve to the OFF position.
3. Relieve all residual pressure in the hose by dispensing fuel by holding the nozzle handle OPEN for a few seconds.
4. Roll-up the transfer hose and place the hose and nozzle in their proper position.
5. Disconnect the power cables from the battery terminals and store in the proper position.