

# Installation Instructions

## Ceramic Vessel Sinks

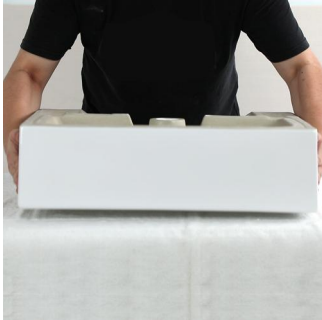

1. Lay down the towels to protect damage to vessel sink. Be careful and place the sink upside down.



2. Apply the silicone around the drain hole at the bottom of the sink.



3. Turn the sink over, install over the drain hole. Wipe off the excess silicone at the bottom of the sink.



4. Now we are ready to install the drain, apply the silicone to the underside of drainage equipment.

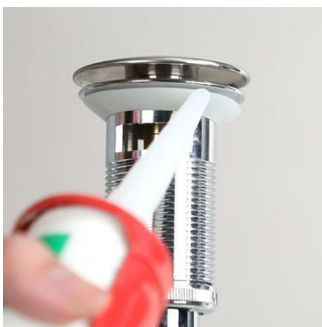

4. Pressing the drain to the drain hole, and wrap gasket and locknuts, tighten with channellock wrench.



6. Wipe off the excess silicone around the drain. Allow silicone to dry 24 hours.



# Ceramic

