



# 60" Tow-Behind Dirt Pulverizer

## OWNER'S MANUAL



### **WARNING:**

Read carefully and understand all **ASSEMBLY AND OPERATION INSTRUCTIONS** before operating. Failure to follow the safety rules and other basic safety precautions may result in serious personal injury.

**Model # FTF-60DPTB**

Thank you very much for choosing this product! For future reference, please complete the owner's record below:

Model: \_\_\_\_\_ Purchase Date: \_\_\_\_\_

Save the receipt, warranty and these instructions. It is important that you read the entire manual to become familiar with this product before you begin using it.

This product is designed for certain applications only. The manufacturer cannot be responsible for issues arising from modification. We strongly recommend this product not be modified and/or used for any application other than that for which it was designed. If you have any questions relative to a particular application, DO NOT use the product until you have first contacted us to determine if it can or should be performed on the product.

For technical questions please call **1-218-943-6296**.

## TECHNICAL SPECIFICATIONS

Item	Description
Tube Frame	6" x 6" x 60"
Teeth	21 ripper teeth (replaceable)
Material	Steel
Tire	15 x 6.00 x 6 pneumatic tires
Trailer jack Travel	8"

## GENERAL SAFETY RULES



**WARNING:** Read and understand all instructions. Failure to follow all instructions listed below may result in serious injury.



**CAUTION:** Do not allow persons to operate or assemble this 60" Tow-Behind Dirt Pulverizer until they have read this manual and have developed a thorough understanding of how the 60" Tow-Behind Dirt Pulverizer works.



**WARNING:** The warnings, cautions, and instructions discussed in this instruction manual cannot cover all possible conditions or situations that could occur. It must be understood by the operator that common sense and caution are factors which cannot be built into this product, but must be supplied by the operator.

## SAVE THESE INSTRUCTIONS

## WORK AREA

- **Keep work area clean**, free of clutter and well lit. Cluttered and dark work areas can cause accidents.
- **Keep children and bystanders** away while operating a 60" Tow-Behind Dirt Pulverizer. Distractions can cause you to lose control, so visitors should remain at a safe distance from the work area.
- **Be alert of your surroundings.** Using a 60" Tow-Behind Dirt Pulverizer in confined work areas may put you dangerously close to cutting tools and rotating parts.

## PERSONAL SAFETY

- **Stay alert**, watch what you are doing and use common sense when using a 60" Tow-Behind Dirt Pulverizer. Do not use a 60" Tow-Behind Dirt Pulverizer while you are tired or under the influence of drugs, alcohol or medication. A moment of inattention while operating may result in serious personal injury.
- **Dress properly.** Do not wear loose clothing, dangling objects, or jewelry. Keep your hair, clothing and gloves away from moving parts. Loose clothes, jewelry or long hair can be caught in moving parts.
- **Use safety apparel and equipment.** Use safety goggles or safety glasses with side shields which comply with current national standards, or when needed, a face shield. Use a dust mask if working in dusty work conditions. This applies to all persons in the work area. Also use non-skid safety shoes, hardhat, heavy-duty work gloves, dust collection systems, and hearing protection when appropriate.

## 60" Tow-Behind Dirt Pulverizer USE AND CARE

- **Do not modify the 60" Tow-Behind Dirt Pulverizer in any way.** Unauthorized modification may impair the function and/or safety and could affect the life of the equipment. There are specific applications for which the 60" Tow-Behind Dirt Pulverizer was designed.
- **Always check for damaged or worn out parts before using the 60" Tow-Behind Dirt Pulverizer.** Broken parts will affect the 60" Tow-Behind Dirt Pulverizer operation. Replace or repair damaged or worn parts immediately.
- **Use weight trays and fill with water for added weight. DO NOT exceed those limits.**
- **Distribute the load evenly.** Uneven loads may cause the 60" Tow-Behind Dirt Pulverizer to tip, resulting in personal injury to the operator or others.
- **Use the 60" Tow-Behind Dirt Pulverizer on flat and level surfaces** capable of supporting the 60" Tow-Behind Dirt Pulverizer and its maximum load. Pulling or pushing a load on a slanted or uneven surface can result in loss of control.
- **Store idle 60" Tow-Behind Dirt Pulverizer.** When 60" Tow-Behind Dirt Pulverizer is not in use, store it in a secure place out of the reach of children. Inspect it for good working condition prior to storage and before re-use.

## ASSEMBLY

1. Secure Connecting Tube (#8) to Main Frame (#1) with Bolt (#20) and Nut (#20-1).
2. Install Upright (#2) to Main Frame (#1) with Bolt (#16) and Nut (#16-1).
3. Attach Trailer Coupler (#12) to Middle Tube (#3) with Bolt (#17) and Nut (#17-1) first, and then attach Side Tube (#4) to Middle Tube (#3) with Bolt (#18) and Nut (#18-1). Finally, install the whole part to Connecting Tube (#8) with Bolt (#19) and Nut (#19-1), connect Upright (#2) and Middle Tube (#3) with Turn Buckle (#13).
4. Secure middle of Trailer Jack (#11) to Upright (#2) with Pin (#24). Connect bottom of Trailer Jack (#11) to H-Frame (#5) with Pin (#24). Also connect H-Frame (#5) with Connecting Tube (#8) by using Bolt (#21) and Nut (#21-1), install Tire (#30) on the H-Frame (#5) with Washer (#28) and R-Pin (#29).
5. Connect one end of Side Arm (#9) to Main Frame (#1) with Nut (#15), the other end to V-Drag (#6 and #7) with Bolt (#23) and Nut (#23-1). Install V-Drag (#6 and #7) by using Bolt (#22) and Nut (#22-1). Install the whole part to the middle of Trailer Jack (#11) with 2 ends of Anchors (#27) which are on the Chain (#26).
6. Install Spike Teeth (#10) to Main Frame (#1) with Bolt (#25) and Nut (#25-1).

## OPERATION



**WARNING: Sharp edges on teeth, USE CAUTION.**

## MAINTENANCE

- **Maintain your 60" Tow-Behind Dirt Pulverizer.** It is recommended that the general condition of any 60" Tow-Behind Dirt Pulverizer be examined before it is used. Keep your 60" Tow-Behind Dirt Pulverizer in good repair by adopting a program of conscientious repair and maintenance. If any abnormal vibrations or noise occurs, have the problem corrected before further use. Have necessary repairs made by qualified service personnel.

# DIAGRAM & PARTS LIST

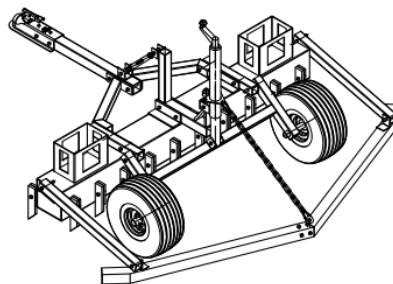
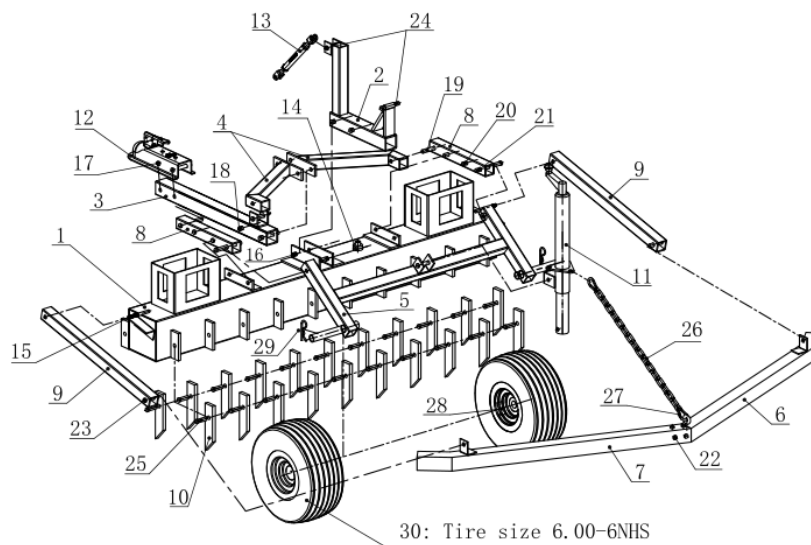

Part#	Description	Qty.	Part#	Description	Qty.	Part#	Description	Qty.
1	Main Frame	1	14	Pipe Plug	1	21-1	Nut M12	2
2	Upright	1	15	Nut M12	2	22	Bolt M10x30	4
3	Middle Tube	1	16	Bolt M10x75	2	22-1	Nut M10	4
4	Side Tube	2	16-1	Nut M10	2	23	Bolt M10x60	2
5	H-Frame	1	17	Bolt M12x75	2	23-1	Nut M10	2
6	V-Drag Right	1	17-1	Nut M12	2	24	Pin $\Phi$ 10x60	4
7	V-Drag Left	1	18	Bolt M12x85	2	25	Bolt M10x40	21
8	Connecting Tube	2	18-1	Nut M12	2	25-1	Nut M10	21
9	Side Arm	2	19	Bolt M10x100	2	26	Chain	1
10	Spike Teeth	21	19-1	Nut M10	2	27	Anchor M6x60	2
11	Trailer Jack	1	20	Bolt M10x65	4	28	Washer $\Phi$ 26	4
12	Trailer Coupler	1	20-1	Nut M10	4	29	R pin 3*65	2
13	Turn Buckle	1	21	Bolt M12x100	2	30	Tire	2

For replacement parts and technical questions, please call **1-218-943-6296**.

## **WARRANTY**

**One-year limited parts warranty**



PO BOX 203  
Miltona, MN 56354

Made in China