

Item No.		Measurement in in./cm	Color
49891	Wall set 1, post with wall holders	13.8 × 9.8 × 51.2 in. 35 × 25 × 130 cm	natural/white
49960			white/gray

Description	Measurement in in./mm	Quantity	Item No.	
			49891	49960
Upper holder for post	13.8 × 5.9 × 9.8 in. 350 × 150 × 250 mm	1	49891-10	01-49950
Lower holder for post	DIAM 5.9 × 9.6 in. ø 150 × 245 mm	1	49891-11	01-49951
Post	DIAM 3.5 × 22.8 in. ø 90 × 580	2	49891-20	01-44043
Connection disc for post	DIAM 3.5 in. ø 9 mm	1	49891-21	01-49952
Hardware set		1	49891-60	

Pos. No.	Description	Measurement in in./mm	Quantity
Pos. a	Socket screw	DIAM 0.2 × 1.5 in. ø 5 × 40 mm	7
Pos. b	Wooden dowels	DIAM 0.2 × 1.0 in. ø 5 × 25 mm	5
Pos. c	Thread rod	M0.3 × 3.1 in. M8 × 80 mm	1
Pos. d	Wood screw (for wooden wall or wooden stud)	DIAM 0.2 × 1.9 in. ø 5 × 48 mm	4
Pos. e	Screw for stone wall	DIAM 0.25 × 2.2 in. ø 6,3 × 55 mm	4
Pos. f	Stone wall anchor, plastic	DIAM 0.25 × 2.2 in. ø 6,3 × 55 mm	4
Pos. g	Metal screw (for metal stud)	DIAM 0.15 × 1.5 in. ø 4 × 37 mm	4
Pos. h	Dry wall screw	DIAM 0.15 × 1.1 in. ø 4 × 28 mm	4
Pos. i	Dry wall anchor, metal	DIAM 0.5 × 1.3 in. ø 13 × 32 mm	4
Pos. j	Washer	DIAM 0.4 in. ø 10 mm	4
Pos. k	Screw caps	DIAM 0.4 in. ø 10 mm	4
Pos. l	Allen key		1

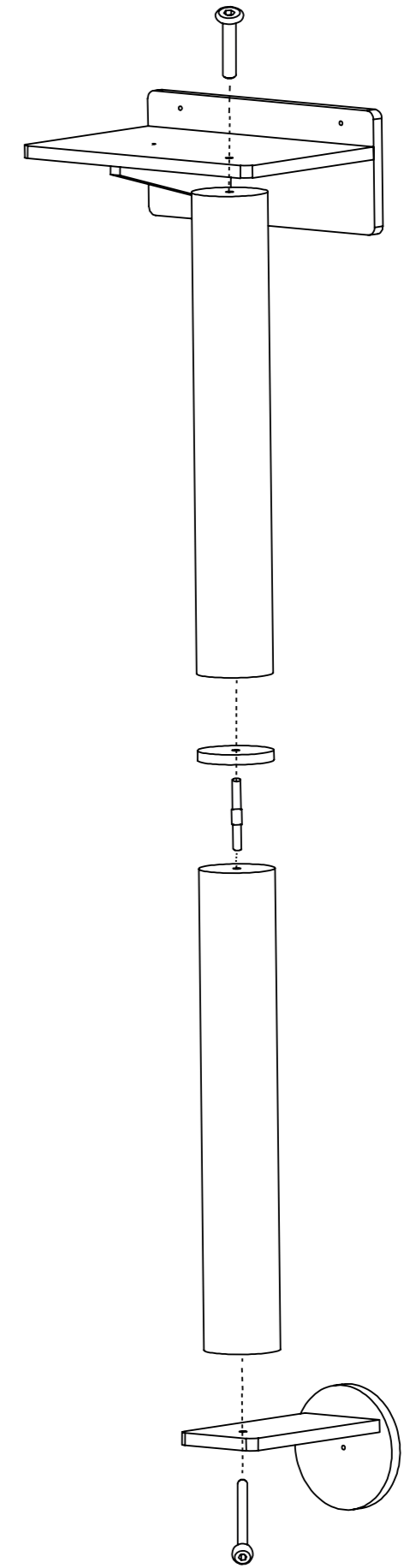

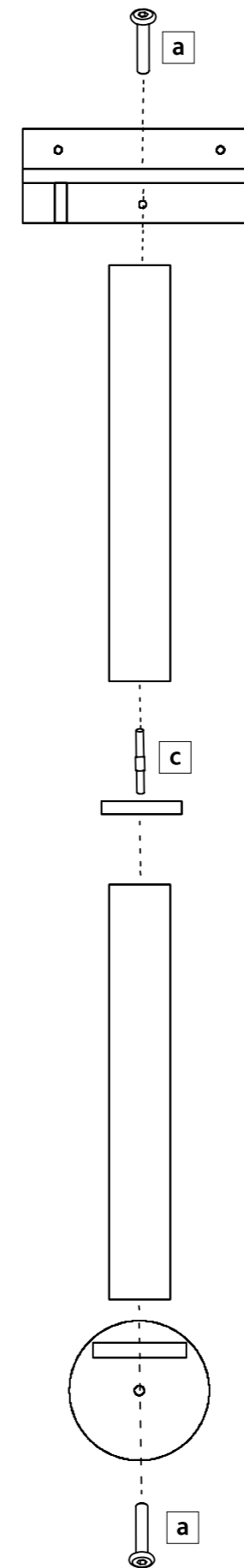
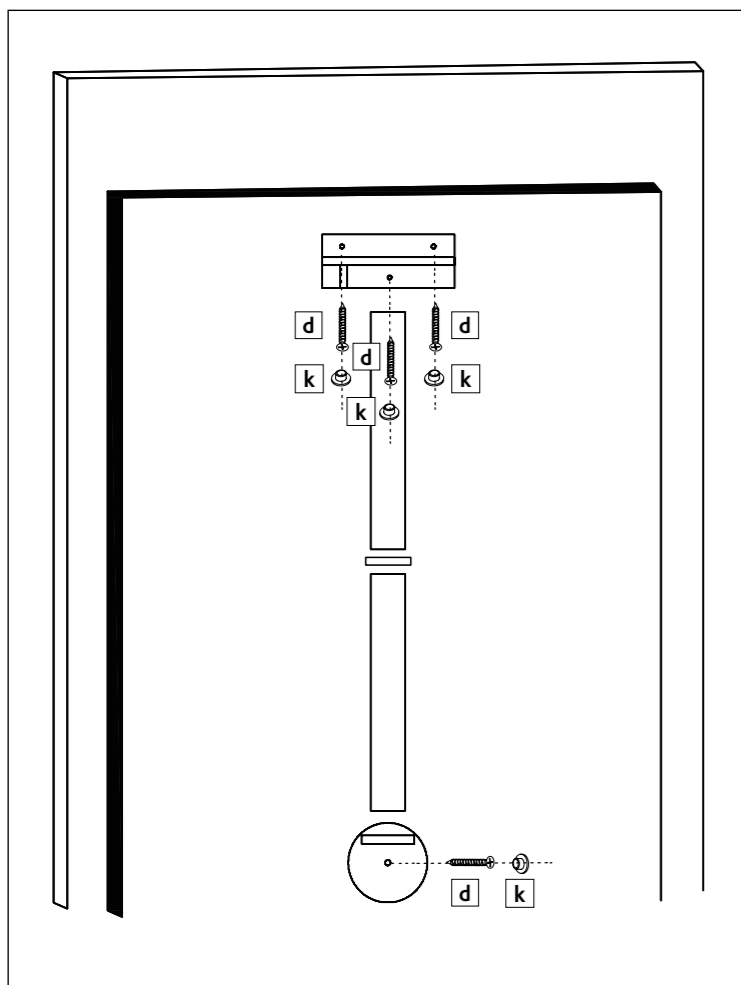

EN Work steps for wooden wall

First Step

Assemble the cat tree as shown in the manual.

Second Step

Bring the product in final position and mark the screw-points in desired location. Use a spirit level or have someone eyeball to make sure the holes are levelled.

Final Step

Mount the cat tree with attached screws to wooden wall at pilot marking and cover the screws with screw caps.

Advice:

Please note the secure assembly and mounting requires two adult persons.

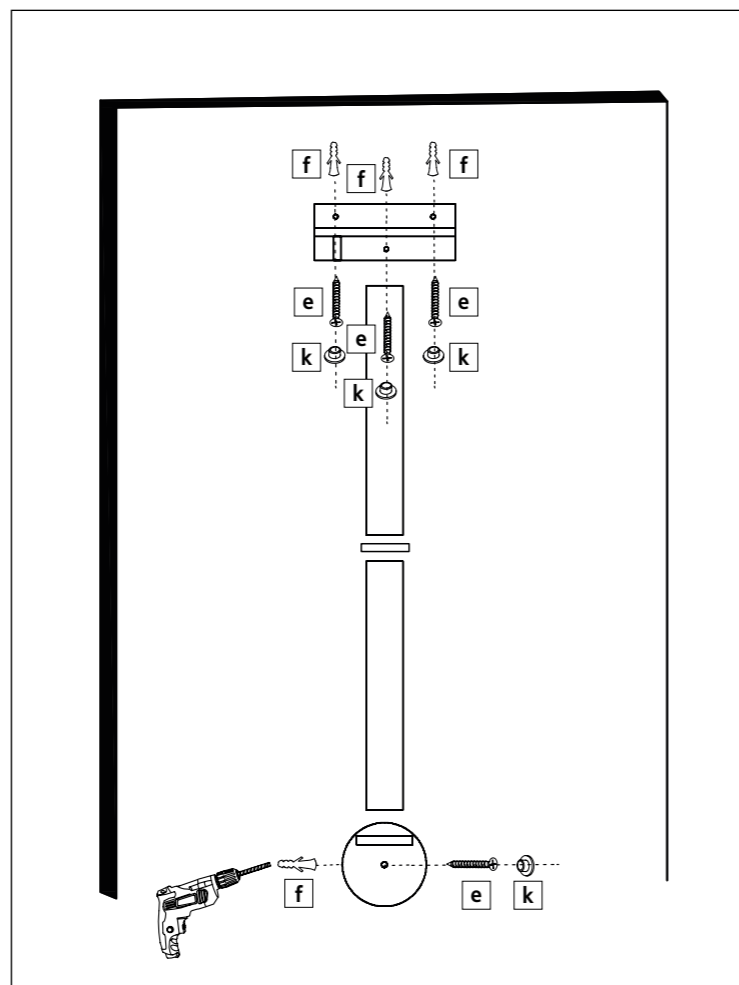

EN Work steps for stone wall or plaster wall with anchors

First Step

Assemble the cat tree as shown in the manual.

Second Step

Bring the product in final position and mark the screw-points in desired location. Use a spirit level or have someone eyeball to make sure the holes are levelled.

Third Step

Drill 1/4" holes at pilot marking, be sure to keep the drill level. Make sure hole depth matches wall anchor length. Insert 1/4" wall anchors into drilled holes (some anchors might require a hammer).

Final step

Mount the cat tree with attached screws to the anchor and cover the screws with screw caps.

Advice:

Please note the secure assembly and mounting requires two adult persons.

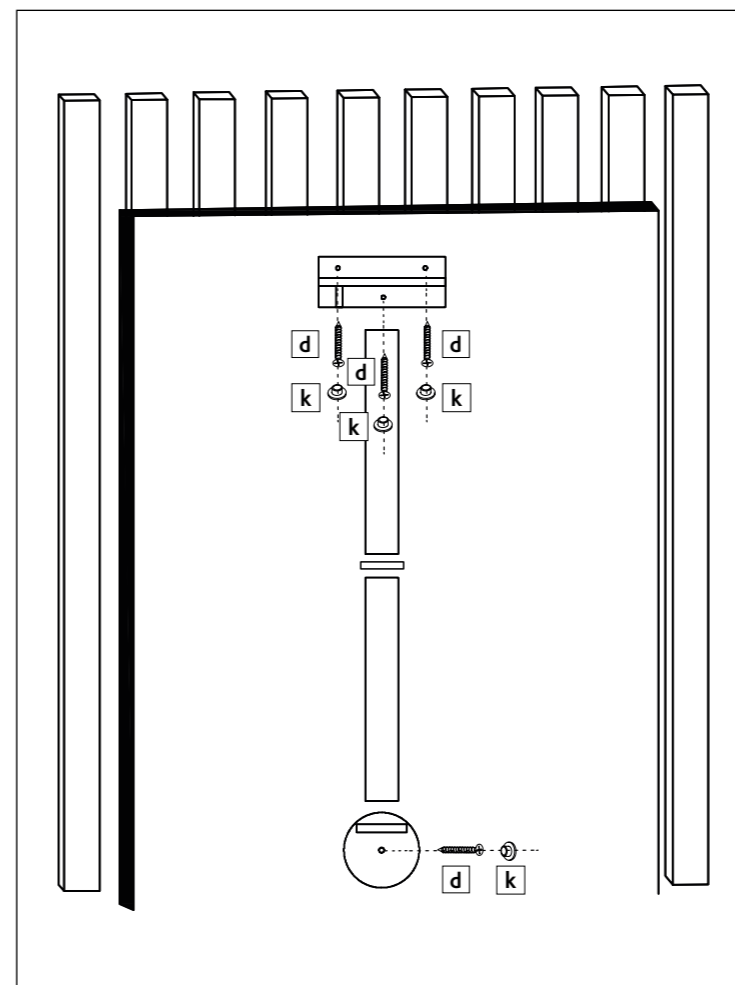

EN Work steps for drywall with wooden drywall stud or metal stud

First Step

Assemble the cat tree as shown in the manual.

Second Step

Use a stud-finder or other technique to locate the studs. Please use a pencil. Bring the product in final position and mark the screw-point on the center of the stud. Use a spirit level or have someone eyeball to make sure the holes are levelled.

Final step

Before you start, make sure to check whether you have wooden or metal studs to select the correct screws.

For wooden stud: Mount the cat tree with attached screws to wooden studs at pilot markings.

For metal stud: Mount the cat tree with attached washers and screws to metal studs at pilot markings.

Cover the screws with screw caps.

If the final position of any holder is not located at a stud, please use the attached drywall screws and drywall anchors for mounting. Please find the instructions for mounting under "Work steps for drywall - Drywall connection with drywall anchor"

Advice:

Please note the secure assembly and mounting requires two adult persons.

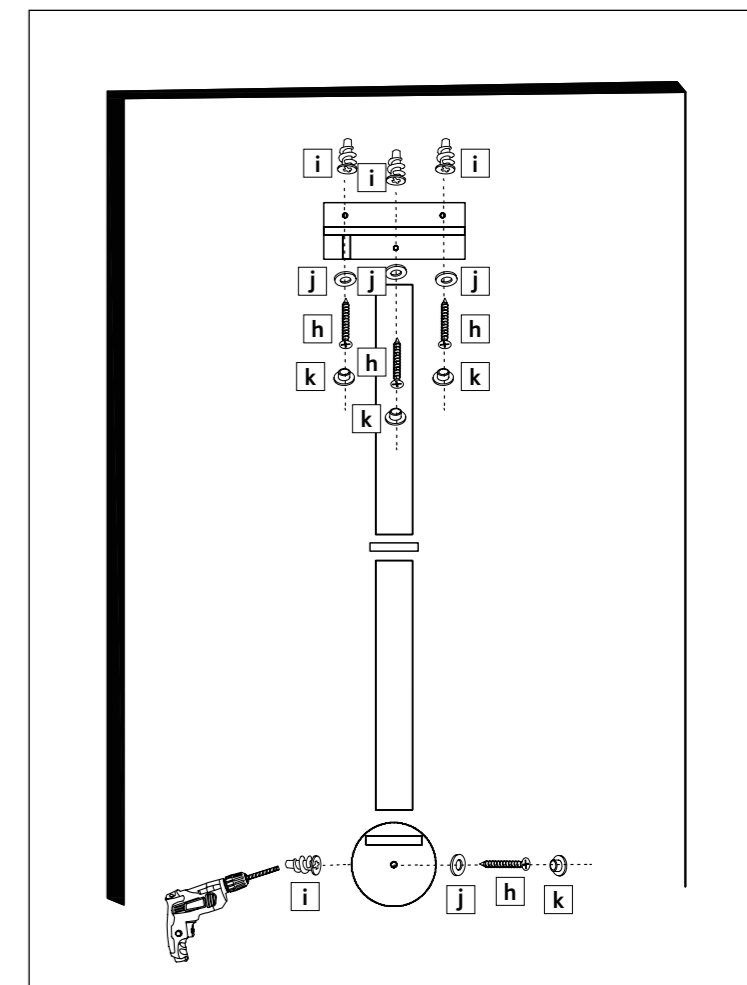

EN Work steps for drywall - Drywall connection with drywall anchor

First Step

Assemble the cat tree as shown in the manual.

Second Step

Bring the product in final position and mark the screw-points in desired location. Use a spirit level or have someone eyeball to make sure the holes are levelled.

Third Step

If you use self-drilling wall anchors a pilot hole is not needed. Use your drill and the 3/16" bit to make pilot holes for maximum 1 inch to markings. Insert wall anchors for dry walls. Be careful not to break the drywall panel.

Final step

Mount the cat tree with attached screws to the anchor and cover the screws with the screw caps.

Advice:

Please note the secure assembly and mounting requires two adult persons.