

**pore**  
enrichment

5 YEAR  
WARRANTY

*mistaire travel*  
PORTABLE ULTRASONIC  
HUMIDIFIER



USER MANUAL  
MODEL: PEHUMINI-2

## WARNINGS & PRECAUTIONS

Read this entire instruction manual before operation. Failure to adhere to the following warnings can cause harm to you or the device.

- Supervise children at all times when the unit is in operation to ensure they do not play with the appliance.
- DO NOT pour water into any opening of the unit unless using the water bottle and base cap as instructed on Page 4. This prevents overflow and damage to the unit.
- DO NOT fill with warm water as this may cause leaking.
- DO NOT place humidifier near heat sources such as stoves, radiators, and heaters.
- Always place humidifier on a firm, flat, level surface at least 2 feet away from the floor and 4 inches away from the wall.
- DO NOT position the mist outlet to directly face a wall for best results.
- NEVER tilt, move, or attempt to empty unit while it is operating.
- Shut off and unplug before removing the water tank and moving the unit.
- DO NOT attempt to refill the humidifier without first unplugging the unit from its electrical outlet.
- DO NOT operate the humidifier a) with a damaged cord or plug, b) after the appliance malfunctions, or c) if it has been dropped or damaged in any manner.
- DO NOT attempt to repair or adjust any electrical or mechanical functions on this unit. Doing so will void your warranty. The inside of the unit contains no user serviceable parts. All servicing should be performed by qualified personnel only.
- DO NOT plug in the cord with wet hands as electric shock could result.
- NEVER use detergents, gasoline, glass cleaner, furniture polish, paint thinner, or other household solvents to clean any part of the humidifier.
- Excessive humidity in a room can cause water condensation on windows and some furniture. If this happens, turn the humidifier OFF.

## INTRODUCTION

Thank you for purchasing MistAir® Travel. This mini humidifier uses a standard-sized individual water bottle to effectively moisturize dry air wherever you go. The diagram below explains all the pieces you will find inside the box. Setup is quick and easy, but be sure to follow all instructions to ensure safe and effective use.

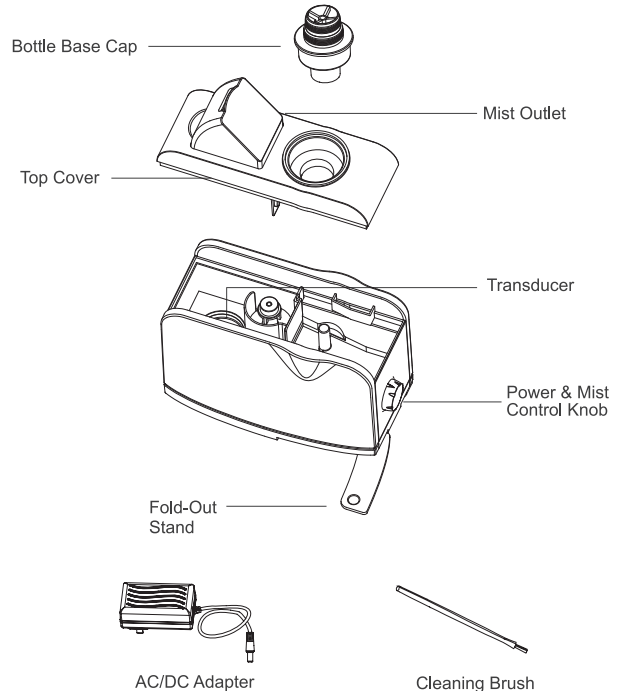

## PRODUCT SPECIFICATIONS

Size:	5.6" x (L) x 3" (W) x 3.5" (H)
Power Supply:	AC: 100V-240V, 50/60Hz, DC: 24V
Max Room Coverage:	220 sq. ft.
Max Run Time:	5hrs (High); 10hrs (Low) - Based on 0.5L bottle
Recommended Bottle Tank Volume:	16.9 oz. (.5 Liters) – Not Included
Avg. Moisture Output:	Up to 1.7 oz (High); 3.4 oz (Low)

\*Run time may vary depending on water quality, room temperature and bottle size.

## PRE-OPERATING INSTRUCTIONS

1. Be sure the humidifier is OFF and disconnected from the electrical outlet.
2. Place the humidifier on a flat surface approximately 2 feet from the floor and 4 inches away from the wall. Avoid placing the unit directly on furniture that could be damaged by water.
3. Use the optional Fold-Out Stand for additional stability or to support larger water bottles.
4. Filling the bottle tank instructions:
  - Fill a 16.9-oz water bottle with cool, fresh water. It is best to use filtered water for maximum unit performance. **DO NOT FILL WITH WARM WATER AS THIS MAY CAUSE LEAKING.**
  - After filling the water bottle, insert the Bottle Base so it fits securely inside the bottle. Place the water bottle on the base. The water bottle will immediately begin to empty into the base.
5. Plug the AC/DC Adapter into an electrical outlet.

## NOTE

The length of cord used on this appliance was selected to reduce the hazard of tripping over a longer cord. If a longer cord is necessary, use an extension cord with a rating equal to or greater than the rating of the humidifier. Take care to arrange the extension cord so that it does not drape over the countertop or tabletop where it can be pulled on by children or accidentally tripped over.

## OPERATING INSTRUCTIONS

Use the Power & Mist Control Knob to turn the unit ON/OFF and to adjust the mist output from low to high. Turn the knob to the right to increase mist output. Turn the knob to the left to decrease mist output.

## NOTE

When MistAire Travel is turned on the power light is designed to serve as a soft glow night light for safe and easy operation in the dark.



## CLEANING & MAINTENANCE

To get the most out of the humidifier and prevent product failure, follow all cleaning and maintenance instructions carefully. Without proper care, microbacteria may begin to grow inside the water bottle and unit.

- Before cleaning, turn the power OFF and unplug the unit from the electrical outlet.
- Lift the water bottle from the humidifier.
- Empty the water bottle in the sink, then thoroughly rinse and drain to remove any sediment and dirt.
- Lift and remove the top cover to wipe away any water or residue inside the unit using a soft cloth. Use the cleaning brush to gently clean the transducer.
- Refill the water bottle as instructed on Page 4.

## MAINTENANCE CAUTIONS

- Never submerge the unit in water.
- Do not use solvents or aggressive cleaning agents to clean the humidifier.
- Use a soft cloth to clean inside the basin.
- Only use the provided cleaning brush to clean the transducer. This should be done once a week.
- Change the water in the bottle tank at least once a week.

## STORING THE HUMIDIFIER

- Before storing, clean the humidifier as described on Page 5 and let the unit air dry.
- Push down the Mist Outlet whenever the unit is not being used to prevent dust and debris from getting inside.
- Store the humidifier in its original box if possible.
- Store in a cool, dry place.

## WARRANTY

The MistAire Travel comes with an industry-leading 5 Year Warranty that begins on the date of purchase.

The warranty applies to the humidifier and necessary parts and labor relating thereto. The warranty does not apply to damage resulting from failure to follow the operating instructions, accidents, abuse, alterations or disassembly by unauthorized individuals.

## PRODUCT REGISTRATION

To ensure your full warranty and to receive product updates and streamlined customer support, remember to register your product at:

[pureenrichment.com/productregistration](http://pureenrichment.com/productregistration)

## TROUBLESHOOTING

Problem	Probable Cause	Solution
<b>Humidifier does not operate</b>	Power cable not plugged in	Plug in power cable
<b>Power light is on, but there is no mist</b>	No water in water bottle tank	Fill bottle tank with water*
<b>Water mist produces an unpleasant smell</b>	Dirty water or the water is left in the water bottle tank for too long	Clean the water bottle tank and change the water
<b>Power light is on, but the humidifier doesn't work</b>	Too much water in the water flume ( <i>the area around the transducer where water can accumulate</i> )	Pour away some water from the water flume ( <i>the area around the transducer where water can accumulate</i> )
<b>Output volume of the mist is low</b>	The transducer is dirty	Clean transducer with cleaning brush
	Water is too dirty or water kept too long in the tank	Clean water bottle tank and change the water
<b>Abnormal noise</b>	Water level is too low	Fill bottle tank with water*
	Unit is on an unstable surface	Move the unit to a stable flat surface

## \*CAUTION

DO NOT pour water into any opening of the unit unless using the water bottle and base cap as instructed on Page 5. This prevents overflow and damage to the unit.

## **FCC NOTICE**

### **PEHUMINI-2: MistAire Travel Portable Ultrasonic Humidifier**

**This device complies with part 18 of the FCC Rules.**

Pure Enrichment  
2803 S Yale St  
Santa Ana, CA 92704  
pureenrichment.com

This equipment generates, uses and can radiate radio frequency energy and, if not installed and used in accordance with the instructions, may cause harmful interference to radio communications. The equipment should be maintained as discussed in this manual. Changes or modifications not expressly approved by Pure Enrichment will void the user's authority to operate the equipment. If this equipment does cause harmful interference to radio or television reception, which can be determined by turning the equipment off and on, the user is encouraged to try to correct the interference by one or more of the following measures:

- Reorient or relocate the receiving antenna.
- Increase the separation between the equipment and receiver.
- Connect the equipment into an outlet on a circuit different from that to which the receiver is connected.
- Consult the dealer or an experienced radio/TV technician for help.



Santa Ana, CA 92704  
pureenrichment.com

REV: 02.10.22