

BLACK+[®] DECKER

PORTABLE AIR CONDITIONER INSTRUCTION MANUAL

CATALOG NUMBER

BPT08WTB

BPT08HWTB

BPT10WTB

BPT10HWTB

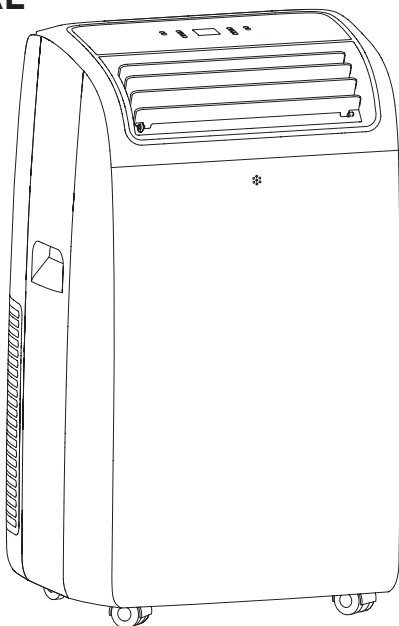

Thank you for choosing BLACK+DECKER!

PLEASE READ BEFORE RETURNING THIS PRODUCT FOR ANY REASON.

If you have a question or experience a problem with your BLACK+DECKER purchase, go to [www.blackanddecker.com/instant answers](http://www.blackanddecker.com/instantanswers)

If you can't find the answer or do not have access to the Internet, call 844-299-0879 from 10:30 a.m. to 6:30 p.m. EST Mon. - Fri. to speak with an agent. Please have the catalog number available when you call.

SAVE THIS MANUAL FOR FUTURE REFERENCE.

CONTENTS

SAFETY INFORMATION

Important Safety Instructions.....	3-4
Grounding Instructions.....	5
LCDI Power Cord and Plug.....	6
Safety Guidelines.....	7-10

SET UP & USE

Parts & Features.....	12
Installation Guide.....	13
Window Slider Kit Installation.....	14
Exhaust Hose Installation.....	15
Control Panel.....	16-17
Operating from the Remote Control.....	18
Remote Control.....	19-26
Water Drainage.....	27-28

CLEANING & CARE.....	29
---------------------------------	-----------

TROUBLESHOOTING & WARRANTY

Before You Call for Service.....	30
Customer Service.....	30
Troubleshooting.....	31
Limited Warranty.....	32

PRODUCT REGISTRATION

Thank you for purchasing our BLACK+DECKER product. This easy-to-use manual will guide you in getting the best use of your product.

Remember to record the model and serial numbers. They are on a label on the back of the product.

Model number

Serial number

Date of purchase

Staple your receipt to your manual. You will need it to obtain warranty service.

SAFETY INFORMATION

DANGER

DANGER - Immediate hazards which **WILL** result in severe personal injury or death

WARNING

WARNING - Hazards or unsafe practices which **COULD** result in severe personal injury or death

CAUTION

CAUTION - Hazards or unsafe practices which **COULD** result in minor personal injury

IMPORTANT SAFETY INSTRUCTIONS

WARNING

When using electrical appliances, basic safety precautions should be followed, including the following:

1. To reduce risk of injury, read this guide before using the appliance.
2. The air conditioner must be connected to the correct electrical outlet and electrical supply.
3. Proper grounding must be ensured to reduce the risk of shock and fire. **DO NOT CUT OR REMOVE THE GROUNDING PRONG.** If you do not have a three-prong electric receptacle outlet in the wall, have a certified electrician install the proper receptacle. The wall receptacle **MUST** be properly grounded.
4. Do not operate air conditioner if power cord is frayed or otherwise damaged. Avoid using it if there are any cracks or abrasion damage along the length, plug connector or if the unit malfunctions or is damaged in any manner. Contact an authorized service technician for examination, repairs or adjustments.
5. **DO NOT USE AN ADAPTER OR AN EXTENSION CORD.**
6. Do not block airflow around the air conditioner. The exhaust hose should be free of any obstructions.
7. Always unplug the air conditioner before servicing it or moving it.
8. Do not install or use the air conditioner in any area where the atmosphere contains combustible gases or where the atmosphere is oily or sulphurous. Avoid any chemical coming in contact with your air conditioner.
9. Do not place any object on the top of the unit.
10. Never operate the air conditioner without filters in place.
11. Do not use the air conditioner near a bathtub, shower or wash basin.
12. This appliance is not intended for use by persons (including children) with reduced physical sensory or mental capabilities or lack of experience & knowledge, unless they have been given supervision or instruction concerning use of the appliance by a person responsible for their safety.
13. Children should be supervised to ensure that they do not play with the appliance.
14. If the **SUPPLY CORD** is damaged, it must be replaced by the manufacturer, a service agent or similarly qualified persons in order to avoid a hazard.
15. The air conditioner shall be installed in accordance with national wiring regulations.



Caution, risk of fire



SAFETY INFORMATION

HANDLING ALKALINE BATTERIES

WARNING

When handling alkaline batteries, basic safety precautions should be followed, including the following:

1. Should fluid from the battery accidentally get into your eyes, there is a threat of loss of eyesight, do not rub them. Immediately rinse your eyes with clean tap water and then consult a physician immediately.
2. Do not put the battery in a fire, expose it to heat, dismantle or modify it. If the insulation or safety valve is damaged, the battery may leak fluid, overheat or explode.
3. Do not insert the battery with the polarities reversed. Doing so may cause some abnormality or a short and the battery may leak fluid, overheat or explode.
4. Keep the battery out of the reach of children. If the battery is swallowed, contact a physician immediately.
5. If the alkali fluid gets in your mouth, rinse your mouth with water and contact a physician immediately.
6. If the alkali fluid gets on your skin or clothes, it may burn your skin, thoroughly rinse the affected area with tap water.
7. Do not mix new and old batteries or other makes of batteries. The different attributes may cause the battery to leak fluid, overheat or explode.
8. This battery was not made to be recharged. Recharging this battery may damage the insulation or internal structure and may cause the battery to leak fluid, overheat or explode.
9. Do not damage or remove the label on the exterior of the battery. Doing so may cause the battery to short, leak fluid, overheat or explode.
10. Do not drop, throw or expose the battery to extreme impact. Doing so may cause the battery to leak fluid, overheat or explode.
11. Do not alter the shape of the battery. If the insulation or safety valve is damaged, the battery may leak fluid, overheat or explode.
12. Immediately remove batteries when they have lost all power. Leaving the batteries in the unit for a long time may cause the batteries to leak fluid, overheat or explode due to gas that is generated by the batteries.
13. Remove the batteries from the unit when not using the unit for an extended period of time. The batteries may leak fluid, overheat or explode due to gas that is generated by the batteries.
14. Do not apply solder directly to the batteries. The heat may cause the batteries to leak fluid, overheat or explode.
15. Do not get the batteries wet. Doing so may cause the batteries to overheat.
16. Store batteries someplace out of direct sunlight where the temperature and humidity are not high. Not doing so may cause the batteries to leak fluid, overheat or explode. Also, it may cause the life and performance of the batteries to decline.
17. Follow the regulations of the local government when disposing of these batteries.
18. NEVER mix alkaline, standard (carbon-zinc), rechargeable (nickel-cadmium) batteries with this product.

SAVE THESE INSTRUCTIONS
HOUSEHOLD USE ONLY

SAFETY INFORMATION

GROUNDING INSTRUCTIONS

ELECTRICAL REQUIREMENTS

In the event of malfunction or breakdown, grounding provides a path of least resistance for electric current to reduce the risk of electric shock. The appliance must be connected to a cord having an equipment-grounding conductor and a grounding plug. The plug must be plugged into an appropriate outlet that is properly installed and grounded in accordance with all local codes and ordinances.

⚠ DANGER - Improper connection of the equipment grounding conductor can result in a risk of electric shock. The conductor with insulation having an outer surface that is green with or without yellow stripes is the equipment grounding conductor. If repair or replacement of the cord or plug is necessary, do not connect the equipment-grounding conductor to a live terminal. Check with a qualified electrician or service person if the grounding instructions are not completely understood, or if in doubt as to whether the appliance is properly grounded. Do not modify the plug connected to the appliance - if it will not fit the outlet, have a proper outlet installed by a qualified electrician.

FOR GROUNDED, CORD-CONNECTED APPLIANCE RATED LESS THAN 15A AND INTENDED FOR USE ON A NOMINAL 120V SUPPLY CIRCUIT

The appliance is for use on a nominal 120V circuit and should be connected to a grounding outlet that looks like the one illustrated below. The use of a temporary adapter is not recommended.

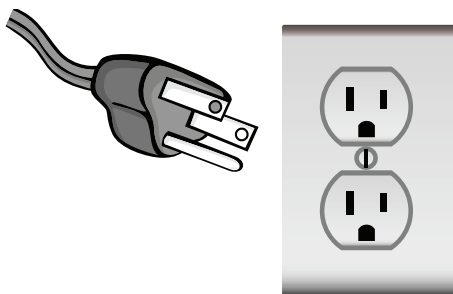

SAFETY INFORMATION

LCDI POWER CORD AND PLUG

This air conditioner is equipped with an LCDI (Leakage Current Detection and Interruption) power cord that is required by UL. This power supply cord contains state-of-the-art electronics that sense leakage current. If the cord is damaged and leakage occurs, power will be disconnected from the unit.

The test and reset buttons on the LCDI Plug are used to check if the plug is functioning properly.

⚠ WARNING: Test LCDI before each use.

To test the plug:

1. Plug power cord into a grounded 3-prong outlet.
2. Press RESET (on some units a green light will turn on).
3. Press the TEST button, the circuit should trip and cut all power to the air conditioner (on some units green light may turn off).
4. Press the RESET button for use. You will hear a click and the A/C is ready for use.
5. The power supply cord must be replaced if it fails to trip when the TEST button is pressed and the unit fails to reset.

NOTE:

- Do not use this device to turn the unit on or off.
- Always make sure the reset button is pushed in for correct operation.

⚠ WARNING:

- The power supply cord must be replaced if it fails to reset when either the test button is pushed, or it cannot be reset.
- If power supply cord is damaged, it can not be repaired.
- It must be replaced by one obtained from the product manufacturer.

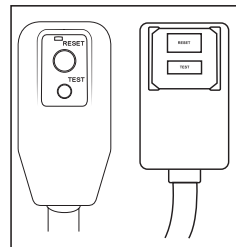

⚠ WARNING - RISK OF FIRE

- It is important the plug fits tightly into the wall outlet.
- If the plug does not fit securely and appears loose, it should not be used.
- Have a licensed electrician replace the receptacle.

SAFETY INFORMATION

SAFETY GUIDELINES

⚠ WARNING: To prevent injury to the user or other people and property damage, the following instructions must be followed. Incorrect operation due to ignoring of instructions may cause harm or damage.

ALWAYS DO THIS	NEVER DO THIS	ENERGY SAVE
<ul style="list-style-type: none"> • Your air conditioner should be used in such away that it is protected from moisture. e.g. condensation, splashed water, etc. Do not place or store your air conditioner where it can fall or be pulled into water or any other liquid. Unplug immediately. • Always transport your air conditioner in a vertical position and stand on a stable, level surface during use. • Turn on the product when not in use. • Always use the switch on the control panel to start or shut off the unit. • Always contact a qualified person to carry out repairs. If the supply cord is damaged it must be repaired by a qualified technician. • Keep an air path of at least 12 inches all around the unit from walls, furniture and curtains. • If the air conditioner is knocked over during use, turn off the unit and unplug from the power supply immediately. 	<ul style="list-style-type: none"> • Do not operate your air conditioner in a wet room such as a bathroom or laundry room. • Do not touch the unit with wet or damp hands or when barefoot. Do not press the buttons on the control panel with anything other than your fingers. • Do not remove any fixed covers. Never use this appliance if it is not working properly, or if it has been dropped or damaged. • Never use the plug to start and stop the unit. • Do not cover or obstruct the inlet or outlet grilles. • Do not use hazardous chemicals to clean or come into contact with the unit. Do not use the unit in the presence of flammable substances or vapor such as alcohol, insecticides, gasoline etc. • Do not allow children to operate the unit unsupervised. • Do not use this product for functions other than those described in this instruction manual. 	<ul style="list-style-type: none"> • Locate the unit where furniture cannot obstruct the air flow. • Keep blinds / curtains drawn. • Keep the filters clean. • Keep doors and windows closed to keep cool air in and warm air out.

SAFETY INFORMATION

IMPORTANT SAFEGUARD



WARNING:

- This hermetically sealed system contains fluorinated greenhouse gases.
ENVIRONMENTAL INFORMATION: This unit contains fluoridated greenhouse gases covered by the Kyoto Protocol.
- Do not use this unit for functions other than those described in this instruction manual.
- Make sure the plug is plugged firmly and completely into the outlet. It can result in the risk of electric shock or fire.
- Do not plug other appliances into the same outlet, it can result in the risk of electric shock.
- Do not disassemble or modify the appliance or the power cord, it can result in the risk of electric shock or fire. All other services should be referred to a qualified technician.
- Do not place the power cord or appliance near a heater, radiator, or other heat source. It can result in the risk of electric shock or fire.
- This unit is equipped with a cord that has an earthed wire connected to an earthed pin or grounding tab. The plug must be plugged into a socket that is properly installed and earthed. Do not under any circumstances cut or remove the earthed pin or grounding tab from this plug.
- The unit should be used or store in such a way that it is protected from moisture e.g. condensation, splashed water, etc. Unplug unit immediately if this occurs.
- Always transport your appliance in a vertical position and place on a stable, level surface during use. If the unit is transported laying on its side it should be stood up and left unplugged for 6 hours.
- Always use the switch on the control panel or remote controller to turn the unit off, and do not start or stop operation by plugging in or unplugging the power cord. It can result in the risk of electric shock.
- Do not touch the buttons on the control panel with your wet and damp fingers.
- Do not use hazardous chemicals to clean or come into contact with the unit. To prevent damage to the surface finish, use only a soft cloth to clean the appliance. Do not use wax, thinner, or a strong detergent. Do not use the unit in the presence of inflammable substance or vapor such as alcohol, insecticides, gasoline, etc.
- If the appliance is making unusual sounds or is emitting smoke or an unusual odor, unplug it immediately.
- Do not clean the unit with water. Water can enter the unit and damage the insulation, creating a shock hazard. If water enters the unit, unplug it immediately and contact Customer Service.
- Utilize two or more people to lift and install the unit.
- Always grasp the plug when plugging in or unplugging the appliance. Never unplug by pulling on the cord. It can result in the risk of electrical shock and damage.
- Install the appliance on a sturdy, level floor capable of supporting up to 110 lbs (50kg). Installation on a weak or unlevel floor can result in the risk of property damage and personal injury.

ELECTRICAL CONNECTIONS

Before plugging the appliance into the mains socket, check that:

- The mains power supply corresponds to the value indicated on the rating plate on the back of the appliance.
- The power socket and electrical circuit are adequate for the appliance.
- The mains socket matches the plug. If this is not the case, have the plug replaced.
- The mains socket is adequately earthed. Failure to follow these important safety instructions absolves the manufacturer of all liability.

SAFETY INFORMATION

WARNING:

- This appliance is not intended for use by persons (including children) with reduced physical, sensory or mental capabilities, or lack of experience and knowledge, unless they have been given supervision or instruction concerning use of the appliance by a person responsible for their safety.
- Children should be supervised to ensure that they do not play with the appliance.
- If the SUPPLY CORD is damaged, it must be replaced by the manufacturer, its service agent or similarly qualified persons in order to avoid a hazard.
- The appliance shall be installed in accordance with national wiring regulations.
- Do not use means to accelerate the defrosting process or to clean, other than those recommended by the manufacturer.
- The appliance shall be stored in a room without continuously operating ignition sources (for example open flames, an operating gas appliance or an operating electric heater).
- Do not pierce or burn.
- Be aware that refrigerants may not contain an odor.

WARNING:

- The handling, installation, storage, servicing and disposal must comply with the provisions of gas-related national laws and regulations, and also national wiring regulation.
- It is necessary to clear away the refrigerant in the system when maintaining or scrapping an appliance.
- Ventilated area (open doors and Windows)
Ensure that the working area is open or well ventilated before turning on the system or performing hot work. Ventilation should be maintained during operation. Ventilation quickly displaces safely diluted leaked refrigerant into the atmosphere.
- Flammable refrigerant R32/R290 is used within appliance. Please follow the instructions carefully to handle, install, clean, and service the appliance to avoid damage or hazard. Do not dispose of appliance in regular trash. Contact qualified agency for proper disposal.
- Servicing shall be performed only as recommended by the manufacturer.



SAFETY INFORMATION

FCC Caution

This device complies with part 15 of the FCC Rules. Operation is subject to the following two conditions:

(1) This device may not cause harmful interference, and (2) this device must accept any interference received, including interference that may cause undesired operation. Any changes or modifications not expressly approved by the party responsible for compliance could void the user's authority to operate the equipment.

NOTE: This equipment has been tested and found to comply with the limits for a Class B digital device, pursuant to part 15 of the FCC Rules. These limits are designed to provide reasonable protection against harmful interference in a residential installation. This equipment generates uses and can radiate radio frequency energy and, if not installed and used in accordance with the instructions, may cause harmful interference to radio communications. However, there is no guarantee that interference will not occur in a particular installation. This equipment does cause harmful interference to radio or television reception, which can be determined by turning the equipment off and on, the user is encouraged to try to correct the interference by one or more of the following measures:

- Reorient or relocate the receiving antenna.
- Increase the separation between the equipment and receiver.
- Connect the equipment into an outlet on a circuit different from that which the receiver is connected.
- Consult the dealer or an experienced radio/TV technician for help. The distance between user and device should be no less than 20cm.

IC Warning

This device complies with industry Canada's licence-exempt RSSs. Operation is subject to the following two conditions:

1. This device may not cause interference; and
2. This device must accept any interference, including interference that may cause undesired operation of the device.

This equipment complies with FCC radiation exposure limits set forth for an uncontrolled environment. This equipment should be installed and operated with minimum distance 20cm between the radiator & your body.

SAFETY INFORMATION

OPERATION CONDITION

The air conditioner must be operated within the temperature range indicated below:

NOTE: Unit performance may be affected when in use outside of these operating temperatures.

MODE	ROOM TEMPERATURE
COOL	64°F (18 °C)-95°F (35 °C)
DEHUMIDIFYING	64°F (18 °C)-95°F (35 °C)
HEAT (ELECTRICAL HEAT TYPE)	45°F (7°C)-81°F (27°C)

The air conditioner should be operated in the relative humidity range of 30%-90% RH.

Never Transport or turn the appliance upside down or on its side. If this occurs wait at least 6 hours before turning the appliance on 24 hours is recommended. After the unit has been on its side, oil needs to return to the compressor to ensure proper function. Without allowing 6-24 hours before turning on, the unit may function for only a short time, and then the compressor will break down from lack of oil.

SET UP & USE

PARTS & FEATURES

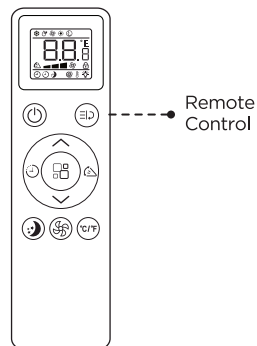
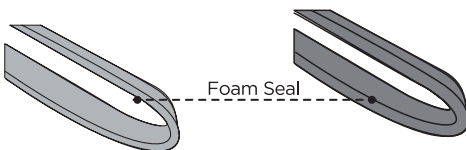
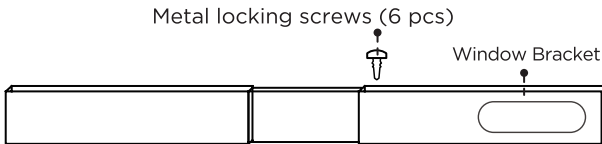
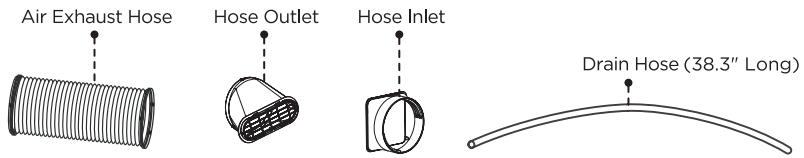
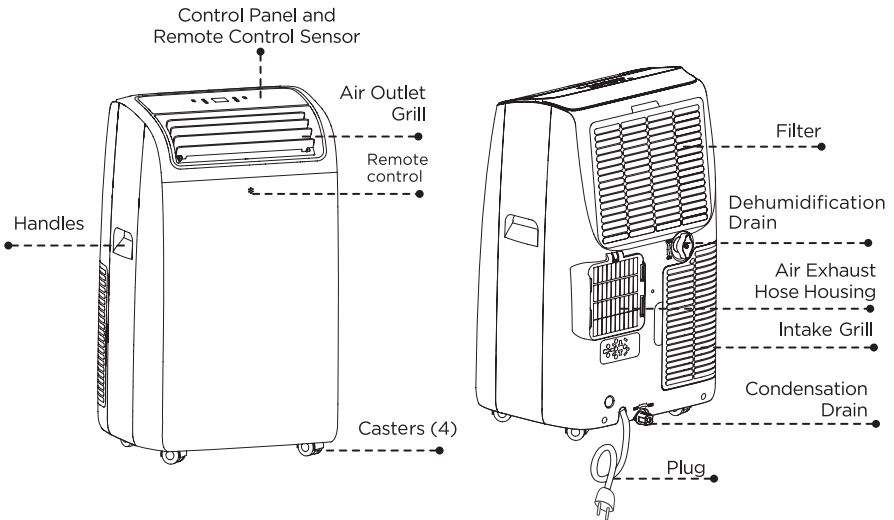

INSTALLATION GUIDE

LOCATION

- The air conditioner should be placed on a firm floor to minimize noise and vibration. For safe and secure positioning, place the unit on a smooth, level floor strong enough to support the unit.
- The unit has casters to aid placement, but it should be rolled on smooth, flat surfaces. Use caution when rolling on carpet surfaces. Do not attempt to roll the unit over objects.
- The unit must be placed within reach of a properly rated grounded socket.
- Never place any obstacles around the air inlet or outlet of the unit.
- It is recommended to allow at least 31.5 inches of clearance between the sides of the portable air conditioner and at least 19.7 inches of space between the top of the portable air conditioner and any adjacent obstacles for optimal air flow.

SUGGESTED TOOLS FOR WINDOW KIT INSTALLATION

- Screwdrivers (medium size Phillips)
- Tape measure or ruler
- Knife or scissors
- Saw (In the event that the window kit needs to be cutdown in size because the window is too narrow for direct installation)

SET UP & USE

WINDOW SLIDER KIT INSTALLATION

Your window slider kit has been designed to fit most standard “Vertical” and “Horizontal” window applications; however, it may be necessary for you to improvise/ modify some aspect of the installation procedures for certain types of window. Minimum and maximum window openings:

MAXIMUM: 59” (150cm)

NOTE: A plastic locking pin is holding the window slider kit together during shipment. Prior to installation, remove plastic locking pin, adjust to desired length and use provided metal locking screws to secure.

NOTE: If the window opening is less than 20.5” the minimum length of the window slider kit, cut the one with a hole in it short to fit for the window opening. Never cut out the hole in window slider kit.

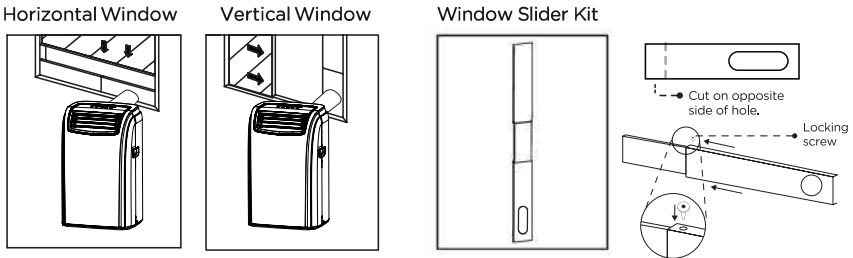

DOUBLE-HUNG SASH/SLIDING CASEMENT WINDOW INSTALLATION

1. Cut the foam seal (adhesive type) to the proper length and attach it to the window sash.
2. Attach the window slider kit to the window sash. Adjust the length of the window slider kit according to the width of window. Shorten the adjustable window kit if the width of window is less than 20.5”.
3. Cut the foam seal (adhesive type) to the proper length and attach it on the top of the window.
4. Close the window securely against the window slider kit.
5. Secure the window slider kit to the window sash.
6. Cut the foam seal to an appropriate length and seal the open gap between the top window frame and outer window frame.

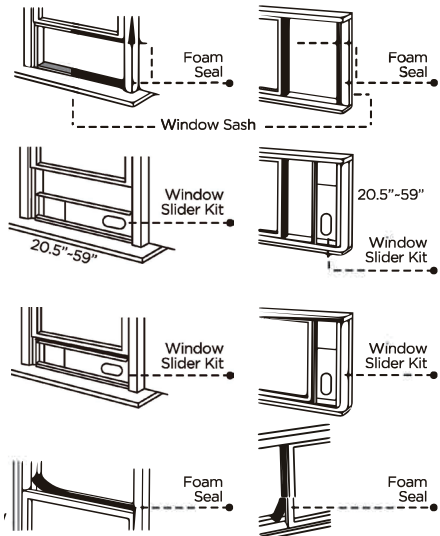

SET UP & USE

EXHAUST HOSE INSTALLATION

The air exhaust hose and hose inlet must be installed or removed from the portable air conditioner in accordance with the way it is being used:

COOL, AUTO, DEHUMIDIFYING, HEAT: (Heat models BPT08HWTB/BPT10HWTB~~HT~~ only)
Air exhaust hose and hose inlet should be connected to the portable air conditioner.

FAN: Air exhaust hose and hose inlet should be disconnected from the portable air conditioner.

To Install:

Position the unit on a flat level surface and make sure there is a minimum clearance of 18" (45cm) and is located near a single circuit power outlet.

1. Align the arrows on the hose inlet connector and the hose. Attach the hose inlet connector by turning it either clockwise or counterclockwise. (Fig. 1)
2. Align the arrows on the hose outlet and the hose. Attach the hose outlet connector by turning it either clockwise or counterclockwise. (Fig. 2)
3. The assembled hose with inlet and outlet connectors appear as Fig 3.
4. Install the hose inlet by aligning it with the slots on the back of the unit and slide down. Insert the outlet into the window bracket. (Fig. 4)

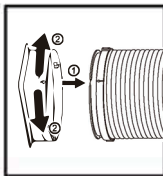

Fig. 1

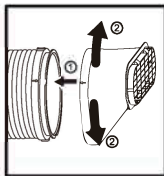

Fig. 2

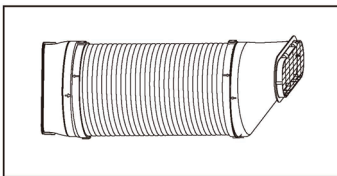

Fig. 3

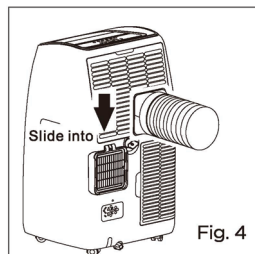
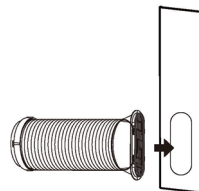
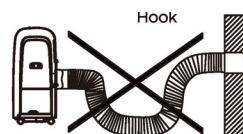

Fig. 4



NOTE: The exhaust hose can be compressed or extended moderately, but it is desirable to keep the length to a minimum. Also make sure that the hose does not have any sharp bends.



SET UP & USE

CONTROL PANEL

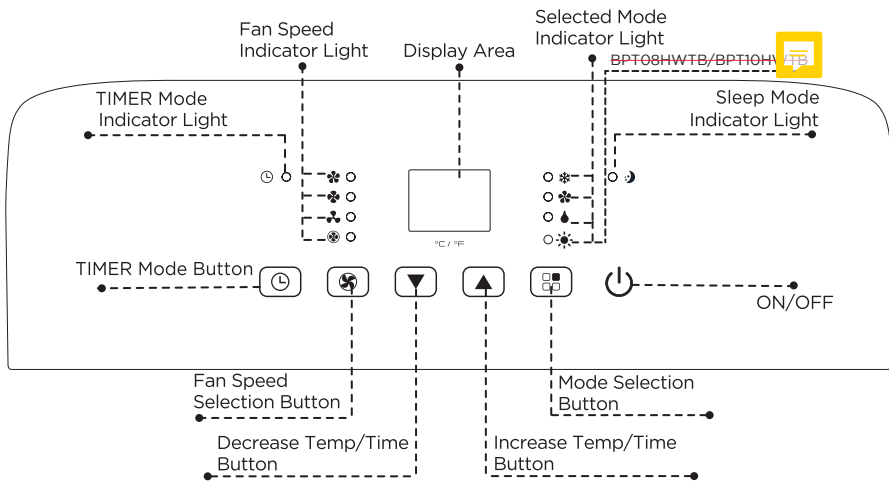

Pictures are for illustration purpose only, Your model may or may not have all the features.



OPERATING FROM THE CONTROL PANEL

The Control Panel enables you to manage all the main functions of the appliance, but to fully exploit its potential, you must use the remote control unit.



Fig. 6

TURNING THE APPLIANCE ON

- Plug into the dedicated electrical outlet. Two lines appear on the display indicating that the appliance is in standby. (Fig.6).
- Press the  button until the appliance comes on. The last function active when it was turned off will appear.
- Never turn the air conditioner off by unplugging from the outlet. Always press the  button, then wait for a few minutes before unplugging. This allows the appliance to perform a cycle of checks to verify operation.

NOTE: Before pressing Power On button make sure the condensate drain cap in the rear of the unit is securely in place to avoid any leaking.

- Press the MODE  button until the light corresponding to the required Mode lights up.



COOL



DEHUMIDIFYING



FAN



HEAT

(Heat models BPT08HWTB and BPT10HWTB only)

SET UP & USE

COOL MODE



Ideal for hot weather when you need to cool and dehumidify the room. To set operation of the appliance correctly, press the  or  buttons until the desired temperature is displayed. (See Fig.7)



Fig. 7

Then select the fan speed by pressing the Fan Speed Button until the light corresponding to the required fan speed lights up:





-  **HIGH:** The Fan operates at maximum to reach the required temperature as rapidly as possible.
-  **MED:** Reduces Fan noise level but still maintains a good level of comfort.
-  **LOW:** For quiet operation.
-  **AUTO:** The appliance automatically selects the most suitable fan speed in relation to the temperature set on the digital display.



Fig. 8

DEHUMIDIFYING MODE

Ideal for reducing humidity in spring and autumn, during rainy spells or in damp rooms, etc.

In dehumidifying mode, the appliance must have the same configuration as for the air conditioner mode, with the air exhaust hose fitted to the appliance to allow air to be discharged externally.

When the dehumidifying mode is selected, the light comes on and "dh" appears on the display. (See Fig.8)

At the same time, the AUTO fan light comes on. In this mode, other fan speeds cannot be selected.

HEAT MODE

(Heat models BPT08HWTB and BPT10HWTB only) Press the MODE button until the HEAT mode indicator light appears. Select the target temperature by pressing the or button until the corresponding value is displayed. (Temperature range is 55°F to 81°F). Select the fan speed by pressing the Fan Speed Button until the light corresponding to the desired fan speed lights up: HIGH, MED, LOW, AUTO.

NOTE: At the beginning of this mode, you may have to wait a few seconds before the appliance starts to produce hot air. When operating in very cold rooms, the appliance defrosts automatically and may disrupt normal operation. The fan will continue operating for a few seconds to lower the interior temperature even after the appliance shuts off. In this mode, the fan may operate for short periods even though the set temperature has been reached.

FAN MODE

Adjust fan speed by pressing the Fan Speed button as described for the cool mode.



Fig. 9

In this mode, AUTO fan cannot be selected.

The fan speed selected will show in the display. One row for Low, Two rows for medium and three rows for high. (See fig. 9)



SETTING THE TIMER

-This timer can be used to delay the appliance start-up or shutdown, this avoids wasting electricity by optimizing operating periods.

Programming start up

- Turn on the appliance, choose the mode you want, for example cool, 24°C, high fan speed. Turn off the appliance.

- Press the Timer button, the  symbol and number of hours flash.

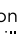
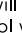

- Press the  or  button to set the number of hours delay before the appliance comes on. The timer can set in intervals of 0.5 hours up to 24 hours.

- A few seconds after set, the setting is memorized, the timer indicator is light and the display shows that the appliance is in standby.

- Press again the Timer button  or the  button, the timer will be canceled, and the "Timer" symbol will disappear from screen.

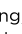
Programming shut down

- When the appliance is running, press the  button, the Timer indicator and the hours flash.

- Press the  or  button to set the number of hours delay before the appliance comes on. The timer can set in intervals of 0.5 hours up to 24 hours.

- A few seconds after set, the setting is memorized, the timer indicator is light and the display shows the current mode.

At the end of the set time the unit automatically turns to standby mode.

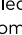
- Press again the Timer button  or the  button, the timer will be canceled, and the "Timer" symbol will disappear from screen.

NOTE: In DEHUMIDIFYING and HEAT mode there will be water removed from the air and collected in the tank. When the tank is full, the appliance shuts down and "ft" (FULLTANK) appears on the display, the tank must be emptied (See water drainage section). The appliance will start up again.

SET UP & USE

OPERATING FROM THE REMOTE CONTROL

BATTERY INSTALLATION (BATTERIES NOT INCLUDED)

- (1) Slide open the battery compartment cover.
- (2) Insert 2 × “AAA” batteries as shown.
- (3) Slide back the battery cover.

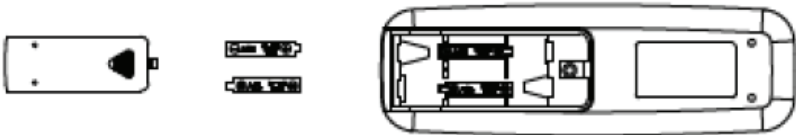

CAUTION: Use only AAA or IEC R03 1.5V alkaline batteries. Remove the batteries if the remote is not used for a month or longer. Do not attempt to recharge the batteries. Both batteries should be replaced at the same time. Do not dispose of the batteries in a fire as they may explode.

Point the remote control at the receiver on the appliance. The remote control must be no more than 7 meters away from the appliance (without obstacle between the remote control and the receiver).

The remote control must be handled with extreme care. Do not drop it or expose it to direct sunlight or sources of heat.

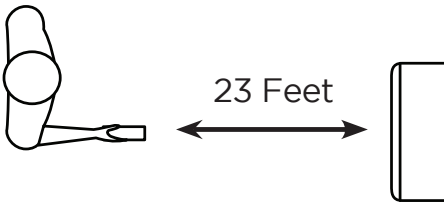

SET UP & USE

REMOTE CONTROL

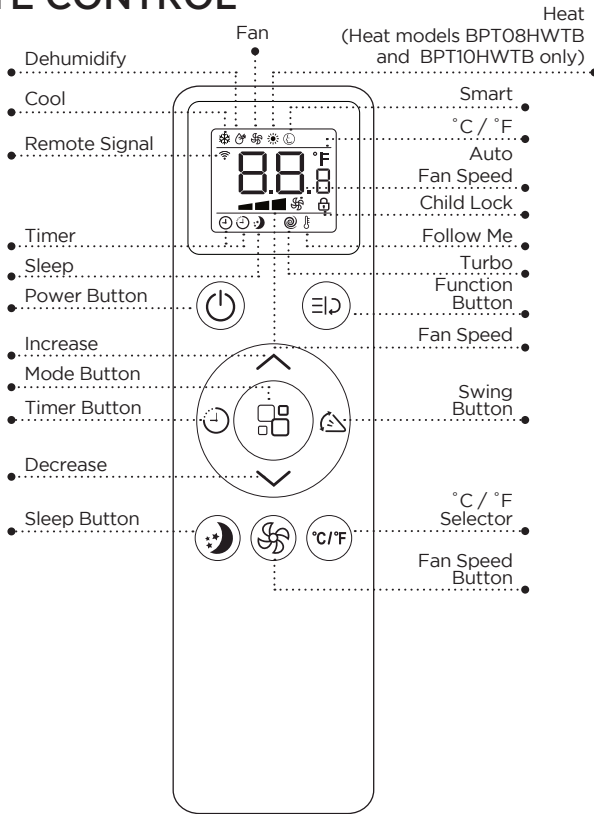

POWER BUTTON: Press to Turn ON or OFF.

MODE BUTTON: Each time you press the button COOL, DEHUMIDIFY, FAN, HEAT (Heat models BPT08HWTB and BPT10HWTB only) is selected.

INCREASE: Increase the temperature setting to 90°F in COOL mode or 81°F in HEAT mode (HEAT model BPT10HWTB only). Also used to set time.

DECREASE: Decrease the temperature setting to 64°F in COOL mode or 55° F in HEAT mode (HEAT model BPT10HWTB only). Also used to set time.

FAN SPEED BUTTON: Used to select the HIGH, MED, LOW or AUTO fan speed.

FUNCTION BUTTON: Access FOLLOW ME or TURBO functions.

















TIMER BUTTON: Used to set a delay start or shut down time.

SWING BUTTON: Activate air swing of the louvers.

SLEEP BUTTON: Gradually increase the temperature in COOL mode or decrease the temperature in HEAT mode (Heat models BPT08HWTB and BPT10HWTB only).

°C / °F SELECTOR BUTTON: Select Fahrenheit or Celsius.







SET UP & USE

LED Display Indicators			
	Cooling mode		Fan speed
	Dehumidify mode		Auto speed
	Fan mode		Child lock
	Heat mode (Heat models BPT08HWTB and BPT10HWTB only)		Timer on
	Smart mode		Timer off
	Signal		Sleep
	Display temperature or hours		Turbo
	Fahrenheit or Celsius		Follow me
	Swing		

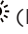

POWER BUTTON

- Press to Turn Air Conditioner ON or OFF.
-  Will show on the remote LED screen when buttons are pressed to show that the remote control is sending a signal to the air conditioner.

MODE BUTTON

- Press the  button to scroll through COOL , DEHUMIDIFY , FAN , HEAT  (Heat models BPT08HWTB and BPT10HWTB only) and SMART .
- The corresponding symbol will illuminate on the LED display to indicate which mode is selected.

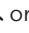
COOL

- Select the target temperature 64°F-90°F (18°C-32°C) by pressing the  or  buttons until the desired temperature is displayed on the LED screen.
- Press the Fan Speed Button  to select Low, Medium, High or Auto Speed.

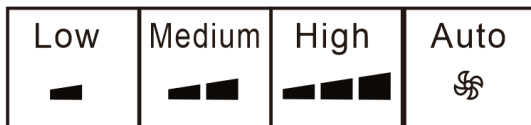

SET UP & USE

DEHUMIDIFY

Ideal for reducing humidity.

- Keep window and door closed for the best dehumidifying effect.
- Exhaust hose attachment is not required to reduce humidity, however it is recommended in very humid rooms so the warm air can be exhausted outside.

Draining in Dehumidify mode

- It is recommended that the dehumidification drain and drain hose be used for continuous drainage.
- WATER FULL - When the water level reaches a predetermined level, **Ft** will be indicated on the display. The unit will have to be drained.

NOTE: Refer to Water Drainage section.



- In this mode, fan speed is selected automatically by the appliance and can not be set manually.

FAN

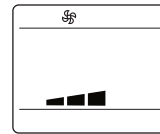
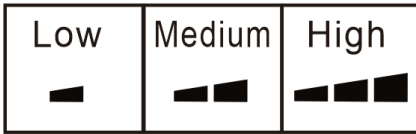
- Press the Fan Speed Button  to select Low, Medium or High Speed.



HEAT (Heat models BPT08HWTB and BPT10HWTB only)

- Select the target temperature 55°F- 81°F (13°C-27°C) by pressing the  or  buttons until the desired temperature is displayed on the LED screen.
- Press the Fan Speed Button  to select Low, Medium, High or Auto Speed.

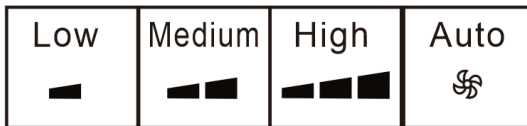

NOTE: At the beginning of this mode, you may have to wait a few seconds before the appliance starts to give out hot air.

- In HEAT mode there will be water removed from the air and collected in the tank, when the tank is full, the appliance shuts down and "ft" (FULL TANK) appears on the display, the tank must be Emptied (See water drainage page). The appliance will start up again.
- When operating in very cold rooms, the appliance defrosts automatically and may disrupt normal operation. The fan will continue operating for a few seconds to lower the interior.
- Temperature even after the appliance shuts off. In this mode, the fan may operate for short periods even though the set temperature has been reached.

SET UP & USE

SMART MODE

- In SMART model the air conditioner will make automatic selections based on the room temperature.

FOR COOL ONLY MODELS

- The air conditioner will automatically operate in FAN mode when the room temperature is below 73°F (23°C).
- It will operate in COOL mode when the room temperature is above 73°F (23°C).

FOR COOL AND HEAT MODELS (Heat models BPT08HWTB and BPT10HWTB only)

- The air conditioner will automatically operate in HEAT mode when the room temperature is below 68°F (20°C).
- It will operate in FAN mode when the room temperature is from 68°F (20°C) to 73°F (23°C).
- It will operate in COOL mode when the room temperature is above 73°F (23°C).
- Press the FAN Speed button  to select HIGH, MED, LOW or AUTO fan speed.

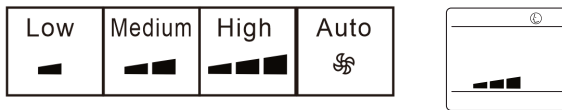





- The control panel on the air conditioner LED display will indicate the below in this mode.



SWING BUTTON

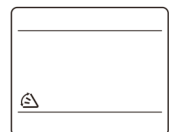

This button will activate the air swing of the louvers while in COOL, DEHUMIDIFY and FAN modes.

- Press the  button, and the  symbol will illuminate on the LED screen of the remote. The deflector will start to swing.
- Press the  button again, the  symbol disappears. The deflector will stop swinging.







SET UP & USE

FUNCTION BUTTON

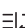



- Press the  to access FOLLOW ME and TURBO functions.
- TURBO  is ideal for a warm room. It will automatically set the temperature to 64°F (18°C) at HIGH Fan speed to cool the room in the shortest time.
- This function only operates in COOL mode.

TO OPERATE TURBO

- Press the Function  button, TURBO  symbol flashes on screen then press the function  button again, the TURBO  symbol will stop flashing and will illuminate on the LED screen indicating that TURBO is activated.

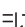







TO CANCEL TURBO

- Press the Function  button, TURBO  symbol flashes on screen then press the function  button again, the TURBO  symbol will stop flashing and will no longer be illuminated in the LED screen indicating that TURBO function is deactivated.







SET UP & USE

FOLLOW ME

Parts of the room are cooler where there is a draft. Other parts are warmer due to direct sunlight. The FOLLOW ME Function allows the room to be cooled according to the room temperature, wherever the remote is located.

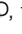
- This function can be activated from the remote control ONLY. The remote control serves as a thermostat allowing for the precise temperature control at its location.
- To activate the Follow Me function, point the remote control towards the appliance and press the FUNCTION  button.
- Press either the  OR  button until the FOLLOW ME  symbol flashes on the LED screen.
- Press the Menu  button. The FOLLOW ME  will stop flashing and illuminate on the LED screen.
- The remote will display the actual temperature at its location. The remote control will send this signal to the air conditioner at 20 minute intervals.
- If the unit does not receive the Follow Me/Temp Sensing signal during a 25 minutes interval, the follow me function will be canceled and will need to be reactivated.



NOTE: · The remote must be within 23 feet of the remote control receiver on the air conditioner unit. It should not have any obstructions.

- To cancel this function, press the , then press either the  or  button until the  flashes onscreen, and then press the  button to confirm the cancellation. The  will stop flashing and disappear from the screen.





TIMER BUTTON



- The timer can be used to delay the appliance start-up or shutdown.

PROGRAMMING START-UP



- With the appliance ON select the settings that you would like to program at start-up. Example: COOL Mode, temperature, fan speed. Turn OFF the air conditioner.
- Press the  button twice, the LED screen will display hours, the  symbol and

 h symbol will flash











- Press the  or  button to set the time when you want the appliance to switch on using the buttons (from 30 minutes to 24 hours).
- During the first ten hours you can select half hour intervals. For times longer than ten hours, one hour intervals can be selected.
- Press the  button again to activate the selected time. The  symbol and h

 will be displayed on the LED screen . Remaining time will be displayed on the LED screen

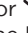
SET UP & USE

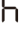
- To cancel the programmed start-up, press the  button again or the  button. The  symbol will not be illuminated on the LED screen.



PROGRAMMING SHUT DOWN

- With the appliance ON Press the  button twice, the LED screen will display hours, the  symbol and  symbol will flash .
- Press the  or  button to set the time when you want the appliance to shut down using the buttons (from 30 minutes to 24 hours).
- Press the  button again to activate the selected time. The  symbol and  will be displayed on screen . Remaining time will be displayed on the LED screen.
- To cancel the programmed shut-down, press the  button again or the  button. The  symbol will not be illuminated on the LED screen.



SLEEP BUTTON

- The SLEEP function maintains the room at optimum temperature without excessive fluctuations with silent operation. Fan speed is always at Low, while room temperature adjusts gradually to ensure the most comfortable environment operation of the appliance.

WHEN OPERATING IN COOL MODE

- Press the  button, and the  symbol appears.
- Selected temperature will increase by 1°F (1°C) per hour in a 2 hour period. This new temperature will be maintained for the next 6 hours, then the air conditioner will turn off.

WHEN OPERATING IN HEAT MODE (Heat models BPT08HWTB and BPT10HWTB only)

- Press the  button, and the  symbol appears.
- Selected temperature will decrease by 1°F (1°C) per hour in a 3 hour period. This new temperature will be maintained for the next 5 hours, then the air conditioner will turn off.
- When you select the SLEEP function, the screen will reduce the brightness, and the fan speed is low.
- The SLEEP function can be canceled at any time during operation by pressing the “Sleep”, “Mode” or “fan speed” button.
- SLEEP function cannot be set In FAN or DEHUMIDIFY mode.

SET UP & USE

°C / °F SELECTOR BUTTON

- When the appliance is powered on, press the °C / °F button, then you can select the unit of temperature from Fahrenheit or Celsius.

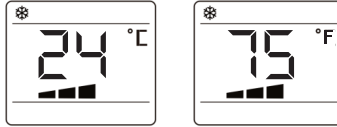

NOTE: This will indicate an “E” momentarily when battery is installed. It will automatically change to °F and display Fahrenheit

CHILD LOCK

- This function is used to prevent children from inadvertently changing the settings by pressing the remote control buttons.
- Press and hold the ^ and v buttons simultaneously for at least 3 seconds to activate the child lock function. When it is activated the lock symbol will appear on the LED screen. Settings cannot be changed by pressing random buttons on the remote.
- To deactivate the child lock, press and hold the ^ and v buttons simultaneously for at least 3 seconds again. The lock symbol will not appear on the LED screen and the settings on the remote can be changed.

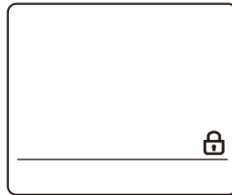

SET UP & USE

WATER DRAINAGE

~~Draining in Cooling Mode.~~ Heat models BPT08HWTB and BPT10HWTB only.

This air conditioner is equipped with auto water evaporation so the water compartment would not typically fill in cooling mode unless there is high humidity. Water drainage will generally only be required at the end of the season, (see START-END OF SEASON OPERATIONS).

NOTE: As a safety measure to prevent water leakage, the air conditioner will turn off when the water level reaches a predetermined level. The control panel will display “ft”(full tank). The unit will not restart until it is drained.

Intermittent Draining (Fig.10)

Water may need to be drained in high humidity areas

1. Unplug the unit from power source.
2. Place a drain pan under the lower drain plug. See diagram.
3. Remove the lower drain cap.
4. Water will drain out and collect in the drain pan (not supplied).
5. After the water is drained, replace the lower drain cap firmly.
6. Turn on the unit.

Continuous Draining (Fig.11)

1. Unplug the unit from the power source. Remove the bottom drain cap. While doing this operation, some residual water may spill. Have a drip pan (not supplied) to collect the water.
2. Connect the drain hose (supplied) as shown in the diagram. The water can be continuously drained through the hose into a floor drain or drip tray.
3. Turn on the unit.

Figure 10

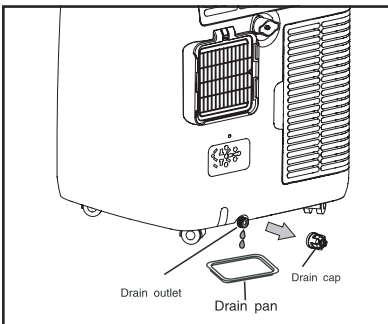
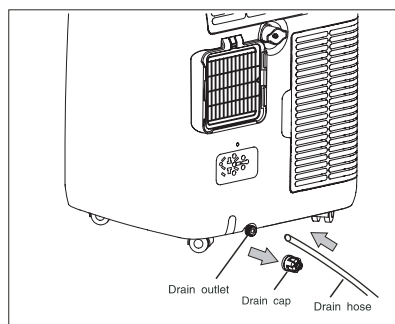

Figure 11



WAIT 3 MINUTES BEFORE RESUMING OPERATION

After the unit has stopped, it cannot be restarted for 3 minutes. Operation will automatically restart after 3 minutes.

SET UP & USE

NOTE: Please be sure that the height of and section of the drain hose should not be higher than that of the drain outlet, or the water tank may not be drained. (Fig.16 and Fig.17).

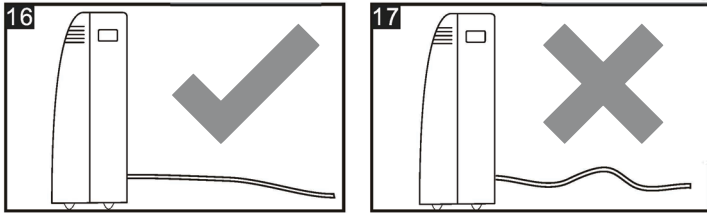

Continuous Draining for Dehumidification Mode

- Unplug the unit from the power source.
- Remove the drain cap (Fig A) located in the back center of the unit. While doing this operation, some residual water may spill. Have a drip pan (not supplied) to collect the water.
- Connect the drain hose (supplied) as shown in the diagram (Fig B). The water can be continuously drained through the hose into a floor drain or bucket.
- Turn on the unit.

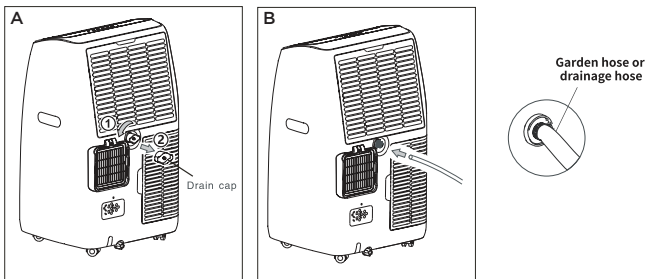

NOTE: Please be sure that the height of and section of the drain hose should not be higher than that of the drain outlet, or the water tank may not be drained.

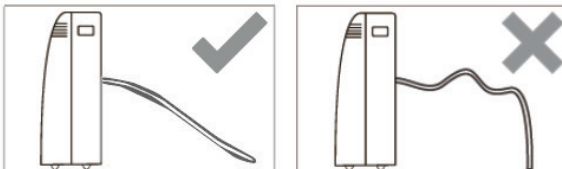

WAIT 3 MINUTES BEFORE RESUMING OPERATION

After the unit has stopped, it cannot be restarted for 3 minutes. Operation will automatically restart after 3 minutes.

CLEANING AND MAINTENANCE

CLEANING



WARNING: Before cleaning or maintenance, turn the appliance off by pressing the **U** button on the control panel or **U** button on the remote control. Wait for a few minutes then unplug from the electrical outlet.

CLEANING THE CABINET

You should clean the appliance with a slightly damp cloth then dry with a dry cloth.



WARNING:

- Never use petrol, alcohol or solvents to clean the appliance.
- Never wash the air conditioner with water.
- It could be dangerous. Never spray insecticide liquids or similar.

CLEANING THE FILTERS

To keep your air conditioner working efficiently, you should clean the filters every week of operation.

The evaporator filter can be removed as shown in Fig.12.

The condenser filter is two pieces.

STEP 1: Take out one filter as shown.

STEP 2: Take out other filter as shown.

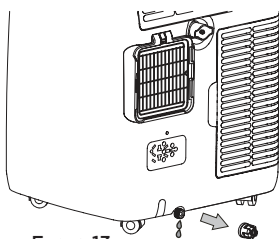

Figure 13

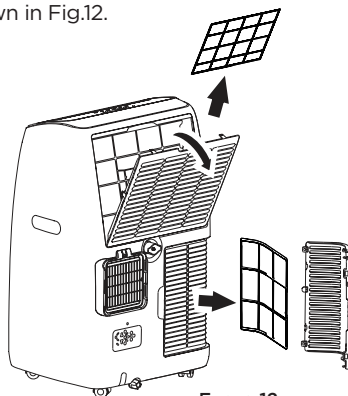

Figure 12

Use a vacuum cleaner to remove dust accumulations from the filters. If it is very dirty, immerse in warm water and rinse a number of times. The water should be luke warm. After washing, leave the filters to dry then re-insert.

SATART - END OF SEASON OPERATIONS

START OF SEASON CHECKS

Make sure the power cable and plug are undamaged. Follow the installation instructions precisely.

END OF SEASON OPERATIONS

To empty the internal circuit completely of water, remove the drain cap (Fig.13)

Run off all water left into basin. When all the water has been drained, put the cap back in place.

Clean the filter and dry thoroughly before putting back.

TROUBLESHOOTING & WARRANTY

BEFORE YOU CALL FOR SERVICE

IF THE APPLIANCE FAILS TO OPERATE:

- A) Check to make sure that the Air Conditioner is plugged in securely. If it is not, remove the plug from the outlet, wait 10 seconds and plug it in again securely.
- B) Check for a blown circuit fuse or a tripped main circuit breaker. If these seem to be operating properly, test the outlet with another appliance.

IF NONE OF THE ABOVE SOLVES THE PROBLEM, CONTACT A QUALIFIED TECHNICIAN. DO NOT TRY TO ADJUST OR REPAIR THE APPLIANCE YOURSELF.

CUSTOMER SERVICE

IMPORTANT

DO NOT RETURN THIS PRODUCT TO THE STORE

If you have a problem with this product, please contact the BLACK+DECKER Customer Satisfaction Center at 844-299-0879 or service@equitybrands.com

**DATED PROOF OF PURCHASE, MODEL # AND SERIAL #
REQUIRED FOR WARRANTY SERVICE**

TROUBLESHOOTING & WARRANTY

Troubleshoot your problem by using the chart below. If the air conditioner still does not work properly, contact W Appliance Co. customer service center or the nearest authorized service center. Customers must never troubleshoot internal components.

TROUBLE	POSSIBLE CAUSE	POSSIBLE REMEDY
Unit does not start when pressing ON/OFF button	<ul style="list-style-type: none"> A. FT appears in the display window B. Room temperature is lower than set temperature (cooling mode) 	<ul style="list-style-type: none"> A. Drain the water in the bottom tray B. Reset the temperature
Not cool enough	<ul style="list-style-type: none"> A. The windows or doors in the room are not closed B. There are heat sources inside the room C. Exhaust air duct is not connected or blocked D. Temperature setting is too high E. Air filter is blocked by dust F. The unit will take approx 3 minutes of operation before cooling/heating occurs. 	<ul style="list-style-type: none"> A. Make sure all the windows and doors are closed B. Remove the heat sources if possible C. Connect the duct and make sure it can function properly D. Decrease the set temperature E. Clean the air filter F. A microprocessor control delays the compressor from operating until 3 mins have passed.
Noisy or vibration	<ul style="list-style-type: none"> A. The surface is not level or not flat enough 	<ul style="list-style-type: none"> A. Place the unit on a flat, level surface if possible
Gurgling sound	<ul style="list-style-type: none"> A. The sound comes from the flowing of the refrigerant inside the air-conditioner 	<ul style="list-style-type: none"> A. It is normal
Unit stops operating	<ul style="list-style-type: none"> A. LT does not display 	<ul style="list-style-type: none"> A. Unit is in defrost mode and will restart automatically once excess frost has been removed.

TROUBLESHOOTING & WARRANTY

LIMITED WARRANTY

Any repair, replacement, or warranty service, and all questions about this product should be directed to W Appliance at **844-299-0879** from the USA or Puerto Rico.

W Appliance warrants to the original purchaser that the product will be free from defects in material, parts and workmanship for the period designated for this product. The warranty commences the day the product is purchased and covers up to a period of **1 year (12 months) for labor/1 year (12 months) for parts (manufacturing defects only)**.

W Appliance agrees that it will, at its option, replace the defective product with either a new or remanufactured unit equivalent to your original purchase during the warranty period.

Exclusions: This warranty does not apply if any of the following conditions exist:

1. If the appearance or exterior of the product has been damaged or defaced, or altered or modified in either design or construction.
2. If the product original serial number has been altered or removed or cannot be readily determined.
3. If there is damage due to a power line surge, user damage to the AC power cord or connection to improper voltage source.
4. If damage is due to general misuse, accidents, or acts of God.
5. If repair attempts are done by unauthorized service agents; use of parts other than genuine parts or parts obtained from persons other than authorized service companies.
6. On units that have been transferred from the original owner.
7. On products that have been purchased as refurbished, like new, second-hand, in a "As-Is" or "Final Sale" terms.
8. To products used in a commercial or rental setting.
9. To product was used in settings other than ordinary household use or used other than in accordance with the provided instructions.
10. To damages for service calls for improper installations.
11. Transportation and shipping costs associated with the replacement of the unit.
12. Service calls to instruct you how to use your product.
13. Service calls to repair or replace the house fuse, reset a circuit breaker, or correct the wiring in the house.

REPAIR OR REPLACEMENT AS PROVIDED UNDER THIS WARRANTY IS THE EXCLUSIVE REMEDY OF THE CUSTOMER; W APPLIANCE SHALL NOT BE LIABLE FOR ANY INCIDENTAL OR CONSEQUENTIAL DAMAGES FOR BREACH OF ANY EXPRESS OR IMPLIED WARRANTY ON THIS PRODUCT, EXCEPT TO THE EXTENT PROHIBITED BY APPLICABLE LAW. ANY IMPLIED WARRANTY OF MERCHANTABILITY OF FITNESS FOR A PARTICULAR PURPOSE ON THIS PRODUCT IS LIMITED TO THE DURATION OF THE WARRANTY.

Some states do not allow the exclusion or limitations of incidental or consequential damages, or limitations on how long the warranty lasts. In these cases the above exclusions or limitations may not apply to you. This warranty gives you specific legal rights and you may also have other rights which vary from state to state.

Obtaining Service: To obtain service, product literature, supplies or accessories please call **844-299-0879** to create a ticket for exchange/repair. Please make sure to provide the date of purchase, model number and a brief description of the problem. Our customer service representative will contact you or send detailed return instructions.

W Appliance does not warrant that the appliance will work properly in all environmental conditions, and makes no warranty and representation, either implied or expressed, with respect to the quality, performance, merchantability, or fitness for a particular purpose other than the purpose identified within this user's manual. W Appliance has made every effort to ensure that this user's manual is accurate and disclaims liability for any inaccuracies or omissions that may have occurred. Information in this user's manual is subject to change without notice and does not represent a commitment on the part of W Appliance. W Appliance reserves the right to make improvements to this user's manual and/or to the products described in this user's manual at any time without notice. If you find information in this manual that is incorrect, misleading, or incomplete, please contact us at **844-299-0879**.

W Appliance Co.
1356 Broadway
New York, NY 10018

BLACK & DECKER, BLACK+DECKER, the BLACK & DECKER and BLACK+DECKER logos and product names and the orange and black color scheme are trademarks of The Black & Decker Corporation, used under license. All rights reserved.

Product in this box may differ slightly from that pictured. Does not affect function. Not all accessories shown in photography are included in this package.

Imported by W Appliance, Inc., 1356 Broadway, New York, NY 10018