

**DK2 USA WEST**

4301 S Valley View Blvd  
Suite 10-11, Las Vegas  
Nevada, 89103, United States

**DK2 CANADA**

5330 Mainway  
Burlington, Ontario  
L7L 6A4, Canada

**DK2 USA EAST**

3750 South Avenue  
North Unit, Toledo, Ohio  
43615, United States



DK2 is a leading manufacturer of power products and automotive accessory items. Our line has expanded into 6 categories of products; Snow Plows, Outdoor Power Equipment, Trailers, Auto Accessories, Winches and our newest addition: Cordless Tools.

We believe in providing quality first and are focused on delivering our products to our customers on time and in accordance with their ever changing needs.

We believe that our business can – and should – have a positive impact on the communities we serve.

With Distribution Centres in both Canada and the US, we service a wide range of wholesale and retail channels by maintaining our commitment of providing products that are designed and created with high ethical standards.



# LIMITED 1 YEAR WARRANTY

## WHAT IS COVERED

DK2 Inc. warrants to the original purchaser of any DK2 product that it will be free and clear of manufacturing defects in workmanship and materials under normal use and service for a period of one (1) year from the date of the original purchase.

If within one (1) year from the original date of purchase this product fails due to defect in material or workmanship, Detail K2 will repair, replace, or supply any defective part at our option. Upon expiry of one (1) year, Detail K2 will have no further liability related to the product. Detail K2 does not authorize any party, including its authorized distributors or dealers, to offer any other warranty on behalf of Detail K2 Inc.

## THIS WARRANTY DOES NOT COVER OR APPLY TO:

- (a) Damage to the product due to misuse, mishandling and abuse
- (b) Improper installation, maintenance and storage
- (c) Expendable parts such as nuts and bolts, pins and springs
- (d) Normal wear and tear
- (e) Consequential damage & incidental damages such as damage to persons or property

## PROCEDURE FOR OBTAINING A RETURN AUTHORIZATION

Within the one (1) year warranty period, the purchaser of the product must notify an authorized distributor or dealer of the claimed defect and provide proof of original purchase. At this time the validity of the claim will be determined and a Return Goods Authorization Number (RGA) will be issued if approved. No returned product will be accepted under warranty unless accompanied by an RGA# issued by Detail K2 Inc.

## RESOLUTION FOR A DEFECTIVE PRODUCT

Detail K2 Inc. will at its option repair or replace the defective product covered by this warranty. The repaired product will be shipped to the purchaser upon completion. All transportation charges shall be the responsibility of the purchaser. Any damage in transit will be the responsibility of the carrier or at the risk of the purchaser.

**DKA** SNOW  
PLOWS



**PAGES**  
**5 - 12**

**DKA**  **POWER**



**PAGES**  
**13 - 28**

**DKA**  **TRAILERS**



**PAGES**  
**29 - 38**

**DKA**  **ACCESSORIES**



**PAGES**  
**39 - 48**

**DKA**  **WARRIOR**



**PAGES**  
**49 - 66**

**DKA**  **CORDLESS  
TOOLS**



**PAGES**  
**67 - 71**



**DKA** SNOWPLOWS<sup>®</sup>









## HITCH-MOUNTED SNOW PLOW

### ITEM NUMBER / UPC

AVAL8219 / 826518004992  
 AVAL8422 / 826518005005  
 AVAL8826 / 826518005708

### FEATURES

- Fits most light trucks and SUV's
- Easy to mount - simply slides into a 2" class III front mount receiver in seconds. Slide out and roll away for storage
- An electric winch lifts the blade, controlled from inside your warm vehicle for easy up and down snow control
- Blade angles set and lock manually with a single lever lifting a pin to 3 blade locking positions: straight on, angled to the right, and angled to the left
- Powder coated all-steel with UV protected paint
- Flip down locking castors allow easy plow attachment, removal, and roll away storage - just lower the wheels and roll the unit to wherever you want it
- Each snow plow kit also includes a set of blade stiffeners for added strength
- ISO 9001 certified manufacturer
- 1 year limited warranty
- Ships in a single carton on a standard size pallet



### DESCRIPTION

The DK2 Universal T-Frame Mounted Snow Plows allow you to quickly and effectively remove snow from your driveway or small parking lot. These plows simply slide into a 2" front mount receiver for easy removal and storage.

Each snow plow ships in a single carton complete with hardened steel cutting edge scraper, rubber snow deflector, polymer-wrapped wire rope plow markers, skid shoes, castor kit for easy storage, and a 3,000lb wireless electric winch. Each plow kit will also include a set of blade stiffeners for added strength by creating a 3 point connection.

### SPECIFICATION

- **Item Number: AVAL8219**
  - Blade Dimensions: 82" (W) x 19" (H)
  - Assembled Weight: 265 lb
  - Gross Weight: 288 lb
  - Box Dimensions: 43" (L) x 32" (W) x 18" (H)
- **Item Number: AVAL8422**
  - Blade Dimensions: 84" (W) x 22" (H)
  - Assembled Weight: 283 lb
  - Gross Weight: 296 lb
  - Box Dimensions: 44" (L) x 32" (W) x 18" (H)
- **Item Number: AVAL8826**
  - Blade Dimensions: 88" (W) x 26" (H)
  - Assembled Weight: 296 lb
  - Gross Weight: 341 lb
  - Box Dimensions: 46" (L) x 35" (W) x 17" (H)



**3,000 LB WIRELESS ELECTRIC WINCH**



**BLADE VIEW**



**MOUNT VIEW**



## HITCH-MOUNTED ELITE SNOW PLOW

### ITEM NUMBER / UPC

AVAL8219ELT / 826518005661  
 AVAL8422ELT / 826518005685  
 AVAL8826ELT / 826518005715



### DESCRIPTION

The DK2 Universal T-Frame Mounted Snow Plows allow you to quickly and effectively remove snow from your driveway or small parking lot. These plows simply slide into a 2" front mount receiver for easy removal and storage.

Each snow plow ships in a single carton complete with hardened steel cutting edge scraper, rubber snow deflector, polymer-wrapped wire rope plow markers, skid shoes, castor kit for easy storage, and a wireless electric actuator for extra strength and reliability versus the winch-driven standard series. Each plow kit will also include a set of blade stiffeners for added strength by creating a 3 point connection.

### ACTUATOR BENEFITS

Smoother operation, better control, with a built-in clutch to protect your snow plow blade. Actuators use a strong chain to lift your plow while using less amperage than the winch, extending the life of your solenoid. Built with a completely sealed gearbox and housing - IP67 dust and water rating.

### SPECIFICATION

- **Item Number: AVAL8219ELT**
- Blade Dimensions: 82" (W) x 19" (H)
- Assembled Weight: 265 lb
- Gross Weight: 321 lb
- Box Dimensions: 46" (L) x 36" (W) x 18" (H)
  
- **Item Number: AVAL8422ELT**
- Blade Dimensions: 84" (W) x 22" (H)
- Assembled Weight: 283 lb
- Gross Weight: 334 lb
- Box Dimensions: 44" (L) x 32" (W) x 18" (H)
  
- **Item Number: AVAL8826ELT**
- Blade Dimensions: 88" (W) x 26" (H)
- Assembled Weight: 296 lb
- Gross Weight: 341 lb
- Box Dimensions: 46" (L) x 35" (W) x 17" (H)



WIRELESS ELECTRIC ACTUATOR



BLADE VIEW



MOUNT VIEW

### FEATURES

- Fits most light trucks and SUV's
- Easy to mount - simply slides into a 2" class III front mount receiver in seconds. Slide out and roll away for storage
- An electric actuator lifts the blade, controlled from inside your warm vehicle for easy up and down snow control
- Blade angles set and lock manually with a single lever lifting a pin to 3 blade locking positions: straight on, angled to the right, and angled to the left
- Powder coated all-steel with UV protected paint
- Flip down locking castors allow easy plow attachment, removal, and roll away storage - just lower the wheels and roll the unit to wherever you want it
- Each snow plow kit also includes a set of blade stiffeners for added strength
- ISO 9001 certified manufacturer
- 1 year limited warranty
- Ships in a single carton on a standard size pallet



## CUSTOM MOUNTED SNOW PLOW

### ITEM NUMBER / UPC

RAMP8219 / 693495992167  
 STOR8422 / 693495992174  
 SUMM8826 / 693495992181

### FEATURES

- Fits most light trucks and SUV's
- Easy to mount – simply slides onto your custom vehicle specific mounting brackets in seconds. Slide out and roll away for storage
- A wireless winch lifts the blade, controlled from inside your warm vehicle for easy up and down snow control
- Blade angles set and lock manually with a single lever lifting a pin to 3 blade locking positions: straight on, angled to the right, and angled to the left
- Powder coated all-steel with UV protected paint
- Locking castors allow easy plow attachment, removal, and roll away storage – just lower the wheels and roll the unit to wherever you want it
- ISO 9001 certified manufacturer
- 1 year limited warranty
- Ships in a single carton on a standard size pallet

10



### DESCRIPTION

All DK2 Snow Plows allow you to quickly & effectively remove snow from your driveway or small parking lot. DK2's range of personal plows each mount on to a vehicle specific custom mounting brackets.

Ships in a single carton complete with hardened steel cutting edge scraper, rubber snow deflector, polymer-wrapped wire rope plow markers, skid shoes, castor kit for easy storage, and a 3,000lb wireless electric winch.

### SPECIFICATION

#### • RAMPAGE II

- **Item Number: RAMP8219**
- Blade Dimensions: 82" (W) x 19" (H)
- Assembled Weight: 265 lb
- Gross Weight: 280 lb
- Box Dimensions: 43" (L) x 32" (W) x 18" (H)



**3,000 LB WIRELESS ELECTRIC WINCH**

#### • STORM II

- **Item Number: STOR8422**
- Blade Dimensions: 84" (W) x 22" (H)
- Assembled Weight: 283 lb
- Gross Weight: 287 lb
- Box Dimensions: 43" (L) x 32" (W) x 18" (H)



**BLADE VIEW**

#### • SUMMIT II

- **Item Number: SUMM8826**
- Blade Dimensions: 88" (W) x 26" (H)
- Assembled Weight: 296 lb
- Gross Weight: 301 lb
- Box Dimensions: 46" (L) x 35" (W) x 17" (H)



**MOUNT VIEW**







### ITEM NUMBER / UPC

RAMP8219ELT / 826518005326  
 STOR8422ELT / 826518005333  
 SUMM8826ELT / 826518004916

### FEATURES

- Fits most light trucks and SUV's
- Easy to mount – simply slides onto your custom vehicle specific mounting brackets in seconds. Slide out and roll away for storage
- An electric actuator lifts the blade, controlled from inside your warm vehicle for easy up and down snow control
- Blade angles set and lock manually with a single lever lifting a pin to 3 blade locking positions: straight on, angled to the right, and angled to the left
- Powder coated all-steel with UV protected paint
- Flip down locking castors allow easy plow attachment, removal, and roll away storage - just lower the wheels and roll the unit to wherever you want it
- Each snow plow kit also includes a set of blade stiffeners for added strength
- ISO 9001 certified manufacturer
- 1 year limited warranty
- Ships in a single carton on a standard size pallet

### DESCRIPTION

DK2's line of personal snow plows just got better! The DK2 ELITE SERIES Snow Plow line up takes its simple yet effective design and improves on it with a wireless actuator for ultimate reliability.

DK2's ELITE SERIES each mount on to a vehicle specific custom mounting brackets. Each snow plow ships in a single carton complete with hardened steel cutting edge scraper, rubber snow deflector, polymer-wrapped wire rope plow markers, skid shoes, castor kit for easy storage, and a wireless electric actuator kit.

### ACTUATOR BENEFITS

Smoother operation, better control, with a built-in clutch to protect your snow plow blade. Actuators use a strong chain to lift your plow while using less amperage than the winch, extending the life of your solenoid. Built with a completely sealed gearbox and housing - IP67 dust and water rating.

### SPECIFICATION

- **RAMPAGE II ELITE**
- **Item Number: RAMP8219ELT**
- Blade Dimensions: 82" (W) x 19" (H)
- Assembled Weight: 265 lb
- Gross Weight: 280 lb
- Box Dimensions: 43" (L) x 32" (W) x 18" (H)
  
- **STORM II ELITE**
- **Item Number: STOR8422ELT**
- Blade Dimensions: 84" (W) x 22" (H)
- Assembled Weight: 283 lb
- Gross Weight: 287 lb
- Box Dimensions: 43" (L) x 32" (W) x 18" (H)
  
- **SUMMIT II ELITE**
- **Item Number: SUMM8826ELT**
- Blade Dimensions: 88" (W) x 26" (H)
- Assembled Weight: 296 lb
- Gross Weight: 301 lb
- Box Dimensions: 46" (L) x 35" (W) x 17" (H)



WIRELESS ELECTRIC ACTUATOR



BLADE VIEW



MOUNT VIEW



# FULLY HYDRAULIC EVEREST SNOW PLOW

## ITEM NUMBER

EVST9022

## UPC

826518005579

## FEATURES

- Ships partially assembled (mount & wiring required)
- Simple bolt on custom fitted mounting brackets, no drilling or welding required (sold separately)
- Hydraulic system lifts and lowers blade
- Light weight, no need to alter stock suspension
- Black UV powder coated components with an industrial painted blade skin
- Self-leveling foot provides max blade tip clearance when the blade is fully raised
- Skid shoes to assist guiding the blade edge over uneven terrain or from possibly marking those more delicate driveways
- Snow deflector to assist directing snow forward and also minimizing windshield spray
- Wired hand held control
- Blade hardware holds the hydraulic pump so it can be rolled away from the vehicle rather than being left on the truck with the mount
- Thicker trip springs to ensure tension remains strong and coils tight for optimal performance when encountering obstacles
- Existing holes in plow frame make it easy to add bolt-on accessories
- Bolt-on accessories and upgrades available



12



## DESCRIPTION

DK2 is proud to bring you the ultimate snow plow solution in our line up - the DK2 Everest.

This prosumer, fully hydraulic snow plow kit provides you the opportunity to clear your parking lot, driveway, or lane way whenever required. With our fully hydraulic system you can raise, lower, and angle the snow plow blade from inside your vehicle using our wired hand held remote. For extreme durability against the elements and rust, DK2 combines an industrial powder-coated paint finish on the blade with hot dipped galvanized hardware components to keep your plow looking new for years.

The plow itself simply clips to a DK2 custom fitted vehicle mounting system and can pretty much mount to anything that's fit to push snow.

## SPECIFICATION

- Blade Dimensions: 88" (W) x 22" (H)
- Assembled Weight: 425 lb
- Gross Weight: 450 lb
- Shipping Dimensions: 48" (L) x 42" (W) x 40" (H)
- Construction: Steel tube & sheet
- Color/Finish: Black industrial powder coated blade skin and all other components
- Lift system: Hydraulic
- Angling System: Hydraulic, multiple positions
- Control System: Wired remote control to lift, lower, angle left or right
- Vehicle Mounting System: Custom bolt-on mounting brackets \*Sold separately
- Scraper Blade: Powder coated steel, replaceable
- Included: Snow Deflector, Skid Shoes





**DKA**  **POWER**









OPC533

DKM POWER

KOHLER



## 3 INCH CHIPPER SHREDDER

### ITEM NUMBER

OPC503

### UPC

826518005487

### FEATURES

- Powered by a KOHLER® CH270 7 HP Command Pro Commercial Engine.
- Direct drive combo chipper shredder with dual carbide chip & quad hammer shredders
- Perfect for trees, branches, leaves and garden composting
- Extra large feed chutes
- Drop stand and handy removable tow bar
- ATV-locking wheels (Off-road only)
- Removable key shutoff
- 4-stage cyclonic air filter system
- Includes 3 year KOHLER® Commercial Warranty and 1 Year DK2 Chassis Warranty

**OFF-ROAD ONLY  
MAX SPEED 15 MPH**



16

### DESCRIPTION

ATV towable 3 inch 4000 RPM Direct Drive combo chipper shredder. Double cutting blades with direct shaft drive centrifugal force deteriorates Trees, Branches, Leaves, and Garden composting.

Additional premium features include extra large feed chutes, drop stand and handy removable tow bar, locking wheels, removable key shutoff, 4 Stage cyclonic filter system, a 7HP KOHLER® CH270 Command PRO Engine and a 3YR Commercial warranty.

### SPECIFICATION

<b>ENGINE MODEL</b>	KOHLER CH270
<b>ENGINE</b>	7 HP 4000 RPM Command Pro Commercial
<b>TIRES</b>	ATV-Locking <b>OFF-ROAD ONLY</b>
<b>WHEELBASE</b>	28"
<b>TREE DIAMETER</b>	3"
<b>CUTTING BLADES</b>	Dual Carbide Blades
<b>CHIPPER SHREDDER</b>	Leaves, Brush, Garden Compost
<b>GEARBOX</b>	Direct Drive
<b>EXPULSION CHUTE</b>	Adjustable
<b>DIMENSIONS</b>	63" x 32" x 43"
<b>WEIGHT</b>	170 lb
<b>SHIPPING DIMENSIONS</b>	43" x 23" x 22"
<b>SHIPPING WEIGHT</b>	199 lb
<b>WARRANTY</b>	3 Year Engine 1 Year Chassis



**TOP LOADING CHUTE**



**EXTRA LARGE FEED CHUTE**



**ATV-LOCKING WHEELS  
\*NOT FOR HIGHWAY USE**



**TOW BAR & HITCH INCLUDED**

## 3 INCH 3-IN-1 CHIPPER SHREDDER & VACUUM

### ITEM NUMBER

OPC503V

17

### UPC

827518006979



### DESCRIPTION

ATV towable 3 inch 4000 RPM Direct Drive combo chipper shredder with a vacuum kit. Double cutting blades with direct shaft drive centrifugal force deteriorates Trees, Branches, Leaves, and Garden composting.

Additional premium features include extra large feed chutes, drop stand and handy removable tow bar, locking wheels, removable key shutoff, 4 Stage cyclonic filter system, a 7HP KOHLER® CH270 Command PRO Engine and a 3YR Commercial warranty.

### SPECIFICATION

<b>ENGINE MODEL</b>	KOHLER CH270
<b>ENGINE</b>	7 HP 4000 RPM Command Pro Commercial
<b>TIRES</b>	ATV-Locking <b>OFF-ROAD ONLY</b>
<b>WHEELBASE</b>	28"
<b>TREE DIAMETER</b>	3"
<b>CUTTING BLADES</b>	Dual Carbide Blades
<b>CHIPPER SHREDDER &amp; VACUUM</b>	Leaves, Brush, Garden Compost
<b>GEARBOX</b>	Direct Drive
<b>EXPULSION CHUTE</b>	Adjustable
<b>DIMENSIONS</b>	63" x 32" x 43"
<b>WEIGHT</b>	170 lb
<b>SHIPPING DIMENSIONS</b>	43" x 23" x 22"
<b>SHIPPING WEIGHT</b>	199 lb
<b>WARRANTY</b>	3 Year Engine 1 Year Chassis



**VACUUM KIT INCLUDED**



**EXTRA LARGE FEED  
& TOP LOADING CHUTES**



**ATV-LOCKING WHEELS  
OFF-ROAD ONLY**



**TOW BAR & HITCH INCLUDED**

### FEATURES

- Powered by a KOHLER® CH270 7 HP Command Pro Commercial Engine.
- Direct drive combo chipper shredder with dual carbide chip & quad hammer shredders
- Perfect for trees, branches, leaves and garden composting
- Extra large feed chutes
- Drop stand and handy removable tow bar
- ATV-locking wheels (Off-road only)
- Vacuum kit included
- Removable key shutoff
- 4-stage cyclonic air filter system
- Includes 3 year KOHLER® Commercial Warranty and 1 Year DK2 Chassis Warranty

**OFF-ROAD ONLY  
MAX SPEED 15 MPH**



## 3 INCH CHIPPER SHREDDER

### ITEM NUMBER

OPC533

### UPC

827518007235

### DESCRIPTION

Don't let its size fool you. This small unit chews through any tree up to 3 inches, branches, leaves, and garden composting. The OPC533 features dual cutting blades with direct shaft drive centrifugal force, an extra large feed chute with a heavy duty deflector, drop stand and a handy removable tow bar for compact storage, locking wheels that secure the unit in place when in use, and a quick latch chute to access the cutter chamber with ease.

### SPECIFICATION

<b>ENGINE MODEL</b>	KOHLER RH265
<b>ENGINE</b>	6.5 HP, 196cc 3600 RPM 2000 Series OHV
<b>GEARBOX</b>	Direct Drive 10.7 Gross Torque
<b>TREE DIAMETER / BRUSH &amp; LEAVES</b>	3" Trees / 3/8" Brush & Leaves
<b>CUTTING FEED</b>	Blade Feed
<b>CUTTING BLADES</b>	2 Dual 2 Chip Cutters
<b>WHEELS</b>	ATV-Locking - Rims Lock While Chipping <b>OFF-ROAD ONLY</b>
<b>WHEELBASE</b>	26"
<b>DIMENSIONS</b>	63" x 26" x 43"
<b>WEIGHT</b>	165 lb
<b>SHIPPING DIMENSIONS</b>	36" x 22" x 25"
<b>SHIPPING WEIGHT</b>	185 lb
<b>WARRANTY</b>	2 Year Engine (Parts & Labor) 1 Year Chassis



**TOP LOADING CHUTE**



**LARGE FEED CHUTE**



**ATV-LOCKING WHEELS**  
**OFF-ROAD ONLY**



**REMOVABLE TOW BAR**

### FEATURES

- Powered by a KOHLER® RH265 196cc, 6.5 HP 2000 Series OHV Engine.
- Chips through trees up to 3 inches and brush up to 3/8" inches in diameter.
- Direct drive 10.7 gross torque with 2 dual 2 chip cutters
- ATV-locking wheels - rims lock while chipping (Off-road only)
- Top loading hopper for branches and leaves
- Large feed chute for trees
- Includes 2 year KOHLER® parts and labor warranty and 1 year DK2 Chassis warranty

**OFF-ROAD ONLY**  
**MAX SPEED 15 MPH**





## 4 INCH DISK CHIPPER

### ITEM NUMBER

OPC514

19

### UPC

827518007266

### DESCRIPTION

Introducing the brand new DK2 OPC514 14 HP Wood Chipper, powered by a CH440 KOHLER® Command Pro Commercial Engine that gives you the power to devour trees and branches up to 4.5 inches in diameter. This unit's expulsion chute is perfect for pickup truck bed height, and it's dual belt drive disk chipping capability keeps the chipper more compact than our other models of this caliber. This unit is D.O.T. approved (*NOT for highway towing*) and should be towed at a maximum of 25 MPH. With the included 2" hitch receiver, tow bar and free jack, this unit can be moved to different locations with ease.

### SPECIFICATION

<b>ENGINE MODEL</b>	KOHLER CH440
<b>ENGINE</b>	14 HP 3600 RPM Command Pro Commercial
<b>TREE DIAMETER</b>	4.5"
<b>CUTTING METHOD</b>	Disk
<b>CUTTER DISK</b>	Dual Belt Drive 17mm x 900mm Li (0.67" x 35.4" inner dia.) Centrifugal Clutch
<b>WHEELS</b>	16.1" x 3-3/4" D.O.T. Rated 4.8-8 4 Ply Pneumatic Tires <b>NOT FOR HIGHWAY USE</b>
<b>WEIGHT</b>	573 lb
<b>DIMENSIONS</b>	89.4" x 39.4" x 65.2"
<b>SHIPPING WEIGHT</b>	595 lb
<b>SHIPPING DIMENSIONS</b>	41.4" x 30.4" x 49.3"
<b>WARRANTY</b>	3 Year Engine 1 Year Chassis



**DUAL BELT DRIVE DISK**



**4.8-8 PNEUMATIC TIRES  
NOT FOR HIGHWAY USE**



**PICKUP TRUCK BED HEIGHT**



**TOW BAR & JACK INCLUDED**

### FEATURES

- Powered by a KOHLER® CH440 429cc, 14 HP Command Pro Commercial Engine.
- Chips through trees and branches up to 4.5 inches in diameter.
- Built with dual belt drive 17mm x 900mm Li (0.67" x 35.4" inner dia.) centrifugal clutch disk to chip with ease and keep the unit more compact than its other 14 HP counterparts.
- Tow bar and jack included
- D.O.T. Rated (up to 25 MPH) 4.8-8 pneumatic tires to move the unit to different job sites easily (Not for highway use)
- Designed to be pickup truck bed height for effortless chip loading.
- Includes 3 year KOHLER® Commercial warranty and 1 year DK2 Chassis warranty

**NOT FOR HIGHWAY USE  
MAX SPEED 25 MPH**



## 4 INCH KINETIC CHIPPER

### ITEM NUMBER

OPC524

### UPC

827518007259

20



### DESCRIPTION

The DK2 Power 4 inch 7 HP Commercial Chipper features dual swing chutes, dual edge reversible high speed cutting blades, Bearing mounted ATV tires and rims and built in toolbox. Extended load chute with safety E-Stop. The KOHLER® Commercial Command Pro engine has a 3-Year Kohler warranty. The 7 hp 4000RPM delivers 10.5 ft/lb torque for superior cutting performance. Dual V belt direct drive and kinetic cyclonic drum pulverize up to 4 inch diameter trees. For increased longevity, the blades are double edge cut reversible. The tool-free dual swing chutes quickly open for easy drum access. The feed chute features dual integrated handles for easy equipment moving, a quick-drop stand, and a 1 7/8 inch ball removable tow bar. Schedule 80 tool free chip chute pipe rotates 180 degrees. Includes bonus built in full size tool box.

### SPECIFICATION

<b>ENGINE MODEL</b>	KOHLER CH270
<b>ENGINE</b>	7 HP 4000 RPM Command Pro Commercial
<b>TREE DIAMETER</b>	4"
<b>CHIPPER</b>	Auto Adjusting up to 4" Dia. Trees and Brush
<b>CUTTING BLADES</b>	Double-Edge Cut Reversible
<b>EXPULSION CHUTE</b>	Tool-Free Swing Open and Adjustable 180°
<b>WHEELS</b>	Bearing Mounted ATV Rims and Tires (Off-Road Only) <b>OFF-ROAD ONLY</b>
<b>DIMENSIONS</b>	91" x 46" x 30"
<b>WEIGHT</b>	300 lb
<b>SHIPPING DIMENSIONS</b>	34" x 22" x 35"
<b>SHIPPING WEIGHT</b>	330 lb
<b>WARRANTY</b>	3 Year Engine 1 Year Chassis



**SWING OPEN CHUTES**



**ATV TIRES & RIMS**  
**OFF-ROAD ONLY**



**EXTRA LARGE FEED CHUTE**



**TOW BAR & HITCH INCLUDED**

### FEATURES

- Powered by a KOHLER® CH270 7 HP Command Pro Commercial Engine
- Chips through trees and branches up to 4 inches in diameter
- Dual belt drive drum transmission with dual edge reversible cutters for trees and brush up to 4 inches in diameter
- Bearing mounted ATV rims and tires for off-road performance (Off-road only)
- E-stop safety shutoff
- Extended feed chute
- Dual tool-free swing open chutes for easy drum access
- 180 degree tool-free rotational spout on chip chute
- Extra large reinforced feed chute with equipment moving handles
- Includes 3 year KOHLER® Commercial warranty and 1 year DK2 Chassis warranty

**OFF-ROAD ONLY**  
**MAX SPEED 15 MPH**





## 5 INCH AUTO FEED ELECTRIC START DISK CHIPPER

### ITEM NUMBER

OPC505AE

21

### UPC

827518006702



### DESCRIPTION

5 inch electric start D.O.T. wood chipper, self contained auto feed system with hydraulic roller speeds up to 600 RPM.

3600 RPM drive with auto adjusting feed chamber up to 5.25 dia trees, large feed chute, adjustable pickup height rotational chip chute. ALL TERRAIN ON/OFF ROAD TIRES D.O.T approved (not for highway use) with included 2 inch ball tow bar. CE safety certified. DK2 POWER manufactures performance equipment.

### SPECIFICATION

<b>ENGINE MODEL</b>	KOHLER CH440
<b>ENGINE</b>	14 HP 3600 RPM Command Pro Commercial
<b>TIRES</b>	D.O.T. (25 MPH max) <b>NOT FOR HIGHWAY USE</b>
<b>WHEELBASE</b>	47"
<b>TREE DIAMETER</b>	5.25"
<b>CUTTING BLADES</b>	High Speed Disk Cutters
<b>CHIPPER SHREDDER</b>	Auto Adjusting 5" to 1/8" Materials
<b>GEARBOX</b>	Direct Drive
<b>EXPULSION CHUTE</b>	Adjustable 180° 59" Pickup Bed Height
<b>DIMENSIONS</b>	91" x 40" x 61"
<b>WEIGHT</b>	638 lb
<b>SHIPPING DIMENSIONS</b>	63" x 33" x 45"
<b>SHIPPING WEIGHT</b>	726 lb
<b>WARRANTY</b>	3 Year Engine 1 Year Chassis



**EXTRA LARGE FEED CHUTE**



**PICKUP TRUCK BED HEIGHT**



**D.O.T. TIRES (25 MPH)  
NOT FOR HIGHWAY USE**



**TOW BAR & HITCH INCLUDED**

### FEATURES

- Powered by a KOHLER® CH440 14 HP Command Pro Commercial Engine
- Dual swing-open chutes for easy drum access
- High speed disk chipper shredder
- 600 RPM feed
- Auto blade feeding system
- Auto adjust cutters for brush up to 5.25 diameter trees
- All-terrain on/off road tires D.O.T. approved (not for highway use) with included 2 inch ball tow bar
- Dual, tool free rotational spout on chip chute
- Internal, free-spinning teeth clears chips and wood from drum interior
- Extra-large reinforced feed hopper with integrated equipment moving handles
- Electric start - battery included
- Includes 3 year KOHLER® Commercial warranty and 1 year DK2 Chassis warranty

**NOT FOR HIGHWAY USE  
MAX SPEED 25 MPH**



## 6 INCH CYCLONIC CHIPPER SHREDDER

### ITEM NUMBER

OPC506

### UPC

826518005517

22



### DESCRIPTION

The DK2 POWER OPC506 is a 6 inch cyclonic chipper shredder powered by a KOHLER® 14 HP 3600 RPM Command Pro Commercial engine, equipped with dual 13 inch, double-edge reversible cutting blades that auto adjust to pulverize trees and brush up to 6.25 inches in diameter.

Large quick open hoppers, 59" truck bed height chip chute with adjustable cast iron rotating hood, easy drop stand, removable tow bar, 2 inch hitch. Premium built-in tool box, Key shutoff with lock out safety switch. Extended 48 inch safety stability axle with D.O.T. tires (not for highway use). Safety kit includes, tools, glasses, ear protection and gloves. Integrated chute handles, powder coated for durability.

### SPECIFICATION

<b>ENGINE MODEL</b>	KOHLER CH440
<b>ENGINE</b>	14 HP 3600 RPM Command Pro Commercial
<b>TIRES</b>	D.O.T. (25 MPH max) <b>NOT FOR HIGHWAY USE</b>
<b>WHEELBASE</b>	47"
<b>TREE DIAMETER</b>	6.25"
<b>CUTTING BLADES</b>	Dual Reversible Double Edge Blades
<b>CHIPPER SHREDDER</b>	Auto Adjusting 6" to 1/8" Materials
<b>GEARBOX</b>	Dual Direct Drive
<b>EXPULSION CHUTE</b>	Adjustable 180° 59" Pickup Bed Height
<b>DIMENSIONS</b>	102" x 47" x 59"
<b>WEIGHT</b>	395 lb
<b>SHIPPING DIMENSIONS</b>	45" x 26" x 43"
<b>SHIPPING WEIGHT</b>	461 lb
<b>WARRANTY</b>	3 Year Engine 1 Year Chassis



**DUAL SWING-OPEN CHUTES**



**PICKUP TRUCK BED HEIGHT**



**D.O.T. TIRES (25 MPH)  
NOT FOR HIGHWAY USE**



**TOW BAR & HITCH INCLUDED**

### FEATURES

- Powered by a KOHLER® CH440 429cc, 14 HP Command Pro Commercial Engine.
- Reversible dual-edge high-speed cutting blades
- Auto adjusting cyclonic drum chamber deteriorates trees and brush up to 6.25 inches in diameter
- Large, quick-open hoppers
- 59 inch pickup truck bed height chip chute with adjustable cast iron rotating hood and easy drop stand
- Removable tow bar with 2 inch hitch
- Premium built-in toolbox
- Key shutoff with lock out safety switch
- Extended 48 inch safety stability axle with D.O.T. tires (Not for highway use)
- Safety kit includes tools, glasses, ear protection and gloves
- Integrated chute handles, powder-coated for durability
- Includes 3 year KOHLER® Commercial warranty and 1 year DK2 Chassis warranty

**NOT FOR HIGHWAY USE  
MAX SPEED 25 MPH**





## 6 INCH KINETIC CYCLONIC ELECTRIC START CHIPPER

ITEM NUMBER

OPC566E

23

UPC

827518006757

### DESCRIPTION

6" kinetic cyclonic chipper, electric start 3600 RPM 14 HP CH440 KOHLER® Command Pro Commercial engine.

Dual edge reversible 12 inch cutting blades auto adjust to pulverize trees and brush up to 6.25 inches in diameter. Tool Free Dual Swing Chutes quickly open for easy drum access. D.O.T. road legal tires. 48 inch extended axle for uneven ground and towing stability. Front articulated ground wheels for easy equipment moving. 2 inch ball tow bar. Rotational chip chute pickup truck height for bed loading.

### SPECIFICATION

ENGINE MODEL	KOHLER CH440
ENGINE	14 HP 3600 RPM Command Pro Commercial
TIRES	D.O.T. (25 MPH max) <b>NOT FOR HIGHWAY USE</b>
WHEELBASE	48"
TREE DIAMETER	6.25"
CUTTING BLADES	Dual Reversible Double Edge
CHIPPER	Auto Adjusting 6" to 1/8" Materials
GEARBOX	Dual Direct Drive
EXPULSION CHUTE	Adjustable 180° 59" Pickup Bed Height
DIMENSIONS	102" x 47" x 59"
WEIGHT	594 lb
SHIPPING DIMENSIONS	45" x 31" x 48"
SHIPPING WEIGHT	726 lb
WARRANTY	3 Year Engine 1 Year Chassis



EXTRA LARGE FEED CHUTE



PICKUP TRUCK BED HEIGHT



D.O.T. TIRES (25 MPH)  
**NOT FOR HIGHWAY USE**



TOW BAR & HITCH INCLUDED

### FEATURES

- Powered by a KOHLER® CH440 14 HP Command Pro Commercial Engine.
- Dual belt drive drum transmission with 12 in. dual edge reversible cutting blades
- Auto Adjust cutters for trees and brush up to 6.25 inches in diameter
- Auto blade branch feeding
- Extended 48 inch axle D.O.T approved for legal road towing (NOT for highway use)
- Includes safety glasses, ear protection, work gloves and assembly tools
- Electric start - battery included
- CE Safety approved shutoff
- Dual tool free swing open chutes
- Tool free rotational spout on chip chute - pickup truck bed height
- Extra-large reinforced feed hopper with integrated moving handles
- Includes 3 year KOHLER® Commercial warranty and 1 year DK2 Chassis warranty

**NOT FOR HIGHWAY USE**  
**MAX SPEED 25 MPH**



## 12 INCH STUMP GRINDER

### ITEM NUMBERS

OPG777

### UPC

826518005524

### FEATURES

- Powered by a KOHLER® CH440 429cc, 14 HP Command Pro Commercial Engine.
- Demolishes stumps with 9 Carbide teeth cutting 3½ inches wide per cut.
- Cuts any diameter stump 12 inches above and 9 inches below ground.
- Extreme duty 2x2 axle with dual locking hitch pins for trouble free wheel brakes and transport over rough terrain.
- ATV-locking tires (Off-road only)
- Key shut-off
- Locking throttle
- Drop Stand
- Solid bar lift handles
- Includes 3 year KOHLER® Commercial warranty and 1 year DK2 Chassis warranty

### DESCRIPTION

Powered by 14HP KOHLER® Command PRO commercial engine. Mounted on a Heavy Duty welded 2x2 Steel, solid frame structurally engineered for endurance performance. Extreme duty 2x2 axle with dual locking hitch pins for trouble free wheel brakes and transport over rough terrain. Direct Power Drive delivers 3600RPM and 22.7 Gross Torque FT lb to a 12 inch solid steel cutting wheel mounted on premium pillar bearings. Demolishes stumps with 9 Carbide teeth cutting 3½ inches wide per cut. Cuts any diameter stump 12" above and 9 in below ground. Designed and manufactured for Strength, Durability and Performance. Features Key shut-off, locking throttle, drop stand, solid bar lift handles.

### SPECIFICATION

<b>ENGINE</b>	KOHLER CH440 14 HP Command Pro Commercial
<b>RATED SPEED</b>	3600 RPM
<b>TIRES</b>	ATV-Locking Heavy Duty Axle <b>OFF-ROAD ONLY</b>
<b>WHEELBASE</b>	32"
<b>STUMP DIAMETER / HEIGHT MAX</b>	Any Diameter 12" High
<b>CUTTING BLADES</b>	9 Dual Carbide Cast Mounted Cutters
<b>CUTTING WIDTH</b>	3 ½" Cutting Path
<b>GEARBOX</b>	Direct Drive Dual Belts
<b>WARRANTY</b>	3 Year Engine 1 Year Chassis
<b>DIMENSIONS</b>	91" x 32" x 52"
<b>WEIGHT</b>	234 lb
<b>SHIPPING DIMENSIONS</b>	43" x 23" x 25"
<b>SHIPPING WEIGHT</b>	275 lb



**9 DIRECT DRIVE CARBIDE TEETH**



**DUAL LOCKING ATV TIRES  
OFF-ROAD ONLY**



**ADJUSTABLE HEAVY DUTY  
MOUNTED BOW HANDLE**



**TOW BAR INCLUDED**

**OFF-ROAD ONLY  
MAX SPEED 15 MPH**





## 14 INCH STUMP GRINDER

### ITEM NUMBER

OPG888E

25

### UPC

827518006719

### DESCRIPTION

The OPG888E is a 14 inch 12 cutter commercial performance stump grinder.

Equipped with a KOHLER® CH440 14 HP Command Pro Commercial engine, and the ability to perform 4 inch wide cuts with 12 carbide high speed direct drive teeth. Heavy duty under carriage, ATV wheels. Removable flip bar for towing or easy trolley to and from the work site. New operator controlled Posi-lok wheel brake for pivot grinding. Comfort bow handle with CE safety approved hands off shut down. Demolishes any diameter stump up to 14 inches above and 10 inches below ground.

### SPECIFICATION

<b>ENGINE MODEL</b>	KOHLER CH440
<b>ENGINE</b>	14 HP 3600 RPM Command Pro Commercial
<b>TIRES</b>	ATV Wheels (13.75D x 5.25W 145/70-6) <b>OFF-ROAD ONLY</b>
<b>WHEELBASE</b>	48"
<b>TREE DIAMETER</b>	6.25"
<b>CUTTING BLADES</b>	Dual Reversible Double Edge
<b>CHIPPER</b>	Auto Adjusting 6" to 1/8" Materials
<b>GEARBOX</b>	Dual Direct Drive
<b>EXPULSION CHUTE</b>	Adjustable 180° 59" Pickup Bed Height
<b>DIMENSIONS</b>	102" x 47" x 59"
<b>WEIGHT</b>	594 lb
<b>SHIPPING DIMENSIONS</b>	45" x 31" x 48"
<b>SHIPPING WEIGHT</b>	726 lb
<b>WARRANTY</b>	3 Year Engine 1 Year Chassis



**12 HIGH-SPEED CARBIDE CUTTERS**



**DUAL DIRECT V-BELT 3600 RPM DRIVE**



**ADJUSTABLE BOW HANDLE**



**ATV WHEELS ON HEAVY DUTY AXLE OFF-ROAD ONLY**

### FEATURES

- Powered by a KOHLER® CH440 14 HP Command Pro Commercial Engine.
- Performs 4 inch wide cuts with 12 carbide high-speed direct drive teeth
- Heavy duty under carriage
- ATV wheels on a heavy-duty axle (Off-road only)
- Removable flip-bar
- New operator controlled Posi-lok wheel brake for pivot grinding
- Comfort bow handle with CE safety approved hands off shut-down
- Demolishes any diameter stump up to 14 inches above and 10 inches below ground
- 12V battery included
- Includes 3 year KOHLER® Commercial warranty and 1 year DK2 Chassis warranty

**OFF-ROAD ONLY  
MAX SPEED 15 MPH**



## 18 INCH TRENCHER

### ITEM NUMBERS

OPT118

### UPC

826518005586

26



### DESCRIPTION

The DK2 18 inch trencher is powered by a KOHLER® CH270 7 HP Command Pro Commercial Engine. This unit comes equipped with 21 high pressure sintered tungsten carbide cutters that are mounted on a 63 inch chain and spin at 400 RPM.

The OPT118 can trench at 200 feet per hour and provides an aggressive 10.5 feet per pound of torque that easily digs 4 inch wide trenches. Features an adjustable leveling handle, axle auto lock when in reverse, quick all position depth change, quick change teeth with 3/8" plow plates.

### SPECIFICATION

<b>ENGINE</b>	KOHLER CH270 7 HP Command Pro Commercial
<b>RATED SPEED</b>	4000 RPM
<b>CHAIN SPEED</b>	1800 ft/min
<b>CHAIN DIMENSION</b>	63"
<b>TRENCH</b>	4" x 18"
<b>CUTTING TEETH &amp; SPEED</b>	21 Carbide Alloy High Pressure Teeth @ 400 RPM
<b>GEARBOX</b>	Dual Belt Chain Drive Auger
<b>AUGER</b>	Side Offload Direct Drive
<b>TIRES</b>	Dual Auto Lock in Reverse
<b>DIMENSIONS</b>	95" x 47" x 59"
<b>WEIGHT</b>	335 lb
<b>SHIPPING DIMENSIONS</b>	41" x 30" x 33"
<b>SHIPPING WEIGHT</b>	362
<b>WARRANTY</b>	3 Year Engine 1 Year Chassis



**TRI-CUT HIGH CARBIDE  
TEETH**



**DUAL AUTO LOCK IN  
REVERSE TIRES**



**DIRECT CHAIN DRIVE**



**ADJUSTABLE LEVELING  
HANDLE**

### FEATURES

- Powered by a KOHLER® CH270 7 HP Command Pro Commercial Engine.
- Direct chain drive trencher chain and auger
- High pressure sintered carbide teeth
- 5 depth positions
- Dual locking wheels for digging in reverse
- 3/8" plow plates with quick change teeth
- Adjustable handle
- 6 inch direct drive auger
- Heavy gauge steel construction
- 4000 RPM direct drive with 400 RPM tri-cut teeth chain drive at 200 feet per hour dig rate
- Release and stop safety hand grip
- Includes 3 year KOHLER® Commercial warranty and 1 year DK2 Chassis warranty





## 40-TON KINETIC LOG SPLITTER

### ITEM NUMBERS

OPS240

27

### UPC

826518005746



### DESCRIPTION

Introducing the DK2 POWER OPS240 40-Ton Kinetic Log Splitter, powered by the KOHLER® CH270 7 HP Command Pro Commercial Engine for outstanding performance. Equipped with an oversized reinforced steel work table, safety lockout and a clam shell quick access body for easy use and maintenance. The OPS240 has an 8 inch expansion wedge and an auto-retracting bearing-guided ram to crush through logs up to 22 inches in diameter and up to 22 inches in length. Keep yourself safe while working with its extended stability stand and ATV locking wheels, keeping the splitter securely in place.

### SPECIFICATION

<b>ENGINE</b>	KOHLER CH270 7 HP Command Pro Commercial
<b>RATED SPEED</b>	4000 RPM
<b>TIRES</b>	ATV-Locking Heavy Duty Axle <b>OFF-ROAD ONLY</b>
<b>MAX LOG DIA. &amp; LENGTH</b>	22" x 22"
<b>CUTTING WEDGE</b>	8" Steel Wedge
<b>CYCLE TIME</b>	1 Second
<b>WARRANTY</b>	3 Year Engine 1 Year Chassis
<b>DIMENSIONS</b>	120" x 44" x 37"
<b>WEIGHT</b>	616 lb



**QUICK-RELEASE CLAM SHELL BODY**



**OVERSIZED STEEL WORKTABLE**



**AUTO-RETRACTING BEARING GUIDED RAM**



**FITS ON A 2" HITCH RECEIVER**

### FEATURES

- Powered by a KOHLER® Command Pro Commercial CH270 7 HP Engine
- 8" solid steel expansion wedge
- Oversized steel worktable with quad-log slides
- H-beam height sits at 25"
- 40-ton kinetic, heat-treated ram with bearing glide force and auto-retraction
- Extended stability stand
- ATV locking wheels (Off-road only)
- Fits on a 2" hitch receiver for easy towing
- Quick-release clam shell body for easy access to interior of the unit
- Safety lock out
- Super-quick 1 second cycling time
- Includes 3 year KOHLER® Commercial warranty and 1 year DK2 Chassis warranty

**OFF-ROAD ONLY  
MAX SPEED 15 MPH**



## 1100 LB HYDRAULIC ELECTRIC DUMP CART

28



### ITEM NUMBER

OPD811

### UPC

826518005722

### DESCRIPTION

With a wet bucket for sand, gravel, concrete and more, the DK2 POWER OPD811 self-drive electric powered hydraulic dump cart runs for up to 6 hours on one charge and moves it all. Equipped with a hydraulic electric lift, this unit is capable of tipping its wet bucket to 90° vertically for easy unloading. The OPD811 comes with throttle bar speed control and articulated floating rear wheels to keep your load level and steady, while moving around the job site is effortless with forward and reverse speeds of 6 MPH and dual front wheel drive to climb over rough terrain with ease.

### SPECIFICATION

<b>MAX CAPACITY</b>	1100 lb
<b>MAX SPEED</b>	6 MPH
<b>CHARGE TIME</b>	5 Hours
<b>RUN TIME</b>	6 Hours
<b>TIRES</b>	All-terrain
<b>WARRANTY</b>	1 Year Chassis
<b>DIMENSIONS</b>	85" x 46" x 42"
<b>WEIGHT</b>	572 lb
<b>SHIPPING DIMENSIONS</b>	54" x 32" x 35"
<b>SHIPPING WEIGHT</b>	616 lb



1100 LB MAX CAPACITY



6 MPH MAX SPEED



ALL-TERRAIN TIRES



90° VERTICAL DUMP

### FEATURES

- All-terrain tires, electric drive up to 6 MPH and dual front wheel drive to move effortlessly around job sites.
- Hydraulic electric lift cylinder to tip bucket to 90° vertical for easy unloading.
- Throttle bar speed control with articulated floating rear wheels keep your load level and steady.
- Improved "magic brake" system to brake upon the release of the brake handle, making your hauls safe and secure.





**DK** **ETRAILERS**<sup>®</sup>











## 4 x 6 LANDSCAPE TRAILER

### ITEM NUMBER

MMT4X6

### UPC

826518004831

32



### DESCRIPTION

The “little brother” of the best-selling DK2 MMT5X7 is specially designed for handling a variety of hauling tasks. This trailer is the perfect solution for anyone needing to pull a trailer behind a small vehicle, full size truck, law tractor, or ATV. The trailers are engineered to provide exceptional balance and ease of mobility without giving up one ounce of payload capacity. Every trailer is made from 100% welded tubular steel with expanded steel decks. Our back gate design is multi-purpose and can sit flat in the bed, up in a vertical position, or lying down as a ramp for easy loading.

### SPECIFICATION

<b>PAYLOAD CAPACITY</b>	1,295 lb
<b>GVW</b>	1,600 lb
<b>CURB WEIGHT</b>	305 lb
<b>BED DIMENSIONS</b>	48" x 72"
<b>OVERALL LENGTH</b>	152" (Tongue Extended)
<b>FLOOR HEIGHT</b>	18"
<b>CONSTRUCTION</b>	Fully Welded Heavy Duty Tubular Steel
<b>SIDE PANELS</b>	Solid Sides
<b>FLOATING RAMP GATE</b>	36" Reinforced Square Tube Steel Ramp with Heavy Duty Round Tube Exterior
<b>LIGHTING</b>	Pre-Wired, Quick Connect LED Lighting, Uses D.O.T. Standards
<b>HITCH HEIGHT</b>	14"
<b>FLOORING</b>	100% Welded, Corrugated Steel Floor Panel
<b>SHIPPING DIMENSIONS</b>	78" x 52" x 9"
<b>SHIPPING WEIGHT</b>	305 lb



DRIVE-UP GATE



SHIPS IN A SINGLE CARTON



SHIPS IN A STACK OF 10

### FEATURES

- Capacity: 1,295 lb
- Fully welded heavy-duty powder-coated steel frame
- Corrugated steel floor & solid side and front panels / rails
- Solid square tube cambered axle
- Drive-up rear ramp tailgate
- 2 position dump bed axle mount with quick release lock pin
- Hitch Height: 16 inches
- Heavy-duty tail light protectors
- LED quick connect lighting with side markers
- Wheel Diameter: 12 inches
- Wheel Bolt Pattern: 5 on 4-1/2"
- Tire Size: 4.80-12
- Load Range: C
- Assembly required
- 2 inch coupler

### 3-IN-1 UTILITY TRAILER

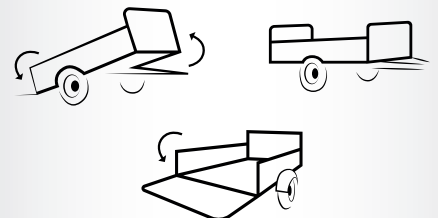

## 4 x 6 OPEN RAIL LANDSCAPE TRAILER

### ITEM NUMBER

MMT4X60

33

### UPC

826518005623



### DESCRIPTION

The “little brother” of the best-selling DK2 MMT5X7 is specially designed for handling a variety of hauling tasks. This trailer is the perfect solution for anyone needing to pull a trailer behind a small vehicle, full size truck, law tractor, or ATV. The trailers are engineered to provide exceptional balance and ease of mobility without giving up one ounce of payload capacity. Every trailer is made from 100% welded tubular steel with expanded steel decks. Our back gate design is multi-purpose and can sit flat in the bed, up in a vertical position, or lying down as a ramp for easy loading.

### SPECIFICATION

<b>PAYLOAD CAPACITY</b>	1,295 lb
<b>GVW</b>	1,600 lb
<b>CURB WEIGHT</b>	305 lb
<b>BED DIMENSIONS</b>	48" x 72"
<b>OVERALL LENGTH</b>	152" (Tongue Extended)
<b>FLOOR HEIGHT</b>	18"
<b>CONSTRUCTION</b>	Fully Welded Heavy Duty Tubular Steel
<b>SIDE PANELS</b>	Solid Sides
<b>FLOATING RAMP GATE</b>	36" Reinforced Square Tube Steel Ramp with Heavy Duty Round Tube Exterior
<b>LIGHTING</b>	Pre-Wired, Quick Connect LED Lighting, Uses D.O.T. Standards
<b>HITCH HEIGHT</b>	14"
<b>FLOORING</b>	100% Welded, Corrugated Steel Floor Panel
<b>SHIPPING DIMENSIONS</b>	78" x 52" x 9"
<b>SHIPPING WEIGHT</b>	305 lb



DRIVE-UP GATE



SHIPS IN A SINGLE CARTON



SHIPS IN A STACK OF 10

### FEATURES

- Capacity: 1,295 lb
- Fully welded heavy-duty powder-coated steel frame
- Corrugated steel floor & solid side and front panels / rails
- Solid square tube cambered axle
- Drive-up rear ramp tailgate
- 2 position dump bed axle mount with quick release lock pin
- Open rail design
- Hitch Height: 16 inches
- Heavy-duty tail light protectors
- LED quick connect lighting with side markers
- Wheel Diameter: 12 inches
- Wheel Bolt Pattern: 5 on 4-1/2"
- Tire Size: 4.80-12
- Load Range: C
- Assembly required
- 2 inch coupler

### 3-IN-1 UTILITY TRAILER

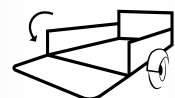

## FOLDING 4 x 8 TRAILER

### ITEM NUMBER

MFT4X8

### UPC

827518007150

34



### DESCRIPTION

The trailer you've always needed has arrived with the DK2 MFT4x8 Folding Trailer Kit. High-performing, durable and versatile, this trailer is ready for work. Built with a patented welded steel frame and deck for added strength and easy assembly, you'll spend less time reading manuals and more time on the road. For increased safety and secure storage, the DK2 MFT is coated with high-performance anti-slip textured UV powder, all while maintaining its complete folding functionality. When it comes to trailers – there's truly nothing like it.

### SPECIFICATION

<b>PAYLOAD CAPACITY</b>	1,450 lb
<b>GVW</b>	1,720 lb
<b>CURB WEIGHT</b>	262 lb
<b>BED DIMENSIONS</b>	48" x 96"
<b>FOLDED DIMENSIONS</b>	74" x 65" x 25"
<b>RIM SIZE</b>	12" x 4"
<b>TIRES</b>	5.30-12 6 Ply
<b>TIRE PRESSURE</b>	80 PSI Cold
<b>CONSTRUCTION</b>	Black UV-Powder Coated Steel
<b>TORQUE</b>	85-90 ft/lb
<b>AXLE</b>	Square Cambered
<b>HUB</b>	Cast Iron Dia. 5.6"
<b>LIGHTING</b>	Pre-Wired LED
<b>SHIPPING DIMENSIONS</b>	49" x 63" x 8"
<b>SHIPPING WEIGHT</b>	300 lb



COMPACT FOLDING DESIGN



SHIPS IN A SINGLE CARTON



SHIPS IN A STACK OF 10

### FEATURES

- Overall assembled length is 138 inches and overall width is 64 inches
- Payload capacity is 1,450 with a 1,720 lb maximum GVWR
- Includes two 5.30-12 6 ply tires
- Pre-wired LED light kit with flat 4-wire harness and connector
- Safety chain with S-hook, and a 2 inch coupler
- Designed to fit in compact spaces when not in use
- Trolley wheels included when standing for easy stowaway transport
- Pocket holes for DIY rails or for tubular steel rails
- Certificate of origin for registering and licensing is included





## 5-IN-1 MULTI-UTILITY 5 x 7 TRAILER

### ITEM NUMBER

MMT5X7

35

### UPC

826518003391



### DESCRIPTION

The single axle multi-utility trailer from DK2 is one of the most versatile trailer on the market. Sitting on a solid square tube cambered axle with 30.5 cm (12 in.) 6 ply bias tires, and a load capacity of 1,639 lb (743.4kg). When the front and back load-bearing gates are down, the trailer bed extends to nearly 3.5m (11.58 ft.). Another great feature is the tilt/dump capability that makes it easy to load or unload heavy items. Fabricated from 100% steel, all of the components are reinforced, adjustable, removable and / or interchangeable.

### SPECIFICATION

<b>PAYLOAD CAPACITY</b>	1,639 lb
<b>GVW</b>	2,090 lb
<b>CURB WEIGHT</b>	451 lb
<b>BED DIMENSIONS</b>	52" x 88" → 52" x 136"
<b>OVERALL LENGTH</b>	177" (Tongue Extended)
<b>FLOOR HEIGHT</b>	20"
<b>CONSTRUCTION</b>	Fully Welded Heavy Duty Tubular Steel
<b>SIDE PANELS</b>	14" Height Corrugated Steel
<b>DROP GATES</b>	24" Height Corrugated Steel
<b>LIGHTING</b>	Pre-Wired, Quick Connect LED Lighting, Uses D.O.T. Standards
<b>DUMP BED</b>	2 Position
<b>HITCH HEIGHT</b>	16"
<b>FLOORING</b>	100% Welded, Corrugated & Reinforced Steel Bed
<b>SHIPPING DIMENSIONS</b>	89" x 55" x 9"
<b>SHIPPING WEIGHT</b>	460 lb



### ACCESSORIES AVAILABLE



### LOAD BEARING GATES



### SHIPS IN A SINGLE CARTON



### SHIPS IN A STACK OF 10

### FEATURES

- Back drop gate
- 100% Steel
- Heavy duty
- Best in class
- Exclusive design
- Extended bed length: nearly 12 feet
- 2 position dump bed
- Quick release lock pin
- Load bearing gates
- Removable steel side panels
- Corrugated steel floor
- 100% welded tubular steel frame
- Heavy-duty tail light protectors
- Solid square tube cambered axle
- Easy-lube 5 on 4.5 hub assembly
- V tongue for added strength
- 2 inch coupler with safety chains
- 12 x 5.3 - 6 ply tires

## 5-IN-1 UTILITY TRAILER

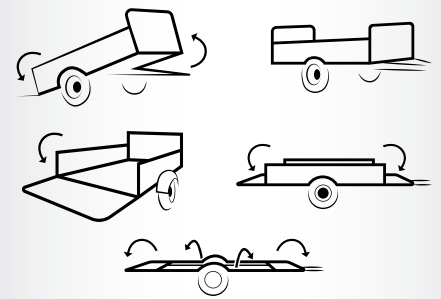

## 5-IN-1 MULTI-UTILITY 5 x 7 DRIVE-UP GATE TRAILER

### ITEM NUMBER

MMT5X7-DUG

### UPC

826518005296

36



### DESCRIPTION

The single axle multi-utility trailer from DK2 is one of the most versatile trailer on the market. Sitting on a solid square tube cambered axle with 30.5 cm (12 in.) 6 ply bias tires, and a load capacity of 1,639 lb (743.4kg). This trailer comes equipped with a convenient drive-up gate so you can load and unload with ease. Another great feature is the tilt/dump capability that makes it easy to load or unload heavy items. Fabricated from 100% steel, all of the components are reinforced, adjustable, removable and / or interchangeable.

### SPECIFICATION

<b>PAYLOAD CAPACITY</b>	1,639 lb
<b>GVW</b>	2,090 lb
<b>CURB WEIGHT</b>	451 lb
<b>BED DIMENSIONS</b>	52" x 88" → 52" x 136"
<b>OVERALL LENGTH</b>	177" (Tongue Extended)
<b>FLOOR HEIGHT</b>	20"
<b>CONSTRUCTION</b>	Fully Welded Heavy Duty Tubular Steel
<b>SIDE PANELS</b>	14" Height Corrugated Steel
<b>DROP GATES</b>	24" Height Corrugated Steel
<b>LIGHTING</b>	Pre-Wired, Quick Connect LED Lighting, Uses D.O.T. Standards
<b>DUMP BED</b>	2 Position
<b>HITCH HEIGHT</b>	16"
<b>FLOORING</b>	100% Welded, Corrugated & Reinforced Steel Bed
<b>SHIPPING DIMENSIONS</b>	89" x 55" x 9"
<b>SHIPPING WEIGHT</b>	460 lb



ACCESSORIES AVAILABLE



DRIVE-UP GATE



SHIPS IN A SINGLE CARTON



SHIPS IN A STACK OF 10

### FEATURES

- Back drop gate
- 100% Steel
- Heavy duty
- Best in class
- Exclusive design
- Drive-up gate for easy loading / unloading
- 2 position dump bed
- Quick release lock pin
- Load bearing gates
- Removable steel side panels
- Corrugated steel floor
- 100% welded tubular steel frame
- Heavy-duty tail light protectors
- Solid square tube cambered axle
- Easy-lube 5 on 4.5 hub assembly
- V tongue for added strength
- 2 inch coupler with safety chains
- 12 x 5.3 - 6 ply tires

## 5-IN-1 UTILITY TRAILER

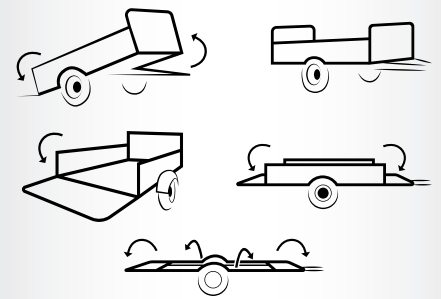



# 5-IN-1 MULTI-UTILITY 5 x 7 GALVANIZED DRIVE-UP GATE TRAILER

## ITEM NUMBER

MMT5X7G-DUG

37

## UPC

826518005302



## DESCRIPTION

The new addition to the DK2 trailer line up is the Hot Dipped Galvanized 5x7 Utility Trailer. Constructed from 100% steel all the components are reinforced, adjustable, removable or interchangeable. The MMT5X7G-DUG is fully welded and hot dipped galvanized to protect the steel from the elements especially in coastal regions. This unit offers the end user excellent value for their money and will dramatically add to the life of the trailer kit. Each trailer ships in a single carton including pre wired LED lighting for easy installation.

## SPECIFICATION

<b>PAYLOAD CAPACITY</b>	1,639 lb
<b>GVW</b>	2,090 lb
<b>CURB WEIGHT</b>	451 lb
<b>BED DIMENSIONS</b>	52" x 88" → 52" x 136"
<b>OVERALL LENGTH</b>	177" (Tongue Extended)
<b>FLOOR HEIGHT</b>	20"
<b>CONSTRUCTION</b>	Fully Welded Hot-Dipped Galvanized Tubular Steel
<b>SIDE PANELS</b>	14" Height Corrugated Steel
<b>DROP GATES</b>	24" Height Corrugated Steel
<b>LIGHTING</b>	Pre-Wired, Quick Connect LED Lighting, Uses D.O.T. Standards
<b>DUMP BED</b>	2 Position
<b>HITCH HEIGHT</b>	16"
<b>FLOORING</b>	100% Welded, Corrugated & Reinforced Steel Bed
<b>SHIPPING DIMENSIONS</b>	89" x 55" x 9"
<b>SHIPPING WEIGHT</b>	460 lb



ACCESSORIES AVAILABLE



DRIVE-UP GATE



SHIPS IN A SINGLE CARTON



SHIPS IN A STACK OF 10

## FEATURES

- Back drop gate
- 100% Steel
- Heavy duty
- Best in class
- Exclusive design
- Drive-up gate for easy loading / unloading
- 2 position dump bed
- Quick release lock pin
- Load bearing gates
- Removable steel side panels
- Corrugated steel floor
- 100% welded hot-dipped galvanized tubular steel frame
- Heavy-duty tail light protectors
- Solid square tube cambered axle
- Easy-lube 5 on 4.5 hub assembly
- V tongue for added strength
- 2 inch coupler with safety chains
- 12 x 5.3 - 6 ply tires

## 5-IN-1 UTILITY TRAILER

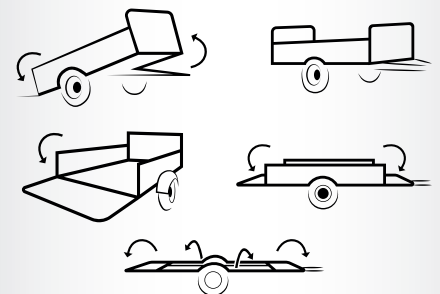

# DIAMOND & ACCESSORIES







## TRUNK MOUNTED ALUMINUM 3-BIKE CARRIER

### ITEM NUMBER

BCR190

### UPC

827518007129

40



### DESCRIPTION

Just because you don't have a receiver hitch on your vehicle doesn't mean you can't take your bikes with you. The DK2 BCR190 allows you to strap our carrier to the trunk of your car or small SUV and haul up to 3 bikes with you. Adjustable for most makes and model of vehicles and easy to assemble. Soft rubber cradles and strap allow you to secure the bikes to the carrier without managing the finish or performance of your bicycles. Six adjustable straps will securely hold the bikes in place for whatever trip you take!

### SPECIFICATION

<b>CONSTRUCTION</b>	UV Resistant Lightweight Aluminum
<b>COMPATIBILITY</b>	Mountain Bikes and Road Bikes
<b>MOUNT STYLE</b>	Trunk Mounted
<b>DIMENSIONS</b>	29" x 18" x 29"
<b>WEIGHT</b>	8 lb
<b>SHIPPING DIMENSIONS</b>	19.5" x 34" x 6"
<b>SHIPPING WEIGHT</b>	11 lb

### FEATURES

- UV resistant lightweight aluminum construction
- Extreme temperature resistance
- Mounts to the trunk of most cars or small SUV's
- Carries up to three bicycles
- Frame straps are easy to use and long lasting
- Folding adjuster allows you to fold your rack away when not in use
- Gross Weight: 11 lb
- Net Weight: 8 lb
- 1 year limited warranty



**FOLDING ADJUSTER**



**ATTACHMENT STRAPS**



**FRAME STRAPS**



## HITCH MOUNTED 4-BIKE CARRIER

### ITEM NUMBER

BCR290

41

### UPC

827518007136



### DESCRIPTION

The DK2 Hitch Mounted Bike Carrier is the perfect way to transport your bicycles on those long road trips. Quick and easy assembly takes only minutes. The BCR290 is constructed of UV power coated steel to help resist damage from harsh weather conditions. Simply slide the bike carrier into your 2 inch receiver hitch and secure using the anti wobble hitch pin. No mark straps allow you to secure up to 4 bikes to your carrier for transportation. The carrier also tilts away for easy access to your trunk.

### SPECIFICATION

<b>CONSTRUCTION</b>	Powder Coated Steel
<b>COMPATIBILITY</b>	Mountain Bikes and Road Bikes
<b>MOUNT STYLE</b>	Hitch-Mounted
<b>DIMENSIONS</b>	35" x 12" x 35"
<b>WEIGHT</b>	20 lb
<b>SHIPPING DIMENSIONS</b>	22.5" x 14" x 3.75"
<b>SHIPPING WEIGHT</b>	23.2 lb

### FEATURES

- Powder coated steel construction
- Easy to assemble
- Can be folded when not in use
- Can open trunk while unit is mounted on your vehicle
- Mounts up to 4 bicycles
- Fits any 2 inch hitch receiver
- Frame straps are easy to use and durable
- 1 year limited warranty



FITS ANY 2" RECEIVER



EASY TO ASSEMBLE



FRAME STRAPS





## HITCH-MOUNTED 2-BIKE PLATFORM CARRIER

### ITEM NUMBER

BCR590

### UPC

827518007112

42

### DESCRIPTION

The DK2 Hitch Mounted BCR590 Bike Carrier fits into either a 1-1/4" or 2" receiver hitch. This unit allows you to transport two bicycles by securing them to carrier. The BCR590 adjusts in width and height to fit your bike while making sure the no mark straps do not damage the finish of your bike. The carrier folds up when not in use and the center arm can fold down to allow access to the rear of the vehicle without removing the rack. Light weight and easy to assemble the BCR590 is the perfect solution for those long road trips!

### SPECIFICATION

<b>CONSTRUCTION</b>	UV-Powder Coated Steel
<b>COMPATIBILITY</b>	Mountain Bikes and Road Bikes
<b>MOUNT STYLE</b>	Hitch-Mounted
<b>DIMENSIONS</b>	53" x 39" x 20"
<b>WEIGHT</b>	28 lb
<b>SHIPPING DIMENSIONS</b>	40" x 10.5" x 5.5"
<b>SHIPPING WEIGHT</b>	30 lb

### FEATURES

- Easily adjustable to all frame sizes
- Transports up to 2 bicycles with a more secure, platform design
- Fits on to a 1-1/4" or 2" hitch receiver
- Safe bike holder with adjustable height
- Can adjust the rack according to the bike tire size and secure with rubber straps
- UV-Powder coated steel construction
- Folding center arm allows for easy rear vehicle access
- 1 year limited warranty



FITS 1-1/4" AND  
2" HITCH



ADJUSTABLE  
BIKE HOLDER



ADJUSTABLE TIRE RACKS WITH  
SECURE RUBBER STRAPS



## HITCH-MOUNTED E-BIKE HAULER

### ITEM NUMBER

BCR690E

43

### UPC

827518008003



### DESCRIPTION

Adventure knows no bounds with the DK2 BCR690E E-Bike Hauler. Built to conveniently load 2 bikes of any size, you and a friend or family member can ride off-road, in the city, or wherever your journey takes you. With effortless loading capabilities and a revolutionary pivot feature that gives you access to your tailgate or hatchback, your only concern will be where to go next.

### SPECIFICATION

<b>CONSTRUCTION</b>	Powder Coated Steel
<b>COMPATIBILITY</b>	Most E-Bikes, Mountain Bikes, Road Bikes & Fat Tire Bikes
<b>TIRE SIZE COMPATIBILITY</b>	40.6 cm - 73.6 cm 15.9" - 28.9"
<b>MAX TIRE WIDTH</b>	12.1 cm / 4.7"
<b>FOLDED DIMENSIONS</b>	157 cm (l) x 108 cm (w) x 42 cm (h) >> 85 cm (depth from vehicle hitch) 61.8 in (l) x 42.5 in (w) x 16.5 in (h) >> 33.4 in (depth from vehicle hitch)
<b>UNFOLDED DIMENSIONS</b>	157 cm (l) x 108 cm (w) x 110 cm (h) >> 85 cm (depth from vehicle hitch) 61.8 in (l) x 42.5 in (w) x 43.3 in (h) >> 33.4 in (depth from vehicle hitch)
<b>WEIGHT</b>	20 kg / 44 lb
<b>RACK WEIGHT CAPACITY</b>	32.8 kg / 72.3 lb
<b>TOTAL WEIGHT CAPACITY</b>	65.7 kg / 144.8 lb
<b>RECEIVER</b>	Fits on a 5 cm / 2" Hitch Receiver

### FEATURES

- Heavy-duty powder coated steel construction
- Fits over a 2" hitch receiver
- Padded universal top clamp
- Adjustable base to fit most size tires
- Effortless loading and unloading
- Safely hauls up to 2 bicycles, including e-bikes, mountain bikes, road bikes, and fat tire bikes
- Super compact folding capability for easy storage
- Access your hatch or tailgate while the hauler is attached



**COMPACT FOLDING CAPABILITIES FOR EASY STORAGE AND REAR VEHICLE ACCESS**



**HOLDS UP TO 2 BIKES**





## HITCH-MOUNTED STEEL CARGO CARRIER

### ITEM NUMBER

HCC602

### UPC

827518001165

44



### DESCRIPTION

The DK2 hitch-mounted black powder coated steel cargo carrier allows you to immediately increase the cargo capacity of your vehicle so you can haul bulky, messy items like luggage, coolers or firewood.

This carrier has a 500 lb carrying capacity (with a Class III or IV hitch receiver) and also flips up against your vehicle when not in use.

### SPECIFICATION

<b>CONSTRUCTION</b>	Corrosion Resistant Black Powder Coated Steel
<b>MOUNT STYLE</b>	Hitch-Mounted
<b>MAX CAPACITY</b>	500 lb *With a Class III or IV Hitch Receiver
<b>DIMENSIONS</b>	60" x 20" x 6.5"
<b>WEIGHT</b>	47 lb
<b>SHIPPING DIMENSIONS</b>	32" x 22" x 10"
<b>SHIPPING WEIGHT</b>	51 lb

### FEATURES

- Increase the cargo capacity of your vehicle
- Easy to assemble
- Mounts to any 2 inch hitch receiver
- Flips up when not in use and stows against the rear of the vehicle
- Black powder coat finish resists corrosion
- Carries up to 500 lb dependent on receiver strength (recommended Class III or IV)
- Heavy duty tubular and expanded mesh steel construction



## HITCH-MOUNTED ALUMINUM CARGO CARRIER

### ITEM NUMBER

HCC502A

45

### UPC

826518005050



### DESCRIPTION

The DK2 hitch-mounted aluminum cargo carrier allows you to immediately increase the cargo capacity of your vehicle so you can haul bulky, messy items like luggage, coolers or firewood.

This carrier has a 500 lb carrying capacity (with a Class III or IV hitch receiver) and also flips up against your vehicle when not in use.

### SPECIFICATION

<b>CONSTRUCTION</b>	Lightweight Aluminum Construction Formed Steel Hitch & Hitch Bracket / Carbon Steel Hardware / Thermoplastic End Caps
<b>MOUNT STYLE</b>	Hitch-Mounted
<b>MAX CAPACITY</b>	500 lb *With a Class III or IV Hitch Receiver
<b>DIMENSIONS</b>	49.5" x 22.25" x 6.5"
<b>WEIGHT</b>	29 lb
<b>SHIPPING DIMENSIONS</b>	50" x 24" x 4"
<b>SHIPPING WEIGHT</b>	32 lb

### FEATURES

- Increase the cargo capacity of your vehicle
- Easy to assemble
- Mounts to any 2 inch hitch receiver
- Flips up when not in use and stows against the rear of the vehicle
- Aluminum finish resists corrosion
- Carries up to 500 lb dependent on receiver strength (recommended Class III or IV)
- Includes threaded anti-wobble hitch pin for added stability
- 11 reflectors for added safety
- Durable and lightweight aluminum construction





## HITCH-MOUNTED MOTORCYCLE CARRIER

### ITEM NUMBER

TMC201

### UPC

693495970561

46



### DESCRIPTION

For someone who doesn't want the hassles associated with towing a trailer, the hitch-mounted motorcycle carrier is the perfect option for you.

Since this carrier utilizes our patent-pending WedgeLock™ mounting system, it is rock solid and will keep your bike stable and secure. Now you can transport your bike with confidence and ease. This carrier works equally great with motorcycles, motocross & dual purpose bikes, scooters and mopeds.

### SPECIFICATION

<b>CONSTRUCTION</b>	UV-Powder Coated Steel
<b>MOUNT STYLE</b>	Hitch-Mounted
<b>DIMENSIONS</b>	55" x 21" x 7"
<b>WEIGHT</b>	86 lb
<b>SHIPPING DIMENSIONS</b>	56" x 21" x 7"
<b>SHIPPING WEIGHT</b>	89 lb

VEHICLE HITCH MANUFACTURER RATING	MAXIMUM CARRYING CAPACITY OF CARRIER
300 lb	180 lb
350 lb	225 lb
500 lb	350 lb
750 lb	500 lb

### FEATURES

- Extremely versatile, secure and stable: patent-pending design results in a snug anti-wobble fit
- Tilts down for easy loading and unloading
- Easily installed and removed - no extra tools required
- Ideally suited for SUV, RV, or pickup trucks with cap
- Features adjustable front wheel channel to accommodate different sized bikes
- Retractable tie-down bar
- Safety chains and hitch pin included
- Fits any standard 2 inch class III or IV hitch receiver (weight capacity dependent on receiver strength)
- UV-Powder coated steel construction



**DRX WARRIOR** 









Jeep



WARRIOR

WARRIOR

WARRIOR

WARRIOR



WARRIOR



# HOISTS

50

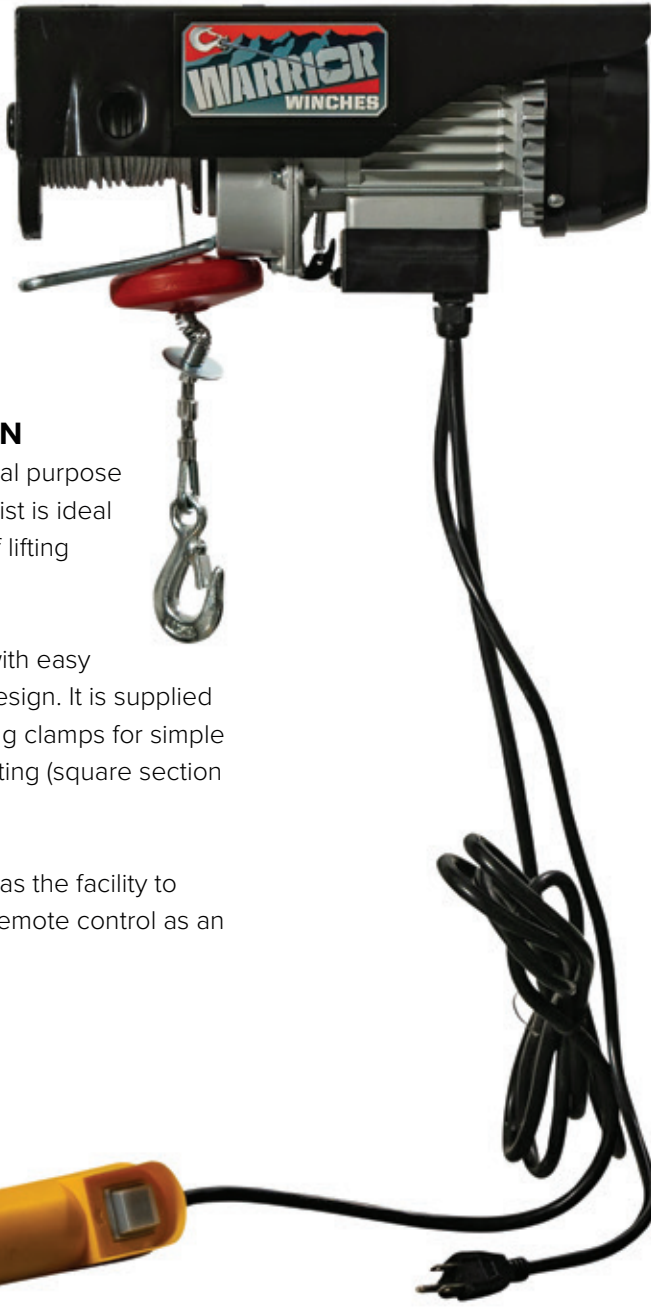

## DESCRIPTION

Compact, general purpose 120V electric hoist is ideal for all manner of lifting applications.

Easy to install, with easy change cable design. It is supplied with special fixing clamps for simple section beam fitting (square section beams).

This hoist also has the facility to add a wireless remote control as an option.

## DK2 WARRIOR HOISTS

### ITEM NUMBER / UPC

EH250 / 827518007303

EH500 / 827518007310

### SPECIFICATION

#### MODEL: EH250 (120V)

##### Max Load

Single Pull: 275 lb

Double Pull: 551 lb

##### Lift Speed p/min

Single Pull: 59 ft

Double Pull: 29 ft

**Cable:** 0.12" x 59 ft

**Rating:** IP54

#### MODEL: EH500 (120V)

##### Max Load

Single Pull: 551 lb

Double Pull: 1102 lb

##### Lift Speed p/min

Single Pull: 59 ft

Double Pull: 29 ft

**Cable:** 0.15" x 59 ft

**Rating:** IP54





## DESCRIPTION

Ideal for large ATVs and small trailers. A huge high power motor, heavy duty clutch, heavy duty steel gearing and heavy duty waterproof contactors ensure the ultimate in performance and reliability. Strengthened Steel drum makes it ideal to use with Synthetic Rope. Watertight 4 Pin connection allows the use of 'Plug and Play' Wireless.

## SPECIFICATION

C2500N		C3500N	
<b>RATED LINE PULL</b>	2,500 lb	<b>RATED LINE PULL</b>	3,500 lb
<b>MOTOR: 12V</b>	1.35 HP	<b>MOTOR: 12V</b>	1.95 HP
<b>GEARING</b>	170:1	<b>GEARING</b>	170:1
<b>BRAKING ACTION</b>	Dynamic	<b>BRAKING ACTION</b>	Dynamic
<b>DRUM SIZE DIA X L</b>	1.5" x 3.1"	<b>DRUM SIZE DIA X L</b>	1.5" x 3.1"
<b>CABLE SIZE DIA X L</b>	0.2" x 46 ft (WR) 0.2" x 46 ft (SR)	<b>CABLE SIZE DIA X L</b>	0.2" x 42 ft (WR) 0.2" x 46 ft (SR)
<b>MOUNT PATTERN</b>	3.1"	<b>MOUNT PATTERN</b>	3.1"
<b>DIMENSIONS</b>	13.2" x 4.6" x 6.5"	<b>DIMENSIONS</b>	13.7" x 4.6" x 6.5"



## NINJA SERIES ATV WINCHES

51

### ITEM NUMBER / UPC

C2500N / 826518004619  
 C2500N-SR / 826518005234  
 C3500N / 826518004626  
 C3500N-SR / 826518005241

### FEATURES

- Sealed high power motor
- Heavy duty watertight contactors
- Full steel planetary gearing
- Strengthened steel drum (suitable for synthetic rope)
- Watertight controller socket
- Gloss chip resistant paint

### INCLUDES

- Steel cable
- Heavy duty roller fairlead
- Heavy duty battery leads
- 3 ton pulley block
- Mounting plate and hardware
- 1/4 hook







52

## NINJA SERIES TRAILER WINCHES

### ITEM NUMBER / UPC

C4500N / 826518005258  
C4500N-SR / 826518005265

### DESCRIPTION

High quality three stage planetary gearing ensure this is one of the quietest and smoothest winches on the market. The silky smooth performance and the full load holding brake make it the perfect solution for high spec applications.

### SPECIFICATION

C4500N		LINE PULL (LB)	LINE SPEED (FT / MIN)	AMP DRAW	
				12V	24V
RATED LINE PULL	4,500 lb	0	11.6	20	15
MOTOR: 12V	1.95 HP	1,500	9.2	70	40
GEARING	172:1	2,500	7.8	100	65
BRAKING ACTION	Auto in the Drum	3,500	6.6	140	80
DRUM SIZE DIA X L	1.7" x 3.8"	4,500	4.9	200	130
CABLE SIZE DIA X L	0.25" x 47.5 ft (WR) 0.24" x 49 ft (SR)	LAYER OF WIRE ROPE		LINE PULL (LB)	
		1		4,500	
MOUNT PATTERN	5" x 3.7"	2		3,642	
DIMENSIONS	14.4" x 4.9" x 6.4"	3		3,060	
WEIGHT	28.6 lb	4		2,638	

### FEATURES

- Power in and power out
- High torque 1.95 HP motor
- Heavy duty waterproof contactors
- Full steel planetary gearing
- Mount plate as standard
- Full load holding break
- Can fit tow ball mount

### INCLUDES

- 0.25" x 47.5 ft steel cable
- 3m remote handset
- Heavy duty roller fairlead
- Heavy duty battery leads
- Mounting plate
- 3/8 hook
- \*ATV remote available

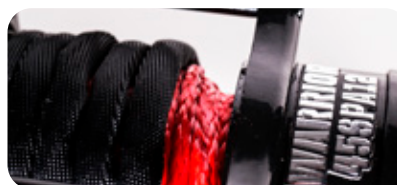

STEEL & SYNTHETIC VERSIONS AVAILABLE





## TROJAN SERIES PORTABLE UTILITY WINCH

53



### ITEM NUMBER / UPC

40PUS12 / 827518007402  
40PUA12 / 827518007396

### DESCRIPTION

The Trojan Portable Utility Winch is a complete winching solution in a convenient kit that features a 4,000 lb rated line pull winch on a unique powder coated winch platform, all in a compact, easy to carry composite tool box. The kit is easy to store, use, and repack. Completely portable, the Trojan requires no installation and does not require a winch mount; however, it can be permanently mounted on a trailer and be used as a utility winch if desired.

### SPECIFICATION

RATED LINE PULL	4,000 lb	LINE PULL	LINE SPEED	AMP DRAW
		(LB)	(FT / MIN)	12V
MOTOR: 12V	1.4 hp	0	20	20
GEARING	166:1	4,000	5.5	220
CABLE SIZE DIA X L	0.2" x 42' (WR) 0.2" x 49' (SR)			
DIMENSIONS	19.9" x 12" x 7.6"			
WEIGHT	45.2 lb			

### FEATURES

- 4,000 lb pulling power
- Synthetic or wire rope version available
- Built in 1/4 inch hardened steel plate
- Can be permanently mounted
- Quick plug and play functionality

### INCLUDES

- 6,000 lb pulley block
- Quick connect cord with alligator clips
- Three 20,000 lb D-shackles
- 2 x 8 ft heavy duty straps rated 8,000 lb
- 12 ft hand held remote
- 10 ft quick connect power cord
- Heavy duty leather palmed winch gloves







## SPARTAN 6,000 LB ELECTRIC WINCH

### ITEM NUMBER / UPC

6000 / 826518005173  
6000-SR / 827518006764

### DESCRIPTION

Warrior Winches are delighted to announce the arrival of the new member of Spartan Series, Tough, Strong and ready for Battle. The Spartan 6000 lb short drum model is ideal where space and payload are limited. The winch has a short drum and is less than 66Lbs, however the extended drum supports allow it to carrier up to 131ft of 0.28" cable. The Synthetic rope version comes fitted with 0.27" x 98ft.

We really believe these to be the best value for money Winches around, a lower price does not mean that we have had to compromise the core values integral to a good winch, such as reliability and durability.

With great performance, outstanding features included as standard, & backed by the Warrior Winches un-rivalled limited Lifetime Warranty, this should make a Spartan the first choice for all serious enthusiasts.

### FEATURES

- Weather sealed high performance motor
- Heavy duty 3 stage gearbox
- Heavy duty drum supports
- Full steel planetary gearing
- Full load holding brake
- Every winch is 100% load tested
- Chip resistant gloss paint finish

### SPECIFICATION

RATED LINE PULL	6,000 lb	LINE PULL	LINE SPEED	AMP DRAW
		LB	FT / MIN	12V
MOTOR: 12V	4.5 hp	0	19.4	80
		2,000	13.1	140
GEARING	230:1	4,000	9.2	210
		6,000	7.2	285
DRUM SIZE DIA X L	2.48" x 4.2"	LAYER OF WIRE ROPE	LINE PULL (LB)	CABLE CAP (FT)
CABLE SIZE DIA X L	0.28" x 131 ft (WR) 0.28" x 98 ft (SR)	1	6,000	9.8
		2	4,979	22
DIMENSIONS	17.4" x 7.7" x 10.8"	3	4,255	36.1
		4	3,714	52.2
WEIGHT	66 lb	5	3,296	70.5
		6	2,962	90.9
		7	2,690	113.2
		8	2,463	131.2

### INCLUDES

- 10 ft remote handset
- 5/16 hook
- Aluminum or roller fairlead (synthetic rope or steel cable)
- Heavy duty battery leads
- Stainless steel mounting hardware
- 0.27" x 98 ft synthetic rope or 0.28" x 131 ft steel cable



STEEL & SYNTHETIC VERSIONS AVAILABLE





## DESCRIPTION

The Spartan Series: Tough, Strong and ready for a Battle, these Winches really will challenge all before them. We have reluctantly termed them as 'entry level', however this describes the price point, not the performance.

We believe these to be the best value for money Winches around, a lower price does not mean that we have had to compromise the core values integral to a good winch, such as reliability and durability.

## SPECIFICATION

8000		9500	
<b>RATED LINE PULL</b>	8,000 lb	<b>RATED LINE PULL</b>	9,500 lb
<b>MOTOR: 12V</b>	4.6 hp	<b>MOTOR: 12V</b>	4.6 hp
<b>GEARING</b>	233:1	<b>GEARING</b>	230:1
<b>BRAKING ACTION</b>	Auto in the drum	<b>BRAKING ACTION</b>	Auto in the drum
<b>DRUM SIZE DIA X L</b>	2.5" x 8.8"	<b>DRUM SIZE DIA X L</b>	2.5" x 8.8"
<b>CABLE SIZE DIA X L</b>	0.3" x 85 ft (WR) 0.35" x 82 ft (SR)	<b>CABLE SIZE DIA X L</b>	0.36" x 82 ft (WR) 0.35" x 82 ft (SR)
<b>MOUNT PATTERN</b>	10" x 4.5"	<b>MOUNT PATTERN</b>	10" x 4.5"
<b>DIMENSIONS</b>	21.3" x 6.3" x 8.6"	<b>DIMENSIONS</b>	21.3" x 6.3" x 8.6"
12000			
<b>RATED LINE PULL</b>	12,000 lb		
<b>MOTOR: 12V</b>	6.0 hp		
<b>GEARING</b>	230:1		
<b>BRAKING ACTION</b>	Auto in the drum		
<b>DRUM SIZE DIA X L</b>	2.5" x 8.8"		
<b>CABLE SIZE DIA X L</b>	0.4" x 82 ft (WR) 0.43" x 82 ft (SR)		
<b>MOUNT PATTERN</b>	10" x 4.5"		
<b>DIMENSIONS</b>	22.8" x 6.3" x 8.6"		



## SPARTAN SERIES ELECTRIC WINCH

55

### ITEM NUMBER / UPC

8000 / 826518003148  
 8000-SR / 826518005197  
 9500 / 826518003155  
 9500-SR / 826518005203  
 12000 / 826518003162  
 12000-SR / 826518005210

### FEATURES

- Weather sealed high performance motor
- Heavy duty 3 stage gearbox
- Heavy duty drum supports
- Weather sealed solenoids
- Full steel planetary gearing
- Full load holding brake
- Every winch is 100% load tested
- Chip resistant gloss paint finish

### INCLUDES

- Galvanized steel cable
- 10 ft remote handset
- Heavy duty steel roller fairlead
- Heavy duty battery leads
- Stainless steel mounting hardware
- Clevis hook







## DESCRIPTION

Superb high specification winch. Ideal for recovery and 4x4 applications. Outstanding features include high quality series wound double sealed motor with brass fittings, heavy duty waterproof contactors, double sealed drum on maintenance free bearings, quiet, efficient full steel planetary gearing. Comes with stainless steel roller fairlead and fittings as standard. Complete with Heavy Duty integrated wireless remote. Available with Armortek Synthetic Rope and Aluminum Fairlead.

## SPECIFICATION

S8000		S9500	
RATED LINE PULL	8,000 lb	RATED LINE PULL	9,500 lb
MOTOR: 12V	4.6 hp	MOTOR: 12V	4.6 hp
GEARING	210:1	GEARING	230:1
BRAKING ACTION	Auto in the drum	BRAKING ACTION	Auto in the drum
DRUM SIZE DIA X L	2.5" x 8.8"	DRUM SIZE DIA X L	2.5" x 8.8"
CABLE SIZE DIA X L	0.3" x 95 ft	CABLE SIZE DIA X L	0.4" x 85 ft
MOUNT PATTERN	10" x 4.5"	MOUNT PATTERN	10" x 4.5"
DIMENSIONS	21.3" x 6.3" x 8.6"	DIMENSIONS	21.3" x 6.3" x 8.6"
S12000			
RATED LINE PULL	12,000 lb		
MOTOR: 12V	6.5 hp		
GEARING	230:1		
BRAKING ACTION	Auto in the drum		
DRUM SIZE DIA X L	2.5" x 8.8"		
CABLE SIZE DIA X L	0.4" x 85 ft		
MOUNT PATTERN	10" x 4.5"		
DIMENSIONS	22.8" x 6.3" x 8.6"		



## SAMURAI SERIES ELECTRIC WINCH

### ITEM NUMBER / UPC

S8000 / 826518003247  
 S8000-SR / 826518003179  
 S9500 / 826518003254  
 S9500-SR / 826518003186  
 S12000 / 826518003261  
 S12000-SR / 826518003193

### FEATURES

- All brass (no corrosion) series wound motor
- Double sealed motor
- Sealed waterproof contactor
- Steel contactor cover
- Double sealed drum (gearbox/ motor)
- Sealed 3 stage planetary gears
- Stainless steel 4 way fairleads
- Integrated wireless remote

### INCLUDES

- Galvanized steel cable
- 10 ft remote handset
- Heavy duty stainless steel fairlead
- Heavy duty battery leads
- Stainless steel mounting hardware
- Built-in wireless remote
- 5/16 hook





## SAMURAI 9,500 LB HIGH SPEED WINCH

### ITEM NUMBER / UPC

S9500HS / 826518003278  
S9500HS-SR / 826518003223

### DESCRIPTION

The ultimate winch for Extreme Terrain. Fully Sealed with an unbeatable line Speed of 65 ft/min. Outstanding features includes Huge 6.5 hp high quality double sealed motor with brass fittings, heavy duty waterproof contactors, double sealed drum on maintenance free bearings, quiet, fully sealed efficient full steel planetary gearing.

Complete with heavy duty integrated wireless remote. Available with Steel Rope or Armortek Synthetic Rope and Aluminum Fairlead.

### SPECIFICATION

		LINE PULL		LINE SPEED		AMP DRAW	
		LB		FT / MIN		12V	24V
RATED LINE PULL	9,500 lb	0		65		80	45
MOTOR: 12V	6.5 hp	4,000		12.5		300	175
GEARING	110:1	6,000		11.81		400	230
BRAKING ACTION	Auto in the drum	9,500		8.86		530	335
DRUM SIZE DIA X L	2.5" x 8.8"	LAYER OF WIRE ROPE		LINE PULL (LB)			
CABLE SIZE DIA X L	0.4" x 98 ft	1		9,500			
MOUNT PATTERN	10" x 4.5"	2		7,706			
DIMENSIONS	22.7" x 6.3" x 8.5"	3		6,482			
WEIGHT	90 lb	4		5,400			

### FEATURES

- Weather sealed high performance motor
- Heavy duty 3 stage gearbox
- Heavy duty drum supports
- Full steel planetary gearing
- Full load holding brake
- Every winch is 100% load tested
- Chip resistant gloss paint finish

### INCLUDES

- 10 ft remote handset
- 5/16 hook
- Aluminum or roller fairlead (synthetic rope or steel cable)
- Heavy duty battery leads
- Stainless steel mounting hardware
- 0.27" x 98 ft synthetic rope or 0.28" x 131 ft steel cable



STEEL & SYNTHETIC VERSIONS AVAILABLE







## SAMURAI 9,500 LB SHORT DRUM WINCH

### ITEM NUMBER / UPC

S9500SD / 826518003285  
S9500SD-SR / 826518003230

### DESCRIPTION

The narrow drum version of the best selling 9500. A total width of 17.2 inches ensures this is the perfect product for limited space. The 5.0hp motor delivers 9500lb of pulling power in space normally designed for Winches with half the power.

The Short Drum winch is the preferred choice of the British Military on specialist vehicles currently serving in action. Available with synthetic rope and aluminium fairlead, to give a total weight of 44 lbs.

### SPECIFICATION

		LINE PULL	LINE SPEED	AMP DRAW	
		LB	FT / MIN	12V	24V
RATED LINE PULL	9,500 lb	0	23	80	70
MOTOR: 12V	5 hp	3,000	12.5	170	140
GEARING	230:1	6,000	9.8	260	210
BRAKING ACTION	Auto in the drum	9,500	6.4	380	270
DRUM SIZE DIA X L	2.5" x 4.7"	LAYER OF WIRE ROPE		LINE PULL (LB)	
CABLE SIZE DIA X L	0.4" x 46 ft	1	9,500		
MOUNT PATTERN	5.9" x 4.5"	2	7,706		
DIMENSIONS	17.2" x 6.3" x 10.7"	3	6,482		
WEIGHT	80 lb	4	5,593		

### FEATURES

- Power in and power out
- High quality 5 hp series wound motor
- Heavy duty waterproof contactors
- Full steel planetary gearing
- Double sealed motor and drum
- Full load holding brake
- Integrated wireless remote

### INCLUDES

- 0.4" x 46 ft wire rope
- 10 ft remote handset
- Heavy duty stainless steel fairlead
- Heavy duty battery leads
- Isolation switch
- Stainless steel mounting hardware
- Built-in wireless remote
- 5/16 hook





## DESCRIPTION

Warrior Winches are excited to announce the arrival of the colossal Samurai 17500 & 20000lb Winches. Designed for the toughest of applications & tested in the most extreme environments imaginable, these Winches boasts a massive 7.0 & 7.5 hp Series wound motors respectively.

Double sealed drum on maintenance free bearings and quiet, fully sealed efficient full steel planetary gearing ensures these immense Warriors are ready for any battle.

## SPECIFICATION

S17500		S20000	
<b>RATED LINE PULL</b>	17,500 lb	<b>RATED LINE PULL</b>	20,000 lb
<b>MOTOR: 12V</b>	7 hp	<b>MOTOR: 12V</b>	7.5 hp
<b>GEARING</b>	430:1	<b>GEARING</b>	430:1
<b>BRAKING ACTION</b>	Auto in the drum	<b>BRAKING ACTION</b>	Auto in the drum
<b>DRUM SIZE DIA X L</b>	3.5" x 8.6"	<b>DRUM SIZE DIA X L</b>	3.5" x 8.6"
<b>CABLE SIZE DIA X L</b>	0.5" x 85 ft	<b>CABLE SIZE DIA X L</b>	0.47" x 87 ft
<b>MOUNT PATTERN</b>	10" x 4.5"	<b>MOUNT PATTERN</b>	10" x 4.5"
<b>DIMENSIONS</b>	24" x 8.5" x 10"	<b>DIMENSIONS</b>	24" x 8.6" x 10.7"
<b>WEIGHT</b>	147.7 lb	<b>WEIGHT</b>	158.7 lb



STEEL & SYNTHETIC VERSIONS AVAILABLE

## SAMURAI 17,500 & 20,000 LB WINCHES

### ITEM NUMBER / UPC

S17500 / 826518003209  
 S17500-SR / 827518008096  
 S20000 / 826518003216  
 S20000-SR / 826518005616

### FEATURES

- All brass (no corrosion) series wound motor
- Double sealed motor
- Sealed waterproof contactor
- Reinforced plastic contactor cover
- Doubled sealed drum (G-box/ motor)
- Sealed 3 stage planetary gears
- Stainless steel 4 way fairleads
- High quality steel drum supports

### INCLUDES

- 0.5" x 85 ft wire rope
- 10 ft remote handset
- Heavy duty stainless steel fairlead (wire version)
- Alloy fairlead (synthetic rope version)
- Heavy duty battery leads
- Isolation switch
- Stainless steel mounting hardware
- Wireless remote







## DESCRIPTION

The Predator is designed for hard-core competition. Two powerful 7.2HP sealed motors provide performance that is truly out of this World. Together with a 108:1 ratio 3 stage planetary gearbox, this winch handles the most extreme off-road punishment.

With a surprisingly low draw of only 140 amps (at no load), the Predator also contains an innovative “multi stop” 10% ratchet brake design, which provides zero drag when returning the “cable in”, and is situated away from the drum to prevent any damaging heat transferring to your Armortek or Synthetic rope.

The steel drum flanges are precision machined to 0.39” on either side to resist the unique loading characteristics of synthetic rope, while the Alloy Carbon gears are heat treated and tempered to 62HRC rating for extra strength. This Warrior from another dimension will mercilessly prey on its weaker rivals, hunting the opposition down. At 10kg lighter than any of its nearest competitors, with off-load line speeds from 65ft per minute & available with or without synthetic rope, there’s a Predator out there, ready & waiting, for everyone!

## SPECIFICATION

RATED LINE PULL	10,000 lb	LINE PULL	LINE SPEED	AMP DRAW
		LB	FT / MIN	12V
MOTOR: 12V	7.2 hp	0	66	140
GEARING	108:1	4,000	19.7	400
		6,000	16.7	560
DRUM SIZE DIA X L	2.8” x 8.42”	8,000	13.1	690
		10,000	10.5	790
CABLE SIZE DIA X L	0.35” x 124 ft	LAYER OF WIRE ROPE	LINE PULL (LB)	TOTAL ROPE ON DRUM (FT)
MOUNT PATTERN	10” x 4.5”	1	10,000	18.4
		2	8,153	41.0
DIMENSIONS	18.8” x 10.3” x 13.9”	3	6,881	68.9
		4	5,953	101
WEIGHT	99 lb	5	5,245	131.2

## PREDATOR 10,000 LB DUAL MOTOR WINCH

### ITEM NUMBER

P10000D-SR

### UPC

826518005272

### FEATURES

- Dual 7.2 hp sealed motors
- Sealed motor conforms to IP67
- Sealed waterproof contactor
- “Multi-stop” 10% ratchet brake design
- Sealed 3 stage planetary gears
- Alloy carbon gears hardened to 62HRC rating
- No load speed of 65 ft / min

### INCLUDES

- 0.35” x 124 ft synthetic Armortek rope
- Wireless remote with LCD display
- Heavy duty remote control
- Silver Warrior aluminum fairlead
- Heavy duty battery leads
- Stainless steel mounting hardware
- 12 ton competition hook



## T1000 ELITE COMBAT WINCHES

61



### DESCRIPTION

The T1000 Series Winches are built specifically for military use, able to withstand extreme climates and temperatures. Features include hardened 3 stage planetary gears for reliable and efficient use in the harshest environments. The waterproof remote control has thermometric LED indicators signals to monitor the temperature of the motor and high temp lithium grease is used which doesn't solidify in extreme climates. Coupled with corrosion & chemical resistant matte black powder coat & a stainless steel fairlead makes this a formidable winch able to withstand whatever is thrown at it.

### SPECIFICATION

T1000-100 & T1000-100AE		T1000-145 & T1000-145AE	
<b>RATED LINE PULL</b>	10,000 lb	<b>RATED LINE PULL</b>	14,000 lb
<b>MOTOR: 12V</b>	6.2 hp	<b>MOTOR: 12V</b>	7.2 hp
<b>GEARING</b>	228:1	<b>GEARING</b>	228:1
<b>DRUM SIZE DIA X L</b>	2.5" x 8.6"	<b>DRUM SIZE DIA X L</b>	2.5" x 8.6"
<b>CABLE SIZE DIA X L</b>	0.36" x 82 ft (AE) 0.36" x 82 ft (WR)	<b>CABLE SIZE DIA X L</b>	0.43" x 65.6 ft (AE) 0.43" x 75.5 ft (WR)
<b>MOUNT PATTERN</b>	10" x 4.5"	<b>MOUNT PATTERN</b>	10" x 4.5"
<b>DIMENSIONS</b>	22.6" x 6.3" x 10.2"	<b>DIMENSIONS</b>	22.6" x 6.3" x 10.2"
<b>WEIGHT</b>	61.7 lb (AE) 82.7 lb (WR)	<b>WEIGHT</b>	82.6 lb (AE) 90 lb (WR)
T1000-220 & T1000-220AE			
<b>RATED LINE PULL</b>	22,000 lb		
<b>MOTOR: 12V</b>	7.4 hp		
<b>GEARING</b>	450:1		
<b>DRUM SIZE DIA X L</b>	3.5" x 8.5"		
<b>CABLE SIZE DIA X L</b>	0.55" x 65.6 ft (AE) 0.55" x 78.7 ft (WR)		
<b>MOUNT PATTERN</b>	10" x 4.5"		
<b>DIMENSIONS</b>	24.1" x 6.3" x 10.2"		
<b>WEIGHT</b>	136.6 lb (AE) 165.3 lb (WR)		



### ITEM NUMBER / UPC

T1000-100 / 827518007167  
 T1000-100AE / 827518007174  
 T1000-145 / 827518007181  
 T1000-145AE / 827518007198  
 T1000-220 / 827518007204  
 T1000-220AE / 827518007211

### FEATURES

- IP68 rated military grade winch and control box
- Hardened 3 stage planetary gears
- Waterproof remote control with LED indicators
- Corrosion and chemical resistant powder coat
- High temperature lithium grease that won't solidify in extreme temperatures

### INCLUDES

- Armortek winch rope (or steel rope available)
- Aluminum fairlead (or stainless steel fairlead for wire rope)
- Stainless steel mounting hardware
- Hook







62

### NH SERIES HYDRAULIC WINCHES

#### ITEM NUMBER / UPC

10000NH / 826518003360  
15000NH / 826518003377

#### DESCRIPTION

Compact, tough. A hydraulic winch for industrial and commercial applications. The unique patented steel gearing system combined with a highly efficient and powerful hydraulic motor ensures maximum performance over the full load range.

Complete with internal brake to ensure maximum control and load holding. Stainless steel roller fairleads and fittings are standard.

#### SPECIFICATION

10000NH		15000NH	
<b>RATED LINE PULL</b>	10,000 lb	<b>RATED LINE PULL</b>	15,000 lb
<b>MAX LINE PULL</b>	12,500 lb	<b>MAX LINE PULL</b>	17,000 lb
<b>MOTOR</b>	Hydraulic Dis 50 ml/r	<b>MOTOR</b>	Hydraulic Dis 80 ml/r
<b>GEARING</b>	33:1	<b>GEARING</b>	37:1
<b>DRUM SIZE DIA X L</b>	2.8" x 8.8"	<b>DRUM SIZE DIA X L</b>	3.5" x 8.8"
<b>CABLE SIZE DIA X L</b>	0.4" x 87 ft	<b>CABLE SIZE DIA X L</b>	0.5" x 87 ft
<b>MOUNT PATTERN</b>	10" x 4.5"	<b>MOUNT PATTERN</b>	10" x 4.5"
<b>DIMENSIONS</b>	20" x 7.3" x 8.8"	<b>DIMENSIONS</b>	20.9" x 8.1" x 9.7"
<b>WEIGHT</b>	121 lb	<b>WEIGHT</b>	143 lb

#### FEATURES

- Patented heavy duty gearing
- Integral, automatic failsafe brake
- Spring engaged manual free-spool
- Stainless steel fairlead and fittings
- Rugged and compact for long life

#### INCLUDES

- Steel cable
- Heavy duty roller fairlead (10000NH / 15000NH)
- 5/16 or 3/8 hook





### NW SERIES HYDRAULIC WINCHES

#### ITEM NUMBER / UPC

10000NW / 826518005159  
15000NW / 826518005166

#### DESCRIPTION

Compact, tough. A hydraulic winch for industrial and commercial applications. The special heat treated planetary gearing system combined with a highly efficient and powerful hydraulic motor ensures maximum performance over the full load range.

Complete with internal brake to ensure maximum control and load holding.

#### FEATURES

- Patented heavy duty gearing
- Integral, automatic failsafe brake
- Spring engaged manual free-spool
- Rugged and compact for long life
- Meets the requirements of SAE J706

#### SPECIFICATION

10000NW		15000NW	
<b>RATED LINE PULL</b>	10,000 lb	<b>RATED LINE PULL</b>	15,000 lb
<b>MAX LINE PULL</b>	12,500 lb	<b>MAX LINE PULL</b>	17,000 lb
<b>MOTOR</b>	Hydraulic Dis 100.8 ml/r	<b>MOTOR</b>	Hydraulic Dis 160 ml/r
<b>GEARING</b>	16:1	<b>GEARING</b>	17.2:1
<b>DRUM SIZE DIA X L</b>	3.9" x 9.9"	<b>DRUM SIZE DIA X L</b>	5" x 10.6"
<b>CABLE SIZE DIA X L</b>	1/2" x 86 ft	<b>CABLE SIZE DIA X L</b>	0.6" x 92 ft
<b>MOUNT PATTERN</b>	14.6" x 4.5"	<b>MOUNT PATTERN</b>	11.9" x 4.5"
<b>DIMENSIONS</b>	25" x 10.33" x 9.39"	<b>DIMENSIONS</b>	28.2" x 11.1" x 12"
<b>WEIGHT</b>	130 lb	<b>WEIGHT</b>	270 lb

#### INCLUDES

- 86 ft x 1/2" steel cable
- 5/16 hook
- Tensioner included







### DESCRIPTION

Tough and compact, the JP series are heavy duty hydraulic winches designed and tested for toughest applications.

Minimum rope to drum ratio of 10:1, multi disc frictional brake, balance valve and rope tensioner as standard.

Available from 10 tonne to 40 tonne. Manufactured to meet GJB82-86 National Military Standard.

## JP SERIES HYDRAULIC WINCHES

### ITEM NUMBER / UPC

- 10TJP / 826518004923
- 13.5TJP / 826518004931
- 15TJP / 826518004947
- 20TJP / 826518004954
- 30TJP / 826518004978

### FEATURES

- Full float heavy duty planetary gearing
- Multi-disk friction brake
- Minimum 10:1 rope/drum ratio
- High torque industrial motor
- Air and manual clutch operation

### INCLUDES

- Heavy duty rope tensioner as standard
- Balance valve as standard

SPECIFICATION	10TJP	13.5TJP	15TJP
RATED LINE PULL	22,046 lb	29,762 lb	33,069 lb
WORKING SPEED	21.6 ft / min	24.6 ft / min	20 ft / min
ARRESTER RESP PRESS	5 Mpa	<2.5 Mpa	<2.5 Mpa
WORKING PRESSURE	20 Mpa	17 Mpa	17 Mpa
OIL FLOW	15-75 L / min	110 L / min	110 L / min
DRUM SIZE	5.4" x 12.4"	15.7" x 8.3" x 13.4"	15.7" x 8.3" x 13.4"
REC ROPE SIZE	0.6" x 157 ft	0.7" x 131 ft	0.9" x 230 ft
WEIGHT	363 lb	578 lb	628 lb
	20TJP	30TJP	
RATED LINE PULL	44,092 lb	66,138 lb	
WORKING SPEED	20 ft / min	18 ft / min	
ARRESTER RESP PRESS	<2.5 Mpa	<2.5 Mpa	
WORKING PRESSURE	17 Mpa	17 Mpa	
OIL FLOW	120 L / min	120 L / min	
DRUM SIZE	20.9" x 8.3" x 13.4"	20.9" x 11" x 14.2"	
REC ROPE SIZE	1" x 197 ft	1.3" x 197 ft	
WEIGHT	650 lb	1,257 lb	



**DIY** **CORPLESS**  
**TOOLS** 











## 4-IN-1 CORDLESS TOOL KIT

### ITEM NUMBER

CHPW102

### UPC

827518007105

68



### DESCRIPTION

Gone are the days of having too many tools that serve only one purpose.

A pressure washer, blower, inflater, and vacuum all in one, the DK2 4 in 1 Cordless Kit is a first of its kind. The lightweight and secure handle is designed to make switching attachments effortless, while the high capacity battery won't run out until the job is done.

Don't let its compact size fool you, the DK2 4-in-1 Cordless Kit's convenient size is designed for anyone to tackle any job.

### SPECIFICATION

<b>DIMENSIONS</b>	18" x 19" x 12"
<b>WEIGHT</b>	12 lb
<b>SHIPPING DIMENSIONS</b>	15.5" x 22.5" x 6"
<b>SHIPPING WEIGHT</b>	14 lb

### FEATURES

#### CONTENTS INCLUDE:

- 20V x 2.0AS Lithium Battery x2
- 1 hour quick charging station
- High pressure washer attachment (330 PSI max pressure)
- 20 ft. water hose
- Inflater attachment
- Blower attachment
- Vacuum cleaner attachment

#### PRESSURE WASHER:

- Max Pressure: 330 PSI / 25 bar
- Flow: 2.5 L / min
- 1 x 19.8 ft. hose
- 1 x short lance
- 1 x spray nozzle

#### INFLATER:

- Max Pressure: 100 PSI / 7 bar
- 1 x 19.7 inch inflater hose
- 1 x ball adapter
- 1 x air bed adapter

#### VACUUM CLEANER:

- No-load speed: 0-15,000 RPM
- Air Flow: 2.5m<sup>3</sup> / min
- Vacuum: 8000 Pa
- Container Capacity: 0.6 L

#### BLOWER:

- No-load speed: 0-15,000 RPM
- Air Flow: 2.5m<sup>3</sup> / min



**POWER 2 GO  
PORTABLE  
CHARGING KIT**

**ITEM NUMBER**

P2G850

69

**UPC**

826518005142



**DESCRIPTION**

The DK2 Power 2 Go is the incredibly powerful yet versatile battery jump starter that literally sits in the palm of your hand. Slightly larger than your Smartphone, it is powerful enough to jump-start most full sized cars and trucks. All this power and it can still be easily stored in your glove box. With multiple ports and adapters included, there's no longer a need to panic when your Smartphone, tablet or laptop is running low on power. Simply plug into your DK2 Power 2 Go and watch in amazement as your device quickly charges. The P2G can be used on: Cars, Bobcats, ATVs, UTVs, Snowmobiles, Golf carts, and Boats.

**SPECIFICATION**

<b>DIMENSIONS</b>	6.3" x 3" x 1.4"
<b>WEIGHT</b>	2 lb
<b>SHIPPING DIMENSIONS</b>	11" x 2" x 8"
<b>SHIPPING WEIGHT</b>	2 lb

**FEATURES**

- NEW & Improved clamps to avoid overheating, Built in rechargeable high output Lithium-ion battery
- Upgraded copper booster cables and clamps, 14,000 mAh capacity
- Output: 12V / 5V, 2 A, peak current 500A
- 850 cold cranking amps starting current
- Can boost a single vehicle 20 times on a single charge
- Overload and over-charge protection
- Charging adapters for most major electronic devices





**DIA**®