

1. BEFORE YOU BEGIN

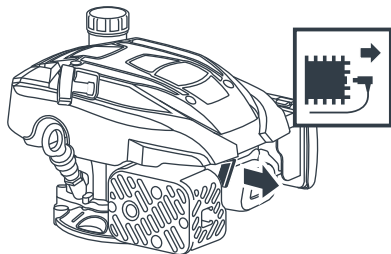

1. Disconnect spark plug wire from spark plug and place wire where it cannot come in contact with plug.



2. Completely drain fuel from tank, wipe off any spilled fuel from lawn mower or side of engine.

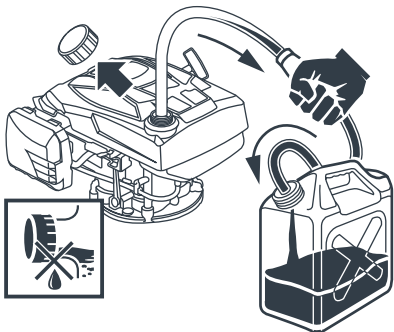

3. Always keep the air filter and carburetor facing up whenever needed to tip the machine onto its side.

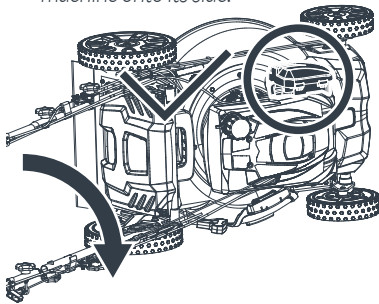

2. REPLACE THE BELT



1. Wedge a block of wood between the mower blade and the deck. Remove the blade, saving all mounting hardware. (See **Figure 18 & 19** in Operator's Manual).

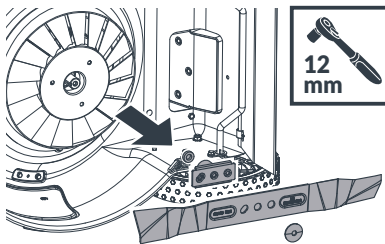

2. Remove the four M6x12 bolts fixing the engine pulley cover and put the engine pulley cover aside.

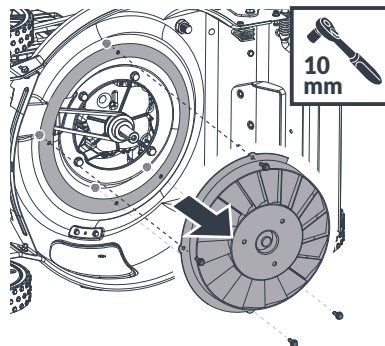

3. Remove the five bolts fix the front belt cover and removing the front belt cover.

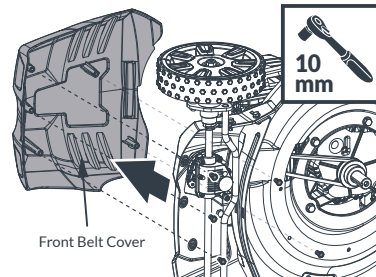

4. First remove the cable on the tension roller plate, then remove the bolts fixing the tension roller plate, and the tension roller plate, and finally remove the front end of the V-belt.

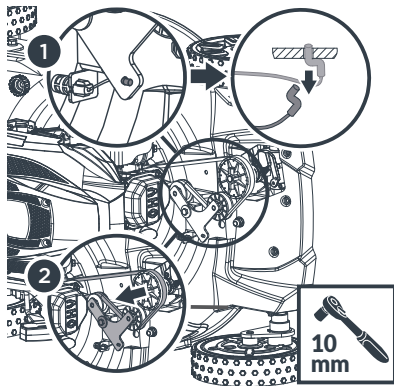

5. Remove the rear end of the V-belt. Replace the new belt and restore it.

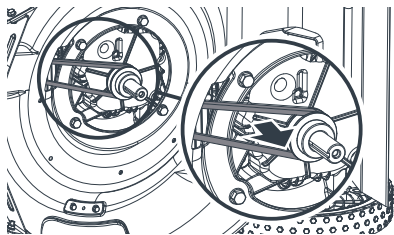

6. Assemble the machine in reverse order.