

Thank you for purchasing this Winsome House product. This product has been manufactured with the highest standards of safety and quality.

<b>Product Name:</b>	Metal Oval Garden Bed
<b>SKU #:</b>	WHPL431

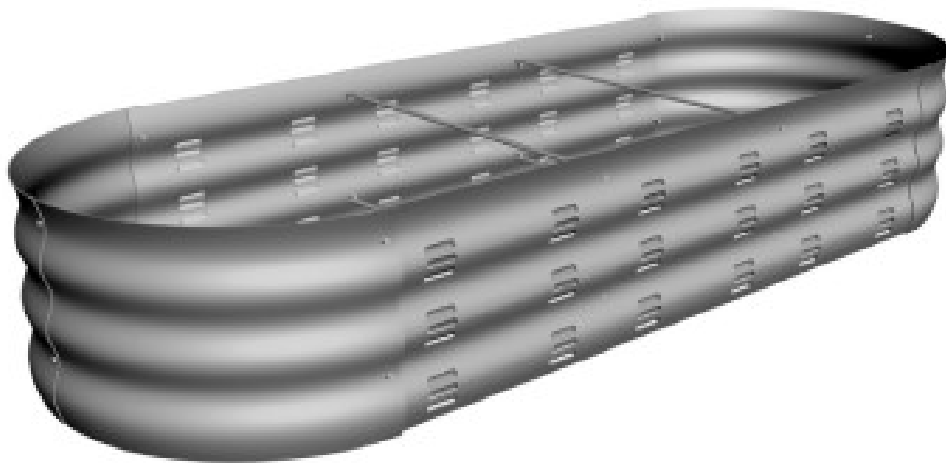

### PREPARATION

---

Before assembling product, make sure all parts are present. Compare parts with package contents list and hardware contents below. If any part is missing or damaged, do not attempt to assemble the product.

**No tools required for assembly**

### SAFETY INFORMATION

---

- Tighten all the screws before using.
- This planter is intended for outdoor use only. The floor may be wet when watering the plant.
- Not for use by children. Keep children and pets away from the planter.

<b>Product Name:</b>	Metal Oval Garden Bed
<b>SKU #:</b>	WHPL431

### PACKAGE CONTENTS

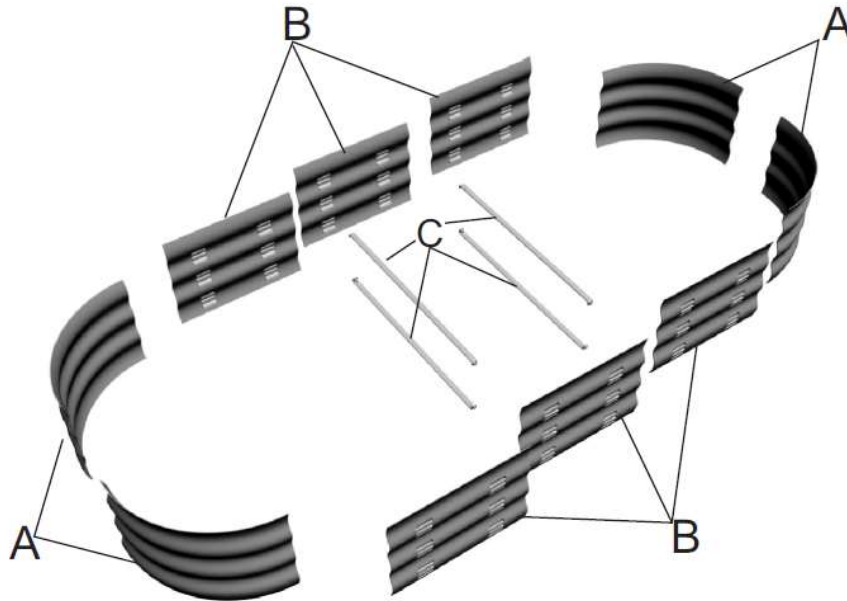

Part	Description	Quantity
A	corner panel	4
B	side panel	6
C	reinforce stick	4

### HARDWARE CONTENTS

D

E



M6X10 MM Bolt  
QTY. 20



M6 Nut  
QTY. 20

<b>Product Name:</b>	Metal Oval Garden Bed
<b>SKU #:</b>	WHPL431

### ASSEMBLY INSTRUCTION

- ① Left side stand: Attach 2 corner panels (A) with bolt (D) and nut (E).  
 Right side stand: Do the same way to the other side.

#### Left side stand

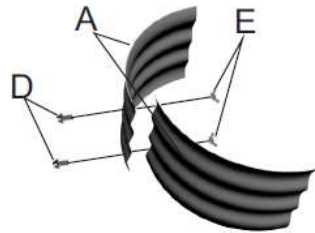

#### Right side stand

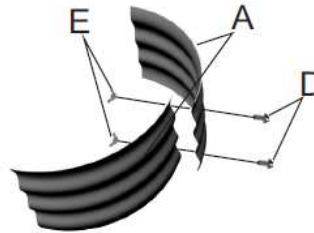

Hardware Used: D  x4 E  x4  
 M6X10 MM Bolt M6 Nut

- ② Attach total 4 side panels attached. side panel(B) to step ①  
 Attention: convex surface of vent inside placed.

#### Left side stand

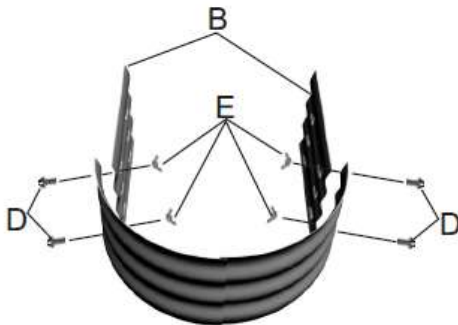

#### Right side stand

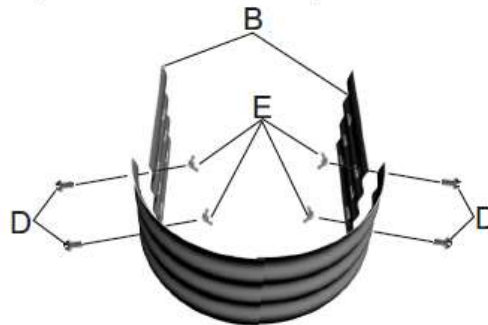

Hardware Used: D  x8 E  x8  
 M6X10 MM Bolt M6 Nut

<b>Product Name:</b>	Metal Oval Garden Bed
<b>SKU #:</b>	WHPL431

③ Attach side panel (B) and reinforce stick (C) to step ②.

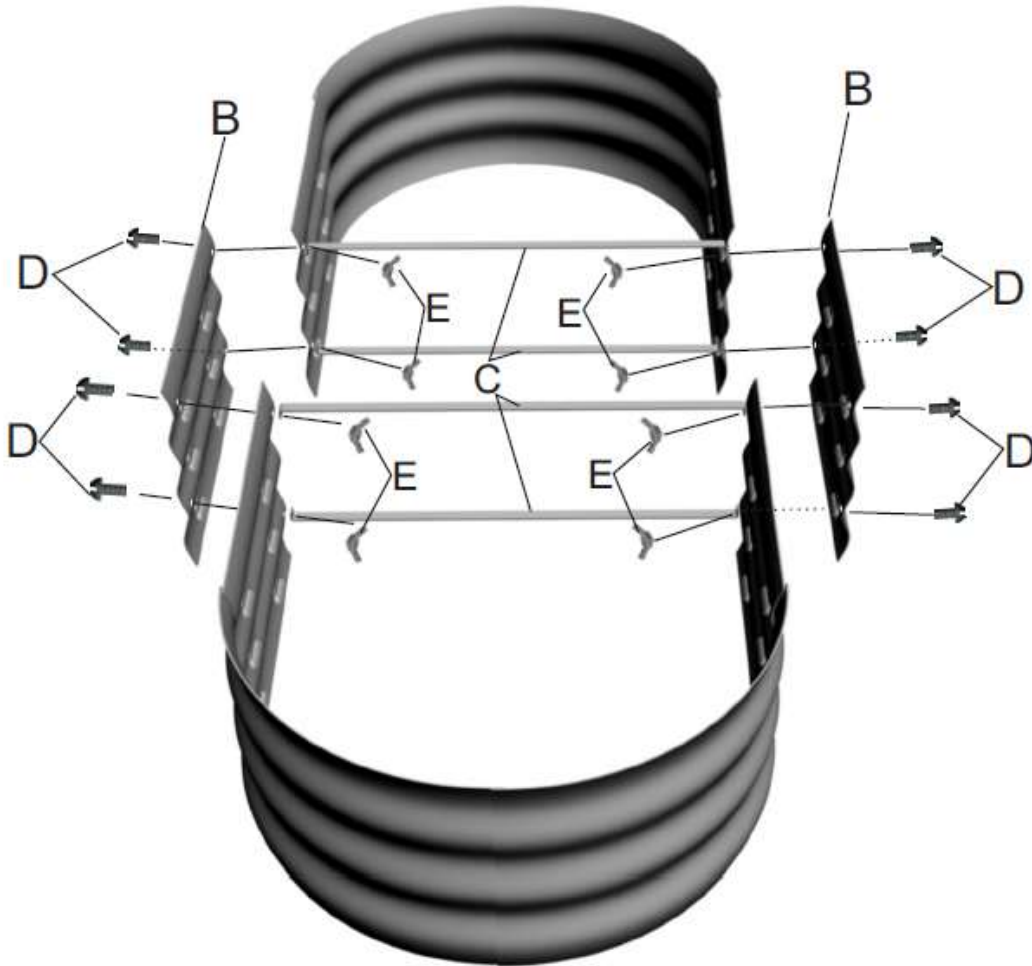

Hardware Used: D  x8 M6X10 MM Bolt E  x8 M6 Nut