

Installation Instructions

Part Numbers:

GOOSENECK MOUNTING KIT

4438

Dodge Ram 1500 2002-2008

Short & Long Bed, Excluding Megacabs

Equipment Required:

Fastener Kit: 4438F

Wrenches: 15/16, 10 mm

Drill Bits: 1/4"

Other Tools: Drill, Reciprocating Saw

WARNING: Under no circumstances do we recommend exceeding the towing vehicle manufacturers recommended vehicle towing capacity.

9464/9474 HIDE-A-GOOSE HITCH INSTALLATION

All Fasteners Typical, Both Sides

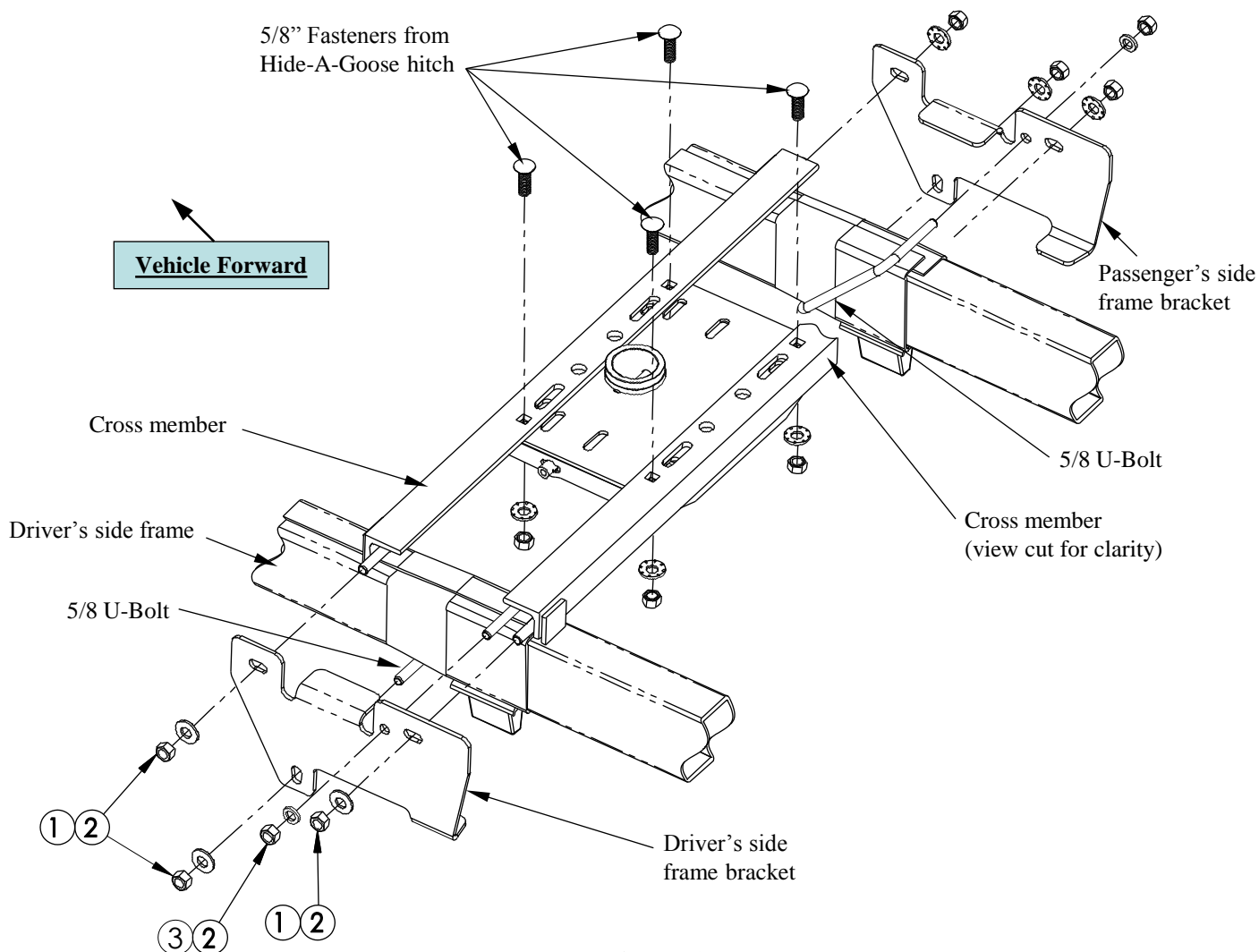

Figure 1

1	Qty. (6)	Conical Toothed Washer, 5/8"	4	Qty. (1)	Cable Tie (not shown)
2	Qty. (8)	Hex Nut, 5/8"-11	5	Qty. (4)	Shims, 5/16" x 2" x 1" (not shown in this Figure)
3	Qty. (2)	Lock Washer, 5/8"			

Installation Instructions

Part Numbers:

GOOSENECK MOUNTING KIT

4438

Dodge Ram 1500 2002-2008

Short & Long Bed, Excluding Megacabs

9464/9474 HIDE-A-GOOSE HITCH INSTALLATION

NOTES:

- This rail kit can be used with a 9464 or 9474 head only.
- Always make sure the ball is fully locked before towing.
- Keep the ball and ball sleeve well lubricated.
- Periodically re-torque all the hitch fasteners.
- Check ball, hitch coupler, safety chains and other connections for proper operation every time you tow.

Warning:

- ❖ The tow vehicle manufacturers recommended towing capacities should **UNDER NO CIRCUMSTANCES** be exceeded.
- ❖ Check for adequate clearance between the gooseneck trailer and the rear of the cab and the rear of the truck box before installing hitch.
- ❖ All trucks have fuel lines, brake lines and electrical wiring located along the vehicle frame where the rail kit installs. Carefully examine the location of fuel lines, brake lines and electrical wires before installation and be certain not to damage these when positioning the hitch components. Be careful when drilling holes, cutting sheet metal and tightening fasteners as to not limit the integrity of these systems.

Hide-A-Goose Only – Drilled Hole in Bed Location (see Step 2):

Short Box, 44-1/2 inches

Long Box, 46-1/2 inches

1. To make installation easier, the spare tire and exhaust can be lowered.
2. When installing the 9464/9474 Hide-A-Goose hitch, a hole must be drilled in the bed of the truck. Mark and drill a 1/4" hole **44-1/2 inches (6' bed) / 46-1/2 inches (8' bed)** from the rear of the bed and centered between the wheel wells. Using a hole saw, enlarge the pilot hole to the final diameter. Refer to the 9464/9474 instruction sheet for hole size.
3. Place 5/8" GR8 carriage bolts from the Hide-A-Goose fastener kit into the square holes on the cross members from the top pointing towards the ground. See Figure 1.
4. From underneath the vehicle, install the **rear** hitch cross member first by placing the right end over the exhaust and under the front bed support (see Figure 2). The front and rear cross members are the same.
5. Carefully maneuver the left end up over the wires and brake lines on the inside of the driver's side frame, until the end of the cross member is over the frame.
6. Slide the left end of the cross member to the left over the frame, then rotate the right side back and over the passenger's side frame. Push the rear cross member back against the rear bed support as shown in Figure 2.
7. Install the **front** hitch cross member the same way as the rear cross member was installed.

Installation Instructions

Part Numbers:

GOOSENECK MOUNTING KIT

4438

Dodge Ram 1500 2002-2008

Short & Long Bed, Excluding Megacabs

9464/9474 HIDE-A-GOOSE HITCH INSTALLATION

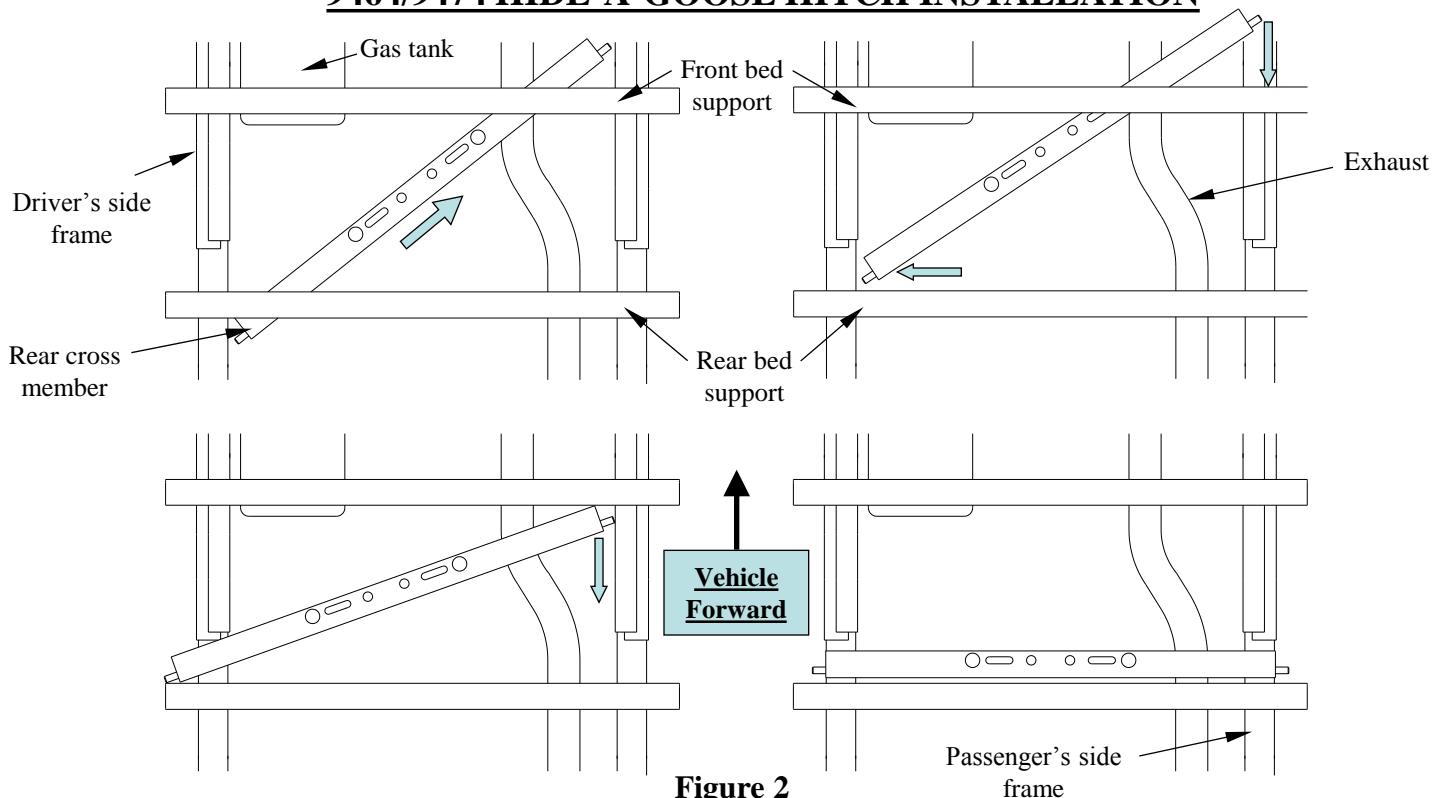

Figure 2

Rear cross member placement shown

8. Line up the mounting holes on the frame brackets with the studs on the ends of the cross members. Loosely attach frame brackets to rails with 5/8" hex nuts, lock washers and flat washers as shown in Figure 3.
9. Loosen the brake line that is attached to the inside of the driver's side frame. Install the 5/8" U-Bolt to the frame bracket and frame so that it is between the brake line and the frame. Put the 5/8" hex nuts, lock washers and flat washers loosely on the U-Bolts.

⚠ WARNING: Do not apply U-Bolt over the brake line. Place U-Bolt under brake line as shown in Figure 4. Failure to do so may result in failure of the braking system and loss of vehicle control.

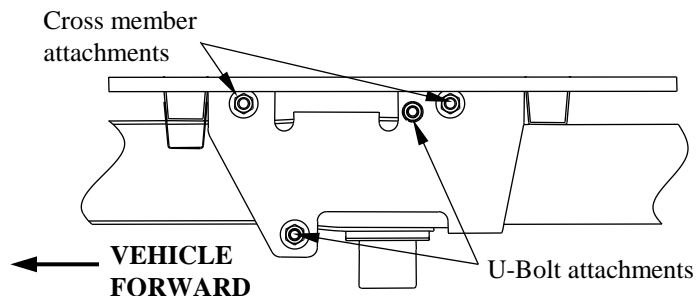

Figure 3

View of driver's side bracket over axle

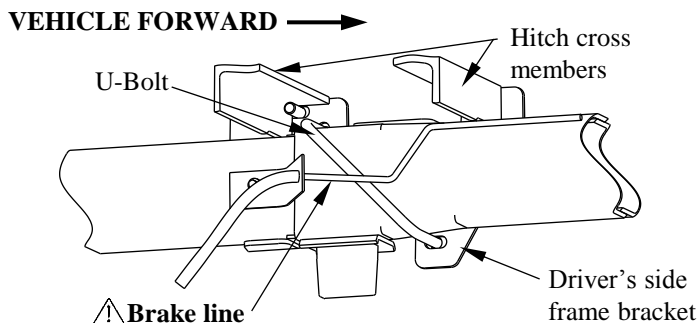

Figure 4

View of brake line and U-Bolt inside driver's side frame

Installation Instructions

Part Numbers:

GOOSENECK MOUNTING KIT

4438

Dodge Ram 1500 2002-2008

Short & Long Bed, Excluding Megacabs

9464/9474 HIDE-A-GOOSE HITCH **INSTALLATION**

10. Loosely install the Hide-A-Goose hitch. Refer to the 9464/9474 instruction sheet.
11. After installing the Hide-A-Goose hitch and 4438 mounting kit, carefully align the hitch ball sleeve with the opening in the truck bed. Torque the 5/8" hex nuts on the cross member studs and U-Bolts to 150 ft.-lb. (203 N-m). Torque the 5/8" nuts that attach the Hide-A-Goose hitch to the cross members to 212 ft.-lb. (287 N-m). Use the following sequence: a) torque U-Bolt nuts to frame brackets, b) torque cross members to the frame brackets, c) torque Hide-A-Goose hitch to cross members.
12. Reattach the brake line to the inside of the vehicle driver's side frame. If the brake line cannot be reattached using the existing hardware, use the cable tie to attach the line to the forward hitch cross member.
13. If necessary, reinstall the exhaust and raise the spare tire to its stored position.

Installation Instructions

Part Numbers:

GOOSENECK MOUNTING KIT

4438

Dodge Ram 1500 2002-2008

Short & Long Bed, Excluding Megacabs

Equipment Required:

Fastener Kit: 4438F

Wrenches: 15/16, 10 mm

Drill Bits: 1/4"

Other Tools: Drill, Reciprocating Saw

WARNING: Under no circumstances do we recommend exceeding the towing vehicle manufacturers recommended vehicle towing capacity.

6300/8339/83391/83399 GOOSENECK HITCH INSTALLATION

All Fasteners Typical, Both Sides

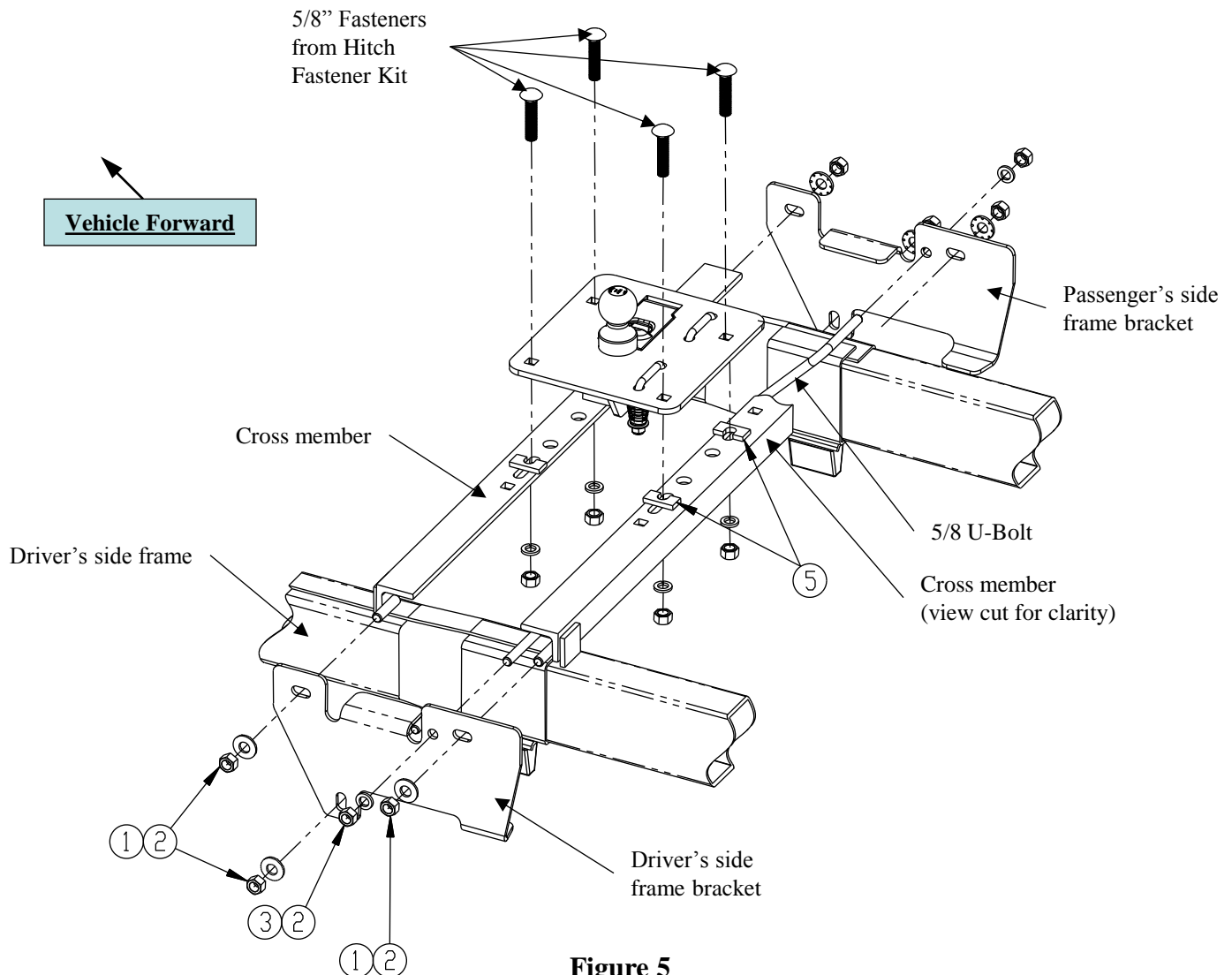

Figure 5

1	Qty. (6)	Conical Toothed Washer, 5/8"	4	Qty. (1)	Cable Tie (not shown)
2	Qty. (8)	Hex Nut, 5/8"-11	5	Qty. (4)	Shims, 5/16" x 2" x 1"
3	Qty. (2)	Lock Washer, 5/8"			

Installation Instructions

Part Numbers:

GOOSENECK MOUNTING KIT

4438

Dodge Ram 1500 2002-2008

Short & Long Bed, Excluding Megacabs

6300/8339/83391/83399 GOOSENECK HITCH INSTALLATION

NOTES:

- This rail kit can be used with a 6300, 8339, 83391, 83399 heads only.
- Always make sure the ball is fully locked before towing.
- Keep the ball and ball pocket well lubricated.
- Periodically re-torque all the hitch fasteners.
- Check ball, hitch coupler, safety chains and other connections for proper operation every time you tow.

Warning:

- ❖ The tow vehicle manufacturers recommended towing capacities should **UNDER NO CIRCUMSTANCES** be exceeded.
- ❖ Check for adequate clearance between the gooseneck trailer and the rear of the cab and the rear of the truck box before installing hitch.
- ❖ All trucks have fuel lines, brake lines and electrical wiring located along the vehicle frame where the rail kit installs. Carefully examine the location of fuel lines, brake lines and electrical wires before installation and be certain not to damage these when positioning the hitch components. Be careful when drilling holes, cutting sheet metal and tightening fasteners as to not limit the integrity of these systems.

1. To make installation easier, the spare tire and exhaust can be lowered.
2. From underneath the vehicle, install the **rear** hitch cross member first by placing the right end over the exhaust and under the front bed support (see Figure 6a). The front and rear cross members are the same.
3. Carefully maneuver the left end up over the wires and brake lines on the inside of the driver's side frame, until the end of the cross member is over the frame.

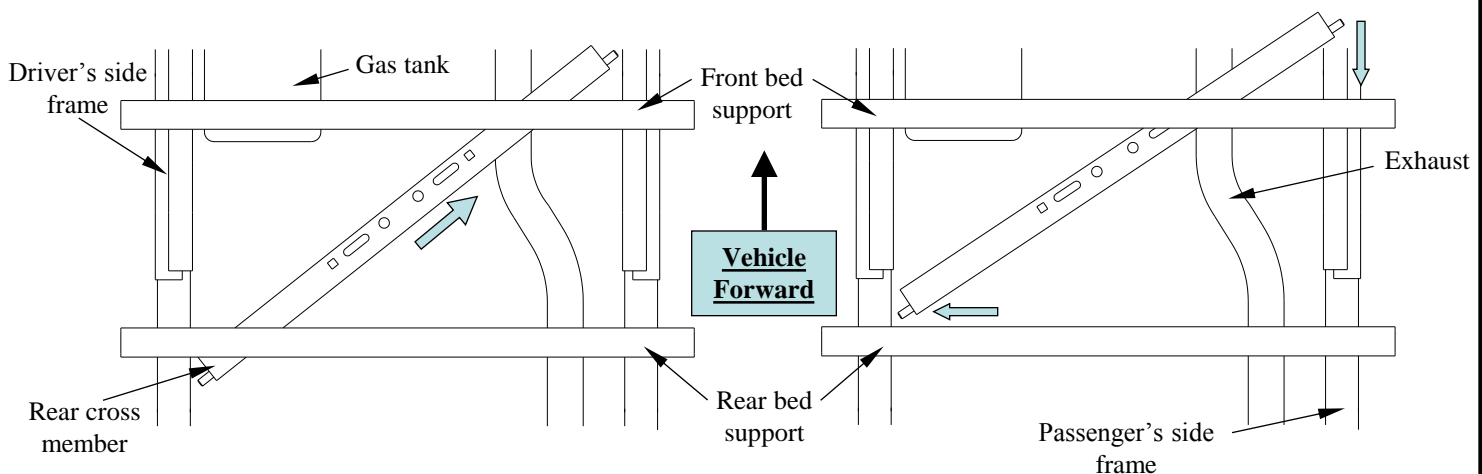

Figure 6a

Rear cross member placement shown

Installation Instructions

Part Numbers:

GOOSENECK MOUNTING KIT

4438

Dodge Ram 1500 2002-2008

Short & Long Bed, Excluding Megacabs

6300/8339/83391/83399 GOOSENECK HITCH

INSTALLATION

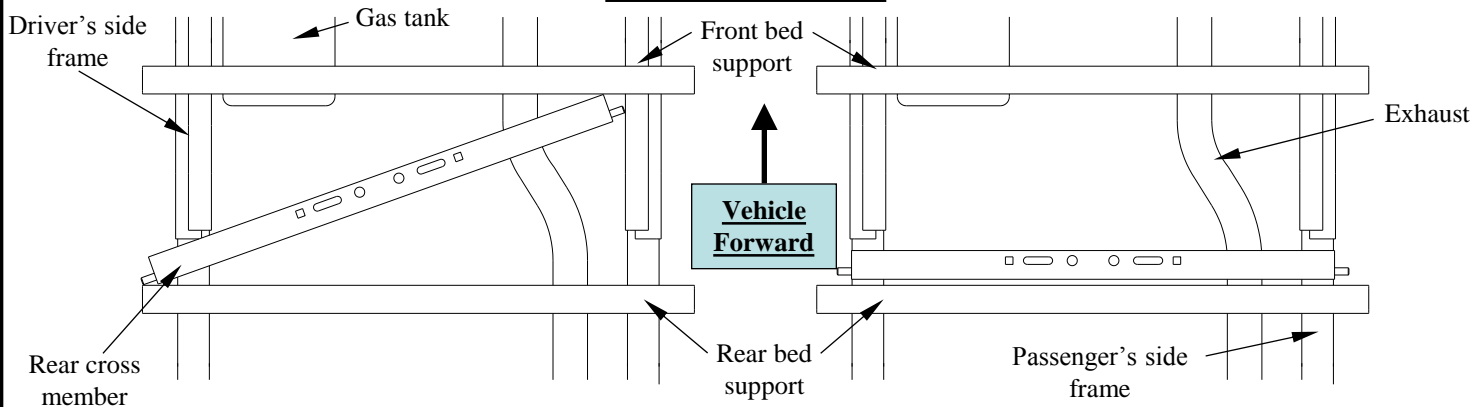

Figure 6b

Rear cross member placement shown

- Slide the left end of the cross member to the left over the frame, then rotate the right side back and over the passenger's side frame. Push the rear cross member back against the rear bed support as shown in Figure 6b.
- Install the **front** hitch cross member the same way as the rear cross member was installed.
- Line up the mounting holes on the frame brackets with the studs on the ends of the cross members. Loosely attach frame brackets to rails with 5/8" hex nuts, lock washers and flat washers as shown in Figure 7. The brackets will fit closely between the two bed supports.
- Loosen the brake line that is attached to the inside of the driver's side frame. Install the 5/8" U-Bolt to the frame bracket and frame so that it is between the brake line and the frame. Put the 5/8" hex nuts, lock washers and flat washers loosely on the U-Bolts.

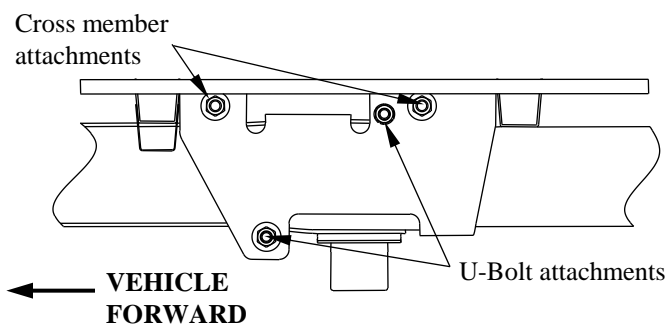

Figure 7

View of driver's side bracket over axle

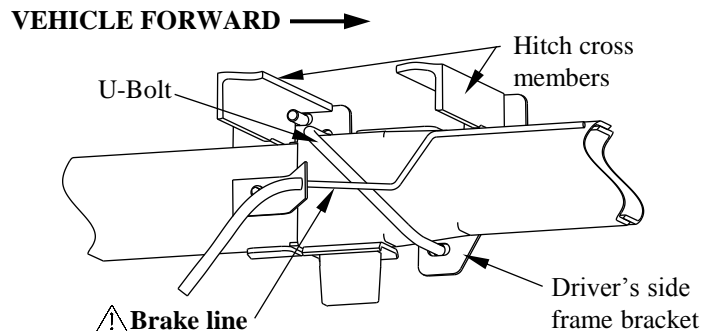

Figure 8

View of brake line and U-Bolt inside driver's side frame

⚠ WARNING: Do not apply u-bolt over the brake line. Place u-bolt under brake line as shown in Figure 8. Failure to do so may result in damage to the braking system and loss of vehicle control.

- With the **rearward** cross member and side brackets properly aligned, torque 5/8" hex nuts on the U-Bolts and the studs **on the rearward cross member** to 150 ft.-lb (203 Nm). Make sure that the top of the rear cross member is flush with the bottom of the truck bed after tightening it to the frame brackets. The forward cross member should be left loose until Step 18.

- 9a. **For 6300 & 8339** use the **outer** edges of the long slots in the rearward cross member as a template to drill 5/8" diameter holes through the truck bed as shown in Figure 9a. Not all holes can be drilled from under the vehicle, but should be done later from inside the bed.
- 9b. **For 83391 & 83399** use the **inner** edges of the long slots in the rearward cross member as a template to drill 5/8" diameter holes through the truck bed as shown in Figure 9b. Not all holes can be drilled from under the vehicle, but should be done later from inside the bed.
10. Align the holes on the template (provided with the gooseneck hitch) with the holes previously drilled through the bed (see Figure 10). Be sure that the template is properly oriented toward the front of the vehicle. Center punch the holes that will be used to cut the opening in the bed. If the vehicle is equipped with a bed liner, a section of the bed liner must be cut away so that the gooseneck hitch can contact the bed corrugations.

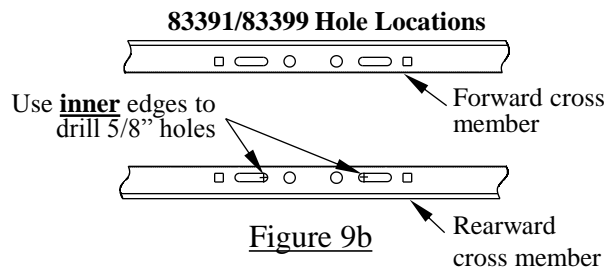
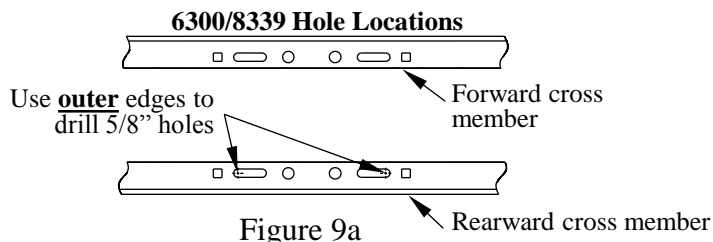

Figure 9a

Figure 9b

Template p/n 5978 for use with 6300 head
 Template p/n 114234 for use with 8339 head
 Template p/n 114523 for use with 83391/83399 heads

Durable and reusable stainless steel templates are also available. A time saver for cutting bed liner and bed.

Template p/n 6467 for use with 6300 head
 Template p/n 6425 for use with 8339 head
 Template p/n 58384 for use with 83391/83399 heads

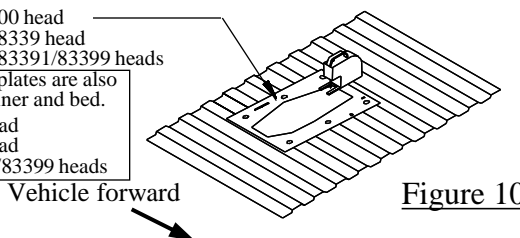

Figure 10

WARNING: The fuel tank and/or other vehicle components are located below some of the holes. A wood or metal shield must be placed between the frame and the fuel tank to prevent puncturing the fuel tank when the drill breaks through the bed.

11. Drill 1/4" pilot holes (size will depend on width of blade in saber saw).
12. Cut out the truck bed and file edges as needed.
13. Install the hitch into the opening.
14. Use hitch as a guide to drill the 5/8" diameter holes for the forward cross member. Also, drill 5/8" diameter U-Bolt holes if installing a 6300 or 8339 gooseneck hitch.

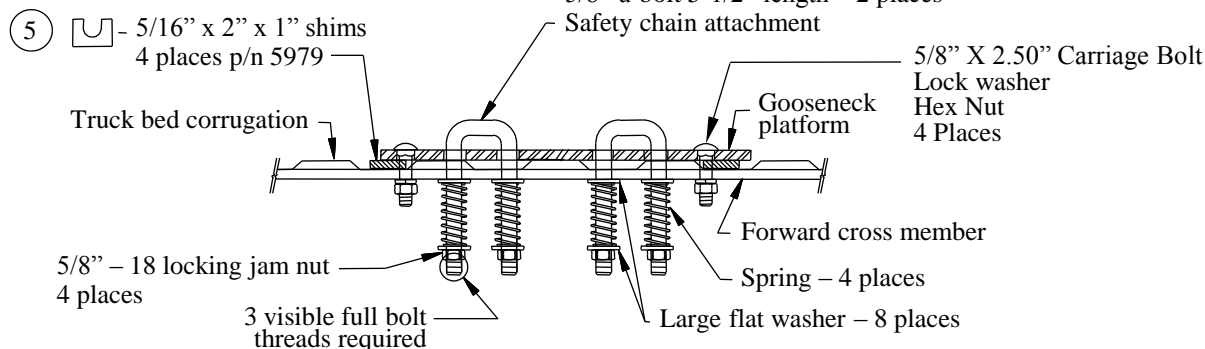

Figure 11

15. Before installing the 5/8" carriage bolts through the hitch, the U-Block shims (Part Number 5979) must be placed between the hitch and the bed and between the cross members and the bottom of the bed. These shims are necessary to prevent the bed corrugations from collapsing when the bolts are tightened (see Figure 11).
16. Align the forward cross member with the 5/8" diameter drilled holes.
17. Install the 5/8" X 2.50" carriage bolts through the hitch, shims and cross members. Secure with lock washers and nuts. Torque nuts to 150 ft.-lb. (203 N-m).
18. Tighten the 5/8" hex nuts that attach the forward cross member to the frame brackets. Torque nuts to 150 ft.-lb. (203 N-m).
19. **For 6300 and 8339 Installations:** Install the (2) U-Bolts through the hitch and from under the vehicle install the large flat washer over the U-Bolt followed by a spring, another large flat washer and secure with a thin 5/8" jam nut. Repeat for the other legs of the U-Bolts. The 5/8" jam nuts are tightened until (3) threads are visible past the bottom of the jam nut.
20. Reattach the brake line to the inside of the vehicle driver's side frame. If the brake line cannot be reattached using the existing hardware, use the cable tie to attach the line to the forward hitch cross member.
21. Reinstall the exhaust, if necessary. Raise the spare tire to its stored position.

LIMITED LIFETIME WARRANTY

Part No: _____

Date of Original Purchase: _____

Original Owner: _____

Original Installer: _____

1. Limited Lifetime Warranty ("Warranty"). Cequent Performance Products, Inc. ("We" or "Us") warrants to the original consumer purchaser only ("You") that the product will be free from material defects in both material and workmanship, ordinary wear and tear excepted; provided that installation and use of the product is in accordance with product instructions. There are no other warranties, express or implied, including the warranty of merchantability or fitness for a particular purpose. This warranty is not transferable.
2. Limitations on the Warranty. This Warranty does not cover: (a) normal wear and tear; (b) damage through abuse, neglect, misuse, or as a result of any accident or in any other manner; (c) damage from misapplication, overloading, or improper installation; (d) improper maintenance and repair; and (e) product alteration in any manner by anyone other than Us, with the sole exception of alterations made pursuant to product instructions and in a workmanlike manner.
3. Obligations of Purchaser. To make a Warranty claim, contact Us, at our principal address of 47912 Halyard Dr. Suite 100, Plymouth, MI 48170, 1-888-521-0510, identify the product by model number, and follow the claim instructions that will be provided. Any returned product that is replaced by Us becomes our property. You will be responsible for return shipping costs. Please retain your purchase receipt to verify date of purchase and that You are the original consumer purchaser. The product and the purchase receipt must be provided to Us in order to process Your Warranty claim.
4. Remedy Limits. Product replacement is Your sole remedy under this Warranty. We shall not be liable for service or labor charges incurred in removing or replacing a product or any incidental or consequential damages of any kind.
5. Assumption of Risk. You acknowledge and agree that any use of the product for any purpose other than the specified use(s) stated in the product instructions is at Your own risk.
6. Governing Law. This Warranty gives You specific legal rights, and You also may have other rights which vary from state to state. This Warranty is governed by the laws of the State of Michigan, without regard to rules pertaining to conflicts of law. The state courts located in Oakland County, Michigan shall have exclusive jurisdiction for any disputes relating to this Warranty.