

INSTRUCTION SHEET

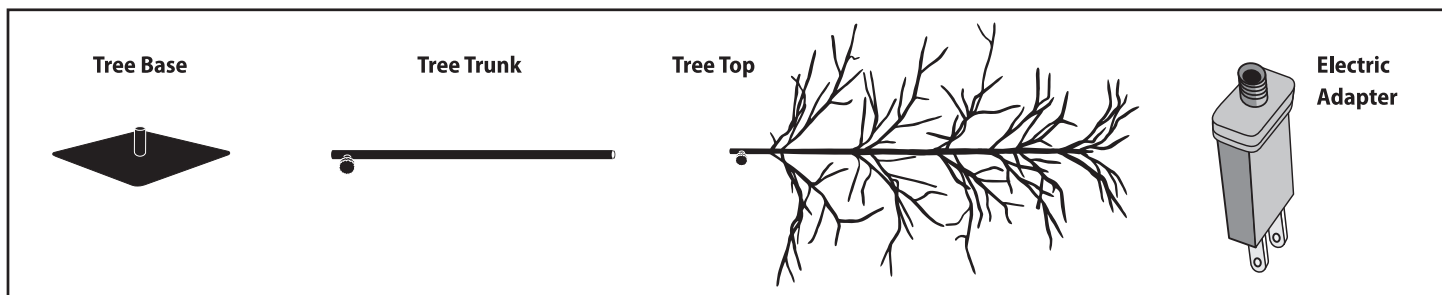

TREE ASSEMBLY:

1. Place the base on a flat even surface. Take tree trunk pole with tightening knob facing toward the tree base, and place onto base as shown. **(diagram A)** Tighten knob clockwise until secure.
2. Insert the tree top onto top of tree trunk pole. Use tightening knob and turn clockwise until secure. **(diagram B)**
3. Pull down branches on tree top and adjust for desired form and shape.
4. Assemble UL adapter with tree cord by connecting the cord plug into the outdoor adapter and tighten as shown. **(diagram C)**

USE:

To operate, insert UL adapter into electrical outlet. Plugging in adapter turns lights on, pulling out adapter turns lights off.

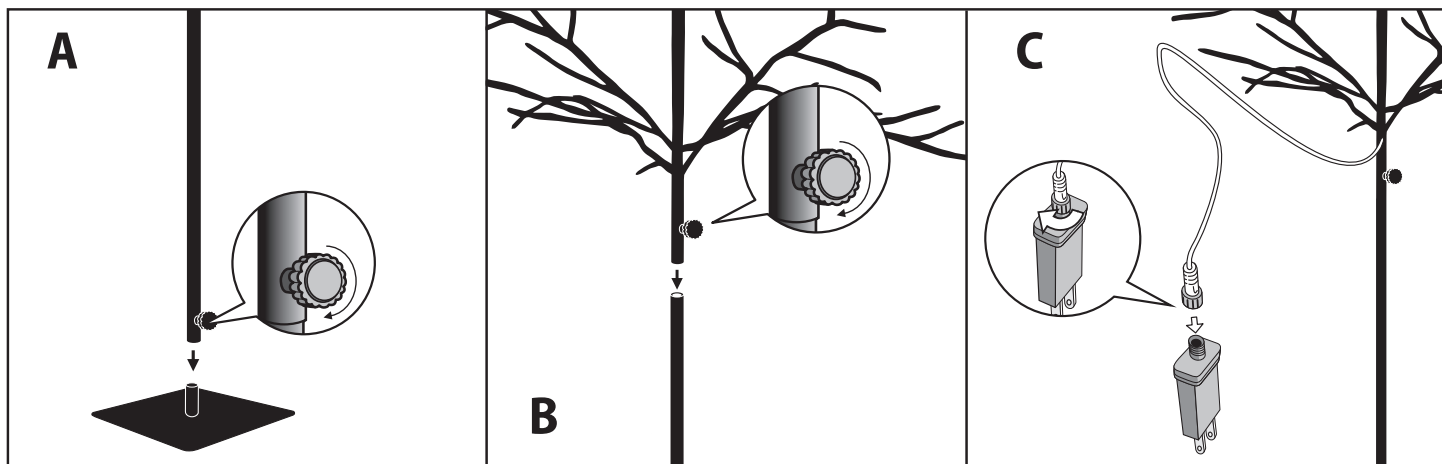

CARE: Keep adapter out and away from water.

WARNING: Risk of electric shock. When in use outdoors, install only to a covered GFCI electrical outlet that is weather proof. Make sure the adapter and cord are assembled correctly and secured tightly to prevent water from entering the device.

KEEP THIS INSTRUCTION SHEET FOR REFERENCE AS IT CONTAINS IMPORTANT INFORMATION.

1. Please read and follow all instructions and warnings both on the instructions and on the product carefully before use.
2. Retain these instructions for future reference.
3. This product is to be used only as intended as outlined on these instructions.
4. For Indoor/Outdoor Use.
5. If used outdoors, connect the product to a Ground Fault Circuit Interrupting (GFCI).
6. This product is not intended for permanent installation or use.
7. Do not mount or place near gas or electric heaters, fireplaces, candles or other similar sources of heat.
8. Do not secure the wiring of this product with staples or nails, or place on sharp hooks, nails or in a manner that can cut or damage the wire or insulation.
9. Unplug the product when leaving the house, when retiring for the night or if left unattended.
10. This is an electric product and not a toy! To avoid risk of fire, burns, personal injury and electric shock it should not be played with or placed where small children can reach it.
11. Do not hang ornaments or other object from the cord, wire or lighted branch.
12. Do not close doors or windows on the product or extension cords as this may damage the wire and insulation.

WARNING: The power unit that comes with the product is intended to be correctly orientated in a vertical or floor mount position. Install only to a covered Class A GFCI receptacle that has an enclosure that is weatherproof with the attachment plug cap inserted or removed.

WARNING: Not for use with receptacles that are weatherproof only when the receptacle is covered (attachment plug cap not inserted and receptacle cover closed) Risk Of Electric Shock. Mount the unit at a height greater than 1 foot from the ground surface.

11.00 in
279 mm

8.50 in
216 mm