

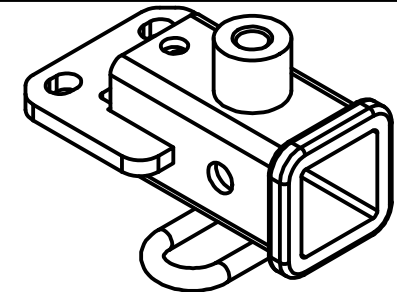

Class III Receiver Hitch

Part No. 69631C



Fits: RAM 1500 (W/ CLASS III FACTORY BUMPER HITCH)



GROSS LOAD CAPACITY WHEN USED AS A WEIGHT CARRYING HITCH: 6,000 LBS. TRAILER WEIGHT & 600 LBS. TONGUE WEIGHT.
GROSS LOAD CAPACITY WHEN USED AS A WEIGHT DISTRIBUTION HITCH: N/A LBS. TRAILER WEIGHT & N/A LBS. TONGUE WEIGHT.



WARNING: * DO NOT EXCEED VEHICLE MANUFACTURER'S RECOMMENDED TOWING CAPACITY. *****

Parts List			
ITEM	QTY	PART NUMBER	DESCRIPTION
2	1	13419-NPWA	WELDMENT ASSEMBLY
2	1	10-10363	FHSCS, 3/4-10 UNC, 3-1/4, GRD8, YZ
3	2	10-10334	HHCS, 1/2-13 UNC, 1-1/2, GRD8, YZ
4	2	30-00149	WASHER, S-CON, 1/2, YZ

TOOLS REQUIRED
3/4" SOCKET
1/2" HEXBIT SOCKET
RATCHET
TORQUE WRENCH

BUMPER BEAM

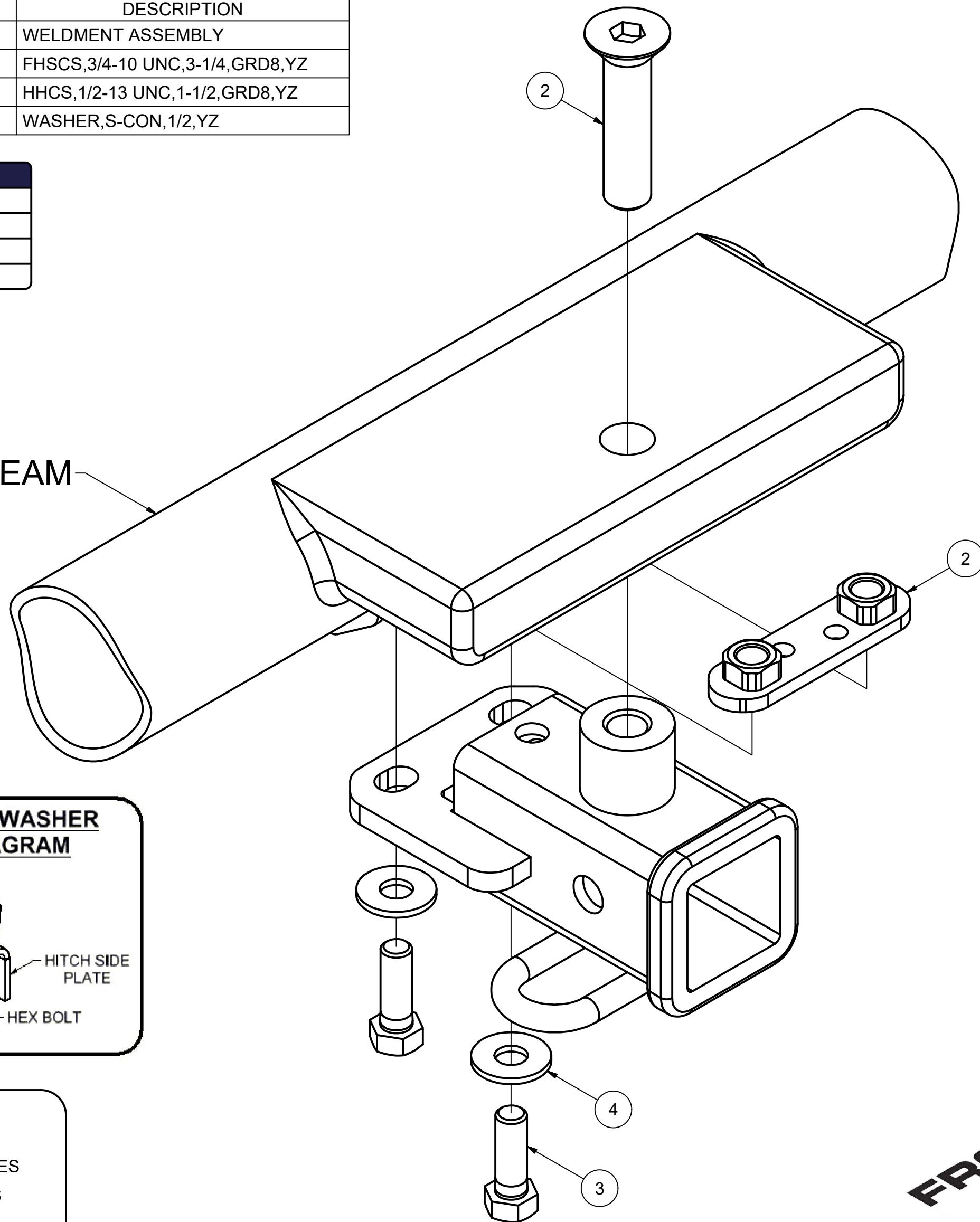

CONICAL TOOTHED WASHER ORIENTATION DIAGRAM

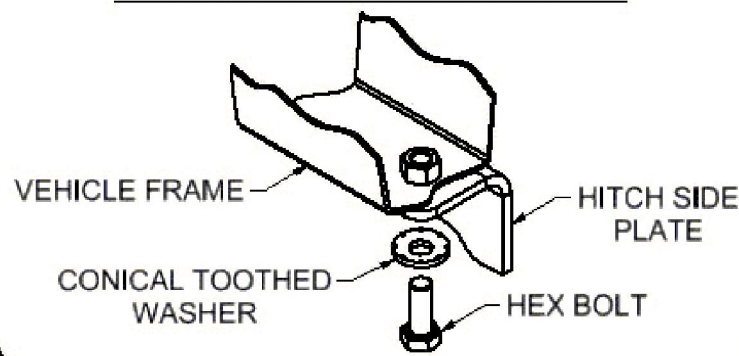

HITCH WEIGHT: 7 LBS.

INSTALL TIME

PROFESSIONAL: 15 MINUTES

NOVICE (DIY): 30 MINUTES

INSTALL NOTES:

NO DRILLING

INSTALLATION STEPS

1. Remove plug from center of bumper step and insert 3/4" bolt. Save plug for reinstallation in Step 4.
2. Place 13419-NPWA on top of vehicle safety chain loop with weldnuts on top.
3. Raise hitch into position and loosely secure with 3/4" bolt followed by 1/2" bolt and conical tooth washer.
4. Torque 3/4" hardware to 320 lb-ft and 1/2" hardware to 110 lb-ft. Reinstall plug removed in Step 1.

PERIODICALLY CHECK THIS RECEIVER HITCH TO ENSURE THAT ALL FASTENERS ARE TIGHT AND THAT ALL STRUCTURAL COMPONENTS ARE SOUND.

Keystone Automotive Operations Inc., warrants this product to be free of defects in material and/or workmanship at the time of retail purchase by the original purchaser. If the product is found to be defective, Keystone Automotive Operations Inc., may repair or replace the product, at their option, when the product is returned, prepaid, with proof of purchase. Alteration to, misuse of, or improper installation of this product voids the warranty. Keystone Automotive Operations Inc.'s liability is limited to repair or replacement of products found to be defective, and specifically excludes liability for incidental or consequential loss or damage. This product complies with safety specifications and requirements for connecting devices and towing systems of the state of New York, V.E.S.C. Regulation V-5 and SAE J684. For Technical & Warranty Support: 1-877-544-4449 Fax- 1-855-242-8922 www.huskytow.com

4/10/2020