



## BARIKADE SETUP GUIDE

Follow these steps to get your safe up and running.

### Step 1: Install a 9V Alkaline Battery.

Barikade is powered by a 9V Alkaline battery that lasts up to one year.

### Step 2: Program the Master Code.

First time users should change the default code as soon as possible to prevent unauthorized access to your safe, so it should be kept confidential.

### Step 3: Program the Biometric Scanner. (Only Biometric Model)

You can program up to 20 unique fingerprints. The 1st and 2nd fingerprints will be recognized as administrative fingerprints and will be used to authorize additional users 3-20.

### Step 4: Register the safe.

Registration provides many benefits including three year warranty, technical support, and ordering replacement keys should you misplace them.

If you have any questions about your safe or need help configuring the system, we encourage you to visit [vaulteksafe.com/support/](http://vaulteksafe.com/support/) and select your model.

## AT A GLANCE

The Vaultek® Barikade® Series 1 is a tough and rugged quick access safe. Its solid structure and penetration resistant design makes it ideal for storing valuables such as firearms, jewelry, cash and other personal items. Powered by a 9V battery, the safe combines high security with complete access control.

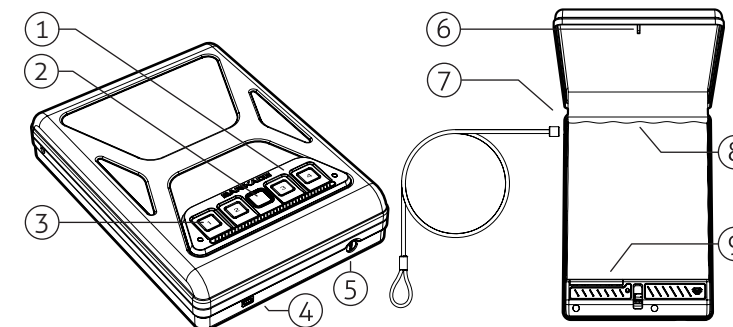

01: Control Panel  
02: Biometric Scanner (Only Biometric Model)  
03: Smart Sense™ Digital Keypad  
04: Micro-USB Port  
05: Manual Key Access

06: Anti-Impact Latch  
07: Steel Security Cable Mount  
08: Interior Mounted Hinges  
09: Battery Compartment and Program Button (Under Battery Door)

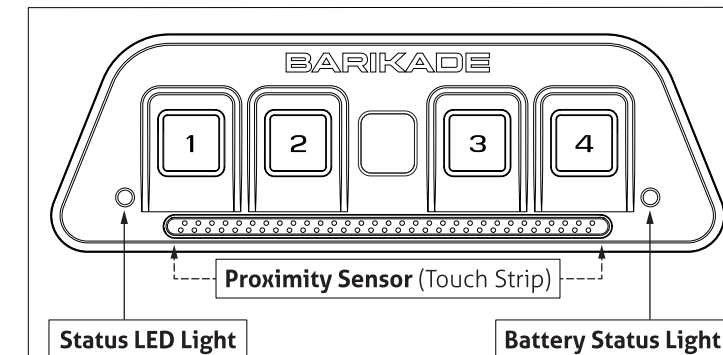

**IMPORTANT!** Before entering the master code you need to wake Barikade by tapping the touch strip so all the keys light up RED.

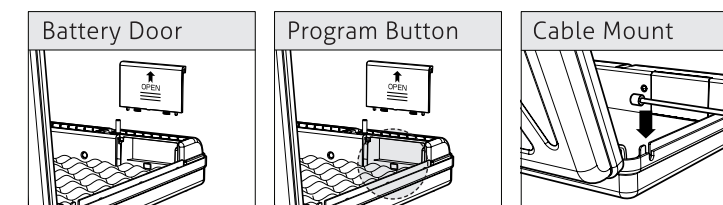

## WARNINGS

To prevent damage to your Vaultek® unit or injury to yourself or to others, read the following safety precautions before using this unit.

- **Before using this safe,** inspect the safe to make sure the door latches properly. You can perform a quick test by using the included mechanical key. Open and close the safe 5 times. Do not use the product if you notice any problem or defect. Please email Vaultek customer support at [support@vaulteksafe.com](mailto:support@vaulteksafe.com).
- **Always check to make sure the safe door has latched when closing.** This safe uses a rugged latch system. When closing press firmly near the center of the front door. Door requires a firm press and will lock automatically when closed properly.
- **Change the default code as soon as possible to prevent unauthorized access to your safe.**
- **DO NOT** lose the keys.
- **DO NOT** place or store the backup keys inside the safe at any time.
- **DO NOT** store loaded guns in this unit. Firearms are serious in nature and must be handled with respect. Store responsibly.
- Keep this product away from small children as the package contains small items that could become a choking hazard.

**Battery Power:** Your safe has power via a 9V Alkaline battery (not included) and needs them for normal function of the keypad and biometric scanner.

**Smart Sense™ Digital Keypad:** Vaultek's exclusive keypad technology uses a proprietary touch-sensitive design that responds to quick simple taps.

**Biometric Scanner:** (Only Biometric Model) Personalized access for up to 20 fingerprints.

**Key:** Two keys are provided for manual access to the safe.

**Security Sleep Mode:** Activates when six (6) consecutive incorrect keypad entries are entered or (6) incorrect fingerprint scans (biometric model) are made. The safe will not accept any entries for four minutes. If any additional attempts are made the alarm will beep. The security sleep mode can be cleared upon unlock of the safe by any authorized access method including the backup keys.

**Before using this safe,** inspect the safe to make sure the lid latches properly. You can perform a quick test by using the included mechanical key. Open and close the safe 5 times. Do not use the product if you notice any problem or defect. Please email Vaultek customer support at [support@vaulteksafe.com](mailto:support@vaulteksafe.com).

## BATTERY

Barikade is powered by a 9v Alkaline battery (not included). Under normal use the battery can last up to one year. We recommend purchasing a name brand battery for best performance.

**In the event the battery dies and you do not have the key,** the safe can be plugged in using a micro-USB cable to power the unit.

**1.** Open the safe. Key entry is located at front of the safe.

**2.** Remove the battery compartment door (Figure A).

**3.** Connect a 9V Alkaline battery to the connector. Be sure to snap the battery in the correct orientation (Figure B).

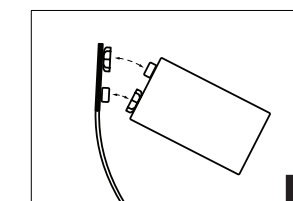
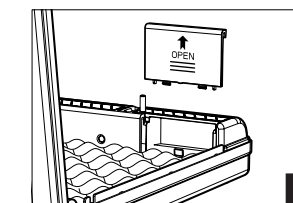

**Troubleshooting!** If you snap the battery in and the keypad is flashing then your battery is likely low. Replace the battery with a new 9v Alkaline battery. We recommend a brand name battery like Duracell or Energizer.

**Quick Setup / Tutorials / Troubleshooting**  
[vaulteksafe.com/support](http://vaulteksafe.com/support) and select your model

MASTER CODE TIPS

- Your code can be as short as 4 digits, or up to 8 digits in length. We recommend a code 6 to 8 digits in length using at least one of each key to make it more difficult for someone to guess.
- Avoid easy-to-guess digits such as 1234, 1111, 2222, etc.
- Two keys cannot be pressed simultaneously.
- The default master code is 1-2-3-4.
- Programming a new master code will overwrite your previous code.

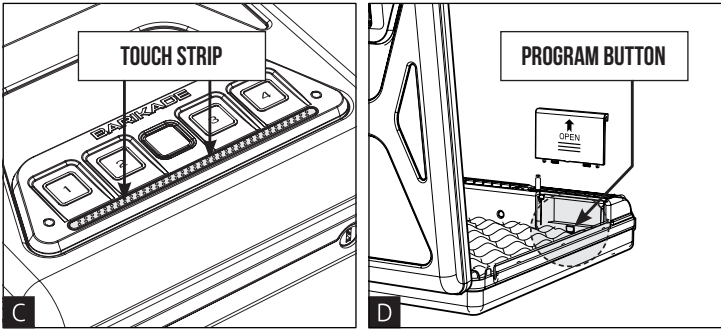

MASTER CODE PROGRAMMING

1. Open the safe lid, and wake the safe by tapping the touch strip so all the keys light up RED (Figure C).
2. While safe is still awake, immediately press and hold the program button (Figure D) until all keys 1-4 light up and you hear the confirmation beep, then let go.
3. Enter your new master code then immediately press and hold the program button a second time until all keys 1-4 light up and you hear the confirmation beep.
4. Enter your new master code a second time then immediately press and hold the program button a third time until all keys 1-4 light up and you hear the confirmation beep. The status ring will light GREEN if successful.

**Troubleshooting!** The safe needs to be awake before programming. Be sure to tap the touch strip near the front of the keypad so all the keys light up RED (step 1) then proceed with steps 2-4.

**Master Code Usage Tip!** Before entering your master code you need to wake Barikade by tapping the touch strip so all the keys light up RED.

BIOMETRIC SCANNER TIPS (Biometric Model Only)

- A user consists of 4 scans of the same finger during registration.
- **Place the core of the fingerprint flat** over the center of the scanner (this allows the scanner to read where most of the fingerprint detail is located) (see Figure E).
- Adjust your finger slightly between scans for increased accuracy (see Figure F).
- Excessive moisture, lotions, or dirt will affect your fingerprint and may cause inaccurate sensor reading.

**Troubleshooting!** If you are having difficulty with your print, program the same fingerprint 4 or 5 times. You have 20 slots available for programming and you can also try your thumb as it has more surface area to read.

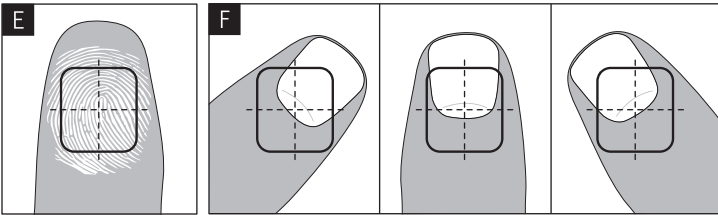

BIOMETRIC SCANNER PROGRAMMING

The 1st and 2nd fingerprints will be recognized as administrative fingerprints and will be used to authorize additional users.

**Tip!** Each fingerprint requires 4 registration scans to be enrolled into the safe.

Programming Admin Prints 1 and 2

1. Open the safe lid, and wake the safe by tapping the touch strip (Figure C) so all the keys light up RED.
2. While safe is awake, quickly tap the program button (Figure D) to get the 1 key blinking. Place your finger on the scanner and remove it when the status LED ring turns GREEN and you hear a confirmation beep.
3. Place your finger on the scanner again at a slight different angle and remove it when the status LED ring turns GREEN. You will repeat this process until all 4 scans are completed. The status LED ring will turn GREEN and you hear a confirmation beep. **This completes enrollment for the first admin print.**

Repeat these steps to enroll the 2nd admin print.

BIOMETRIC SCANNER PROGRAMMING

With both admin prints enrolled, you can enroll additional users. This safe can store up to a total of 20 fingerprints.

Programming Additional Prints 3 to 20

1. Open the safe lid, and wake the safe by tapping the touch strip (Figure C) so all the keys light up RED.
2. While safe is awake, quickly tap the program button (Figure D) to get keypad flashing RED, and the LED around the scanner to illuminate YELLOW. Scan one of the enrolled admin prints to authorize enrolling a new user.
3. With the 1 key now blinking, place the new finger on the scanner and remove it when the status LED ring turns GREEN and you hear a confirmation beep.
4. You will repeat this process until all 4 scans are completed. The status LED ring will turn GREEN and you hear a confirmation beep. This completes enrollment for a new single user.

Repeat steps 1-4 to enroll additional prints.

KEYPAD HOTKEYS

Your safe has a list of hotkey shortcuts.

**Sound:** To toggle the sound ON/OFF press and hold keys '1' and '2' together for 3 seconds. If the status LED glows GREEN, the sound is ON; if the status LED glows RED, the sound is OFF.

**Interior Light:** To toggle the interior light settings press and hold keys '3' and '4' together for 3 seconds to toggle the interior light to OFF, ON for 20 seconds, or ON for 60 seconds. By default the light is toggled to ON for 20 seconds.

- When the light is toggled to OFF the status LED will glow RED for 1 seconds.
- When the light is toggled to ON for 20 seconds the status LED will glow GREEN for 1 second.
- When the light is toggled to ON for 60 seconds the status LED will turn GREEN and blink 3 times.

**Delete Fingerprints: (Biometric Model Only)** To delete fingerprints press and hold keys '2' and '3' at the same time for 3 seconds until all keys (1-4) light up RED then enter your master code. This will remove all the fingerprints.

PRODUCT REGISTRATION

Vaultek strongly encourages you to register your safe as soon as you receive it. **Registration provides many benefits including three year warranty, technical support and ordering replacement keys should you misplace them.** Your Vaultek safe has a unique product number located in several places: on the inside of the battery compartment and on the front of this manual. There is also a unique 4-digit ID number engraved on the keys. You will need these numbers to register your safe.

1. Please visit the Vaultek website at vaulteksafe.com and click Support/Product Registration and enter the required information.

SUPPORT

If you have any questions about your safe or need help configuring the system, we encourage you to visit vaulteksafe.com/support/ and select your model for troubleshooting, FAQs, and helpful videos. You can also email us at support@vaulteksafe.com.

**Visit our mobile-friendly online guide.** Includes tutorial videos at vaulteksafe.com/support and select your model.

FCC

REV 071924

This device complies with part 15 of the FCC rules. Operation is subject to the following two conditions: (1) this device may not cause harmful interference, and (2) this device must accept any interference received, including interference that may cause undesired operation.

NOTE: The manufacturer is not responsible for any radio or TV interference caused by unauthorized modifications or changes to this equipment. Such modifications or changes could void the user's authority to operate the equipment.

**Visit our mobile-friendly online guide.** Includes tutorial videos at vaulteksafe.com/support and select your model.