

Shed Assembly Instructions

SKIAB

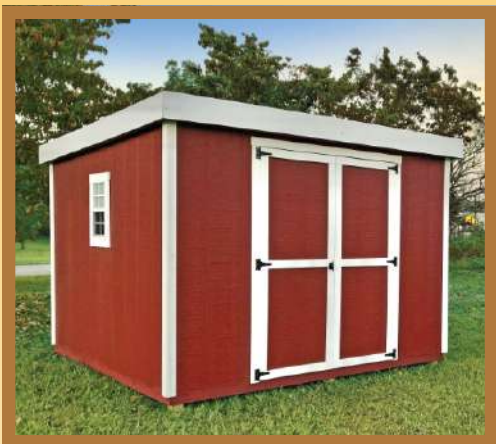

Happy
with our product?

Please help us spread the word
by leaving a review at:

www.OverEZchickencoop.com



Made in the U.S.A.

For more information about all our products, visit: www.OverEZchickencoop.com

Wall and Door Assembly

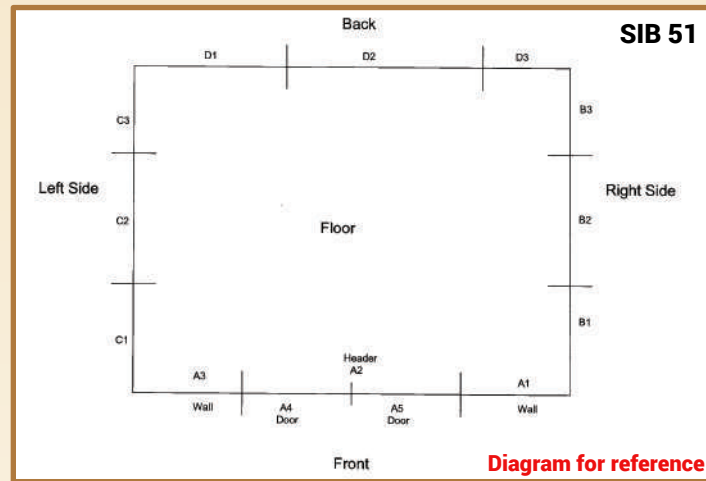

1. Attach A1 wall to Right Front corner floor, marked A1 on Picture SIB 51.



2. Attach B1 Wall to Right Side Front Corner floor, marked B1 on picture SIB 51.

3. Screw A1 and B1 walls together. This forms your first corner.



4. Attach B2 wall to right side floor, marked B2 on picture SIB 51.

5. Screw B1 and B2 walls together.

DO NOT ATTACH WALL B3 AT THIS TIME! Save for last.



6. Attach A3 wall to Left Front corner floor, marked A3 on picture SIB 51.



7. Attach C1 wall to Left side Front corner floor, marked C1 on picture SIB 51.

8. Screw A3 and C1 walls together. This forms your second corner.



9. Attach C2 wall to left side floor, marked C2 on picture SIB 51.

10. Screw C1 and C2 walls together.



11. Attach C3 wall to left back corner floor, marked C3 on picture SIB 51.

12. Screw C2 and C3 walls together.



13. Attach D1 wall to left back corner floor, marked D1 on picture SIB 51.

14. Screw C3 and D1 walls together. This forms your 3rd corner.



Rafter Assembly



15. Attach D2 wall to back center floor, marked D2 on picture SIB 51.

16. Screw D1 and D2 walls together.



17. Attach D3 wall to Right back corner floor, marked D3 on picture SIB 51.

18. Screw D2 and D3 walls together.



19. Attach B3 wall to right side back corner floor, marked B3 on picture SIB 51.

20. Screw D3 and B3 walls together. This completes your last corner.



21. Attach A2 Door Header to A1 wall and A3 wall. This completes the walls.

Place 1/2 inch spacer stick on floor to set Doors on.



22. Hang A4 left Door.

23. Hinge A5 Right Door.

24. Remove 1/2 inch spacer stick from under Doors.

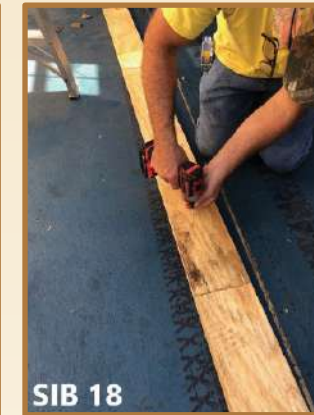

1. Screw R1-A & R1-B together, making one long Rafter.

2. Repeat Step #1 for Rafters R2, R3, R4, and R5.

3. R6-A and R6 B **do not** get screwed together. They attach directly to the top of the back wall.

Hang Rafters



1. Hang R1 Rafter setting it tight against the front wall. Side wall over hang should be the same on both sides.

Attach with metal brackets.



2. Hang R2 Rafter at marked location. Use metal bracket. Over hang should be even on each side.



3. Repeat step #2 for R3, R4, and R5.



4. Hang R6-A rafter by screwing it on top of the left back Wall. Make sure the over hang is the same as other rafters.

5. Hang R6-B rafter by screwing it on top of right back wall. Make sure the over hang is the same as other rafters.

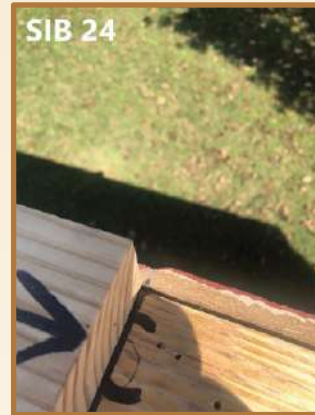

Hang Facia Board

- 1.** Hang Facia Board A&B on right Side. Attach to Rafter ends.
- 2.** Repeat for Left Side.



Hang Soffit Boards

- 1.** Hang Soffit Boards A&B to Right Side. Attach to bottom edge of Facia boards.
- 2.** Repeat for Left Side.

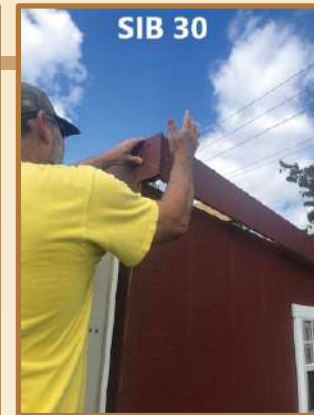

Attach Corner Fillers

- 1.** Attach Corner fillers to all four corners.

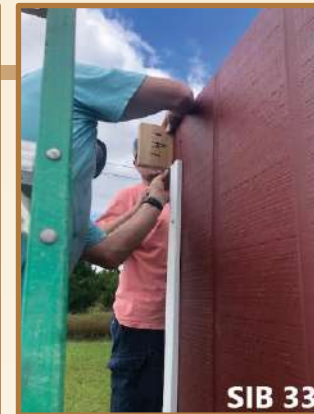

Attach Front Soffit Blocks

- 1.** Attach Soffit blocks A, B, C, D, & E to front of shed match to the top.



Attach Front Soffit

- 1.** Attach soffit A & B to bottom of blocks.



White Corner Trim

- 1.** Attach Right and Left Front Corner Trim.
- 2.** Attach Right and Left Rear Corner Trim.

Shed Roof Assembly

Attach Roof Metal

DO NOT GET ON THE ROOF

Start on a ladder on the outside of shed. Then move ladder to inside and work your way across the building.

Move ladder to outside and finish back row.

Repeat this process for the Front row.

DO NOT GET ON THE ROOF



1. Hang Right Rear Corner piece First. Leave a 5-inch overhang in the rear. Match even to edge of Rafters. Run screws into rafters.

Do not over tighten screws. Only put 2 screws in this piece, on the right edge to start.

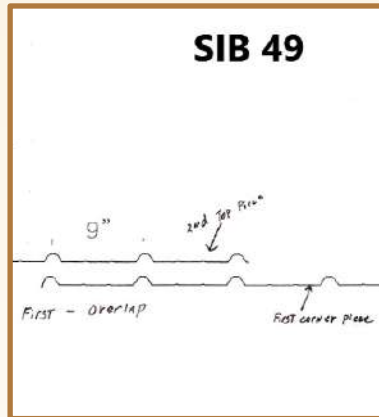

2. The 2nd roof panel must overlap the first piece by 1/2 a sheet. Finish screwing first panel down going through panel one and panel two.

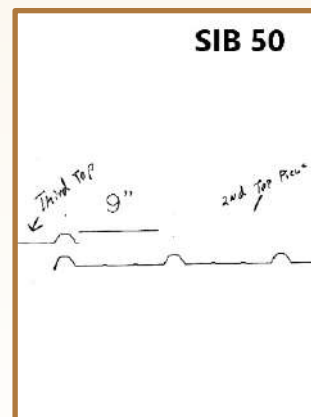

3. The 3rd roof panel will overlap the 2nd roof panel by one ridge only. Screw panel down.



4. The 4th roof panel will overlap the 3rd roof panel by one ridge. The 4th panel should be even with left side eaves. + or - a little.

Screw panel down. This should complete the rear roof panels.

5. Hang right front panel. Match Front edge with Front eave overhang. Match even to edge of rafters.

6. Repeat steps 2, 3, 4, & 5. This should complete your roof panels.



Metal Roof Trim



1. Hang rear trim by sliding under roof panels. Screw this trim on the side.

2. Hang Right Top side trim. Hang rear side trim piece first. The front top side trim should overlap the rear side trim.

Screw down on top and side.



3. For Left side repeat step #2.

4. Hang Front top trim. Hang left front trim first. Then hang Right front trim next.





SKLAB



www.OverEZchickencoop.com