

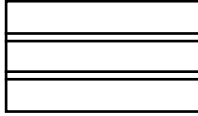

**ASSEMBLY GUIDE  
GUIDE DE MONTAGE  
GUÍA DE MONTAJE**

**CLASSIC**  
CLASSIQUE  
CLÁSICO



# SPRINGPORT ARBOR

TONNELLE DE SPRINGPORT  
CENADOR DE SPRINGPORT

**VA68146**

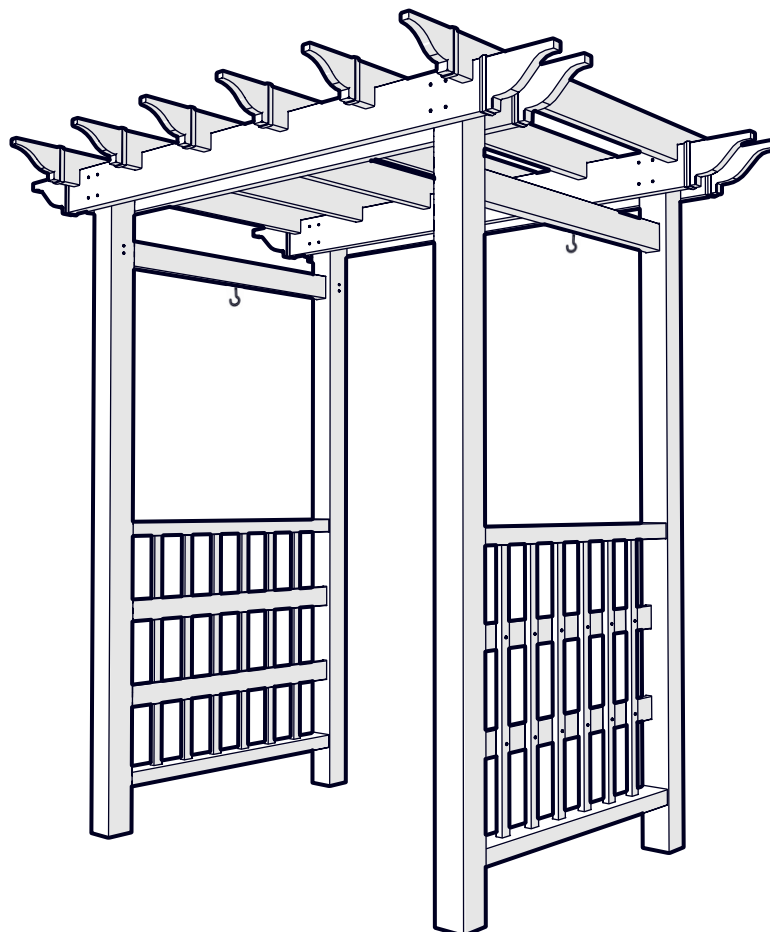

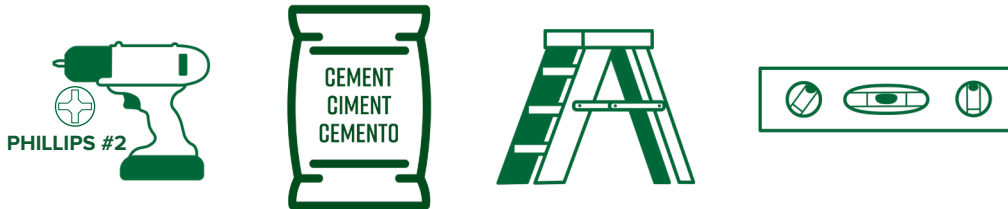

REQUIRED TOOLS AND MATERIALS (NOT INCLUDED)  
OUTILS ET MATÉRIAUX REQUIS (NON INCLUS)  
HERRAMIENTAS Y MATERIALES REQUERIDOS (NO INCLUIDOS)



HELLO@WEAREVITA.COM



VISIT [WWW.WEAREVITA.COM](http://WWW.WEAREVITA.COM)  
CLICK 'CHAT'



1-800-282-9346  
MONDAY - FRIDAY | 8AM - 5PM EST



**PRODUCT DIMENSIONS    DU PRODUIT DIMENIONES    DEL PRODUCTO**

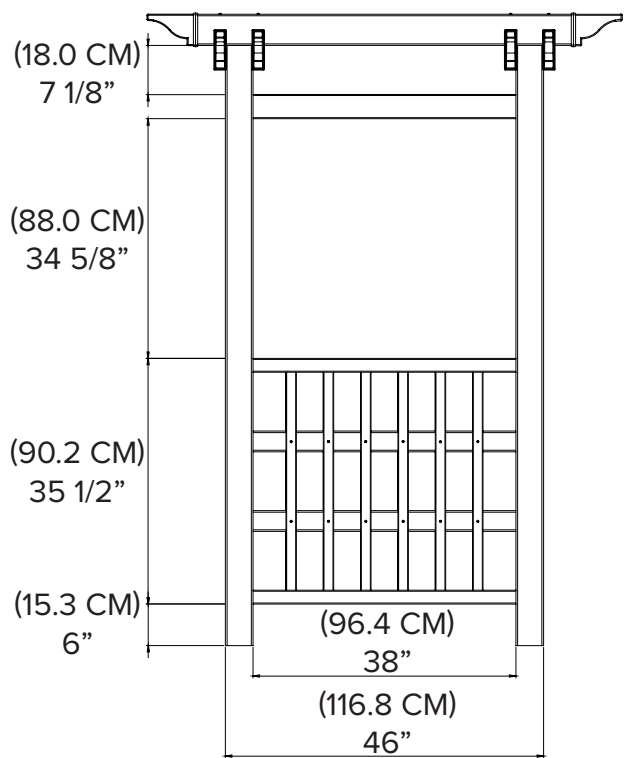
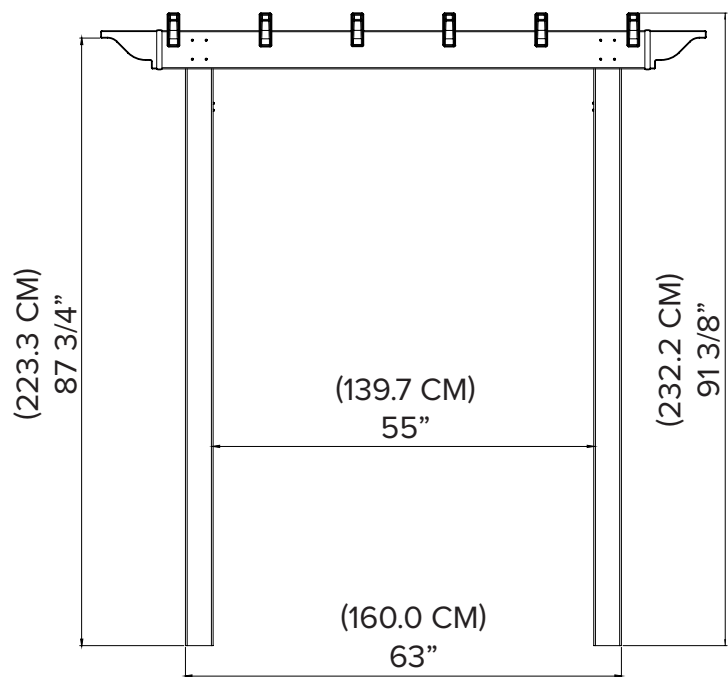
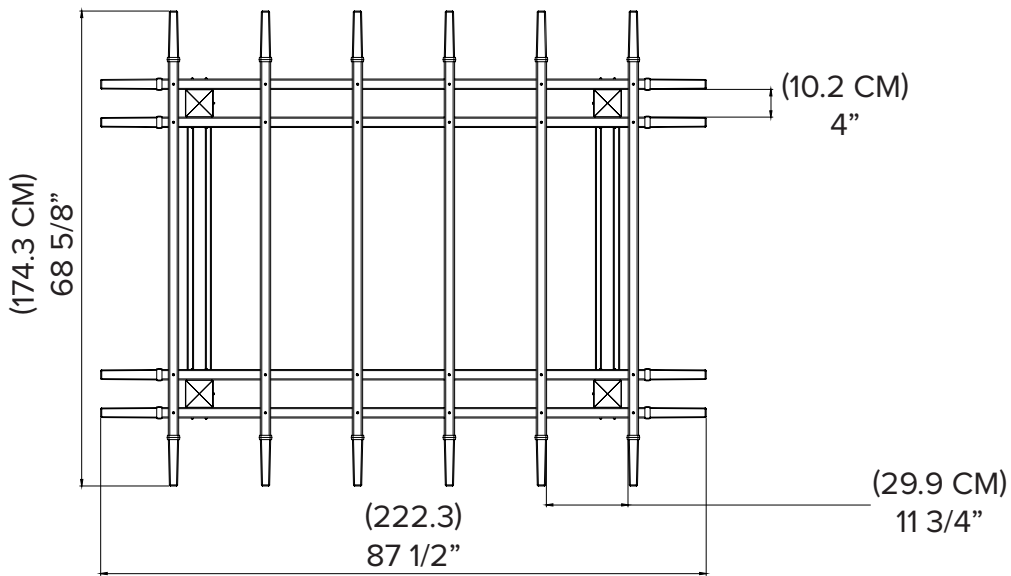

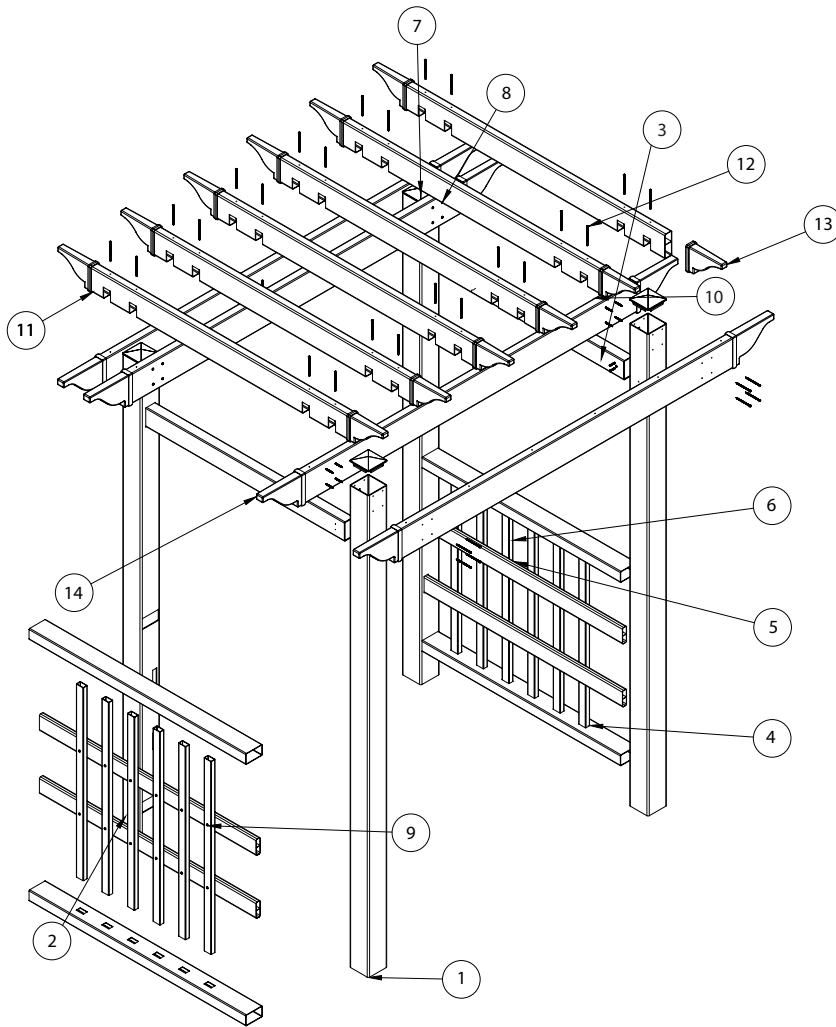

ITEM NO#	PART NUMBER	PART NAME	DIMENSION	QTY.
1	11187	LEFT POST	88" (223.5 CM)	2
2	11188	RIGHT POST	88" (223.5 CM)	2
3	11189	HANGING RAIL	45 3/4 (116.1 CM)	2
4	11190	HORIZONTAL RAIL	45 3/4 (116.1 CM)	4
5	11191	HORIZONTAL BEAM	45 3/4 (116.1 CM)	4
6	11192	VERTICAL BEAM	35 1/4" (89.5 CM)	12
7	10824	POST CAP	4" X 4" (10 CM X 10 CM)	4
8	20007	SCREW	3" (7.6 CM)	44
9	20080	SCREW	1 1/4" (3.2 CM)	24
10	11193	LARGE RAFTER	71" (180.4 CM)	4
11	11194	SMALL RAFTER	55" (139.6 CM)	6
12	20039	SCREW	3 1/2" (8.9 CM)	24
13	10700-1	SMALL END CAP	4 1/2 (11.5 CM)	12
14	30015	LARGE END CAP	5 1/2" (13.9 CM)	8
15	20000	GLUE	1 1/2 OZ	2
16	17091	EYE HOOK	2" (5.1 CM)	2

# COMPLETELY UNPACK AND TAKE INVENTORY OF PARTS BEFORE BEGINNING

DEBALLEZ COMPLETEMENT ET FAITES L'INVENTAIRE DES PIÈCES AVANT DE COMMENCER

ANTES DE COMENZAR, DESEMBALE COMPLETAMENTE EL PRODUCTO Y REALICE UN INVENTARIO DE LAS PIEZAS

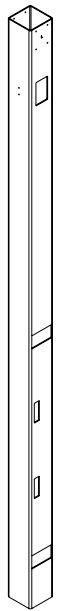

X2  
①

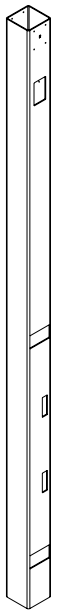

X2  
②

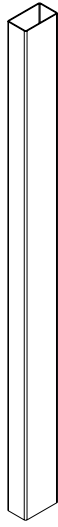

X2  
③



X4  
④



X4  
⑤

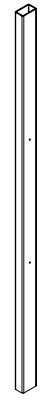

X12  
⑥

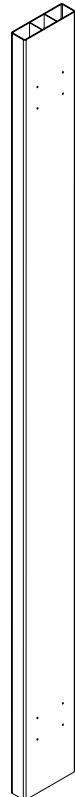

X4  
⑩

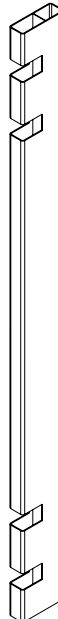

X6  
⑪



x44  
⑧

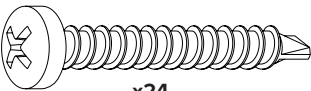

x24  
⑨

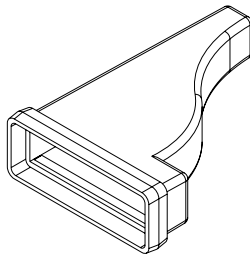

X12  
⑬

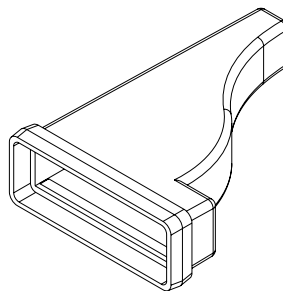

X8  
⑭

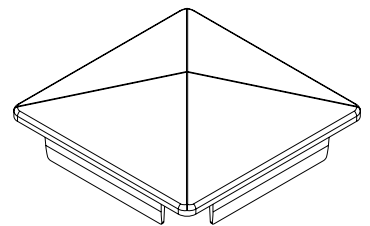

X4  
⑦



x24  
⑫



X2  
⑮

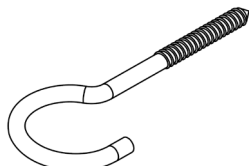

X2  
⑯

## ALIGN AND SECURE YOUR LATTICE

ALIGNEZ ET FIXEZ VOTRE TREILLAGE  
ALINEE Y ASEGURE EL ENREJADO

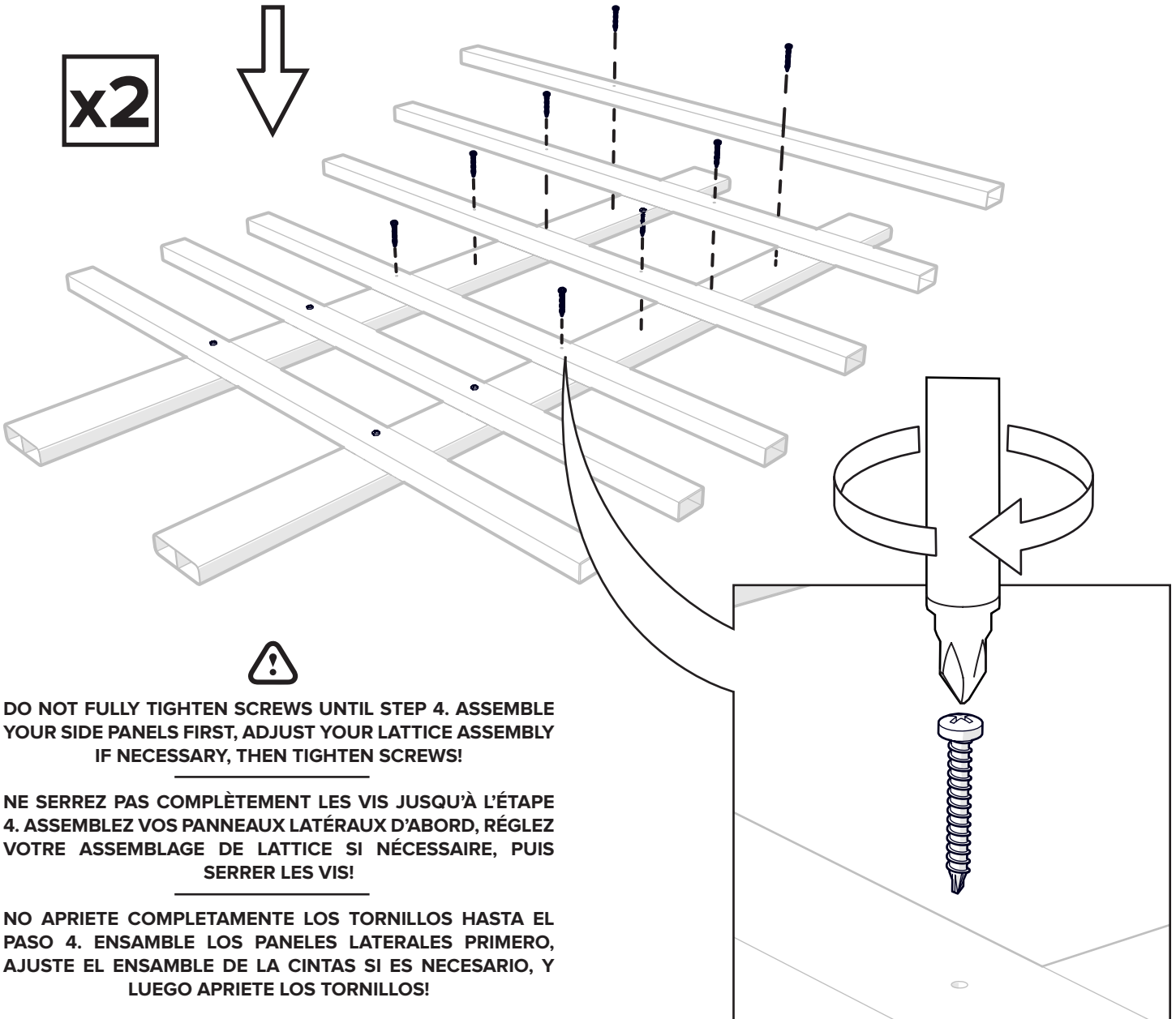
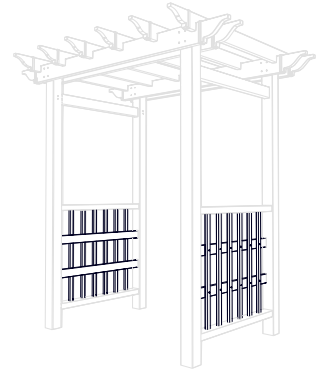
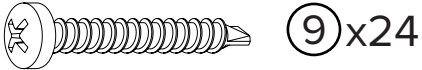
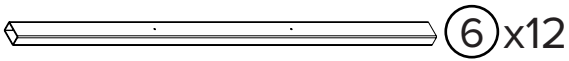
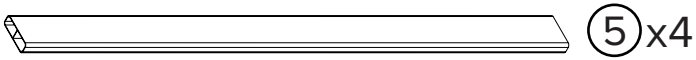

x2



**DO NOT FULLY TIGHTEN SCREWS UNTIL STEP 4. ASSEMBLE YOUR SIDE PANELS FIRST, ADJUST YOUR LATTICE ASSEMBLY IF NECESSARY, THEN TIGHTEN SCREWS!**

**NE SERREZ PAS COMPLÈTEMENT LES VIS JUSQU'À L'ÉTAPE 4. ASSEMBLEZ VOS PANNEAUX LATÉRAUX D'ABORD, RÉGLEZ VOTRE ASSEMBLAGE DE LATTICE SI NÉCESSAIRE, PUIS SERRER LES VIS!**

**NO APRIETE COMPLETAMENTE LOS TORNILLOS HASTA EL PASO 4. ENSAMBLE LOS PANELES LATERALES PRIMERO, AJUSTE EL ENSAMBLE DE LA CINTAS SI ES NECESARIO, Y LUEGO APRIETE LOS TORNILLOS!**



## 2 ATTACH YOUR TOP AND BOTTOM RAILS

ATTACHEZ LES RAILS SUPÉRIEUR ET INFÉRIEUR  
ACOPLE LOS RIELES SUPERIOR E INFERIOR

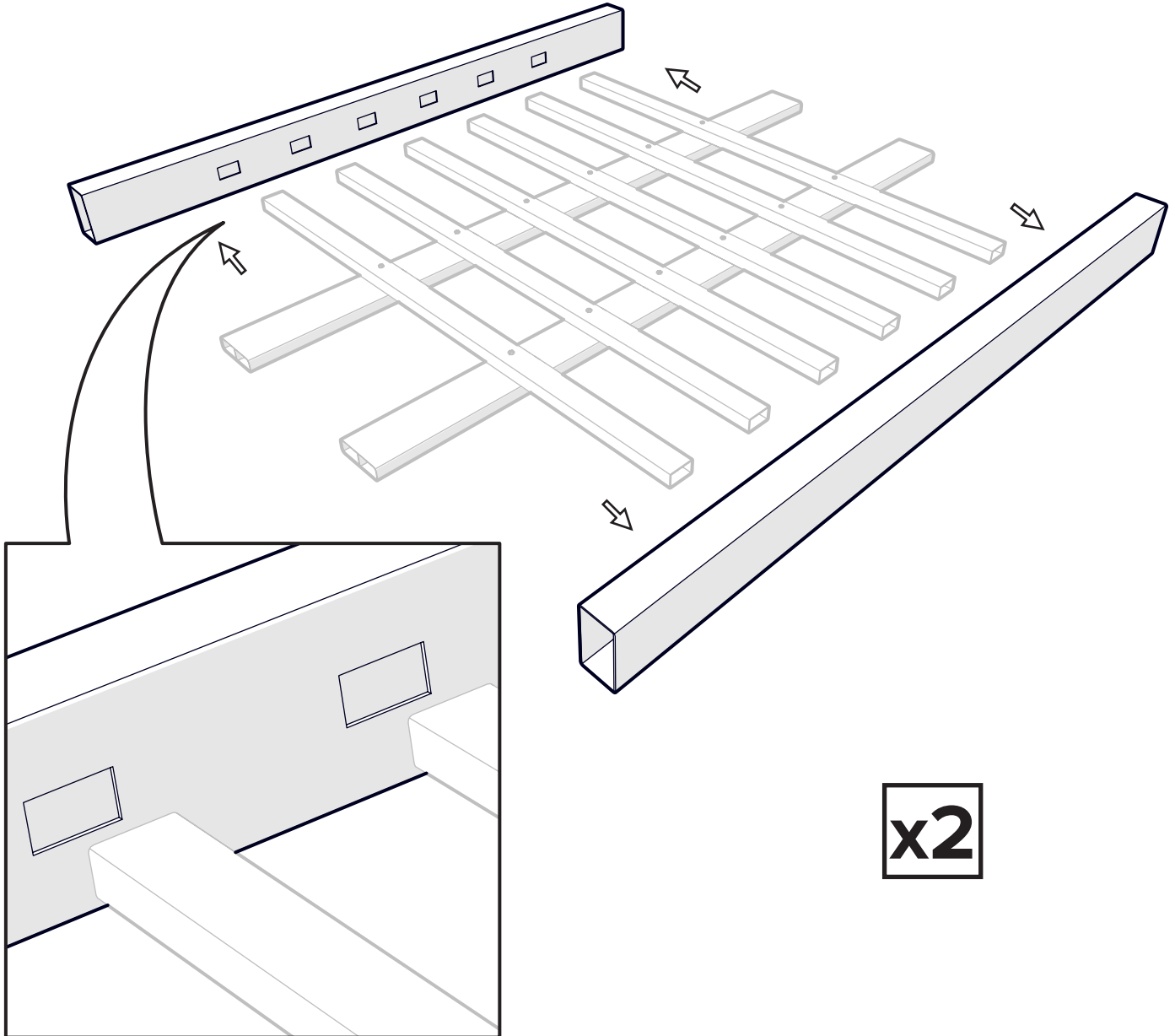
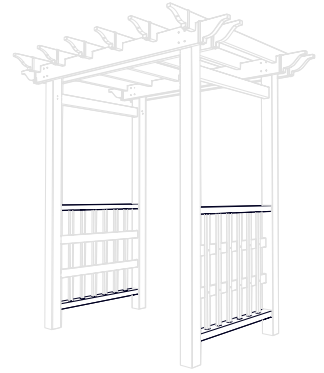

### 3 ATTACH YOUR LEFT AND RIGHT POST

ATTACHEZ LES POTEAUX DROIT ET GAUCHE  
ACOPLE LOS POSTES IZQUIERDO Y DERECHO

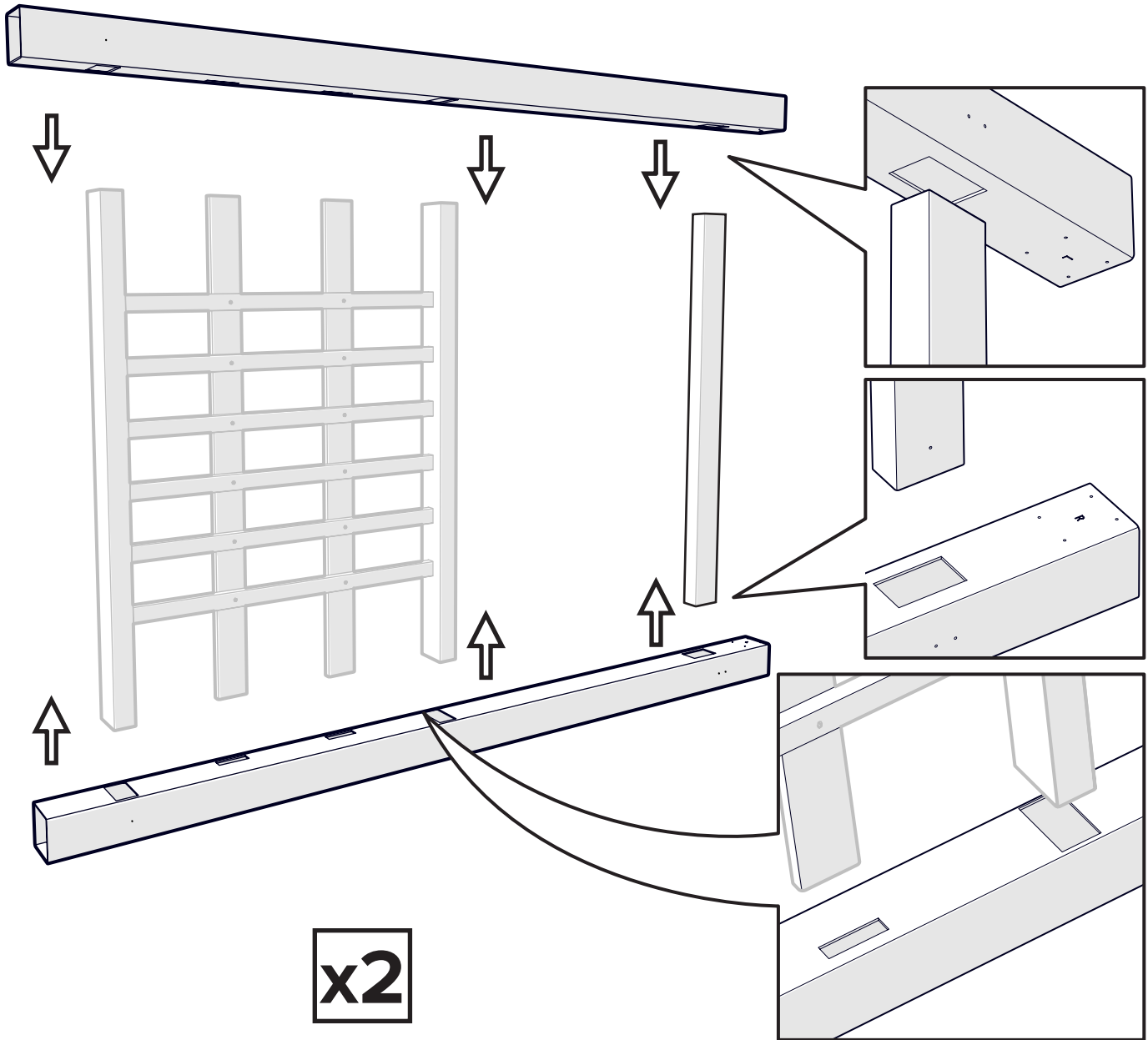
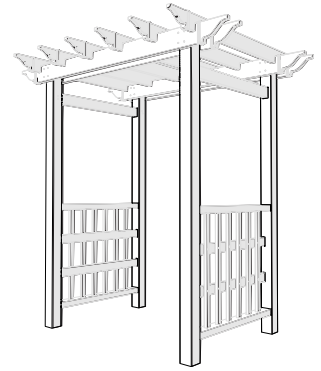
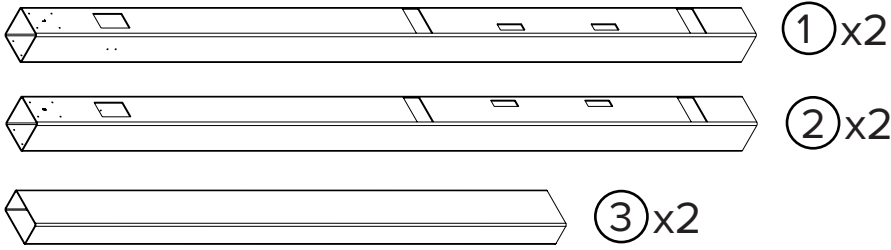



# 4 SECURE YOUR LEFT AND RIGHT POST

FIXEZ LES POTEAUX DROIT ET GAUCHE  
ASEGURE LOS POSTES IZQUIERDO Y DERECHO

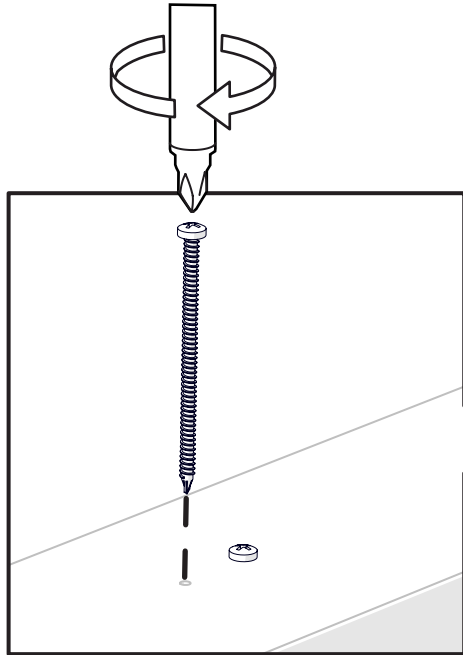
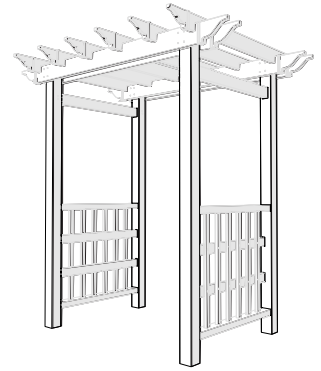
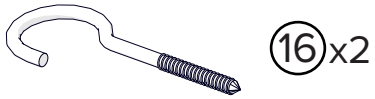

MAKE SURE TO ADJUST YOUR LATTICE IF NECESSARY, THEN FULLY TIGHTEN YOUR SCREWS!

ASSUREZ-VOUS D'AJUSTER VOTRE TREILLIS SI NÉCESSAIRE, PUIS SERREZ À FOND VOS VIS!

¡ASEGÚRESE DE AJUSTAR SU CELOSÍA SI ES NECESARIO, LUEGO APRIETE COMPLETAMENTE LOS TORNILLOS!

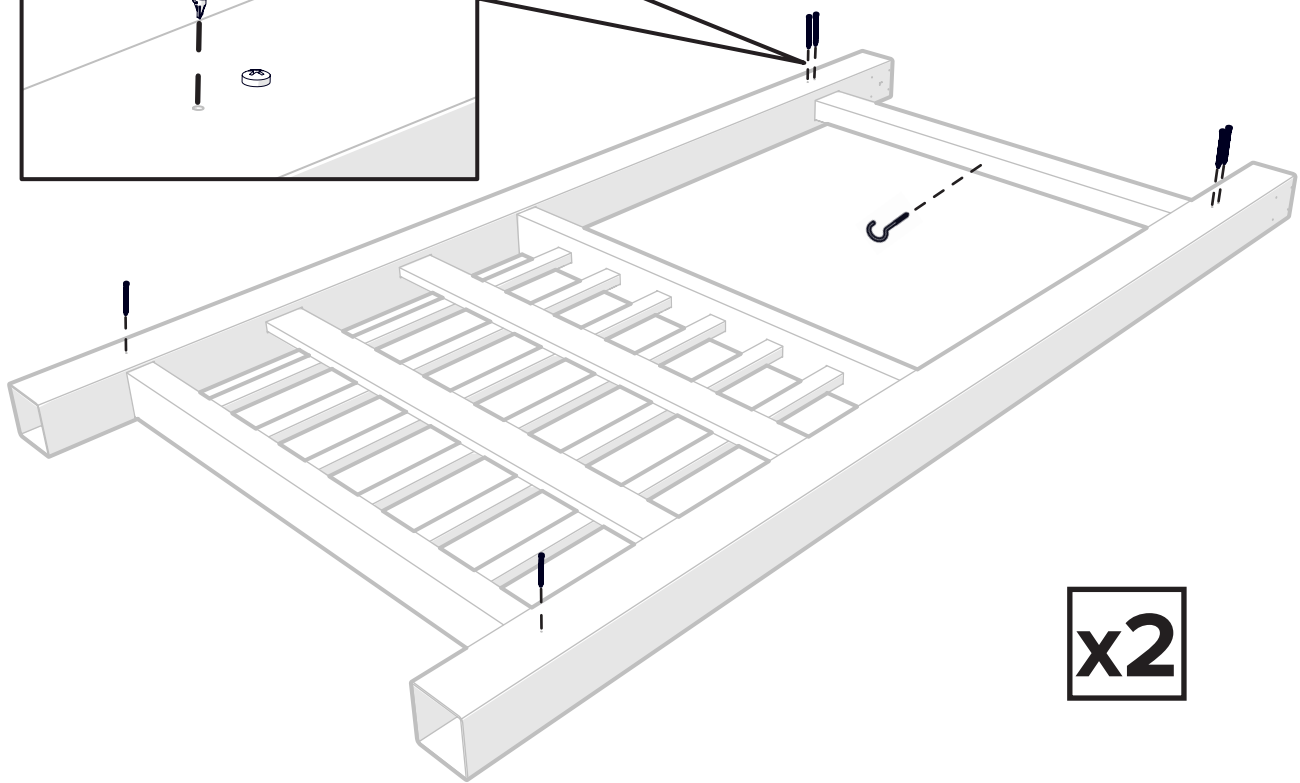

# 5 GLUE YOUR END CAPS TO YOUR MAIN BEAMS

COLLEZ LES EMBOUTS SUR VOTRE POUTRE PRINCIPALE  
PEGUE LAS TAPAS A LOS EXTREMOS DE LA VIGA PRINCIPAL

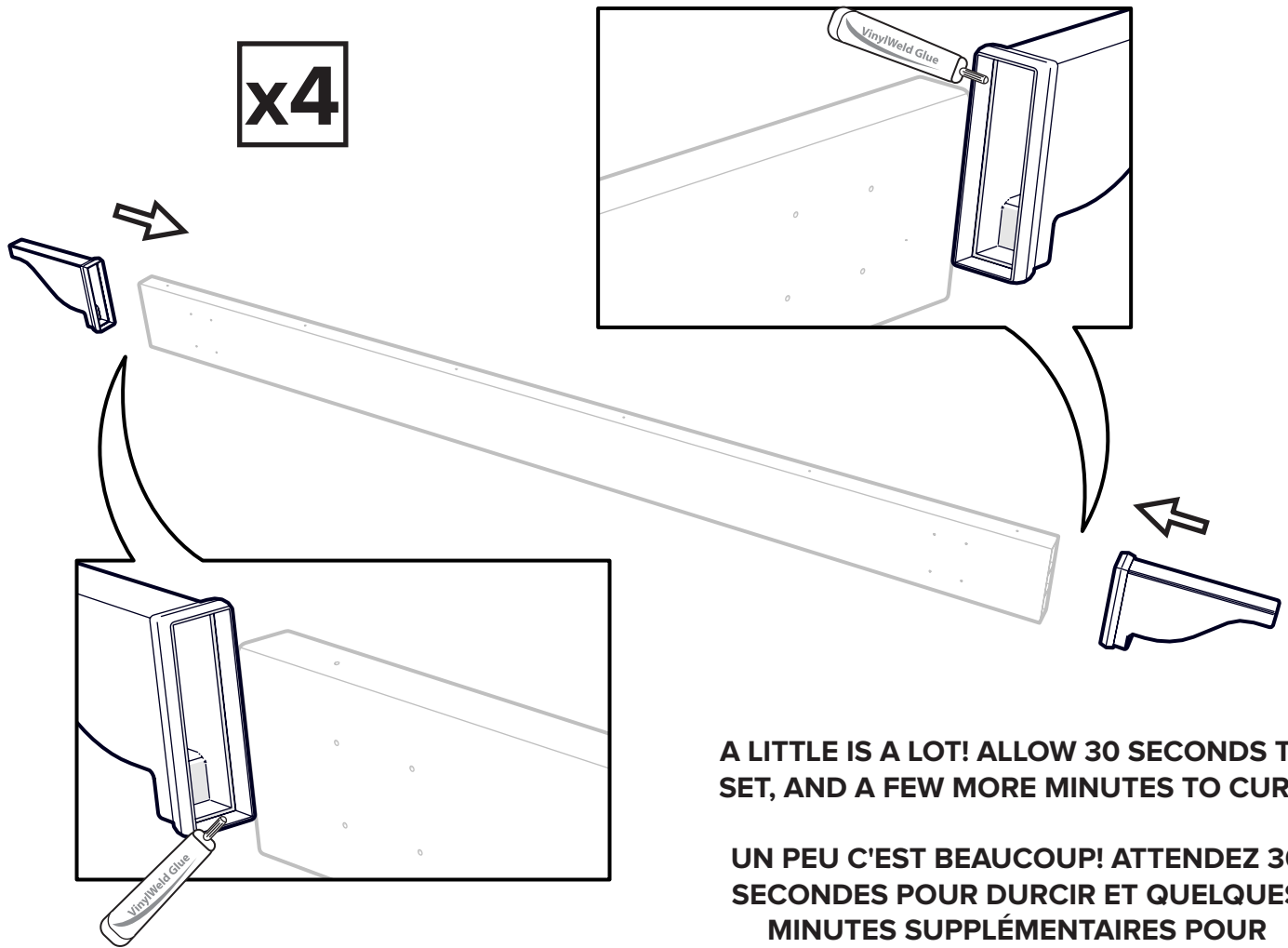
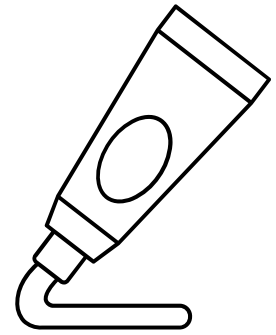
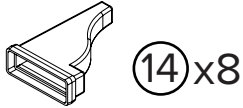
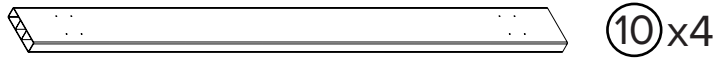

**A LITTLE IS A LOT! ALLOW 30 SECONDS TO SET, AND A FEW MORE MINUTES TO CURE!**

**UN PEU C'EST BEAUCOUP! ATTENDEZ 30 SECONDES POUR DURCIR ET QUELQUES MINUTES SUPPLÉMENTAIRES POUR DURCIR!**

**¡UN POCO ES MUCHO! ¡DEJE QUE SE SEQUE DURANTE 30 SEGUNDOS Y UNOS MINUTOS MÁS PARA QUE SE CURE!**

# 6 GLUE YOUR END CAPS TO YOUR RAFTERS

COLLEZ LES EMBOUTS SUR LES CHEVRONS  
PEGUE LAS TAPAS A LAS VIGAS TRANSVERSALES

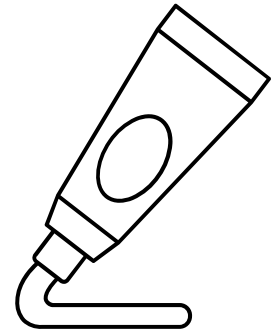
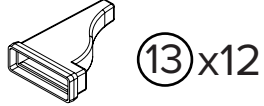
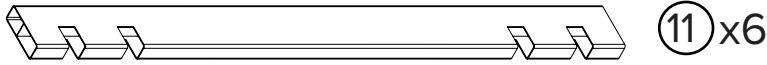

**x6**

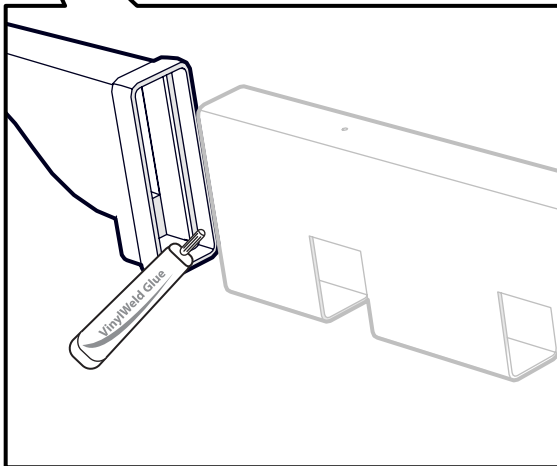
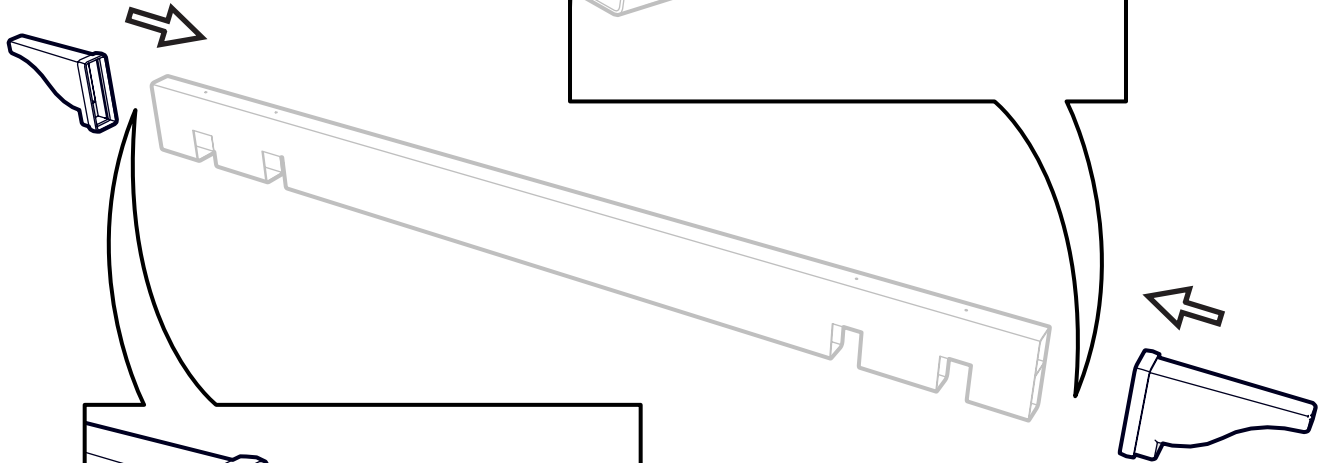
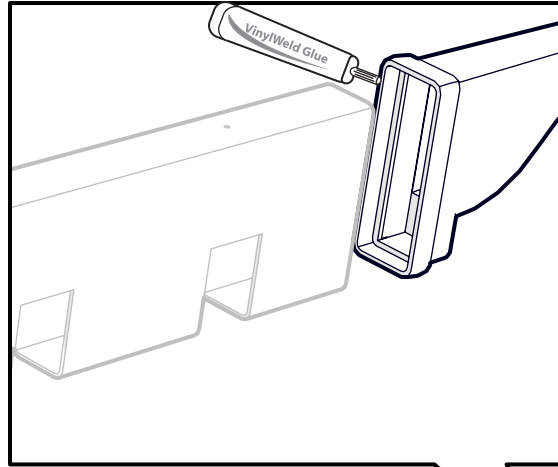

**A LITTLE IS A LOT! ALLOW 30 SECONDS TO SET, AND A FEW MORE MINUTES TO CURE!**

**UN PEU C'EST BEAUCOUP! ATTENDEZ 30 SECONDES POUR DURCIR ET QUELQUES MINUTES SUPPLÉMENTAIRES POUR DURCIR!**

**¡UN POCO ES MUCHO! ¡DEJE QUE SE SEQUE DURANTE 30 SEGUNDOS Y UNOS MINUTOS MÁS PARA QUE SE CURE!**

# 7

CUT FOUR LENGTHS OF 3 1/2" X 3 1/2" X 3' LUMBER AND SECURE TO BOTTOM POSTS OF ARBOR. DIG 4 HOLES 8" (20.3 CM) DIAMETER X 30" (78.2 CM) DEEP, AND 59" (149.8 CM) X 42" (106.6 CM) FROM CENTER TO CENTER. SET DIRT ASIDE. FILL EACH HOLE WITH 1 BAG OF QUICK MIX CONCRETE MIX PER HOLE. WITH A HELPER, CAREFULLY LEVEL AND PLUMB YOUR ARBOR. USE A FEW BRICKS OR SOME WOOD TO HELP SECURE THE ARBOR FROM SINKING. BACK-FILL WITH THE REMOVED SOIL ONCE CONCRETE HAS CURED AND PACK TIGHTLY, THEN MOVE ON TO STEP 8.

COUPER QUATRE LONGUEURS DE BOIS DE 3 1/2" X 3 1/2" X 3' ET FIXER AUX POTEAUX INFÉRIEURS DE LA TONNELLE. CREUSEZ 4 TROUS DE 20,3 CM DE DIAMÈTRE X 78,2 CM DE PROFONDEUR ET 149,8 CM X 106,6 CM DE CENTRE À CENTRE, ÉCARTEZ LA TERRE DE CREUSEMENT, REMPLISSEZ CHAQUE TROU AVEC UN SAC DE BÉTON À PRISE RAPIDE. AVEC UN NIVEAU, NIVELEZ ET FIXEZ VOTRE TREILLIS SOIGNEUSEMENT. UTILISEZ QUELQUES BRIQUES OU DU BOIS POUR SÉCURISER ET EMPÊCHER VOTRE TREILLIS DE S'ENFONCER. COMBLEZ A NOUVEAU UNE FOIS QUE LE BÉTON À PRIS AVEC LA TERRE QUE VOUS AVIEZ MISE DE CÔTÉ ET TASSEZ FERMEMENT, PUIS PASSEZ A L'ÉTAPE 8.

CORTE CUATRO PEDAZOS DE MADERA DE 3 1/2" X 3 1/2" X 3' Y ASEGÚRELOS A LOS POSTES INFERIORES DE LA ENRAMADA. CAVE 4 ORIFICIOS DE 20,3 CM DE DIÁMETRO Y 78,2 CM DE PROFUNDIDAD, A UNA DISTANCIA DE 149,8 CM X 106,6 CM ENTRE SUS CENTROS. APARTE LA TIERRA RETIRADA. RELLENE LOS HOYOS CON UNA BOLSA DE CONCRETO DE MEZCLA RÁPIDA POR CADA UNO DE ELLOS. CON UN AYUDANTE, NIVELE CUIDADOSAMENTE Y UTILICE UNA PLOMADA PARA ALINEAR SU GLORIETA. USE ALGUNOS LADRILLOS O UN POCO DE MADERA PARA ASEGURARSE DE QUE LA GLORIETA NO SE HUNDA. UNA VEZ QUE EL CONCRETO SE HAYA SECADO, VUELVA A RELLENAR CON LA TIERRA RETIRADA ANTERIORMENTE Y COMPRIMA BIEN, LUEGO AVANCE AL PASO 8.

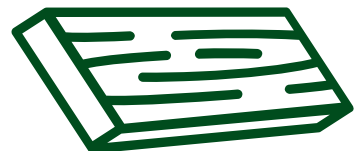
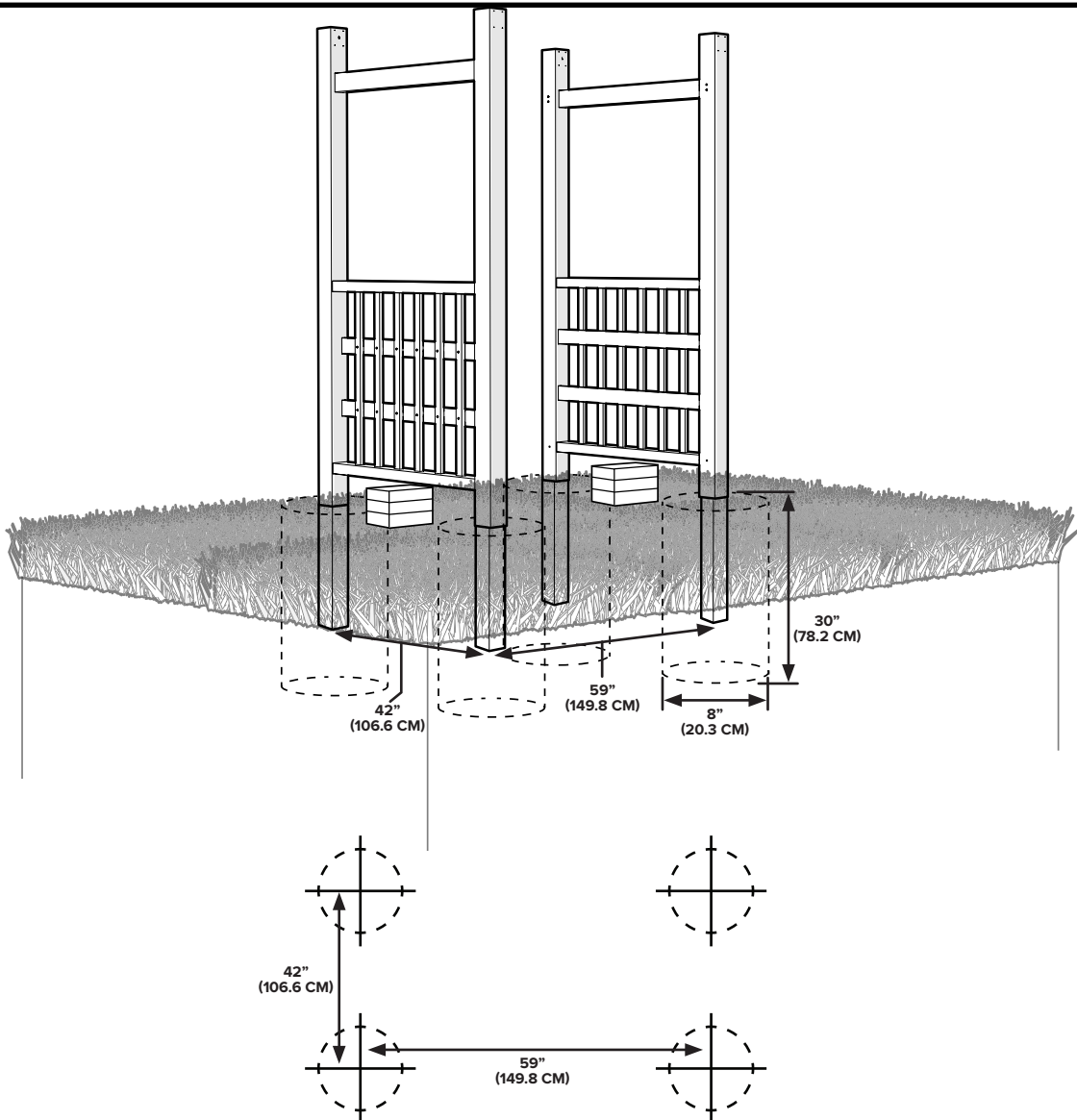

# 8 ATTACH AND SECURE YOUR MAIN BEAMS

ATTACHEZ ET FIXEZ LES POUTRES PRINCIPALES  
ACOPLE Y ASEGURE LAS VIGAS PRINCIPALES



⑧x32

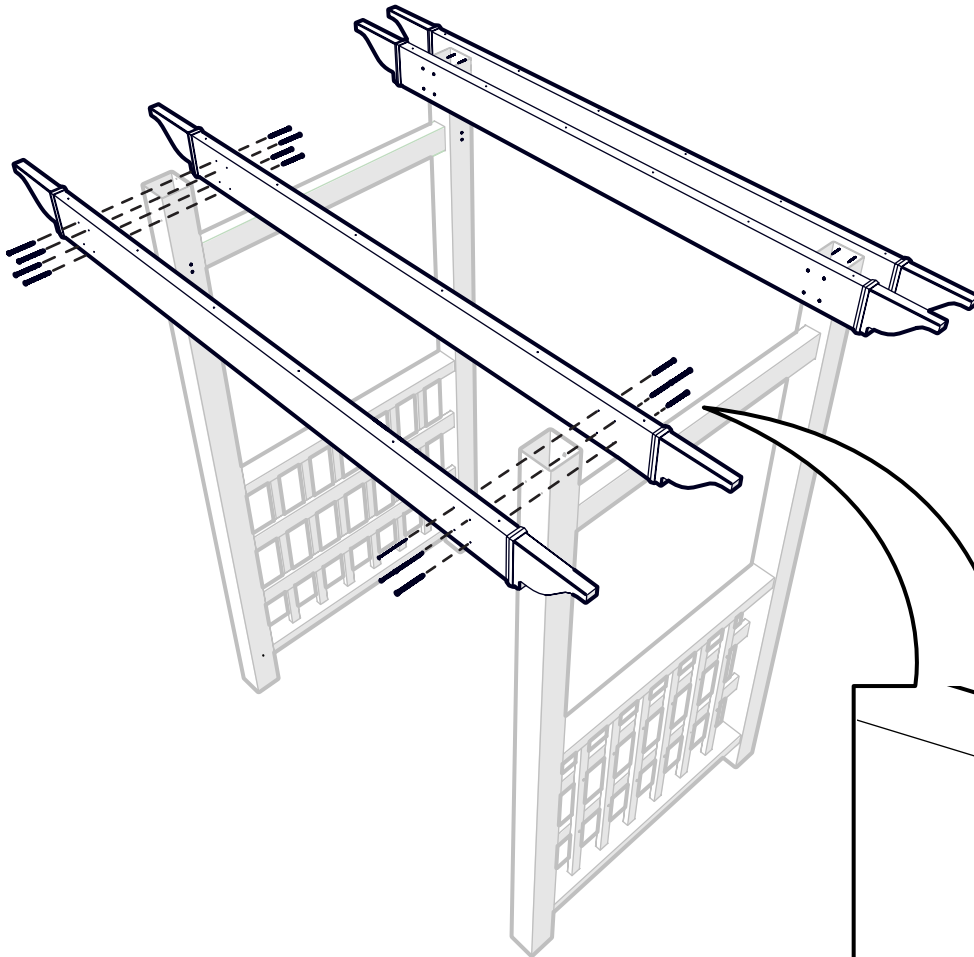

x2

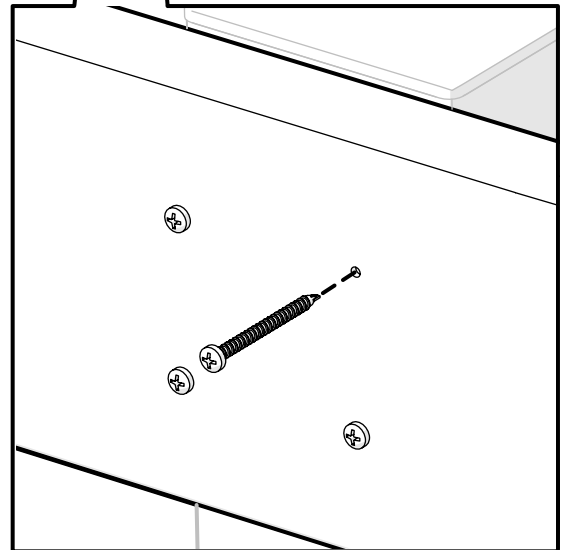

# 9 ATTACH AND SECURE YOUR RAFTERS

ATTACHEZ ET FIXEZ LES CHEVRONS  
ACOPLE Y ASEGURE LAS VIGAS TRANSVERSALES

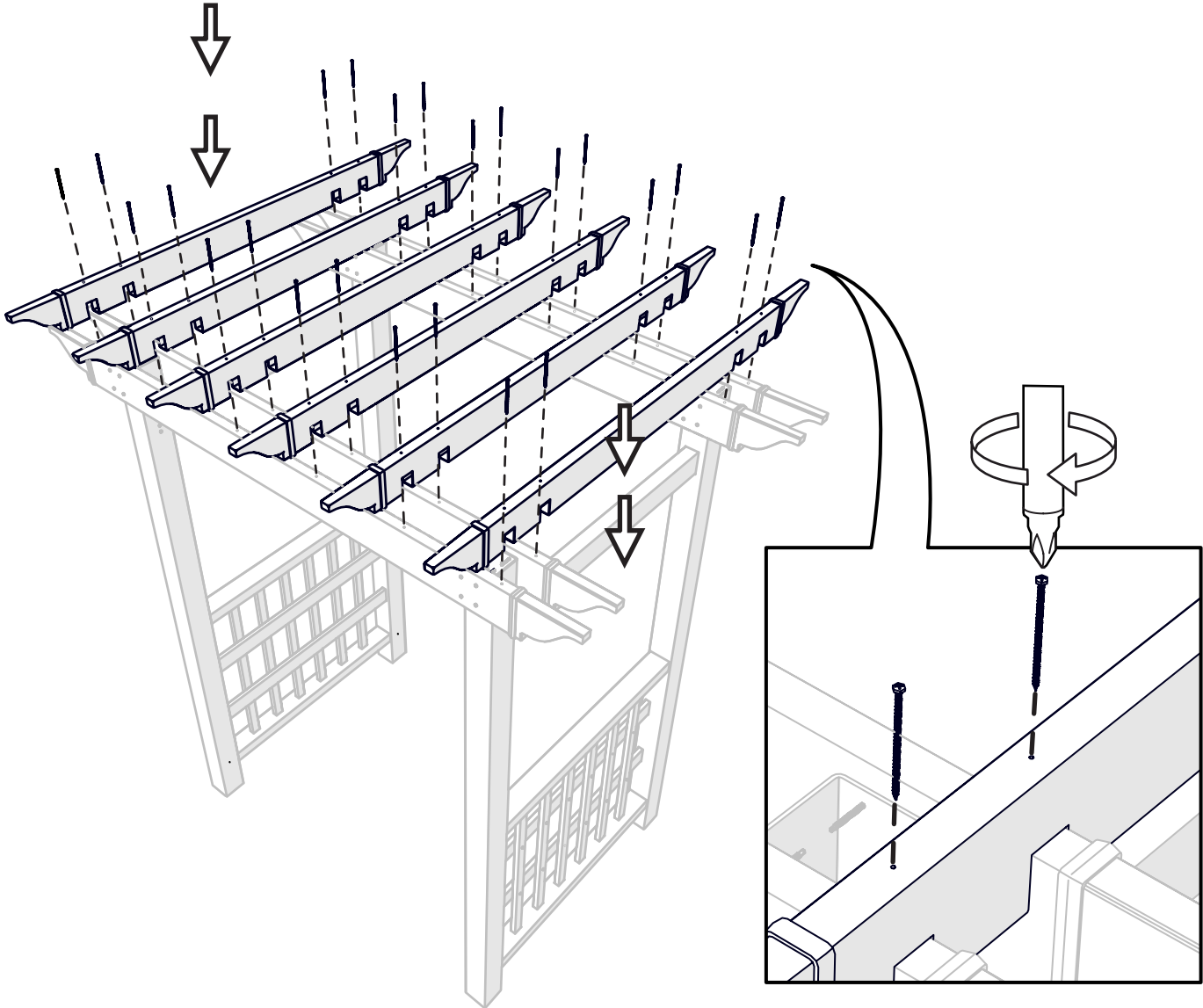

# 10 GLUE YOUR FLAT POST CAPS ONTO YOUR POST

COLLEZ LES EMBOUTS PLATS DES POTEAUX SUR LES POTEAUX  
PEGUE LAS TAPAS PLANAS AL POSTE

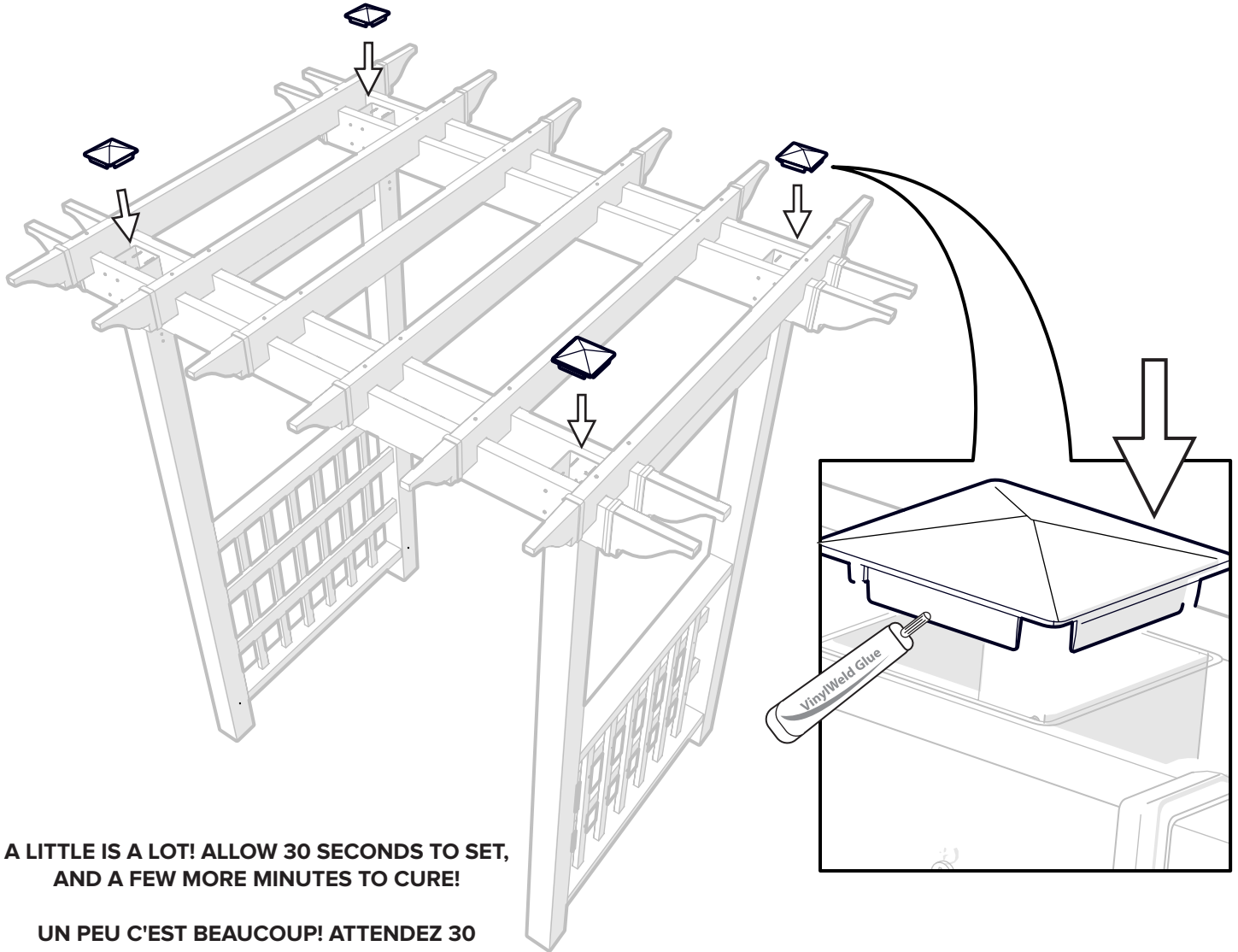
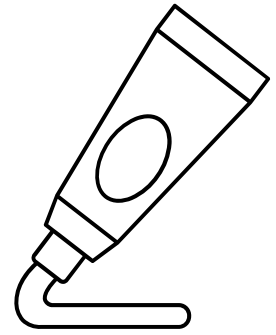
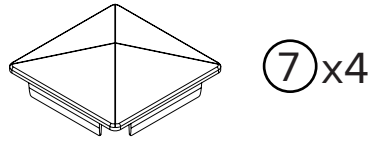

**A LITTLE IS A LOT! ALLOW 30 SECONDS TO SET,  
AND A FEW MORE MINUTES TO CURE!**

**UN PEU C'EST BEAUCOUP! ATTENDEZ 30  
SECONDES POUR DURCIR ET QUELQUES  
MINUTES SUPPLÉMENTAIRES POUR DURCIR!**

**¡UN POCO ES MUCHO! ¡DEJE QUE SE SEQUE  
DURANTE 30 SEGUNDOS Y UNOS MINUTOS  
MÁS PARA QUE SE CURE!**