

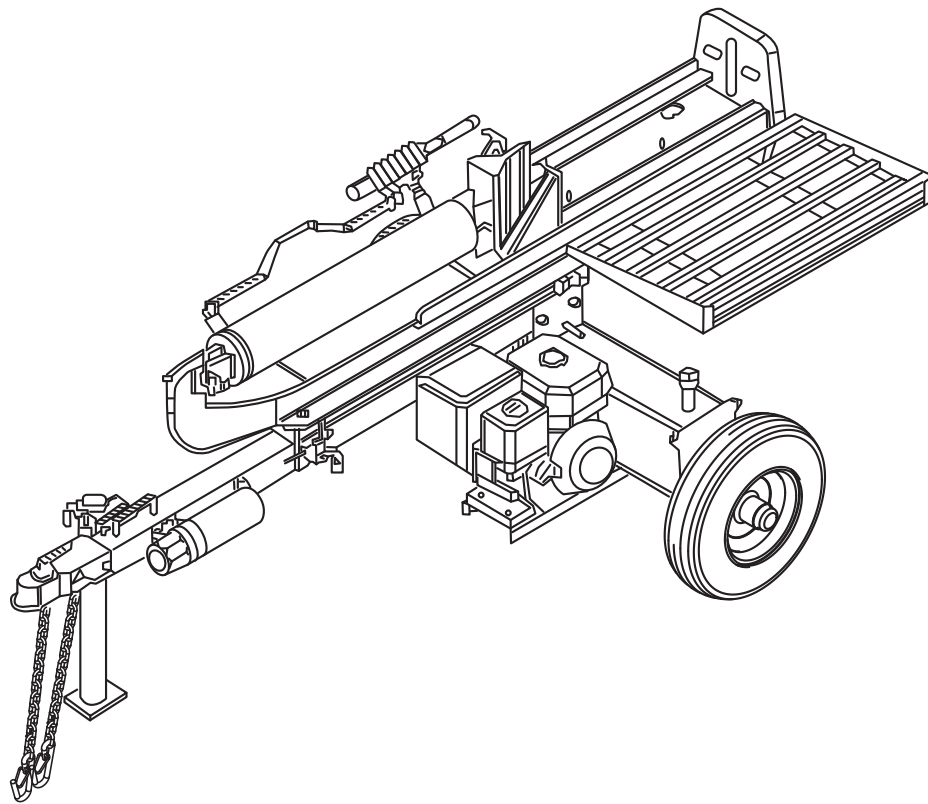

Original Instruction Manual

# VERTICAL/HORIZONTAL LOG SPLITTER

Models OR25TBS-2, OR25TKO-2, OR30TBS-2, OR30TKO-2,  
OR35TBS-2, OR35TKO-2



OregonProducts.com

# Introduction



Read this manual before operating your Oregon equipment. The information presented will prepare you to do a better and safer job. Keep this manual handy for ready reference. Require all operators to read this manual carefully and become acquainted with all adjustment and operating procedures before attempting to operate. Replacement manuals can be obtained from your dealer. To locate your nearest dealer, check the Dealer Locator at OregonProducts.com, or in the United States and Canada call 1-800-525-8322.



**¡LEA EL INSTRUCTIVO! SI NO LEE INGLÉS PIDA AYUDA A ALGUIEN QUE SI LO LEE PARA QUE LE TRADUSCA LAS MEDIDAS DE SEGURIDAD.**

The equipment you have purchased has been carefully engineered and manufactured to provide dependable and satisfactory use. Like all mechanical products, it will require cleaning and upkeep. Lubricate the unit as specified. Observe all safety information in this manual and safety decals on the equipment.

This Operator's Manual should be regarded as part of the machine. Suppliers of both new and second-hand machines must make sure this manual is provided with the machine.

For service, your authorized Oregon dealer has trained mechanics, genuine Oregon service parts, and the necessary tools and equipment to handle all your needs.

Use only genuine Oregon service parts. Substitute parts will void the warranty and may not meet standards required for safe and satisfactory operation. Record the model number and serial number of your equipment in the spaces provided:

Serial Number Label Location: See Safety Decal Section

Record the information below for future reference.

Model No \_\_\_\_\_

Date of Purchase \_\_\_\_\_

Serial No. \_\_\_\_\_

Place of Purchase \_\_\_\_\_

Provide this information to your dealer to obtain correct repair parts.

Serial Number Label Location:  
Tank Plate Below Beam

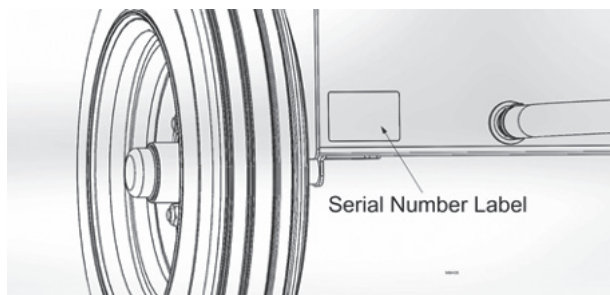

# Table of Contents

Explanation of Signal Words . . . . .	.4	Assembly Instructions . . . . .	15
Specifications . . . . .	.5	Operating Instructions . . . . .	23
General Information . . . . .	.5	Hydraulic Oil Recommendation:	23
Safety Rules. . . . .	.6	Engine Oil Recommendations	23
Training	6	Operating the Log Splitter	23
Preparation	6	Log Splitter Setup	24
Towing Safety	7	Log Splitter Operation – Horizontal Position	25
Intended Use	7	Log Splitter Operation – Vertical Position	26
Personal Protective Equipment	7	Towing	27
General Safety	8	Storage	27
Work Area	8	Maintenance	27
Preparation of the Log	8	Replacement Parts . . . . .	28
Operation of the Log Splitter	9	Beam Assembly	28
General Repair	10	Wheel Assembly	29
Hydraulic Safety	10	Tank Assembly	30
Fire Prevention	11	Motor Assembly	31
Spark Arrester	11	Tongue Assembly	33
Safety & Instructional Decals . . . . .	12	622492 Hardware Kit for 30T	34
		Limited Warranty . . . . .	35

© 2022 Oregon Tool, Inc. Pricing and specifications subject to change without notice.  
 All rights reserved. Oregon® is a trademark of Oregon Tool, Inc. in the United States and/or in other countries.

# Explanation of Signal Words

This section contains safety information for the Oregon Rotary Cutter. Throughout this manual, the terms **DANGER**, **WARNING**, and **CAUTION** are used in conjunction with the Safety-Alert Symbol (a triangle with an exclamation mark) to indicate the degree of hazard for items of personal safety. The term **NOTICE** is used to indicate that failure to observe can cause damage to equipment.



This is the safety alert symbol. It is used to alert you to potential physical injury hazards. Obey all safety messages that follow this symbol to avoid possible injury or death.



Indicates a hazard with a high level of risk which, if not avoided, will result in death or serious injury.



Indicates a hazard with a medium level of risk which, if not avoided, could result in death or serious injury.



Indicates a hazard with a low level of risk which, if not avoided, could result in minor or moderate injury.

**NOTICE**

Indicates a potential situation exists which, if not avoided, may result in damage to your equipment or property.

**NOTE**

Indicates helpful information.

Symbol	Name	Explanation
	Read instructions	Read and thoroughly understand the owner's manual and engine manual before assembly, operation, towing and maintenance.
	Wear personal protective equipment	Wear safety goggles to protect eyes from flying debris. Wear ear protection to prevent hearing damage from excessive noise.
	Wear hand protection	Wear sturdy work gloves to protect hands from injury.
	Wear foot protection	Wear sturdy footwear to protect feet from falling logs.
	Crush hazard	Keep hands, body and clothing clear of cutting wedge and other moving parts while splitting.
	High pressure hydraulic oil	Hydraulic fluid escaping under pressure can pierce the skin. Do not check for high pressure oil leaks with your hands. Use cardboard.
	Hot surface	Do not touch hot cylinder.

# Specifications

<b>Model No.</b>	<b>OR25TBS-2</b>	<b>OR25TKO-2</b>	<b>OR30TBS-2</b>	<b>OR30TKO-2</b>	<b>OR35TBS-2</b>	<b>OR35TKO-2</b>
Engine	Briggs & Stratton CR950 208cc	Kohler SH265 196cc	Briggs Stratton XR1150 250cc	Kohler SH265 196cc	Briggs & Stratton XR1450 306cc	Kohler CH395 277cc
Maximum Splitting Force*	25 Tons	25 Tons	30 Tons	30 Tons	35 Tons	35 Tons
Cycle Time*	11.2-seconds	11.2-seconds	12.9-seconds	12.9-seconds	12.7-seconds	12.7-seconds
Pump	2-stage, 14 GPM	2-stage, 14 GPM	2-stage, 14 GPM	2-stage, 14 GPM	2-stage, 17 GPM	2-stage, 17 GPM
Cylinder	4" x 24" with 1.75" inner rod diameter	4" x 24" with 1.75" inner rod diameter	4.5" x 24" with 1.75" inner rod diameter	4.5" x 24" with 1.75" inner rod diameter	5" x 24" with 2" inner rod diameter	5" x 24" with 2" inner rod diameter
Valve	3915 PSI	3915 PSI	3625 PSI	3625 PSI	3625 PSI	3625 PSI
Maximum Log Length	25.5"	25.5"	25.5"	25.5"	25.5"	25.5"
Wheels	4.5" x 16" diameter	4.5" x 16" diameter	4.5" x 16" diameter	4.5" x 16" diameter	4.5" x 16" diameter	4.5" x 16" diameter
Wedge Height	8" tall wedge	8" tall wedge	8" tall wedge	8" tall wedge	8" tall wedge	8" tall wedge
Hydraulic Capacity	4.5 gallons	4.5 gallons	6 gallons	6 gallons	6.6 gallons	6.6 gallons
Filter	In-tank filter	In-tank filter	In-tank filter	In-tank filter	In-tank filter	In-tank filter
Height -- Vertical	71"	71"	71"	71"	71"	71"
-- Horizontal	40"	40"	40"	40"	40"	40"
Width	48"	48"	48"	48"	48"	48"
Shipping Weight	578 lbs.	578 lbs.	644 lbs.	644 lbs.	699 lbs.	710 lbs.

\* Tonnage and cycle times vary dependent upon mechanical and environmental conditions.

## General Information



**Some illustrations in this manual show the equipment with safety shields removed to provide a better view. This equipment should never be operated with any necessary safety shielding removed.**

The purpose of this manual is to assist you in operating and maintaining your 3-point equipment. Read it carefully. It furnishes information and instructions that will help you achieve years of dependable performance. These instructions have been compiled from extensive field experience and engineering data. Some information may be general in nature due to unknown and varying operating conditions. However, through experience and these instructions, you should be able to develop procedures suitable to your particular situation.

The illustrations and data used in this manual were current at the time of printing but, due to possible inline production changes, your machine may vary slightly in detail. We reserve the right to redesign and change the machines as may be necessary without notification.

Throughout this manual, references are made to right and left directions. These are determined by standing behind the equipment, facing the direction of the forward travel. Blade rotation is counterclockwise as viewed from the top of the cutter.

## Safety Rules



**ATTENTION!** Become alert! Your safety is involved!

**Safety is a primary concern in the design and manufacture of our products. Unfortunately, our efforts to provide safe equipment can be wiped out by an operator's single careless act. In addition to the design and configuration of equipment, hazard control and accident prevention are dependent upon the awareness, concern, judgment, and proper training of personnel involved in the operation, transport, maintenance and storage of equipment. It has been said "The best safety device is an informed, careful operator." We ask you to be that kind of operator.**

### Training

- **Safety instructions are important! Read all attachment and power unit manuals; follow all safety rules and safety decal information. (Replacement manuals and safety decals are available from your dealer. To locate your nearest dealer, check the Dealer Locator at [OregonProducts.com](http://OregonProducts.com), or in the United States and Canada call 1-800-525-8322.) Failure to follow instructions or safety rules can result in serious injury or death.**
- **If you do not understand any part of this manual and need assistance, see your dealer.**
- **Know your controls and how to stop engine and attachment quickly in an emergency.**
- **Operators must be instructed in and be capable of the safe operation of the equipment, its attachments, and all controls. Do not allow anyone to operate this equipment without proper instructions.**
- **Never allow children or untrained persons to operate equipment.**

### Preparation

- **Check that all hardware is properly installed. Always tighten to torque chart specifications unless instructed otherwise in this manual.**
- **Always wear relatively tight and belted clothing to avoid getting caught in moving parts. Wear sturdy, rough-soled work shoes and protective equipment for eyes, hair, hands, hearing, and head; and respirator or filter mask where appropriate.**
- **Remove accumulated debris from this equipment, power unit, and engine to avoid fire hazard.**
- **Make sure all safety decals are installed. Replace if damaged. (See Safety Decals section for location.)**
- **Make sure shields and guards are properly installed and in good condition. Replace if damaged.**

## Towing Safety

- **Never allow anyone to sit or ride on your log splitter.**
- **Never move your log splitter over hilly or uneven terrain without a tow vehicle or adequate help.**
- **Never carry any cargo or wood on your log splitter.**
- **Never exceed 45 mph when towing your log splitter. Towing the log splitter at speeds higher than 45 mph could result in loss of control, or serious injury or death, or damage to the equipment. Adjust towing speed for terrain and conditions. Be extra cautious when towing over rough terrain, especially railroad crossings, and avoid sharp turns and steep angles when towing your log splitter.**
- **Never exceed weight capacity of ball or load limits of coupler.**
- **Always confirm coupler tightness each time before towing and after towing 50 miles.**
- **Always disconnect your log splitter from the towing vehicle before operating it.**
- **Always use safety chains when towing your log splitter.**
- **Always check all local and state regulations regarding towing, licensing, and lights before towing your log splitter.**
- **Always check before towing to make sure that the log splitter is correctly and securely attached to the towing vehicle and that the safety chains are secured to the hitch or bumper of the vehicle with enough slack to allow turning.**
- **Always use a class 1, 2" ball with this log splitter.**
- **Always replace ball or coupler if damaged or excessively worn.**
- **Always be careful when backing up your log splitter in tow. It could jackknife.**
- **Always allow for added length of your log splitter when turning, parking, crossing intersections and in all driving situations.**
- **Always if applicable, turn the fuel shut off valve on the engine to the "OFF" position before towing the log splitter. Failure to do so may result in flooding the engine.**
- **Always lift support stands and have beam pinned down and forward for transport.**

## Intended Use

**Never use this log splitter for any other purposes than splitting firewood. It is designed for this use only. Any other use can cause serious injury or death.**



## Personal Protective Equipment

**Before operating this log splitter, make sure that you wear safety gear such as goggles or safety glasses, steel toed shoes and tight fitting gloves (without loose cuffs or draw strings). Always wear a protective hearing device when operating this log splitter.**

## General Safety

- **Never allow children or those lacking proper instructions and understanding to operate this log splitter.**
- **Never wear loose clothing or jewelry that can be caught by moving parts of the log splitter. Keep clothing and hair away from all moving parts when operating this log splitter.**
- **Always keep the operator's manual in the storage tube for reference. Reread the manual periodically.**
- **Always keep all bystanders and pets a minimum of 10 feet away from your work area when operating this log splitter. Only the operator is to be near the log splitter during use.**
- **Never actuate the control unit until all people are clear of the work area.**
- **Never operate the log splitter when under the influence of alcohol, drugs, medication, or when otherwise not alert enough to operate dangerous machinery.**

## Work Area

- **Never operate the log splitter in an enclosed area. Exhaust fumes contain carbon monoxide which can be deadly when inhaled.**
- **Never operate the log splitter on slippery, wet, muddy or icy ground.**
- **Always chock the wheels before splitting.**
- **Only operate the log splitter on level ground. Operating on a slope could cause the log splitter to roll over or logs to fall off.**
- **Only operate the log splitter in daylight or under good artificial light.**
- **Always keep the work area clean. Remove split wood around the log splitter immediately to prevent accidents.**

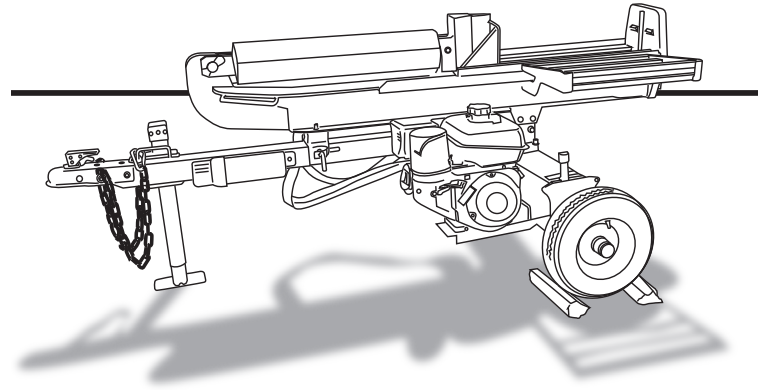

## Preparation of the Log

**Both ends of the log should be cut as square as possible to help prevent the log from riding out of the splitter during operation. Do not split logs greater than 25.5" in length.**



## Operation of the Log Splitter

**Only one operator may operate the log splitter from the operator zone as shown in the diagram. Keep all bystanders and pets away. The operator has the safest and most efficient access to the control valve and the beam in this location. Operating the log splitter in another location can result in serious injury or death.**

Horizontal Position

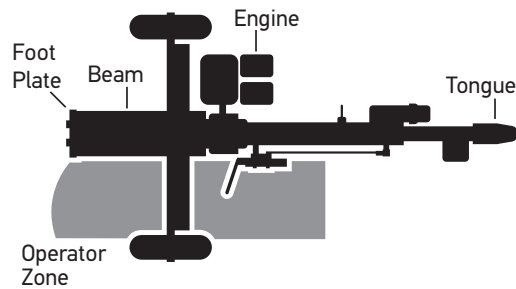

Vertical Position

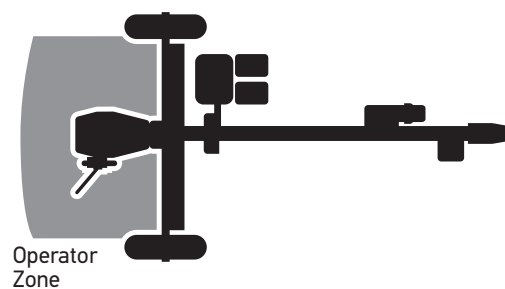

- **Never split a log heavier than 100 lbs in horizontal position.**
- **Never touch the log while wedge is engaged or moving.**
- **Always set up the log splitter in a clear, level area. Failure to do so can result in instability of the log splitter.**
- **Always block the wheels to prevent movement of the log splitter while in operation.**
- **Know how to stop the log splitter and disengage the controls before operating it.**
- **Never place hands or feet between the log and splitting wedge during forward or reverse strokes as this could result in serious injury or death.**
- **Never straddle or step over the log splitter during operation.**
- **Never reach or bend over the log splitter to pick up a log.**
- **Never split more than one log at a time.**
- **Never try to split a log across the grain.**
- **Never attempt to load the log splitter when the ram or wedge is in motion.**
- **Never use your foot, a rope, or any extension device to operate the control lever on the valve. Only use hand.**
- **Never move the log splitter while the engine is running. Shut off the engine if you are leaving the log splitter, even for a short period of time.**
- **Never touch the muffler and hot areas of the engine during operation. Wait until the engine cools down.**

### General Repair

- **Never alter your log splitter in any manner. Such alterations may cause your log splitter to be unsafe and will void the warranty.**
- **Never tamper with the engine to run it at excessive speeds. The maximum engine speed is preset by the manufacturer, and is set within safety limits. Running the engine at excessive speeds will void the warranty. Refer to the engine owner's manual for your particular log splitter.**
- **Never perform any service or repair on your log splitter without first removing the spark plug wire.**
- **Always replace all damaged or worn parts immediately.**
- **Always be sure that all replacement parts meet manufacturer's specifications.**
- **Never operate your log splitter when it is in poor mechanical condition or in need of repair.**
- **Always perform all recommended maintenance procedures before using your log splitter.**
- **Always check the level of hydraulic oil and engine oil before operation.**
- **Always periodically check that all nuts, bolts, screws, hydraulic fittings and hose clamps are tight.**

### Hydraulic Safety

- **The hydraulic system of your log splitter requires careful inspection along with the mechanical parts. Be sure to replace frayed, kinked, cracked, or otherwise damaged hydraulic hoses or hydraulic components.**
- **Never check for leaks of hydraulic fluid with your hand. Fluid escaping from a small hole can be almost invisible. Escaping fluid under pressure can have sufficient force to penetrate skin causing serious injury or even death. Leaks can be safely detected by passing a piece of cardboard over the suspected leak and looking for discoloration.**
- **Always seek professional medical attention immediately if injured by escaping hydraulic fluid. Serious infection or reaction can develop if proper medical treatment is not administered immediately.**
- **Never remove the cap from the hydraulic tank or reservoir while the log splitter is running. The tank could contain hot oil under pressure which could result in serious injury.**
- **Never adjust the hydraulic valve. The pressure relief valve on your log splitter is preset at the factory. Only a qualified service technician should perform this adjustment.**
- **Always be sure to relieve all pressure by shutting off the engine and moving the valve control handle back and forth should it become necessary to loosen or remove any hydraulic fitting.**

## Fire Prevention

- **Never operate your log splitter near a flame or spark, or smoke during operation. Hydraulic oil and gasoline are flammable and can explode.**
- **Never fill the gas tank while the engine is hot or running. Allow the engine to cool before refueling.**
- **Only refuel your log splitter in a clear, well ventilated area with no gas fumes or spilled gas.**
- **Always replace the gas cap securely.**
- **If gasoline has spilled, move the log splitter away from the area of the spill and avoid creating any source of ignition until the spilled gas has evaporated.**
- **Always clean wood debris from the engine, muffler and beam.**
- **Always store gasoline in an approved, tightly sealed container and away from heating appliances. Store the container in a cool, dry place.**
- **Always drain the fuel tank prior to storage to avoid the potential fire hazard.**

## Spark Arrester

**This log splitter is equipped with an internal combustion engine and should not be used on or near any unimproved forest-covered, brush-covered, or grass-covered land unless the engine's exhaust system is equipped with a spark arrester meeting applicable local or state laws (if any). In the state of California, a spark arrester is required by law.**

**Other states have similar laws. Federal laws apply on federal lands. Always check the legal requirements in your area.**

**If a spark arrester is used, it should be maintained in effective working order by the operator. A spark arrester muffler is optional and available as an accessory at your nearest engine dealer.**

**As a precautionary measure against possible flying sparks, always take a Class B fire extinguisher with you when operating this log splitter in dry areas.**

# Safety & Instructional Decals



**ATTENTION! Become alert! Your safety is involved!**

Replace immediately if damaged!

Make sure that all safety warning decals are in good condition and readable. Always replace missing or defaced decals. Call 1-800-525-8322 for replacement decals. Safety Decal Kit Material # is 622521.

<b>⚠ WARNING</b>	<b>⚠ ADVERTENCIA</b>	<b>⚠ AVERTISSEMENT</b>	
<p>To minimize risk of serious injury or death to you or others, when towing log splitter:</p> <ul style="list-style-type: none"> <li>- Read manual for how to properly attach coupler to hitch ball and how to safely tow.</li> <li>- Use correct ball size.</li> <li>- Do not exceed weight capacity of ball or load limits of coupler.</li> <li>- Always use safety chains.</li> <li>- Never exceed 45 mph.</li> <li>- Avoid sharp turns and steep angles.</li> <li>- Confirm coupler tightness each time before towing and after towing 50 miles.</li> <li>- Replace ball or coupler if damaged.</li> </ul>	<p>Para minimizar el riesgo de lesiones severas o la muerte a usted o a terceros mientras remolca una cortadora de troncos:</p> <ul style="list-style-type: none"> <li>- Lea el manual para saber cómo adherir el acople a la esfera del enganche y cómo remolcar en forma segura.</li> <li>- Use el tamaño de esfera correcto.</li> <li>- No exceda la capacidad de peso de la esfera ni los límites de carga del acople.</li> <li>- Siempre use cadenas de seguridad.</li> <li>- Nunca exceda los 45 mph.</li> <li>- Evite los giros bruscos y los ángulos marcados.</li> <li>- Revise la firmeza del acople todas las veces antes de remolcar y después de remolcar una distancia de 50 mil las.</li> <li>- Reemplace la esfera o el acople si están dañados.</li> </ul>	<p>Pour minimiser les risques de blessures graves ou mortelles pour vous et pour les autres pendant le remorquage de la fendeuse hydraulique:</p> <ul style="list-style-type: none"> <li>- Lira le manuel pour savoir comment accrocher correctement le coupleur à la boule d'attelage et remorquer de manière sécuritaire.</li> <li>- Utiliser une boule de la bonne grosseur.</li> <li>- Ne pas dépasser la capacité pondérale de la boule ni les limites de charge du coupleur.</li> <li>- Toujours utiliser des chaînes de sécurité.</li> <li>- Ne jamais dépasser une vitesse de 45 m/h.</li> <li>- Éviter les virages serrés et les angles d'approche accentués.</li> <li>- S'assurer du serrage du coupleur à chaque fois, avant et après un remorquage sur 50 miles.</li> <li>- Remplacer le coupleur ou la boule d'attelage s'ils sont endommagés.</li> </ul>	<small>S52062500 AC</small>

PART NUMBER: S52062500

LOCATION: SIDE, FRONT END OF TONGUE



**⚠ DANGER**  
**Crush Hazard**  
 Keep hands clear when cutting wedge is moving.

**⚠ PELIGRO**  
**Riesgo de aplastamiento**  
 Mantenga las manos alejadas cuando la cuña de corte está en movimiento.

**⚠ DANGER**  
**Danger d'écrasement**  
 Tenir les mains éloignées lorsque le bord tranchant est en mouvement.

S52062200E AB 07/21

PART NUMBER: S52062200

LOCATION: TOP OF CYLINDER

REFLECTIVE TAPE

PART NUMBER: S52020700

LOCATION: REAR OF TANK

**NOTICE**



To prevent damage to the hydraulic system, do not fill tank beyond "OK" range on dipstick. Use universal hydraulic fluid or DEXTRON II Transmission Fluid. Use 10W AW32, ASLE H-150, or ISO 32 type hydraulic fluid.

**AVISO**

Para prevenir daños en el sistema hidráulico, no llene el tanque más allá de la marca "OK" en la varilla. Use fluido hidráulico universal o fluido de transmisión DEXTRON II. Use fluido hidráulico tipo 10W AW32, ASLE H-150 o ISO 32.

**AVIS**

Pour prévenir les dommages du système hydraulique, ne pas remplir le réservoir au-delà la marque « OK » apparaissant sur la jauge graduée. Utilisez un fluide hydraulique universel ou le liquide pour Transmission DEXTRON II. Utilisez un fluide hydraulique de type 10W AW32, ASLE H-150, ou ISO 32.

S52062400 AB 03/20

PART NUMBER: S52062400

LOCATION: HYDRAULIC TANK LOWER TANK, RIGHT CORNER

**WARNING**

To minimize the risk of serious injury or death:

- Read and thoroughly understand owner's manual and engine manual before assembly, operation, towing and maintenance.
- Only one operator permitted. Must operate in operator safe zone. Keep all bystanders and pets away.
- Do not step or reach over splitter during operation.
- Hold logs by the sides, never by ends.
- Keep hands, body, and clothing away from moving parts when splitting.
- Do not operate indoors.
- Do not check for high pressure oil leaks with your hands. Use cardboard.
- Wear safety glasses, shoes, and hearing devices.
- Do not operate if tired or under influence of alcohol or drugs.
- Hot surface. Do NOT touch hot cylinder.

**OPERATING INSTRUCTIONS**

1. Place splitter on dry, level surface. Remove debris.
2. Start engine. Advance throttle to max.
3. Place log onto beam, against foot plate.
4. Split wood in direction of grain.
5. Move control handle to EXTEND or RETRACT as needed.

Control Valve

Retract ▲

Extend ▼

For Responsive Service or if manual is missing Call 1-800-525-8322 or visit OregonProducts.com

**ADVERTENCIA**

Para minimizar el riesgo de lesiones severas o la muerte:

- Lea y asegúrese de entender completamente el manual del usuario y el manual del motor antes de proceder a las operaciones de montaje, operación, remolque y mantenimiento.
- Se permite solo un operador por vez, que debe operar en la zona segura para el operador. Todos los transeúntes y mascotas deben mantenerse alejados.
- No se pare ni pase sobre la cortadora de troncos durante la operación.
- Sostenga los troncos por los costados, nunca por los extremos.
- Mantenga las manos, el cuerpo y la ropa alejadas de las partes en movimiento durante la operación.
- No opere en interiores.
- No inspeccione para determinar si hay filtraciones de aceite de alta presión con las manos, utilice cartón.
- Utilice antiparras, calzado de seguridad y dispositivos para la protección de los oídos.
- No opere el equipo si se siente cansado o está bajo la influencia del alcohol o las drogas.
- Superficie caliente, NO toque el cilindro caliente.

**INSTRUCCIONES DE OPERACION**

1. Coloque la cortadora sobre una superficie seca y nivelada. Quite toda la suciedad que haya sobre la superficie.
2. Arranque el motor. Lleve el acelerador a la posición máxima.
3. Coloque el tronco sobre el brazo, contra el pedal.
4. Corte la madera en la dirección de la veta.
5. Mueva la palanca de control para EXTENDER o RETRAER, según resulte necesario.

Válvula de control

Retraer ▲

Extender ▼

Para solicitar servicio o si falta el manual, llame al 1-800-525-8322 o visite OregonProducts.com

**AVERTISSEMENT**

Pour minimiser les risques de blessures graves ou mortelles :

- Lire et bien comprendre le manuel du propriétaire et le manuel du moteur avant tout assemblage, fonctionnement, remorquage et entretien.
- Un seul opérateur est autorisé. Doit fonctionner dans une zone sécuritaire pour l'opérateur. Tenir tous les spectateurs et animaux à distance.
- Ne pas marcher sur la refendeuse ni passer par-dessus pendant le fonctionnement.
- Tenir les rondins par les côtés, jamais par les extrémités.
- Tenir les mains, le corps et les vêtements éloignés des pièces mobiles lors du fendage.
- Ne pas faire fonctionner à l'intérieur.
- Ne pas vérifier les fuites d'huile à haute pression avec vos mains. Utiliser un carton.
- Porter des lunettes et souliers de sécurité ainsi qu'un dispositif de protection auditive.
- Ne pas faire fonctionner si vos facultés sont affaiblies par l'alcool ou des drogues.
- Surface chaude, NE PAS toucher le cylindre chaud.

**DIRECTIVES DE FONCTIONNEMENT**

1. Placer la refendeuse sur une surface sèche et nivelée. Enlever les débris.
2. Démarrer le moteur. Avancer la manette de poussée au maximum.
3. Placer le rondin sur la poutre, contre la palette d'appuyé.
4. Fendre le bois dans le sens du grain.
5. Déplacer la poignée de commande vers DÉPLOYER ou RETRACTER, au besoin.

Valve de commande

Rétracter ▲

Déployer ▼

Pour un service attentif ou si vous n'avez pas de manuel, composez le 1-800-525-8322 ou visitez OregonProducts.com

8082219A-02/21

PART NUMBER: S52062100  
LOCATION: TOP OF HYDRAULIC CYLINDER



PART NUMBER: S52062300  
LOCATION: STRIPPER PLATE, NON-OPERATOR SIDE



PART NUMBER: S52062600  
LOCATION: STRIPPER PLATE, OPERATOR SIDE

**WARNING ADVERTENCIA AVERTISSEMENT**

**Explosive fuel can cause fires and severe burns.**  
Stop engine before filling fuel tank. Leave 5/8" (16 mm) at top of tank for fuel expansion. Read owner's manual.

**La explosión de combustible puede causar incendios y quemaduras graves.**  
Pare el motor ante de llenar el tanque de combustible. Deje 5/8" (16 mm) en la parte superior del tanque para la expansión del combustible. Lea el manual del propietario.

**Le carburant explosif peut entraîner des incendies et des brûlures graves.**  
Arrête le moteur avant de remplir le réservoir de carburant. Laissez un espace vide de 5/8 po (16 mm) en haut du réservoir pour l'expansion du carburant. Lire le manuel du propriétaire.

621827 AA 03/20

PART NUMBER: 621827  
LOCATION: ENGINE FUEL TANK



PART NUMBER: 622869  
 LOCATION: CRATE



PART NUMBER: 582221  
 LOCATION: TONGUE

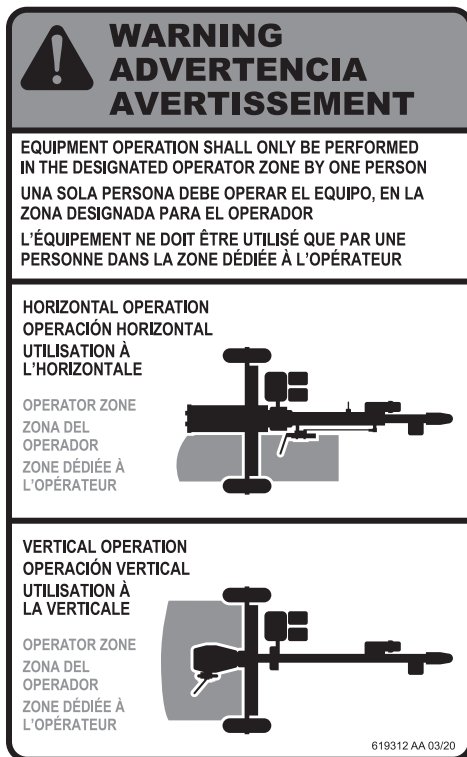

PART NUMBER: 619312  
 LOCATION: TANK



PART NUMBER: 608317  
 LOCATION: TONGUE

**Be Careful!**

- **Keep safety decals clean and visible. Use a clean, damp cloth to clean safety decals.**
- **Avoid spraying too close to decals when using a pressure washer; high-pressure water can enter through very small scratches or under edges of decals causing them to peel or come off.**
- **Replace safety decals if they are missing or illegible. Replacement safety decals can be ordered free from your Oregon dealer. To locate your nearest dealer, check the Dealer Locator at OregonProducts.com, or in the United States and Canada call 1-800-525-8322.**
- **Apply replacement decals to clean dry surface. Use even pressure to remove any bubbles from beneath the decal.**

# Assembly Instructions

This log splitter is partially assembled at the factory. Please refer to the drawings and parts list should it become necessary to disassemble the unit for repair or replacement of parts. The drawings in this manual are for reference only. Some of the components on your log splitter may look slightly different.

**CAUTION**

To avoid personal injury, always get help when moving or assembling heavier components such as a beam.

## Tools Required

- 1/4" wide flat head screwdriver
- Hammer
- 10 mm wrench
- 13 mm wrench
- 18mm wrench
- 19mm wrench
- 10 mm Hex wrench (included)
- Needle-nose pliers
- Box cutter

### STEP 1:

- 1a: Remove the top and sides by bending open all the metal side locks. Use caution as shifting may have occurred.
- 1b: Remove loose items from the crate and set aside.
- 1c: Cut all hold down straps and inspect each part for damage.
- 1d: Take note that the following items are included in the crate:

Description	Quantity	Description	Quantity
Beam Assembly	1	Wheel Assemblies	2
Tank Assembly	1	Log Catcher	1
Motor/Pump Assembly	1	Hardware Kit	1
Pressure Hoses	2	Manual Canister	1

**NOTE:** If any part is damaged, contact your dealer or delivering carrier.

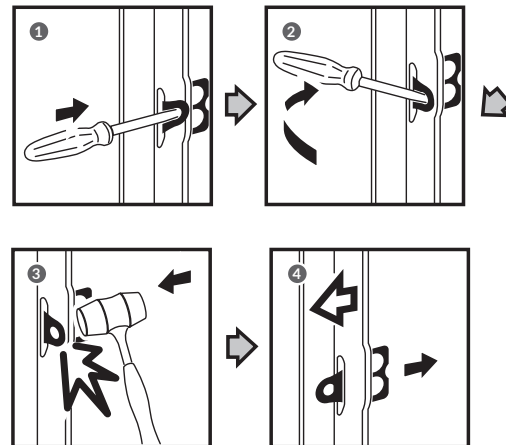
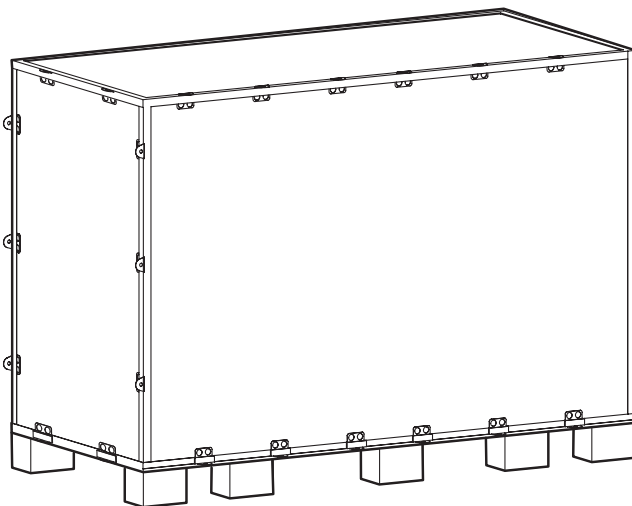

# ASSEMBLY INSTRUCTIONS

## STEP 2:

- 2a: Locate the tongue assembly and rotate the jack into the down position.
- 2b: Remove the hold down bolt that secures the tank to the base of the pallet.
- 2c: Position the tongue so that the mounting holes align with the holes in the tanks tongue mount.
- 2d: Insert the two M12 x 110mm bolts with a flat washer under the head of the bolt.
- 2e: Install a flat washer, lock washer, nut on each bolt and tighten.

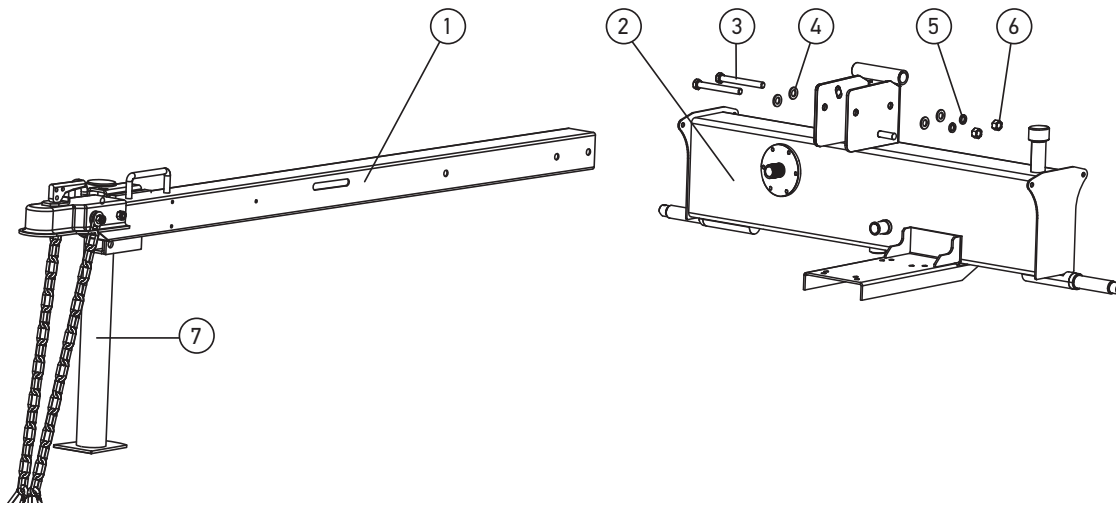

Item	Description	Quantity
1	Tongue Assembly	1
2	Tank Assembly	1
3	M12 x 110 Bolt	2
4	Flat Washer	4
5	Lock Washer	2
6	M12 Nut	2
7	Ground Stand / Jack Stand	1



## STEP 3:

- 3a: Rotate tank tongue assembly on the crate base corner so that axles are clear of the base.
- 3b: Locate wheel assemblies, Flat washers, Castle nuts, Cotter pins and Dust caps from the hardware kit.
- 3c: Remove the protective cover from one axle shaft and the plastic cover from one wheel.
- 3d: Install the wheel (with the valve stem pointed out), outer bearing, flat washer, and castle nut.
- 3e: Tighten the castle nut until snug and rotate the wheel three full turns to seat the bearings.
- 3f: Back off (loosen) the castle nut just enough to align the hole in the axle with the notches in the castle nut, allowing installation of the cotter pin. Do not loosen more than necessary to install cotter pin.
- 3g: Spin the wheel to verify it spins freely.

**NOTE:** A small amount of play is acceptable.

- 3h: Insert cotter pin and split/bend the pin end left and right.
- 3i: Install the dust cap.
- 3j: Repeat steps outlined above for the other wheel installation.

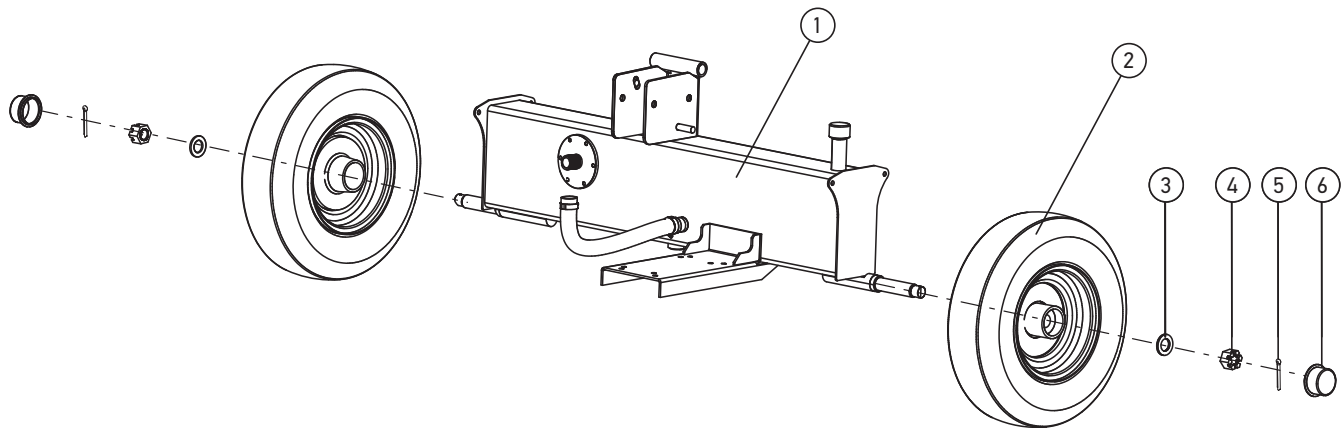

Item	Description	Quantity
1	Tank Assembly	2
2	Wheel Assembly	2
3	Flat Washer	2
4	Castle Nut	2
5	Cotter Pin	2
6	Dust Cap	2

# ASSEMBLY INSTRUCTIONS

## STEP 4:

- 4a: Remove the two hold down bolts securing the beam to the crate base.
- 4b: Slide the beam down so that the foot plate hangs over the edge of the crate base.
- 4c: Using two people or a suitable lifting device, stand the beam assembly up on end as shown, making sure that the beam is on a stable and level surface.

### **CAUTION**

**Have a person stabilize the beam until it is secured to the tank/tongue assembly.**

- 4d: Locate the pivot pin and r-clip from the hardware kit.
- 4e: Roll the tank/tongue assembly into position, aligning the pivot tube located on the tank assembly with the holes located on the two tabs that are on the beam.
- 4f: Slide the pivot pin through both the holes and fasten with the R-clip.
- 4g: Engage the beam vertical lock located near the pivot tube on the tank assembly.
- 4h: With the beam in vertical position, locate the beam to tongue lock (2) M12 x 25 SHCS, (2) M12 flat washers, and (2) M12 lock washers from the hardware kit.
- 4i: Place the beam lock into position and align the holes.
- 4j: Fasten the beam lock in place using the provided hex wrench and hardware.
- 4k: Lower the beam into horizontal position and verify the beam locks onto the tongue.

4f:

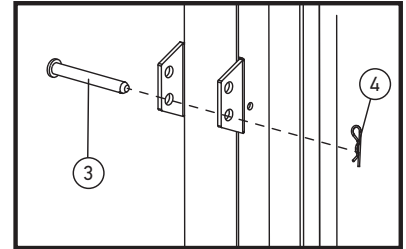

4j:

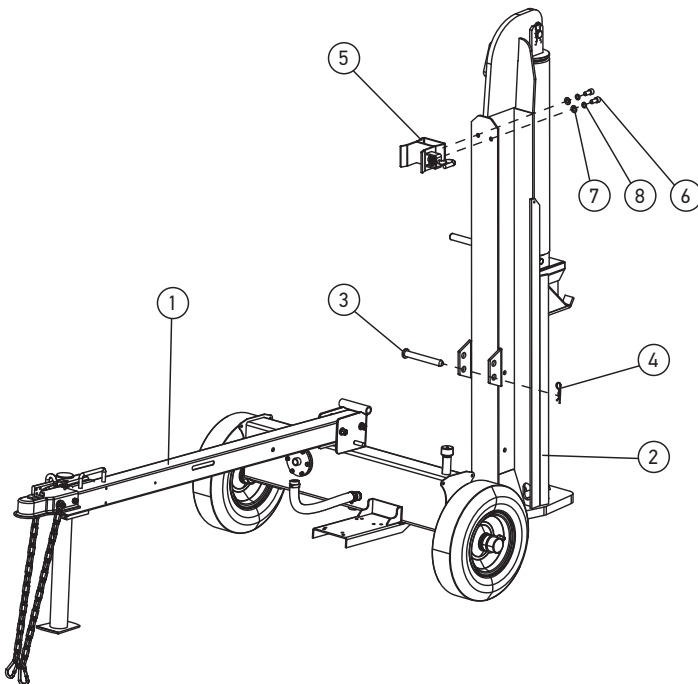
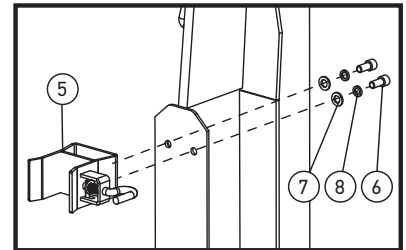

Item	Description	Quantity
1	Tank and Tongue Assembly	1
2	Beam Assembly	1
3	Pin	1
4	R-clip	1
5	Beam Lock	1
6	M12 x 25 Screw	2
7	Flat Washer	2
8	Lock Washer	2

## STEP 5:

5a: Locate the engine and pump assembly and remove the two hold down bolts.

5b: Place motor/pump assembly onto the engine plate located on the tank assembly.

5c: **For the 25T and 30T models**

Locate (4) M8 x 40 bolts, (8) #8 flat washer, (4) #8 lock washers and (4) M8 nuts, from the hardware kit.

**For the 35T models**

Locate the (4) M10 x 45 bolts, (8) #10 flat washer, (4) #10 lock washers and (4) M10 nuts, from the hardware kit.

5d: Install as shown and tighten.

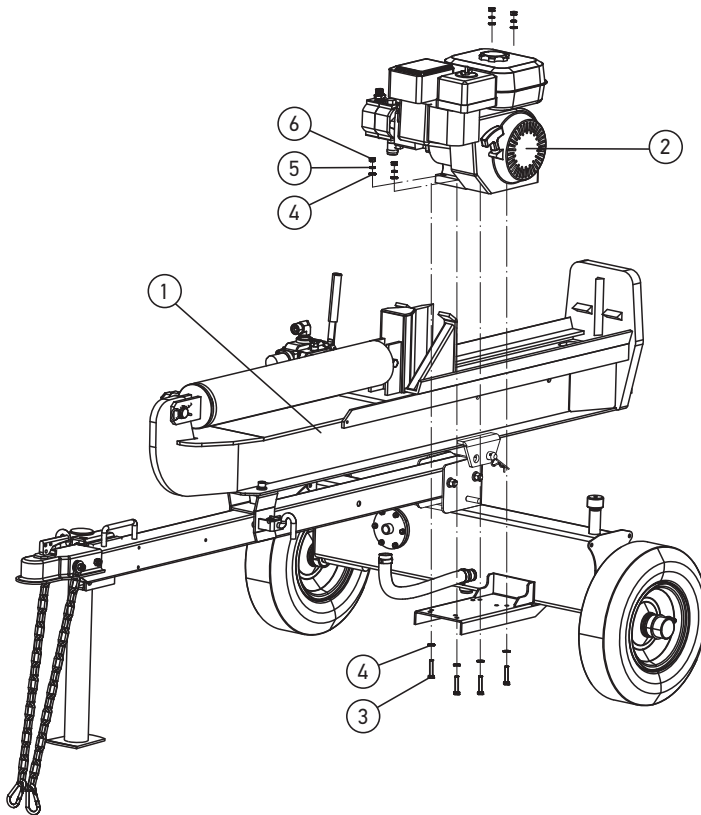

Item	Description	Quantity
1	Log Splitter Assembly	1
2	Engine and Pump Assembly	1
<b>25T &amp; 30T</b>		
3	M8 x 40 Bolt	4
4	M8 Flat Washer	8
5	M8 Lock Washer	4
6	M8 Nut	4
<b>35T</b>		
3	M10 x 45 Bolt	4
4	M10 Flat Washer	8
5	M10 Lock Washer	4
6	M10 Nut	4

# ASSEMBLY INSTRUCTIONS

## STEP 6:

- 6a: Place wheel chocks, or other suitable blocks on both wheels.
- 6b: Confirm beam is locked to the tongue.
- 6c: Lift log splitter by the tongue and beam handle unit if the foot plate rests on the ground and have an assistant stabilize the unit.
- 6d: Remove the plug from the suction hose, item 1, while keeping the open end as high as possible.
- 6e: Slide hose onto the fitting on the bottom of the pump and tighten clamp.
- 6f: With an assistant, lower the log splitter back down onto the jack.
- 6g: Next take the hydraulic hose, item 2, and remove the plastic cap and plug then attach to valve assembly and tighten.
- 6h: Take remaining hydraulic hose, item 3, and attach to pump and valve assembly and tighten.

**NOTE:** Hose connectors are designed to only fit on the proper connection and cannot be connect to the incorrect location.

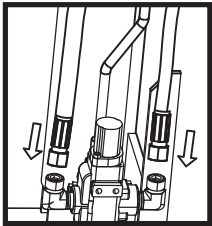

Item	Description	Quantity
1	Suction Hose	1
2	Return Hose	1
3	Pressure Hose	1

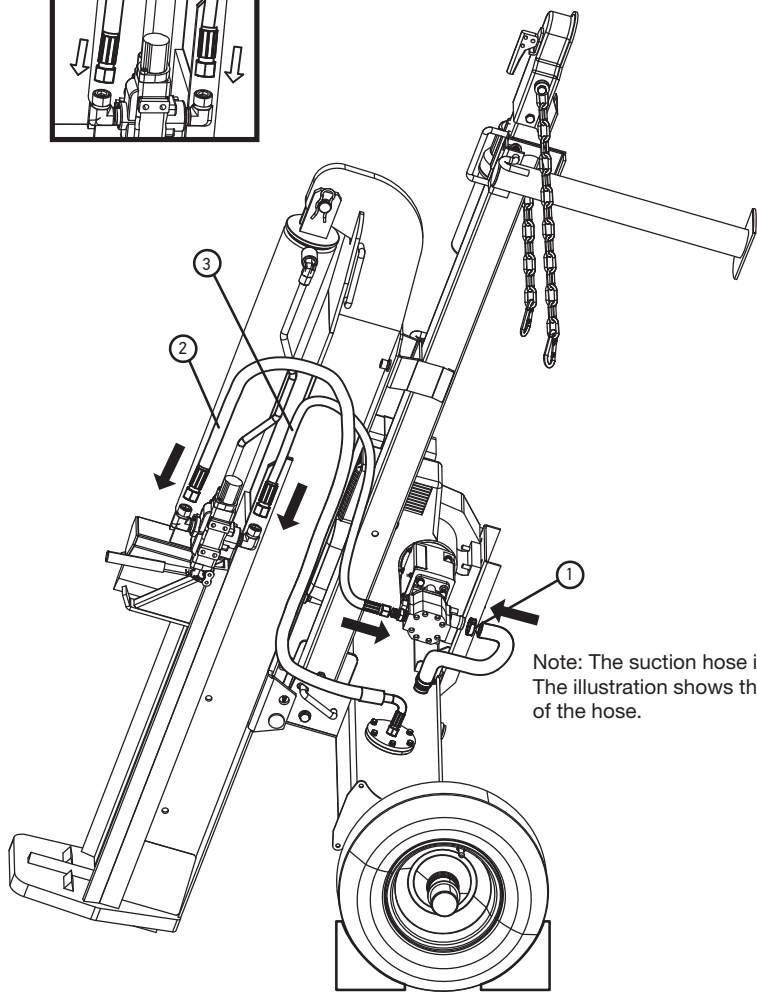

Note: The suction hose is straight.  
The illustration shows the routing  
of the hose.

**STEP 7:**

- 7a: Locate manual canister, (3) M6 screw and (3) M6 flat washers from the hardware kit.
- 7b: Remove the cap of the manual canister to ease installation.
- 7c: Install the manual canister with the provided hardware.

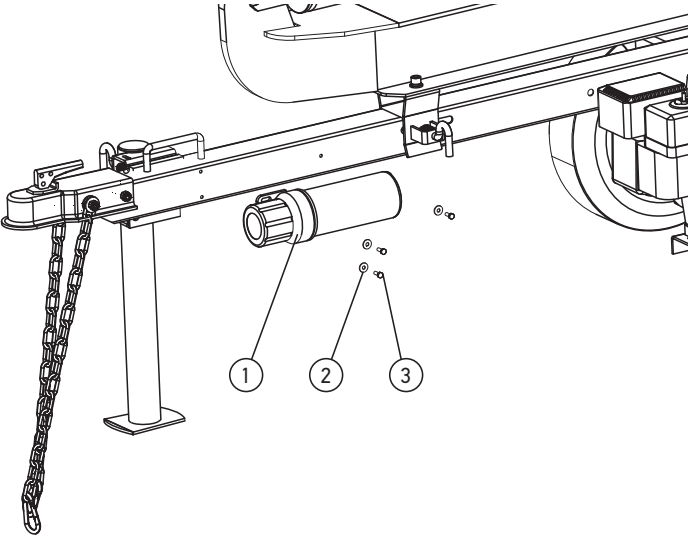

Item	Description	Quantity
1	Manual Canister	1
2	Washer M6	3
3	M6 x 20 Hex. Bolt	3

# ASSEMBLY INSTRUCTIONS

## STEP 8:

8a: Locate log catcher accessory box.

8b: Remove the contents and inspect for damage.

**NOTE:** If any part is damaged, contact your dealer or delivering carrier.

8c: Locate the (2) M12 x 35mm bolts, (2) M12 flat washers, and (2) M12 lock washers

8d: Align holes in log catcher with holes in the beam.

8e: Attach log catcher with provided hardware and tighten.

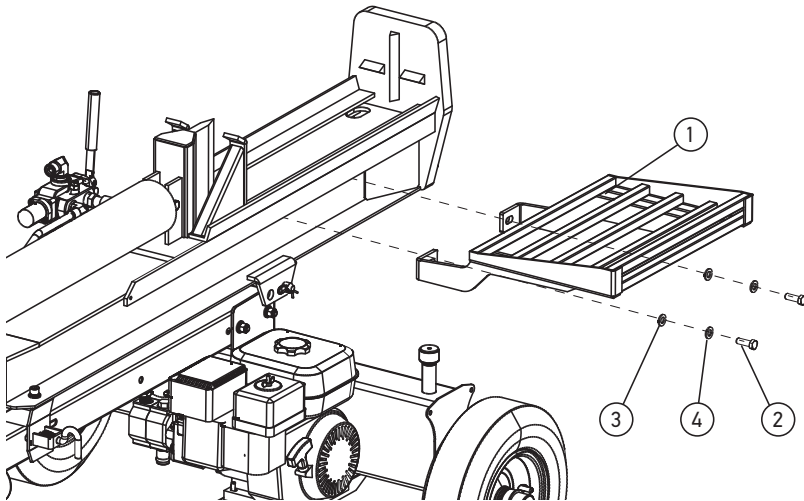

Item	Description	Quantity
1	Log Catcher	1
2	M12 x 35 Bolt	2
3	12mm Washer	2
4	M12 Lock Washer	2

# Operating Instructions

**⚠ WARNING**

**Read and thoroughly understand all instructions in this manual and on safety decals before assembling or operating this log splitter. Failure to do so may cause serious injury or death. Do not allow anyone to operate this log splitter who has not read this manual. As with all power equipment, a log splitter can be dangerous if assembled or used improperly. Do not operate this log splitter if you have any questions concerning safe operation. To get answers to any questions, call our technical support department at 1-800-525-8322.**

**NOTE:** This log splitter is not shipped with oil in the engine. Refer to the engine owner's manual for information on filling with oil. The log splitter is pre-filled with AW22 hydraulic fluid. After bleeding the air from hydraulic system, as noted in the "Hydraulic Oil Recommendation" section, some oil may need to be added.

**⚠ CAUTION**

**Do not start or run the engine before adding oil in the hydraulic reservoir and oil in the engine.**

## Hydraulic Oil Recommendation:

**STEP 1:** Unscrew fill cap and verify fluid level is between the two marks on the dipstick. AW22 or AW32 hydraulic oil is recommended when oil is needed. Automatic transmission fluid can be substituted and should be used instead of hydraulic oil when temperatures are below 32°F. Use only clean oil and take care to prevent dirt from entering the hydraulic reservoir. Fill the hydraulic tank with enough hydraulic fluid to register between the upper and lower marks on the dipstick.

### Minimum Hydraulic Oil Levels

25 Ton	Minimum 4 gallons
30 Ton	Minimum 5 gallons
35 Ton	Minimum 5.6 gallons

**NOTE:** This unit is filled at the factor with AW22 hydraulic oil.

**STEP 2:** After the hydraulic reservoir and the engine crankcase are filled with the recommended oil and hydraulic fluid, fill the engine with fuel and start. With the engine running at full speed, move the hydraulic valve lever toward the foot plate until the ram stops, then push the valve lever in the opposite direction and release. The Ram will return to the start position. Repeat this procedure several times to fill the ram and expel the air.

**NOTE:**

- Erratic movement of the ram indicates that there is still air in the system.
- Hydraulic pump will prime itself.

After cycling the hydraulic ram several times, shut off the motor and top off the hydraulic fluid, and look for leaks.

## Engine Oil Recommendations

For engine oil recommendations and engine starting instructions, please see engine owner's manual for further information.

## Operating the Log Splitter

Before operating the log splitter, do the following:

For the wood, make sure the wood is at the correct length, no longer than 25.5". If splitting in the horizontal position, do not split logs over 100 lbs.

Select a level splitting area, away from wet ground and slippery slopes.

Make sure you have enough light, never operate the splitter in the dark.

## Log Splitter Setup

Move log splitter to selected area mentioned above.

Disengage the log splitter from towing vehicle by pulling on the locking lever from the 2" ball coupler and lower the ground or jack stand. Then, disconnect the safety chains.

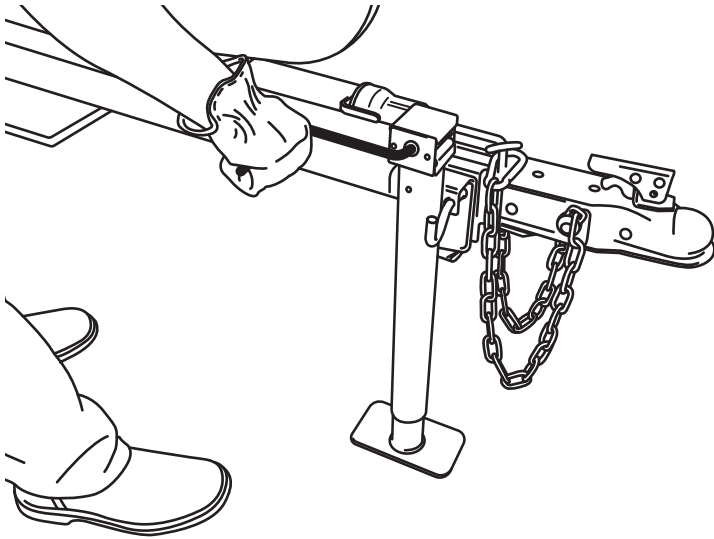

Check the engine oil and hydraulic oil levels to make sure they are at the proper operating range.

Check the engine to make sure it has enough fuel. For additional information concerning the engine oil recommendations and engine starting instructions, please see engine owner's manual for further information.

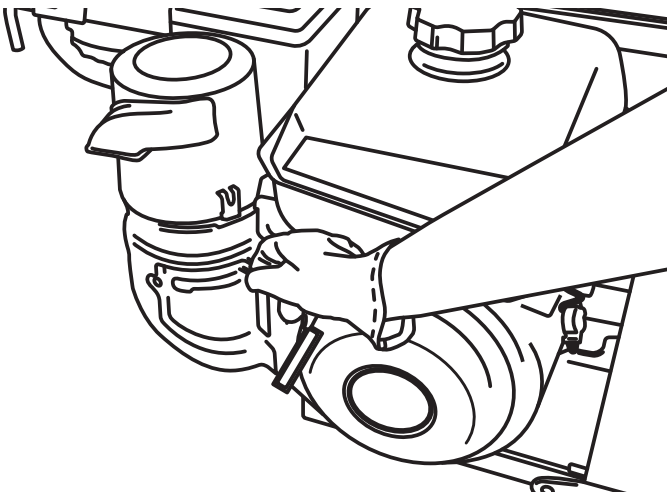

Block wheels by placing wheel chocks on both sides of the wheel to keep the log splitter stable while in use.

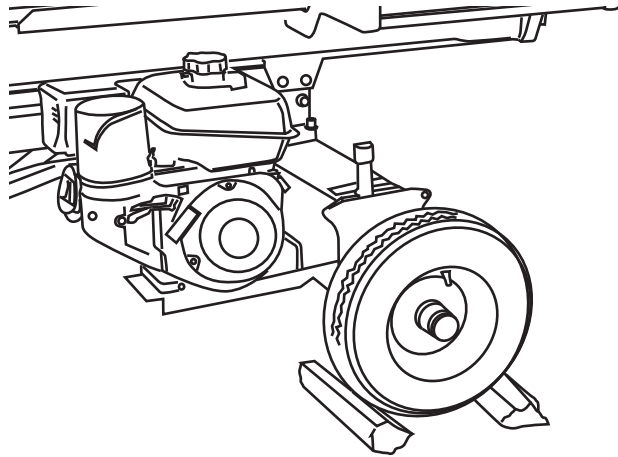

Check for loose hose connections, nuts and bolts and other fasteners prior to use.

Make sure the beam rails and debris slots are free of wood chips and debris. This should be cleaned as needed during splitting operation.

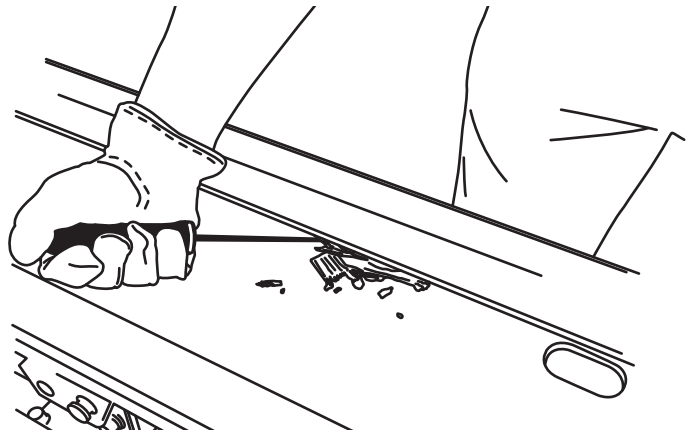

### **! WARNING**

See safety information related to general safety, work area, preparations of the log, and operation of the log splitter on pages 7 through 11 of this manual. Make sure that you have the recommended personal protective equipment described previously.

### **! CAUTION**

For operation in wooded areas, obtain a spark arrester for the exhaust system, see the engine operating and maintenance manual and check with your authorized engine service center. See Fire Prevention on page 11 of this manual.



## Log Splitter Operation – Horizontal Position

### Horizontal Position

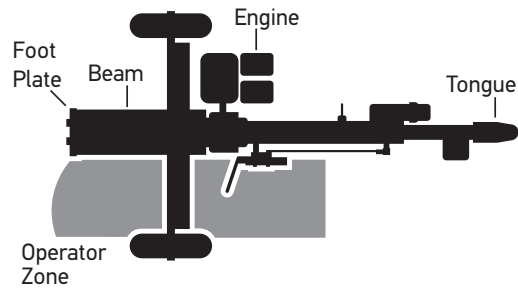

Once proper PPE is worn and the engine is started, select your first log to be split, not exceeding 100 lbs.

Place the square cut log onto the beam rails and slide it towards the foot plate.

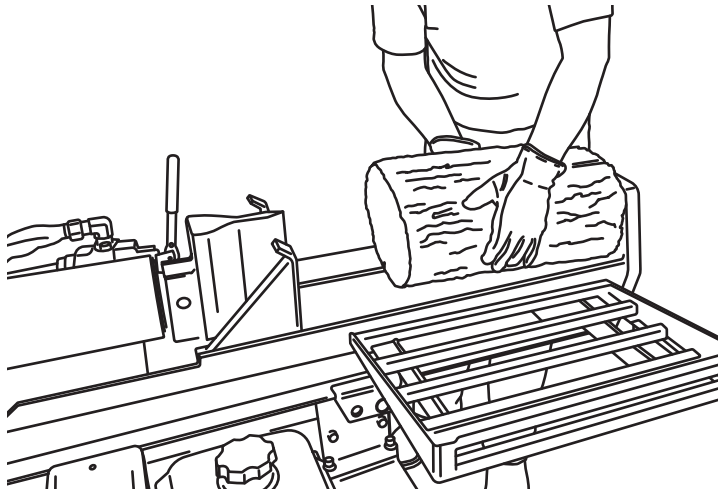

Never place hands between the log and splitting wedge while placing the log onto the beam rails, always handle the log from the sides, not the ends.

Always split the wood with the grain, not against the grain.

Never split more than one log at a time.

Before engaging the actuator, please ensure that you are standing in the proper location. See diagram.

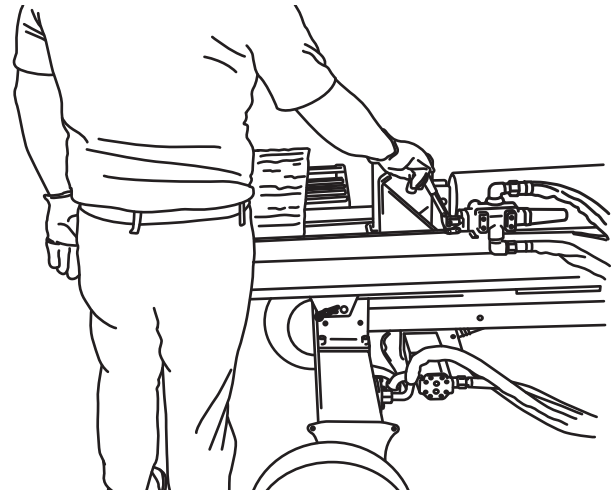

Once the log is in the proper position, place one hand on the actuator lever of the valve and move it towards the foot plate. This will engage the hydraulics and push the wedge through the log. Apply constant pressure to the lever until the wedge completely splits the wood and cylinder has fully traveled across the beam rails, pull back on the lever to retract the wedge. Once the detent is engaged, the lever will lock in the retract position until it automatically returns to its starting position.

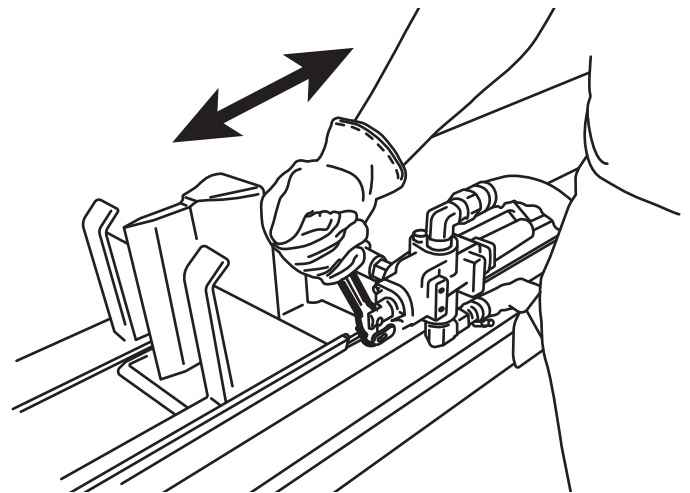

## OPERATING INSTRUCTIONS

DO NOT place the other hand on the log while the wedge is traveling towards the foot plate. NEVER touch the log while hydraulics are engaged.

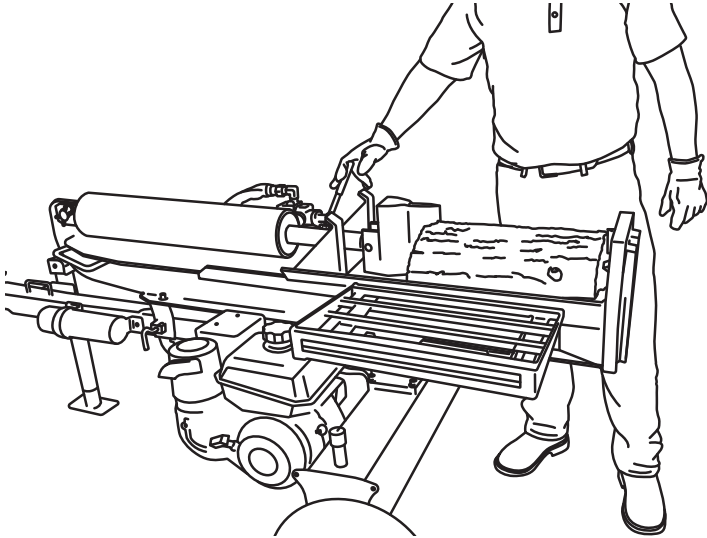

If the log does not split completely once the wedge has fully traveled on the beam rails, retract the wedge by pulling back on the handle as describe above and allow the stripper plates to hold the log while the wedge retracts. This will free the stuck log from the wedge.

- Always keep hands away from the log and stripper plates while the wedge retracts.
- Always keep work zone clean of split wood and debris to avoid trip hazards. Remember to keep the beam rails and debris slots free of wood and debris.



For logs over 100 pounds, we recommend the log splitter to be placed in vertical position.

NOTICE: Holding the valve in the “forward” position at the end of the stroke may damage the pump.

NOTICE: To extend the life of the hydraulic cylinder, avoid “bottoming out” wedge plate to the foot plate. To conform with the industry safety recommendations, the wedge stops at a minimum of 1” from the foot plate.

## Log Splitter Operation – Vertical Position

### Vertical Position

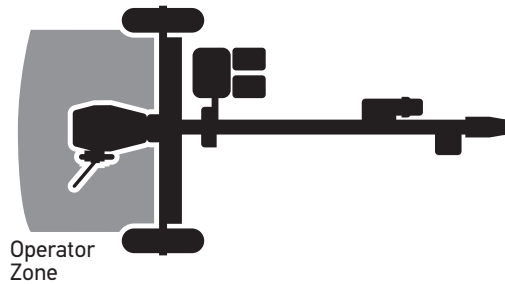

This is achieved by pulling the beam lock pin and standing the beam up slowly until the foot plate is firmly engaged on the ground and the log splitter is stable.

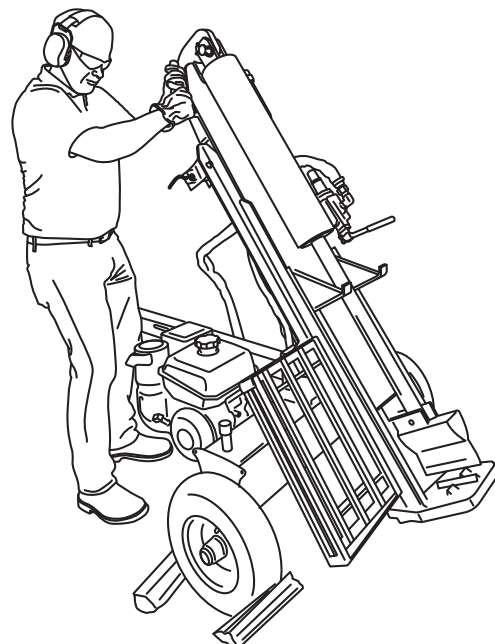
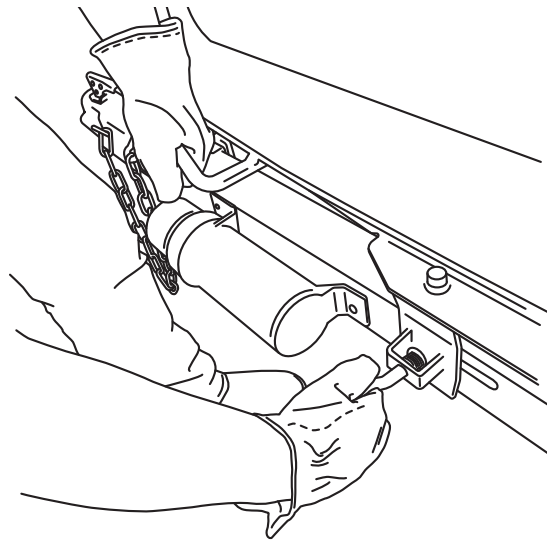

Once the beam is in the vertical position, engage the beam vertical lock located on the right side of the tongue and beam bracket.

Select a log and roll it to the splitter and place it on the foot plate up against the beam. For large rounds, place a wood block or wedge under the log to keep it firmly secured against the beam.

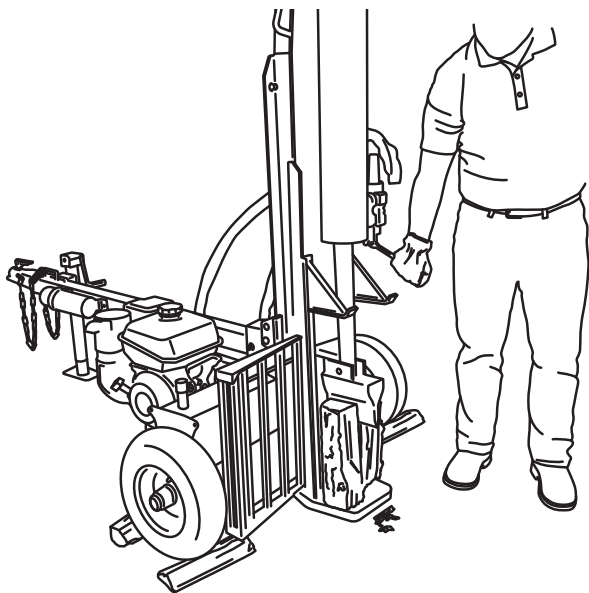

Once the log is secured, stand in the operator zone shown and engage the valve handle towards the foot plate.

**NOTICE:** Holding the valve in the “forward” position at the end of the stroke may damage the pump.

**NOTICE:** To extend the life of the hydraulic cylinder, avoid “bottoming out” wedge plate to the foot plate. To conform with the industry safety recommendations, the wedge stops at a minimum of 1” from the foot plate.

### Towing

**CAUTION**

**See safety information related to Towing Safety on page 7 of this manual.**

This log splitter is equipped with pneumatic tires, a class 1 coupler (2 in. diameter ball required) and safety chains. Before towing, the safety chains must be secured to the hitch or bumper of the vehicle. Local regulations should be checked regarding licensing, lights, towing, etc. Turn fuel shut off valve on the engine to the “OFF” position prior to towing. Failure to do so may result in flooding the engine. Do not exceed 45 mph when towing this log splitter. See also Towing Safety on page 7 of this manual.

### Storage

1. Follow engine manufacture recommendation for engine including storing with fuel in the tank.
2. Store in a dry place or under a water proof cover.
3. Shutoff fuel before storing.
4. Store the log splitter with the beam in the horizontal position, beam lock engaged, jack down and wheels blocked.

### Maintenance

**CAUTION**

**See safety information related to General Repair and Hydraulic Safety on page 10.**

1. Consult the operating and maintenance instructions of the engine manufacturer for engine care and maintenance.
2. Always check the oil level of the hydraulic reservoir before operation. Operating the log splitter without an adequate oil supply will cause severe damage to the pump.
3. Change the hydraulic oil filter after the first 25 hours of operation. Thereafter, change the oil filter every 100 hours or seasonally, whichever comes first. The filter kit part number is 622528.
4. To drain the hydraulic oil, remove the drain screw on the bottom of the tank.
5. If the wedge becomes dull or nicked, it can be removed and sharpened.
6. Clean the breather cap after 25 hours of operation. Clean it more often when operated in dusty conditions.
7. See also General Repair and Hydraulic Safety on page 10 of this manual.
8. All replacement parts must meet manufacturer’s specifications.

# Replacement Parts

## Beam Assembly

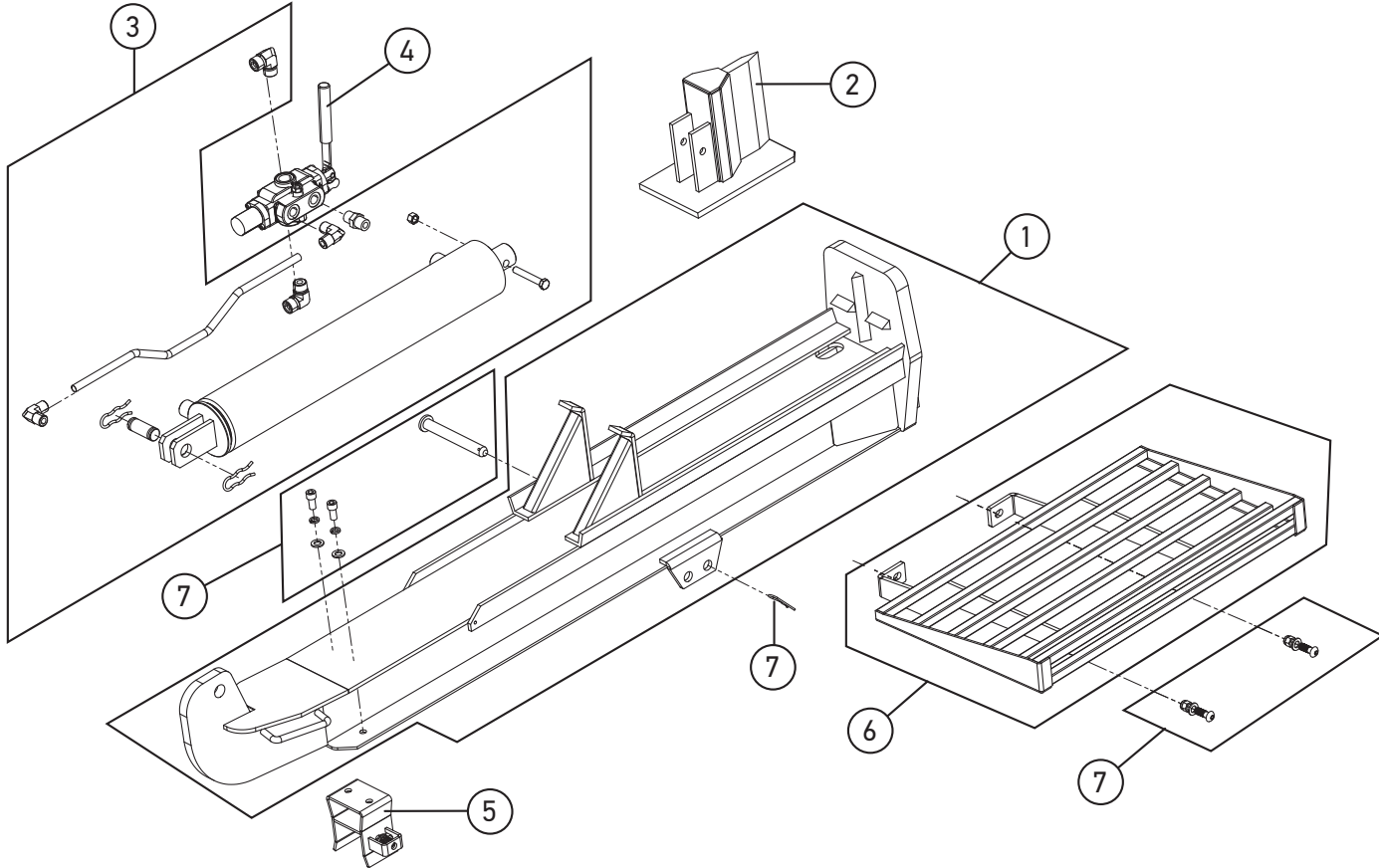

### 25T

Item	Kit No.	Description
1	622519	Beam 25T, with Oregon Decals
2	622524	8" Wedge, 25T
3	622906	4" Cylinder Kit with Decals
4	622608	Valve, 3915 PSI
5	622520	Beam Lock
6	622576	Log Catcher
7	622492	Hardware Kit
not shown	623308	4" Cylinder Seal Kit

### 30T

Item	Kit No.	Description
1	622543	Beam 30T, with Oregon Decals
2	624190	8" Wedge, 30T
3	622522	4.5" Cylinder Kit with Decals
4	622546	Valve, 3625 PSI
5	622520	Beam Lock
6	622576	Log Catcher
7	622492	Hardware Kit
not shown	623309	4.5" Cylinder Seal Kit

### 35T

Item	Kit No.	Description
1	622554	Beam 35T, with Oregon Decals
2	624191	8" Wedge, 35T
3	622545	5" Cylinder Kit with Decals
4	622523	Valve, 3625 PSI
5	622520	Beam Lock
6	622576	Log Catcher
7	622492	Hardware Kit
not shown	623310	5" Cylinder Seal Kit

Wheel Assembly

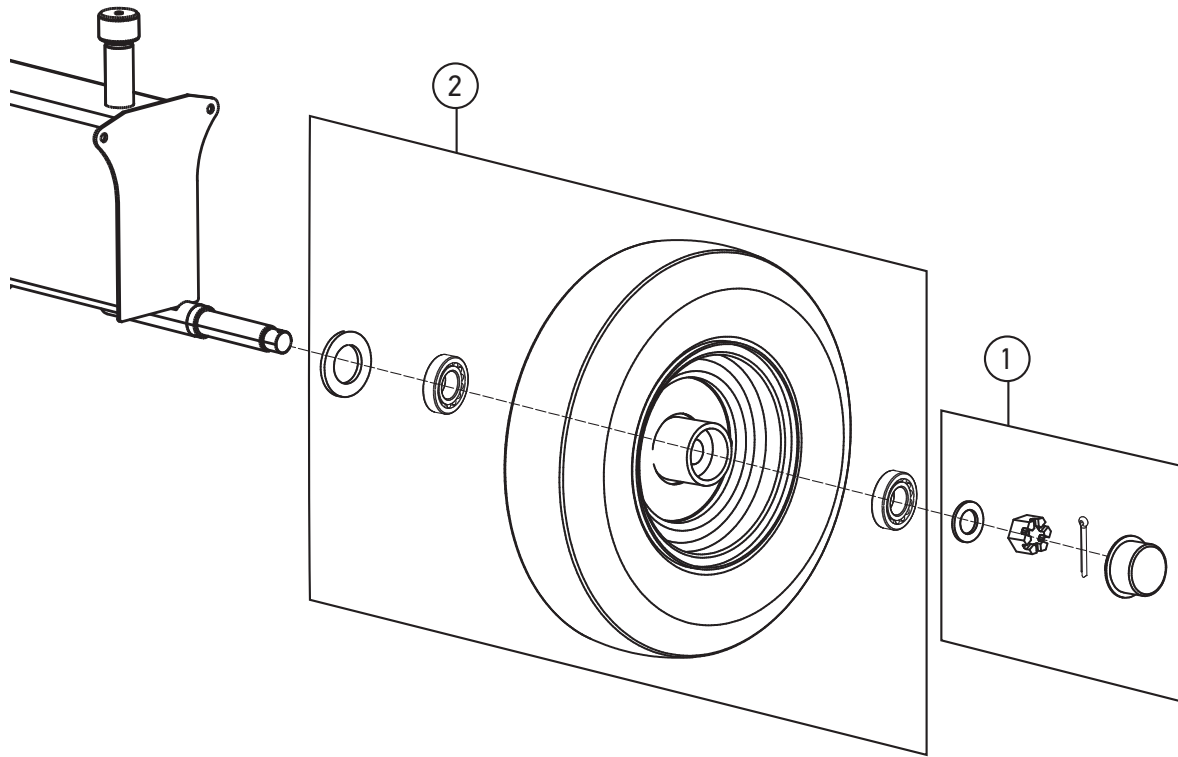

25T & 30T

Item	Kit No.	Description
1	622492	Hardware Kit, Bracket
2	S400312B0	4.8" X 8" Wheel Assembly

35T

Item	Kit No.	Description
1	622492	Hardware Kit, Bracket
2	S400312B0	4.8" X 8" Wheel Assembly

# REPLACEMENT PARTS

## Tank Assembly

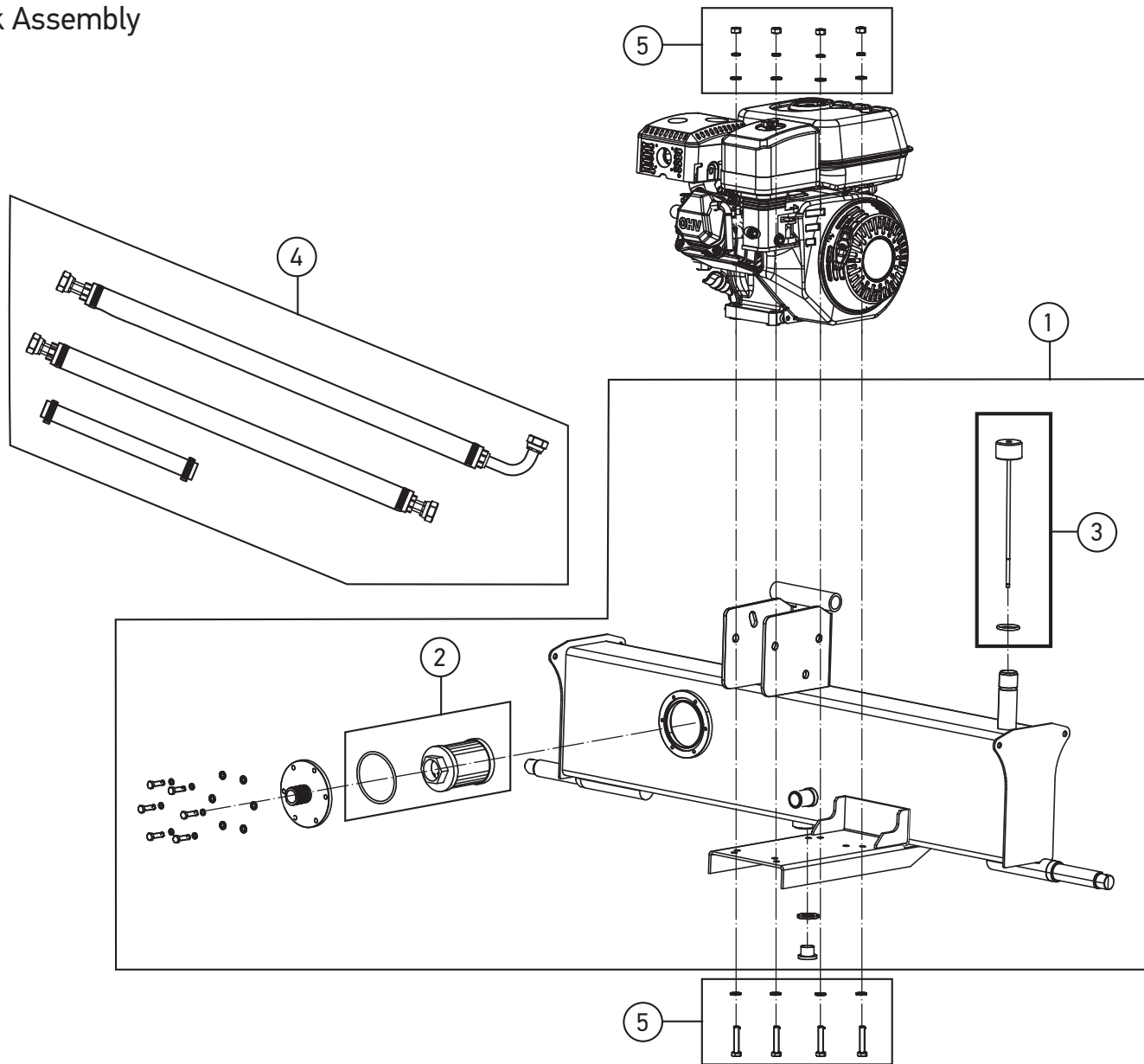

### 25T

Item	Kit No.	Description
1	622526	Assembly Tank, 25T
2	622528	Filter Assembly Kit
3	622529	Vent Cap Assy
4	622497	Hose Kit, Bracket
5	622492	Hardware Kit, 25T & 30T

### 30T

Item	Kit No.	Description
1	622622	Assembly Tank, 30T
2	622528	Filter Assembly Kit
3	622529	Vent Cap Assy
4	622497	Hose Kit, Bracket
5	622492	Hardware Kit, 25T & 30T

### 35T

Item	Kit No.	Description
1	622626	Assembly Tank, 35T
2	622528	Filter Assembly Kit
3	622529	Vent Cap Assy
4	622497	Hose Kit, Bracket
5	622492	Hardware Kit, 35T

Motor Assembly

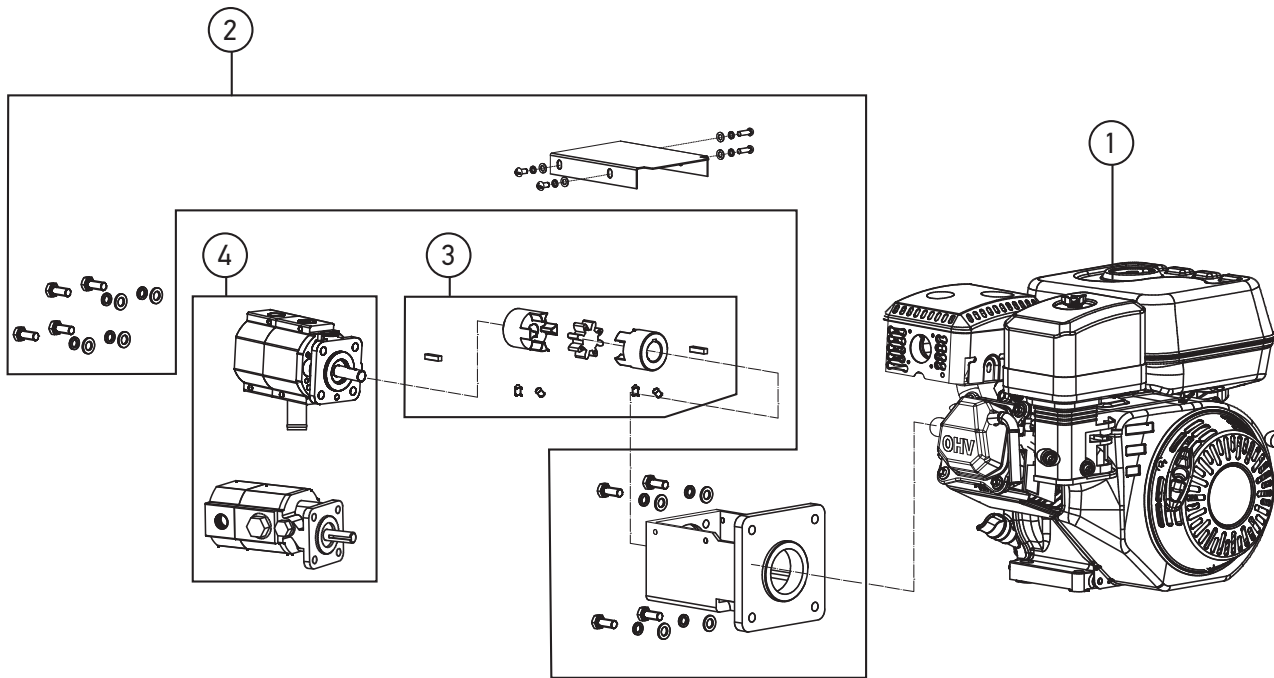

25T with Briggs CR950

Item	Kit No.	Description
1	623641	Motor, Briggs CR950
2	622535	SM Pump Mount Assembly Kit
3	622493	Briggs CR950 CPLR Kit
4	622536	Pump 2-Stage 14 GPM

30T with Briggs XR1150

Item	Kit No.	Description
1	622564	Motor, Briggs XR1150
2	622535	SM Pump Mount Assembly Kit
3	622538	Briggs XR1150 CPLR Kit
4	622536	Pump 2-Stage 14 GPM

25T with with Kohler SH265

Item	Kit No.	Description
1	622558	Motor, Kohler SH265
2	622535	SM Pump Mount Assembly Kit
3	623656	Kohler SH265 CPLR Kit
4	622536	Pump 2-Stage, 14 GPM

30T with Kohler SH265

Item	Kit No.	Description
1	622558	Motor, Kohler SH265
2	622535	SM Pump Mount Assembly Kit
3	623656	Kohler SH265 CPLR Kit
4	622536	Pump 2-Stage, 14 GPM

# REPLACEMENT PARTS

## Motor Assembly

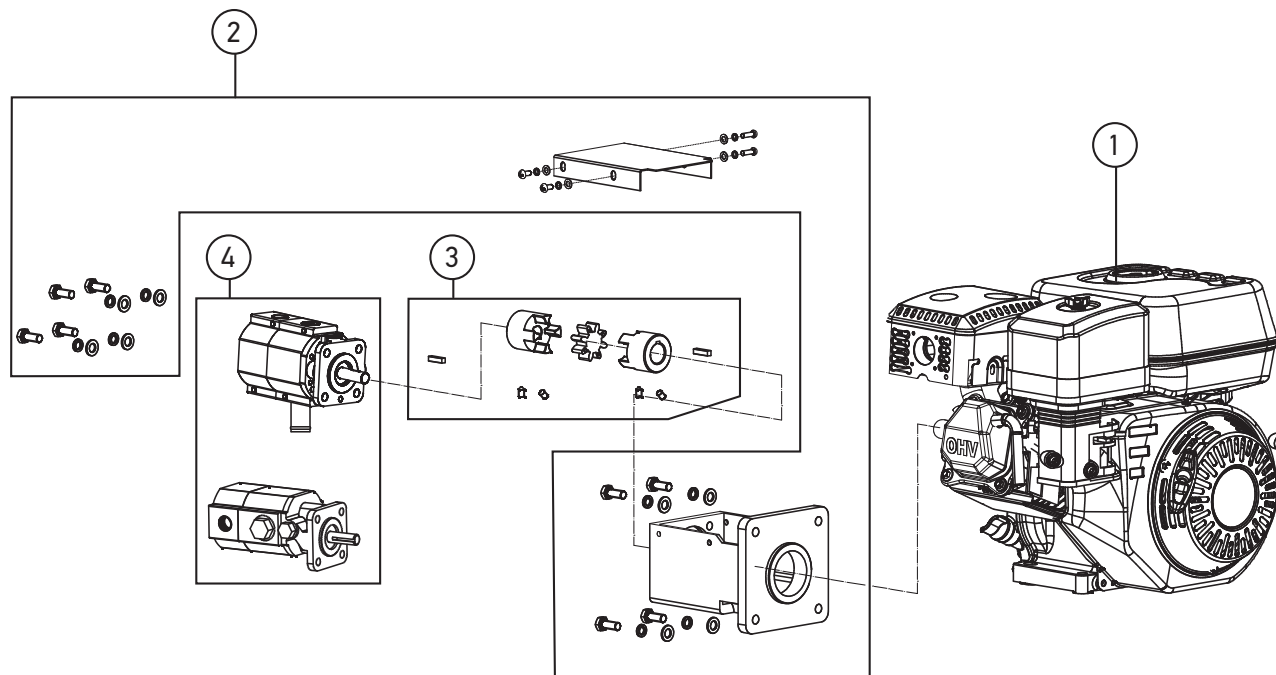

### 35T with Briggs XR1450

Item	Kit No.	Description
1	S39054500	Motor, Briggs XR1450
2	623939	MD Pump Mount Assembly Kit
3	622550	Briggs XR1450 CPLR Kit
4	622548	Pump 2-Stage, 17 GPM

### 35T with with Kohler CH395

Item	Kit No.	Description
1	622567	Motor, Kohler CH395
2	625330	LG Pump Mount Assembly Kit
3	623657	Kohler CH395 CPLR Kit
4	622548	Pump 2-Stage, 17 GPM



Tongue Assembly

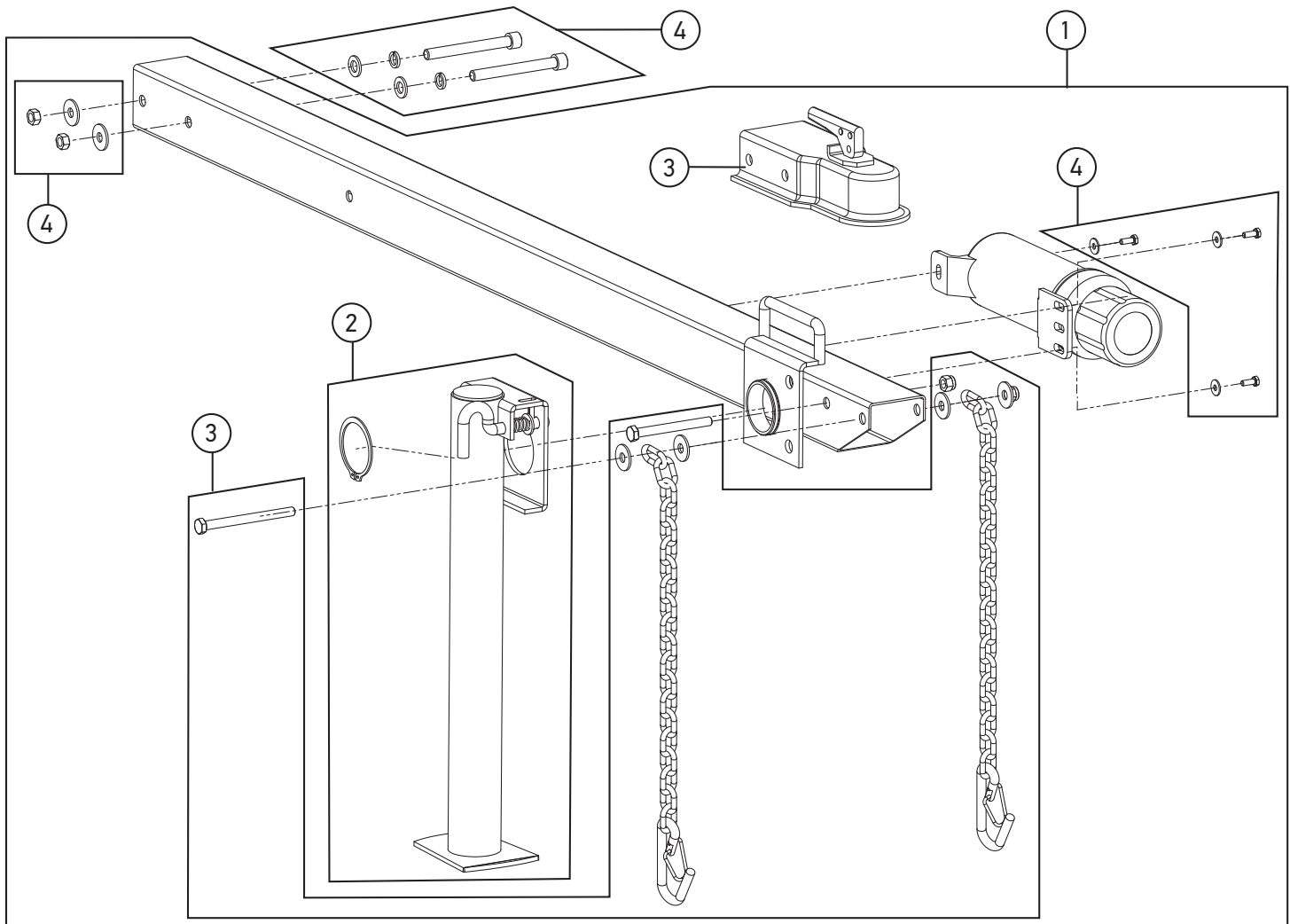

25T & 30T

Item	Kit No.	Description
1	622530	Tongue Assembly Ground Stand Kit
2	622533	Ground Stand Kit
3	622532	2in Ball Coupler Kit with Chains
4	622492	Hardware Kit, 25T & 30T

35T

Item	Kit No.	Description
1	622575	Tongue Assembly Jack Stand Kit
2	622578	Jack Stand Kit
3	622532	2in Ball Coupler Kit with Chains
4	622492	Hardware Kit, 35T

# REPLACEMENT PARTS

## 622492 Hardware Kit for 30T

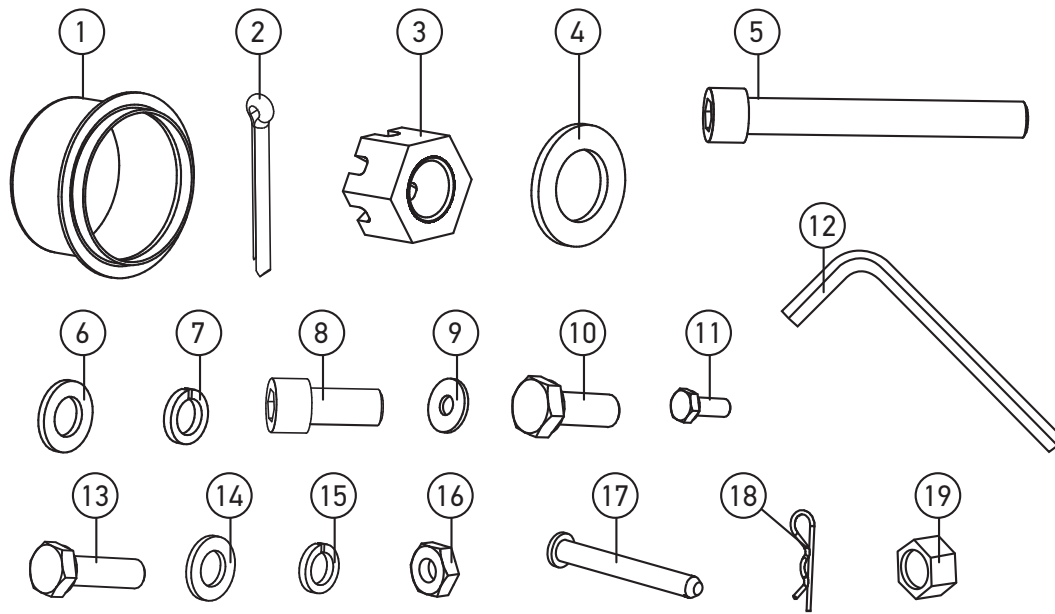

Item	Description	Quantity
1	Dust cap	2
2	4 x 50 Cotter Pin	2
3	M22 Castle Nut	2
4	M22 Flat Washer	2
5	M12 x 110mm Socket Head Cap Screw	2
6	M12 Flat Washer	8
7	M12 Lock Washer	6
8	M12 x 25mm Socket Head Cap Screw	2
9	M6 Flat Washer	3
10	M12 x 35mm Bolt	2
11	M6 x 20mm Hex Head Screw	3
12	Hex Key	1
17	Pin	1
18	R-Clip	1
19	M12 Nut	2

### 25T & 30T

Item	Description	Quantity
13	M8 x 40mm Bolt	4
14	M8 Flat Washer	8
15	M8 Lock Washer	4
16	M8 Nut	4

### 35T

Item	Description	Quantity
13	M10 x 45mm Bolt	4
14	M10 Flat Washer	8
15	M10 Lock Washer	4
16	M10 Nut	4

## Limited Warranty

This log splitter is guaranteed to be free from defects in material and workmanship for the normal service life of the product not to exceed 24 consecutive months from the date of purchase.

- The cylinder, valve, pump and other hydraulic components are guaranteed for two (2) years from the date of purchase.
- This warranty does not cover/extend to the engine. The engine is covered under a separate manufacturer's warranty and is enclosed with the owner's manual.
- Oregon will repair or replace, free of charge, any part or parts of the log splitter that are judged to be defective in material or workmanship during the limited warranty period stated above.

The limited warranty does not cover parts that in the judgement of the manufacturer have been subjected to negligent use, misuse, alteration, accident, disassembled in any way or if repairs have been made by anyone except an authorized Oregon service center. Warranty claims must include the log splitter identification number and be submitted within thirty days of the date of failure. Defective parts must be returned through an authorized Oregon dealer and transportation charges to the factory must be prepaid. You may register online at [OregonProducts.com](http://OregonProducts.com).

**DISCLAIMER OF OTHER WARRANTIES:** THIS LIMITED WARRANTY IS THE ONLY WARRANTY FOR THIS PRODUCT. OREGON MAKES NO OTHER WARRANTY, EXPRESS OR IMPLIED, INCLUDING ANY IMPLIED WARRANTY OF MERCHANTABILITY OR FITNESS FOR A PARTICULAR PURPOSE, WITH RESPECT TO THIS PRODUCT. ALL SUCH WARRANTIES ARE EXPRESSLY DENIED.

**LIMITATIONS OF LIABILITY:** MANUFACTURER ASSUMES NO LIABILITY FOR INCIDENTAL, CONSEQUENTIAL OR PUNITIVE DAMAGES IN CONNECTION WITH THE USE OF THIS PRODUCT, INCLUDING BUT NOT LIMITED TO LIABILITY FOR INJURY, LOSS OF LIFE, PROPERTY DAMAGE, LOSS OF USE, LOSS OF TIME, INCONVENIENCE OR COMMERCIAL LOSS. ANY AND ALL SUCH LIABILITY IS EXPRESSLY EXCLUDED. THESE LIMITATIONS OF LIABILITY APPLY TO ALL SUCH CLAIMS. IN NO EVENT SHALL OREGON BE RESPONSIBLE FOR ANY AMOUNT EXCEEDING THE PURCHASE PRICE OF THIS PRODUCT.



Oregon Tool, Inc.  
4909 SE International Way  
Portland, Oregon 97222 USA  
800-525-8322

**OregonProducts.com**

633904 AB 03/22