

ADJUSTABLE DROP HITCH

OPERATING INSTRUCTIONS

 TRAILER VALET

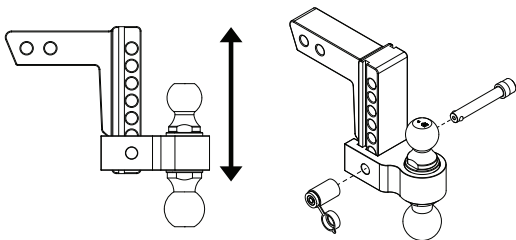

STEP 1:
Place the Drop Hitch at the desired drop on the drawbar in order to ensure that your vehicle and trailer are properly positioned.

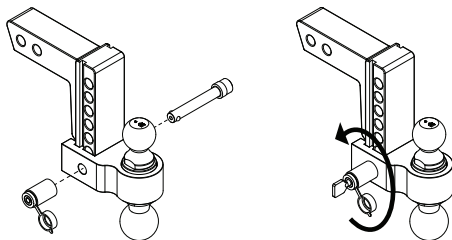

STEP 2:
Insert the keylock pin into the Drop Hitch when you have achieved the desired position along the drawbar.

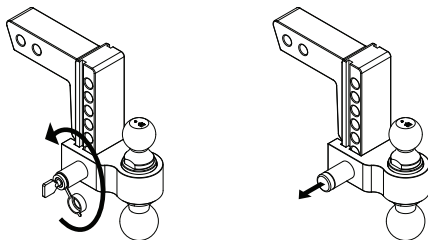

STEP 3:
To lock the keylock pin in place, turn key counter clockwise. To unlock, turn key clockwise.

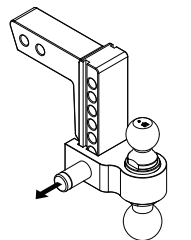

STEP 4:
Pull keylock pin to ensure that it has been engaged. Do not operate without making sure keylock assemble is securely locked in place.

IMPORTANT SAFETY INFORMATION

Ensure safety chains are attached between vehicle and trailer. **DO NOT** attach chains directly to hitch. Do not exceed either the tow vehicle's rated load or your Blackout Drop Hitch capacity rating. Secure your Blackout Drop Hitch to receiver with keylock or hitch pin.

BALL MOUNTS & DROP HITCHES

SPECIFICATIONS



				
SKU	BSDH0010	BSDH0011	BSDH0020	BSDH0040
BALL SIZE	2"	2"	2" and 2-5/16"	2" and 2-5/16"
DROP	2"	4"	2"	0-6"
TYPE	Standard	Standard	Reversible	Adjustable
CAPACITY	5,000 LBS	6,000 LBS	6,000/7,500 LBS	14,000 LBS
MATERIAL	Steel	Steel	Steel	Steel
CLASS	Class III	Class III	Class III	Class V

				
SKU	BSDH0030	BSDH0031	BSDH0032	BSDH0033
BALL SIZE	2" and 2-5/16"	2" and 2-5/16"	2" and 2-5/16"	2" and 2-5/16"
DROP	0-4"	0-6"	0-8"	0-10"
TYPE	Adjustable	Adjustable	Adjustable	Adjustable
CAPACITY	8,000/10,000 LBS	8,000/10,000 LBS	8,000/10,000 LBS	8,000/10,000 LBS
MATERIAL	Aluminum	Aluminum	Aluminum	Aluminum
CLASS	Class IV	Class IV	Class IV	Class IV