

RIPPLING TOWER OUTDOOR WATER FOUNTAIN SSS-183

Read the assembly instructions carefully and follow the care instructions. Keep these instructions for future reference.

Select a smooth, level surface to place the fountain.

Assemble components on a soft, clean surface to avoid scratching or damaging the finish.

| PARTS | QTY. |
|---------------------------|------|
| Fountain Body | 1 |
| Basin | 1 |
| Electric Submersible Pump | 1 |
| AC Adapter | 1 |
| Leak Guard | 1 |



Inspect packaging to ensure all parts are accounted for before disposing of packing materials.

NOTE: The water tubing is built into the fountain body. Take care when handling the water tube; detaching the water tube from the fountain will damage the fountain and void the product warranty.

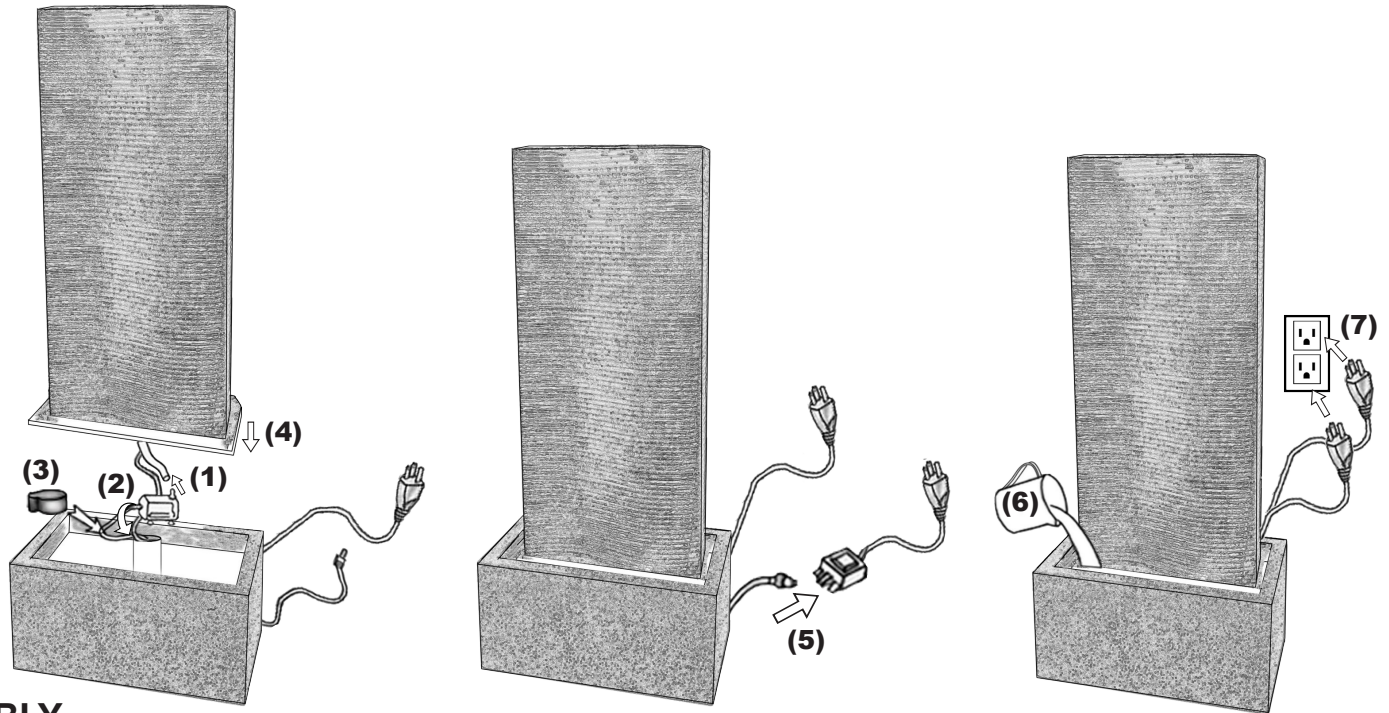

ASSEMBLY

1. Locate the water tube on the underside of the fountain body and firmly attach the pump.
2. Run the pump and the light power cords through the tube located inside the basin. Make sure the power cords are beneath the groove on the bottom of the basin to prevent damage once the fountain is filled with water.
3. Place the leak guard over the tube inside the fountain basin, ensuring the power cords are within the groove of the leak guard.
4. Gently place the fountain body onto the basin.
5. Connect the pump cord to the transformer.
6. Fill the fountain with enough water to keep the pump fully submerged during operation; approximately 2.5 gallons.
7. Plug the power cords into properly grounded GFCI outlets.

Note: When first used, there may be air in the pump. It may take several minutes for trapped air to escape, allowing water to flow. You may need to add more water as the pump begins to circulate water through the fountain.

TROUBLESHOOTING

- Ensure that the pump is fully submerged and add water if necessary.
- If water is not flowing within several moments of the fountain being plugged in, the pump may have trapped air which can prevent water from circulating properly. Simply unplug the power supply for a few moments and plug it back in.
- If water is not flowing check the tubing for kinks or obstructions. Also check the pump for obstructions.
- If water is splashing, check the flow control on the body of the pump; it may need to be adjusted to achieve the desired flow rate.
- If water is not flowing evenly, ensure the fountain is on a smooth, level surface.
- If the lights are not working, ensure the cables are fully connected and the seal is adequately tightened (do not over-tighten). Ensure connector ends are completely dry before connecting and plugging the power cord back into an outlet.
- Soft surfaces may cause the fountain to become unbalanced. A large stepping stone or paving stone (not included) is recommended to help ensure the fountain remains evenly balanced.
- Make sure the power outlet is working; if in doubt about electrical connections, consult a certified electrician.

If you are still experiencing issues, please contact our customer service team through one of the methods mentioned at the top of page 1. Please have the item number and order information available to help expedite response time.

⚠ IMPORTANT INFORMATION ⚠

- For outdoor use only.
- Some splashing is normal; adjust the flow rate on the pump body if the water flow is too high.
- Check the water level and fill frequently to ensure the pump remains fully submerged; never allow the pump to run dry as it will burn out the motor.
- Only use water in this fountain. Distilled water will help prevent mineral buildup, but is not required. Avoid heavily chlorinated water as it may damage the fountain and pump.
- Periodically change the water to keep the fountain and pump clean. Remove scale and buildup regularly.
 - DO NOT use harmful additives such as bleach, chlorine, etc.
 - DO NOT use abrasive materials to scrub the fountain or pump.
 - DO NOT use a pressure washer to clean the fountain.
- Always shut the power supply off before cleaning and maintaining the fountain and pump.
- Take care when handling the pump; only pick it up by the body of the pump, never by the power cord.
- During freezing weather, drain the fountain, disconnect the pump and store indoors; allowing ice to form may damage the fountain in such ways as, but not limited to, the fountain cracking, permanent pump damage, and/or lighting malfunctions.
- Over time, the finish may gradually mellow in color from sun exposure; this is part of the natural aging process and is not cause for return.

Any modification to the product or failure to follow recommended care will void the product warranty.

⚠ WARNING!

Manufacturer and seller expressly disclaim any and all liability from personal injury, property damage or loss, whether direct or indirect, or incidental, resulting from the incorrect attachment, improper use, inadequate maintenance, or neglect of this product.