



Foot-Operated Kindling Splitter

OWNER'S MANUAL



WARNING:

Carefully read and understand all **ASSEMBLY AND OPERATION INSTRUCTIONS** before operating. Failure to follow the safety rules and other basic safety precautions may result in serious personal injury.

Item# TMW-84

Thank you very much for choosing this product! For future reference, please complete the owner's record below:

Model: TMW-84

Purchase Date: _____

Save the receipt, the warranty, and these instructions. It is important that you read the entire manual to become familiar with this product before you begin using it. This product is designed for certain applications only. The manufacturer cannot be responsible for issues arising from modification. We strongly recommend that this product not be modified and/or used for any application other than that for which it was designed. If you have any questions relative to a particular application, DO NOT use the product until you have first contacted us to determine if it can, or should, be performed on the product.

For technical questions, please call 1-218-943-6290.

INTENDED USE

Timber Tuff's TMW-84 Foot-Operated Kindling Splitter is the easy way to split wood. It is designed with a step ratchet and handles logs up to 18" long and 10" in diameter. It easily splits wood using the power of your foot.

GENERAL SAFETY RULES



WARNING: Read and understand all instructions. Failure to follow all instructions listed below may result in serious injury.



CAUTION: Do not allow persons to operate or assemble this Foot-Operated Kindling Splitter until they have read this manual and have developed a thorough understanding of how the Foot-Operated Kindling Splitter works.



WARNING: The warnings, cautions, and instructions discussed in this instruction manual cannot cover all possible conditions or situations that could occur. It must be understood by the operator that common sense and caution are factors that cannot be built into this product, but must be supplied by the operator.

SAVE THESE INSTRUCTIONS

WORK AREA

- Keep work area clean, free of clutter, and well lit. Cluttered and dark work areas can cause accidents.
- Keep children and bystanders away while operating a Foot-Operated Kindling Splitter. Distractions can cause you to lose control, so visitors should remain at a safe distance from the work area.
- Be alert of your surroundings. Using a Foot-Operated Kindling Splitter in confined work areas may put you dangerously close to sharp tools and rotating parts.

PERSONAL SAFETY

- Stay alert, watch what you are doing, and use common sense when using a Foot-Operated Kindling Splitter. Do not use a Foot-Operated Kindling Splitter while you are tired or under the influence of drugs, alcohol, or medication. A moment of inattention while operating a Foot-Operated Kindling Splitter may result in serious personal injury.
- Dress properly. Do not wear loose clothing, dangling objects, or jewelry. Keep your hair, clothing, and gloves away from moving parts. Loose clothes, jewelry, or long hair can be caught in moving parts.
- Use safety apparel and equipment. Use safety goggles or safety glasses with side shields that comply with current national standards or, when needed, a face shield. Use a dust mask if working in dusty work conditions. This applies to all persons in the work area. Also use non-skid, safety shoes, hard hats, heavy-duty work gloves, dust collection systems, and hearing protection when appropriate.

Foot-Operated Kindling Splitter USE AND CARE

- Do not modify the Foot-Operated Kindling Splitter in any way. Unauthorized modification may impair the function and/or safety and could affect the life of the equipment. There are specific applications for which the Foot-Operated Kindling Splitter was designed.
- Always check for damaged or worn-out parts before using the Foot-Operated Kindling Splitter. Broken parts will affect the Foot-Operated Kindling Splitter operation. Replace or repair damaged or worn parts immediately.
- Do not exceed the Foot-Operated Kindling Splitter load capacity.
- Distribute the load evenly. Uneven loads may cause the Foot-Operated Kindling Splitter to tip, resulting in personal injury to the operator or others.
- Use the Foot-Operated Kindling Splitter on flat and level surfaces capable of supporting the Foot-Operated Kindling Splitter and its maximum load. Pulling or pushing a load on a slanted or uneven surface can result in loss of control.
- Store idle Foot-Operated Kindling Splitter. When Foot-Operated Kindling Splitter is not in use, store it in a secure place out of the reach of children. Inspect it for good working condition prior to storage and before re-use.

ASSEMBLY

WARNING KEEP FACE WELL AWAY WHEN UNCLIPPING.

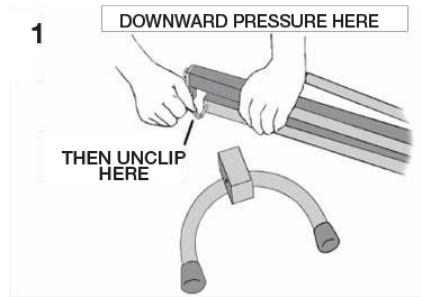
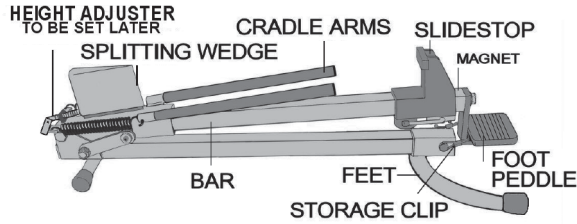

UNIT COMES IN TWO PIECES. ASSEMBLY REQUIRED. TAKEOUT STORAGECLIP, THEN SLOWLY RELEASE PRESSURE. THEBAR WILL RISE TO 2 INCHES.

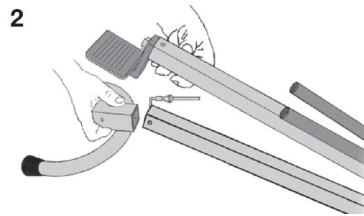

INSTALL FEET. RE-INSTALL STORAGE CLIP

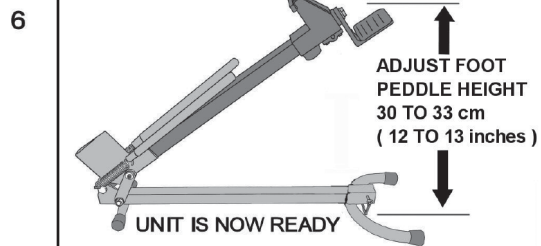
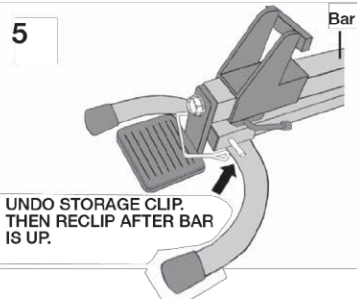
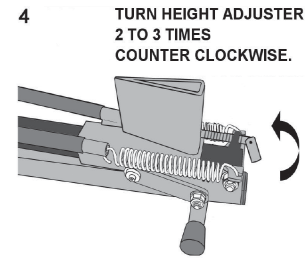
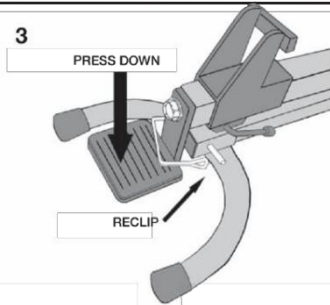

NET WEIGHT: 21 LBS

CUTTING CAPACITY: 10in DIAMETER, 18in LENGTH

DIMENSIONS: 32.5in L x 10.5in W x 9in H

OPERATION

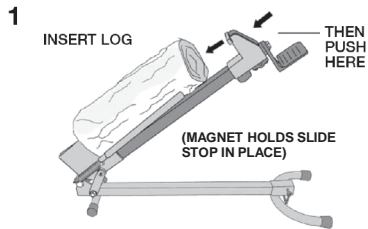

PLACE ON MAT TO PROTECT FLOORING.

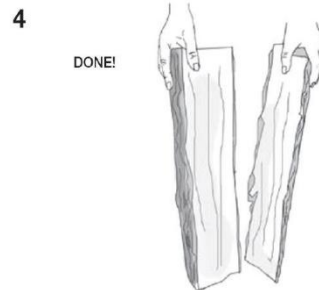
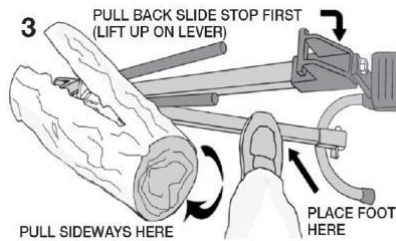
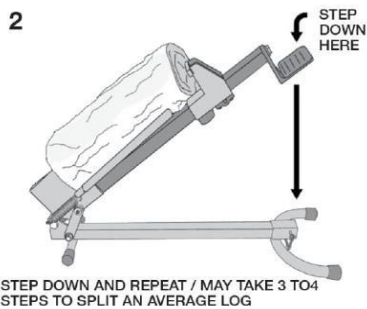

TIPS

Wet or non-seasoned wood is more difficult to split than dry wood because the fibers stick together. Reversing the block and splitting from the other end may help if you cannot pull the wood apart.

Similarly large or multiple knots in a log make splitting more difficult. Usually if the log is rotated so that the knots are vertical to the blade, the wood will split more easily and less stress is placed on the splitter. This will reduce wear and tear or the possibility of damaging some components of the splitter.

Damage from overstress or abuse may void the warranty on your firewood splitter. This splitter is not designed to replace heavy-duty hydraulic powered equipment.

PARTS DIAGRAM:

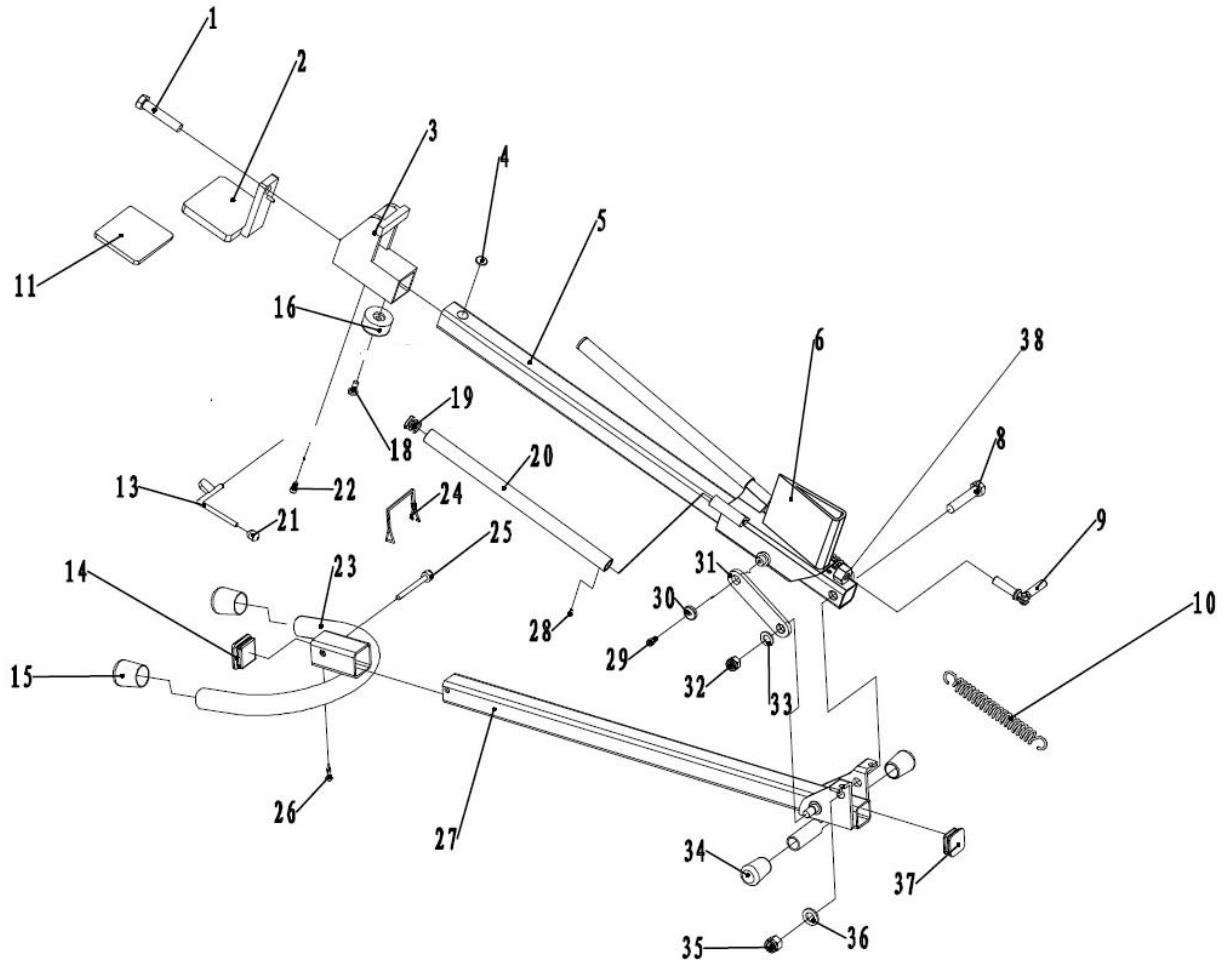

PARTS LISTING:

Part#	Description	Qty.	Part#	Description	Qty.
1	Screw M10x25	1	22	Screw M5x10	2
2	Pedal	1	23	Condition Foot	1
3	Log Arm	1	24	Transport Lock	1
4	Magnet	1	25	Shaft	1
5	Arm	1	26	Screw M4x20	1
6	Splitting Wedge	1	27	Stand	1
8	Screw M12x60	1	28	Pin	2
9	Adjusting Screw	1	29	Screw M5x15	2
10	Spring	2	30	Washer Ø25mm	2
11	Rubber Pedal	1	31	Lever Arm	2
13	Stopping Lever	1	32	Lock Nut M10	2
14	Cap 38x38mm	1	33	Washer Ø20mm	2
15	Rubber Foot	2	34	Rubber Foot	2
16	Rubber Bracket	1	35	Lock Nut M12	1
18	Screw M6x20	1	36	Washer Ø24mm	1
19	Cap Ø20mm	2	37	Cap 32x32mm	1
20	Log Guide Bar	2	38	Adjust Nut M10	1
21	Stopping Lever Ball	2			

For technical questions or replacement parts, please call 218-943-6290.

WARRANTY

One-year limited parts warranty.



BAC

PO BOX 155

Miltona, MN 56354

Made in China