

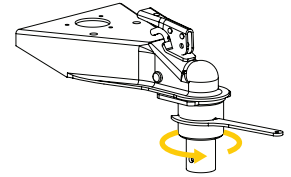

TRAILER VALET XL w/ BALL MOUNT

Quick Start Guide

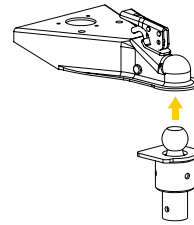
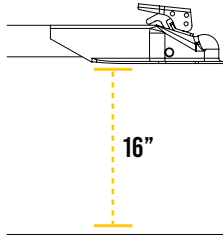

1.

Check trailer height and raise the trailer tongue to where the frame is about 16 inches off the ground to give adequate space to attach the dolly.

2.

Attach hitch ball w/ ball base to coupler.

3.

Use spanner wrench and tighten that base!

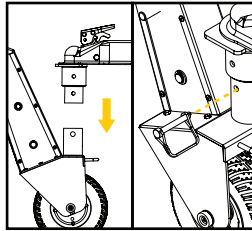

4.

Using your trailer jack, lower the hitch towards the unit's rotating coupler and attach rotation pin to secure.

5.

Make sure the XL is securely tightened and not rocking.

6.

Attach the crank handle, lift the steering handle to disengage brakes, and start moving!

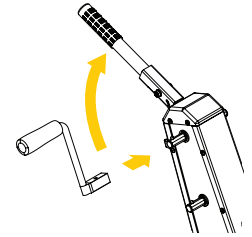
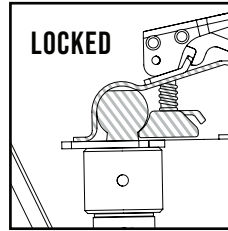

Check that you have all your parts and accessories.



SPANNER WRENCH

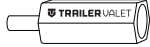

DRILL ATTACHMENT

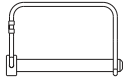

ROTATION PIN



COUPLING PLATE

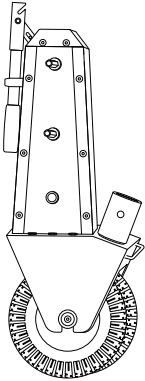

XL UNIT

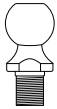

HITCH BALL

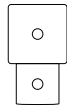

BALL BASE

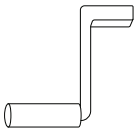

HAND CRANK



MANUAL

IMPORTANT SAFETY INFORMATION

For information and assistance, please visit our support page at TrailerValet.com or give us a call at (844) 846-9344. Scan the QR code to the right for detailed safety and usage information.





TRAILER VALET XL w/ MOUNT BRACKET

Quick Start Guide

<p>Check that you have all your parts and accessories.</p>		<p>SECURITY BOLT</p>	<p>ROTATION PIN</p>
<p>XL UNIT</p>	<p>CRANK HANDLE</p>	<p>DRILL ATTACHMENT</p>	
	<p>MANUAL</p>	<p>BRACKET CLAMPS (2X)</p>	
<p>FOAM STRAP</p>			
<p>MOUNT BRACKET</p>	<p>BRACKET BOLTS (4X)</p>		
<p>MOUNTING JOINT</p>	<p>STOW PIN</p>		

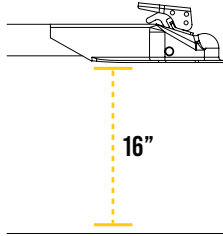

1. Check trailer height and raise the trailer tongue to where the frame is about 16 inches off the ground to give adequate space to attach the dolly.
2. Install the XL Mount bracket to your trailer frame.

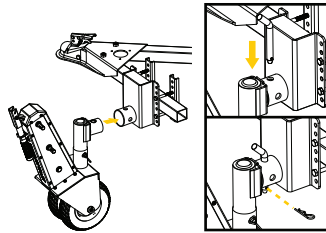
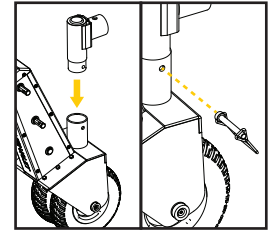
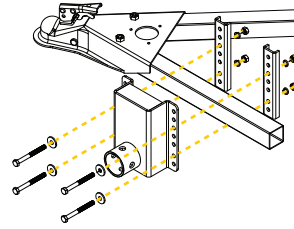

4. Connect XL unit to Mount Bracket and secure with stow pin.
5. Attach the crank handle, lift the steering handle to disengage brakes, and start moving!

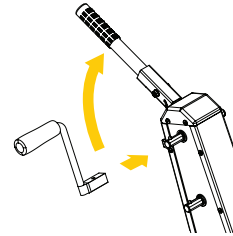

6. **OPTIONAL:** Lock with security bolt located in the back of the bracket to prevent removal.

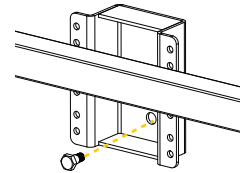

IMPORTANT SAFETY INFORMATION

For information and assistance, please visit our support page at TrailerValet.com or give us a call at (844) 846-9344. Scan the QR code to the right for detailed safety and usage information.

