



# HITCH BALL & BALL BASE

Operating Instructions

TVHB20/TVHB25

Rev 6.13.23

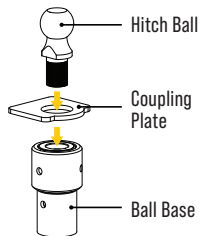

## STEP 1:

If the Coupling Plate is not already installed with the Ball Base, detach the ball from the Base, slip the Coupling Plate under the ball, and reinsert into the Base. Secure tightly.

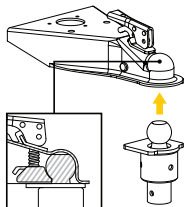

## STEP 2:

Slip the Hitch Ball into the coupler and lock the ball with the coupler latch.

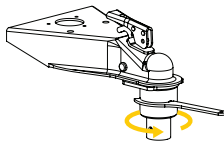

## STEP 3:

Using the Spanner Wrench, turn the Locking Nut counter clockwise until the nut is secured flat against the coupler.

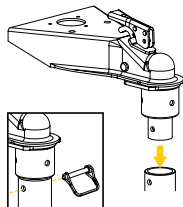

## STEP 4:

Using your trailer jack, lower the hitch towards the unit's rotating coupler and attach a rotation pin to secure and start moving!

## WARNING!

Failure to tighten the Locking Nut against the coupler may cause the ball to slip out of the coupler.