

# DR<sup>®</sup> PTO POST HOLE DIGGER

## SAFETY & OPERATING INSTRUCTIONS



Serial No. \_\_\_\_\_

Order No. \_\_\_\_\_

DR Power Equipment  
Toll-free phone: 1-800-DR-OWNER (376-9637)  
Fax: 1-802-877-1213  
Website: [www.DRpower.com](http://www.DRpower.com)

### **WARNING**

Read and understand this manual and all instructions before operating the DR PTO Post Hole Digger.

## Table of Contents

Chapter 1: General Safety Rules.....	3
Chapter 2: Setting Up The DR PTO Post Hole Digger .....	6
Chapter 3: Operating The DR PTO Post Hole Digger .....	10
Chapter 4: Maintaining The DR PTO Post Hole Digger .....	11
Chapter 6: Parts Lists and Schematic Diagrams .....	14

### *Conventions used in this manual*

---

#### **DANGER**

This indicates a hazardous situation, which, if not followed, *will* result in death or serious injury.

---

#### **WARNING**

This indicates a hazardous situation, which, if not avoided, *could* result in death or serious injury.

---

#### **CAUTION**

This indicates a hazardous situation, which, if not avoided, *could* result in minor or moderate injury.

---

#### **NOTICE**

This information is important in the proper use of your machine. Failure to follow this instruction could result in damage to your machine or property.

---

### *Serial Number and Order Number*

A Serial Number is used to identify your machine and is located on the Serial Number Label on your machine. An Order Number is used to check and maintain your order history and is located on the upper left portion of your packing slip. For your convenience and ready reference, enter the Serial Number and Order Number in the space provided on the front cover of this manual.

### *Additional Information and Potential Changes*

DR Power Equipment reserves the right to discontinue, change, and improve its products at any time without notice or obligation to the purchaser. The descriptions and specifications contained in this manual were in effect at printing. Equipment described within this manual may be optional. Some illustrations may not be applicable to your machine.

## Chapter 1: General Safety Rules

### **WARNING**

- Read the tractor owner's manual for instructions on operation, attachment of 3-point equipment and safety before using this Post Hole Digger.
- Read this Safety & Operating Instructions manual before you use the DR PTO Post Hole Digger. Become familiar with the operation and service recommendations to ensure the best performance from your machine. If you have any questions or

### Labels

Your DR PTO Post Hole Digger carries prominent labels as reminders for its proper and safe use. Take a moment to study them and make a note of their location on your DR PTO Post Hole Digger as you set up and before you operate the unit. Replace damaged or missing safety and information labels immediately.



#400421



#400431



#400401

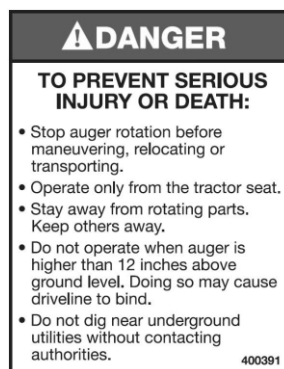

#400391



#400411



#400381

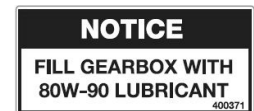

#400371

### Tractor Safety Information

### **DANGER**

- YOUR DR PTO Post Hole Digger is driven by a PTO shaft that transfers power from your Tractor. The Tractor and PTO shaft are extremely dangerous and will cause serious injury or death if not used properly. Read and understand all of the Warnings and operating instructions that came with your Tractor and the PTO shaft to protect yourself from severe injury or death.
- Always check with authorities for underground utilities before digging a hole. Serious injury or death could result from contact with gas or electric lines.
- NEVER operate the post hole digger with anyone near or in contact with any part of the implement, PTO driveline or auger. Serious injury or death could result from entanglement with moving parts.

### Safety for Children and Pets

### **WARNING**

Tragic accidents can occur if the operator is not alert to the presence of children and pets. Children are often attracted to the machine and the digging activity. *Never* assume that children will remain where you last saw them. Always follow these precautions:

- Keep children and pets out of the working area and under the watchful care of a responsible adult.
- Be alert and turn the machine off if children or pets enter the work area.
- Never allow children to operate the DR PTO Post Hole Digger.
- Use extra care when approaching blind corners, shrubs, trees, or other objects that may obscure your vision.

## *Protecting yourself and those around you*

### **WARNING**

This is a high-powered machine, with moving parts operating with high energy at high speeds. You must operate the machine safely. Unsafe operation can create a number of hazards for you, as well as anyone else in the nearby area. Always take the following precautions when using this machine:

- Keep in mind that the operator or user is responsible for accidents or hazards occurring to other people, their property, and themselves.
- Always wear protective goggles or safety glasses with side shields while operating the Post Hole Digger to protect your eyes from possible thrown debris.
- Avoid wearing loose clothing or jewelry, which can catch on the machine's moving parts.
- Use ear protectors or ear plugs rated for at least 20 dba to protect your hearing.
- NEVER attach the post hole digger with the tractor engine running.
- Never tamper with safety devices. Check their proper operation regularly.
- Never operate the machine when under the influence of alcohol, drugs, or medication.

## *Operating the Post Hole Digger Safely*

### **WARNING**

This is a high-powered machine, with moving parts operating with high energy at high speeds. You must operate the machine safely. Unsafe operation can create a number of hazards for you, as well as anyone else in the nearby area. Always take the following precautions when using this machine:

- Know how to stop the Post Hole Digger quickly by disengaging the PTO Shaft and shutting down the tractor.
- Never allow people who are unfamiliar with these instructions to use the DR PTO Post Hole Digger. Allow only responsible individuals who are familiar with these rules of safe operation to use your machine.
- Operate this Post Hole Digger from the tractor seat only. Make sure that the tractor engine is shut off and the PTO drive is disengaged before leaving the tractor seat.
- ALWAYS make sure that the Tractor Brake is set before Digging a hole.
- NEVER move the tractor with the power-take-off in the ON position.
- Only one person should operate the Post Hole Digger.
- Make sure that the auger point and cutting edges are intact and in good working order before using this Post Hole Digger.
- Your DR PTO Post Hole Digger is a powerful tool, not a plaything. Exercise extreme caution at all times. The design of your machine is for digging holes. Do not use it for any other purpose.
- Whenever you leave the operating position to make adjustments, maintain blades, or if you have to remove grass or debris from the Auger, always disengage the PTO, shut down the Tractor Engine, remove the Key, wait for all moving parts to come to a complete stop, disconnect the PTO shaft from the Tractor, then wait five minutes before performing any maintenance procedure or inspection on the Post Hole Digger.
- This machine is designed to operate at 540 rpm PTO Shaft speed only! Never operate at a faster speed; doing so can cause serious injury to the operator or bystanders and could cause damage to the machine that is not covered under warranty.
- NEVER operate the post hole digger with the auger point more than 6 inches above ground level. Operating the Post Hole Digger in elevated positions may cause the PTO "U" joints to bind resulting in equipment damage and operator injury.

## Operating the Post Hole Digger Safely (continued)

### **WARNING**

- ALWAYS turn off the digger immediately if an immovable object is encountered to prevent damage to the gear box or driveshaft and possible injury. A shear bolt is provided but may become welded to the input shaft if the driveshaft is left running after being sheared.
- Do not transport people, animals, or objects on the Post Hole Digger.
- NEVER manually position the auger or manually force the auger into the ground.
- Be mindful of roll over hazards, changes in terrain, slopes, or wet conditions. Use care when backing up.
- Never, under any conditions, remove, bend, cut, fit, weld, or otherwise alter standard parts on the DR PTO Post Hole Digger. This includes all shields and guards. Modifications to your machine could cause personal injuries and property damage and will void your warranty.
- If the Auger strikes a foreign object or if your machine should start making an unusual noise or vibration, disengage the PTO, shut down the Tractor Engine, remove the Key, wait for all moving parts to come to a complete stop, lower the Auger to the ground, disconnect the PTO shaft from the Tractor, then wait five minutes before performing any maintenance procedure or inspection on the Post Hole Digger. Vibration is generally a warning of trouble. Clean, repair, and/or replace damaged parts.
- While using the DR PTO Post Hole Digger, do not hurry or take things for granted. When in doubt about the equipment or your surroundings, turn the tractor engine off, disengage the PTO drive and lower the auger point to the ground.
- Use the machine only in daylight.
- Be cautious when using your DR PTO Post Hole Digger around fencing, rocks, wires, ropes, and hoses. It is possible that these and other debris can hit or become wound around the Auger, potentially damaging the machine or injuring you.
- Keep all nuts and bolts tight and keep the equipment in good operating condition.

## Safety When Digging Near Utilities

### **DANGER**

Call 811 before you begin any digging project. A new, federally-mandated national "Call Before You Dig" number, 811 was created to help protect you from unintentionally hitting underground utilities while working on digging projects. Every digging job requires a call. If you hit an underground utility line while digging, you can harm yourself or those around you, disrupt service and potentially be responsible for fines and repair costs.

- There may be buried power, gas, and/or telephone lines in the work area. Electric shock, death, or explosion may occur.
- Have the property or work area marked for buried lines and do not dig in marked areas.

## California Proposition 65

### **WARNING**

California Proposition 65:

- This product contains or emits chemicals known to the state of California to cause cancer, birth defects, and other reproductive harm.

## A Note to All Users

No list of warnings and cautions can be all-inclusive. If situations occur that are not covered by this manual, the operator must apply common sense and operate this DR PTO Post Hole Digger in a safe manner. Contact us at [www.DRpower.com](http://www.DRpower.com) or call 1-800-DR-OWNER (376-9637) for assistance.

## Chapter 2: Setting Up The DR PTO Post Hole Digger

It may be helpful to familiarize yourself with the controls and features of your DR PTO Post Hole Digger as shown in **Figure 2** before beginning these procedures. If you have any questions at all, please feel free to contact us at [www.DRpower.com](http://www.DRpower.com).

### DR PTO Post Hole Digger Features and Specifications

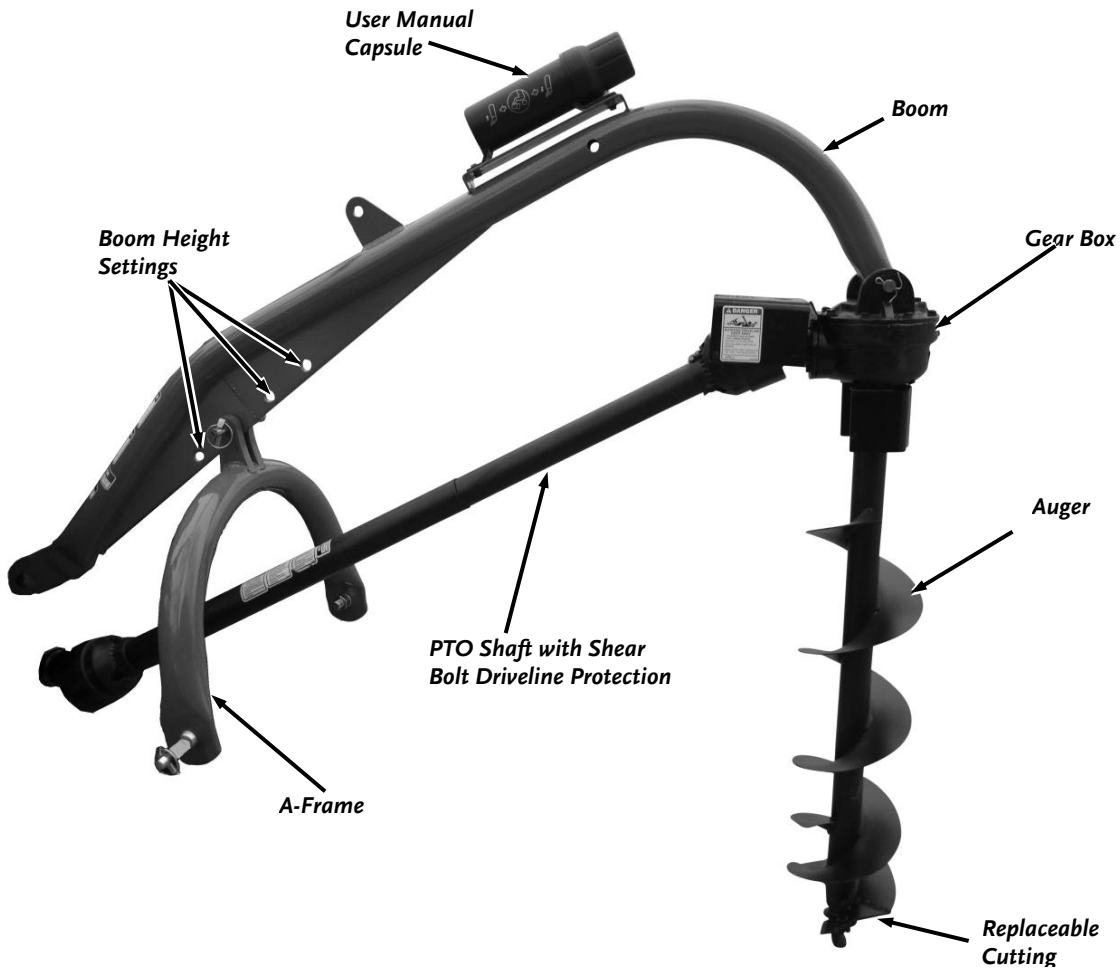

Figure 1

Tractor Requirements	3-Point Hitch, Category 1, and Category 2
PTO Speed	540 RPM
PTO Shaft Interface	6 Spline Quick Release Tractor Yoke
Auger Drive	Tractor PTO
Driveline Protection	Shear Bolt, 5/16" Grade 5
Digging Diameter	Compatible with 6", 9", and 12" Augers (Sold Separately)
Digging Depth	Up to 40"
Number of Cutting Edges	2
Gearbox Ratio	3:1
Gearbox Oil	1.E. S.A.E. 80w/90 or S.A.E. 85w/140 Multi-purpose gear oil
A-Frame	2-7/8" High Strength Tubing
Boom	2-7/8" High Strength Tubing

## Assembling the DR PTO Post Hole Digger

### Parts Supplied - (Figure 2 and list below):

Item #	Part #	Description	Qty
1	10000032000	.. Shaft, PTO, Post Hole Digger.....	1
2	10000031967	.. A-Frame.....	1
3	10000031946	.. Boom, Post Hole Digger.....	1
4	N/A	..... Auger (Shipped Separately) .....	1
5	N/A	..... Gearbox Assembly, Post Hole Digger .....	1
6	10000031899	.. Capsule, Manual .....	1

### Hardware Supplied in Hardware Bag #1 - (Figure 3 and list below):

Item #	Part #	Description	Qty
7	10000031948	.... Pin, Linch.....	3
8	10000031866	.... Pin, Bottom Link, PTO Class 1 .....	2
9	323791	..... Washer, Lock, 7/8.....	2
10	10000032014	.... Nut, Hex, 7/8-14.....	2
11	10000031947	.... Pin, A Frame.....	1

### Hardware Supplied in Hardware Bag #2 - (Figure 4 and list below):

Item #	Part #	Description	Qty
12	354711	..... Bolt, 1/2"-13 X 3".....	2
13	111411	..... Bolt, 5/16"-18 X 3", Grade 5.....	1
14	111581	..... Bolt, 5/16"-18 X 1".....	3
15	112411	..... Washer, Flat, 5/16".....	3
16	110761	..... Nut, Nylon Lock, 5/16"-18 .....	1
17	112421	..... Washer, Lock, 1/2" .....	2
18	229101	..... Nut, 1/2"-13" .....	2
19	351841	..... Screw, Set, 1/4"-20 X 3/8" .....	1

Compare the contents of the Shipping Crate with the "Parts Supplied" list above. If you have any questions please contact us at [www.DRpower.com](http://www.DRpower.com) or call 1-800-DR-OWNER (376-9637) for assistance.

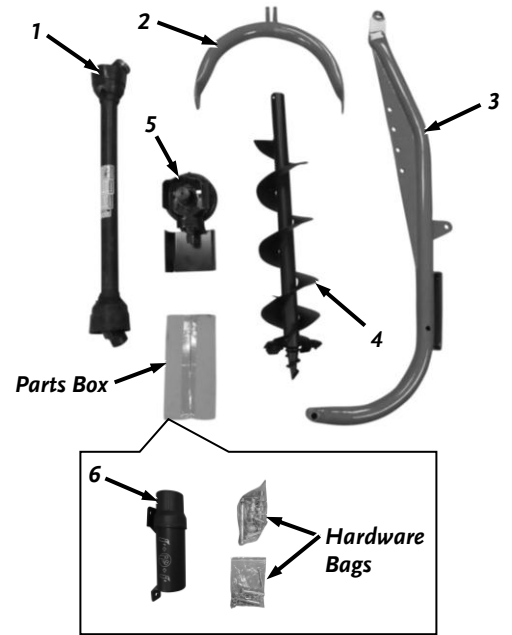

Figure 2

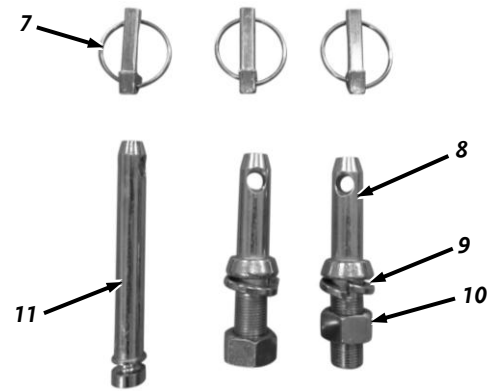

Figure 3: Hardware Bag #1

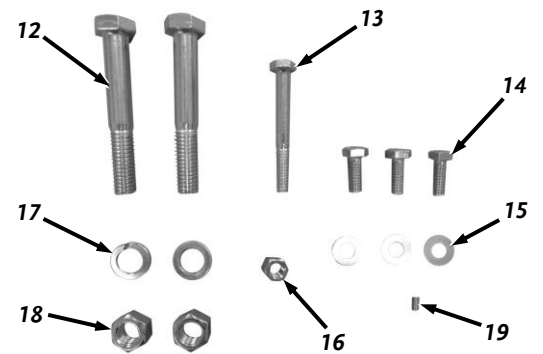

Figure 4: Hardware Bag #2

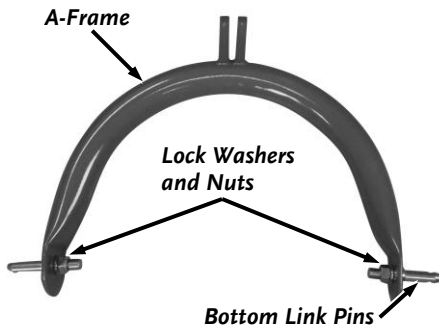

Figure 5

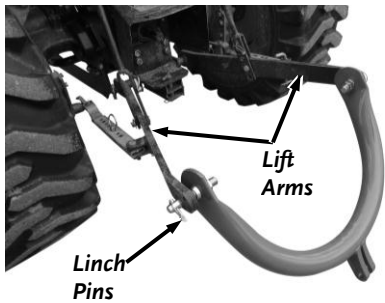

Figure 6

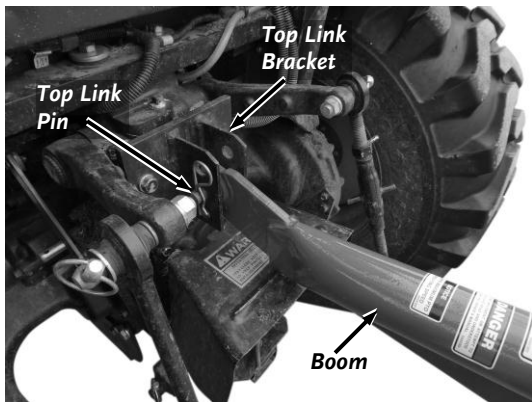

Figure 7

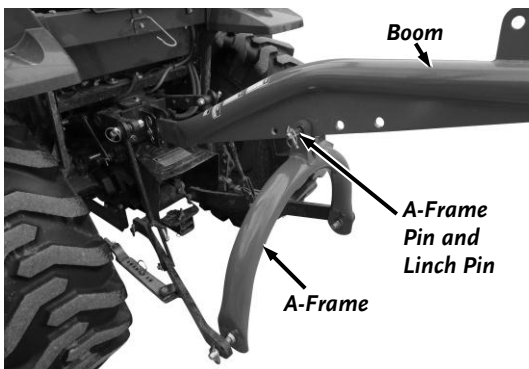

Figure 8

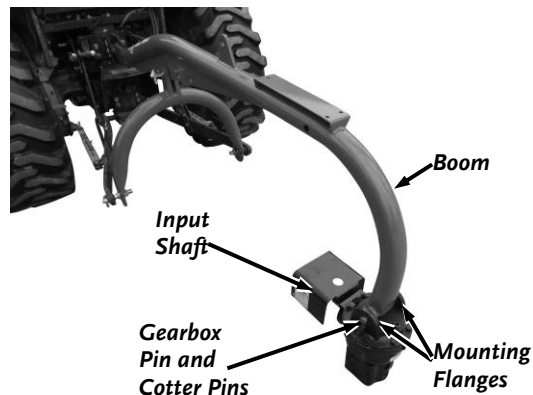

Figure 9

### Tool and Supplies Needed:

- Pliers
- 3/4" Socket with Extension
- 3/4" Wrench
- 1/2" Socket with Extension
- 1/2" Wrench
- Large Adjustable Wrench
- Screwdriver
- 1/8" Allen Wrench
- General Purpose Grease

1. Loosely install the Bottom Link Pins to the A-Frame using the, 7/8" Lock Washers, and 7/8-14 Nuts (**Figure 5**). Use a Screwdriver in the Hole of the Bottom Link Pin to hold it in place while you tighten the Nut using a Large Adjustable Wrench.
2. Attach the A-Frame to the Tractor Lift Arms and secure it using two Linch Pins (**Figure 6**).

**Note:** The Spherical end of the Boom has two hole options, one (smaller) for Category One Tractors and another (larger) for Category Two Tractors. Use the hole option that fits your tractor.

3. Remove the Top Link from the Top Link Bracket on your tractor. Position the End of the Boom into the Top Link Bracket and secure it using your Tractors Top Link Pin (**Figure 7**).
4. Rotate the A-Frame up and secure it to the Boom using the A-Frame Pin and Linch Pin (**Figure 8**). The Hole on the Boom which the A-Frame is secured to will depend on your tractors geometry and the Height Setting desired. It may be changed later if needed.
5. Position the Gearbox on the Ground beneath the Boom with the Input Shaft facing the Tractor (**Figure 9**). Lower the Lift Arms so that the end of the Boom aligns with the Mounting Flanges on the Gearbox.
6. Secure the Gearbox to the Boom using the Gearbox Pin and two Cotter Pins. Use Pliers to bend the Cotter Pins.



7. Raise the Boom by raising the Lift Arms on your Tractor. Position the Auger onto the Output Shaft of the Gearbox (**Figure 10**).
8. Align the bolt holes in the Auger with the bolt holes on the Output Shaft and install the two 1/2"-13 X 3" Bolts, Lock Washers and Nuts. Tighten the Hardware using a 3/4" Socket with extension through the Access Holes on the Output Shaft Guard and a 3/4" Wrench.
9. Position the PTO Shaft onto the Input Shaft of the Gearbox (**Figure 11**). Align the Bolt Holes and install the 5/16"-18 X 3" Shear Bolt and Locknut. Tighten the Hardware using a 1/2" Socket with extension through the Access Hole on the Input Shaft Guard and a 1/2" Wrench.
10. Install the 1/4-20 Set Screw into the threaded hole on the PTO Shaft using a 1/8" Allen Wrench. Screw the Set Screw all the way in then loosen it one full turn.
11. Attach the other end of the PTO Shaft to the tractor by pulling on the Locking Collar and sliding onto the Tractor PTO.
12. Attach the Manual Capsule to the Top of the Boom with three 5/16-18 X 1" Bolts and Flat Washers (**Figure 12**). Tighten the hardware using a 1/2" Wrench.

### Adding Oil to the Gearbox

#### Tool and Supplies Needed:

- S.A.E. 80W/90 or S.A.E. 85W/140 Multi-purpose Gear Oil
- 10mm Allen Wrench
- 6mm Allen Wrench
- Clean Rags

**Note:** Ensure that the Gearbox is Level when adding oil to ensure an accurate reading.

1. Remove the Oil Fill Plug from the top of the Gearbox using a 10mm Allen Wrench (**Figure 13**).
2. Remove the Overflow Plug from the side of the Gearbox using a 6mm Allen Wrench
3. Slowly add oil to the top of the Gearbox until it starts draining from the overflow hole. Allow a few seconds for the oil to settle to get an accurate reading.
4. Reinstall the Overflow Plug into the side hole.
5. Reinstall the Gearbox Plug into the top of the Gearbox.

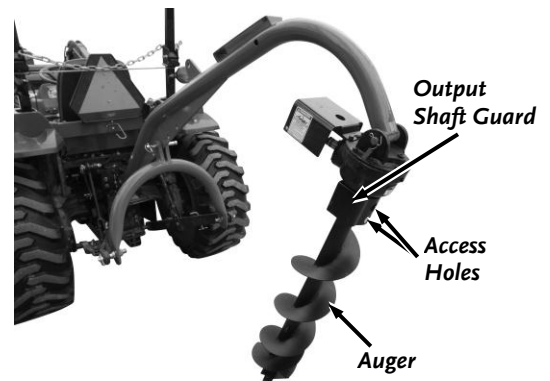

Figure 10

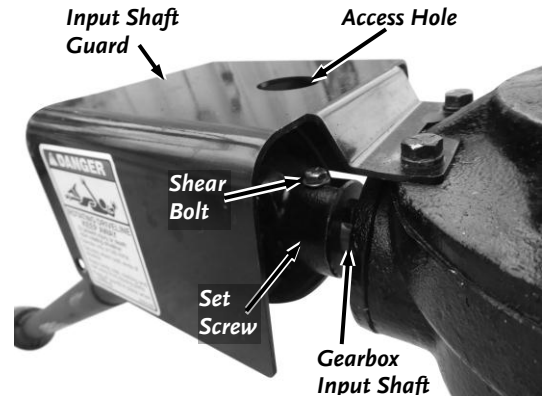

Figure 11

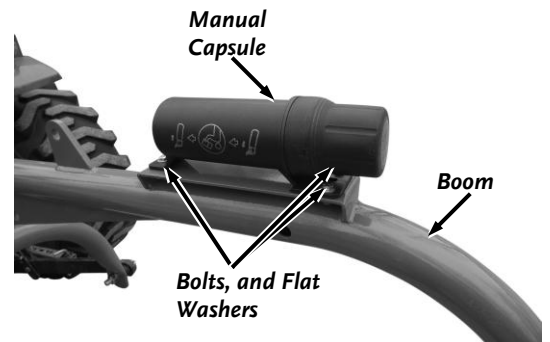

Figure 12

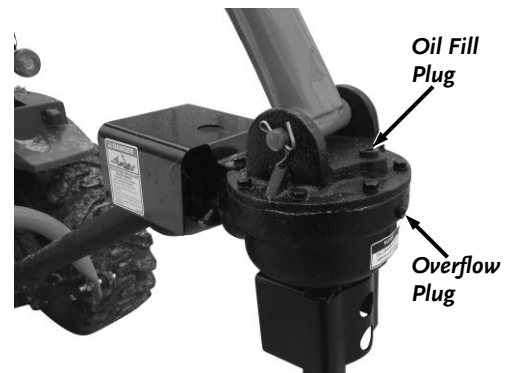

Figure 13

## Chapter 3: Operating The DR PTO Post Hole Digger

---

### **WARNING**

- This machine is designed to operate at 540 rpm PTO Shaft speed only! Never operate at a faster speed; doing so can cause serious injury to the operator or bystanders and could cause damage to the machine that is not covered under warranty.
  - Read and understand your Tractor user's manual and all Tractor safety Warnings for operating your Tractor safely before operating this DR PTO Post Hole Digger.
- 

### **DANGER**

Call 811 before you begin any digging project. A new, federally-mandated national "Call Before You Dig" number, 811 was created to help protect you from unintentionally hitting underground utilities while working on digging projects. Every digging job requires a call. If you hit an underground utility line while digging, you can harm yourself or those around you, disrupt service and potentially be responsible for fines and repair costs.

- There may be buried power, gas, and/or telephone lines in the work area. Electric shock, death, or explosion may occur.
  - Have the property or work area marked for buried lines and do not dig in marked areas.
- 

### **Operation Notes**

- See the Owner's Manual that came with your Tractor for all safety warnings and detailed information for operating your Tractor properly.
- Always operate the Tractor PTO at 540 RPM when Digging.
- Always disengage the PTO, lock the Parking Brake and shut off the Tractor when leaving the Tractor Seat.
- Never transport the Post Hole Digger while the PTO is turning.
- Never operate the Post Hole Digger when the auger point is more than 6 in. above ground level. Operating the digger in elevated positions may cause the PTO driveline "U" joints to bind resulting in equipment damage and operator injury.
- Remove any debris buildup from the Auger before every use of the Post Hole Digger.

### **Operation Steps**

1. Lower the Auger Point slowly to the ground at the desired digging angle.
2. With the tractor throttle set to a slow speed, engage the PTO to begin turning the auger.
3. Slowly increase the throttle speed and lower the lift arms as the Auger begins to dig.
4. When the Auger has reached the desired depth, reduce the throttle speed and raise the lift arms.
5. Disengage the Tractor PTO before transporting to the next digging location.

## Chapter 4: Maintaining The DR PTO Post Hole Digger

Regular maintenance is the way to ensure the best performance and long life of your machine. Please refer to this manual for maintenance procedures.

### **WARNING**

Disengage PTO, shut down the Tractor Engine, remove the Key, wait for all moving parts to come to a complete stop, lower the Auger to the ground, disconnect the PTO shaft from the Tractor, then wait five minutes for parts to cool before performing any maintenance procedure or inspection on the Post Hole Digger.

### **Regular Maintenance Checklist**

**Note:** Consider that the service intervals shown are the maximum under normal operating conditions. Increase frequencies under extremely dirty or dusty conditions. See the Owners Manual that came with the Tractor and with the PTO Shaft for Specific Tractor and PTO Shaft maintenance.

PROCEDURE	BEFORE EACH USE	EVERY 18-20 HOURS	EVERY 50 HOURS
Check General Equipment Condition, e.g. Nuts, Bolts, Welds, etc.	▲		
Clean all Debris from the machine.	▲		
Check the Auger point and Cutting Edges for excessive dullness or damage.	▲		
Replace broken or damaged Auger point and Cutting Edges.	▲		
Lubricate PTO Shaft Spline ends and center overlap		▲	
Check Gearbox Oil			▲

### **Greasing the PTO U-joints**

Your PTO Shaft was greased at the Factory so it will not need grease until the scheduled maintenance as listed at the beginning of this Chapter.

#### **Tools and Supplies needed:**

- Flexible hose grease gun
- Lithium grease
- Clean cloth

**Note:** The U-Joint Grease Fitting is sometimes located on the inside of the Joint. The plastic Collar will need to be unclipped and pushed down to access the Fitting for this type.

1. Wipe all dirt, etc., from the PTO Shaft grease fittings with a clean cloth.
2. Apply no more than three pumps of quality general-purpose lithium grease with a hand-pumped grease gun to each of the two U-Joint Grease Fittings (**Figure 14**).

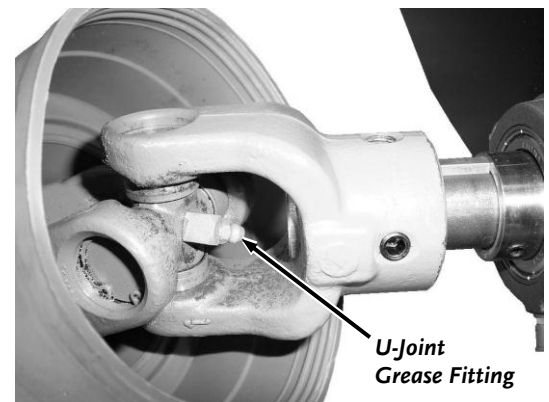

**Figure 14**

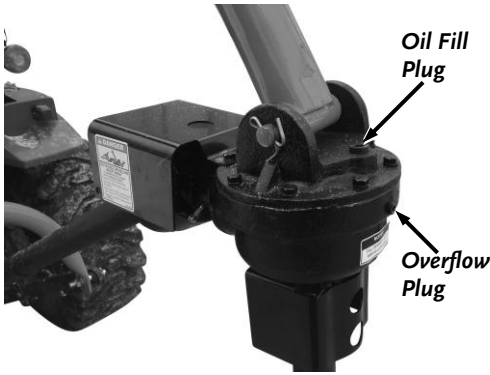

Figure 15

## Adding Oil to the Gearbox

### Tool and Supplies Needed:

- S.A.E. 80W/90 or S.A.E. 85W/140 Multi-purpose Gear Oil
- 10mm Allen Wrench
- 6mm Wrench
- Clean Rags

**Note:** Ensure that the Gearbox is Level when adding oil to ensure an accurate reading.

1. Remove the Oil Fill Plug from the top of the Gearbox using a 10mm Allen Wrench (**Figure 15**).
2. Remove the Overflow Plug from the side of the Gearbox using a 6mm Allen Wrench
3. Slowly add oil to the top of the Gearbox until it starts draining from the overflow hole. Allow a few seconds for the oil to settle to get an accurate reading.
4. Reinstall the Overflow Plug into the side hole.
5. Reinstall the Gearbox Plug into the top of the Gearbox.

## Replacing the Cutting Edges

### Tools and Supplies Needed:

- 9/16 Wrench
- Gloves

1. Clean any Dirt/Debris away from the damaged or Worn Cutting Edges.
2. Remove the two Carriage Bolts and Locknuts that secure each Cutting Edge to the Auger using a 9/16" Wrench (**Figure 16**).

**Note:** 9" and 12" Augers have Inner and Outer Cutting Edges (one of each). 6" Augers have two of the same Cutting Edges. For Best performance, always replace both Cutting Edges at the same time.

3. Position the new Cutting Edge on the underside of the Auger with the Beveled Edge facing up (**Figure 16**). Reinstall the two Carriage Bolts and Locknuts and tighten them using a 9/16" Wrench.
4. Repeat Step 3 for the other Cutting Edge.

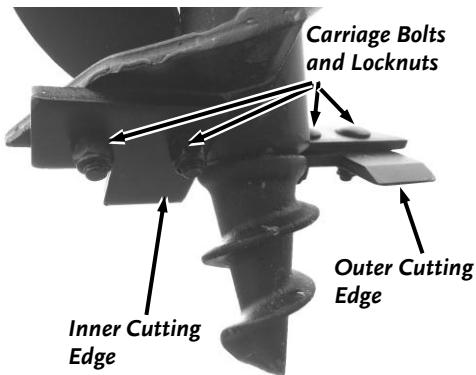

Figure 16

# DR<sup>®</sup> PTO Post Hole Digger



## 2-Year Limited Warranty

### Terms and Conditions

The DR<sup>®</sup> PTO Post Hole Digger is warranted for two (2) years against defects in materials or workmanship when put to ordinary and normal consumer use; ninety (90) days for any other use.

For the purposes of all the above warranties, "ordinary and normal consumer use" refers to non-commercial residential use and does not include misuse, accidents or damage due to inadequate maintenance.

DR Power Equipment certifies that the DR<sup>®</sup> PTO Post Hole Digger is fit for ordinary purposes for which a product of this type is used. DR<sup>®</sup> Power Equipment however, limits the implied warranties of merchantability and fitness in duration to a period of two (2) years in consumer use, ninety (90) days for any other use.

The 2-Year Limited Warranty on the DR<sup>®</sup> PTO Post Hole Digger starts on the date the machine ships from our factory. The 2-Year Limited Warranty is applicable only to the original owner.

The warranty holder is responsible for the performance of the required maintenance as defined by the manufacturer's owner's manuals. The warranty holder is responsible for replacement of normally wearing parts such as the Cutting Edges and PTO shaft. Accessories to the machine are not covered by this warranty.

During the warranty period, the warranty holder is responsible for the machine transportation charges, if required. During the warranty period, warranty parts will be shipped by standard method at no charge to the warranty holder. Expedited shipping of warranty parts is the responsibility of the warranty holder.

SOME STATES DO NOT ALLOW LIMITATIONS ON THE LENGTH OF IMPLIED WARRANTIES, SO THE ABOVE LIMITATIONS MAY NOT APPLY TO YOU.

DR<sup>®</sup> Power Equipment shall not be liable under any circumstances for any **incidental or consequential damages or expenses** of any kind, including, but not limited to, cost of equipment rentals, loss of profit, or cost of hiring services to perform tasks normally performed by the DR<sup>®</sup> PTO Post Hole Digger.

SOME STATES DO NOT ALLOW THE EXCLUSION OR LIMITATION OF INCIDENTAL OR CONSEQUENTIAL DAMAGES, SO THE ABOVE LIMITATIONS MAY NOT APPLY TO YOU.

THIS WARRANTY GIVES YOU SPECIFIC LEGAL RIGHTS, AND YOU ALSO HAVE OTHER RIGHTS, WHICH VARY FROM STATE TO STATE.

## Chapter 6: Parts Lists and Schematic Diagrams

### Parts List— Post Hole Digger Assembly

*Note: Part numbers listed are available through DR Power Equipment.*

Ref#	Part#	Description	Ref#	Part#	Description
1	10000031946	Boom, Post Hole Digger	18	112421	Washer, Lock, 1/2"
2	10000031899	Manual Capsule	19	229101	Nut, Hex, 1/2-13
3	111581	Bolt, 5/16-18 X 1"	20	10000031866	Pin, Bottom Link, Post Hole Digger
4	112411	Washer, Flat, 5/16"	21	323791	Washer, Lock, 7/8
5	10000031980	Guard, Gearbox, Input	22	10000032014	Nut, Hex, 7/8-14
6	150431	Bolt, 3/8-16 X 1-1/4"	23	10000031948	Pin, Linch
7	222531	Washer, Lock, 3/8	24	10000032000	Shaft, PTO, Post Hole Digger
8	10000031947	Pin, A-Frame	25	111411	Bolt, Shear, 5/16-18 X 3". Grade 5
9	10000031948	Pin, Linch	26	110761	Locknut, 5/16-18
10	10000031955	Gearbox, Post Hole Digger	27	351841	Screw, Set, 1/4-20 X 3/8"
11	10000031949	Pin, Gearbox	28	10000031973	Cutting Edge, 6" Auger
12	186551	Pin, Cotter, 3/16" x 2"		10000031956	Cutting Edge, Inner, 9" Auger
13	10000031991	Guard, Gearbox, Output		10000031957	Cutting Edge, Inner, 12" Auger
14	111521	Bolt, 3/8-16 X 1"	29	10000031973	Cutting Edge, 6" Auger
15	222531	Washer, Lock, 3/8		10000032018	Cutting Edge, Outer, 9" Auger
16	416521	Auger, 6", Post Hole Digger		10000031985	Cutting Edge, Outer, 12" Auger
	416531	Auger, 9", Post Hole Digger	30	384821	Bolt, Carriage, 3/8-16 X 1-1/4"
	416541	Auger, 12", Post Hole Digger	31	110751	Locknut, 3/8-16
17	354711	Bolt, 1/2-13 X 3"	32	10000031958	Tip, Auger
			33	10000031967	A-Frame

**Schematic – Post Hole Digger Assembly**

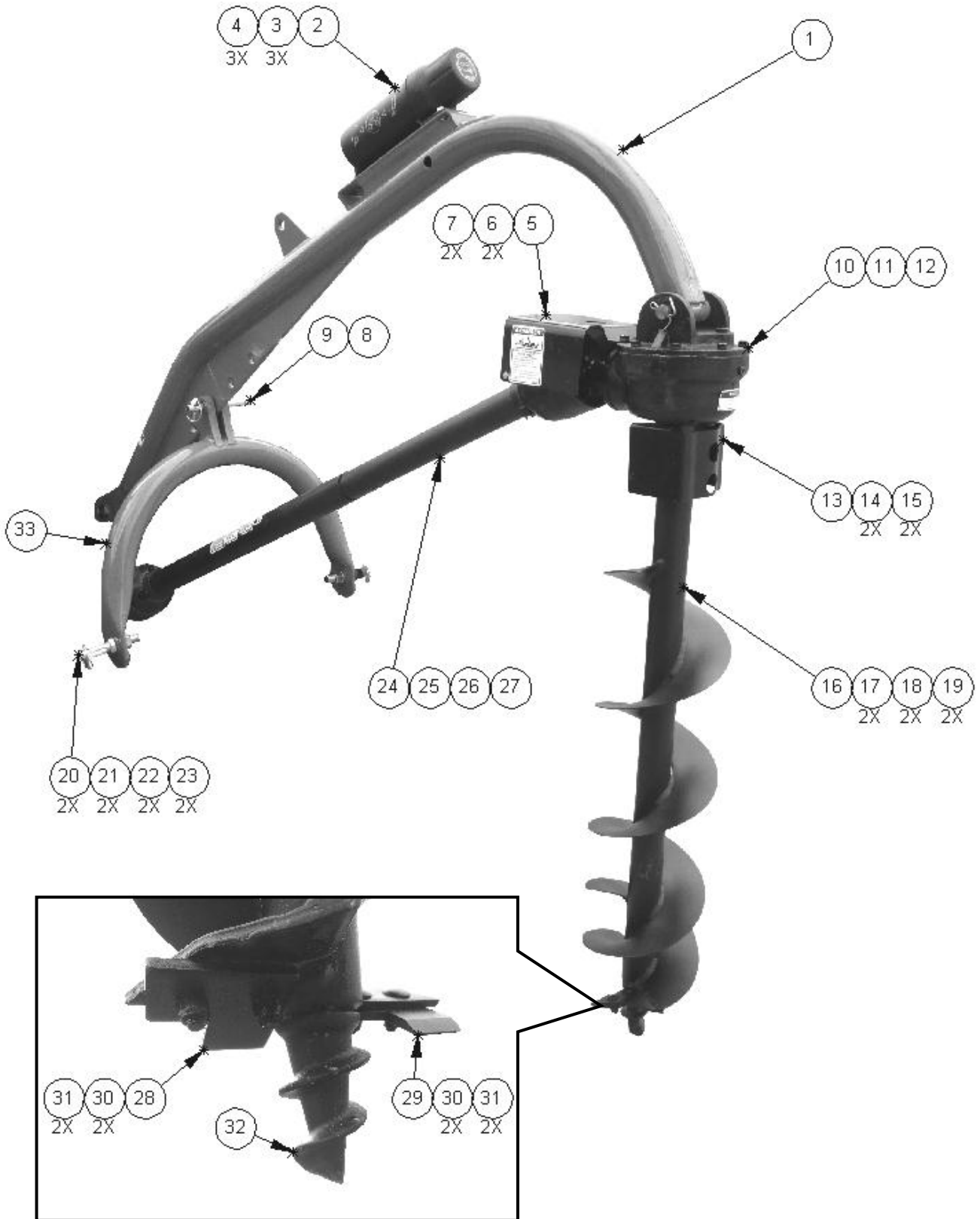

## Daily Checklist for the DR PTO Post Hole Digger

To help maintain your DR PTO Post Hole Digger for optimum performance, we recommend you follow this checklist each time you use your machine.

---

### WARNING

Disengage PTO, shut down the Tractor Engine, remove the Key, wait for all moving parts to come to a complete stop, lower the Auger to the ground, disconnect the PTO shaft from the Tractor, then wait five minutes for parts to cool before performing any maintenance procedure or inspection on the Post Hole Digger.

---

[ ] CUTTING EDGES: Replace damaged or overly worn Cutting Edges.

[ ] GENERAL CONDITION: Check the general condition of the machine, e.g.; nuts, bolts, welds etc.

## End of Season and Storage

---

### WARNING

Disengage PTO, shut down the Tractor Engine, remove the Key, wait for all moving parts to come to a complete stop, lower the Auger to the ground, disconnect the PTO shaft from the Tractor, then wait five minutes for parts to cool before performing any maintenance procedure or inspection on the Post Hole Digger.

---

- Lubricate PTO Shaft Grease Fittings.
- Check the Cutting Edges for Damage or Wear. Replace as needed.
- Check the general condition of the machine, e.g.; nuts, bolts, welds, etc. Replace parts or tighten Hardware as needed.
- Store in a dry covered area to protect from moisture.
- Remove any stones, dirt, wrapped grass or weeds from the Auger.



---

75 MEIGS ROAD, P.O. BOX 25, VERGENNES, VERMONT 05491