

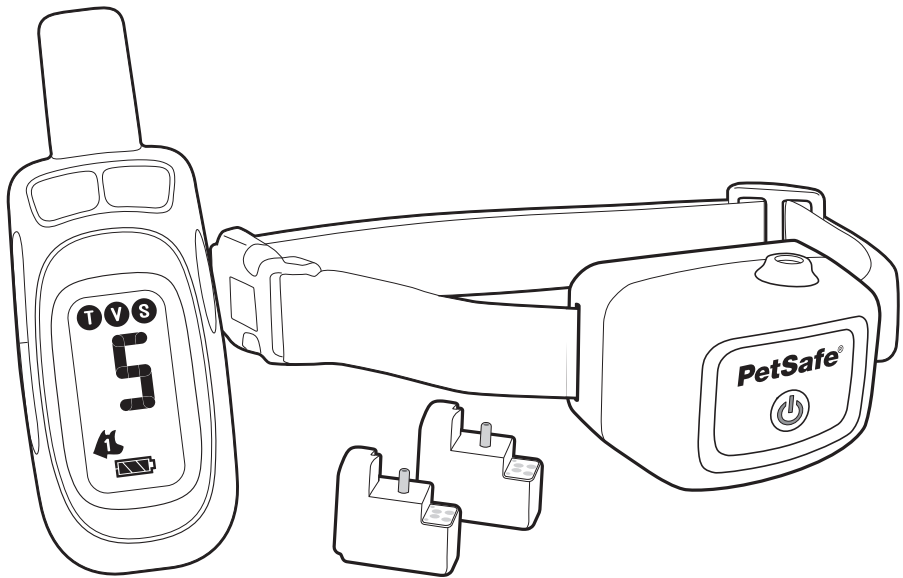

Product Manual

PDT00-16395

Remote Spray Trainer



Please read this entire Product Manual before beginning.

Welcome

You and your pet were made for each other. Our aim is to help you have the best companionship and the most memorable moments together. Your PetSafe® Remote Spray Trainer is designed to give your pet more freedom while keeping him safe.

We know that safe pets make happy owners. Before getting started, please take a moment to read through the important safety information. If you have any questions, please don't hesitate to contact us.

Hereinafter Radio Systems Corporation and any other affiliate or Brand of Radio Systems Corporation may be referred to collectively as "We" or "Us".

IMPORTANT SAFETY INFORMATION

Explanation of Attention Words and Symbols used in this Product Manual



This is the safety alert symbol. It is used to alert you to potential personal injury hazards. Obey all safety messages that follow this symbol to avoid possible injury or death.

⚠ WARNING

WARNING indicates a hazardous situation which, if not avoided, could result in death or serious injury.

⚠ CAUTION

CAUTION, used with the safety alert symbol, indicates a hazardous situation which, if not avoided, could result in minor or moderate injury.

CAUTION

CAUTION, used without the safety alert symbol, indicates a hazardous situation which, if not avoided, could result in harm to your pet.

⚠ WARNING

Not for use with aggressive dogs. Do not use this product if your dog is aggressive, or if your dog is prone to aggressive behavior. Aggressive dogs can cause severe injury and even death to their owner and others. If you are unsure whether this product is appropriate for your dog, please consult your veterinarian or certified trainer.

Do not puncture or incinerate the collar or the refill cartridge. Do not expose to extreme heat or store at temperatures above 113 °F or 45 °C.

Lithium Rechargeable Batteries This device contains Lithium-Ion (Li-Ion) batteries; never incinerate, puncture, deform, short-circuit, or charge with an inappropriate charger. Fire, explosion, property damage, or bodily harm may occur if this warning is not followed.

Do not expose the device to freezing temperatures (32 °F or 0 °C) or to conditions warmer than 113 °F or 45 °C. Do not leave the collar in direct sunlight. Never leave the collar in a car where the device can heat up to high temperatures (113 °F or 45 °C).

- Contains gas under pressure; may explode if heated.
- Wear protective gloves/ eye protection/ face protection.
- Do not breathe dust/ fume/ gas/ mist/ vapors/ spray.
- In case of inadequate ventilation, wear respiratory protection.
- If exposed or concerned: Get medical advice/attention.
- Protect from sunlight. Store in a well-ventilated place. Do not puncture. Do not burn.
- Keep out of reach of children.

FIRST AID TREATMENT:

If inhaled, get medical attention if you feel unwell. After skin contact, rinse affected area with soap and water. After eye contact, rinse/flush eyes gently using water for 15-20 minutes.

⚠ CAUTION

This product is not a toy. Keep it away from the reach of children.

CAUTION

Risk of skin damage. Please read and follow the instructions in this manual. Proper fit of the collar is important. A collar worn for too long or made too tight on the pet's neck may cause skin damage. Ranging from redness to pressure ulcers; this condition is commonly known as bed sores.

- Avoid leaving the collar on the dog for more than 12 hours per day.
- When possible, reposition the collar on the pet's neck every 1 to 2 hours.
- Check the fit to prevent excessive pressure; follow the instructions in this manual.
- Never connect a leash to the electronic collar.
- When using a separate collar for a leash, don't put pressure on the electronic collar.
- Wash the dog's neck area and the contact area of the collar weekly with a damp cloth.
- Examine the contact area daily for signs of a rash or a sore.
- If a rash or sore is found, discontinue use of the collar until the skin has healed.
- If the condition persists beyond 48 hours, see your veterinarian.
- For additional information on bed sores and pressure necrosis, please visit our website.

The PetSafe® Remote Spray Trainer must be used only on healthy dogs. We recommend that you take your dog to a veterinarian before using the collar if he is not in good health.

What's Covered

In the Box.....	4
How it Works.....	5
Charge the Training Collar.....	5
Function and Response.....	6
Charge the Remote.....	6
Using Tone, Vibration and Spray.....	7
Add the Spray Refill Cartridge.....	7
Fit the Collar.....	8
Re-pairing the Collar or Pairing a Second Collar.....	9
Ensure a Proper Spray Pattern.....	9
Find the Best Stimulation for Your Pet.....	9
Training Tips.....	9
Frequently Asked Questions.....	10
Customer Care.....	10
Terms of Use and Limitation of Liability.....	11
Warranty.....	11
Important Recycling Advice.....	11
Compliance.....	12

In the Box

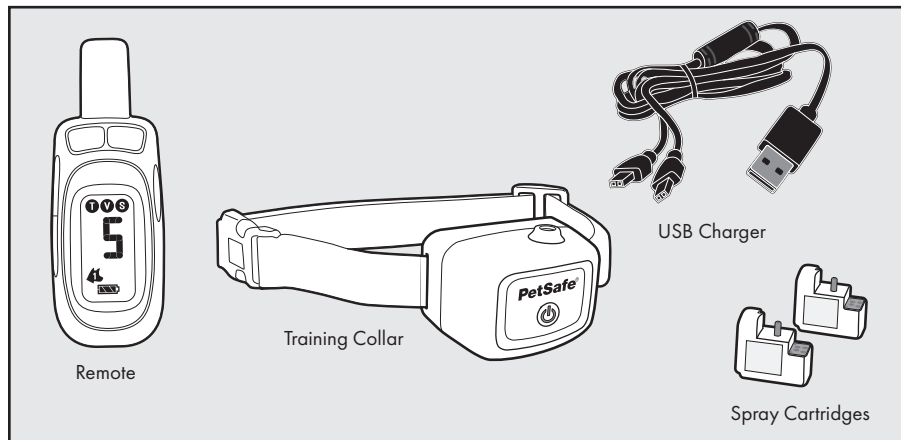

How it Works

The PetSafe® Remote Spray Trainer can easily help improve the communication between you and your dog. At the push of a button the remote sends a signal to your dog's collar. With three training options - tone, vibration and spray stimulation - you can ensure you will have a well-trained dog in a short amount of time.

The trainer can be used for off-leash walks within a range of up to 300 yards. The remote includes an easy-to-read digital display, and the training collar is lightweight, rechargeable and water-resistant.

The collar uses replaceable and recyclable spray refill cartridges that provide approximately 35 sprays per use. They are safe and easy to use. One Citronella and one Unscented refill are included. For more information, go to www.petsafe.com.

Charge the Training Collar

Excessive charging can shorten battery life. Only charge your remote or collar when the batteries are low.

1. Lift the rubber cover protecting the remote training collar charging jack.
2. Connect the charger to the charging jack **(1A)**.
3. Plug the charger into a USB port or if you have an adaptor, plug into a standard wall outlet.
4. When fully charged, the green LED on the collar will turn off.
5. When the collar is fully charged, replace the rubber cover.

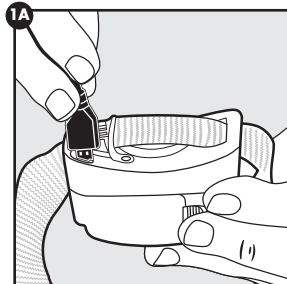

To Turn the Training Collar On

Press and hold the on/off button until the collar beeps low to high, and then release **(1B)**. The green LED will be illuminated during the button press.

To Turn the Training Collar Off

Press and hold the on/off button until the collar beeps high to low, and then release. The red LED will be illuminated during the button press and will turn off when the collar turns off.

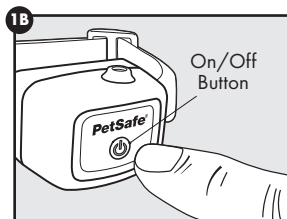

Battery Life

Average battery life is 40 hours, depending on use. However, due to greater use during your dog's training, the first week may not last as long.

Quick Tip: When you're not using the collar, you'll want to turn it off to increase the battery life. When storing for long periods, recharge every 4 to 6 weeks.

Function and Response

Function	LED Light Response	Beep Response
Spray collar is turned on	Green LED illuminates	Beeps low to high
Spray collar is turned off	Red LED illuminates	Beeps high to low
Collar is on	Green LED light flashes once every 5 seconds	None
Spray activation	None	None
Low battery condition	Red LED light flashes 3 times every 5 seconds	None
Low spray warning	Yellow LED flashes once every 5 seconds and the battery is good Yellow LED flashes 3 times every 5 seconds and the battery is low	None
No refill cartridge	Red and green LED's alternate flashing for 5 seconds, and the collar will turn off	4 beeps
Spray collar is on/ Cartridge is empty (will not spray)	Yellow LED flashes once every 5 seconds and the battery is good Yellow LED flashes 3 times every 5 seconds and the battery is low	None
Turning collar on/ Cartridge is empty (will not spray)	Yellow LED flashes 2 times	2 beeps

Charge the Remote

1. Lift the rubber cover protecting the remote charging jack on the back of the remote.
2. Connect the charger to the charging jack (2A).
3. Plug the charger into a USB port or if you have an adaptor, plug it into a standard wall outlet.
4. The battery indicator will display when fully charged.
5. When the remote is fully charged, replace the rubber cover.

NOTE: The remote is always on, and the display will appear when any button is pressed (2B).



Tone Symbol: Delivers a tone with non-adjustable volume to the collar.



Vibration Symbol: Sends 1 non-adjustable level of vibration stimulation to the collar.



Spray Symbol: Delivers 1 level of spray stimulation.



Dog 1/2: Indicates which training collar is active.



Battery Indicator: Indicates the amount of battery remaining in the remote.

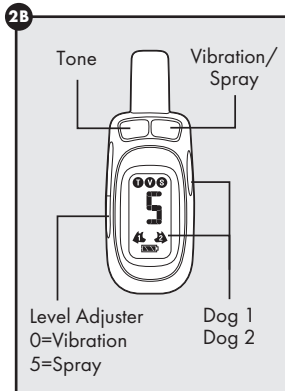
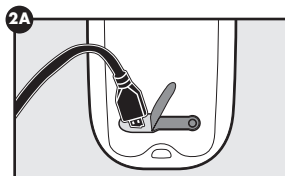

Using Tone, Vibration and Spray

To deliver a tone, press the top left button. The tone symbol will appear. Tone can be used at any time in combination with either vibration or spray.

To deliver a vibration, press the side level adjuster down to 0 then the press the top right button. The vibration symbol will appear.

To deliver a spray stimulation, press the side level adjuster up to S then press the top right button. The spray symbol will appear.

Add the Spray Refill Cartridge

1. Ensure the collar is off.
2. The refill cartridge is located on the bottom of the collar.
3. Press and slide the button and the refill cartridge door will open (3A).
4. Ensure the shipping cap is removed off the refill cartridge before inserting into the collar (3B).
5. Close the cartridge door (3C).

⚠ WARNING

Do not expose the device to freezing temperatures (32 °F or 0 °C) or to conditions warmer than 113 °F or 45 °C. Do not leave the unit in direct sunlight. Never leave the unit in a car where the device can heat up to high temperatures (113 °F or 45 °C).

NOTE: Citronella (PAC17-16371) and Unscented (PAC00-16646) refill cartridges can be purchased from www.petsafe.com.

⚠ CAUTION

CONTENTS UNDER PRESSURE. CONTAINER MAY EXPLODE IF HEATED. Do not expose to heat or store at temperatures above 120 °F or 49 °C. Do not puncture. Do not burn. Protect from sunlight. Store away from heat. Store in a well-ventilated place. This product is not a toy. Keep it away from the reach of children.

FIRST AID TREATMENT: If inhaled, get medical attention if you feel unwell. After skin contact, rinse affected area with soap and water. After eye contact, rinse/flush eyes gently using water for 15-20 minutes.

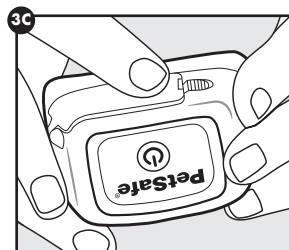
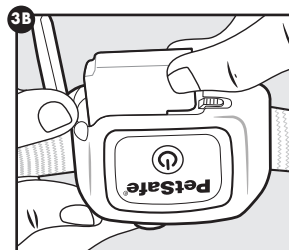
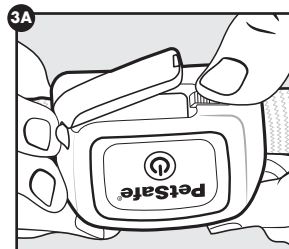

Fit the Collar

Important: The proper fit and placement of the training collar is important for effective operation. The collar should have direct contact with your dog's skin on the underside of his neck.

1. Be sure the collar is turned off before placing it on your pet. Then with your pet standing (4A), fit the collar snugly onto your pet's neck so that the collar makes contact with your pet's skin on the underside of his neck. Make sure the PetSafe® logo is right-side up (4B).
2. Check the tightness of the collar by inserting one finger between the collar and your pet's neck (4C). The fit should be snug but not constricting.
3. Allow your pet to wear the collar for a few minutes, then check it again.

CAUTION

You may need to trim the hair in the area of the collar. Never shave your pet's neck; this may lead to a rash or infection.

4. Once you are satisfied with the fit of the collar, remove it from your pet and trim it, but make sure to allow room for growth or a thicker winter coat. Use a lighter to seal the cut so that it will not fray.
5. The collar will slip if it is not properly threaded onto the strap. The slide buckle prevents the collar from becoming loose around your pet's neck; the ridges must be facing up (4D).

CAUTION

The collar should not be worn for more than 12 hours out of every 24-hour period. Leaving the collar on too long could lead to skin irritation.

NOTE: The collar is water resistant. It should not be submerged. Please remove the collar from the dog before bathing, swimming or any other activities that the collar could be submerged under water.

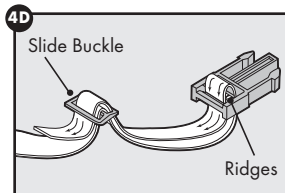
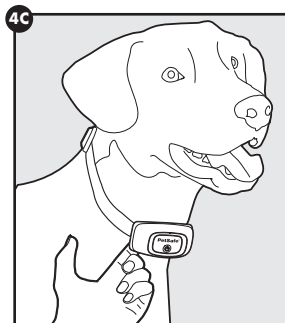
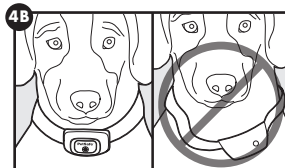
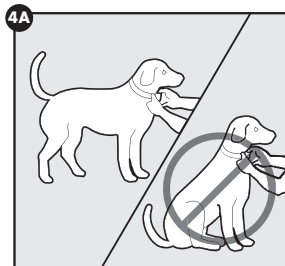

Re-pairing the Collar or Pairing a Second Collar

If your training collar does not respond when a button is pressed, or if you get a second collar, follow these steps:

1. Use the Dog 1/2 button on the remote to select either Dog 1 or Dog 2. With the remote turned on and the collar turned off, press and hold the on/off button on the collar.
2. After about 5 seconds the LED on the collar will turn off indicating that it is ready for pairing. Press either of the top 2 stimulation buttons. The green LED will blink 5 times to indicate successful pairing.

NOTE: If you wish to add another training collar to the system, the Add-A-Dog® collar is available from www.petsafe.com or through our Customer Care Center: PAC00-16736.

Ensure a Proper Spray Pattern

For the PetSafe® Remote Spray Trainer collar to perform properly, the nozzle must be positioned correctly and there must be a clear path from the spray nozzle to your dog's snout. Follow these steps:

1. Make sure the PetSafe® logo on the front of the collar is upright and the spray nozzle is angled out and pointing up towards the dog's snout (**5A**).
2. For long-haired dogs, it may be necessary to trim the neck hairs along the path of the spray. It is important that the spray reaches the dog's snout to be effective.

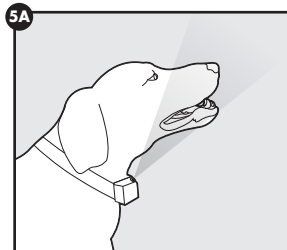

CAUTION

Do not shave the pet's neck as this may increase the risk of skin irritation.

Find the Best Stimulation for Your Pet

The PetSafe® Remote Spray Trainer has 1 tone, 1 vibration, and 1 level of spray stimulation. This allows you to choose the stimulation that is best for your pet. We recommend training with tone and vibration before moving to spray. Please visit www.petsafe.com for additional training information and videos.

Be Consistent and Responsible: Use the Remote Trainer every time your dog misbehaves. Only let responsible family members use the Remote Trainer. It is not a toy.

Training Tips

If you're attempting to teach your dog a behavior, make sure your dog understands what you want before introducing spray stimulation. You can do this using your dog's favorite treats. If your dog looks nervous, scared or confused after spray stimulation, pause using spray stimulation and revisit treat training to ensure your dog understands the cue.

When Training Begins: Only begin using the training collar on dogs that are at least 6 months and that weigh at least 8 lb. You can begin basic obedience training without the training collar as soon as you bring your puppy home.

Collar Conditioning: You don't want your dog to only associate wearing the training collar with being corrected. While your dog is wearing the collar, make sure to spend ample time playing and letting your dog be a dog to help create some positive associations with the collar.

Timing: For spray training to work properly, timing is very important. You should use the tone, vibration or spray stimulation immediately (within 2 seconds) of an undesirable behavior. This will help your dog make the association between the undesirable behavior and the stimulation that works best for you and your dog.

Eliminate one misbehavior or teach one obedience command at a time. If you move too fast with training, your pet may become confused.

- Be consistent. Give your pet a tone, vibration or spray stimulation with each misbehavior.
- Do not over-correct your pet. Use as few sprays as possible to train your pet.
- Unless you can supervise him, it is recommended that you restrict your pet from situations in which he has a history of misbehaving. However, recreating a problem situation as a training session can dramatically improve your chances of success.
- If your pet reacts to the tone by hiding or acting fearful, redirect his attention to a simple and appropriate behavior, such as the “sit” command.
- Only let responsible family members use the trainer. It is not a toy.
- Other pets in hearing range will be affected by the training tone. Therefore, training sessions should be conducted out of hearing range of other pets.

⚠ WARNING

Never use the training collar to correct or eliminate any form of aggressive behavior. If you are unsure if your dog is aggressive, please consult your veterinarian or a certified trainer.

FREQUENTLY ASKED QUESTIONS

How old does a pet have to be before using the Remote Spray Trainer?	Your pet should be able to learn basic obedience commands such as “Sit” or “Stay” and be at least 6 months old before using the trainer. The training collar may be too large for dogs under 8 lbs.
Once my pet is trained and has been obeying my commands, will he have to continue to wear the training collar?	Probably not. He may need to wear the training collar from time to time for reinforcement.
Does the spray need to hit my dog’s nose?	No. The spray is very fine and simply creates a mist in the region of the snout.

Customer Care

USA & Canada - Tel: +1 (800) 732-2677

Monday - Friday 8 AM - 8 PM / Saturday 9 AM – 5 PM (EST)

Terms of Use and Limitation of Liability

1. **Terms of Use**

The use of this product is subject to your acceptance without modification of the terms, conditions and notices contained with this product. Use of this product implies acceptance of all such terms, conditions, and notices. If you do not wish to accept these terms, conditions, and notices, please return the product, unused, in its original packaging and at your own cost and risk to the relevant Customer Care location together with proof of purchase for a full refund.

2. **Proper Use**

Proper Use includes, without limitation, reviewing the entire Product Manual and any specific safety information statements. The specific temperament or size/weight of your pet may not be suitable for this product. If you are unsure whether this product is appropriate for your pet, please consult your veterinarian or certified trainer prior to use. For products used with pets where training is desired, Radio Systems Corporation recommends that these training products are not used if your pet is aggressive and accepts no liability for determining suitability in individual cases.

3. **No Unlawful or Prohibited Use**

This product is designed for use with pets only. This product is not intended to harm, injure or provoke. Using this product in a way that is not intended could result in violation of Federal, State or local laws.

4. **Limitation of Liability**

In no event shall Radio Systems Corporation or any of its associated companies be liable for (i) any direct, indirect, punitive, incidental, special or consequential damage and/or (ii) any loss or damages whatsoever arising out of or connected with the use or misuse of this product. The Purchaser assumes all risks and liability from the use of this product to the fullest extent permissible by law.

5. **Modification of Terms and Conditions**

Radio Systems Corporation reserves the right to change the terms, conditions and notices governing this product from time to time. If such changes have been notified to you prior to your use of this product, they shall be binding on you as if incorporated herein.

Warranty

One Year Non-Transferable Limited Warranty

This product has the benefit of a limited manufacturer's warranty. Complete details of the warranty applicable to this product and its terms can be found at www.petsafe.com.



Important Recycling Advice

Please respect the Waste Electrical and Electronic Equipment regulations in your country. This equipment must be recycled. At the end of the product life, do not place it in the normal municipal waste system. Please check the regulations in your area or return it to where it was purchased so that it can be placed in our recycling system. If these options are not possible, please contact the Customer Care Center for further information.

Compliance

FCC

This device complies with part 15 of the FCC Rules. Operation is subject to the following two conditions: (1) This device may not cause harmful interference, and (2) this device must accept any interference received, including interference that may cause undesired operation.

CAUTION: Modification or changes to this equipment not expressly approved by Radio Systems Corporation may void the user's authority to operate the equipment.

NOTE: This equipment has been tested and found to comply with the limits for a Class B digital device, pursuant to part 15 of the FCC Rules. These limits are designed to provide reasonable protection against harmful interference in a residential installation. This equipment generates, uses, and can radiate radio frequency energy and, if not installed and used in accordance with the instructions, may cause harmful interference to radio communications. However, there is no guarantee that interference will not occur in a specific installation. If interference does occur to radio or television reception, which can be determined by turning the equipment off and on, the user is encouraged to try to correct the interference by one or more of the following measures:

- Reorient or relocate the receiving antenna.
- Increase the separation between the equipment and the receiver.
- Connect the equipment to an outlet on a circuit different from that to which the receiver is connected.
- Consult customer care, the dealer, or an experienced radio/TV technician for help.

Radio Systems Corporation
10427 PetSafe Way
Knoxville, TN 37932
+1 (800) 732-2677
petsafe.com
J400-2189/1

©2018 Radio Systems Corporation