



## Parent and Rider Manual



### DO NOT RETURN TO STORE

This product cannot be returned for a refund after it has been unpacked and used.

**Call us on Toll-Free at  
1-888-411-1786 or Fax us at  
972-584-9110 for assistance  
and information from our  
trained technical staff.**

### CAUTION: THIS IS AN ELECTRONICALLY OPERATED PRODUCT

The charger is an electronically operated product – not a part of the toy.  
This toy is not recommended for children under 3 years of age. As with all electronic products,  
precautions should be observed during handling and use to prevent electric shock.

For assistance with your  
assembly call:  
1-888-411-1786 Toll Free



**Please read this manual before assembly.**



**Honda CRF250R  
6V Ride on Dirt Bike**



**DISTRIBUTED BY:**  
BEST RIDE ON CARS  
1-888-411-1786 Toll Free



## Table of Contents

1. Important Information.....	1
2. Table of Contents.....	2
3. Riding Safety.....	3
4. Product Specifications.....	5
5. Product Assembly.....	6
6. User's Guide.....	7
7. Fused Tube.....	8
8. Troubleshooting.....	9
9. Care and Maintenance.....	9
10. Repairs and Parts.....	10
11. Warranty.....	11
12. Contact Information.....	12

## Important Information

- **ADULT ASSEMBLY REQUIRED.**
- The battery must be charged for 4 hours before first use of toy
- Before starting assembly and charging the battery, refer the battery charging and installation information and instructions on pg. 8 of this manual.
- Use of any other 6 Volt battery or charger may damage the ride-on toy and will void the warranty. Please contact customer service at 1-888-411-1786 for replacement parts\*
- Instruct children on safe operation and riding rules before they take their first ride:
  - Do not allow more than one rider at a time
  - Sit in the proper position on the toy when riding
  - Always wear shoes, helmet & necessary safety gear when riding the toy.
  - Do not allow other children near the toy when riding
  - Do not place your hands, feet, or any part of your body, clothing, or other articles near moving parts while the toy is in operation.
- Instruct children to bring the toy to a complete stop before switching between forward and reverse.
- Do not overload the toy or exceed the maximum weight capacity of 50 lbs. (22.7 kgs) For all questions please contact us at 1-888-411-1786.
- Please read this manual completely for operation and safety information before using the toy. Keep this instructions manual for future reference.

Please read the manual carefully before using our product, which tells you the detailed installation and correct use. Then can avoid damage and injury caused by improper operation. Particularly important is that it tells you a lot about safety precautions. Please memorize these and guide your child with patience. Please place the instructions in easily accessible place for future reference.

**DISTRIBUTED BY:**  
BEST RIDE ON CARS  
1-888-411-1786 Toll Free



# SAFETY Warnings and Caution

## ⚠️ **WARNING: Electrical Hazard**

**RISK OF FIRE.** Do not bypass the fuse. Replace only with the same 12A fuse (on battery pack).

- Please use battery & charger of suggested frequency and stable charging voltage to ensure safety when charging for extended battery life.
- Never modify the electrical system. Changes could cause a fire resulting in serious injury or death, and could also ruin the electrical system.
- Never lift or carry the battery by the wires or connectors. This can damage the battery and possibly cause a fire resulting in serious injury or death. Always use the battery holder to carry it.
- Adults should handle the battery. The battery is heavy and contains sulfuric acid (electrolyte). Always use the attached battery handle for carrying.
- Children should never be allowed to charge the battery. Charging the battery must be done by adults only.
- The electricity involved in charging the battery could injure a child.
- The motors will get hot. Handle carefully.
- Each time you charge the battery, check the battery, charger, and their connectors for excessive wear or damage. Do not use the charger or the battery if damage or excessive wear is detected until you have replaced the worn or damaged parts.
- Carefully read the safety instructions about the battery.

## ⚠️ **WARNING: Riding Hazard**

To reduce the risk of injury, adult supervision is required

- Never use on roadways or near motor vehicles
- Never use on near steep inclines or steps
- Never ride near swimming pools or other bodies of water
- Always wear shoes while riding
- Never allow more than 1 rider at one time
- Max weight of 50lbs. (22.7 kgs)

**NOTE: This toy does not have brakes.**

## ⚠️ **WARNING: Charger**

Changes or modifications to this unit not expressly approved by the party responsible for compliance could void the user's authority to operate the equipment.

**NOTE:** This equipment has been tested and found to comply with the limits for a Class B digital device, pursuant to Part 15 of the FCC Rules. These limits are designed to provide reasonable protection against harmful interference in a residential installation.

This equipment generates, uses, and can radiate radio frequency energy and, if not installed and used in accordance with the instructions, may cause harmful interference to radio communications. However, there is no guarantee that interference will not occur in a particular installation. If this equipment does cause harmful interference to radio or television reception, which can be determined by turning the equipment off and on, the user is encouraged to try to correct the interference by one or more of the following measures:

- Reorient or relocate the receiving antenna.
- Increase the separation between the equipment and receiver.
- Connect the equipment into an outlet on a circuit different from that to which the receiver is connected.
- Consult the dealer or an experienced radio/TV technician for help.

## ⚠️ **CAUTION:**

- When fully unassembled, this package contains small parts. Adult assembly is required.
- Use the charger in dry ventilated areas only.

## ⚠️ **WARNING: ADULT SUPERVISION REQUIRED**

- Always teach safety first.
- While most children can develop the physical skills necessary to operate this toy, it is important to remember that they do not yet have mature judgment skills. Children should never be allowed to ride this toy without adult supervision. Before any child rides this toy an adult must evaluate the child's skill levels and abilities to operate the toy safely. Even after instruction, hazards are not always anticipated or recognized by children. So, before any child operates the toy, teach them appropriate safety rules.
- THERE IS NO SUBSTITUTE FOR DIRECT ADULT SUPERVISION.

## ⚠️ **WARNING: Safe Riding Rules**

Dirt Bike is not suitable for children under 3 years of age due to its speed feature.

To reduce the risk of injury, adult supervision is required.

- Always sit only on the seat of the toy.
- Always wear shoes, helmet & other protective gear.
- No more than one rider at a time.
- Do not ride the toy on loose dirt, sand, or gravel.
- Do not operate near drop-offs, obstructions, swimming pools or other bodies of water.
- Do not operate on roadways, on the street or near moving vehicles.
- Do not operate on or near steep inclines or steps. Use on generally level ground only.
- Do not operate in the dark as unexpected obstacles could cause a crash.
- Do not operate on slopes. The toy may accelerate or roll backwards at unsafe speeds even if the pedalis released.
- Do not place anything near moving parts such as motors, gears, or wheels. Rotating parts can snag hair, fingers, etc. causing serious injury.
- Do not operate near flammable vapors (such as gasoline, paint thinner, acetone, liquid wax, etc.).
- Electrical components can produce an internal spark when first turned on or off. Using the toy near flammable liquids or vapors could cause an explosion or fire resulting in serious injury or death

**DISTRIBUTED BY:**  
BEST RIDE ON CARS  
1-888-411-1786 Toll Free













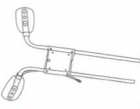

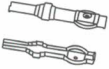

**DISTRIBUTED BY:**  
BEST RIDE ON CARS  
1-888-411-1786 Toll Free

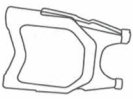

## Product Specifications

Age specifications	Suitable for children from 3 to 6 years	Fuse spec - 12A	Fuse spec. Self-resetting fuse
Loading limitation	50 lbs.	Charging time	3-4 hours
Speed	1.5-2 mph	Power Life	280 times charging
Battery spec	6V,4.5AH	Charging spec	6V 500MA

## Parts list

PART NO	PART NAME	PICTURE	Qty (pcs)	REMARKS	PART NO	PART NAME	PICTURE	Qty (pcs)	REMARKS
1	Handle bar		1		2	Front fender		1	
3	Decorative front fork cover		2		4	Front wheel (no gear attachment)		1	
5	Front axle		1		6	Bushing		2	
7	Front panel		1		8	Body		1	
9	Pedal plate(1)		1		10	Pedal plate(2)		1	
11	Training wheel		2		12	Dashboard		1	
13	Dashboard cover		1		14	Screw M10*140mm		1	

**DISTRIBUTED BY:**  
BEST RIDE ON CARS  
1-888-411-1786 Toll Free



For assistance with your assembly call:  
1-888-411-1786 Toll Free



# Parts diagram

1	Handle bar	6	Bushing	11	Training wheel	16	Screw 4*12mm
2	Front fender	7	Front panel	12	Dashboard	17	Washer 8mm
3	Decorative front fork cover	8	Body	13	Dashboard cover	18	Bolt M5*25mm
4	Front wheel (no gear attachment)	9	Pedal plate(1)	14	Screw(M10*140mm) and nut	19	Screw
5	Front axle	10	Pedal plate(2)	15	Nut 8mm	20	Washer 6mm

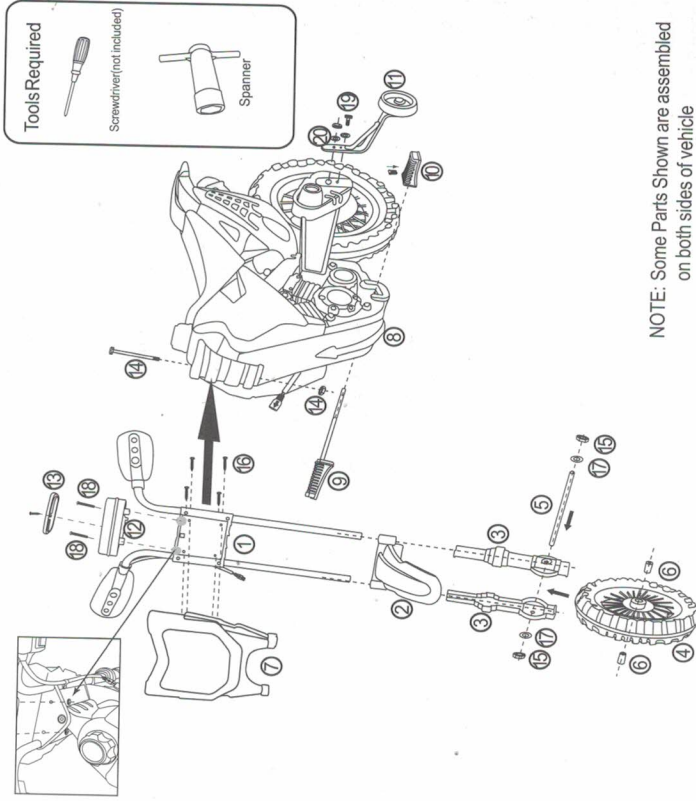

PART NO	PART NAME	PICTURE	Qty (pcs)	REMARKS	PART NO	PART NAME	PICTURE	Qty (pcs)	REMARKS
15	Nut 8mm		2		16	Screw 4*12mm		4	
17	Washer 8mm		2		18	Bolt M5*25mm		2	
19	Bolt M6*16mm		2		20	Washer 6mm		2	
21	Charger		1		22	Instruction manual		1	
23	Included Tools:	 							

For assistance with your assembly call: 1-888-411-1786 Toll Free

For assistance with your assembly call: 1-888-411-1786 Toll Free



## Product Assembly Chart

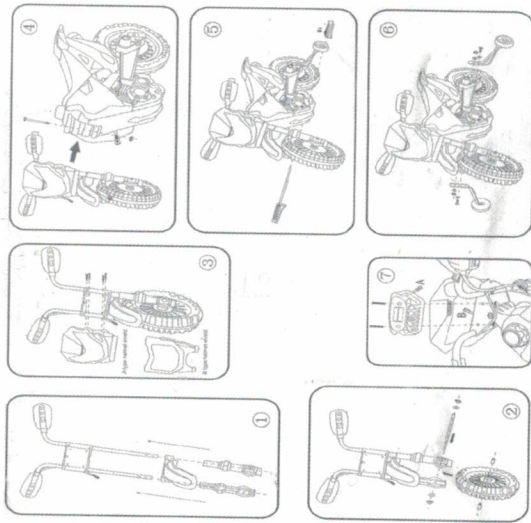

1. Please connect the wire on the handle bar to the lower wire on the front side of the Honda CRF250 6V ride on dirt bike.
2. Press the red button on the handle bar and check if the rear tire is moving.
3. To connect training wheels, please remove the nuts from the rear tire and attach the training wheels and then tighten the nuts to secure the training wheels.
4. To connect the front tire, insert the fender into the handle bar.
5. Insert the plastic side supports into the front handle bar.
6. Insert the axle and tighten the nuts with the tools provided.
7. Connect the front handle bar please remove the black spacer and connect the handle bar to the toy ride on dirt bike.
8. To connect the front handle bar please remove the black spacer and connect the handle bar to the toy ride on dirt bike.
9. Insert the silver rod and tighten it.
10. Insert the front handle bar cover and tighten the screw.
11. To connect the footrest, insert the foot rest into the axle and attach the clip.
12. To connect the music box, open the screw of the music box, place the music box between the handle bar rods, insert the screws and connect the nuts to the screws.
13. Insert 2 AA batteries in the music box to play music.

**DISTRIBUTED BY:**  
BEST RIDE ON CARS  
1-888-411-1786 Toll Free

9



## User's Guide

1. Before using the toy for first time, refer to the picture 1 in Section A, find the plug-ins on the handle and on the body of toy, and tighten the plugs.
2. Insert batteries for sound/music function. Please use AA battery for music, refer to the picture 1 in section B. Find the battery box on the toy body and add 2 dry batteries. Please note the side with the spring is the negative pole, and the opposite side is the positive pole. Do not put batteries on wrong side to avoid burning the circuit board. If the toy is not to be used for a long period of time please remove the dry battery and store it properly.
3. Refer to the picture 2. Note the position with arrow is the charging port. please charge the toy if it is running slower than normal. charge the battery for 3-4 hours. It is normal for the power charger and the battery to become warm when the battery is on charging.
4. Refer to the picture function for the start up mode, press the start switch. To brake, release the grip from the start switch.

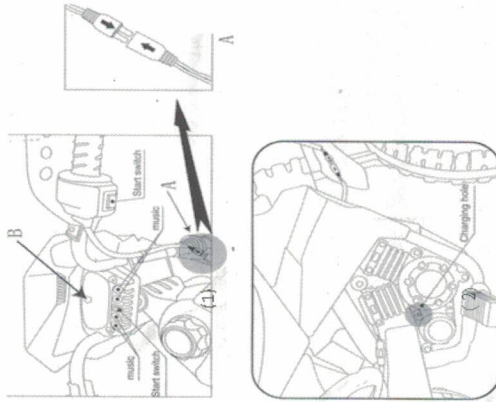

**DISTRIBUTED BY:**  
BEST RIDE ON CARS  
1-888-411-1786 Toll Free

10



## Fused Tube:

A

The Honda CRF250 6V ride on dirt bike uses glass fuses. Please refer to the picture below. When **improperly** used, the fuse will cut off automatically for 10-20 seconds, then, reconnect the power automatically. Also, when overcharged the fuse might blow causing the toy to stop working.

- 1) The maximum weight limit of toy 50 lbs.
- 2) Do not store the toy behind a running car or any other such vehicle.
- 3) Do not immerse the toy in liquid of any kinds. This may cause short circuit in the toy.
- 4) Do not change the toy circuit or structure.

B

- 1) Refer to the picture below. Put the charger into Dirt bike charging port.
- 2) Put the power plug into the matching stable AC power port.

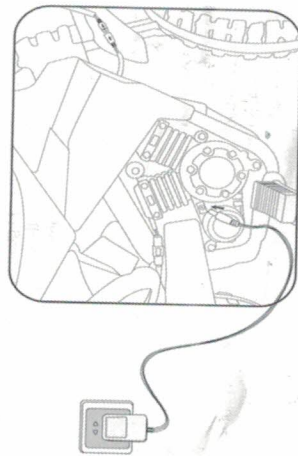

## Precautions when charging the battery of toy:

- 1) The battery should be charged with adult supervision.
- 2) When charging the battery for the first time, charge the battery fully for 3-4 hours.
- 3) Do not open or dismantle the battery and charger. Please use correct charger & battery.
- 4) While charging, do not remove the battery.
- 5) Before charging please check the charger, battery and the plugs not broken. Use the items after repair.
- 6) Charge the battery fully. If the toy is not to be used for extended period of time, then charge every 3 months to extend the lifetime of battery.

**DISTRIBUTED BY:**  
BEST RIDE ON CARS  
1-888-411-1786 Toll Free

11



## Troubleshooting

If the Dirt bike does not move

- 1) Be sure power cords are plugged firmly.
- 2) Be sure the forward and backward switch is in the neutral position.
- 3) Fuse is melted or blown.
- 4) Check for debris stuck in the wheels.

Dirt bike moves slowly

- 1) Check the battery power.
- 2) Be sure child weight limit is observed.

If the battery cannot be fully charged

- 1) Check the charger. Note - when charging, the charger will get warm, this is a normal occurrence.
- 2) Check the condition of battery.
- 3) Check for loose connection of battery and charger.

Exhausted batteries are to be removed from toy.

Rechargeable batteries are only to be charged under adult supervision.

## Care and Maintenance

The dirt bike should be checked for damages, missing or worn parts before each use.

- 1) Clean the vehicle with a soft and dry cloth. To restore shine to plastic parts, use a non-wax furniture polish. Do not use car wax, abrasive cleaners or wash the vehicle with soap and water.
- 2) This product should not be stored in high-temperature places moist places or near fire. The product should be kept covered on snowy and rainy days.
- 3) Charge the battery fully if you want to store the toy for extended period of time. Then charge it every 3 months, this way you can extend the life span of battery.
- 4) When not in use, remove battery from the toy and switch to "OFF" position. Store the battery in a proper place. Do not allow children to play with the battery.
- 5) Do not revise the circuit or structure of the toy.
- 6) Do not mix old and new batteries or batteries of different type (eg: alkaline, standard carbon zinc, rechargeable nickel-cadmium old and new or different types of batteries. Pay attention to the positive and negative poles while installing the battery.
- 7) If there is high voltage or power supply is unstable we recommend installing voltage stabilizer to protect battery.

The dirt bike should be used with caution since skills are required to avoid falls or collisions causing injury to user or to the third parties.

Batteries are to be inserted with the correct polarity.  
Rechargeable batteries are only to be charged under adult supervision.

**DISTRIBUTED BY:**  
BEST RIDE ON CARS  
1-888-411-1786 Toll Free

12



The instruction shall state that transformers or battery charger used with the toy are to be regularly examined for damage to the cord, plug, enclosures and other parts, and in occurrence of such damage they must not be used until damage has been repaired.

**Warning:** Dirt bike has no brake.

**Warning:** Protective equipment should be worn

**Warning:** Not to be used in Traffic, or unfavorable weather.

**Warning:** Dirt Bike is not suitable for children under 3 years of age due to its speed feature.

### Important!

Before using the Honda CRF250 6V ride on dirt bike an adult must read and understand the instructions in this manual. The child must meet the requirements outlined in this manual and understand how to use the vehicle. Read the safety warnings in this manual before using the Honda CRF250 6V dirt bike.

Follow these instructions to use the Honda CRF250 6V:

**Forward:** To move the Honda CRF250 6V Ride on dirt bike forward press the pedals forward.

**Braking:** To stop the Honda CRF250 6V Ride on dirt bike release the grip from the start button.

**Coaster brake:** To slow down the Honda CRF250 6V, press the pedals backwards and provide downward pressure to engage the coaster brake.

**Sound effects:** To turn on the sound effects, move the ON/OFF switch up. You will see a red light when the sounds are activated. To operate the sound effects, twist the right-hand grip backwards.

## Repairs and Parts

Do not return this product to the place of purchase. If your Honda CRF250 6V Ride on dirt bike needs repairs or replacement parts, call:

Best Ride On Cars consumer relations

Hours: 9:00am – 6:00pm (CST) Monday – Friday

Phone: 1-888-411-1786

Email: [sales@bestrideoncars.com](mailto:sales@bestrideoncars.com)

Web: [www.bestrideoncars.com](http://www.bestrideoncars.com)

For technical assistance & product queries your call or email will be directed to our technical support team. To order parts, quote the model and serial number of the product from the manual.

The following is a list of available replacement parts:

- Wheels
- Wheel covers
- Hardware bag for wheel assembly
- Hardware bag for steering assembly
- Seat
- 6-volt battery
- Charger

**DISTRIBUTED BY:**  
BEST RIDE ON CARS  
1-888-411-1786 Toll Free

13



## Warranty

60 Day Limited Warranty

Best Ride on Cars warrants this product to the original retail purchaser as follows:

The vehicle is warranted against defective materials or workmanship for 60 days from the date of original purchase. An original receipt is required to validate your warranty. Best Ride on Cars will provide replacement for defective parts or replace this product. Best Ride on Cars reserves the right to substitute the product, if the part or model has been discontinued.

To make a claim under this warranty you may contact us at [sales@bestrideoncars.com](mailto:sales@bestrideoncars.com); fax us at 972-584-9110, 24 hours a day.

Write to Best Ride on Cars Customer Support Department;

Best Ride on Cars

11937 Denton Dr.

Suite 101

Dallas, TX 75234

from Mon-Fri 9:00 am. to 6:00 pm CST.

**Note that proof of purchase is mandatory to make a claim under this warranty, and customers are responsible for shipping charges.**

### Warranty Limitations

This warranty does not include damages which arise from accident, misuse, abuse, negligence, or other causes not arising out of defects in materials or workmanship, nor does it cover damages arising out of service by other than an authorized Best Ride on Cars service center. Best Ride on Cars Honda CRF250 6V Ride on Dirt Bike is for personal use only. Not for commercial use. The original owner shall pay all labor charges connected with the repair or replacement of all parts. Under no circumstances does this limited warranty include the cost of shipment or transportation to or from an authorized Best Ride on Cars repair center or retailer.

### Limitation of Damages:

The warranty and remedies as set forth are exclusive and in lieu of all others, oral or written, expressed or implied. In no event, will Best Ride on Cars or the dealer selling this product be liable to you for any damages, including incidental or consequential damages, arising out of the use or inability to use this product. Some states do not allow limitations as the exclusion or limitation of incidental or consequential damages, so the above limitation may not apply to you.

### Limitation of Warranties and Warranty Terms

Any implied warranties, including implied warranties of the merchantability and fitness for a particular purpose, shall be limited to the duration and terms of the express written warranty. Some states do not allow limitations as the exclusion or limitation of incidental or consequential damages, so the above limitation may not apply to you. This warranty gives you specific legal rights, and you may have other rights, which vary from state to state. Neither Best Ride on Cars nor the dealer selling this product authorized any person to create for it any other warranty, obligation, or liability in connection with this product.

**DISTRIBUTED BY:**  
BEST RIDE ON CARS  
1-888-411-1786 Toll Free

14





## Contact Information

If you have any questions or comments, please contact us at:  
In U.S.A.

©Best Ride On cars  
11937 Denton Drive  
Suite # 101  
Dallas, Texas - 75234  
Customer Service:  
1-888-411-1786  
sales@bestrideoncars.com  
[www.bestrideoncars.com](http://www.bestrideoncars.com)

This product meets ASTM F963 and CPSIA requirements for electric vehicles.

Designed, manufactured and distributed by Best Ride on Cars. HONDA, the Wing® logo, Honda vehicle model names and their trade dress are trademarks of Honda Motor Co., Ltd. used under license from American Honda Motor Co., Inc. Many Honda vehicle model names and trade dress may be seen at [www.honda.com](http://www.honda.com). All rights reserved.

## ⚠ WARNING:

Use caution as misusing or mishandling the battery may cause a FIRE or EXPLOSION which may result in personal injury, property damage, or death. The user must have an appropriate understanding of the potential dangers of NON SPILLABLE LEAD ACID BATTERIES before purchase and usage. No express or implied guarantee of compatibility, suitability, or fitness for any particular purpose or device can be made. This battery is manufactured and sold for the intended use of system integrations with proper protection circuitry or battery packs with a BMS (battery management system) or PCB (circuit board/module). If purchasing this battery for resale purposes, you MUST forward ALL warnings to ALL customers for their reference and safety!

- DO NOT USE WITH E-CIGARETTE, VAPORIZER, OR SIMILAR DEVICE
- BATTERY IS ONLY FOR USE IN PROTECTED BATTERY PACKS
- ONLY ASSEMBLE A BATTERY PACK IF YOU ARE COMPETENT IN DOING SO
- DO NOT STORE BATTERY/CELL LOOSE OR IN A POCKET, PURSE, ETC. ALWAYS USE A PROTECTIVE CASE OR BOX FOR STORAGE AND TRANSPORT
- WHEN NOT IN USE, ALWAYS STORE NON SPILLABLE LEAD ACID ION BATTERIES IN THE PROTECTIVE CASE/BOX IN WHICH BATTERIES WERE DELIVERED
- Misusing or mishandling Non Spillable lead acid batteries can pose a SERIOUS RISK of PERSONAL INJURY, PROPERTY DAMAGE.
- BATTERIES MAY EXPLODE, BURN, OR CAUSE A FIRE IF MISUSED OR MISHANDLED
- Usage of batteries is AT YOUR OWN RISK!
- ONLY use with proper protection circuitry
- DO NOT short circuit intentionally or unintentionally
- KEEP AWAY from metal/conductive objects to prevent short circuiting
- DO NOT use if battery is damaged in any way
- DO NOT over-charge or charge above the maximum voltage rating
- DO NOT over-discharge or exceed the continuous discharge rating
- DO NOT modify, disassemble, puncture, cut, crush, or incinerate
- DO NOT expose to liquids or high temperatures
- DO NOT solder onto battery, spot weld only
- DO NOT use force to install or install in reverse/backwards
- ONLY use within manufacturer's specification
- KEEP AWAY from pets and children
- ALWAYS charge in or on a fire-proof surface and never leave batteries charging unattended
- ONLY use a smart charger designed for this specific type of battery
- DO NOT mix and match brands and models, old and new, used and unused batteries
- STOP immediately if while charging/storing/using the battery it emits an unusual smell, feels hot, changes color or shape, or appears abnormal in any way
- It is your responsibility to determine that your charger or device is functioning properly
- If exposed to battery electrolyte, flush with water immediately and/or immediately contact a physician or emergency services
- DO NOT throw away in trash; contact your local jurisdiction for proper recycling or disposal
- Resellers MUST forward ALL warnings to ALL customers for their reference and safety

DISTRIBUTED BY:  
BEST RIDE ON CARS  
1-888-411-1786 Toll Free



## BATTERY DISPOSAL

### Battery Recycling - Recycling Electric Kids Car Batteries

Ride on toys, electric bikes and electric scooters - we all have them and we all will have to replace our batteries at some point, or perhaps already have.

#### What to do with those used electric kids car batteries?

You are not allowed to put them out with the trash and can't just toss them in the river or bury them in the back yard because it is devastating to the environment and the public health, not to mention illegal according to Federal law (40 CFR part 273). Most states have their own laws prohibiting the disposal of rechargeable batteries, as well. So, the big question - what to do with the old batteries?

#### The answer: recycle them!

You can take your used rechargeable batteries to one of your local Department of Sanitation's Household Special Waste Drop-off Sites. They offer battery recycling information for Nickel Cadmium (Ni-Cd), Nickel Metal Hydride (Ni-MH), Lithium Ion (Li-ion), or Small Sealed Lead (Pb) weighing 2 pounds or less.

Since most of us use lead batteries weighing much more than 2 pounds, check out your own city's Department of Sanitation web page and see what they have to offer - or else just call them. Another option is retail stores, like auto parts stores or service outlets, which sell new Sealed Lead Acid batteries. Most will likely accept a small number (one or two) of spent Sealed Lead Acid batteries for recycling.

**Tip:** When transporting batteries be sure to eliminate the terminal contacts by either placing the battery in a plastic bag or wrapping black electrical tape around them.