

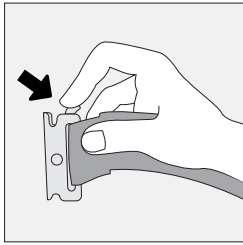

CONNECTING X-TRACK® / E-TRACK ACCESSORY

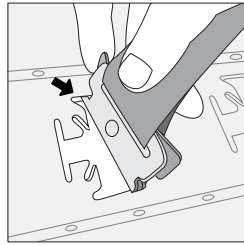

STEP 1:
Press back
locking lever.



STEP 2:
With locking
lever pressed
back, insert
lever end into
X-Track® /
E-Track slot.

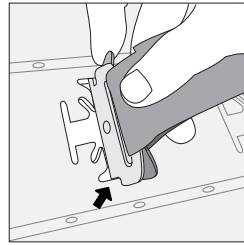

STEP 3:
Insert other
end into
X-Track® /
E-Track slot.

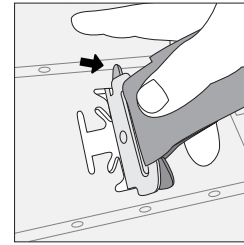

STEP 4:
Release
locking lever.

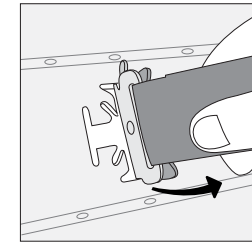

STEP 5:
Pull on
attachment to
ensure that it
has locked
securely.

DISCONNECTING X-TRACK® / E-TRACK ACCESSORY

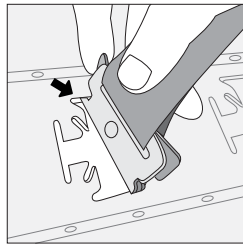

STEP 1:
Press locking
lever and push
toward locking
lever end of slot.

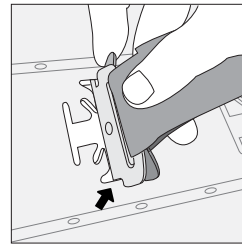

STEP 2:
Lift accessory out
of slot at angle
to remove.