

500 Lbs. ALUMINUM CARGO CARRIER

OWNER'S MANUAL

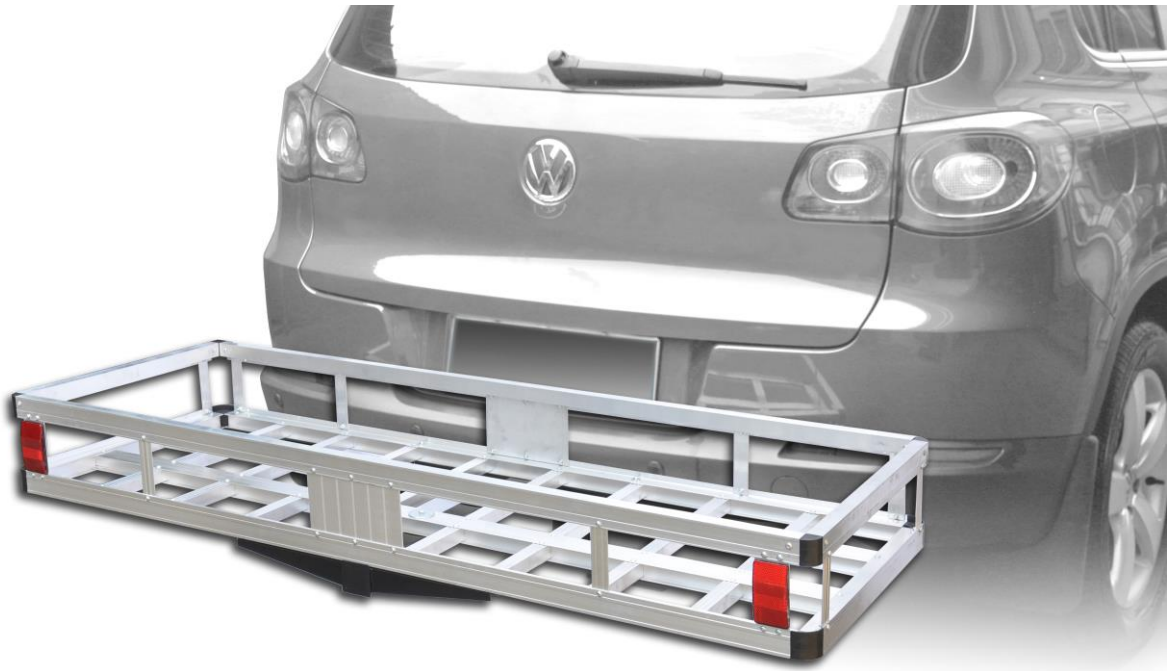

WARNING:

Read carefully and understand all **ASSEMBLY AND OPERATION INSTRUCTIONS** before operating. Failure to follow the safety rules and other basic safety precautions may result in serious personal injury.

TECHNICAL SPECIFICATIONS

Capacity	500 lbs. (227kg)
Construction	Extruded aluminum carrier. Formed steel hitch and hitch bracket. Carbon steel hardware. Thermoplastic end caps.
Vehicle Hitch Receiver Size	2in. (5cm) (Vehicle hitch requires a Class III or Class IV tow rating.)

GENERAL SAFETY RULES



WARNING: Read and understand all instructions. Failure to follow all instructions listed below may result in serious injury.



CAUTION: Do not allow persons to operate or assemble this aluminum cargo carrier until they have read this manual and have developed a thorough understanding of how the aluminum cargo carrier works.



WARNING: The warnings, cautions, and instructions discussed in this instruction manual cannot cover all possible conditions or situations that could occur. It must be understood by the operator that common sense and caution are factors which cannot be built into this product, but must be supplied by the operator.

SAVE THESE INSTRUCTIONS

WORK AREA

- **Keep work area clean**, free of clutter and well lit. Cluttered and dark work areas can cause accidents.
- **Keep children and bystanders** away while operating the aluminum cargo carrier. Distractions can cause you to lose control, so visitors should remain at a safe distance from the work area.
- **Be aware of all power lines, electrical circuits**, water pipes and other mechanical hazards in your work area, particularly those hazards below the work surface hidden from the operator's view that may be unintentionally contacted and may cause personal harm or property damage.
- **Be alert of your surroundings.** Using the aluminum cargo carrier in confined work areas may put you dangerously close to cutting tools and rotating parts.

PERSONAL SAFETY

- **Stay alert**, watch what you are doing and use common sense when using the aluminum cargo carrier. Do not use the aluminum cargo carrier while you are tired or under the influence of drugs, alcohol or medication. A moment of inattention while operating an aluminum cargo carrier may result in serious personal injury.

- **Dress properly.** Do not wear loose clothing, dangling objects, or jewelry. Keep your hair, clothing and gloves away from moving parts. Loose clothes, jewelry or long hair can be caught in moving parts.
- **Use safety apparel and equipment.** Use safety goggles or safety glasses with side shields which comply with current national standards, or when needed, a face shield. Use a dust mask in dusty work conditions. This applies to all persons in the work area. Also use non-skid safety shoes, hardhat, gloves, dust collection systems, and hearing protection when appropriate.

ALUMINUM CARGO CARRIER USE AND CARE

- **Do not modify the aluminum cargo carrier in any way.** Unauthorized modification may impair the function and/or safety and could affect the life of the equipment. There are specific applications for which the aluminum cargo carrier was designed.
- **Always check for damaged or worn out parts before using the aluminum cargo carrier.** Broken parts will affect the aluminum cargo carrier operation. Replace or repair damaged or worn parts immediately.
- **Do not exceed the aluminum cargo carrier load capacity.**
- **Distribute the load evenly.** Uneven loads may cause the aluminum cargo carrier to tip, resulting in personal injury to the operator or others. To minimize the effects of dynamic loading, make sure the load is centered on the carrier.
- **Use the aluminum cargo carrier on flat and level surfaces** capable of supporting the aluminum cargo carrier and its maximum load. Pulling or pushing a load on a slanted or uneven surface can result in loss of control.
- **Prior to transporting a load,** make sure the load is properly secured to the carrier.
- **Store idle aluminum cargo carrier.** When the aluminum cargo carrier is not in use, store it in a secure place out of the reach of children. Inspect it for good working condition prior to storage and before re-use.



WARNING: NEVER impede or block vehicle exhaust. Always keep clear exhaust pipe and exhaust path.

1. This Carrier has a maximum weight capacity of **500 pounds**. Do not exceed the 500 pound capacity.
2. Do not exceed 55 MPH while the Carrier is attached.
3. Always secure the Carrier as close to your vehicle as possible, minimizing the distance of the Carrier and its load from your vehicle.
4. Beware of dynamic loading! Dropping or bouncing a load may briefly create excess load, causing personal injury and/or product failure.
5. Inspect before use, including all bolts and nuts in the Carrier. Do not use if damaged.
6. Turn off the vehicle's ignition and set the parking brake before loading an object onto the Carrier or unloading.
7. Make sure to read and understand all instructions and warnings set forth by the manufacturer of the vehicle that the carrier will be used with.
8. Keep the Carrier clean and dry at all times.
9. This product is not a toy. Keep it out of reach of children.
10. Never ride a motorized object (powered scooters, lawn tractors, ATV's, etc.) onto or off the Carrier. Only load/unload with the motorized object empty of cargo and people.
11. Follow D.O.T. (Department of Transportation) guidelines for installation and use.
12. Make sure to secure the load on the Carrier with ropes, and/or tie-downs (not included)

before transporting.

13. Only use the Carrier with a properly installed **Class III or Class IV** 2 inch hitch receiver capable of supporting the Carrier and its load.
14. The warnings, precautions, and instructions discussed in this manual cannot cover all possible conditions and situations that may occur. It must be understood by the operator that common sense and caution are factors which cannot be built into this product, but must be supplied by the operator.



WARNING! Flammable cargo can ignite from exposure to heat. Be aware of the possible fire risk and property damage resulting from the vehicle's exhaust system pointing at or running near the cargo in the carrier. Do not use if this condition exists.

ASSEMBLY

Setup the Carrier

Your Cargo Carrier will require some light assembly prior to use. It is important that you read the entire manual to become familiar with the product BEFORE you assemble and use the Cargo Carrier. Before assembling and operating the Cargo Carrier be sure that you have all parts described in the Parts List and Assembly Diagram located on the last pages of this manual.

1. Align the Top Carrier Frame (2) with the Carrier Frame (1). Connect them with the two Reflector Plate with reflector (5) on the outside rear corners of the Cargo Carrier using Bolt (3) and Nut (4) - see Assembly diagram. The reflective side must be facing the rear of the Cargo Carrier.
2. Use the Small Connect Plate (9) to connect the Top Carrier Frame (2) to the Carrier Frame (1): Attach each end of the Small Connect Plate (9) to the Top Carrier Frame (2) and the Carrier Frame (1) using Bolt (3) and Nut (4) - see Assembly diagram. Repeat for each Small Connect Plate (9).
3. Attach the Middle Connect Plate (10) so that the top and bottom of the Middle Connect Plate (19) is attached to the Top Carrier Frame (2) with three Bolts (3) and three Nuts (4) on each end. A Middle Connect Plate (10) is attached to both the front and back of the Cargo Carrier. See Assembly Diagram.
4. Place the Hitch Connect Frame (19) underneath the Carrier Frame (1) and align the holes.
5. To secure the Connect Frame (19), insert a Bolt (18&15) through both holes in the Carrier Frame (1) and the Hitch Connect Frame (19). Slide on Washers (17&12), and thread on Nut (11) - see Assembly Diagram.

Mounting carrier to Hitch Receiver

1. Remove the Hitch Pin (16) and the Safety Pin (15) from the front of the Hitch Connect Frame (19).
2. With assistance, lift the empty Carrier and slide the open end of the Hitch Tube into the hitch receiver, and secure them with the Hitch Pin (16) and the Safety Pin (15).

OPERATION

1. Load your things on the carrier. Then secure the load in place using appropriate tie-downs, ropes, etc. (not included). **Do not exceed the 500 Lbs. maximum weight capacity. Weight inside the Carrier should be evenly distributed.**

WARNING: The load weight must be centered or evenly distributed across the Carrier Frame (8). Always use appropriate tie-down restraints to securely attach any cargo loaded onto the Cargo Carrier before moving your vehicle any distance. Do not leave loose items on the Carrier Frame (8) while operating the vehicle.

Note: Any load over 320 lb. requires a Class 3 hitch on the vehicle.

(Class 2 Hitch = 350 lb. maximum tongue weight, add Carrier weight of about 30 lb.)

(Class 3 Hitch = 500 lb. maximum tongue weight)

Always use Reflectors (7). Make certain to use the appropriate red flags (not included) when moving a load. Check with your local traffic enforcement agency to make certain that you are correctly following all local laws.

MAINTENANCE

- **Maintain your aluminum cargo carrier.** It is recommended that the general condition of any aluminum cargo carrier be examined before it is used. Keep your aluminum cargo carrier in good repair by adopting a program of conscientious repair and maintenance. If any abnormal vibrations or noise occurs, have the problem corrected before further use. Have necessary repairs made by qualified service personnel.
 - **BEFORE EACH USE**, inspect the general condition of the Carrier. Check misalignment, loose or damaged parts and any other condition that may affect its safe operation.
- **BEFORE EACH USE**, make sure any dirt, debris, oil, grease, etc. are cleaned off the Carrier. Clean the Carrier with a clean, moist cloth. Do not use solvents.
 - **PERIODICALLY**, check all hardware for tightness.

DIAGRAM & PARTS LIST

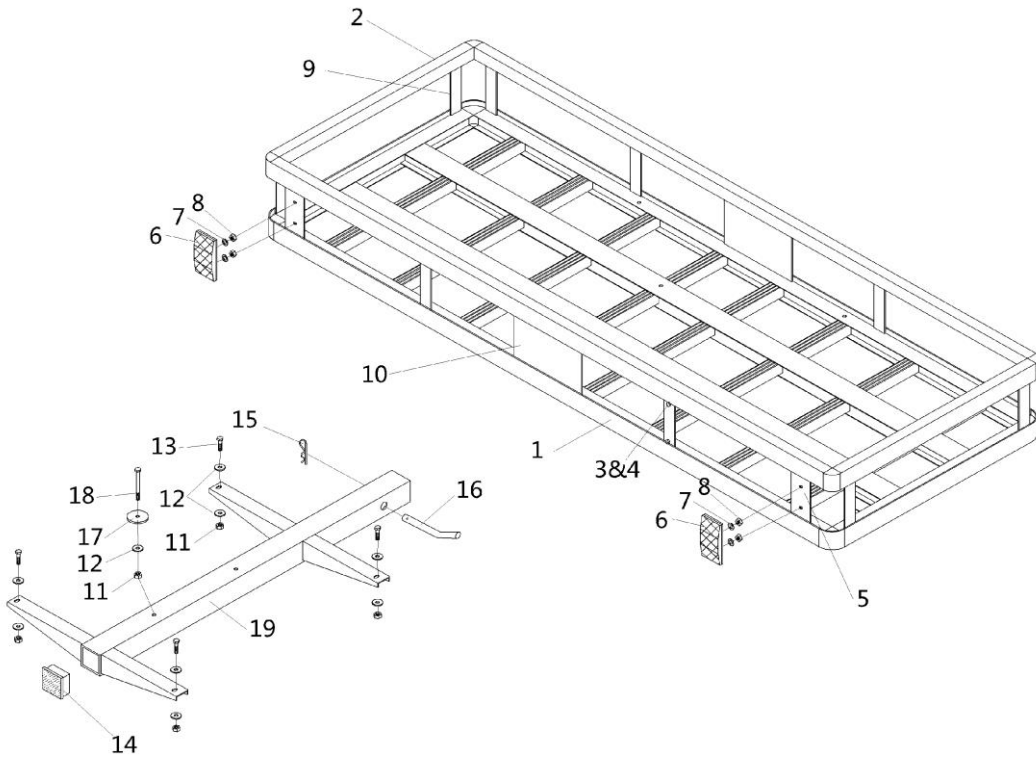

NO	Description	QTY
1	carrier frame	1
2	top carrier frame	1
3	screw M5X12	39
4	locking nut M5	39
5	reflector plate	2
6	reflector	2
7	spring washer 5	4
8	nut M5	4
9	small connect plate	10
10	middle connect plate	2

NO	Description	QTY
11	locking nut M6	6
12	washer 6	10
13	screw M6X45	4
14	end cap	1
15	hitch pin	1
16	safety pin	1
17	big washer 6	2
18	Screw M6X90	2
19	hitch connect frame	1