







TIRE SEALANT INSTRUCTIONS



HOW MUCH PER TIRE?

www.slime.com/calculator

	4 oz. (118 mL)	4 pumps
	8 oz. (237 mL)	8 pumps
	8 oz. (237 mL)	8 pumps
	16 oz. (473 mL)	16 pumps
	Sm-16 oz. (473 mL) Lg-32 oz. (946 mL)	16 pumps 32 pumps
	24 oz. (710 mL)	24 pumps

- Instantly Seals Tread Area Punctures up to 1/4" (6mm) in Size
- Works in Extreme Temperatures
- Safe for Finished Metal Wheels
- Non-Flammable & Non-Toxic
- Cleans Up with Water
- TPMS Safe & Approved (!)



PUMP CARE

THIS PUMP MAY CLOG (it is the nature of Slime)

1. Shake well before pumping.
2. One full depression of the pump dispenses approximately 1 ounce (30 mL) of sealant.
3. If pump clogs, unscrew pump and rinse with warm water.
4. DO NOT RETURN PUMP TO STORE.

If you cannot get pump to work, call 1.888.45.SLIME for a replacement pump.

PRIME THE PUMP: Fill the pump's flex tube with sealant by slowly depressing the pump handle until flex tube is full. Attach flex tube to valve stem, then pump the recommended amount of sealant into the tire.

NOTE: The 2.5 Gallon (9.46 Liters) keg pump dispenses approximately one ounce (30 mL) per full depression.

HOW DO I INSTALL SLIME?

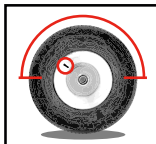

- 1** Position valve in upper half of tire.

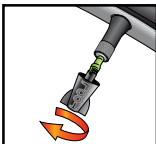

- 2** Remove valve core with included tool.



- 3** Allow tire to fully deflate.



- 4** Remove object (if possible).



- 5** Attach hose and pump in Slime.

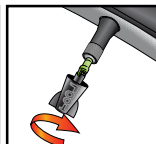

- 6** Reinstall valve core.

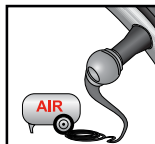

- 7** Just add air.



- 8** Drive. Stop. Verify seal and check pressure.