

EZ Mount Kitty Sill Deluxe with Bolster™

Care & Instructions

Made in China
K&H Pet Products, Central Garden & Pet
Colorado Springs, CO
www.khmf.com | (719) 591-6950



Thank you for purchasing the EZ Mount Kitty Sill Deluxe with Bolster™ designed by K&H Pet Products. When used correctly, your kitty sill should provide years of hassle-free comfort and window viewing pleasure for your cat.

ASSEMBLY OF YOUR EZ Mount Kitty Sill Deluxe with Bolster™

- 1** Remove all pieces from the box and lay out on a table. Included in the box are 2 suction cups, 2 stability rods, frame and cover. See **Figure 1**.
- 2** Turn the frame and cover upside down on the table. Detach the hook and loop material on both long sides and on one end only and lay the 3 open flaps flat on the table. See flaps in **Figure 2**. You will now be installing the stability rods and completing the assembly of the EZ Mount Kitty Sill Deluxe with Bolster™.
- 3** Install both stability rods into the plastic joints and push together your frame until it is taut. See **Figure 3**. Re-attach the hook and loop material by folding over the 3 flaps and pressing down the 3 open sides around the frame. Adjust the material around all edges of the frame until the cover is nice and tight on the frame.
- 4** Turn cover and frame over to top side and install the suction cups onto the frame. It may require some turning and pushing. These are meant to be tight and should be installed onto corners of the unit for safety and stability. See **Figure 4**.

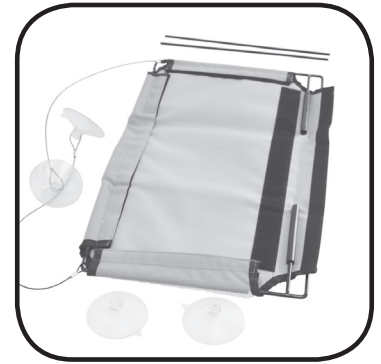

Figure 1

Leave 1 end flap attached to hook and loop material to hold frame.

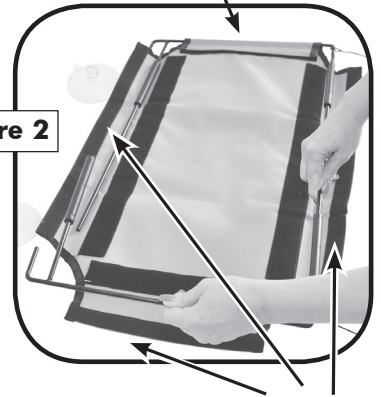

Figure 3



Figure 4

Figure 2



Detach 3 flaps and lay down flat leaving one end attached.

INSTALLING THE BOLSTER ONTO THE FRAME:

- 1** Lay your kitty sill frame right side up and lay the bolster on top so that it overlaps the edges of the frame. At this time, decide which direction you want the back of the bolster to face. Once installed it can either rest against the window or sit on the opposite back edge of the kitty sill.
- 2** Next, run the hook and loop straps located on each of the 4 corners of the bolster through the corners of the kitty sill frame. See **Figure 5**. Secure each hook and loop strap snugly to the metal frame until the bolster is securely attached.



Figure 5

Continued on other side . . .

EZ Mount Kitty Sill Deluxe with Bolster™

Care & Instructions

Made in China
K&H Pet Products, Central Garden & Pet
Colorado Springs, CO
www.khmf.com | (719) 591-6950



INSTALLING ONTO A WINDOW

- 1** Using glass cleaner, thoroughly clean and dry the window that will accommodate the EZ Mount Kitty Sill Deluxe with Bolster™. Clean each suction cup to ensure proper adhesion to the window.
- 2** Holding the frame with the suction cups facing the window, gently push one suction cup against the window. Level the frame and then gently push the second suction cup against the window. See **Figure 6**.
- 3** With fingers, push remaining air out of the suction cups to ensure a proper adhesion. See **Figure 7**.
- 4** Align each support strap and adhere the suction cups to the window taking care to keep similar tension on each strap. See **Figure 8**.
- 5** Make sure your EZ Mount Kitty Sill Deluxe with Bolster™ is level. Readjust as needed.

TIP To operate blinds, curtains and window coverings with the EZ Mount Kitty Sill Deluxe with Bolster™ attached, simply flip up your new kitty sill against the window. You can leave the bolster on or remove it depending on how much clearance you need for your window coverings. Next, pull back both top corners of the hook and loop material on both the right and left sides. See **Figure 9**. Then pull straps on both right and left sides and secure them underneath the hook and loop material and press down to adhere. See **Figure 10**. This will support the kitty sill frame in the upright position. Blinds and curtains can now operate normally.

Secure straps under hook and loop material on both sides



Figure 6



Figure 7

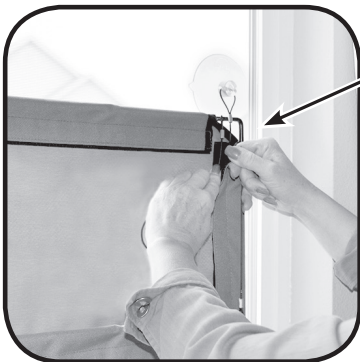

Figure 9



Figure 10



Figure 8

Care Instructions:

Remove cover and bolster. Machine wash & line dry. Wipe frame with a damp cloth.

Caution: As with any suction cup, debris, temperature changes, sunshine and excessive use can weaken the holding power. We recommend removing the suction cups at least once per month to clean the window area, clean the suction cups and then re-install them for optimal strength.

K&H Limited One Year Warranty

Our warranty is as follows: K&H Pet Products warrants to the original consumer, that this product will be free of defects and workmanship for a period of one year from the date of purchase. The manufacturer's liability hereunder is limited to replacement of the product. This warranty is void if the product has been damaged by accident, unreasonable use, neglect, tampering, or other causes not arising from defects in material and workmanship.

To exercise your warranty: If, during the warranty period, your product malfunctions, return it to the place of purchase with your **original purchase receipt**. If this cannot be done, return the product, postage prepaid, to K&H Pet Products, with a **dated proof of purchase or original date receipt**. A return authorization number can be obtained by calling (719) 591-6950 and must accompany all returns to manufacturer. Please include a note explaining the problem when returning the product.