



THE DUKE

Assembly and Safe Use Manual



This X-Stand™ product(s) has been tested to rigid industry standards. Safe operation and use of this X-Stand™ product(s) is the responsibility of the user(s). Please read and follow all safe use instructions and warnings. Failure to follow these may result in serious injury or death! Third Edition, February 2018, Published by X-Stand™ TREESTANDS, Lakeville, Minnesota.

© 2018 X-Stand™ TREESTANDS. All right reserved.

X-STAND.COM

**ATTENTION!! WHEN YOU SEE A “! WARNING!” BE SURE TO HEED THE MESSAGE!
THE INFORMATION CONTAINED IN THESE MESSAGES CAN SAVE YOUR LIFE!!**

LADDERSTAND SAFE USAGE INSTRUCTIONS & WARNINGS

XSL544 • THE DUKE

Max. Weight Capacity (User(s) and Equipment) 300 lbs (136 kg)

! WARNING! This product carries strict weight restrictions. Please note that these weight limitations include the user(s) and their equipment. **DO NOT** use these product(s) if you exceed these total weight limitations. Failure to follow these instructions may result in serious injury or death!

A safe treestand hunting video, *Treestand Safety: It's Up To You*, has been included. Please view it in its entirety prior to using this product! Thank you for your purchase of this quality X-Stand™ Treestands product. To ensure your personal safety, please take a moment to carefully read this Instruction Manual in its entirety before attempting to assemble, set-up, install and/or otherwise use this X-Stand™ Treestands product. Failure to follow these instructions may result in serious injury or death!

Should you have any questions about the installation and/or use of this product, or any other X-Stand™ Treestands product(s) do not hesitate to call one of our customer service representatives at 540-877-2769 or visit X-Stand™ Treestands online at *X-Stand.com*. Our customer service representatives will answer any questions you may have about any of the complete line of X-Stand™ Treestands products.

Do not return this product to the retailer if you have any damaged or missing parts. Call X-Stand™ Treestands for replacement of any damaged or missing parts at 540-877-2769.

! WARNING! Failure to read and strictly comply with the instructions contained in this Instruction Manual may result in serious injury or death!

! WARNING! FALLS FROM A TREESTAND CAN OCCUR ANYTIME AFTER LEAVING THE GROUND. THESE FALLS COULD RESULT IN EITHER SERIOUS INJURY OR DEATH! FOR YOUR PERSONAL SAFETY, PLEASE TAKE A MOMENT TO CAREFULLY READ THIS PRODUCT INSTRUCTION MANUAL IN ITS ENTIRETY BEFORE ATTEMPTING TO ASSEMBLE, SET-UP, INSTALL AND/OR OTHERWISE USE THIS X-STAND™ PRODUCT. AT LEAST ANNUALLY, REVIEW THE CONTENTS OF THIS INSTRUCTION MANUAL AND WATCH THE SAFE TREESTAND HUNTING DVD. ADDITIONALLY, KEEP THESE INSTRUCTIONS FOR THE ENTIRE DURATION THAT YOU OWN THIS PRODUCT(S). FAILURE TO FOLLOW THESE INSTRUCTIONS MAY RESULT IN SERIOUS INJURY OR DEATH!

! WARNING! A *Treestand Safety: It's Up To You* DVD has been included with this treestand. Please view it in its entirety prior to using this or any other X-Stand™ product(s). Failure to follow these instructions may result in serious injury or death!

! WARNING! THE SAFE USE AND OPERATION OF THIS PRODUCT IS THE SOLE RESPONSIBILITY OF THE USER. IT IS ALSO THE SOLE RESPONSIBILITY OF THE OWNER TO PROVIDE ANY PERSON(S) WHO BORROW OR PURCHASE THIS PRODUCT WITH THESE INSTRUCTIONS AND THE AFORE MENTIONED *TREESTAND SAFETY: IT'S UP TO YOU* DVD. FAILURE TO FOLLOW THESE INSTRUCTIONS MAY RESULT IN SERIOUS INJURY OR DEATH! ADDITIONALLY, FAILURE TO FOLLOW THIS INSTRUCTION MAY SUBJECT YOU TO PERSONAL LIABILITY PENALTIES AS DETERMINED BY THE U.S. JUDICIAL SYSTEM.

! WARNING! Prior to each hunt, you must inform someone of your hunting location, including the specific location of your treestand and the expected duration of your hunt. Failure to follow these instructions may result in serious injury or death!

! WARNING! Prior to each hunt, make sure that you have a signaling device (e.g., mobile phone, radio, whistle, signal flare or Personal Locator Device (PLD)) in your possession and in an operable condition. This device must be within easy access should you experience the need to contact emergency assistance. Failure to follow these instructions may result in serious injury or death!

! WARNING! **DO NOT** remove, modify, and/or omit any portion or otherwise mechanically modify this X-Stand™ product(s) or its assemblies in any manner. Modification, misuse, and/or part substitution shall immediately void your factory warranty and may result in serious injury or death! If you suspect that a part(s) is missing and/or defective, immediately contact X-Stand™ at 540-877-2769 for replacement of missing or defective parts. Never modify your stand in any way by making repairs, or altering, adding or attaching anything to it except if explicitly authorized in writing by X-Stand™. **ALWAYS USE GENUINE FACTORY AUTHORIZED X-STAND™ REPLACEMENT PARTS. USE OF ANY REPLACEMENT PARTS OTHER THAN GENUINE X-STAND™ PARTS VOIDS YOUR WARRANTY AND MAY RESULT IN SERIOUS INJURY OR DEATH!**

! WARNING! **ALWAYS** inspect/check **ALL** expiration dates/tags on all straps and the full-body fall arrest harness and its components prior to each use. You must replace **ALL** straps and suspension seats **EVERY** year. Never use any strap(s) or full-body fall arrest harness or its components that has expired and/or is showing any signs of damage and/or wear. Failure to follow these instructions may result in serious injury or death!

! WARNING! Make certain all chains, cables, straps, etc. are tightened per this Instruction Manual prior to use. All treestand contact points must be in contact with the tree before you step onto the stand. The correct adjustment and tightening of attachment hardware is critical to the stable installation of this treestand. Additionally, you **MUST** be wearing your Fall Arrest System (FAS) which includes a full-body fall arrest harness, tree belt, lanyard/tether, suspension relief device and climbing belt/lineman's belt (as applicable) in accordance with the Instructions contained in this Instruction Manual. Failure to follow these instructions may result in serious injury or death!

! WARNING! This product(s) is designed for adult use only. No one under the age of 16 should attempt to use this or any other X-Stand™ product(s) without direct adult supervision. Failure to follow these instructions may result in serious injury or death!

! WARNING! Prior to attempting to use this or any other X-Stand™ product(s) you must take a moment and become familiar with its assembly, setup and installation. You must practice installing, setting-up and using your full-body fall arrest harness and its components (i.e., lanyard/tether, tree belt, suspension relief device, climbing belt/lineman's belt [as applicable]) at ground-level prior to attempting to use it at heights above ground-level. Once you have become thoroughly knowledgeable and comfortable with this X-Stand™ product(s) setup, installation and use at ground-level, you are now ready to use it at heights above ground-level. Failure to follow these instructions may result in serious injury or death!

! WARNING! Several X-Stand™ Treestands are equipped with a footrest, armrests and/or shooting rail. Neither the footrest, armrests nor the shooting rail have been designed to support the users weight. Under no circumstances should you place any more than fifteen (15) lbs (6 kg) of weight on these structures. Doing so will put the user in serious risk of injury or death. Failure to follow these instructions may result in serious injury or death!

! WARNING! You must wear a **Fall Arrest System (FAS)** comprising of a full-body fall arrest harness, tree belt, lanyard, suspension relief device and climbing belt/lineman's belt (as applicable) at all times after leaving the ground. You must stay connected at all times after leaving the ground while using fixed position treestands. Single safety belts and chest harnesses are no longer allowed and should never be used. If you are not wearing a full-body fall arrest harness that is properly attached to the tree to protect you from a fall, do not leave the ground nor attempt to enter your treestand. Failure to follow these instructions may result in serious injury or death!

! WARNING! Never attempt to climb up or down with a weapon and/or gear in your possession. **ALWAYS** unload your weapon and pull it up to hunting height using a tether or pull up rope. **ALWAYS** lower your unloaded weapon down to the ground prior (when raising or lowering firearms, the chamber must be open and the barrel pointing toward the ground) to attempting to climb up or climb down. Use this same method when raising or lowering all other gear. Failure to follow these instructions may result in serious injury or death!

**ATTENTION!! WHEN YOU SEE A “⚠️ WARNING!” BE SURE TO HEED THE MESSAGE!
THE INFORMATION CONTAINED IN THESE MESSAGES CAN SAVE YOUR LIFE!!**

⚠️ WARNING! Prior to each use thoroughly inspect the treestand and all of its related components and all safety devices before use for signs of wear, rot, corrosion, cracks, deterioration and/or any other type of defect. Make certain that your treestand is tight and secure prior to use. Protect this product from extended exposure to direct sunlight, excessive heat or freezing temperatures by storing inside when not in use. **DO NOT** use this or any other product(s) if it shows evidence of wear, rot, corrosion, cracks, deterioration and/or any other type of defect. Failure to follow these instructions may result in serious injury or death!

⚠️ WARNING! DO NOT use this or any other X-Stand™ product(s) if you have a history of heart problems, back problems, impaired vision, joints that lock-up, spinal fusions, equilibrium problems, high blood pressure, are not well-rested and/or any other physical impairment that may limit your ability to use and/or operate this product(s) in the safe manner outlined in this Instruction Manual. Additionally, do not use this or any other X-Stand™ product(s) if you are currently taking medication (including prescription) and/or using and/or consuming any substance, including alcohol, that may limit your ability to use this X-Stand™ product(s) as outlined and described in the Instruction Manual. Never use a treestand when feeling ill, nauseous or dizzy. Failure to follow these instructions may result in serious injury or death!

⚠️ WARNING! DO NOT attempt to make adjustments to this product while in the treestand. All adjustments must be made with the entire treestand on the ground. Failure to follow these instructions may result in serious injury or death!

⚠️ WARNING! DO NOT leave your X-Stand™ product(s) installed for more than two weeks (14 days). Any number of factors can jeopardize its installation and integrity. These include, but are not limited to, weather or other environmental factors that can negatively affect its performance. Animals can also cause damage to your X-Stand™ product(s) that can negatively affect its performance and your safety. Additionally, factors such as tree growth can stress and damage supporting straps, cables, chains and/or buckles. Failure to follow these instructions may result in serious injury or death!

⚠️ WARNING! ALWAYS inspect the treestand and all safety devices prior to each use. **DO NOT** use this product(s) if it shows signs of wear, damage, deterioration, or vandalism. Factors such as tree growth, vandals, weather and animals may affect the performance of an unattended treestand. Failure to follow these instructions may result in serious injury or death!

⚠️ WARNING! DO NOT modify, fix/repair, alter, bend, cut, weld, drill or heat the treestand in any way. Also, do not attach anything to your treestand without explicit authorized and written instructions from the manufacturer. Failure to follow these instructions shall void warranty and may result in serious injury or death!

⚠️ WARNING! Strict weight limitations have been set for each product to ensure your personal safety. Note the weight limitations of your stand and that this weight limit includes the user (one person) and their equipment. **NEVER EXCEED THESE WEIGHT LIMITATIONS!** Failure to follow these instructions may result in serious injury or death!

⚠️ WARNING! DO NOT attempt to use this or any other X-Stand™ product(s) when ice, snow, and/or freezing rain has deposited or formed on any portion of the tree or stand you intend to climb. Do not attempt to use this or any other X-Stand™ product(s) when thunderstorms are threatening and/or present within five (5) miles. Do not attempt to use this or any other X-Stand™ product(s) when any other adverse weather condition presents itself. These include, but are not limited to, weather conditions which have the potential for producing winds, lightning, rain, snow, sleet and/or any other atmospheric condition which may limit the user's ability to operate this X-Stand™ product(s) in a safe manner as described in this Instruction Manual. Should inclement weather conditions arise during your use of this X-Stand™ product(s), return to the ground immediately. Failure to follow these instructions may result in serious injury or death!

⚠️ WARNING! DO NOT jump or bounce on the treestand platform and/or the seat to engage the stand to the tree. Failure to follow these instructions may result in serious injury or death!

⚠️ WARNING! BEFORE each use, make sure all nuts and bolts are secure. **CHECK** all hardware and webbing prior to every use to make sure that no damage has occurred to hardware and that webbing (as applicable) is not cut or frayed. Keep webbing from coming into contact with any sharp edges. **DO NOT USE THIS PRODUCT IF ANY DAMAGE IS SUSPECTED.** Failure to follow these instructions may result in serious injury or death!

⚠️ WARNING! REPLACE any damaged or worn part with original parts. Replace attachment straps every one year and when not in use store in a dry, cool, safe place away from sunlight. Never store a treestand or any of its components outdoors when not in use. To purchase parts contact X-Stand™ Treestands at 540-877-2769. Failure to follow these instructions may result in serious injury or death!

⚠️ WARNING! Always wear the appropriate foot wear when using a treestand. A good non-slip safety boot is important for your safety. Be especially careful that boot laces do not get hooked on the tree stand or its components (tuck shoelaces into boot before climbing). Failure to follow these instructions may result in serious injury or death!

⚠️ WARNING! DO NOT use this product, or attempt to use a treestand, on a dead, leaning, diseased, loose barked tree (bark that flakes or falls off), irregular shaped trees, or utility poles. **DO NOT** use this product on any tree that does not allow for a level standing platform. Failure to follow these instructions may result in serious injury or death!

⚠️ WARNING! NEVER hunt out of a treestand at heights at which you are not completely comfortable. Depending upon the tree and hunting conditions, choose the minimum hunting height that allows for safe, effective hunting. Failure to follow these instructions may result in serious injury or death!

⚠️ WARNING! DO NOT use this, or any other X-Stand™ product(s) to climb utility poles, telephone poles, structural columns or any other man-made structures. Never use this or any other X-Stand™ product(s) around power generation (e.g., transformers, generators, substations, etc.) and/or power transmission equipment. Never use a treestand on a dead, leaning, diseased or loose barked tree. **NEVER USE A TREE BRANCH, OR ANY PORTION OF A TREE, TO SUPPORT ANY PORTION OF YOUR WEIGHT OR AS A HAND HOLD.** Failure to follow these instructions may result in serious injury or death!

⚠️ WARNING! DO NOT stand on the treestand seat. Failure to follow these instructions may result in serious injury or death!

⚠️ WARNING! This X-Stand™ Treestand product(s) was designed for installation on trees with a minimum diameter of nine (9) inches (23 cm) to maximum diameter of twenty (20) inches (51 cm) at treestand installation height (i.e., seat height). **DO NOT** use your X-Stand product(s) on trees with trunk diameters that do not meet these diameter requirements. Failure to follow these instructions may result in serious injury or death!

⚠️ WARNING! A minimum of three (3) adults is required to install and/or remove a ladderstand. Failure to follow these instructions may result in serious injury or death!

⚠️ WARNING! The jaws (on applicable X-Stand ladderstands) and stabilization devices must be attached and tightened before attempting to climb to the seating/standing platforms. Failure to follow these instructions may result in serious injury or death!

⚠️ WARNING! When installing a ladderstand, always apply weight on the first rung to set the ladder firmly into the ground. Failure to follow these instructions may result in serious injury or death!

⚠️ WARNING! Check the ground under ladderstands and climbing systems to make sure it is firm and level. Sloping ground or uneven surfaces (one side on a rock) can cause the ladder to tilt or shift off the tree as you climb. Failure to follow these instructions may result in serious injury or death!

⚠️ WARNING! Always maintain three-point contact when climbing up or down a tree. Proper three-point contact means having either two feet with one hand or one foot with two hands on the step portion of the ladder at all times when climbing up or down. Failure to follow these instructions may result in serious injury or death!

⚠️ WARNING! Always lean forward as you climb and attach your full-body fall arrest harness tree belt to the tree trunk before securing the platform to the tree and stepping onto the platform. Failure to follow these instructions may result in serious injury or death!

READ THIS MANUAL IN ITS ENTIRETY PRIOR TO USING THIS PRODUCT.

This instruction manual complies with ASTM F2123 Standard Practice for Treestand Instruction.

**ATTENTION!! WHEN YOU SEE A “! WARNING!” BE SURE TO HEED THE MESSAGE!
THE INFORMATION CONTAINED IN THESE MESSAGES CAN SAVE YOUR LIFE!!**

FULL-BODY FALL ARREST HARNESS USAGE INSTRUCTIONS & WARNINGS

! WARNING! Failure to read and strictly comply with the instructions contained here may result in serious injury or death!

! WARNING! READ ALL THE INFORMATION INCLUDED HERE PRIOR TO ATTEMPTING TO USE THIS FULL-BODY FALL ARREST HARNESS AND ITS COMPONENTS. YOUR FULL-BODY FALL ARREST HARNESS AND ITS COMPONENTS ARE DESIGNED FOR A MAXIMUM WEIGHT CAPACITY (USER AND EQUIPMENT) OF 300 POUNDS (136 KG). ADDITIONALLY, YOUR FULL BODY FALL ARREST HARNESS AND ITS COMPONENTS MUST BE REPLACED AFTER THREE (3) YEARS OF SERVICE! PLEASE CONTACT X-STAND™ TREESTANDS FOR FULL-BODY FALL ARREST HARNESS REPLACEMENT PROCEDURE SHOULD YOU EXPERIENCE A FALL OR SHOULD IT EXCEED THE THREE (3) YEAR SERVICE PERIOD.

! WARNING! Prior to attempting to use this or any other X-Stand™ product(s) you must take a moment and become familiar with its assembly, setup and installation. You must practice installing, setting-up and using your full-body fall arrest harness at ground-level prior to attempting to use it at heights above ground-level. Once you have become thoroughly knowledgeable and comfortable with this product(s) setup, installation and use at ground-level, you are now ready to use it at heights above ground-level. Failure to follow these instructions may result in serious injury or death!

! WARNING! You must wear a **Fall Arrest System (FAS)** comprising of a full-body fall arrest harness, tree belt, lanyard, suspension relief device and climbing belt/lineman's belt (as applicable) at all times after leaving the ground. You must stay connected at all times after leaving the ground while using fixed position treestands. Single safety belts and chest harnesses are no longer preferred and should never be used. If you are not wearing a full-body fall arrest harness, do not leave the ground. Failure to follow these instructions may result in serious injury or death!

! WARNING! ALWAYS practice using your full-body fall arrest harness (FAS) in the presence of a responsible adult prior to using it in an elevated hunting environment, and learn what it feels like to hang suspended in the harness at ground level. Practice installing and using your treestand at ground level and with a responsible adult present before you go hunting.

! WARNING! The length of the full-body fall arrest harness tether must be kept to a minimum at all times during use. It should be adjusted so that it is above the head with no slack (snug) in the sitting position. Never allow the full-body fall arrest tether to get under your chin, around your neck, or under your arm(s). Failure to follow these instructions may result in serious injury or death!

! WARNING! Should you experience a fall there is time to make a correct decision on what action needs to take place. It is important to remember: **DO NOT PANIC!** Failure to follow this warning may result in serious injury or death!

! WARNING! If you have a limiting physical and/or health condition that precludes and/or renders you incapable of self-recovery and/or a suitable escape plan is not available, **DO NOT** hunt from heights above ground-level. Failure to follow these instructions may result in serious injury or death!

! WARNING! FALLS FROM A TREESTAND CAN OCCUR ANYTIME AFTER LEAVING THE GROUND. THESE FALLS COULD RESULT IN EITHER SERIOUS INJURY OR DEATH! FOR YOUR PERSONAL SAFETY, PLEASE TAKE A MOMENT TO CAREFULLY READ THIS PRODUCT INSTRUCTION MANUAL IN ITS ENTIRETY BEFORE ATTEMPTING TO ASSEMBLE, SET-UP, INSTALL AND/OR OTHERWISE USE THIS X-STAND™ PRODUCT. AT LEAST ANNUALLY, REVIEW THE CONTENTS OF THIS INSTRUCTION MANUAL AND WATCH THE SAFE TREESTAND HUNTING DVD. ADDITIONALLY, KEEP THESE INSTRUCTIONS FOR THE ENTIRE DURATION THAT YOU OWN THIS PRODUCT(S). FAILURE TO FOLLOW THESE INSTRUCTIONS MAY RESULT IN SERIOUS INJURY OR DEATH!

! WARNING! THE SAFE USE AND OPERATION OF THIS PRODUCT IS THE SOLE RESPONSIBILITY OF THE USER. IT IS ALSO THE SOLE RESPONSIBILITY OF THE OWNER TO PROVIDE ANY PERSON(S) WHO BORROW OR PURCHASE THIS PRODUCT FROM THEM WITH THESE COMPLETE INSTRUCTIONS. FAILURE TO FOLLOW THESE INSTRUCTIONS MAY RESULT IN SERIOUS INJURY OR DEATH! ADDITIONALLY, FAILURE TO FOLLOW THESE INSTRUCTIONS MAY SUBJECT YOU TO PERSONAL LIABILITY PENALTIES AS DETERMINED BY THE U.S. JUDICIAL SYSTEM.

! WARNING! Practice the use of your X-Stand™ Treestand full-body fall arrest harness and suspension relief device (SRD) at ground-level in the presence of a responsible adult to experience the feeling of hanging suspended before using in a hunting environment. Failure to follow these instructions may result in serious injury or death!

! WARNING! NEVER allow the full-body fall arrest harness lanyard/tether to get under your chin or around your neck. This poses a choking hazard that can lead to serious injury or death. Failure to follow these instructions may result in serious injury or death!

! WARNING! If your hunting location is unknown by anyone and communication efforts are unsuccessful, you must have a personal plan for self-recovery/escape should you experience a fall. Prolonged suspension in a full-body fall arrest harness can be fatal. It is important to exercise the legs by pushing against the tree or doing other forms of continuous leg exercises to avoid blood pooling while being suspended. Varying degrees of physical fitness may require different plans for self-recovery/escape the effects of prolonged suspension. Have a personal plan and practice it in the presence of a responsible adult before leaving the ground. No one escape/ rescue plan will work for every hunter, on every tree, in every circumstance. Only you can determine the best self-recovery/ escape plan for your hunting situation before leaving the ground. There is time to make a correct decision on what action to take if a fall occurs while wearing a full-body fall arrest harness. It is important to remember, **DO NOT PANIC.** Remain calm and implement your practiced rescue, relief and recovery plan. Hunt from the ground when a self-recovery/escape ability is absent. Failure to follow these instructions may result in serious injury or death!

FULL-BODY FALL ARREST HARNESS INSTRUCTIONS

! WARNING! READ THESE X-STAND™ TREESTANDS FULL-BODY FALL ARREST HARNESS INSTRUCTIONS CAREFULLY AND FOLLOW ALL THE INSTRUCTIONS! YOUR NEW FULL-BODY FALL ARREST HARNESS IS DESIGNED FOR A MAXIMUM CAPACITY (USER & EQUIPMENT) OF 300 POUNDS (136 KG). ADDITIONALLY, YOUR NEW FULL-BODY FALL ARREST HARNESS MUST BE REPLACED AFTER THREE (3) YEARS OF SERVICE! REPLACE YOUR HARNESS IMMEDIATELY SHOULD YOU EXPERIENCE A FALL WHILE WEARING IT.

! WARNING! You must use the X-Stand™ Treestand full-body fall arrest harness provided with this product or a harness that complies with ASTM standards. NOTE: You must store your full-body fall arrest harness out of direct sunlight and out of any other harsh environmental condition(s) that may adversely affect its performance. Failure to follow these instructions may result in serious injury or death!

STEP 1. Identify the main parts of the full-body fall arrest harness (see Fig. 1). Hold the full-body fall arrest harness by the tether loop ensuring the harness is upright and leg straps are hanging down. Straighten any parts that have become twisted. Insert arms through each shoulder strap. (see Fig. 2)

STEP 2. Feed the left leg strap between legs and thread through the bottom left waist loop. Repeat with the right leg strap, feeding between legs and through right waist loop. (see Fig. 3)

ATTENTION!! WHEN YOU SEE A "⚠️ WARNING!" BE SURE TO HEED THE MESSAGE! THE INFORMATION CONTAINED IN THESE MESSAGES CAN SAVE YOUR LIFE!!

STEP 3. Secure the two leg straps by threading the 3 bar buckle as shown in Figure 4. Tighten the leg straps snugly. **DO NOT** over tighten as this will cut off the circulation to your legs. The X-Stand™ Treestands full-body fall arrest harness should look like the one depicted in Figure 5 when done correctly. Note : If leg straps are too long, feed right leg strap with buckle through bottom of the right waist loop, down the top of the left waist loop and secure to left leg strap with 3 Bar Buckle as instructed.

⚠️ WARNING! It is very important to complete this Step of the assembly. Improperly secured buckle may cause full-body fall arrest harness failure resulting in serious injury or death! If there is not enough strap available to complete this step, **DO NOT USE THIS FULL-BODY FALL ARREST HARNESS!** You may need to purchase and use a larger specialty sized full-body fall arrest harness that complies with ASTM standards.

STEP 4. Once you have reached your desired height, insert the tree belt through the loop of the tether. (see Fig. 5) Then, carefully wrap the tree belt around the tree at a height that allows just enough slack for you to sit comfortably in your stand. Keeping the tether as short as possible limits the distance you will travel in the unlikely event you should experience a fall. To secure the tree belt insert free end up through the slot in the buckle closest to opposite end of the tree belt, then cross over the sliding mechanism and back down through opposite slot. Pull on strap to secure and test to make sure sliding mechanism engages creating secure strap placement. (see Fig. 6, 7, 8)

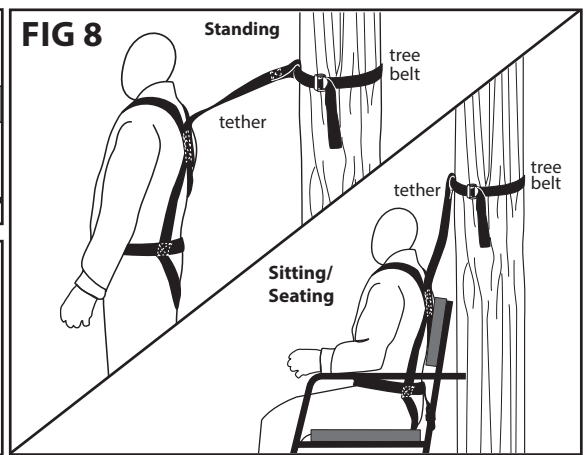
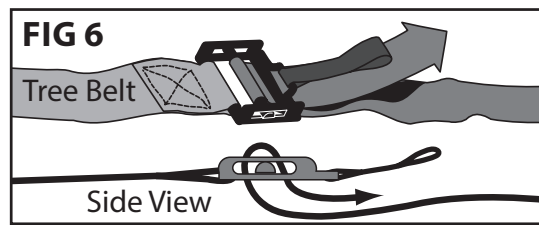
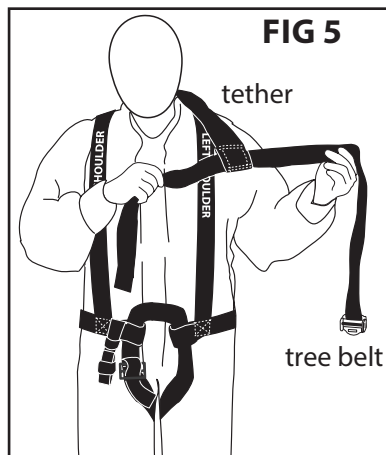
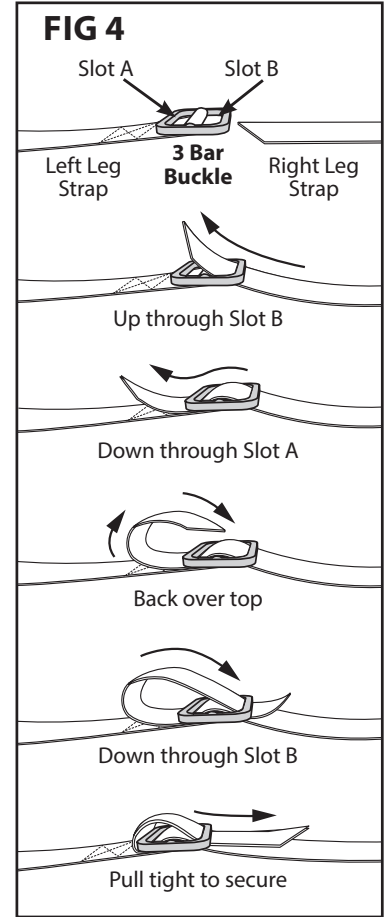
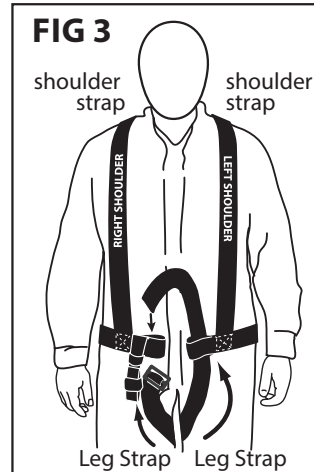
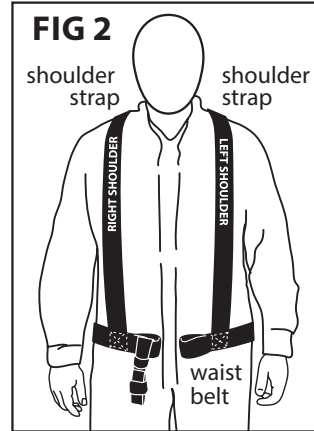
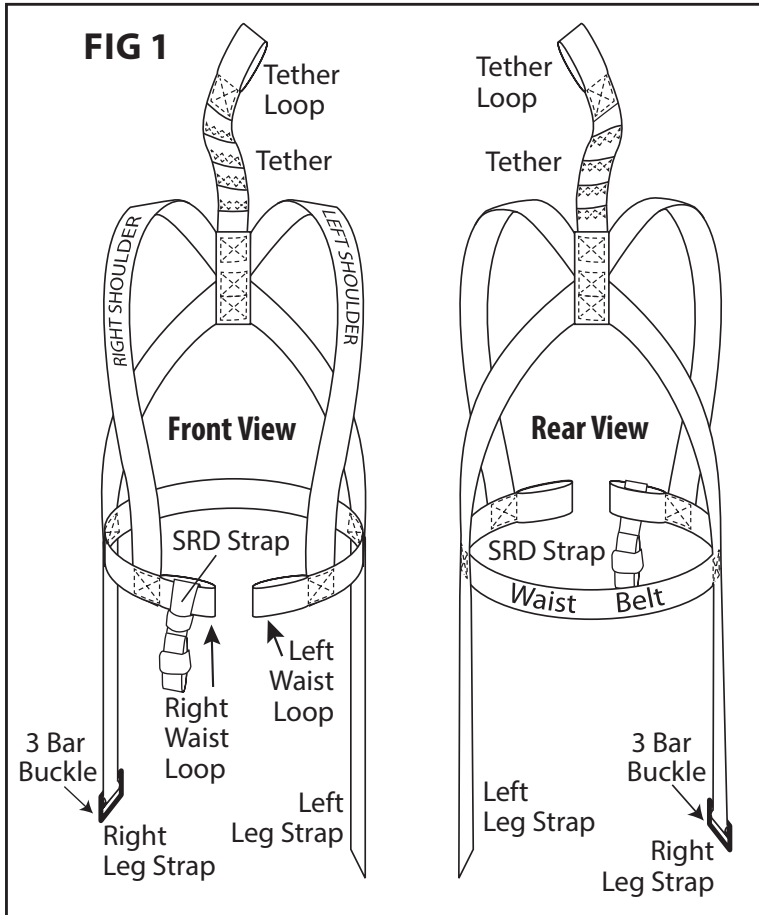

READ THIS MANUAL IN ITS ENTIRETY PRIOR TO USING THIS PRODUCT.

This instruction manual complies with ASTM F2337 Standard Test Method for Treestand Fall Arrest Systems.

**ATTENTION!! WHEN YOU SEE A “! WARNING!” BE SURE TO HEED THE MESSAGE!
THE INFORMATION CONTAINED IN THESE MESSAGES CAN SAVE YOUR LIFE!!**

STEPS TO FOLLOW IF A FALL WERE TO OCCUR:

Although no one plans to fall from their treestand, falls can and do occur without warning. It is important to become familiar with the guidelines below and practice your recovery plan at ground-level. Failure to read, understand, and follow these Steps may result in serious injury or death!

! WARNING! There is time to make a correct decision on what action to take if a fall occurs while wearing a full-body fall arrest harness. It is important **NOT TO PANIC!** Remain calm and implement your practiced rescue, relief and recovery plan. Failure to follow these instructions may result in serious injury or death!

! WARNING! A suspension relief device must be on your person and readily accessible while using a full-body fall arrest harness. This device will allow you to relieve the load on the lower extremities if suspended in a full-body fall arrest harness and help maintain circulation in the legs and mitigate suspension trauma (blood pooling). Follow all instructions below regarding the provided **SRD** (Suspension Relief Device) and **NEVER** remove it from your full-body fall arrest harness. Failure to follow this warning may result in serious injury or death!

STEP 1. After a fall, take a moment to catch your breath and stay calm; **DO NOT PANIC.**

STEP 2. Pull on the **SRD strap** located on the front side of your full-body fall arrest harness. (see Fig. 9)

STEP 3. Adjust the SRD strap so that you are able to step into the loop and then stand up relieving the pressure on your lower extremities. The loop size can be adjusted by moving the buckle up or down. (see Fig. 10 & 11)

STEP 4. If you are able to reach your ladder or climbing system, use it to get back into your secured treestand and then carefully climb down to ground-level. If you are not able to reach your stand, remain calm and continue to stand in the SRD loop until help arrives. (see Fig. 12)

STEP 5. Use your personal locating device or cell phone to call for help.

NOTE: Several optional commercial products/systems are available that offer self-recovery or self extraction from a fall when suspended in a full-body fall arrest harness. Some systems automatically descend the user while others allow user control. One of these products/systems can be considered for use as an additional safety precaution against prolonged suspension and suspension trauma. Be sure to follow the manufacturers' directions on the safe use of these products/systems.

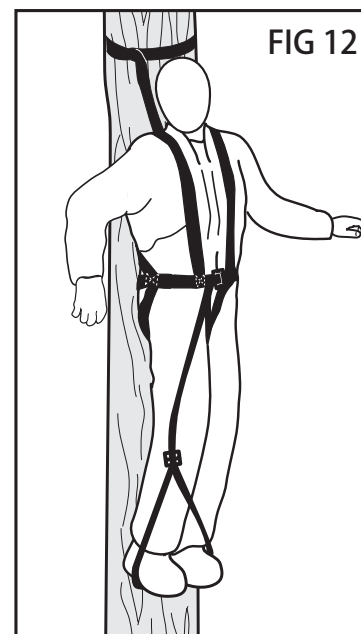
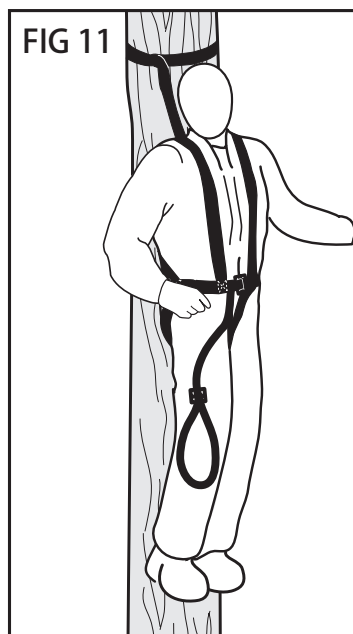
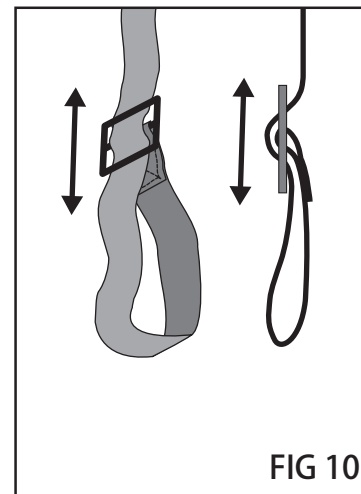
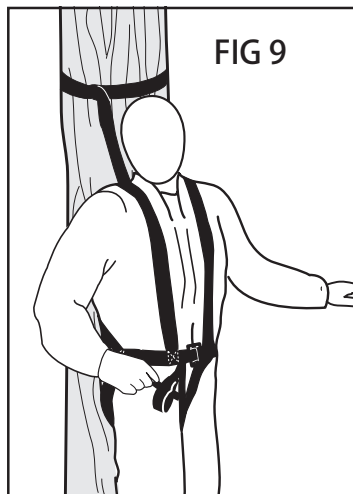

To activate your product's warranty, a registration card (found in the back of this manual) must be completed and returned to the manufacturer within 30 days of purchase.

Be sure to keep a copy of this card for your records.

Should you have any questions about the assembly, installation or use of this X-Stand product, or any other X-Stand products, please do not hesitate to call one of our customer service representatives at 540-877-2769 and they will answer all questions you may have about any of the complete line of X-Stand products.

**ATTENTION!! WHEN YOU SEE A “! WARNING!” BE SURE TO HEED THE MESSAGE!
THE INFORMATION CONTAINED IN THESE MESSAGES CAN SAVE YOUR LIFE!!**

THE DUKE- PARTS LIST

Part #	Description	Qty	Part #	Description	Qty
XP15-0500	Ladder Section D	1	XP15-0581	Ratchet Strap (A)	1
XP15-0503	Ladder Section C	1	XP15-0584	Ratchet Strap (B) Assembly	1
XP15-0506	Ladder Section B	1	XP15-0587	Ratchet Strap (C)	1
XP15-0506	Ladder Section A	1	XP15-0010	Full-Body Fall Arrest Harness	1
XP15-0509	Lower Bark Biter Tree Brace	2	XP15-0020	Safety DVD	1
XP15-0512	Lower Bark Biter Ladder Brace	2	XP15-0030	Instruction Manual for the Duke	1
XP17-0860	Left Top Ladder Extension	1	XP87-0003	5/16” x 3 1/2” Hex Bolt (A)	2
XP17-0858	Right Top Ladder Extension	1	XP87-0005	1/4” x 1 1/4” Hex Bolt (B)	1
XP15-0518	Left Side Frame	1	XP87-0007	1/4” x 1 1/2” Hex Bolt (C)	4
XP15-0521	Right Side Frame	1	XP87-0009	1/4” x 1 3/4” Hex Bolt (D)	2
XP15-0524	Left Backrest Support	1	XP87-0012	1/4” x 2” Hex Bolt (E)	2
XP15-0527	Right Backrest Support	1	XP87-0014	1/4” x 2 1/4” Hex Bolt (F)	2
XP15-0530	Armrest	2	XP87-0015	1/4” x 2 1/2” Hex Bolt (G)	2
XP15-0533	Left Shooting Rail Stop	1	XP87-0016	1/4” x 3 1/4” Hex Bolt (H)	2
XP15-0536	Right Shooting Rail Stop	1	XP87-0018	1/4” x 2 1/2” Carriage Bolt (I)	2
XP15-0539	Rear Frame Support	1	XP87-0020	1/4” Delta Bolt (J)	2
XP15-0542	Jaw	2	XP87-0023	1/4” Nylon Spacer (K)	2
XP15-0545	Footrest	1	XP87-0025	3/8” Nylon Spacer (L)	2
XP15-0548	Seat Assembly	1	XP87-0027	Nylon Washer	40
XP15-0551	Foot Platform	1	XP87-0029	1/4” Nylock Nut	14
XP15-0554	Left Shooting Rail Piece	1	XP87-0032	1/4” Wiz Nut (M)	1
XP15-0557	Right Shooting Rail Piece	1	XP87-0034	1/4” Delta Nut (N)	2
XP15-0560	Shooting Rail Foam	1	XP87-0036	Snap Pins	10
XP15-0563	Shooting Rail Cover	1	XP87-0038	1/4” Wing Nut (O)	2
XP15-0566	Armrest Foam	2	XP87-0040	Allen Wrench	1
XP15-0569	Armrest Cover	2	XP87-0043	Seat Tension Bolt	1
XP15-0572	Accessory Hooks	2	XP87-0045	1/4” x 4 1/4” Eye Bolt (P)	2
XP15-0575	Drink Holder	1	XP87-0047	5/16” Nylock Nut (q)	4
XP15-0578	Jaw Tightening Cable	2			

READ THIS MANUAL IN ITS ENTIRETY PRIOR TO USING THIS PRODUCT.

This instruction manual complies with ASTM F2123 Standard Practice for Treestand Instruction.

THE DUKE - HARDWARE DIAGRAM

NOTE: Part illustrations are for reference purposes only, and may not be to actual size.



[A] 5/16"X3 1/2" Hex Bolt {2 Pieces}



[H] 1/4"X3 1/4" Hex Bolt {2 Pieces}

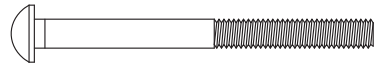

[I] 1/4"X2 1/2" Carriage Bolt {2 Pieces}

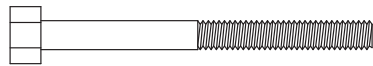

[F] 1/4"X2 1/4" Hex Bolt {2 Pieces}

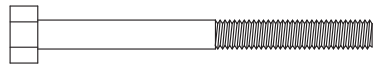

[G] 1/4"X2 1/2" Hex Bolt {2 Pieces}

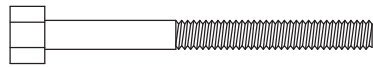

[E] 1/4"X2" Hex Bolt {2 Pieces}

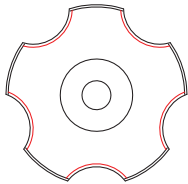

[J] 1/4"Delta Bolt {2 Pieces}

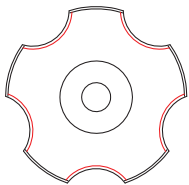

[N] 1/4"Delta Nut {2 Pieces}

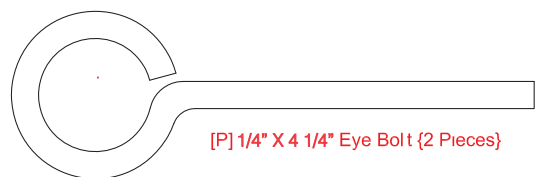

[P] 1/4" X 4 1/4" Eye Bolt {2 Pieces}

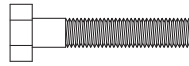

[C] 1/4"X1 1/2" Hex Bolt {4 Pieces}

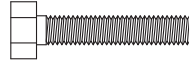

[B] 1/4"X1 1/4" Hex Bolt {1 Piece}

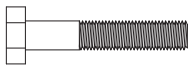

[D] 1/4"X1 3/4" Hex Bolt {2 Pieces}



1/4"Nylock Nut {14 Pieces}



[Q] 5/16" Nylock Nut {4 Pieces}

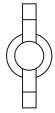

[O] 1/4"Wing Nut {2 Pieces}



[M] 1/4" Wiz Nut{1 Piece}



Nylon Washer {40 Pieces}



[L] 3/8"Nylon Spacer {2 Pieces}



[K] 1/4"Nylon Spacer {2 Pieces}

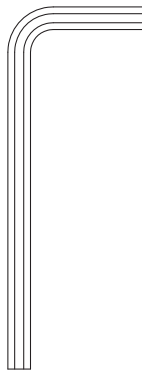

Allen Wrench{1 Piece}

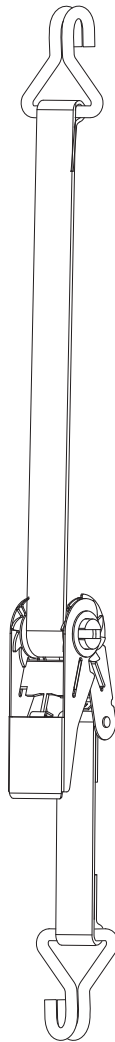

Ratchet Strap - A

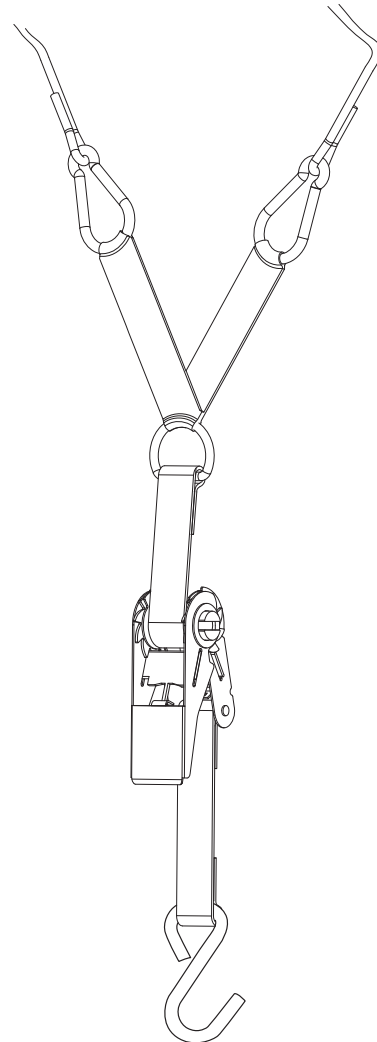

Ratchet Strap - B

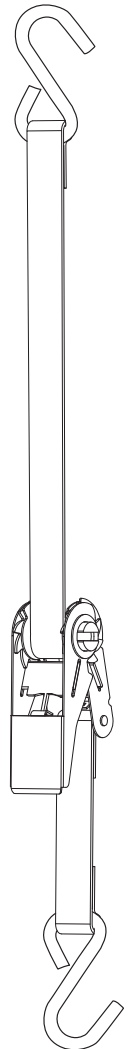

Ratchet Strap - C

NOTE: Steps 1-7 require you temporarily finger tighten nuts to insure proper alignment.

ASSEMBLY INSTRUCTIONS

- THE DUKE -

FIGURE 1

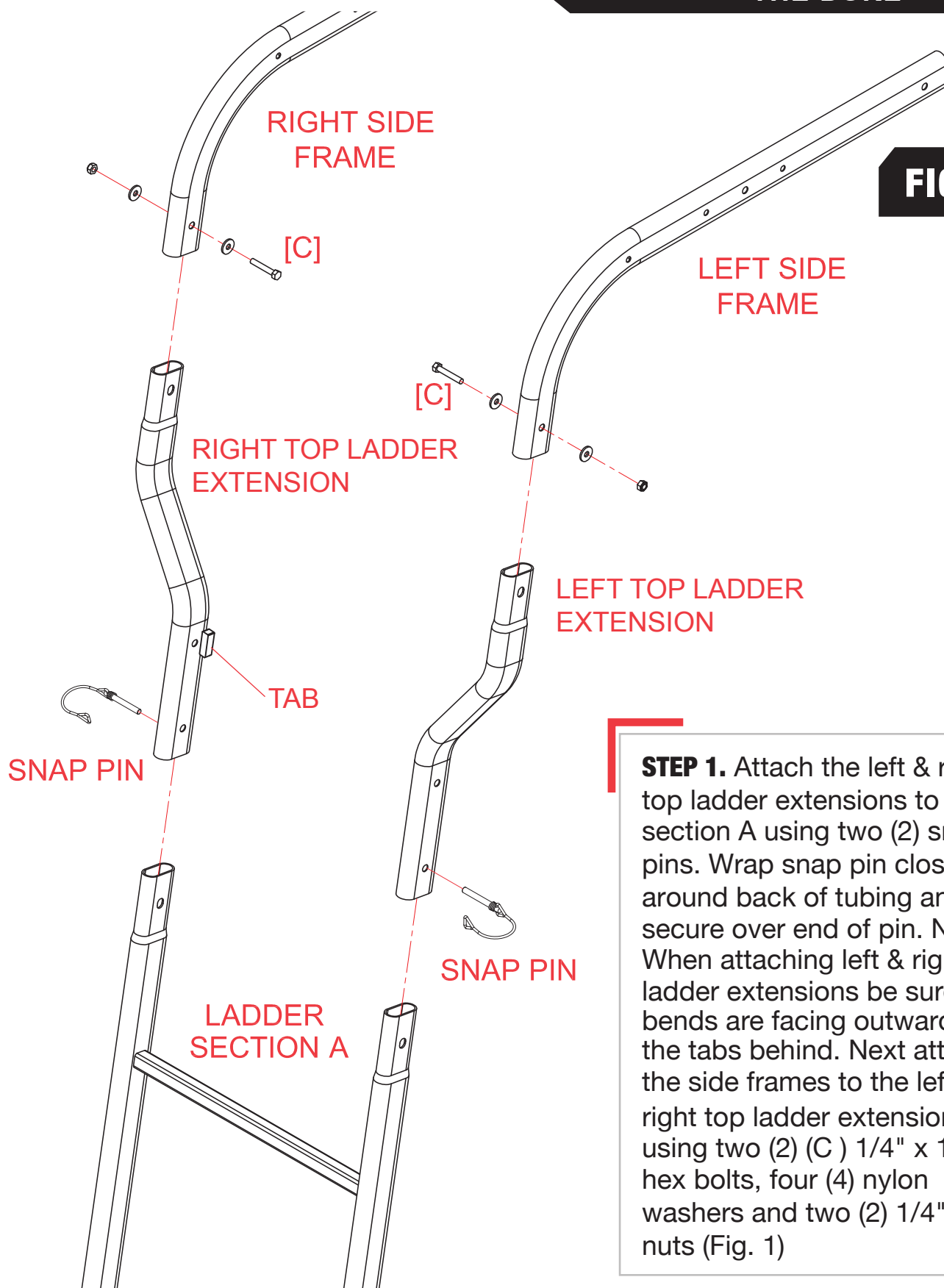

STEP 1. Attach the left & right top ladder extensions to ladder section A using two (2) snap pins. Wrap snap pin closure around back of tubing and secure over end of pin. Note: When attaching left & right top ladder extensions be sure the bends are facing outward and the tabs behind. Next attach the side frames to the left & right top ladder extensions using two (2) (C) 1/4" x 1 1/2" hex bolts, four (4) nylon washers and two (2) 1/4" nylock nuts (Fig. 1)

READ THIS MANUAL IN ITS ENTIRETY PRIOR TO USING THIS PRODUCT.

This instruction manual complies with ASTM F2123 Standard Practice for Treestand Instruction.

STEP 2. Slide the left and right shooting rail stops over the front of the armrests and secure using two (2) (J) 1/4" Delta bolts. Next insert (I) 1/4" x 2 1/4" carriage bolts in top hole in rear of armrest facing outward (Fig. 2)

WARNING! Armrests are provided for comfort and should be used as armrests only. The armrests are not designed to carry the full weight of the user. Never place more than fifteen (15) lbs of force on the armrests. Failure to follow these instructions may result in serious injury or death!

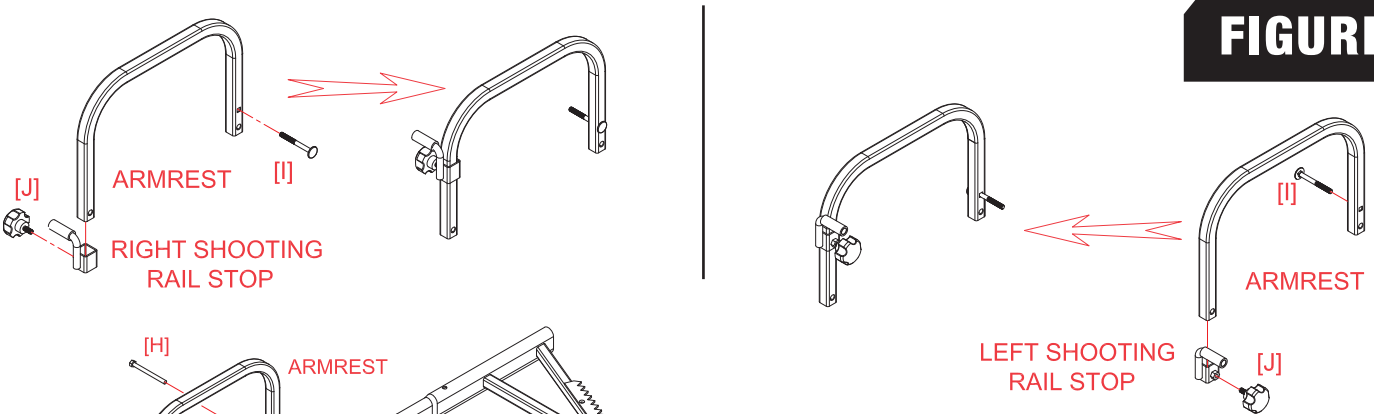

FIGURE 2

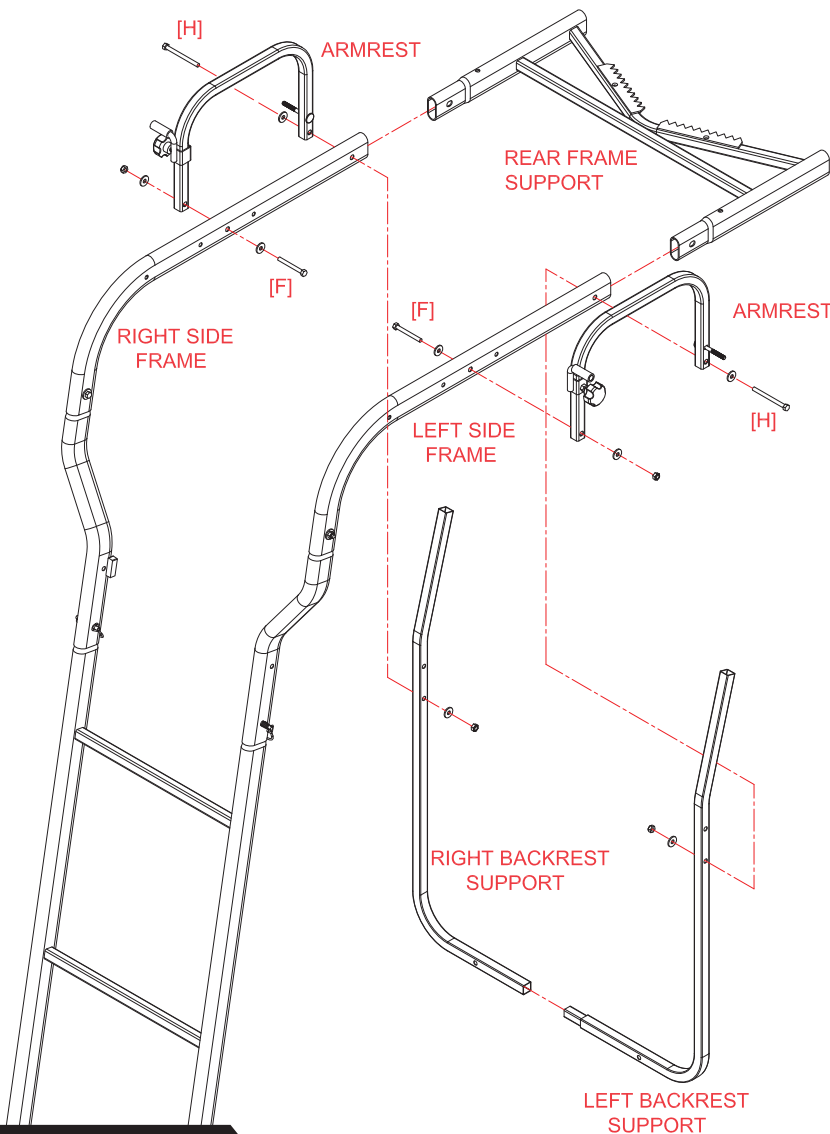
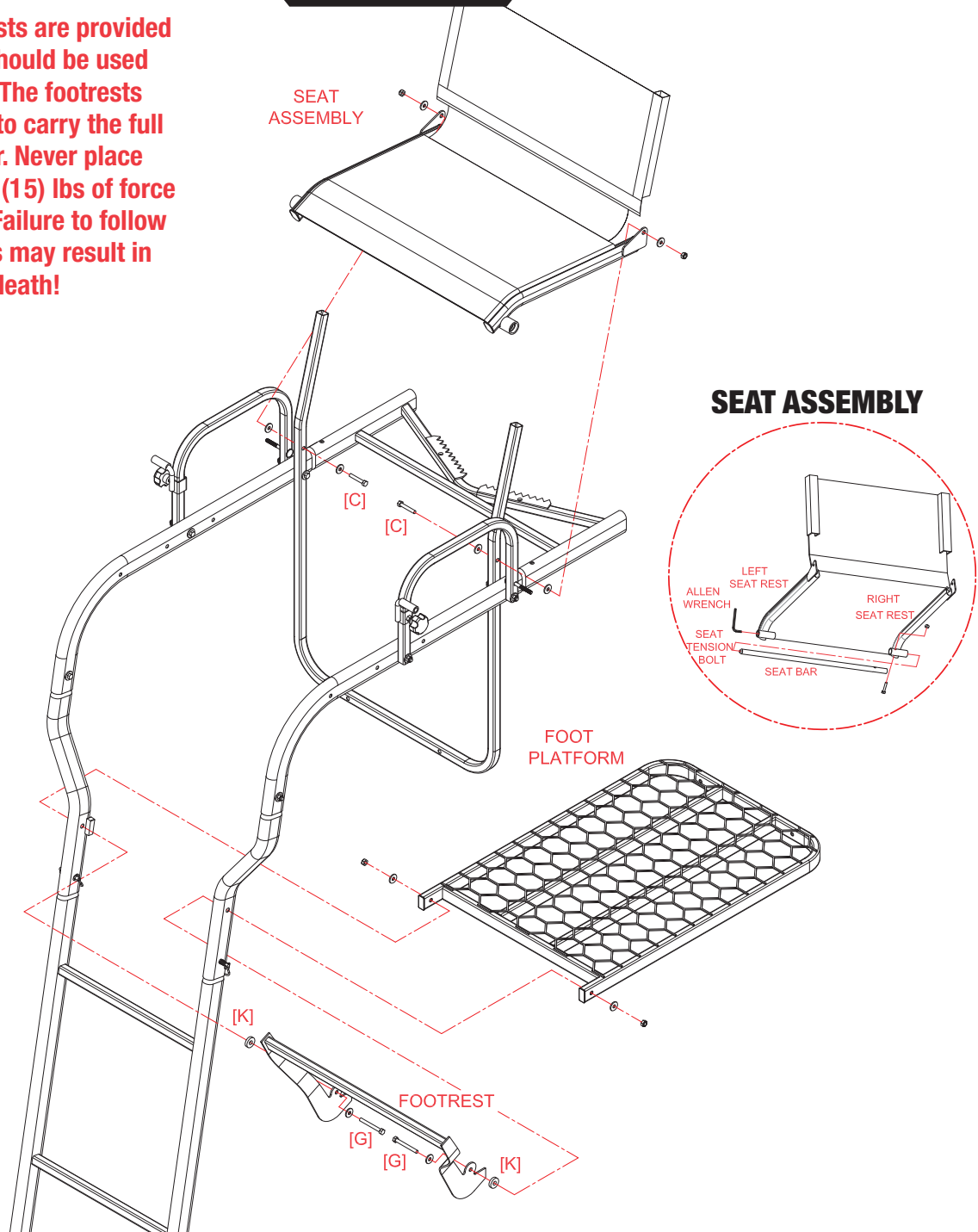

FIGURE 3

STEP 3. Insert the rear frame support into the side frame aligning holes. Next connect the left and right backrest supports, then attach the assembled backrest support to the side frames and armrests using two (2) (H) 1/4" x 3 1/4" Hex bolts, four (4) Nylon washers and two (2) Nylock nuts. Note: the lower holes are used in the armrests and back support. The bends of the backrest are to angle to the rear. (Fig. 3) Next attach the front of the armrests to the outside of the side frames using two (2) (F) 1/4" x 2 1/4" Hex bolts, four (4) Nylon washers and two (2) Nylock nuts. (Fig. 3)

FIGURE 4

WARNING! Footrests are provided for comfort and should be used as footrests only. The footrests are not designed to carry the full weight of the user. Never place more than fifteen (15) lbs of force on the footrests. Failure to follow these instructions may result in serious injury or death!



STEP 4. Attach the footrest and the foot platform to the top ladder extensions using two (2) (G) 1/4"x 2 1/2" Hex bolts, four (4) Nylon washers, two (2) (K) 1/4" Nylon spacers and two (2) 1/4" Nylock nuts. Next sleeve the backrest of the seat assembly over the backrest support. Then attach the seat assembly to the backrest support using two (2) (C) 1/4" x 1 1/2" Hex bolts, six (6) Nylon washers and two (2) 1/4" Nylock nuts (Fig. 4) (Use the allen wrench to tighten the seat tension bolt as needed)

READ THIS MANUAL IN ITS ENTIRETY PRIOR TO USING THIS PRODUCT.

This instruction manual complies with ASTM F2123 Standard Practice for Treestand Instruction.

FIGURE 5

WARNING! Shooting rail is provided for comfort and should be used as a shooting rail only. The shooting rail is not designed to carry the full weight of the user. Never place more than fifteen (15) lbs of force on the shooting rail. Failure to follow these instructions may result in serious injury or death!

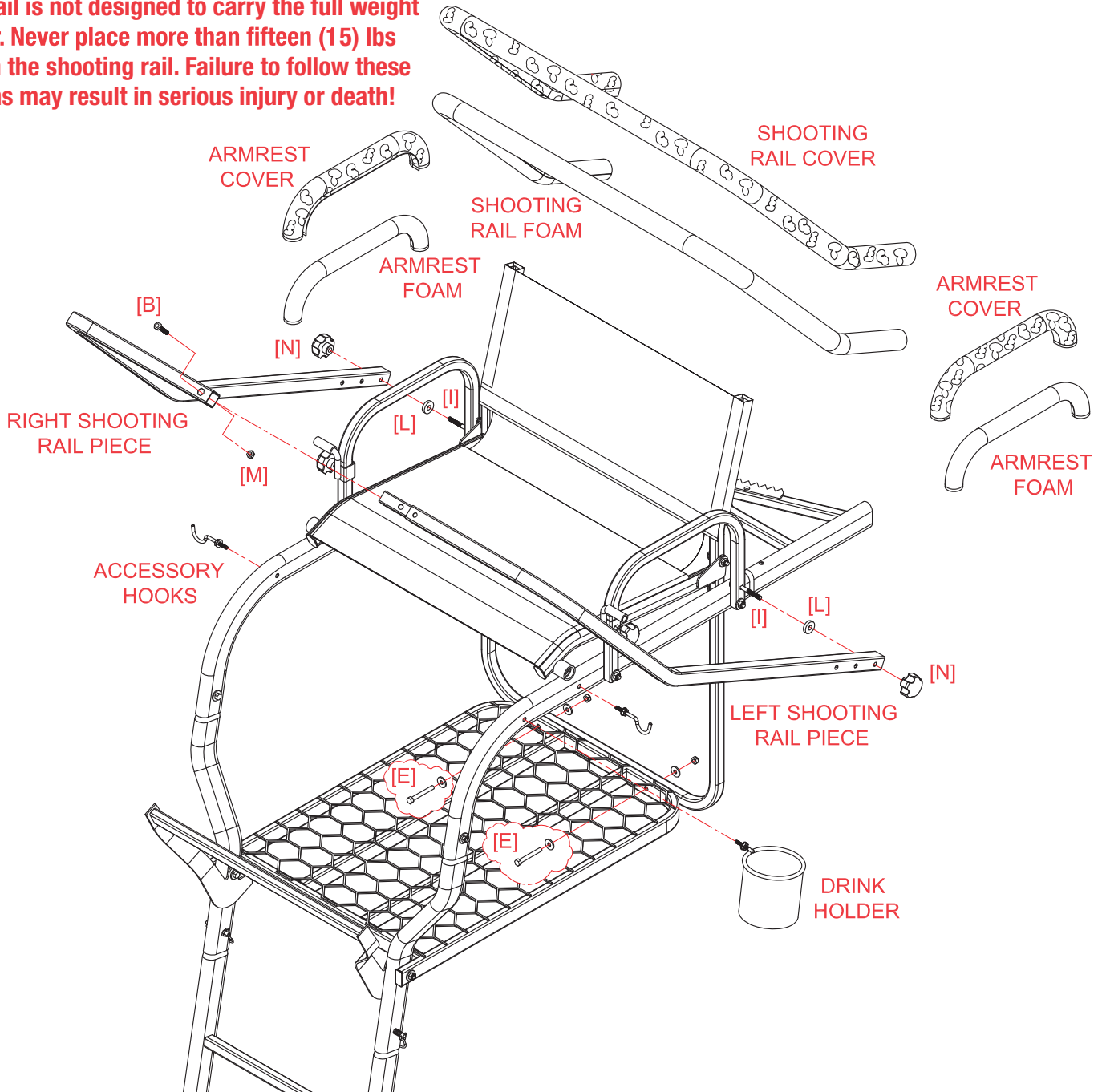

STEP 5. Connect the left and right shooting rails using one (1) (B) 1/4" x 1 1/4" Hex bolt and one (1) (M) 1/4" Wiz nut. Attach the assembled shooting rail to the outside of the armrests using two (2) (I) 1/4" x 2 1/2" carriage bolts (already installed) two (2) (L) 3/8" Nylon spacers and two (2) (N) 1/4" Delta nuts. Next attach the backrest support to the rear of the foot platform using two (2) (E) 1/4" x 2" Hex bolts, four (4) Nylon washers and two (2) 1/4" Nylock nuts (Fig. 5)

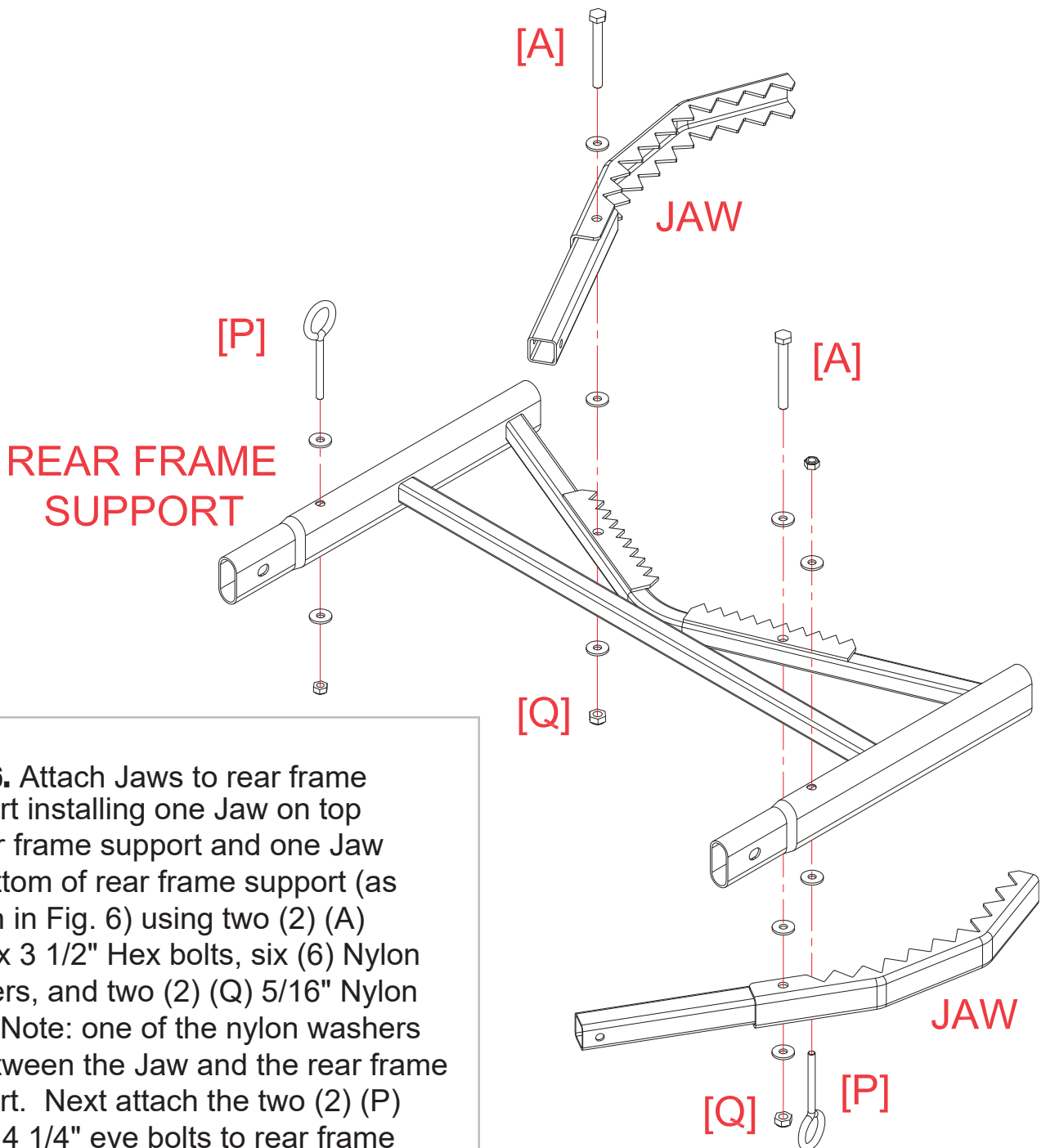
FIGURE 6

STEP 6. Attach Jaws to rear frame support installing one Jaw on top of rear frame support and one Jaw on bottom of rear frame support (as shown in Fig. 6) using two (2) (A) 5/16" x 3 1/2" Hex bolts, six (6) Nylon washers, and two (2) (Q) 5/16" Nylon nuts. Note: one of the nylon washers go between the Jaw and the rear frame support. Next attach the two (2) (P) 1/4" x 4 1/4" eye bolts to rear frame support, one (1) (P) eye bolt, two (2) nylon washers (on top & bottom of eye bolt) and one (1) 1/4" Nylock nut on top matching top Jaw and one (1) (P) eye bolt, two (2) nylon washers (one top & bottom of eye bolt) and one (1) 1/4" Nylock nut on bottom matching bottom Jaw (Fig. 6)

FIGURE 7

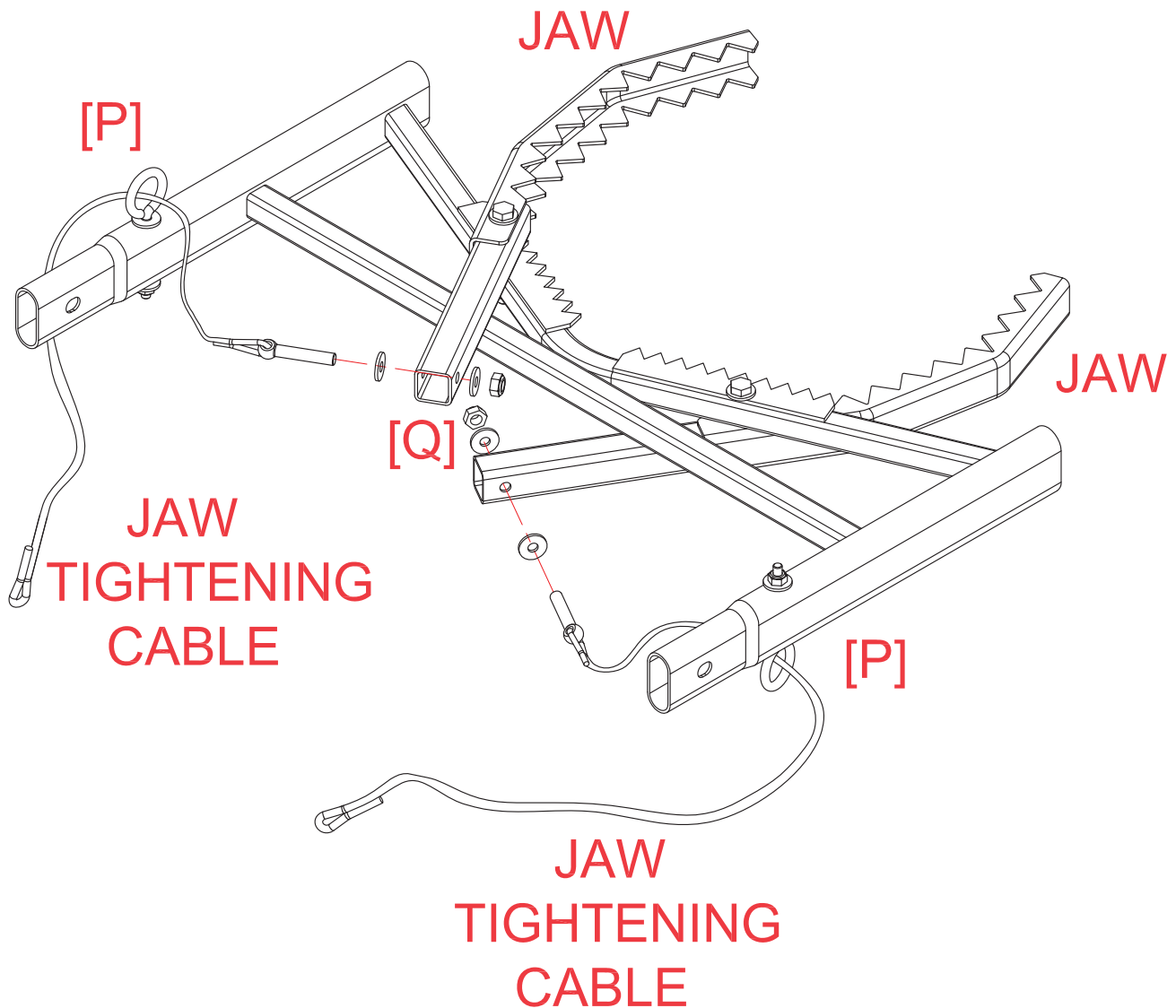

STEP 7. String one (1) Jaw tightening cable with eyelet bolt loop end first thru (P) 1/4"x4 1/4" eye bolt, attach eyelet bolt end of cable to top Jaw using two (2) Nylon washers and one (1)(Q) 5/16" Nylock Nut and repeat for bottom Jaw using second cable and two (2) Nylon washers and one (1)(Q) 5/16" Nylock Nut (Fig. 7)

STEP 8. Securely tighten every nut and bolt at this time.

Step 9. Attach the shooting rail foam and cover and the armrest foam and covers. Install accessory hooks and drink holder in desired locations. (Fig. 5)

STEP 1. Select a straight, healthy tree; one devoid of dead branches and loose bark. **DO NOT** attempt to install this product on a tree that is not healthy.

FIELD INSTALLATION - THE DUKE -

FIGURE 8

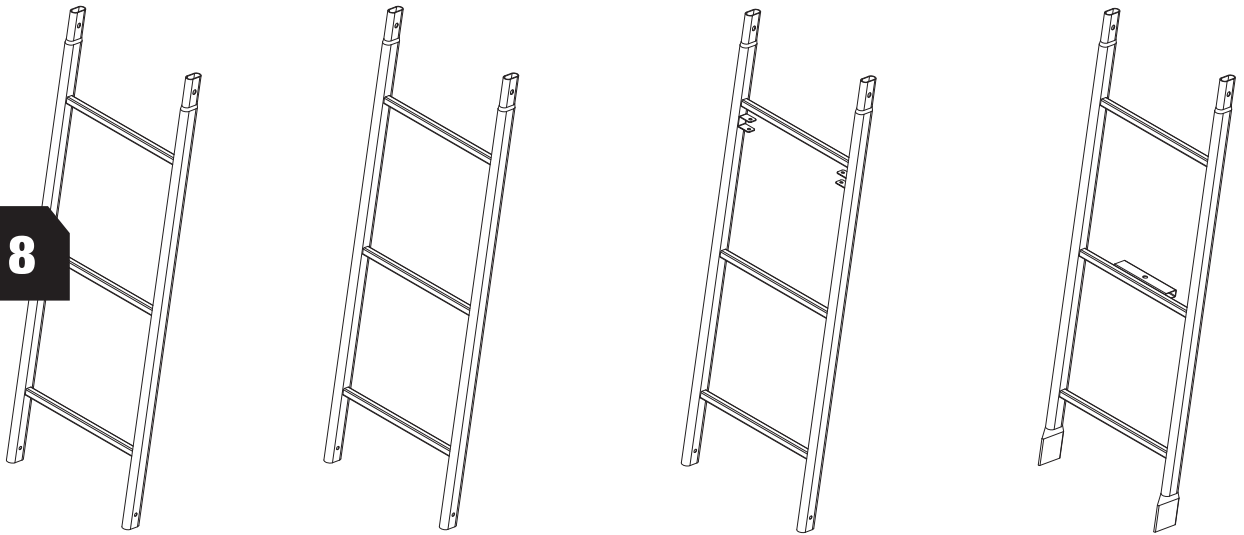

LADDER SECTION A LADDER SECTION B

LADDER SECTION C

LADDER SECTION D

Note: Ladder Sections A and B are identical

⚠ WARNING! DO NOT attempt to install this product on a tree that is not straight, healthy, and devoid of dead branches, limbs, vines, or anything that might interfere with the installation. DO NOT attempt to install this treestand on a tree that is leaning, diseased, crooked, has loose bark, or does not meet the minimum installation diameter of nine (9) inches (23 cm) at treestand height (i.e. seating platform height) or exceeds the maximum installation diameter of twenty (20) inches (51 cm) at treestand height (i.e. seating platform height).

Failure to follow these instructions may result in injury or death!

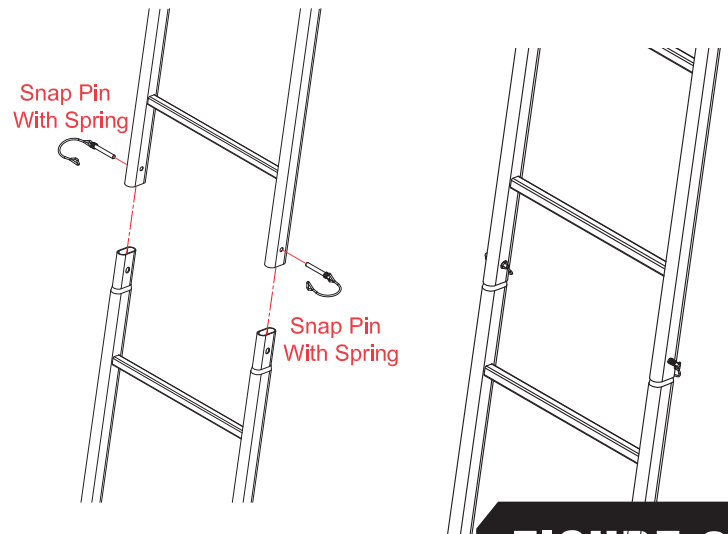

Install the snap pins from the outside in.

FIGURE 9

STEP 2. Assemble ladder sections to the main section. Each ladder section has slight design differences and need to be assembled in the proper order for correct installation. The ladder sections are labeled ladder section A, ladder section B, ladder section C, and ladder section D (Fig. 8). After assembling the ladder, insert snap pins in every joint, wrapping the closure around back of tubing and securing over end of pin.(Fig. 9)

READ THIS MANUAL IN ITS ENTIRETY PRIOR TO USING THIS PRODUCT.

This instruction manual complies with ASTM F2123 Standard Practice for Treestand Instruction.

FIGURE 10

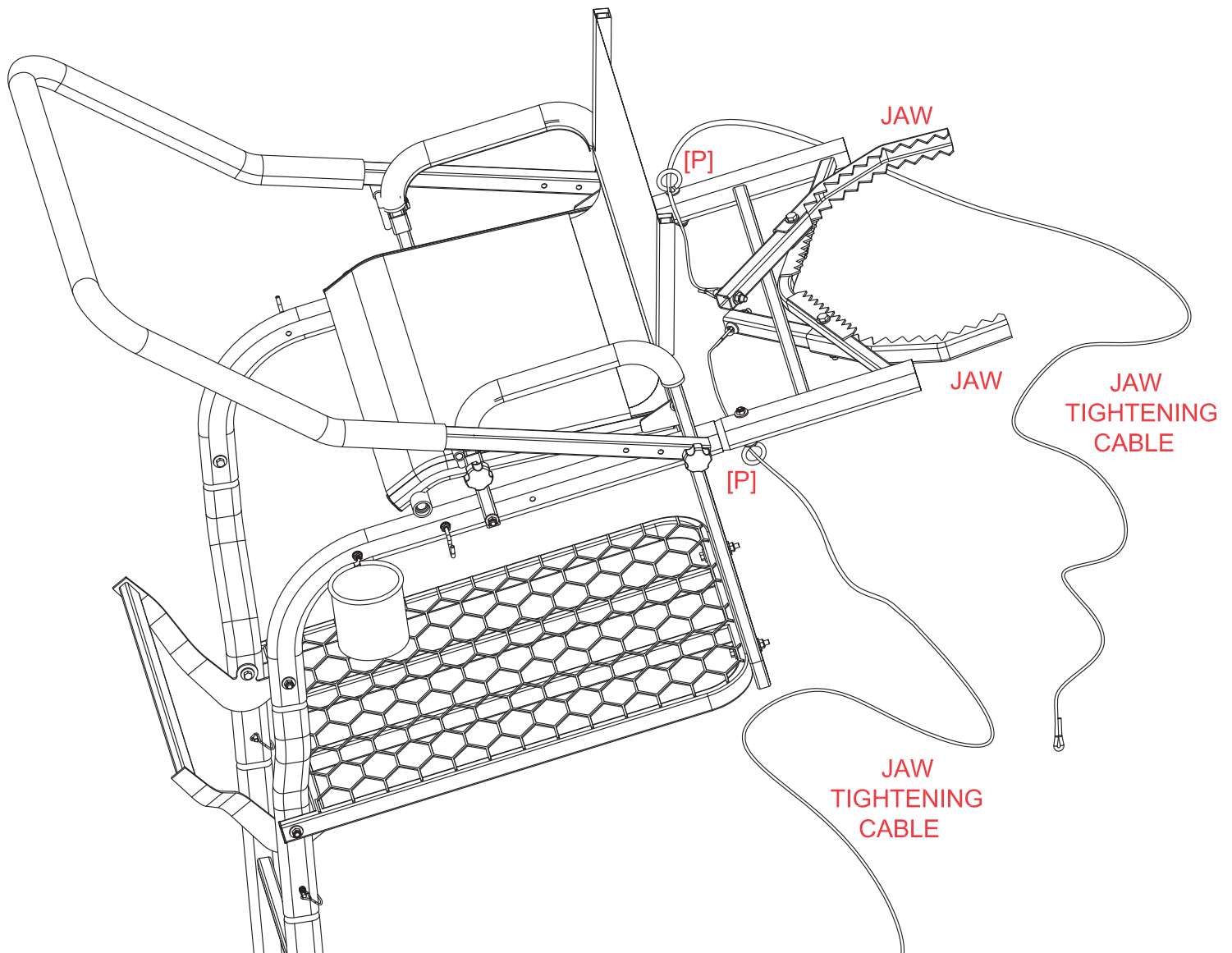

NOTE: Confirm the two (2) Jaws are in the fully open position and the Jaw tightening cables are run properly through the cable guide eye bolts. The extra cable length should be lying on the ground next to the ladderstand, and free from tangles or knots.

STEP 3. Confirm that the two (2) Jaw tightening cables are attached to each Jaw and run through the cable guide eye bolts properly (Fig. 10).

STEP 4: Place the ladderstand flat on the ground in front of the tree with the bottom ladder section (D) approximately three (3) feet away from the base of the trunk (Fig. 11).

NOTE: The bottom ladder section is specially designed to allow the bottom to drive into the ground. This is part of normal installation. Check again to ensure seating and standing platforms are parallel with the ground.

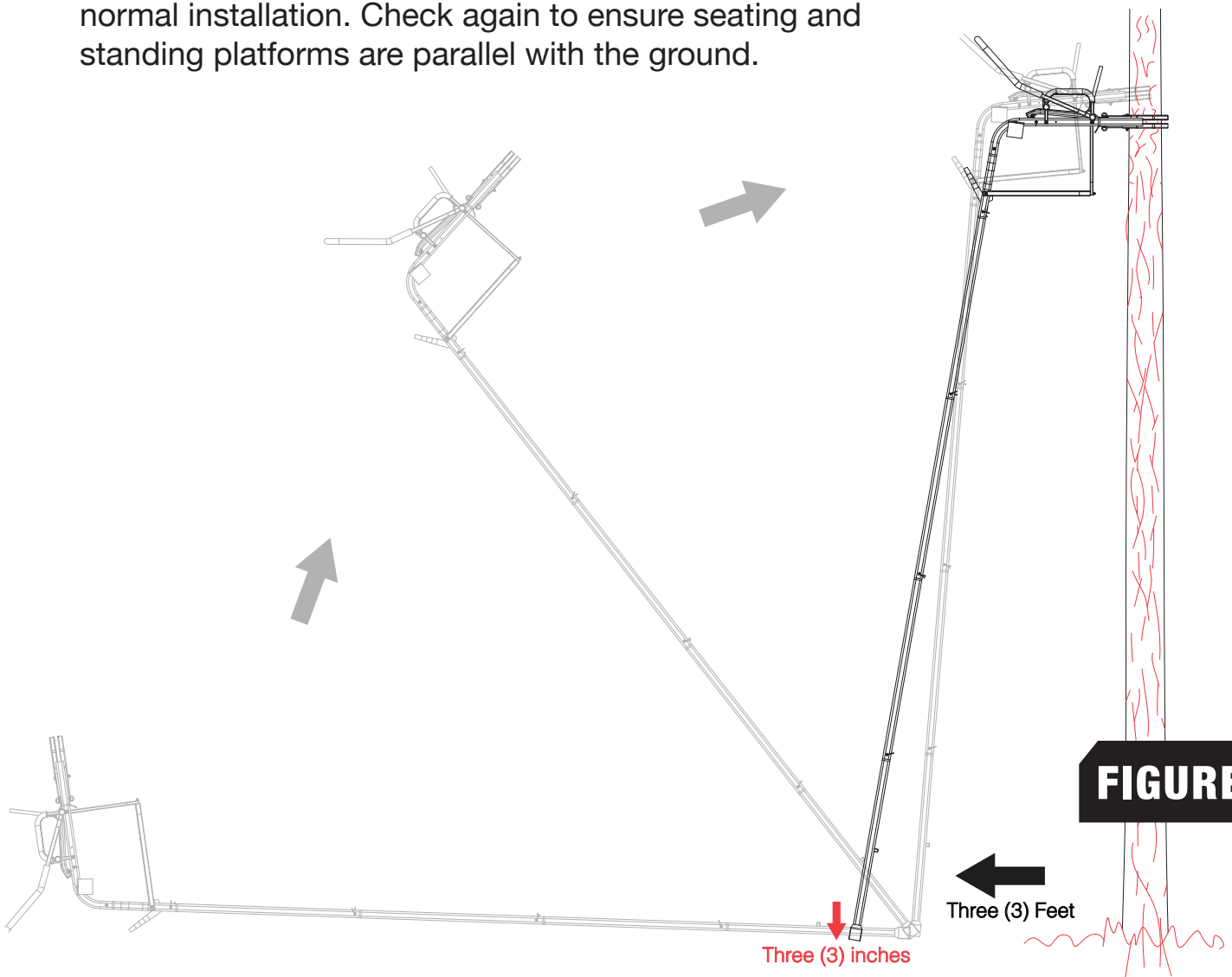

STEP 5. With at least three (3) adults, gently raise the ladderstand to a vertical position allowing the bark biters on the rear frame support to come in direct contact with the tree.

STEP 6: Once elevated completely, carefully pull the base away from the tree until the seating and standing platforms are parallel to the ground. (Fig. 11) Bounce on the bottom ladder section rung to set the ladder into the ground at least three (3) inches deep.

NOTE: Repeat Step 6 if the treestand needs additional adjustment to make the seating and standing platforms parallel with the ground.

READ THIS MANUAL IN ITS ENTIRETY PRIOR TO USING THIS PRODUCT.

This instruction manual complies with ASTM F2123 Standard Practice for Treestand Instruction.

FIGURE 12

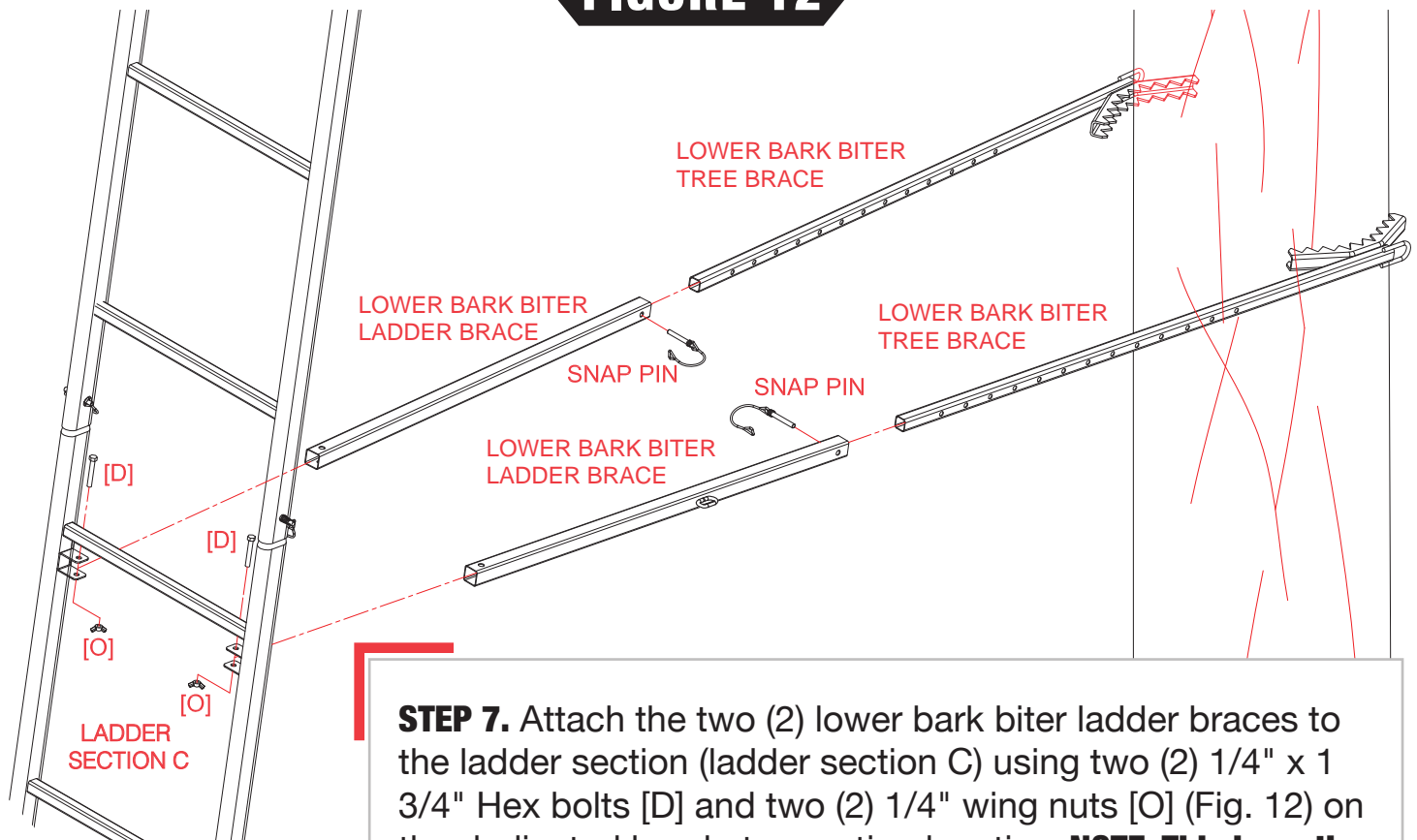

STEP 7. Attach the two (2) lower bark biter ladder braces to the ladder section (ladder section C) using two (2) 1/4" x 1 3/4" Hex bolts [D] and two (2) 1/4" wing nuts [O] (Fig. 12) on the dedicated bracket mounting location. **NOTE: This is on the second ladder section up from the ground.**

FIGURE 13

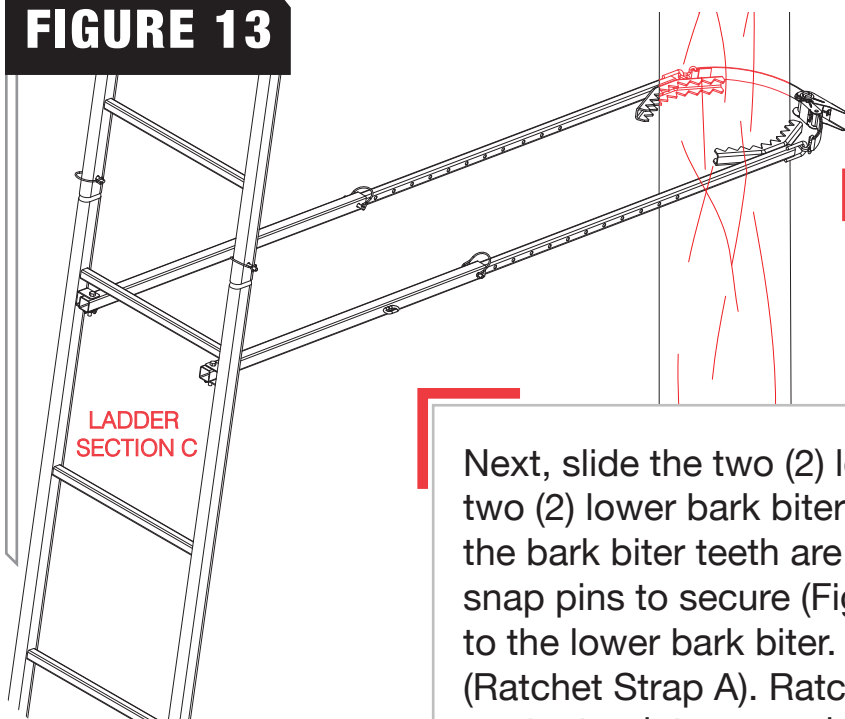

RATCHET STRAP A

Next, slide the two (2) lower bark biter tree braces into the two (2) lower bark biter ladder braces. Adjust the length so the bark biter teeth are hitting the tree evenly and install the snap pins to secure (Fig. 11). Then, attach the ratchet strap to the lower bark biter. This ratchet strap will be labeled (Ratchet Strap A). Ratchets are attached to the dedicated contact points on each lower bark biter. (Fig. 13) Carefully tighten the ratchet strap securely.

FIGURE 14

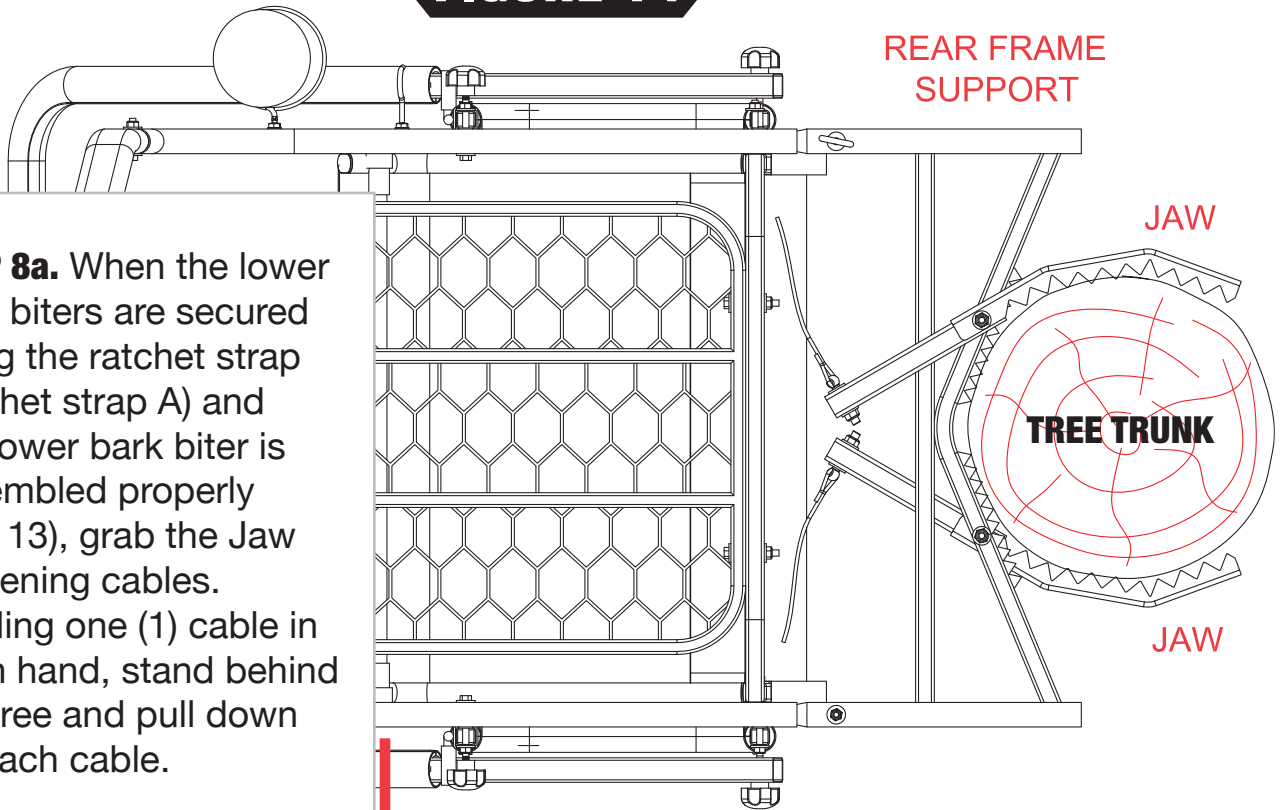

STEP 8a. When the lower bark biters are secured using the ratchet strap (ratchet strap A) and the lower bark biter is assembled properly (Fig. 13), grab the Jaw tightening cables. Holding one (1) cable in each hand, stand behind the tree and pull down on each cable.

NOTE: While doing Step 8 you will be able to visibly see the Jaws moving to the point the Jaw bark biters touch the tree. (Fig 14).

JAW BARK BITERS TOUCH THE TREE

FIGURE 15

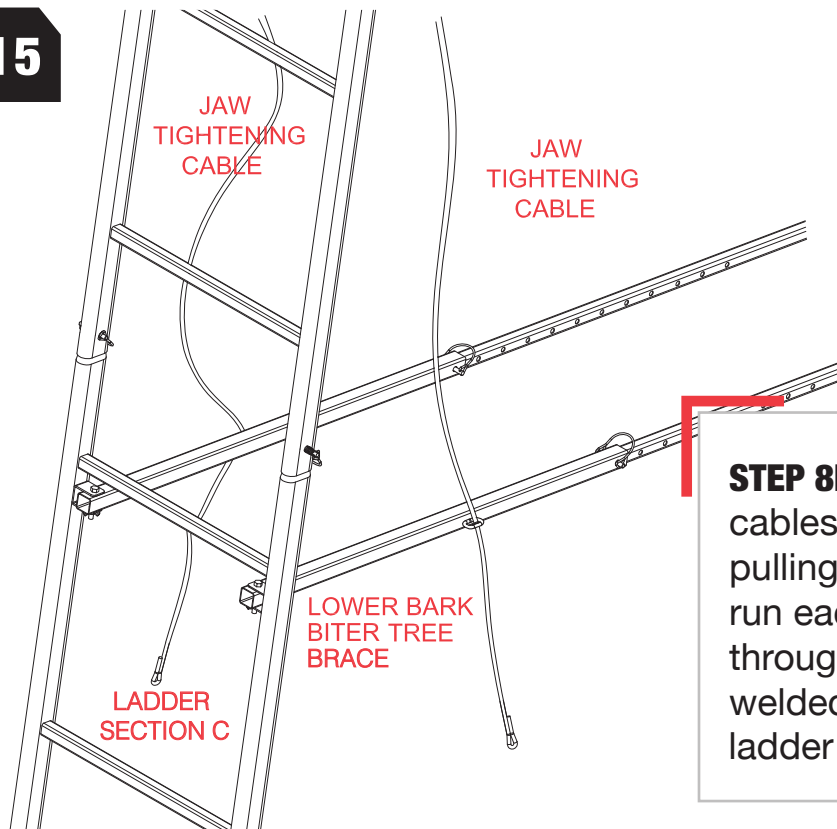

NOTE: Make sure the Jaws contact the tree evenly and are not obstructed by knots, branches, etc.

STEP 8b. Criss-cross the cables behind the tree trunk pulling snug. (Fig. 17) Then run each Jaw tightening cable through the eyelets that are welded to the lower bark biter ladder braces. (Fig. 15)

READ THIS MANUAL IN ITS ENTIRETY PRIOR TO USING THIS PRODUCT.

This instruction manual complies with ASTM F2123 Standard Practice for Treestand Instruction.

NOTE: Your lower bark biters should be firmly gripping the tree at this time, and the Jaws should be firmly gripping the tree. Shake the bottom ladder section of your ladderstand to confirm the treestand is solid and connected to the tree firmly. Make sure all straps are tight before each use.

FIGURE 16

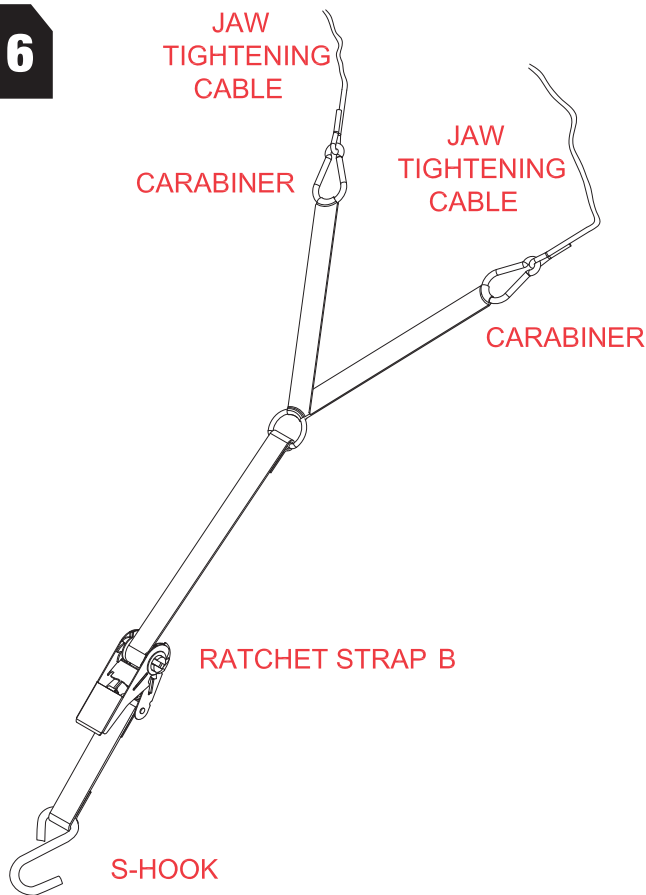

STEP 9. Once the Jaw tightening cables are criss-crossed around the back of the tree and run through the eyelets on the lower bark biter ladder pieces, then attach the two (2) Jaw tightening cables to the two (2) carabiners on ratchet strap B assembly (Fig. 15). Next, attach the S-hook on the opposite end of the ratchet strap to the dedicated location on the bottom ladder section (Fig. 16). Carefully tighten the ratchet strap (ratchet strap B) until stand is secure.

VITAL RATCHET INSTRUCTIONS

STEP 1. Thread strap through slot in the center of the ratchet reel. (see fig. 1) Remove slack from strap by pulling loose end as tightly as possible. (see fig. 2)

STEP 2. Then ratchet handle back and forth to tighten straps, a minimum of two (2) wraps around the ratchet reel is required. (see fig. 3)

STEP 3. After strap is tight, close handle to the lock position.

STEP 4. To remove tension, pull spring loaded retaining lock and open ratchet completely, then manually pull strap to loosen. (see fig. 4)

FIGURE 1

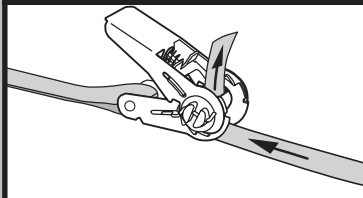

FIGURE 2

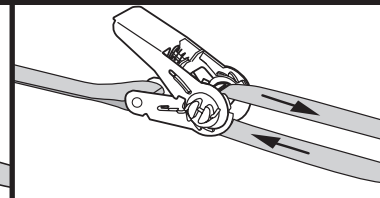

FIGURE 3

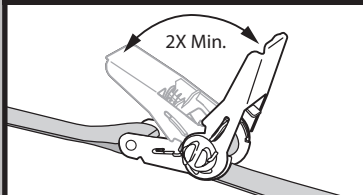

FIGURE 4

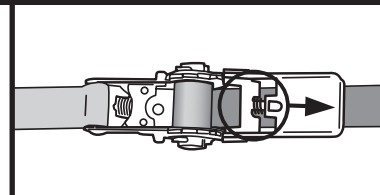
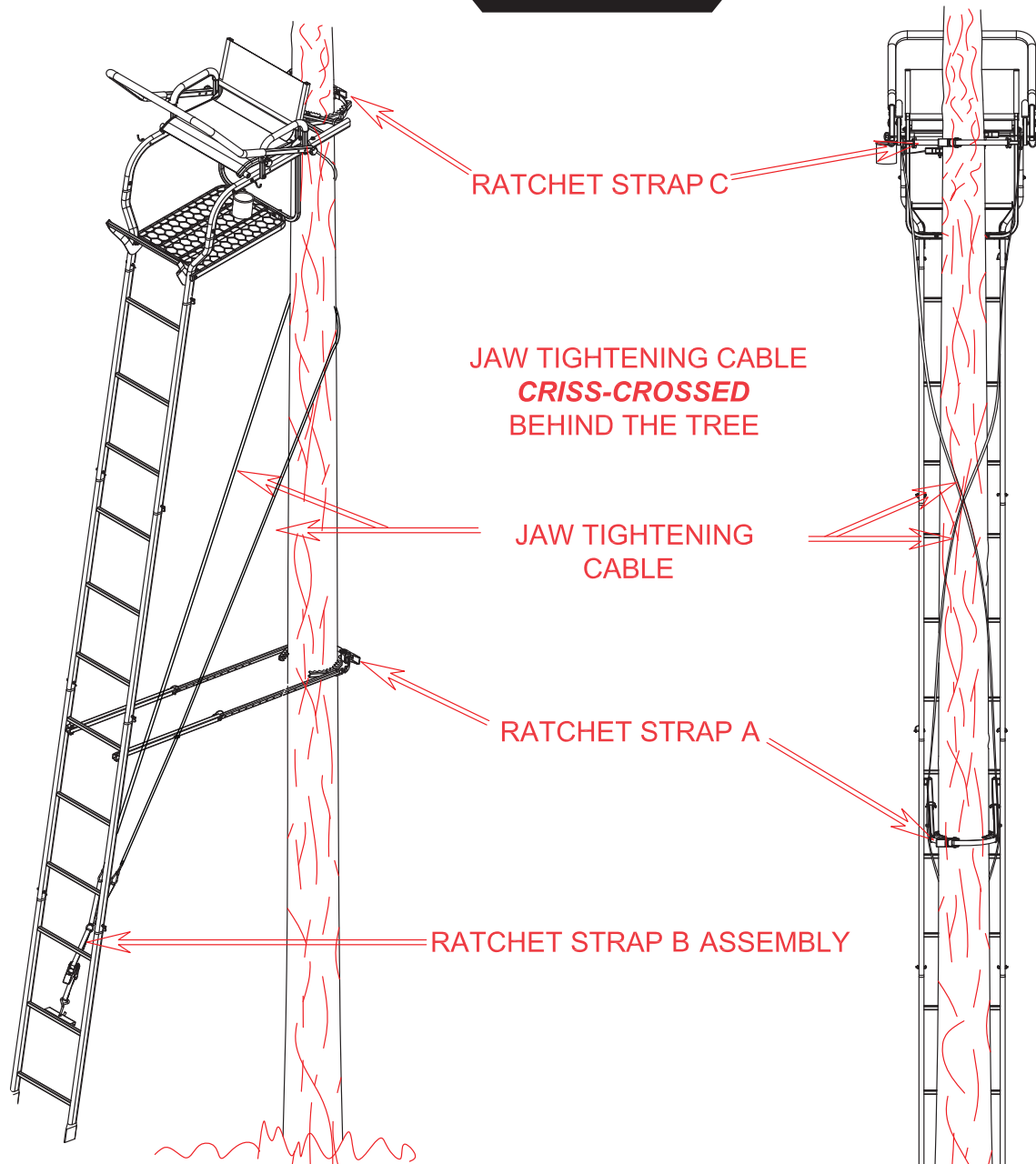

FIGURE 17



STEP 10. After the lower bark biters are secured by the ratchet strap (ratchet strap A), the lower bark biter is assembled properly, and the Jaws are tightened using the ratchet strap (B) assembly, it is now time to attach the platform ratchet strap (ratchet strap C) to the top section of your ladder stand. Ratchet straps are attached at the contact point from the stand to the tree (Fig. 17). Once at platform level hook one end of the ratchet strap to the treestand location shown in (Fig. 17), wrap the strap around the tree trunk, and connect to opposite side (Fig. 17). Carefully tighten the ratchet strap (ratchet strap C) securely.

STEP 11: You are now ready to use your ladder stand!

READ THIS MANUAL IN ITS ENTIRETY PRIOR TO USING THIS PRODUCT.

This instruction manual complies with ASTM F2123 Standard Practice for Treestand Instruction.



ATTENTION!! WHEN YOU SEE A "WARNING!" BE SURE TO HEED THE MESSAGE! THE INFORMATION CONTAINED IN THESE MESSAGES CAN SAVE YOUR LIFE!!

LADDERSTAND WARNINGS & PRODUCT REGISTRATION

WARNING! The (2) jaw tightening cables must be attached and tightened using ratchet strap (B) prior to climbing to attach the platform ratchet strap (ratchet strap C). Additionally, the lower bark biters must be secured by the ratchet strap (ratchet strap A) and the lower bark biter is assembled properly and attached to the ladder section (C) prior to climbing to attached the platform ratchet strap (ratchet strap C). Failure to follow these instructions may result in serious injury or death!

WARNING! Prior to climbing, make sure that all the ladders sections are firmly connected with the proper hardware (snap pins) in place. Make sure none of the sections have become separated. If they are, do not climb the ladder. With the help of two (2) other adults, lower the stand back down to the ground and reattach the ladder sections and reinstall the hardware in the manner previously described. Failure to follow these instructions may result in serious injury or death!

WARNING! Prior to attempting to climb a ladder stand for the first time, make certain the feet are secured into the ground (very bottom portion of the bottom ladder section), and planted in level ground. If they are not firmly planted in level ground DO NOT climb the ladder. With the help of two (2) other adults, lower the stand and find a suitable location to safely install the ladder stand. Failure to follow these instructions may result in serious injury or death!

WARNING! Before attempting to climb the ladder stand, bounce on the bottom ladder section to set the ladder into the ground before attempting to climb the ladder stand. This action should be completed before tightening the lower bark biters or jaw system. Failure to follow these instructions may result in serious injury or death!

WARNING! Always lean forward while climbing and securely attach your full-body fall arrest harness tree belt to the tree prior to securing the platform to the tree. Failure to follow these instructions may result in serious injury or death!

WARNING! When climbing to secure the ratchet strap C on the treestand, it is important to lean forward when climbing to keep the stand centered and secure to the tree trunk. DO NOT lean backwards when climbing. Failure to follow these instructions may result in serious injury or death!

WARNING! When climbing, always maintain three (3) points of contact as you ascend (climb up) and while descending (climb down). Failure to maintain three (3) points of contact puts the user at serious risk of bodily injury. Proper three (3) point contact means having either 2 feet with 1 hand or 1 foot with 2 hands on the step portions of the climbing aids and/or ladder stands at all times when climbing up or down. Failure to follow these instructions may result in serious injury or death!

WARNING! The Ratchet Strap C, the lower bark biter with ratchet strap A, and Jaw system with Ratchet Strap B have all been included All of these safety devices must be installed as outlined in the Instruction Manual. Failure to install these safety devices as outlined in this Instruction Manual may result in serious injury or death!

WARNING! This X-Stand™ product is designed for adult use only! No one under the age of 16 should attempt to use this or any X-Stand™ products without direct adult supervision. Failure to follow these instructions may result in serious injury or death!

To activate your product's warranty, please mail in your registration card or submit it online at www.X-Stand.com

Product Purchased _____ Model Number _____

Serial Number _____

Owner's Name _____

Street Address _____

City _____ State _____ Zip Code _____

E-mail Address _____ Phone _____

Date Purchased _____

Purchased From (Dealer Name) _____

How did you hear about us: Catalog Webpage Friend Magazine

Other, Please Explain _____

Are you a: Bow Hunter Gun Hunter Both

Treestand Preference: Fixed Position Climbing Ladderstand

X-Stand Treestands | 21673 Cedar Avenue South | Lakeville, MN55044

STANDARD LIMITED WARRANTY

Warranty: X-Stand™ Treestands warrant all X-Stand™ treestands, climbing system products and hunting accessories to be free from defects in material and workmanship for a period of twelve months from the original date of retail purchase. X-Stand™ Treestands warrants the enclosed hardware (where applicable) is delivered to be free from physical defects for a period of twelve months from the original date of retail purchase.

Repair Procedures, Exclusive Remedy: X-Stand™ Treestands will at its option, repair, or replace products not conforming to this limited warranty at no charge. THIS IS THE SOLE AND EXCLUSIVE REMEDY AVAILABLE FOR BREACH OF WARRANTY OR UNDER ANY OTHER LEGAL THEORY WITH RESPECT TO X-STAND™ Treestands. If you find a product to be defective, contact the customer service department at 540-877-2769. When you receive authorization, return the product as directed at your expense. Product repairs not covered by warranty, and product updates, will be provided at a set rate.

Limitations: This warranty is void if the product is damaged by improper or abnormal use or by accident; if the product is altered or modified in any way other than those directed by official X-Stand™ Treestands instructions; or if any attempt is made to repair the product without authorization from X-Stand™ Treestands. It is solely the purchaser's responsibility to determine the suitability of these products for each particular application. X-Stand™ Treestands products are intended for hunting and hunting only. X-Stand™ Treestands are in all events not suitable, and are not authorized, for use in any situations that might pose potentially injurious to life and health, other than those situations that the products are intended for. This warranty is not assignable or transferable.

No Other Warranties: EXCEPT AS PROVIDED IN THIS LIMITED WARRANTY SET FORTH IN THE WARRANTY CARD SUPPLIED WITH X-STAND™ TREESTANDS AND INSTRUCTION SHEETS ARE PROVIDED "AS IS". ALL OTHER WARRANTIES AND REPRESENTATIONS, ORAL OR WRITTEN, EXPRESSED OR IMPLIED, INCLUDING BUT NOT LIMITED TO ANY IMPLIED WARRANTIES OF MERCHANTABILITY OR FITNESS FOR A PARTICULAR PURPOSE, ARE EXCLUDED AND DO NOT APPLY. THERE ARE NO WARRANTIES WHICH EXTEND BEYOND THE DESCRIPTION ON THE FACE HERE OF. Except as required by law, no representative, agent or employee of X-Stand™ Treestands is authorized to make warranties, representations, or obligations inconsistent with or in addition to those set forth in this limited warranty.

No Damages: IN NO EVENT WILL X-STAND™ Treestands BE LIABLE FOR DIRECT, INDIRECT, SPECIAL, INCIDENTAL, OR CONSEQUENTIAL DAMAGES RESULTING FROM BREACH OF WARRANTY OR UNDER ANY OTHER LEGAL THEORY, even if advised of the possibility of such damages. In no event will X-Stand™ Treestands be liable for sums in excess of the purchase price of the product. X-Stand™ Treestands is thus not liable for lost profits or goodwill; downtime; damage or destruction of items or equipment used with, or in conjunction with, X-Stand™ Treestands; personal injury or loss; or any other damages.

General: (a) This agreement is the entire agreement between you and X-Stand™ Treestands.; supercedes any prior or different agreements, representations, or proposals; and may be changed only by written agreement with X-Stand™ Treestands. (b) Waiver by any party of any default or breach of this agreement will not constitute a waiver of any subsequent default or breach of the same of different kind. (c) The invalidity of any provision of this agreement shall not affect the validity of the other provisions hereof. (d) This agreement shall be governed by the laws of the State of Minnesota, U.S.A. X-Stand™ Treestands; Lakeville, MN 55044

READ THIS MANUAL IN ITS ENTIRETY PRIOR TO USING THIS PRODUCT.

This instruction manual complies with ASTM F2123 Standard Practice for Treestand Instruction.

X-STAND.COM



21673 Cedar Avenue South | Lakeville, MN 55044 | 540-877-2769 • Fax: 952-236-6458

This X-Stand™ product(s) has been tested to rigid industry standards. Safe operation and use of this X-Stand™ product(s) is the responsibility of the user(s). Please read and follow all safe use instructions and warnings. Failure to follow these may result in serious injury or death! Third Edition, February 2018, Published by X-Stand™ TREESTANDS, Lakeville Minnesota.

© 2018 X-Stand™ TREESTANDS. All rights reserved.