

# Installation Instructions

I - Sheet Number I-PW00803403 Rev.A



Premium Style. Lasting Performance.

For proper installation and best possible fit, please read all instructions BEFORE you begin.  
For technical assistance or to obtain missing parts, please call Customer Relations at 1-800-241-7219.

Para una instalación adecuada y el mejor ajuste posible, lea todas las instrucciones ANTES de comenzar.  
Para obtener asistencia técnica o para obtener piezas que faltan, por favor llame a Relaciones con el cliente en 1-800-241-7219.

Pour une installation correcte et le meilleur ajustement possible, s'il vous plaît lire toutes les instructions AVANT de commencer.  
Pour une assistance technique ou pour obtenir des pièces manquantes, s'il vous plaît communiquer avec les Relations à la clientèle au 1-800-241-7219.

## Care and Cleaning

- **Wash only with mild soap & dry with a clean cloth.**  
Lavar con jabón suave y seque con un paño limpio.  
Laver avec un savon doux et séchez avec un chiffon propre.
- **Every 3 months or 5000 miles check the cover tension and all components for tightness.**  
Revise cada 3 meses o 5,000 millas la tensión de la cubierta y todos los componentes estén ajustados.  
Vérifiez tous les 3 mois ou 5000 miles la tension couvercle et le serrage des composants.

## Congratulations!

You have purchased one of the many quality Lund® branded products offered by Lund International, Inc. We take the utmost pride in our products and want you to enjoy years of satisfaction from your investment. We have made every effort to ensure that your product is top quality in terms of fit, durability, finish and ease of installation.

Usted ha comprado uno de los muchos productos de calidad ofrecidos por Lund® de marca productos ofrecidos por Lund International, Inc. Tomamos el orgullo extremo en nuestros productos y queremos que disfrute durante años de su inversión. Hemos hecho todos los lo posible para que su producto es de calidad superior en cuanto a ajuste, durabilidad, acabado y facilidad de la instalación.

Vous avez acheté un des nombreux produits de qualité offerts par Lund® marque produits offerts par Lund International, Inc Nous sommes extrêmement fiers de nos produits et souhaitons que vous tiriez des années de satisfaction de votre investissement. Nous avons pris toutes les efforts pour s'assurer que votre produit est de qualité supérieure en termes de durabilité, de finition et la facilité de l'installation.

# INSTALLATION INSTRUCTIONS

PART# 244102008/ 260102008

## PARTS LIST:

Qty	Description	Qty	Description
1	Driver Sidebar	2	10mm Plastic Retainers
1	Passenger Sidebar	2	10mm x 30mm Bolt Plates
1	Driver/Left Front Mounting Bracket	2	10mm x 27mm x 3mm Flat Spacer Washers
1	Passenger/Right Front Mounting Bracket	2	10mm Lock Washers
1	Driver/Left Middle Mounting Bracket	2	10mm x 30mm x 2.5mm Flat Washers
1	Passenger/Right Middle Mounting Bracket	2	10mm Hex Nuts
1	Driver/Left Rear Mounting Bracket	28	8-1.25mm x 30mm Hex Bolts
1	Passenger/Right Rear Mounting Bracket	28	8mm Lock Washers
1	Driver/Left Rear Support Bracket	28	8mm x 24mm OD x 2mm Flat Washers
1	Passenger/Right Rear Support Bracket		

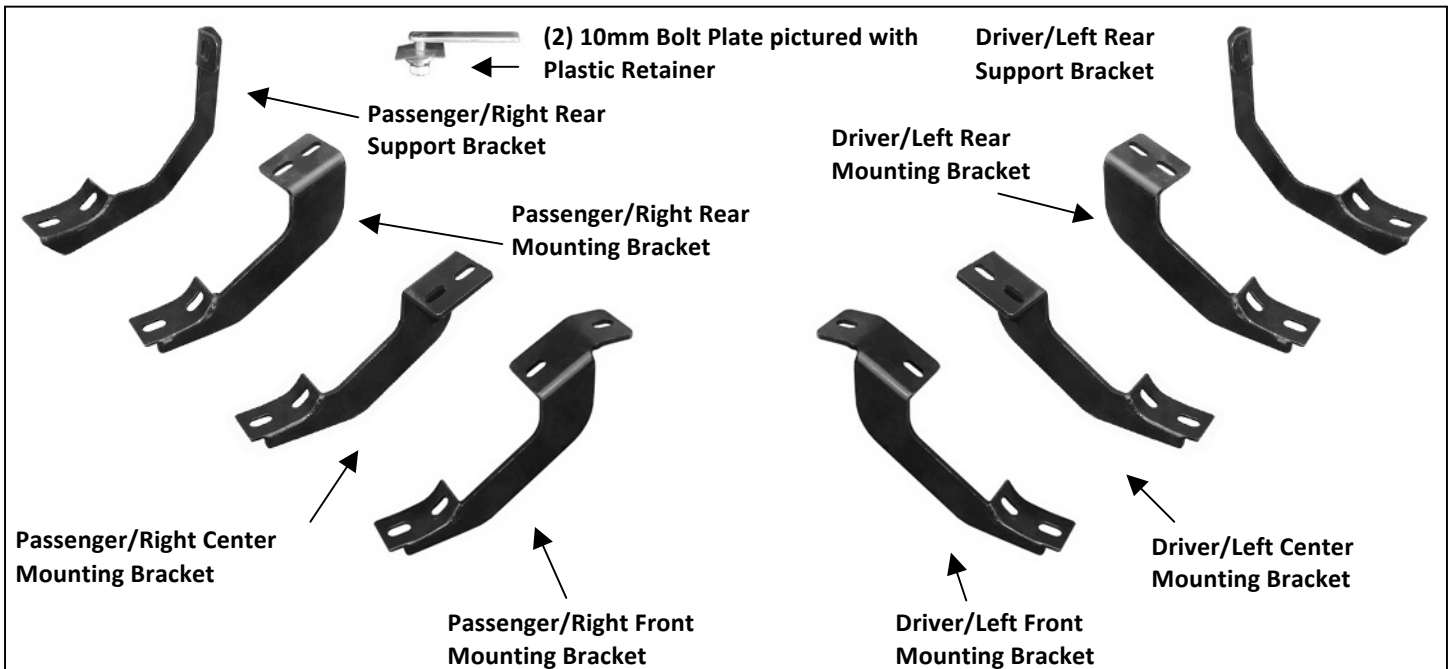

## PROCEDURE:

1. REMOVE CONTENTS FROM BOX. VERIFY ALL PARTS ARE PRESENT. READ INSTRUCTIONS CAREFULLY. ASSISTANCE IS RECOMMENDED.
2. Starting on the driver side front of the vehicle, remove the existing (2) factory bolts, (or plastic plugs), on the side panel located by the front tire opening, **(Figure 1)**. Attach the front Mounting Bracket to the vehicle using the included (2) 8mm x 30mm Hex Bolts, (2) 8mm Lock Washers and (2) 8mm Flat Washers, **(Figure 2)**. Do not tighten hardware at this time.
3. Locate the next mounting location along the side panel closest to the front Bracket and the very last location toward the back of the cab. Remove the factory bolts, (or plastic plugs), as described in **Step 2**. Select the correct driver side Center and Rear Brackets and bolt them to the body panel as described in **Step 2**, **(Figures 3 - 5)**. Do not tighten hardware at this time.
4. Move to the very end of the cab. Locate and remove the rubber plug in the side of the inner body panel, **(Figure 6)**. Select (1) 10mm Bolt Plate and (1) Plastic Retainer, **(Figure 7B)**. Insert the Bolt Plate into the hole and thread the Plastic Retainer down onto the Bolt Plate until it is tight against the body panel, **(Figure 7A)**. **NOTE:** The Plastic Retainer is designed to prevent the Bolt Plate from falling into the body panel and to aid Support Bracket

installation. Select (1) 10mm x 27mm Thick Flat Spacer Washer and slide it onto the threaded end of the Bolt Plate over the Retainer, **(Figure 7A)**. Next, secure the driver side Rear Support Bracket to the Bolt Plate with (1) 10mm x 30mm x 2.5mm Flat Washer, (1) 10mm Lock Washer and (1) 10mm Hex Nut, **(Figure 8)**. Snug but do not fully tighten hardware at this time.

5. Carefully place the Driver/Left Sidebar onto the (4) Brackets. Align the threaded holes in the bottom of the Sidebar with the slots in the Mounting Brackets. Attach the Sidebar to the Mounting Brackets with the included (8) 8mm x 30mm Hex Bolts, (8) 8mm Lock Washers and (8) 8mm Flat Washers, **(Figures 2, 4 & 5)**. Do not tighten hardware at this time.
6. Level and adjust the Sidebar properly and tighten all hardware.
7. Repeat **Steps 2 - 6** for passenger Sidebar installation.
8. Do periodic inspections to the installation to make sure that all hardware is secure and tight.

**To protect your investment**, wax this product after installing. Regular waxing is recommended to add a protective layer over the finish. Do not use any type of polish or wax that may contain abrasives that could damage the finish.

**For stainless steel:** Aluminum polish may be used to polish small scratches and scuffs on the finish. Mild soap may be used also to clean the Sidebar.

**For gloss black finishes:** Mild soap may be used to clean the Sidebar.

#### Driver Side Installation Pictured

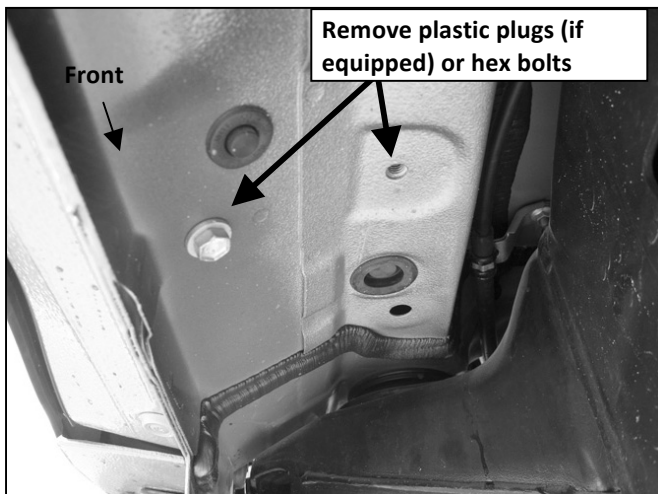

(Fig 1) Driver/Left Front Mounting Location Pictured

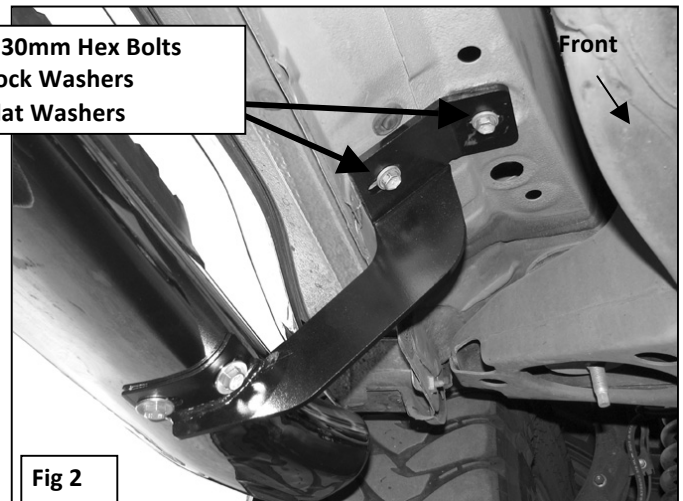
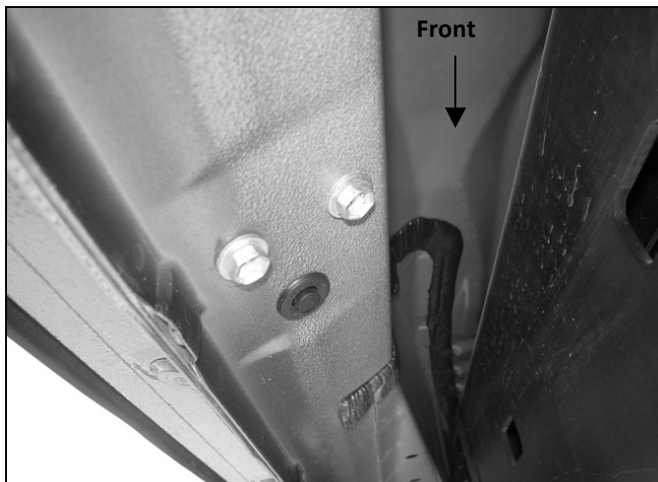
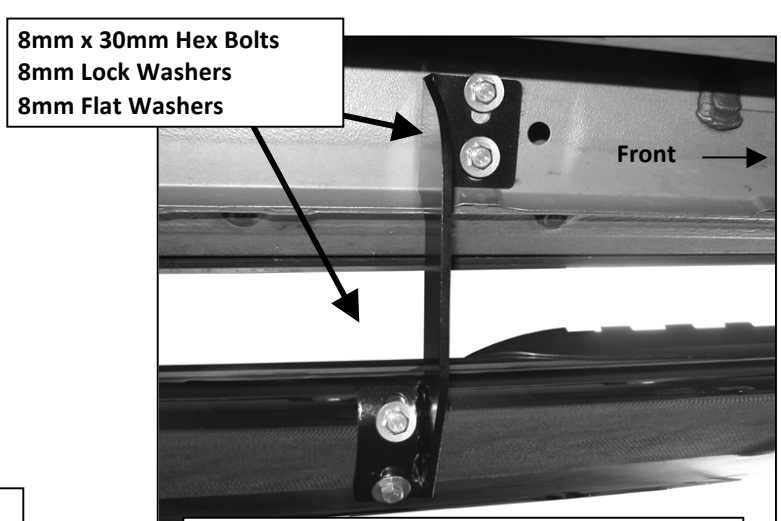

Fig 2

**IMPORTANT:** There are four sets of threaded holes in the side panel. Starting from the front of the vehicle, use the first, second, and fourth set of holes.



(Fig 3) Driver/Left Center Mounting Location Pictured



(Fig 4) Driver/Left Center Bracket Pictured

Driver Side Installation Pictured

