



1298922

TRAILER TONGUE BOX



DISTRIBUTED BY:
TRACTOR SUPPLY COMPANY
5401 VIRGINIA WAY
BRENTWOOD, TN 37027
FOR CUSTOMER SUPPORT,
CALL: 1-888-376-9601
WWW.TRACTORSUPPLY.COM
MADE IN CHINA

Owner's Manual & Safety Instructions

Owner's Manual & Safety Instructions

Save This Manual Keep this manual for the safety warnings and precautions, assembly, operating, inspection, maintenance and cleaning procedures. Keep this manual and the receipt in a safe and dry place for future reference.

TSC TRAILER TONGUE BOX
ITEM 1298922

Specifications

OVERALL SIZE: 46.38in (L) X 18.15in (W) X 14.76in (H)

Important Safety Information

Installation Precautions

1. Install only according to these instructions. Improper installation can create hazards.
2. Wear ANSI-approved safety goggles and heavy-duty work gloves during installation.
3. Keep installation area clean and well lit.
4. Keep bystanders out of the area during installation.
5. Do not install when tired or when under the influence of alcohol, drugs or medication.
6. Weight capacity and other product capabilities apply to properly and completely installed product only.
7. Verify that installation surface has no hidden brake lines or wires before drilling

Use Precautions

1. This product is not a toy. Do not allow children to play with or near this item.
2. Use as intended only.
3. Inspect before every use; do not use if parts are loose or damaged.
4. Lock trailer box before transporting.
5. Comply with all local, state, and federal regulations regarding installation and use.
6. **Be aware of dynamic loading!** Sudden load movement may briefly create excess load causing product failure.
7. Maintain product labels and nameplates. These carry important safety information. If unreadable or missing, contact TSC for a replacement.

Installation Instructions



Read the ENTIRE IMPORTANT SAFETY INFORMATION section at the beginning of this document including all text under subheadings therein before set up or use of this product.

WARNING

TO PREVENT SERIOUS INJURY AND PROPERTY DAMAGE:

Do not attempt to install this product if you are not comfortable and skilled at doing this type of work. This is a custom installed product that requires precise measurements and drilling that is unique to each trailer's design and size. Use an experienced qualified professional installer to install and inspect the fabrication and final installation.

1

2

"A" Frame Tongue Installation Instructions

NOTE: Fasteners sold separately.

1. Measure the width of the trailer tongue on which the trailer box is to be mounted. Mark the inside of the box at 1-1/2" to 2" from front and back of the box inner side and about 2/3rd of the Tongue width from the sides of the box. Punch drill locator guides with a center punch.
2. Drill a 1/8" guide hole at one location. Position the trailer box on the Tongue and mark the chassis through the drilled hole. Remove the box and make sure that the marked position on the chassis is in an appropriate location, keeping in mind that you would be drilling 1/4" hole in that position.
3. Repeating the above mentioned steps, mark the remaining three spots and verify their proper location on the chassis.
4. In the bottom of the trailer box drill four 17/64" holes and remove metal shavings. Attach a 1/4" rubber grommet (not supplied), to each hole.
5. Make sure that there are no hidden electrical wires or conduits below the marked spots and drill a 1/4" hole at each location on the chassis. Clean all metal shavings.
6. Reposition the Box over the tongue aligning the drilled holes.
7. Insert a 1/4" carriage bolt through a 1/4" flat washer and pass it through the grommet and into the drilled hole in the trailer tongue. Attach a flat washer and attach a 1/4" locking nut (do not tighten at this time). Continue with the other three locations. Secure all four nuts tightly. See illustration (on page 4) .

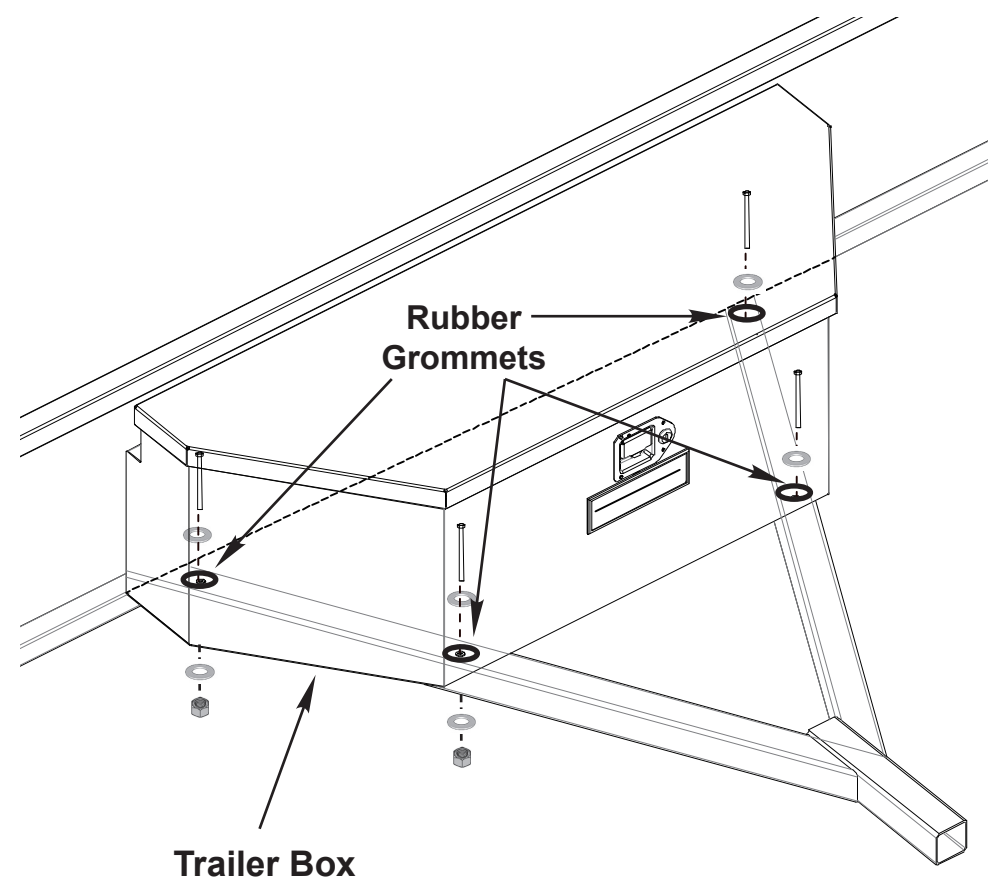

3

4

PLEASE READ THE FOLLOWING CAREFULLY

THE MANUFACTURER AND/OR DISTRIBUTOR HAVE/HAS PROVIDED THE PARTS LIST AND ASSEMBLY DIAGRAM IN THIS MANUAL AS A REFERENCE TOOL ONLY. NEITHER THE MANUFACTURER NOR DISTRIBUTOR MAKES ANY REPRESENTATION OR WARRANTY OF ANY KIND TO THE BUYER THAT HE OR SHE IS QUALIFIED TO MAKE ANY REPAIRS TO THE PRODUCT, OR THAT HE OR SHE IS QUALIFIED TO REPLAC ANY PARTS OF THE PRODUCT. IN FACT, THE MANUFACTURER AND/OR DISTRIBUTOR EXPRESSLY STATES THAT ALL REPAIRS AND PARTS REPLACEMENTS SHOULD BE UNDERTAKEN BY CERTIFIED AN LICENSED TECHNICIANS, AND NOT BY THE BUYER. THE BUYER ASSUMES ALL RISK AND LIABILITY ARISING OUT OF HIS OR HER REPAIRS TO THE ORIGINAL PRODUCT OR REPLACEMENT PARTS THERETO, OR ARISING OUT OF HIS OR HER INSTALLATION OF REPLACEMENT PARTS THERETO.

PARTS LIST AND DIAGRAM

PARTS LIST

NO.	ITEM NO.	DESCRIPTION	QTY
1	XZ.010	BOX LID	1
2	XZ.020	SHACKLE	1
3	GB/T12615.1-2004	ALU. RIVET DIA5X12	4
4	XZ.030	3" HINGE	4
5	GB/T12615.1-2004	ALU. RIVET DIA5X6	24
6	XZ.070	GAS SPRING	2
7	GB/T6184-2000	LOCK NUT M8	4
8	XZ.040	BOX BODY	1
9	XZ.050	PADDLE LOCK	1
10	XZ.060	TSC LOGO BADGE	1
11	XZ.080	SEAL	1
12	GB/T12615.1-2004	ALU. RIVET DIA5X6	4
13	XZ.090	KEY (NOT SHOWN)	2

DIAGRAM

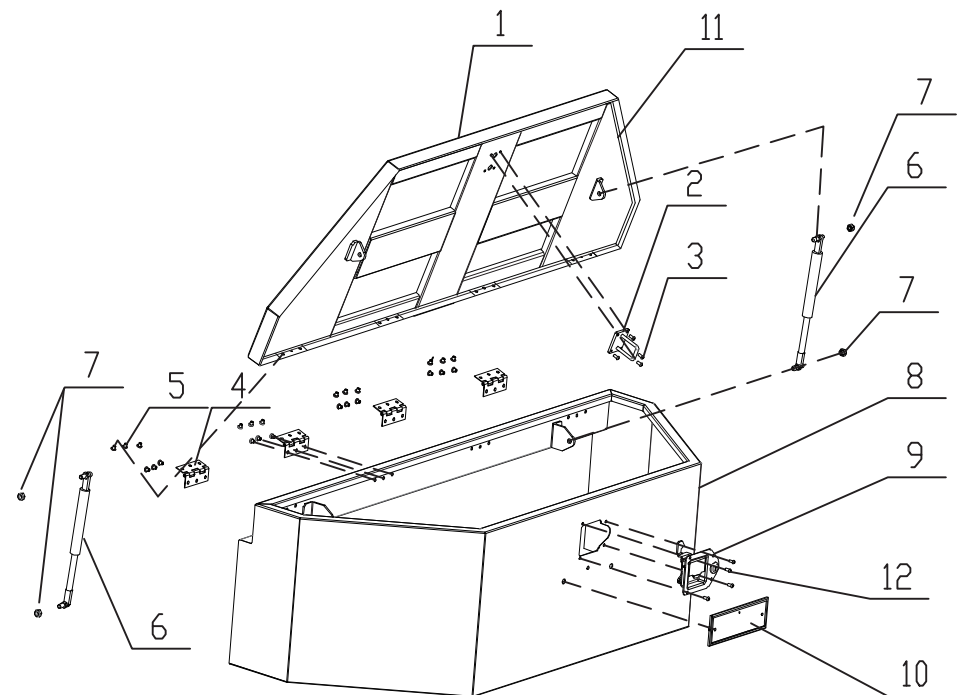

Note: Record Serial Number Here:

Note: If product has no serial number, record month and year of purchase instead.

Note: Some parts are listed and shown for illustration purposes only, and are not available individually as replacement parts.

5

6