

### Professional Glueboard Insect Control

**Please read these instructions carefully and store in a safe place for future reference.**

#### IND35L

As part of the Synergetic® brand of insect control products, **IND35L** is an easy to service and highly effective flylight. **IND35L** utilizes highly effective dual wavelength Synergetic® UV bulbs and is designed for use with a high specification glueboard. Constructed from coated mild steel, **IND35L** can be wall or desk mounted.

#### CONTENTS OF PACKAGE

- 1 x IND35L
- 2 x 15W 18" Shatterproof Synergetic UV bulbs
- 1 x glueboard (Fitted)
- 3 x screws and wall plugs
- 1 x Mains cable (Type X)

**WARNING - THIS APPLIANCE MUST BE GROUNDED**

#### INSECT CONTROL PRODUCTS

**IND35L** utilizes high powered Synergetic® bulbs to attract flying insects and retains the caught insects on a glueboard for inspection or hygienic disposal. Synergetic® bulbs combine both ultraviolet light and visible green light to attract a wider range of flying insects.

#### WARNING

**IND35L** is not to be used by children or persons with reduced physical, sensory or mental capabilities, or lack of experience and knowledge, unless they have been given supervision or instruction.

Children should be supervised to ensure they do not play with the appliance.

If the mains cable is damaged it must be replaced by a specialist mains cable available from P+L Systems Ltd or your supplier.

#### POSITIONING AND GUIDANCE FOR USING IND35L

**THIS UNIT IS FOR INDOOR USE ONLY.**

**IND35L** should ideally be fixed around seven feet above the ground, preferably in the darkest place within the area to be protected. Do not position the unit close to windows, skylights or other sources of light, or where it may be obscured by furniture, doors or other obstacles. Ideally, **IND35L** should be visible from every part of the area to be protected.

**IND35L** should ideally be in operation for 24 hours a day, ensuring your premises are kept free of flying insects. Insects are most attracted to **IND35L** at night when there is no competition from daylight or other light sources.

#### WARRANTY

**IND35L** has a two year warranty and if maintained as recommended in these instructions should continue to work for many years.\* Use of non-approved consumables may invalidate the warranty. Ensure genuine P+L Systems glueboards are used in conjunction with this product.

#### INSTALLATION

**INSTALLATION SHOULD BE CARRIED OUT BY SERVICE PERSONNEL ONLY.**

**IND35L** has swing open front, which allows simple and quick access to the inside of the flylight, for installation and servicing.

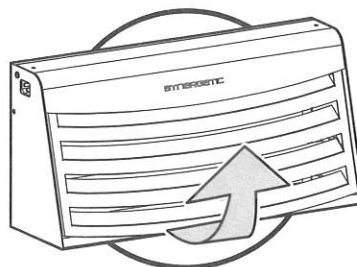

Install **IND35L** by offering the product up to the wall and marking the three fixing centers. Then drill holes and fit the supplied wall plugs and screws. (For specialist wall surfaces such as plasterboard, appropriate wall plugs should be used.) Then hand the product onto the mounting screws.

Once **IND35L** is installed in position, fit the glueboard in place as described in the glueboard replacement section of this document. Use the removable mains lead and plug to connect the **IND35L** to an appropriate rating, as specified on the specification label found on the top of the product.

#### CLEANING

**CLEANING SHOULD BE CARRIED OUT BY SERVICE PERSONNEL ONLY, AFTER ENSURING THAT THE UNIT IS DISCONNECTED FROM THE MAINS SUPPLY.**

It is recommended that cleaning is carried out regularly when the glueboard is replaced. Once the glueboard is removed, the unit should be thoroughly wiped down with a damp cloth, removing any build up of dirt. Ensure the unit is completely dry before reconnecting it to the power supply.

## GLUEBOARD REPLACEMENT

BEFORE REPLACING THE GLUEBOARD, ALWAYS ENSURE THAT THE UNIT IS DISCONNECTED FROM THE MAINS SUPPLY.

The glueboard should be replaced every month with a genuine P+L Systems glueboard. Use of non-approved glueboards may invalidate your warranty.

To replace the glueboard...

1. Swing the front guard open.
2. Remove the protective release paper from the new glueboard.
3. Position the top of the glueboard in position behind the two locating pins, then carefully drop the horizontal face of the board into position.

Always ensure the selected genuine P+L Systems glueboards are compatible with your unit, available from your pest control operator or P+L Systems.

## BULB REPLACEMENT

BULB REPLACEMENT SHOULD BE CARRIED OUT BY SERVICE PERSONNEL ONLY, AFTER ENSURING THAT THE UNIT IS DISCONNECTED FROM THE MAINS SUPPLY.

To ensure the efficiency of **IND35L** in catching flying insects, the UV bulbs should be replaced annually. After twelve months the phosphor coating that emits the correct wavelength of UV light has burnt away and the UV output is diminished substantially.

To replace the UV bulbs...

1. Swing the front guard open.
2. Gently rotate the bulb through 90°.
3. Pull the bulb forward until it becomes free from the bulb support.
4. Reverse the process with the replacement bulb.
5. Dispose of the used UV bulbs in conjunction with local regulations.

## STARTER REPLACEMENT

STARTER REPLACEMENT SHOULD BE CARRIED OUT BY SERVICE PERSONNEL ONLY, AFTER ENSURING THAT THE UNIT IS DISCONNECTED FROM THE MAINS SUPPLY.

The starters provides an extra spark to initially light the UV bulbs. Starters wear out and should be replaced at the same intervals as the UV bulbs.

To replace the starters...

1. Swing the front guard open.
2. Rotate the starter counter-clockwise.
3. Pull the starter free from the unit.
4. Reverse the process with the replacement starter.

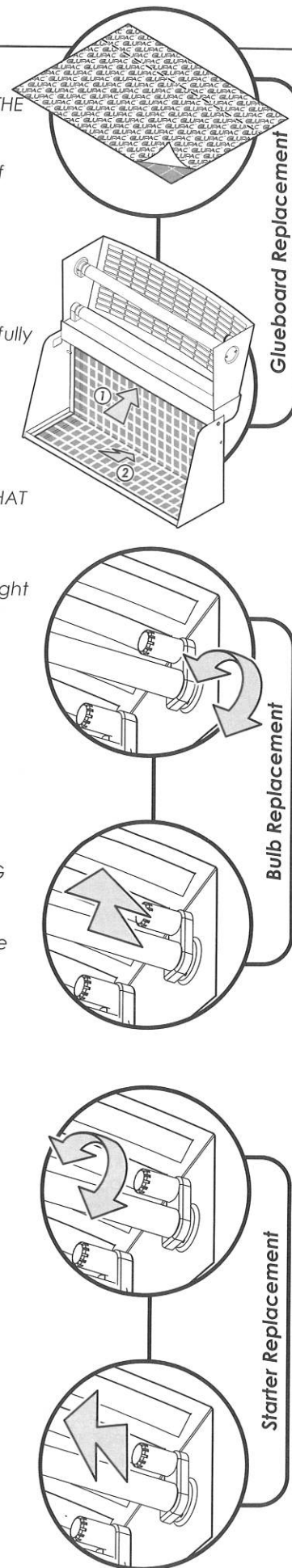

### SPECIFICATION / REPLACEMENT PARTS

Unit	IND35L
Voltage	110V ~ 60Hz
Dimensions(")	20 x 9 1/4 x 5 7/8
Coverage	860 Sq. Feet
Weight	14 1/4 lbs
Light Output	30W
Bulb	2 x TFX15-18S
Starter	2 x I154
Glueboards (x6)	INF212 (Black)