



For Models: 1294895, 1294896, 1294897, 1294898, 1294899



For safety, remove leash and collar before allowing pet to enter the crate.

Assembly Instructions (Drawings may vary from actual product)

Before assembling the crate, install Rubber Feet on the bottom wires first.

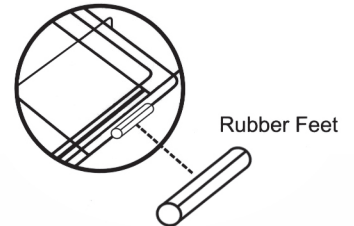

1. Remove the folded crate from the carton.
Unlatch the Locking Device located on the side.

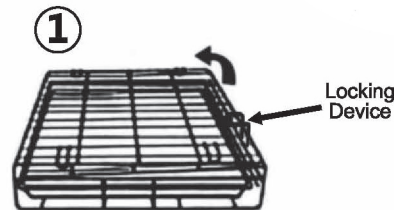

2. Grab any wire on the top panel and turn it like the page of a book. Then grab the crate and pull it upwards.

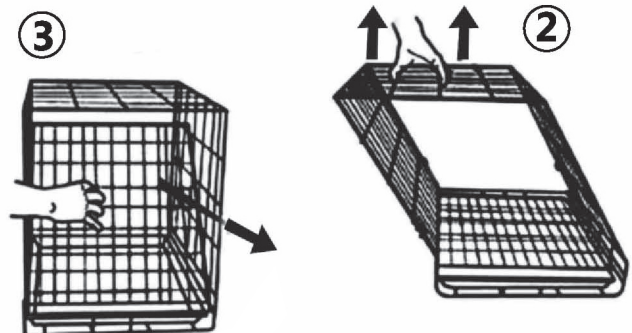

3. Resch in the crate and pull the Door Panel forward until it fits into the hooks on the ends of the Side Panels.

4. To secure the Door Panel to the Top Panel, gently pull forward on the Door Panel while pushing down on the Top Panel, and then fit the hooks over the end wire on the top.

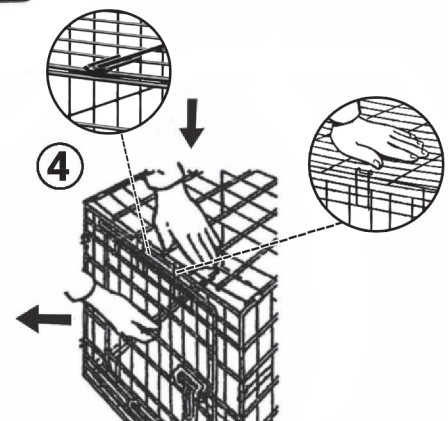

5. Repeat Step 3 and 4 with the end panel.

To disassemble, reverse this process.

Recommended for Crate Trained Pets

Retriever crates are designed and made for safety and security however; it is not recommended to leave an untrained pet in a crate.

Distributed by:
TRACTOR SUPPLY COMPANY
5401 VIRGINIA WAY
BRENTWOOD, TN 37027
For customer support,
call: 1-888-376-9601
www.TractorSupply.com
MADE IN CHINA