



# LOAD-A-PUP

MODEL: LP500

**⚠ WARNING**

**READ ALL INSTRUCTIONS BEFORE USING THE LOAD-A-PUP**

**NOTE: FAILURE TO READ INSTRUCTIONS BEFORE USE COULD RESULT IN INJURY OR DEATH.**

**NOTE: ALL INITIAL INSTALLATION ADJUSTMENTS TO THE LOAD-A-PUP SHOULD BE MADE PRIOR TO LAUNCHING THE BOAT.**

## **Instructions for Installation and Use:**

**CONTENTS: SEE FIGURE 1**

- 1- LOAD-A-PUP PLATFORM ASSEMBLY WITH PRE-INSTALLED CABLES AND "U" BRACKET
- 1- LADDER MOUNTING BRACKET
- 1- LOAD-A-PUP SECURITY STRAP WITH SNAP HOOK
- 2- LADDER CINCHING STRAPS
- 2- 1/4" X 1" BOLTS
- 2- NYLON WASHERS
- 4- FLAT WASHERS
- 2- 1/4" LOCKNUTS

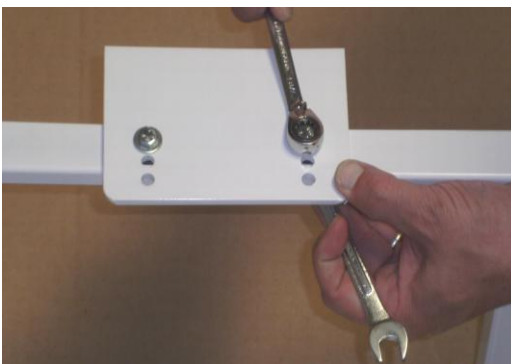

**FIG. 2**

**STEP 1-INSTALLING LADDER MOUNTING BRACKET-SEE FIGURE 2**

SELECT THE PROPER HOLES IN THE LADDER MOUNTING BRACKET THAT WILL ALLOW FOR A SECURE FIT TO LADDER RUNG. ASSEMBLE THE LADDER MOUNTING BRACKET TO THE LOAD-A-PUP PLATFORM ASSEMBLY USING 2- 1/4" X 1" BOLTS, 4- FLAT WASHERS, 2- 1/4" LOCKNUTS & 2- NYLON WASHERS. TIGHTEN SECURELY.

**\*\*NOTE\*\*** THE 2 NYLON WASHERS ARE TO BE PLACED BETWEEN THE LADDER MOUNTING BRACKET AND THE UPRIGHTS OF THE LOAD-A-PUP PLATFORM ASSEMBLY.

**STEP 2-SEE FIGURE 3**  
PLACE LOAD-A-PUP ONTO DESIRED  
RUNG OF BOAT LADDER.



**FIG. 3**



**FIG. 4**



**FIG. 4A**



**FIG. 4B**

**STEP 3-INSTALLING  
SECURITY STRAP WITH SNAP  
HOOK-SEE FIGURE 4 & 4A**

TO SECURE THE LOAD-A-PUP  
TO THE BOAT, INSTALL THE  
LOAD-A-PUP SECURITY STRAP  
WITH SNAP HOOK. ATTACH  
THE END OF THE STRAP  
WITHOUT THE SNAP HOOK TO  
A SECURE POINT ON THE BOAT  
AND CLIP THE SNAP HOOK  
ONTO THE BOLT IN THE “U”  
BRACKET.

**FIGURE 4B-INSTALLING  
CINCHING STRAPS**

UNSNAP THE BUCKLES ON THE  
2 LADDER CINCHING STRAPS  
AND PLACE AROUND THE  
UPRIGHT SECTION OF THE  
LOAD-A-PUP PLATFORM  
ASSEMBLY AND THE LADDER  
RUNGS. POSITION ONE STRAP  
ON EACH SIDE OF LADDER  
MOUNTING BRACKET & SNAP  
BUCKLES BACK TOGETHER.  
PULL UNTIL TIGHT.

**STEP 4-INSTALLATION COMPLETE-SEE  
FIGURE 5**

ONCE PROPERLY INSTALLED THE LOAD-A-  
PUP WILL REST SECURELY ON THE  
LADDER RUNG AND BE READY FOR USE.



**FIG. 5**

**⚠ WARNING**

**LOAD-A-PUP IS NOT DESIGNED OR APPROVED FOR HUMAN USE**

**⚠ WARNING**

**NEVER USE THIS PRODUCT FOR ANYTHING OTHER THAN THE INTENDED USE**

**⚠ WARNING**

**DO NOT USE THIS PRODUCT IN EXTREME WEATHER CONDITIONS i.e., LIGHTNING, HIGH WINDS, ROUGH/CHOPPY WATER**

**⚠ WARNING**

**MAXIMUM WEIGHT CAPACITY IS 200 LBS.**

**⚠ WARNING**

**MAKE SURE THAT SECURITY STRAP WITH SNAP HOOK IS ALWAYS ATTACHED TO PREVENT PRODUCT LOSS.**

**⚠ CAUTION**

**\*NOT FOR HUMAN USE**

**\*FOR USE WITH DOGS WEIGHING 200 LBS. OR LESS**

**\*DO NOT ALLOW DOG ON PLATFORM WHILE BOAT IS MOVING**

**\*DO NOT USE ON BOATS LESS THAN 14 FEET IN LENGTH**

**\*SIDES OF BOAT MUST BE 15 INCHES TALL OR TALLER**

**\*DO NOT USE ON A CANOE OR PIROGUE**

**\*DO NOT USE AS A DIVING PLATFORM**

**\*DO NOT USE AS A HUNTING STAND**

**\*REMOVE UNIT FROM LADDER BEFORE TRAVELING**

For more information about this or other products, contact us at:

**Great Day, Inc.**

604 Kimbrough Dr. \* Tallulah, LA 71282

\* (866) 649-1918 \* [www.greatdayinc.com](http://www.greatdayinc.com)