

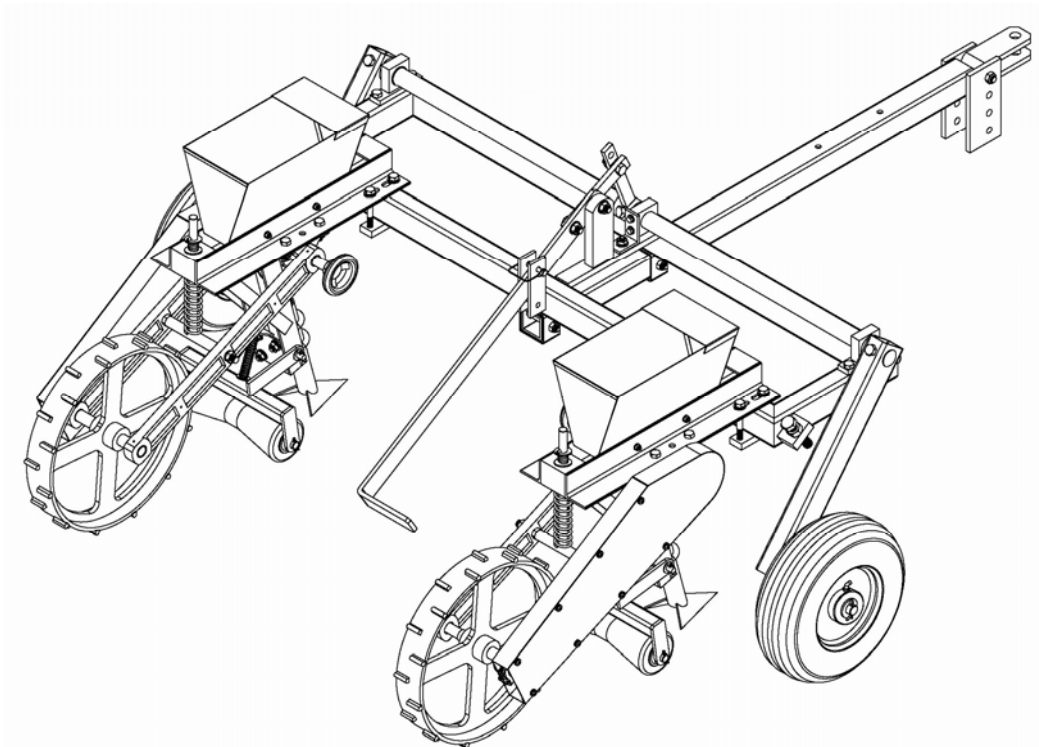

ACREAGE SEEDER / PLANTER OWNER'S MANUAL



WARNING:

Read carefully and understand all **ASSEMBLY AND OPERATION INSTRUCTIONS** before operating. Failure to follow the safety rules and other basic safety precautions may result in serious personal injury.

12242013

Item# ATV-CBP

Thank you very much for choosing this product! For future reference, please complete the owner's record below:

Model: ___ATV-CBP___ Purchase Date: _____

Save the receipt, warranty and these instructions. It is important that you read the entire manual to become familiar with this product before you begin using it.

This machine is designed for certain applications only. The manufacturer cannot be responsible for issues arising from modification. We strongly recommend this machine not be modified and/or used for any application other than that for which it was designed. If you have any questions relative to a particular application, DO NOT use the machine until you have first contacted us to determine if it can or should be performed on the product.

For technical questions please call **1-218-943-6296**.

INTENDED USE

Planter is designed for planting small feed plots or hobby farm.

TECHNICAL SPECIFICATIONS

Manual lift for raising and lowering 13" Pneumatic tires
Adjustable row width from 14"-36"
Ground Driven
Measurements of hopper: 12"x6" at top, 10"x2" at bottom, 8" deep
.22 bushels/hopper, 32 cups/hopper, 1.75 gallons



WARNING: Read and understand all instructions. Failure to follow all instructions listed below may result in serious injury.



CAUTION: Do not allow persons to operate or assemble this planter until they have read this manual and have developed a thorough understanding of how the planter works.



WARNING: The warnings, cautions, and instructions discussed in this instruction manual cannot cover all possible conditions or situations that could occur. It must be understood by the operator that common sense and caution are factors which cannot be built into this product, but must be supplied by the operator.

SAVE THESE INSTRUCTIONS

WORK AREA

- Keep work area clean**, free of clutter and well lit. Cluttered and dark work areas can cause accidents.
- Keep children and bystanders** away while operating the planter. Distractions can cause you to lose control, so visitors should remain at a safe distance from the work area.
- Be aware of all power lines, electrical circuits**, water pipes and other mechanical hazards in your work area, particularly those hazards below the work surface hidden from the operator's view that may be unintentionally contacted and may cause personal harm or property damage.
- Be alert of your surroundings**. Using the planter in confined work areas may put you dangerously close to cutting tools and rotating parts.

PERSONAL SAFETY

- Stay alert**, watch what you are doing and use common sense when using the planter. Do not use the planter while you are tired or under the influence of drugs, alcohol or medication. A moment of inattention while operating the planter may result in serious personal injury.
- Dress properly**. Do not wear loose clothing, dangling objects, or jewelry. Keep your hair, clothing and gloves away from moving parts. Loose clothes, jewelry or long hair can be caught in moving parts.
- Use safety apparel and equipment**. Use safety goggles or safety glasses with side shields which comply with current national standards, or when needed, a face shield. Use as dust mask in dusty work conditions. This applies to all persons in the work area. Also use non-skid safety shoes, hardhat, gloves, dust collection systems, and hearing protection when appropriate.

PLANTER USE AND CARE

- Do not modify the planter in any way**. Unauthorized modification may impair the function and/or safety and could affect the life of the equipment. There are specific applications for which the **planter** was designed.
- Always check of damaged or worn out parts before using the planter**. Broken parts will affect the **planter** operation. Replace or repair damaged or worn parts immediately.
- Do not exceed the planter load capacity**.
- Distribute the load evenly**. Uneven loads may cause the **planter** to tip, resulting in personal injury to the operator or others.
- Use the planter on flat and level surfaces** capable of supporting the **planter** and its maximum load. Pulling or pushing a load on a slanted or uneven surface can result in loss of control.
- Store idle planter**. When **planter** is not in use, store it in a secure place out of the reach of children. Inspect it for good working condition prior to storage and before re-use.

**HOBBY SEED PLANTER
(Patent Pending)**

ASSEMBLY AND OPERATING MANUAL

PRE-ASSEMBLY:

Approximate assembly time of this product is 1 hour.

Helpful Tip: Read all instructions before starting to assemble.

WARNING: TG will not be held liable for any damages, losses or injury, due to the misapplication or misuse of this product or for any other reason. Proper eye and hand protection must be worn at all times.

TOOLS REQUIRED FOR ASSEMBLY

(2) 14mm Wrenches

(1) 24mm Wrench

(2) 19mm Wrenches

REMOVE ALL PARTS FROM CARTONS

Remove the hardware packs and all parts from the cartons.

Layout and identify parts included in carton contents. (see parts listing below)

Layout and identify parts included in the hardware pack. (see parts listing below)

IF ANY PARTS ARE MISSING FROM PACKAGING

Contact TG at 1-218-943-6296 for missing hardware or instructions.

Carton Contents

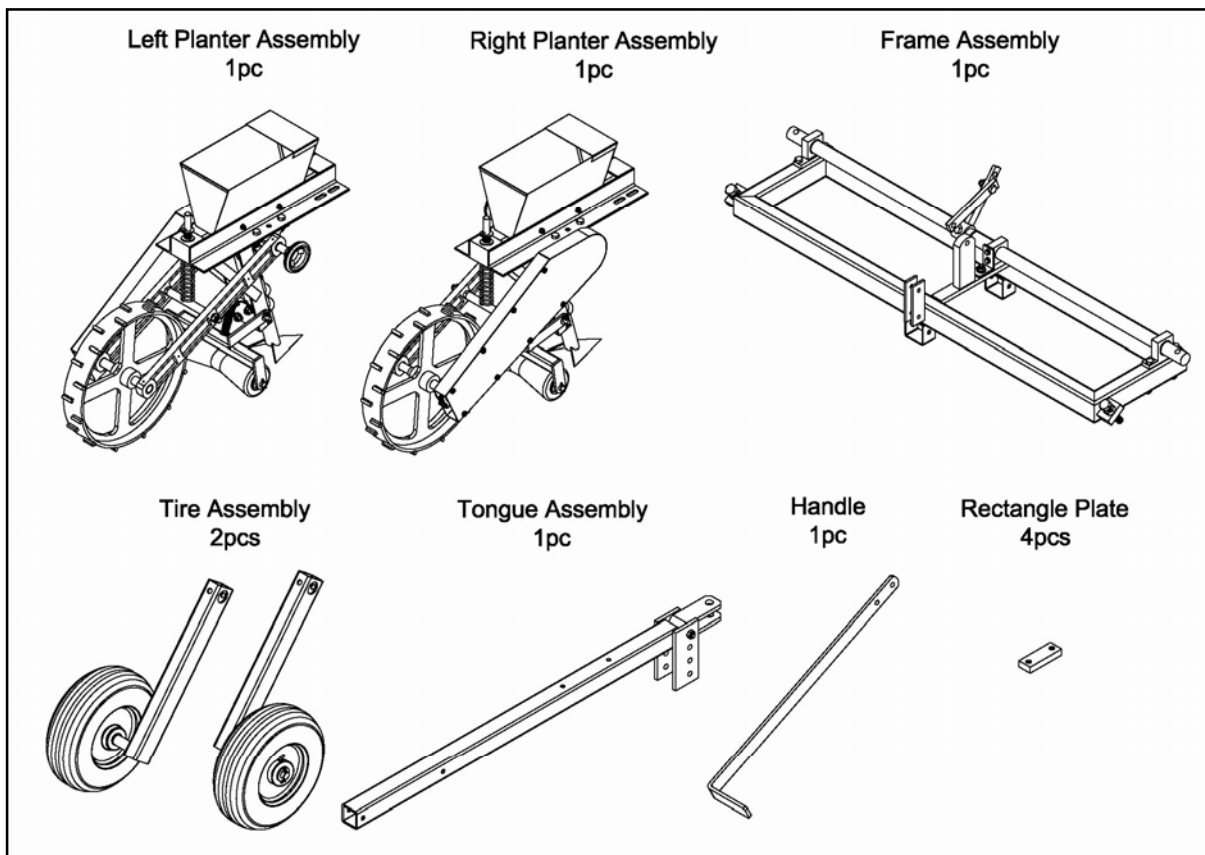
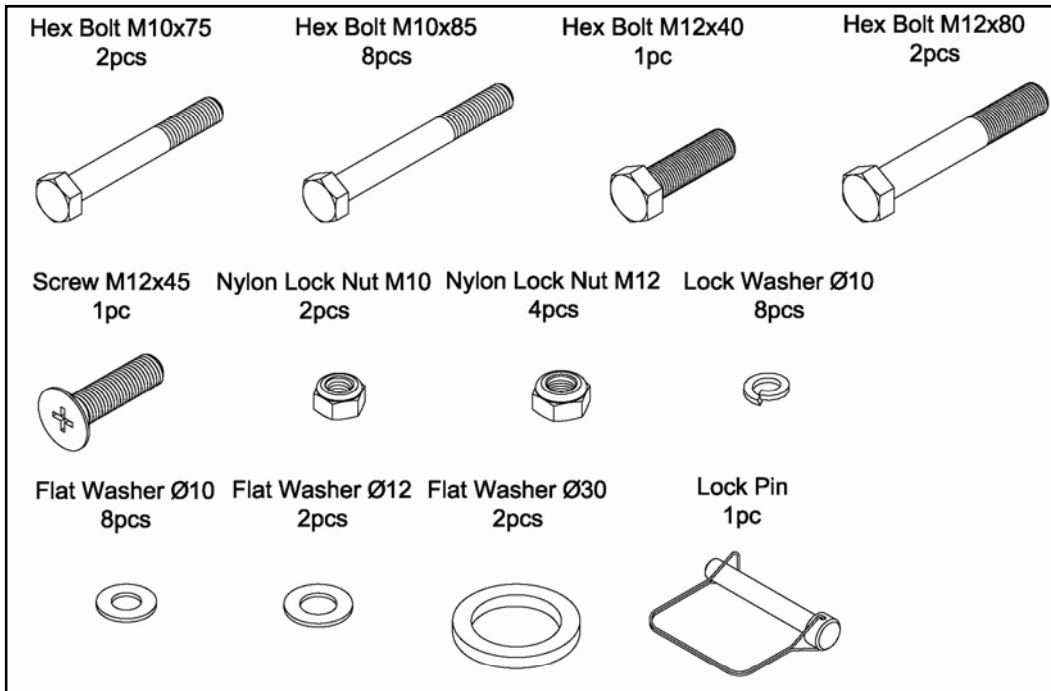

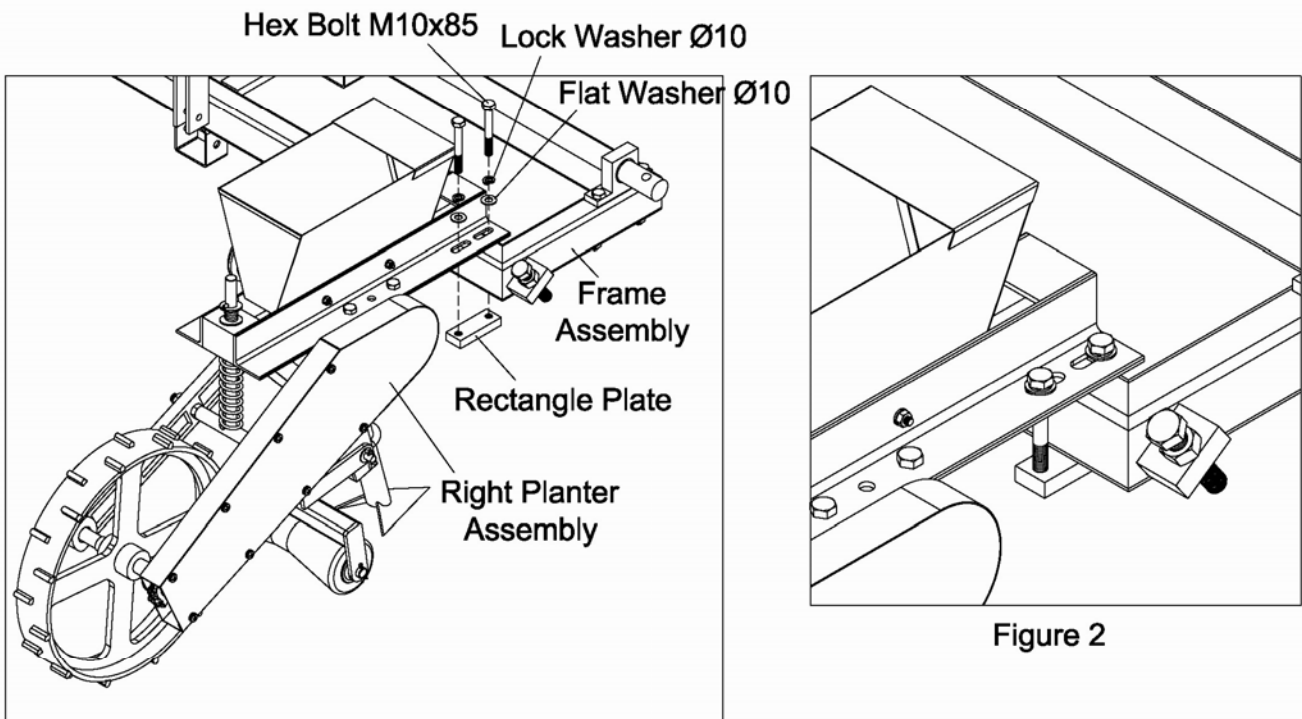

Figure 1

Figure 2

STEP 1: Planter Assembly

Attach the right planter assembly to the right side of the frame assembly using M10 x 85 Hex Bolt, lock washer Ø10, flat washer and rectangle plate as shown in Figure 1. Repeat above procedure for the left planter assembly.

Figure 2. shows the final assembly for this step.

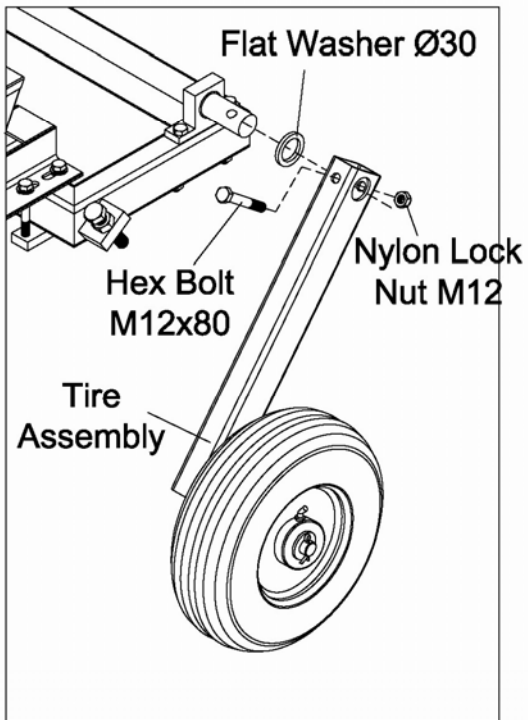

Figure 3

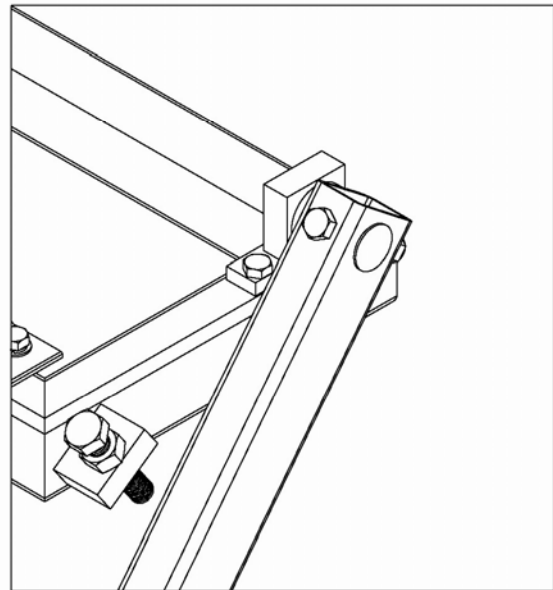

Figure 4

STEP 2: Tire/Wheel Arm Assembly

Install flat washer onto the right axle shaft, then install tire arm assembly onto axle shaft. Install M 12 x 80 Hex Bolt, M12 lock nut and tighten . (Shown in Figure 3)

Repeat above procedure for the left side.

Figure 4 shows completed step.

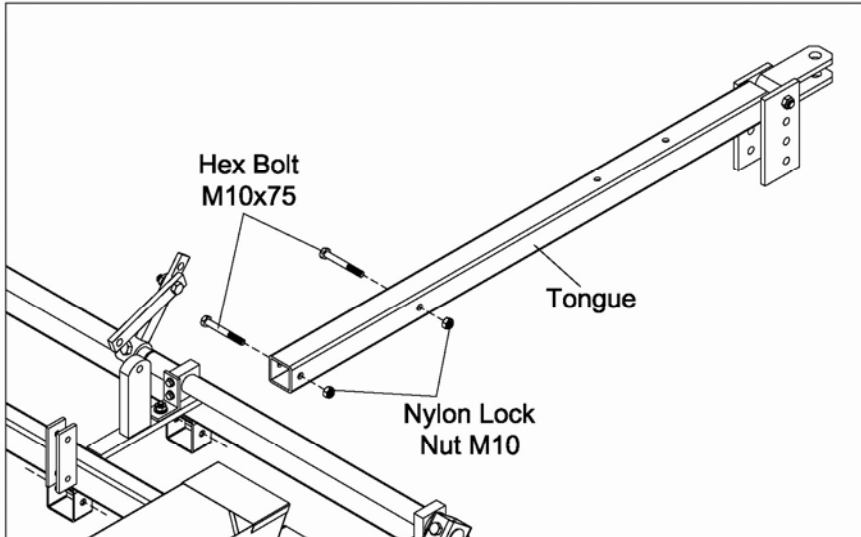

Figure 5

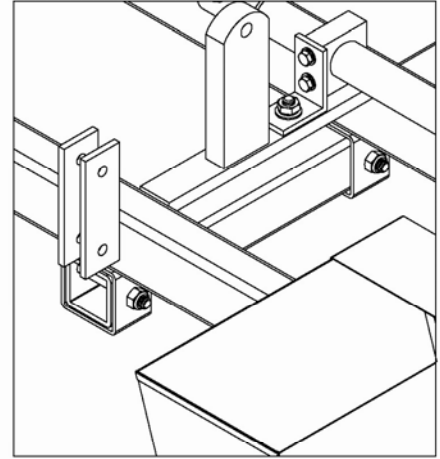

Figure 6

STEP 3: Tongue Assembly

Insert square tongue into the square mounts on the frame assembly, install M 10 x 75 hex bolts, M10 lock nuts and tighten. (As shown in figure 5)

Figure 6 shows the assembled step.

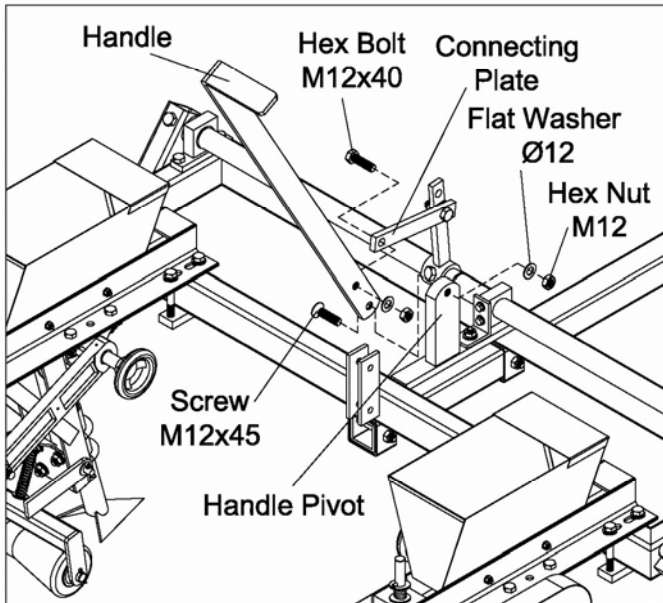

Figure 7

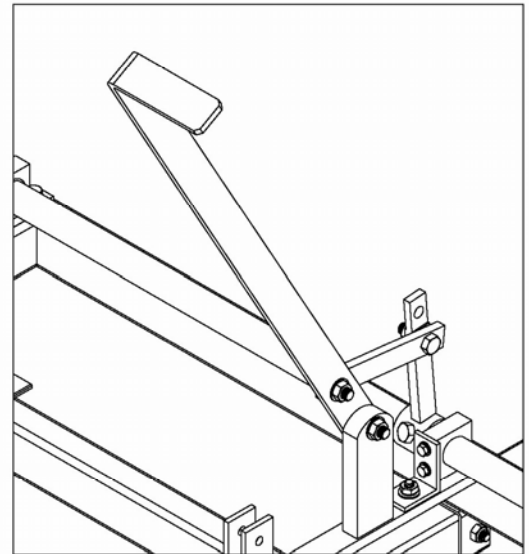

Figure 8

STEP 4: Lift Handle Assembly

Connect handle to the handle pivot mount using M12 flathead bolt , flat washer and M12 nut . (Shown in figure 7)

Note: Flat washer is installed between handle and handle pivot mount.

Figure 8 shows the assembled step.

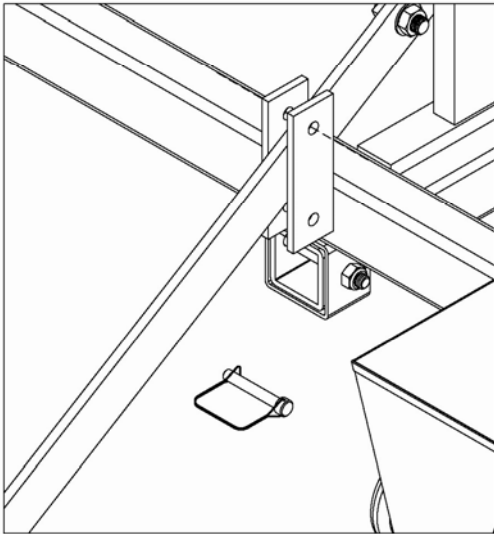

Figure 9

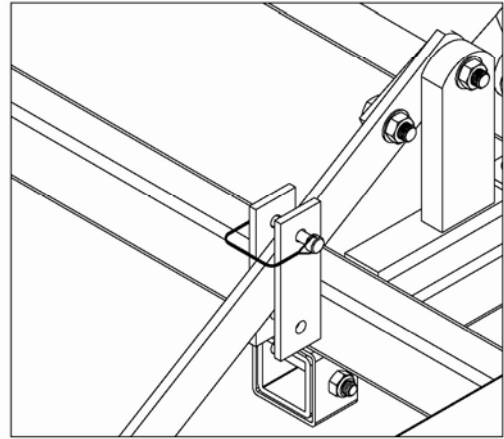
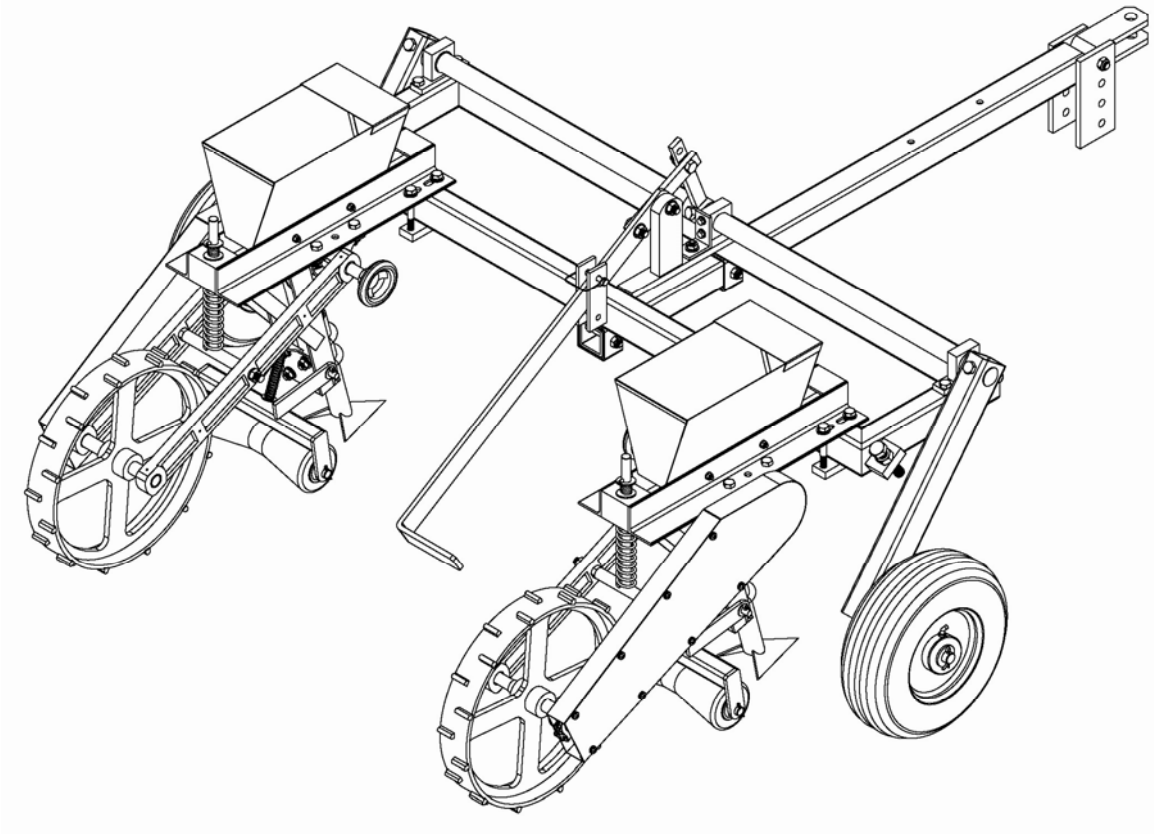

Figure 10

Note: Install lock pin (shown in Figure 10) when towing planter long distances.



Fully
Assembled
Illustration

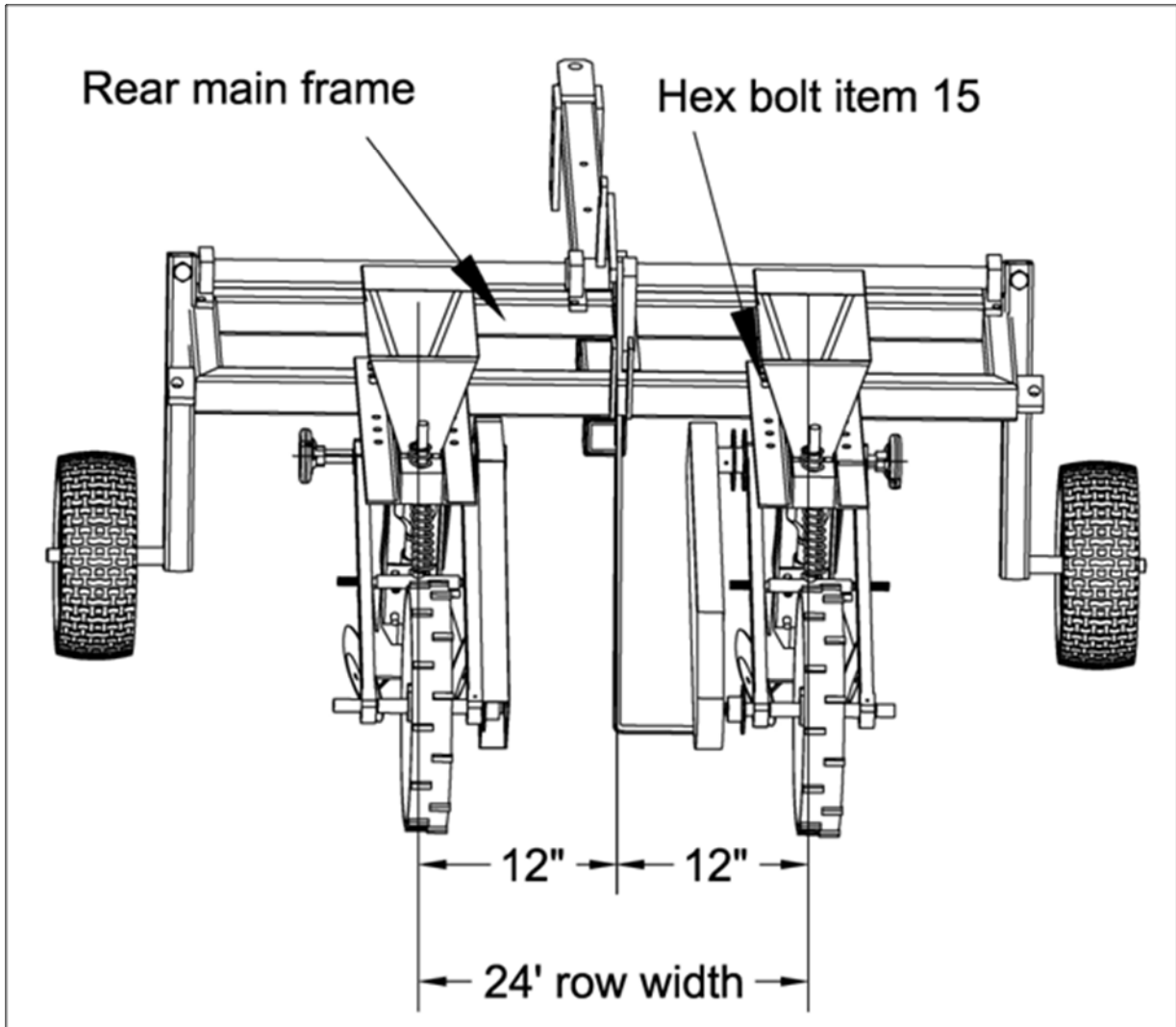

Figure 11

Adjusting Row Width

1. To adjust the row width loosen the 4 hex bolts item 15, that fasten the planter assembly to the rear frame assembly. Measuring from the tongue (middle of frame) move the planter in or out to $\frac{1}{2}$ the row width. I.e. 24" row width measures 12" from tongue to middle of planter. Repeat for opposite planter assembly. See figure 11.

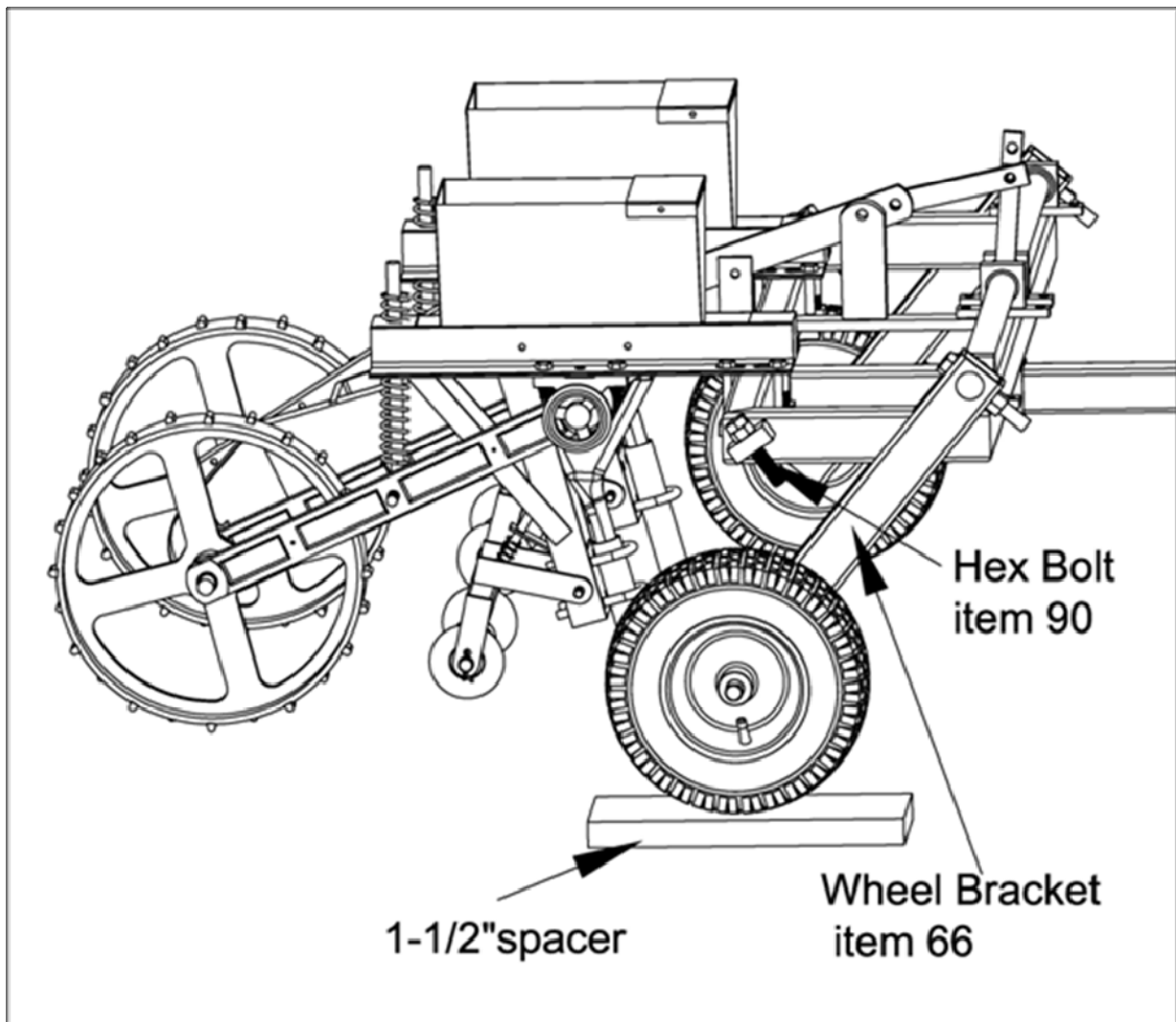

Figure 12

Setting Planter Seed Depth

1. Place the planter on a flat level surface. Lower the planter until the two coulter assemblies item 23, rest on the flat surface. Be certain that main frame and tongue are level.
2. Determine how deep the seed needs to be planted that you are going to plant. i.e. 1", 1-1/2", 2". We will be setting this planter up at 1-1/2" seed depth in this set up.
3. Back out hex bolt, item 90, until the wheel assembly can be raised off the flat surface. Place a 1-1/2" spacer under wheel. See figure 12.
4. Turn the hex bolt, item 90, back in until contacts item 66, wheel bracket. Continue tightening hex bolt until coulter assembly starts to lift off flat surface. Tighten jam nut, item 91. Repeat for opposite side. The planter is now set for 1-1/2" depth.

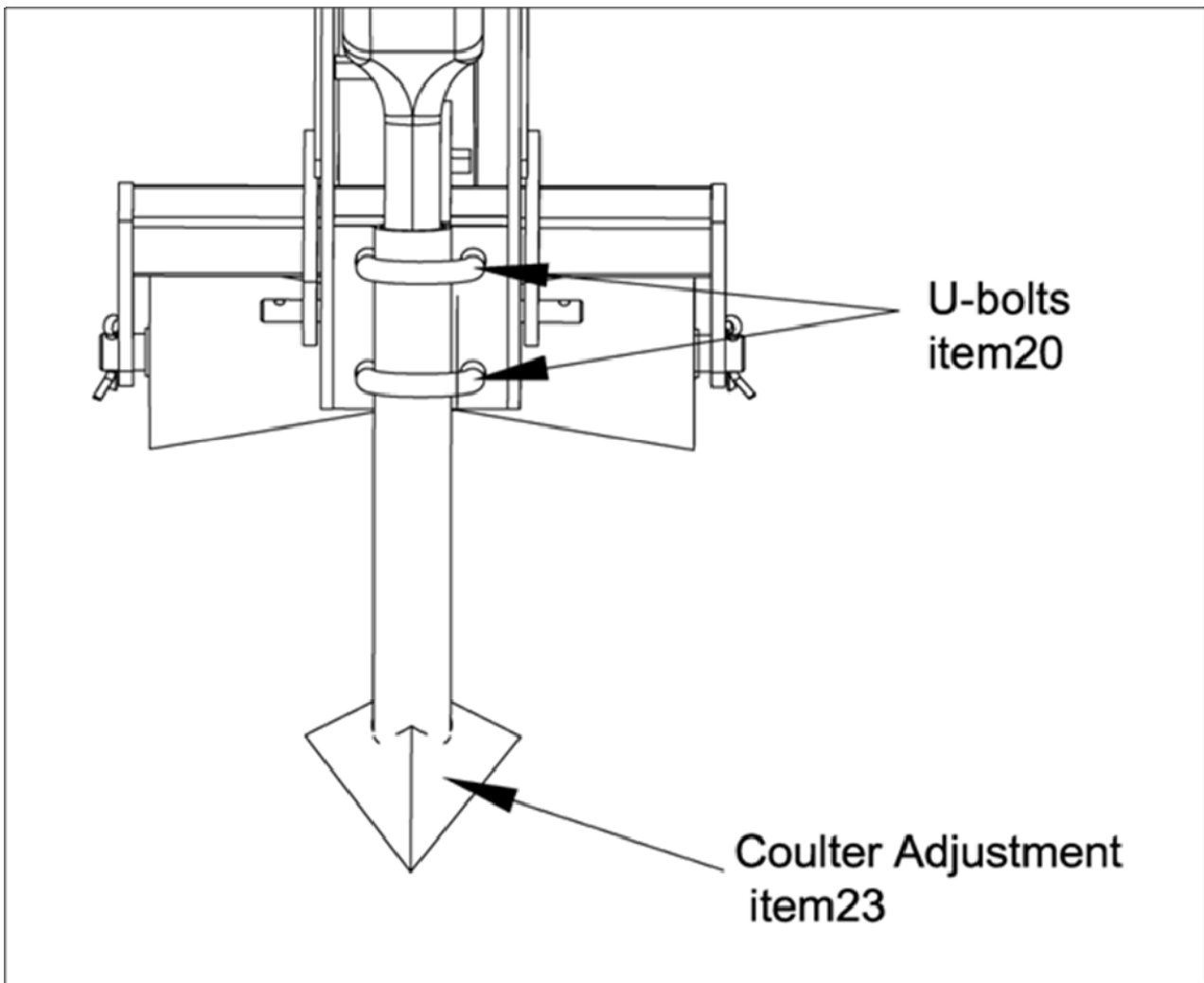

Figure 13

Coulters Adjustment

5. If the depth of planter cannot be achieved because the wheel brackets, item 66, contact item 90 hex bolt mount, the coulters assembly will have to be moved down.
6. To move coulters assembly down raise planter off of flat surface, loosen the u-Bolts item 20 and lower coulters assembly down. Retighten U-bolts. See figure 13. Repeat steps 1 through 4 again.

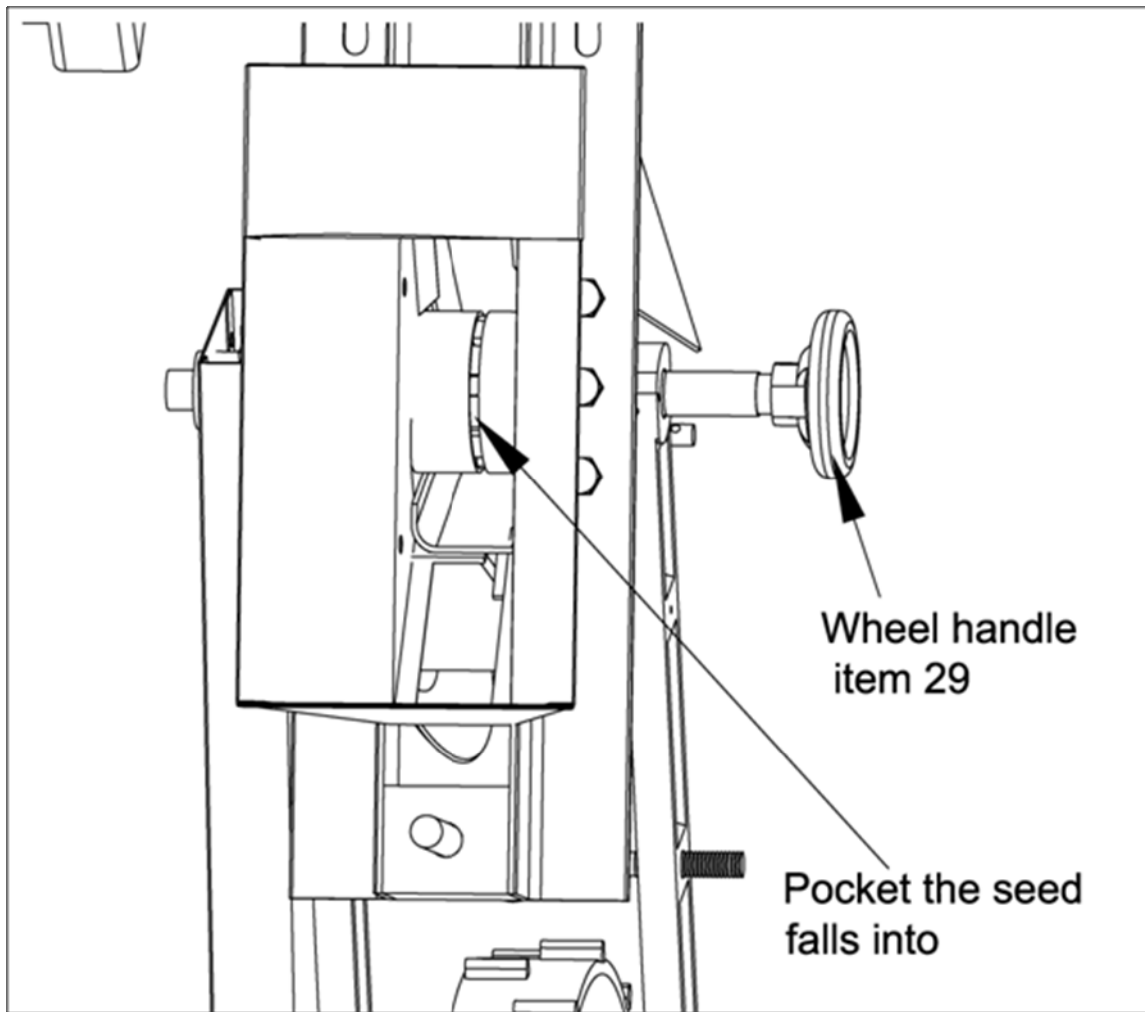

Figure 14

Adjustment for Seed Size

The wheel handle item 29 on the side of planter assembly is used to adjust the size of the pocket that the seed will fall into and be metered out of the hopper assembly. Turning the wheel handle clockwise makes the pocket smaller and counter clockwise enlarges it. See figure 14.

Note: opening up the pocket so more than one seed will fit into pocket, and will give more population of plants.

Concept of operation of planter.

As the planter is pulled forward the black steel wheel is ground driven. The black steel wheel drives the plastic seed hub inside the hopper. As the plastic hub turns the seed drops into the seed pockets. The seed then travels out the hopper via the seed pocket and then is dropped into seed tube. The seed then is placed into the ground and then is covered up by the rear roller.

Trouble Shooting Guide	
Problem	Solution
Planter will not lower	Check to see if lockpin for handle is removed
Planter will not drop seed out of hopper.	Check to see that black steel wheel is contacting ground and is rotating when being pulled forward.
Planter dropping seed erratically.	Make sure black steel wheel is not sliding on to loose of soil. Wheel handle (item 27) may have to be adjusted so the seed pocket is larger.
Planter not planting seed to the proper depth.	Adjust hex bolt (item 90) on the main frame assembly to achieve the proper depth.

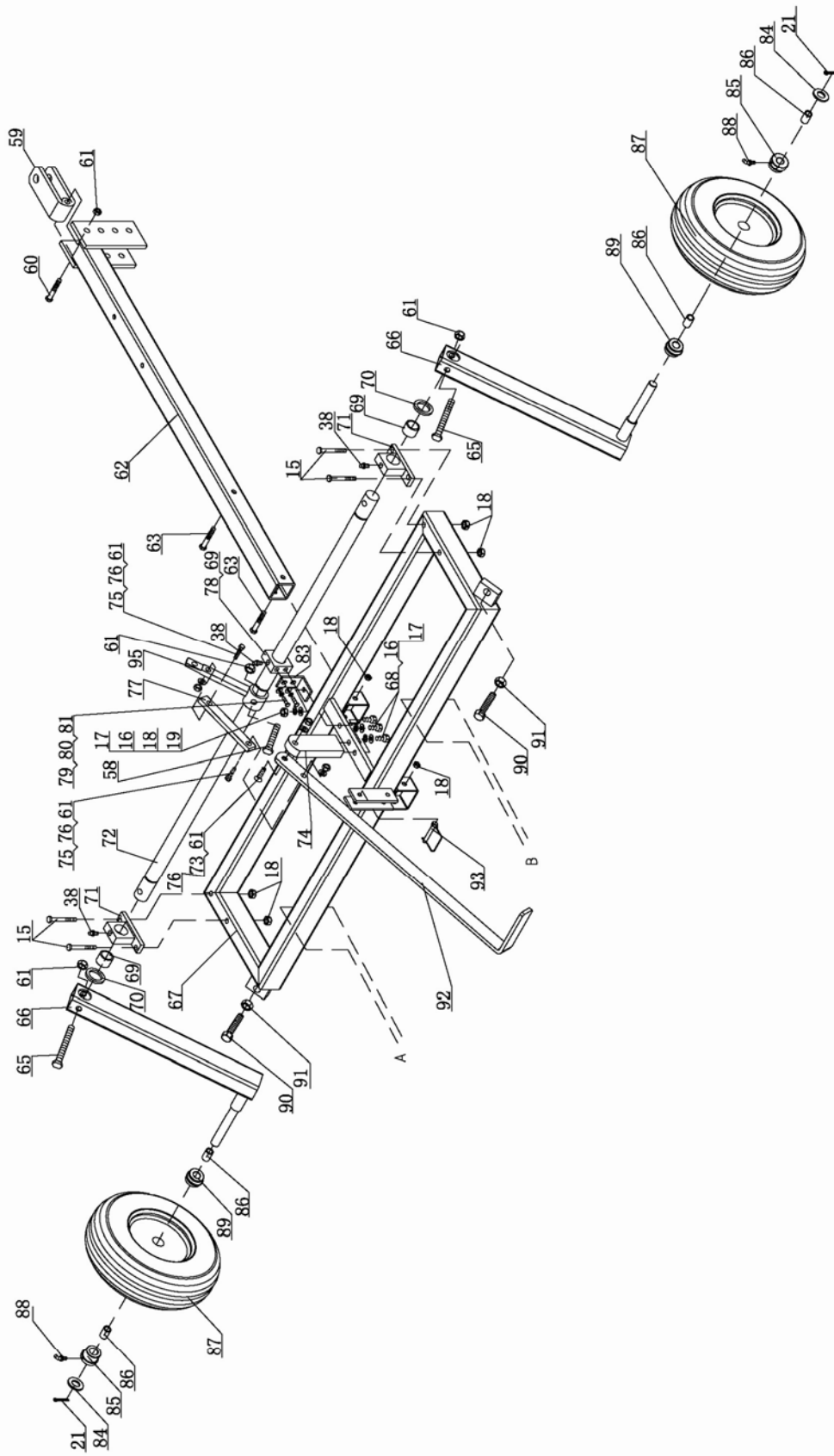

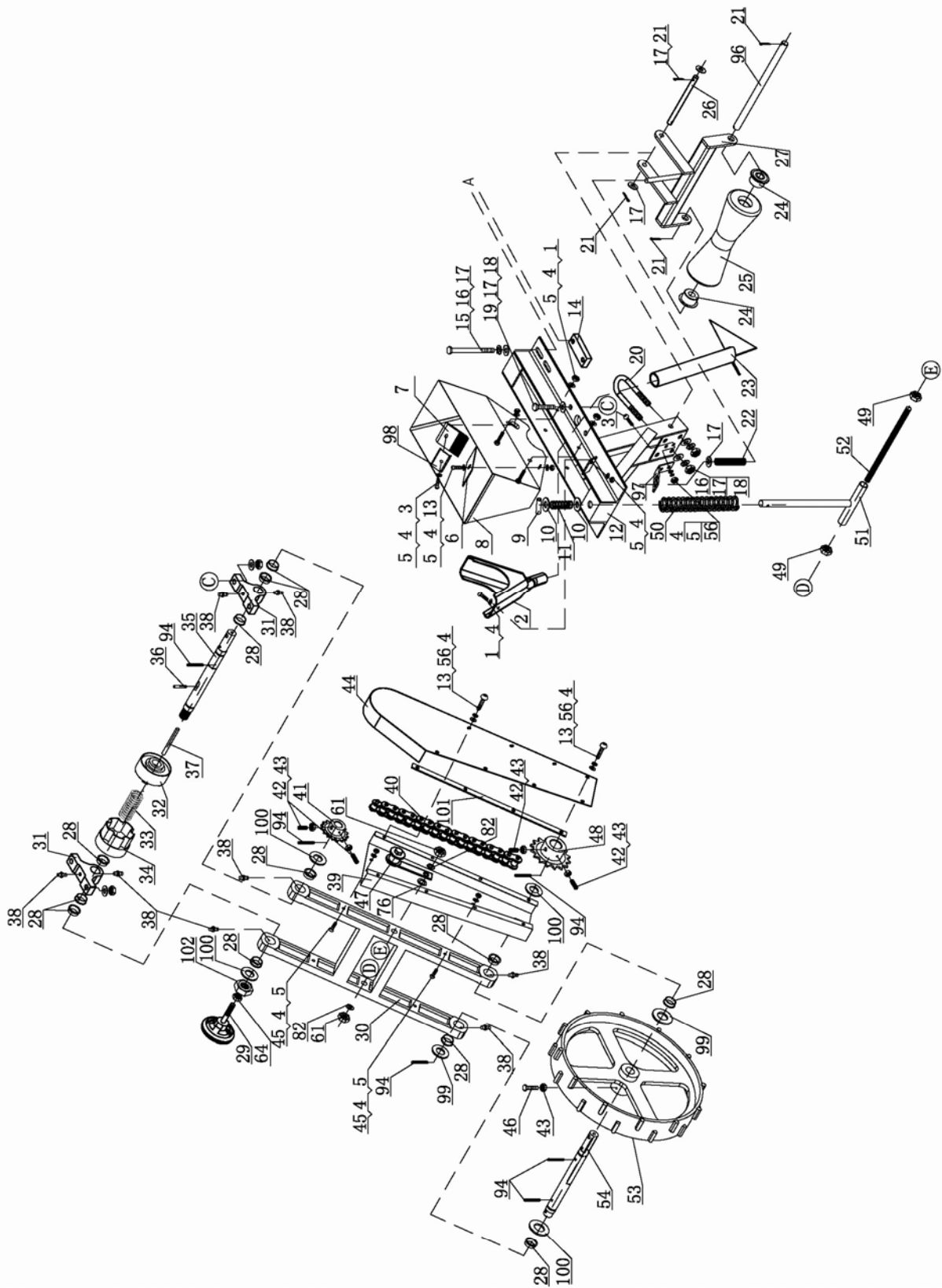

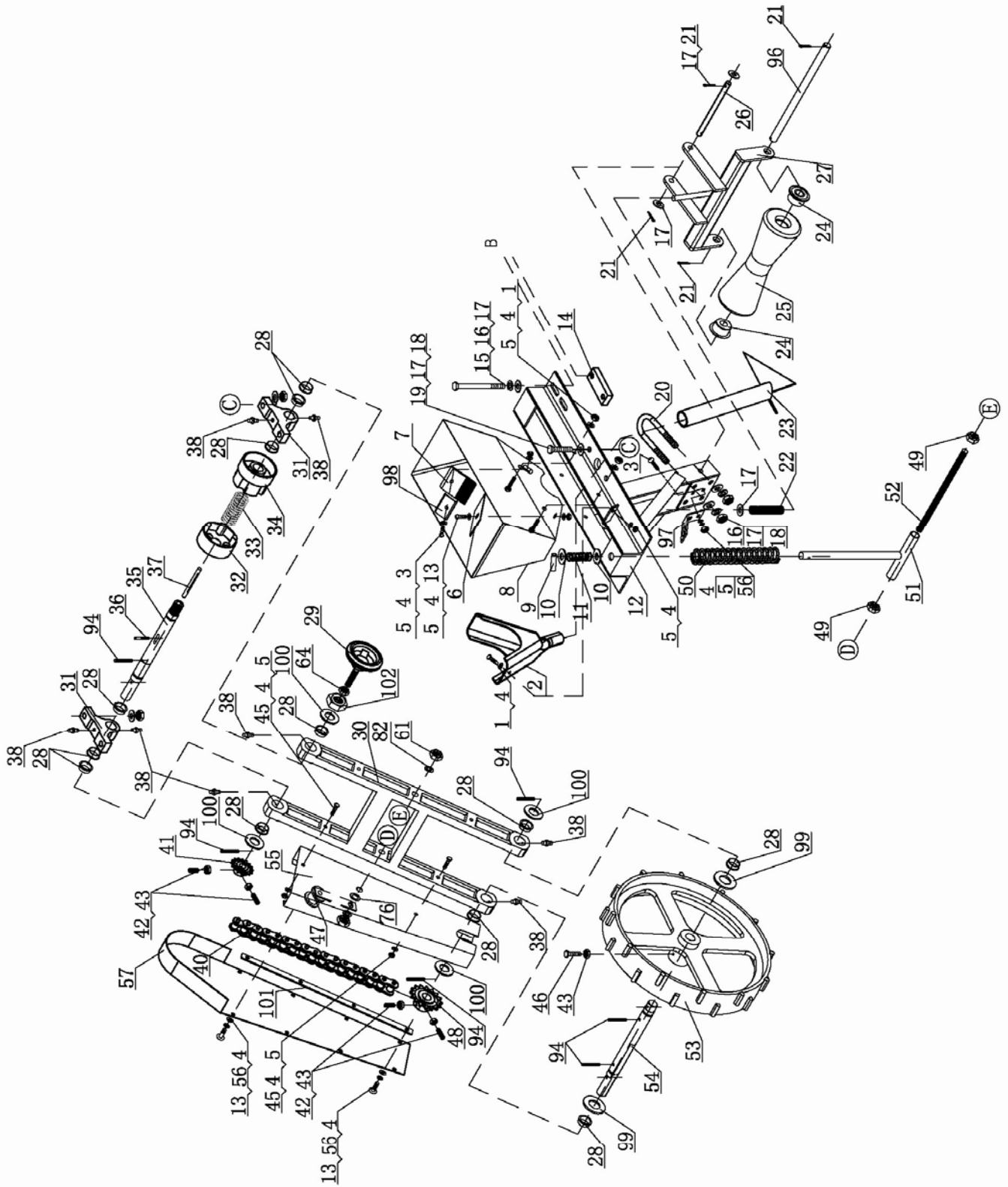

Part No.	#	Description	Qty.	Part No.	#	Description	Qty.
14792	1	Hex Bolt M6x16	10	14825	52	Thread Rod	2
14793	2	Plastic Hopper	2	14826	53	Hub	1
14791	3	Screw M6x20	6	14828	54	Hub Shaft	20
12121	4	Flat Washer Ø6	40	14829	55	Left Protection Cover	1
955416	5	Nylon Lock Nut M6	22	12125	56	Lock Washer Ø6	1
14794	6	Back Plate inside	2	14830	57	Left Cover	1
14795	7	Brush Assy	2	14778	58	Hex Bolt M12x65	1
14796	8	Corn Hopper	2	14831	59	Tongue Connector	1
14772	9	Lock Pin Ø5x30	2	14779	60	Hex Bolt M12x90	1
14305	10	Flat Washer Ø16	4	13671	61	Nylock Nut M12	11
14797	11	Spring 1	2	14832	62	Tongue	1
14798	12	Hopper Bracket	2	14780	63	Hex Bolt M10x75	2
14789	13	Phillips Screw M6x12	18	12102	64	Nylock Nut M10	2
14799	14	Rectangle Plate	4	13767	65	Hex Bolt M12x80	2
14773	15	Hex Bolt M10x85	12	14833	66	Wheel Bracket	2
14774	15	Lock Washer Ø10	15	14834	67	Frame	1
12101	17	Flat Washer Ø10	27	10233	68	Hex Bolt M10x25	2
NB729	18	Hex Nut M10	19	14835	69	Composite Bearing Ø32x20	3
13273	19	Hex Bolt M10x35	9	14781	70	Washer Flat Ø30	2
14800	20	"U" Bolt	4	14836	71	Bearing Base	2
14775	21	Cotter Pin Ø4x30	10	14838	72	Axle Weldment	1
14801	22	Small Spring	2	14782	73	Phillips Screw M12x45	1
14802	23	Colter Assy	2	14837	74	Handle Pivot Mount	1
14803	24	Bearing	4	14783	75	Hex Bolt M12x40	2
14804	25	Rubber Covering Roller	2	14784	76	Flat Washer Ø12	5
14805	26	Pin	2	14839	77	Connecting Plate	1
14806	27	Covering Roller Frame Assy	2	14840	78	Middle Bearing Base	1
14807	28	Composite Bearing	24	11993	79	Hex Bolt M8x16	2
14808	29	Wheel Handle	2	13822	80	Flat Washer Ø8	2
14809	30	Connect Bar	2	LS1402	81	Lock Washer Ø8	2
14810	31	Bearing Bracket Ass'y	4	14785	82	Lock Washer Ø12	4
14811	32	Control Cover	2	14841	83	Bearing Seat Angle Steel	1
14812	33	Control Spring	2	14786	84	Flat Washer Ø20	2
14813	34	Control Bushing Inside	2	14842	85	Axle Bushing, Outside	2
14814	35	Axle for Adjuster	2	14843	86	Complex Bearing 19x40	4
14815	36	Rod Pin Ø5x30	2	14844	87	Tire	2
14816	37	Rod Pin Ø6x80	2	14790	88	Bent Oil Fitting M6	2
14817	38	Oil Fitting M6	19	14845	89	Axle Bushing, Inside	2
14818	39	Right Protection Cover	1	14787	90	Hex Bolt M16x90	2
14819	40	Chain	2	14788	91	Hex Nut M16	2
14852	41	11 teeth Sprocket	2	14846	92	Handle	1
14776	42	Hex Bolt M8x25	8	14847	93	Lock Pin	1
14853	43	Hex Nut M8	10	14848	94	Lock Pin Ø5x40	12
14820	44	Right Cover	1	14849	95	Axle Handle Weldment	1
10936	45	Hex Bolt M6x30	4	14850	96	Clamping Roller Axle	2
14777	46	Hex Bolt M8x35	2	14851	97	Slotted Plate	2
14821	47	Trolley	4		98	Brush Press Plate	2
14822	48	16 teeth Sprocket	2		99	Flat Washer Ø22	4
13140	49	Nut M12	2		100	Flat Washer Ø20	8
14823	50	Long Spring	2		101	Washer	4
14824	51	"T" tube Weldment	2		102	Nylon Lock Nut M20	2

For replacement parts and technical questions, please call **1-218-943-6296**.

WARRANTY

One-year limited parts warranty



TG
PO Box 203
Miltona, MN 56354
MADE IN CHINA