



48" Dethatcher

OWNER'S MANUAL



WARNING:

Read carefully and understand all **ASSEMBLY AND OPERATION INSTRUCTIONS** before operating. Failure to follow the safety rules and other basic safety precautions may result in serious personal injury.

Item# DT-48T

Thank you very much for choosing this Yard Tuff product! For future reference, please complete the owner's record below:

Model: ___DT-48T___ Purchase Date: _____

Save the receipt, warranty and these instructions. It is important that you read the entire manual to become familiar with this product before you begin using it.

This product is designed for certain applications only. The manufacturer cannot be responsible for issues arising from modification. We strongly recommend this product not be modified and/or used for any application other than that for which it was designed. If you have any questions relative to a particular application, DO NOT use the product until you have first contacted us to determine if it can or should be performed on the product.

For technical questions please call **1-218-943-6296**.

INTENDED USE

This tow-behind dethatcher helps prevent roots, leaves, grass clippings and other small vegetation from inhibiting the growth of your lawn. The dethatcher has 24 oil-tempered spring tines that comb the matted layer of thatch on the surface where it can be easily bagged or mulched.

TECHNICAL SPECIFICATIONS

| Item | Description |
|---------------|-------------|
| Working Width | 48" |
| Wheels | 7" Poly |
| Construction | Steel |

GENERAL SAFETY RULES



WARNING: Read and understand all instructions. Failure to follow all instructions listed below may result in serious injury.



CAUTION: Do not allow persons to operate or assemble this dethatcher until they have read this manual and have developed a thorough understanding of how the dethatcher works.



WARNING: The warnings, cautions, and instructions discussed in this instruction manual cannot cover all possible conditions or situations that could occur. It must be understood by the operator that common sense and caution are factors which cannot be built into this product, but must be supplied by the operator.

SAVE THESE INSTRUCTIONS

WORK AREA

- **Keep work area clean**, free of clutter and well lit. Cluttered and dark work areas can cause accidents.
- **Keep children and bystanders** away while operating the dethatcher. Distractions can cause you to lose control, so visitors should remain at a safe distance from the work area.
- **Be aware of all power lines, electrical circuits**, water pipes and other mechanical hazards in your work area, particularly those hazards below the work surface hidden from the operator's view that may be unintentionally contacted and may cause personal harm or property damage.
- **Be alert of your surroundings.**

PERSONAL SAFETY

- **Stay alert**, watch what you are doing and use common sense when using the dethatcher. Do not use the dethatcher while you are tired or under the influence of drugs, alcohol or medication. A moment of inattention while operating the dethatcher may result in serious personal injury.
- **Dress properly.** Do not wear loose clothing, dangling objects, or jewelry. Keep your hair, clothing and gloves away from moving parts.
- **Use safety apparel and equipment.** Use safety goggles or safety glasses with side shields which comply with current national standards, or when needed, a face shield. Also use non-skid safety shoes, hardhat, gloves, dust collection systems, and hearing protection when appropriate.

DETHATCHER USE AND CARE

- **Do not modify dethatcher in any way.** Unauthorized modification may impair the function and/or safety and could affect the life of the equipment. There are specific applications for which the dethatcher was designed.
- **Always check for damaged or worn out parts before using the dethatcher.** Broken parts will affect the dethatcher operation. Replace or repair damaged or worn parts immediately.
- **Do not exceed the dethatcher load capacity.**
- **Distribute the load evenly.** Uneven loads may cause the dethatcher to tip, resulting in personal injury to the operator or others.
- **Use the dethatcher on flat and level surfaces** capable of supporting the dethatcher and its maximum load. Pulling or pushing a load on a slanted or uneven surface can result in loss of control.
- **Storing dethatcher.** When the dethatcher is not in use, store it in a secure place out of the reach of children. Inspect it for good working condition prior to storage and before re-use.

ASSEMBLY

See hardware listing and check all parts before starting assembly

Tools Required:

- 2 – 1/2" wrenches
- 1 – 3/4" wrench
- 1 – 9/16" wrench
- 1 – Medium pliers

PARTS LISTING

Main Parts:

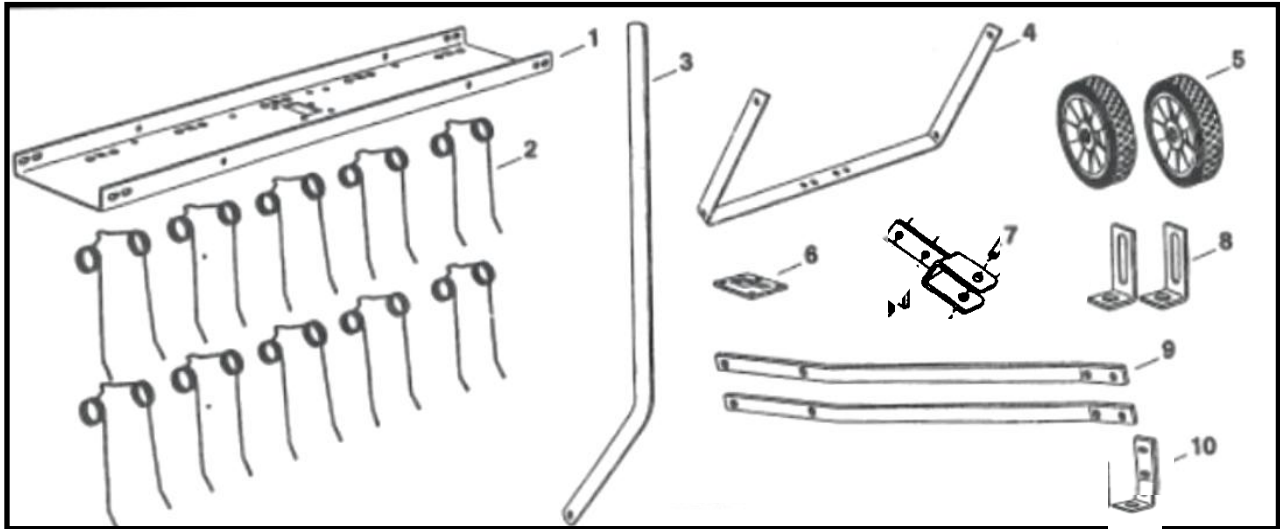

| Reference Number | Quantity Included | Part Description |
|------------------|-------------------|-------------------------|
| 6 | 1 | Main Body De-Thatcher |
| 3 | 12 | Spring Tines |
| 10 | 1 | Lift Handle |
| 9 | 1 | Axel Bracket |
| 5 | 2 | Wheel |
| 8 | 1 | Lift Plate |
| 2 | 1 | Hitch Bracket |
| 1 | 2 | Hitch Arm Mount Bracket |
| 7 | 2 | Hitch Arm |
| 25 | 1 | Tow Angle Bracket |

Hardware:

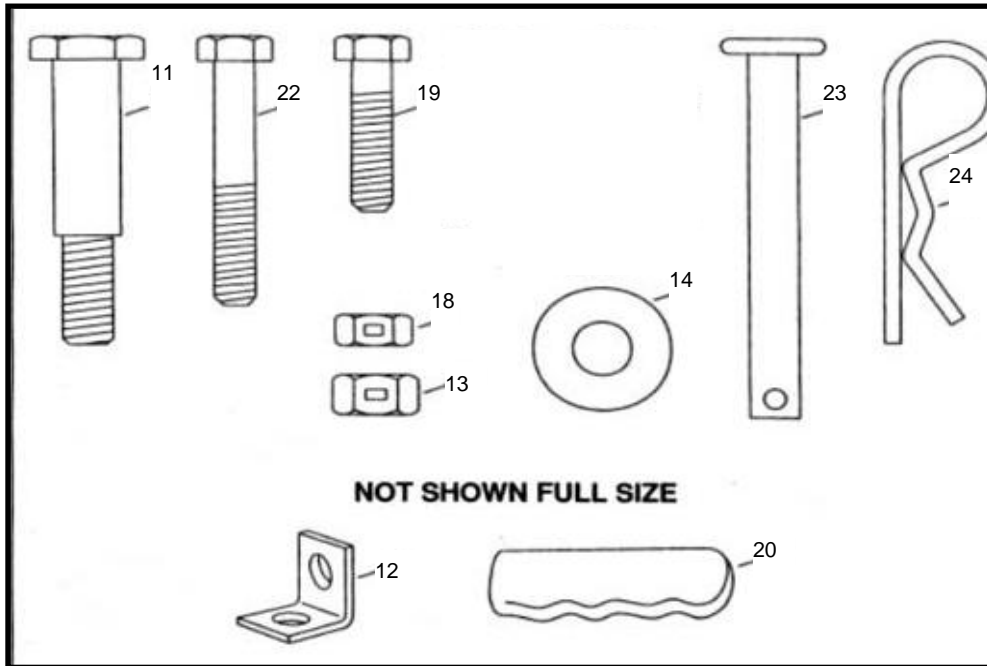

| Reference Letter | Quantity Included | Part Description |
|------------------|-------------------|---------------------|
| 11 | 2 | Shoulder Bolt |
| 22 | 2 | 5/16" x 1-1/4" Bolt |
| 19 | 31 | 5/16" x 1" Bolt |
| 23 | 1 | Hitch Pin |
| 24 | 1 | Cotter Pin |
| 18 | 33 | 5/16" Lock Nut |
| 13 | 2 | 3/8" Lock Nut |
| 14 | 12 | 5/16" Flat Washer |
| 12 | 4 | Short Angle Bracket |
| 20 | 1 | Handle Grip |

Step 1: Attach adjustment lift plate to main body

Attach lift plate to main body of the tine dethatcher using (#19) 5/16 x 1" Bolts and Lock nuts as shown in Figure #1. Fully tighten bolts.

Step 1 Hardware Needed:

4 – 5/16 x 1" Bolt (#19)

4 – 5/16" Lock Nut (#18)

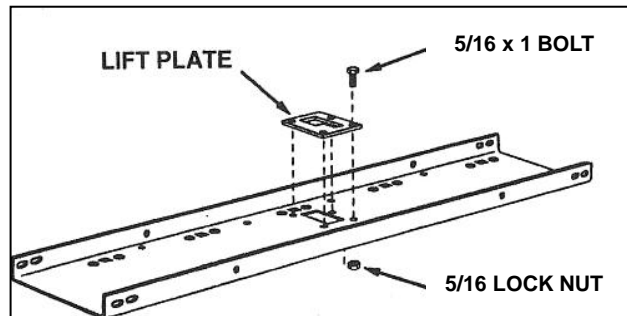

Step 2: Attach angle brackets to main body

Turn over the main body as shown in figure #2. Attach two shorter angle brackets and two hitch arm mount brackets onto the rear of the main body, using (#19) 5/16"x 1" bolts and lock nuts. Refer to figure #2 for bolt locations. Next, attach two shorter angle brackets onto the front of the main body, using 5/16"x1" bolts and lock nuts. Tighten only slightly.

Step 2 Hardware Needed:

6 – 5/16" x 1" Bolt (#19)

6 – 5/16" Lock Nut (#18)

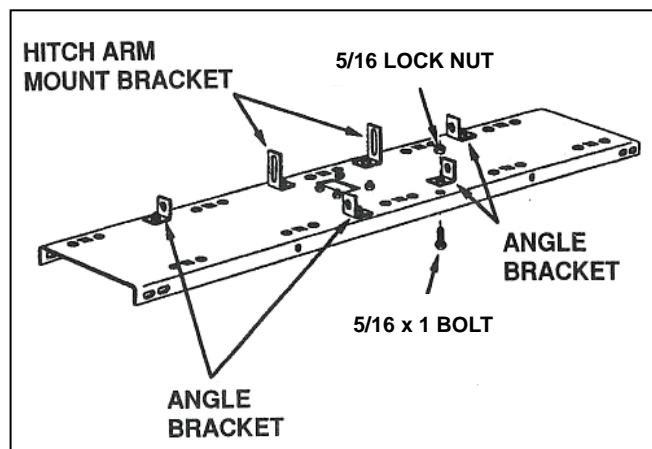

Figure #2

Step 3: Attach hitch arms to angle brackets

Attach each hitch arm to the outside of the angle brackets, using 5/16" x 1" bolts and lock nut. See figure #3 for hitch arm locations. Do Not Fully Tighten Bolts.

Step 3 Hardware Needed:

4 – 5/16" x 1" Bolt (#19)

4 – 5/16" Lock Nut (#18)

Figure #3

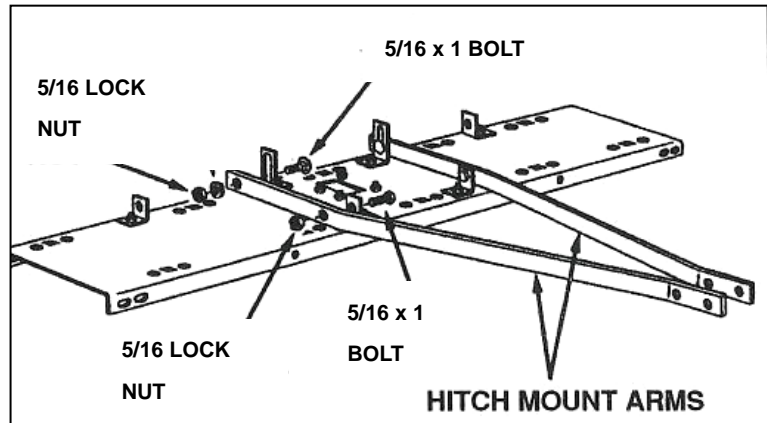

Step 4: Connect front of hitch arms

Attach the front of the two hitch arms **with the hitch bracket** using 5/16 x 1-1/4" Bolts and lock nuts. Ok to tighten. See figure #4.

Step 4 Hardware Needed:

2 – 5/16" x 1-1/4" Bolt (#22)

2 – 5/16" Lock Nut (#18)

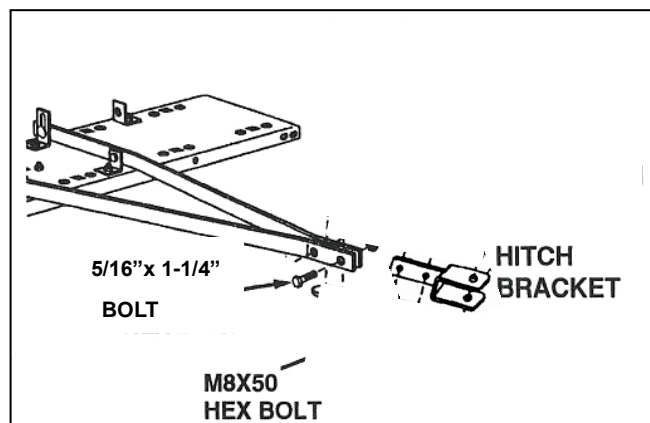

Step 5: Fully tighten bolts in the following order

Front hitch arm bolts in Step 4.

All angle bracket bolts from Step 2.

All angle bracket bolts from Step 3.

Insert Hitch Pin into the hitch pin bracket as shown in figure #4 above. Insert the cotter pin into the hitch pin to hold in-place.

Step 5 Hardware Needed:

1 – Hitch Pin (#23)

1 – Cotter Pin (#24)

Step 6: Attach axel bracket to main body

Attach the axle bracket to outside of angle brackets, using 5/16" x 1" bolts and lock nuts. See figure #7. Only tighten so the wheel bracket can move up and down.

Step 7 Hardware Needed:

2 – 5/16" x 1" Bolt (#19)

2 – 5/16" Lock Nut (#18)

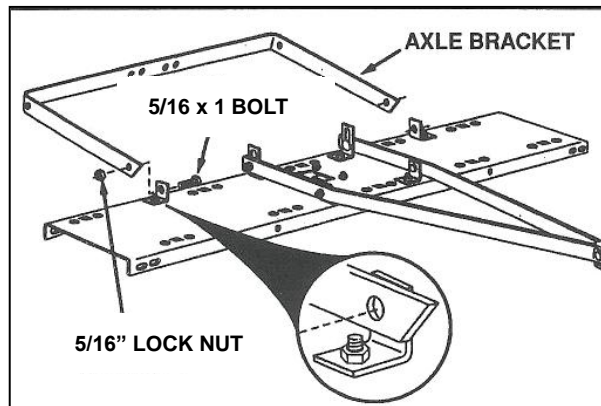

Figure #7

Step 7: Attach the wheels

Attach each wheel using Shoulder Bolt and Lock nut. Tighten bolts.

Note: bolts only tighten to end of threads; wheels need to spin on the bolts. Refer to figure #8.

Step 8 Hardware Needed:

2 – Shoulder Bolt (#11)

2 – 3/8" Lock Nut (#13)

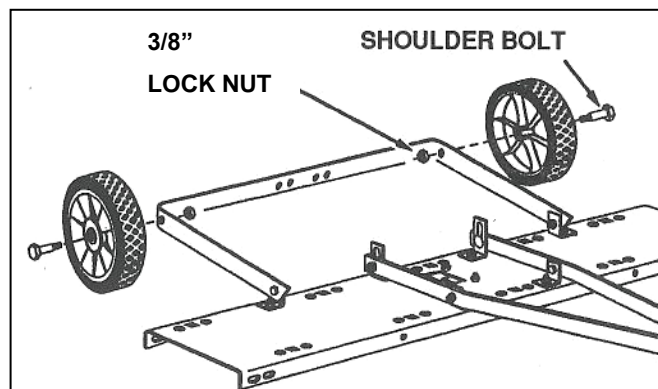

Step 8: Attach steel tines to the main body

Attach each tine using 5/16" x 1" bolt, 5/16" flat washer, and 5/16" lock nut. Refer to figure 8 for the position of the tine. Tine should sit between the metal bumps on main body. Fully tighten.

Step 8 Hardware Needed:

- 12 – 5/16" x 1" Bolt (#19)
- 12 – Flat Washer (#14)
- 12 – 5/16" Lock Nut (#18)

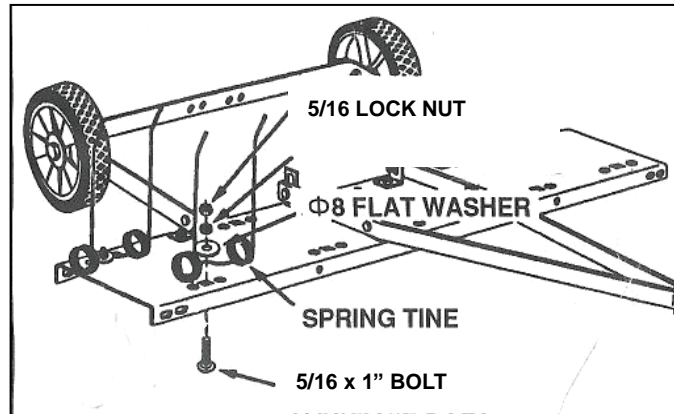

Figure #8

Step 9: Attaching Lift Handle

Turn dethatcher upright onto the tines and wheels. See figure #10 for the following.

Attach Tow angle bracket to the axel bracket using 5/16" x 1" bolt with lock nut. Do not tighten.

Next, position the lift handle through the lift plate on the main body attaching it to the tow angle bracket using 5/16" x 1" bolt and lock nut.

Now tighten all bolts in this step.

Step 9 Hardware Needed:

- 3 – 5/16" x 1" Bolt (#19)
- 3 – 5/16" Lock Nut (#18)

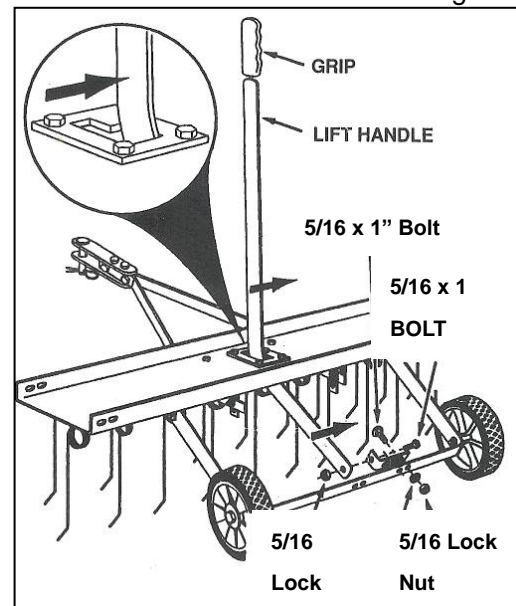

Figure #10

Final Step: Adjust to towing vehicle

Make sure you are on a level surface when making this adjustment. See figure below for reference.

Attach the fully assembled lawn dethatcher to the towing vehicle.

Next, place lawn dethatcher in operating position. (Lower adjustment arm)

Adjust the bolts at the back of the hitch arms until the front

and back rows of tines equally touch the ground. Re-tighten bolts.

Note: adjustment must be changed for each different towing vehicle.

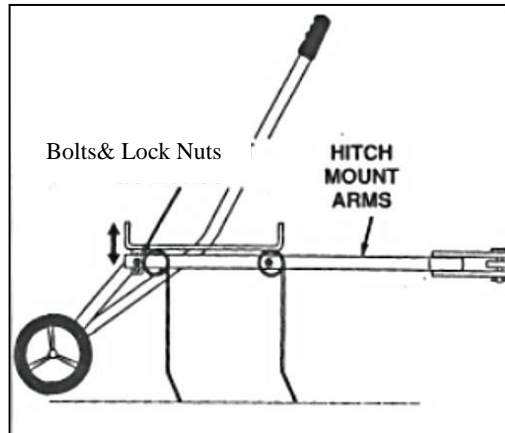

OPERATION



WARNING: Do not operate this dethatcher above 5 MPH.

Before using, check that all connections are tight. Weight may be added to the top of the main body, secure weight to main body.

MAINTENANCE

- **Maintain your dethatcher.** It is recommended that the general condition of any dethatcher be examined before it is used. Keep the dethatcher in good repair by adopting a program of conscientious repair and maintenance. If any abnormal vibrations or noise occurs, have the problem corrected before further use. Have necessary repairs made by qualified service personnel.
- Regularly lubricate wheels and wheel shoulder bolts as needed. Store in a dry place away from moisture or water to avoid rusting.

PARTS DIAGRAM and LISTING

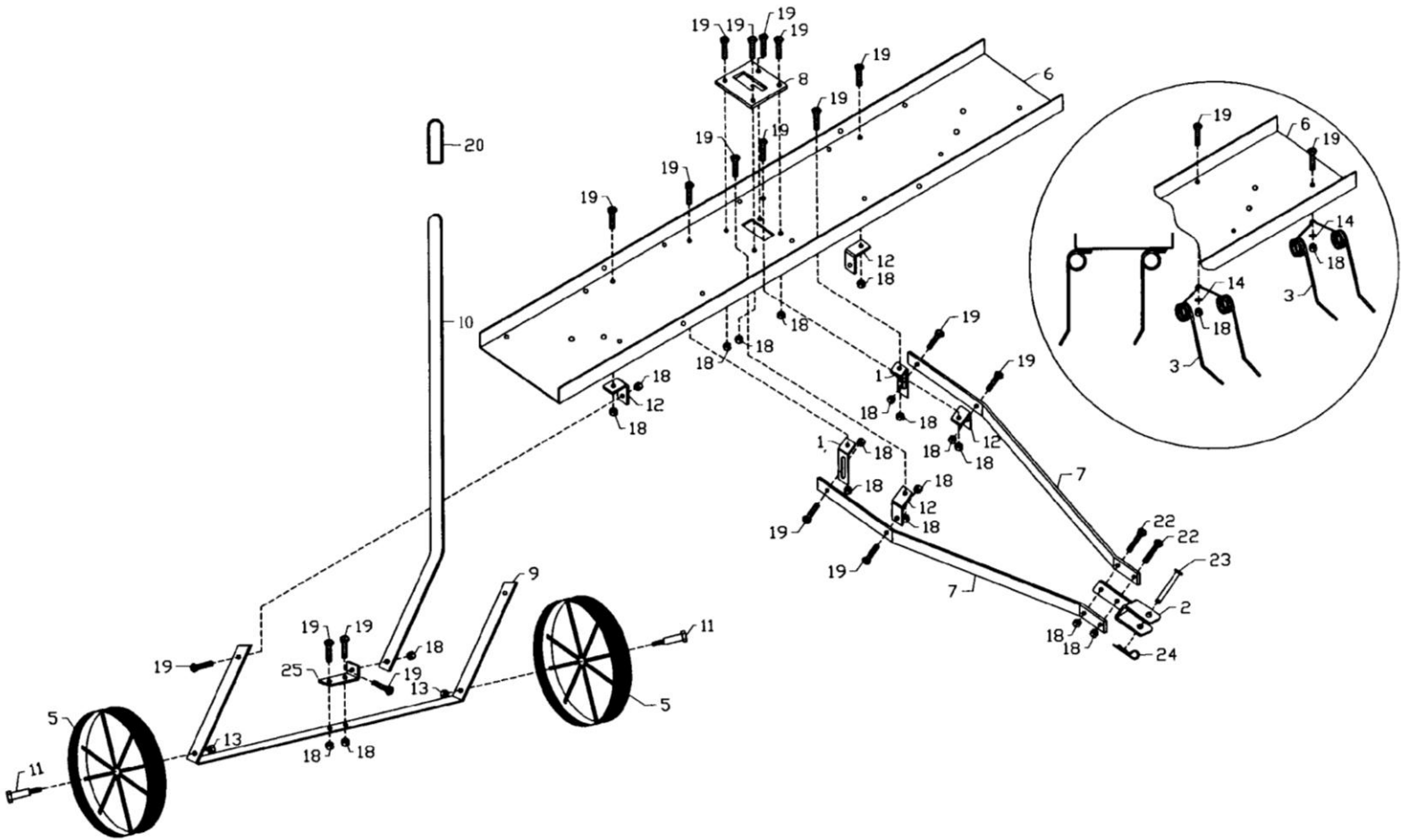

| REF# | Qty | Description | REF# | Qty | Description |
|------|-----|-------------------------|------|-----|---------------------|
| 1 | 2 | Hitch Arm Mount Bracket | 13 | 2 | 3/8" Lock Nut |
| 2 | 1 | Hitch Bracket | 14 | 12 | 5/16" Flat Washer |
| 3 | 12 | Spring Tine | 15 | | Not used this model |
| 4 | | Not used for this model | 16 | | Not used this model |
| 5 | 2 | Wheel | 17 | | Not used this model |
| 6 | 1 | Main Body Dethatcher | 18 | 33 | 5/16" Lock Nut |
| 7 | 2 | Hitch Arm | 19 | 31 | 5/16" x 1" Bolt |
| 8 | 1 | Lift Plate | 20 | 1 | Handle Grip |
| 9 | 1 | Axle Bracket | 21 | | Not used this model |
| 10 | 1 | Lift Handle | 22 | 2 | 5/16" x 1-1/4" Bolt |
| 11 | 2 | Shoulder Bolt | 23 | 1 | Hitch Pin |
| 12 | 4 | Short Angle Bracket | 24 | 1 | Cotter Pin |
| | | | 25 | 1 | Tow Angle Bracket |

For replacement parts and technical questions, please call **1-218-943-6296**.

WARRANTY

One-year limited warranty



TG
PO BOX 203
Miltona, MN 56354
Made in Taiwan