

# ASSEMBLY INSTRUCTIONS

## Self-Stabilizing Hand Truck

### Table of Contents:

Parts List ..... 2

Assembly Instructions ..... 3-6

*For safe, efficient product use, Magline recommends inspecting equipment regularly and replacing damaged components immediately.*



Watch Assembly Video/  
[www.youtube.com/maglineinc](http://www.youtube.com/maglineinc)



Download Assembly Instructions/  
[magliner.com/assembly-instructions](http://magliner.com/assembly-instructions)



# **MAGLINER**®

*Magline, Inc.*

1205 W. Cedar Street • Standish, MI 48658 USA

1-800-MAGLINE (624-5463) • (989) 512-1000 (outside U.S. & Canada)

[www.magliner.com](http://www.magliner.com)

**TOOLS REQUIRED**

- (2) 1/2" COMBINATION WRENCH OR SOCKET
- (1) #3 PHILLIPS SCREWDRIVER
- (1) HAMMER

- (1) PLIERS
- (1) 7/16" COMBINATION WRENCH OR SOCKET
- (1) 3/16" ALLEN WRENCH

Description	Qty.	Part No.
Handle	1	Varies
Frame	1	Varies
RH wheel bracket	1	210123
LH wheel bracket	1	210124
Nose plate	1	Varies
18" axle (16.81" for 815 wheels only)	1	22101 (or 22100); 22141 (or 22140) stress proof
Wheel	2	Varies
Side channel reinforcements	2	302001
Support arm - RH	1	302881
Support arm - LH	1	302880
Support clamp body	2	302901
Support clamp jaw	2	302902
Lift bar	1	302903
Rubber bumper <i>(used only with flush mount extruded aluminum or steel noses)</i>	1	302998
Pan head machine screw - 1/4"-20 x 1-3/4" long <i>Used on models with extruded aluminum nose without vertical strap OR models with steel nose/vertical strap combination</i>	1	80106
Pan head machine screw - 1/4"-20 x 1-5/8" long <i>Used on models with steel nose without vertical strap</i>		80167
Pan head machine screw - 1/4"-20 x 1-7/8" long <i>Used on models with extruded aluminum nose/vertical strap combination</i>		80039
Hex lock nut - 1/4"-20 <i>(used with rubber bumper)</i>	1	80675
Truck loading label	1	98389
Kickstand/Multi-Directional Wheel Pack consists of items below:		
Kickstand axle	1	Varies
Roll pins for kickstand axle	2	81103
Kickstand lever assembly	1	302991
Kickstand cam	1	302995
Kickstand spring	1	302996
1/2" washer - thick	6	80782
Nylon washer - 1/2" x 1" x 1/16"	1	80171
1/2" washer - thin	6	80783
Cotter pin for wheel axle - 1/8" x 1" long	2	81077
Multi-directional wheel	2	130502 (double row) 130503 (triple row)
Hardware Pack 301034 consists of items below:		
Roll pin - 1/8" x 1-1/8"	2	190104
Hex head screw - 5/16"-18 x 1-1/2" long	2	80013
Hex head screw - 5/16"-18 x 1-1/4" long	2	80012
Hex head screw - 5/16"-18 x 2" long	4	80015
Hex lock nut - 5/16"-18	8	80676
5/8" washer - thin	2	80707
5/8" washer - thick	4	80705
Cotter pin for wheel axle - 1/8" x 1" long	2	81077
Pan head machine screw - 1/4"-20 x 1-1/2" long	4	80105
Pan head machine screw - 1/4"-20 x 3/4" long	2	80256
Hex lock nut - 1/4"-20	6	80675

Use a workbench or table of convenient height and place all components in view and within reach. It may be helpful to assemble the hand truck oriented face down. The following assembly sequence is recommended:

# 1

FRAME

MAGLINER

Top  
Parte superior

2x  
302001

# 2

For extruded and steel nose plates follow instructions in mounting bracket kit; then install rubber bumper. Bumper is not used for die-cast noses.

80105

302998

80675

# 3

2x  
80015

210123

2x  
80676

Finger tighten nuts/bolts only at this time.

# 4

Kickstand Axle

2x  
81103

# 5

Apply plastic-safe lubricant on in these places before assembly and one time per month.

80171

302991

302995

# 6

2x  
80782

80783

302996

80171

302991

302995

Select proper axle position based on the wheel diameter and the desired frame angle when hand truck is reclined.

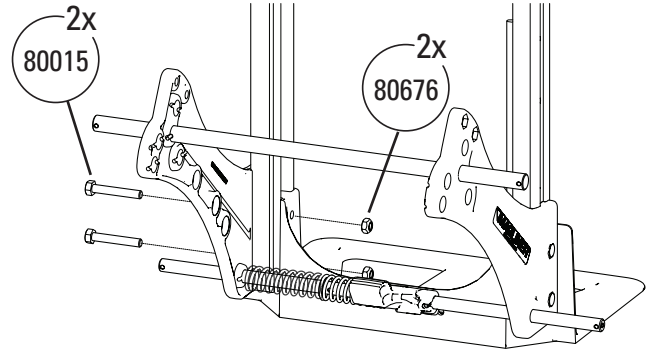
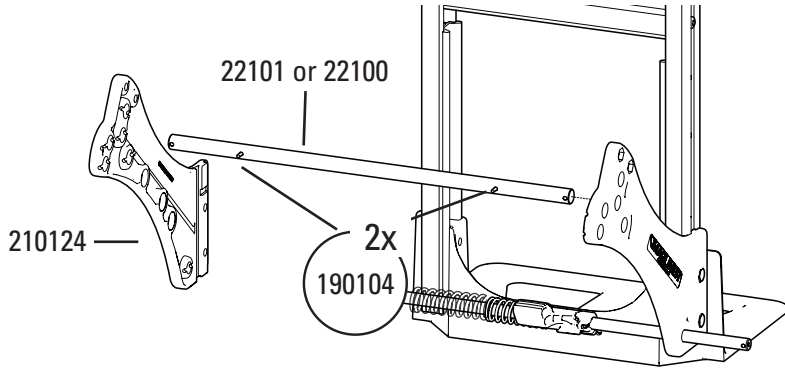

Finger tighten nuts/  
bolts only at this time.

## Set-up the recline angle to suit the load

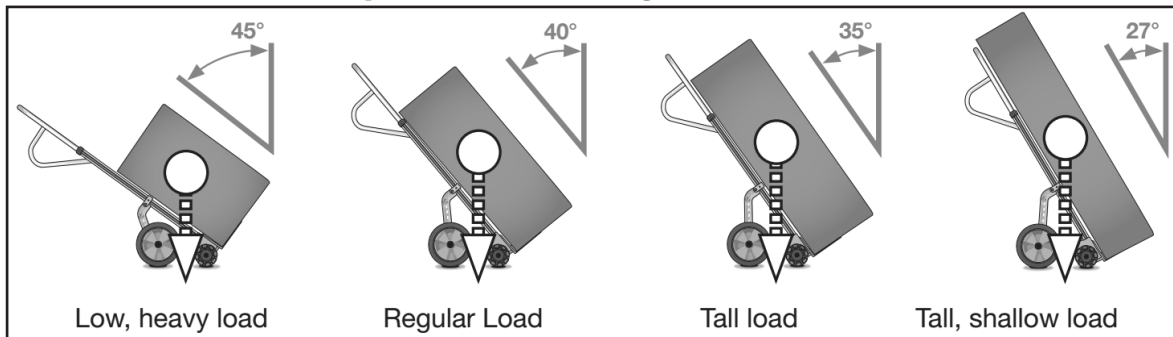

REAR AXLE POSITION	WHEEL DIA	RECLINE ANGLE (MEASURED OFF VERTICAL)
A	8"	45°
	10"	40°
B	8"	40°
	10"	35°
C	8"	38°
	10"	(see position E)
D	8"	32°
	10"	27°
E	8"	37°
	10"	32°

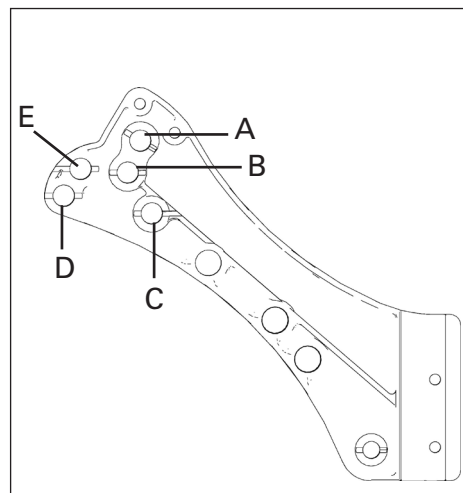

# 8

- Loosely install the support arms (302880, 302881) at the bottom to the wheel brackets.
- Loosely install the support clamp body (302901) and support clamp jaw (302902) with hardware (see close-ups, below).
- Place the lift bar (302903) between the support arms.

9a.

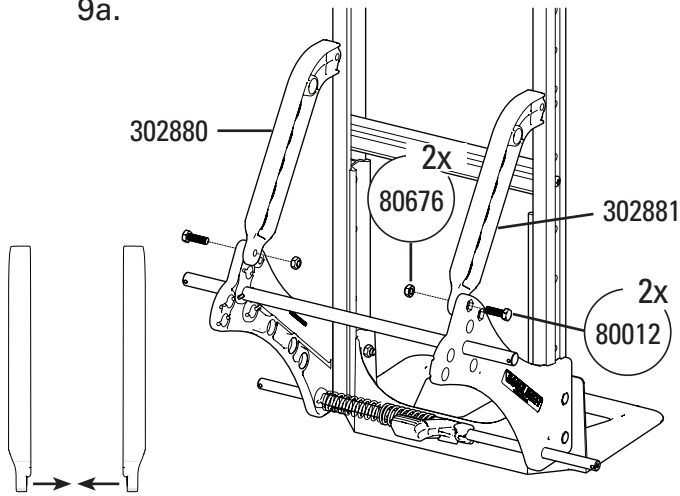

Notches on the bottom of the support arms (302880, 302881) face toward each other (see above left).

Finger tighten nuts/bolts only at this time.

Close-up of support clamp body and support clamp jaw around frame side rails.

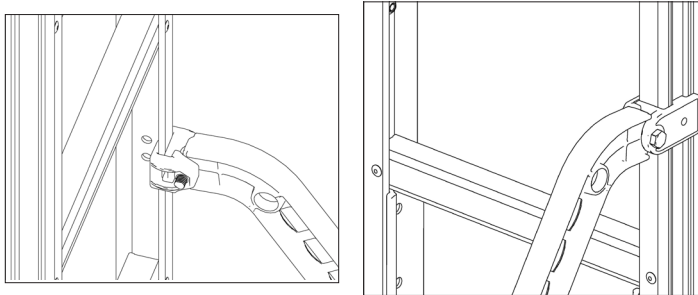

9b-c.

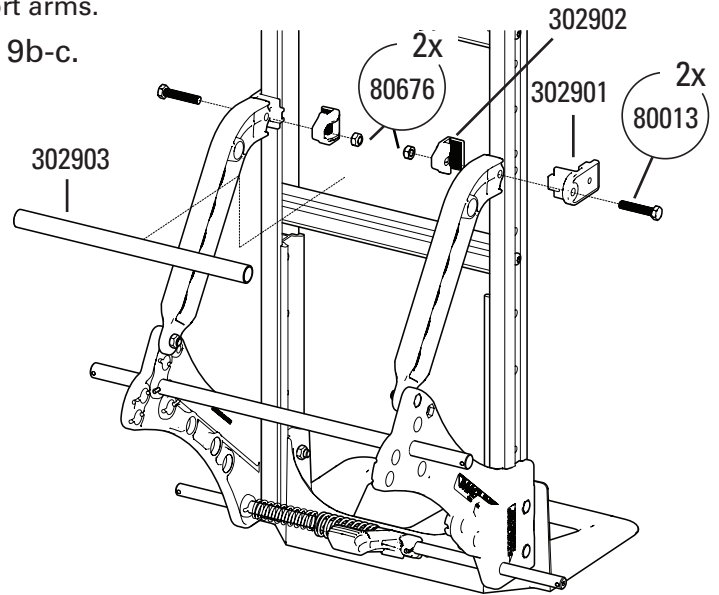

# 9

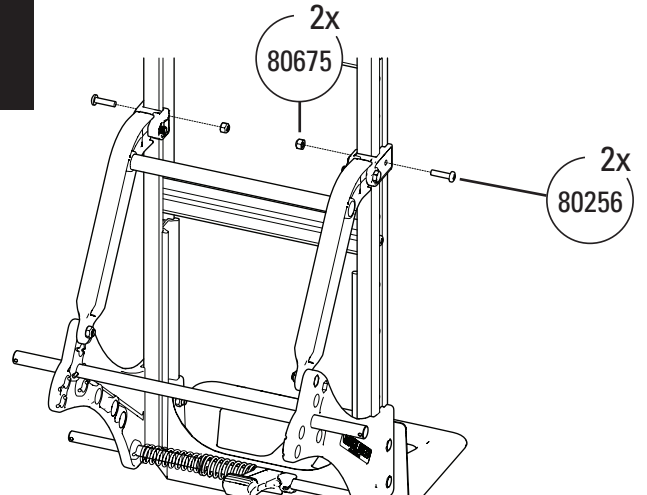

Use a screwdriver to punch a hole through the red stripe.

Finger tighten nuts/bolts only at this time.

# 10

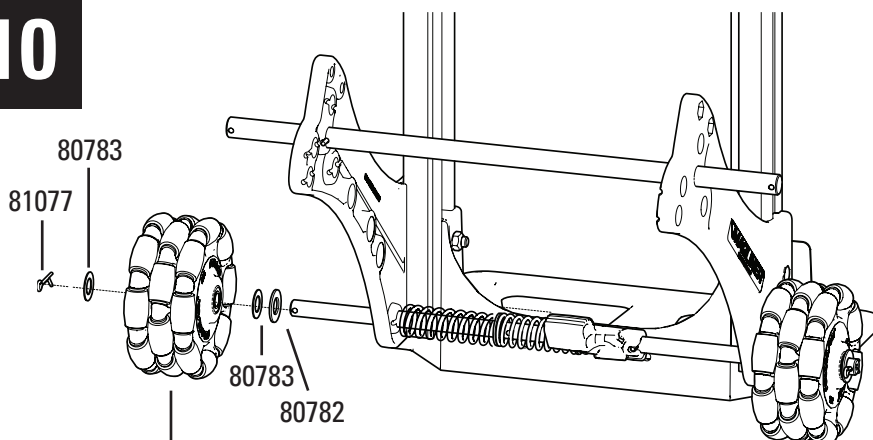

Multi-Directional Wheel

### IMPORTANT NOTE:

- Use the optimal number of extra washers in the kit to minimize side-to-side movement of the wheel on the axle which may vary slightly from diagram.

Multi-Directional Wheel	Part Number
Double row	130502
Triple row	130503

# 11

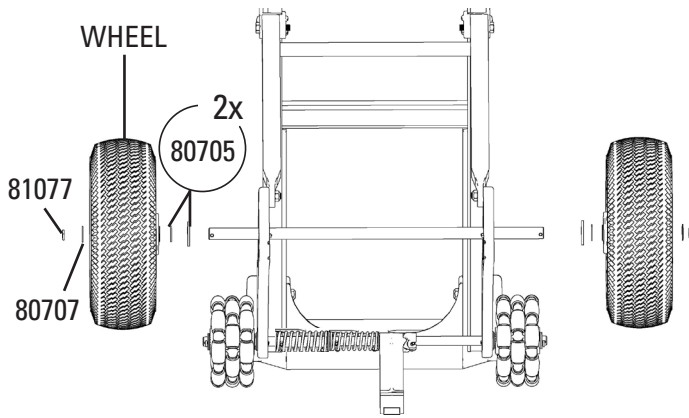

WASHER CONFIGURATIONS		
WHEEL #	WASHERS	
	80705 (THICK)	80707 (THIN)
10815	(1) Inside	(1) Outside
All other wheels (as shown)	(2) Inside	(1) Outside

Quantities listed are per wheel. THESE ARE GUIDELINES ONLY - the exact washer configuration can vary for each hand truck.

# 12

Make any final adjustments and tighten all fasteners to the specifications shown in the chart below:

<i>Fastener Torque Specification Chart</i>	
Type	Torque Specifications
5/16" -18 Hex Head Screws	120-140 in.-lbs.
1/4" -20 Pan Head Screws	50-60 in.-lbs.

# 13

Place black frame caps on frame. Position the handle and fasten with handle hardware. Securely tighten (1/4"-20 screws to 50-60 in.-lbs. torque).

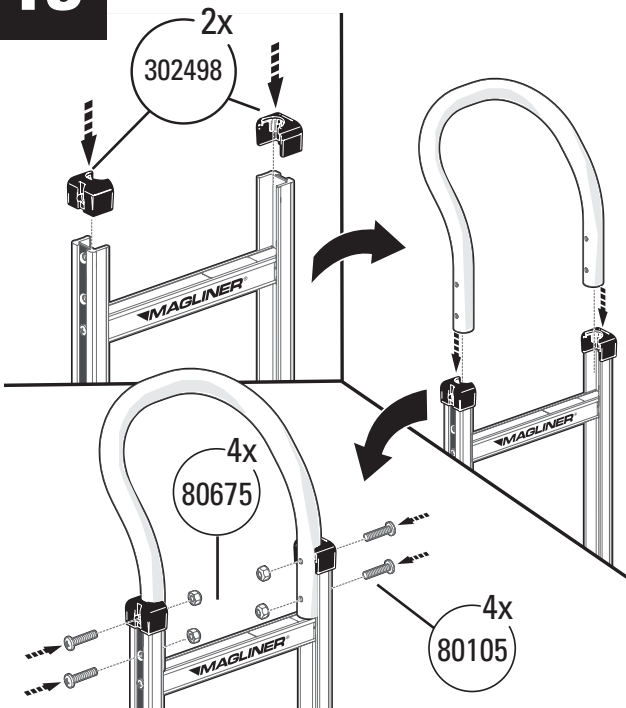

<i>Handle Hardware Packs</i>	
Part Number	Description
in 301034	Handle Only (bolt 80105)
80112	Handle + Hi-U Extension, or Handle + U-brace
80114	Handle + U-brace + Hi-U Extension

# 14

- a. Make sure the top of the top cross brace is clean and free of debris. If needed, clean the cross brace with a mild solvent. Let completely dry.
- b. Apply truck loading steps adhesive label to the top of the top cross brace as shown below.

Aluminum Cross Braces

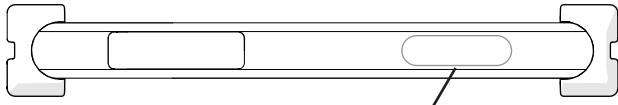

Affix loading label here

Polymer Cross Braces

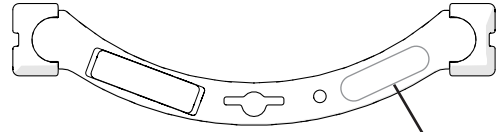

Affix loading label here

