

## CAUTION: ATTACH FEET BEFORE OPERATING

### DO NOT OPERATE WITH FEET MISSING.

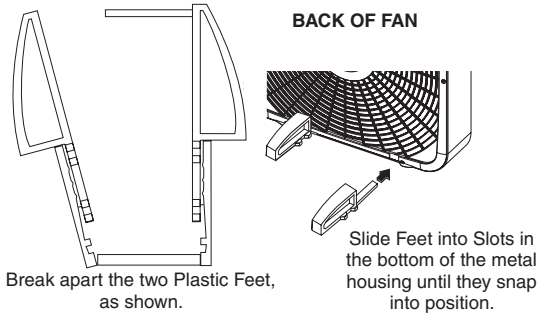

### WARNING

This appliance has a polarized plug (one blade is wider than the other). To reduce the risk of electric shock, this plug is intended to fit in a polarized outlet only one way. **MATCH WIDE BLADE OF PLUG TO WIDE SLOT. FULLY INSERT.** If the plug does not fit fully in the outlet, reverse the plug. If it still does not fit, contact a qualified electrician. Do not attempt to defeat this safety feature. This plug is a safety feature. To reduce the risk of fire, electric shock and personal injury, do not remove, replace, repair or tamper with the originally supplied plug. If the Fan does not function properly, it may be due to the safety device incorporated in this plug. If the plug warning label is missing or damaged, call the toll free number for a replacement label.

**This Fan is for residential use only. It is not intended to be used in commercial, industrial or agricultural settings. This fan does not meet the requirements of NEC Article 547-7.**

### GENERAL SAFETY INSTRUCTIONS

1. Never insert fingers, pencils, or other foreign objects through the grill.
2. Disconnect Fan when moving it from one location to another.
3. Be sure that the Fan (with feet in place) is on a stable surface when operating, to avoid the chance of it overturning.
4. Disconnect Fan when removing grills for cleaning. Reinstall grills before reconnecting to power supply.
5. **WARNING:** To reduce the risk of fire, electric shock or personal injury:
  - a) Do not use this Fan with any solid-state speed control device.
  - b) Unplug Fan before cleaning or servicing.
  - c) If you disassemble your Fan, completely reassemble before plugging into outlet, according to instructions.

### OPERATION

1. Plug the Fan into any standard 120V AC household outlet.
2. Using the rotary switch, set the desired Fan speed.

### MAINTENANCE

1. To clean your Fan, use a soft cloth moistened with a mild soap solution. **NEVER IMMERSER ELECTRICAL PARTS IN WATER.** Avoid using gasoline, benzene, thinner, hard cleansers, etc. Be certain that the Fan is completely dry before plugging in.
2. Lubrication is not required as your Fan has permanently lubricated bearings.
3. Store in a clean and dry area when not in use.

### LASKO PRODUCTS, INC. LIMITED WARRANTY - NOT VALID IN MEXICO

**WHAT THIS WARRANTY COVERS:** This product is warranted against defects in workmanship and/or materials.

**HOW LONG THIS WARRANTY LASTS:** This warranty extends only to the original purchaser of the product and lasts for two (2) years from the date of original purchase or until the original purchaser of the product sells or transfers the product, whichever first occurs.

**WHAT LASKO WILL DO:** During the warranty period, Lasko will, at its sole option, repair or replace any part or parts that prove to be defective or replace the whole product with the same or comparable model.

**WHAT THIS WARRANTY DOES NOT COVER:** This warranty does not apply if the product was damaged or failed because of accident, improper handling or operation, shipping damage, abuse, misuse, unauthorized repairs made or attempted, or the use of the product for commercial or nonresidential service. This warranty does not cover shipping costs for the return of products to Lasko for repair or replacement. Lasko will pay return shipping charges from Lasko following warranty repairs or replacement.

**ANY AND ALL WARRANTIES, EXPRESSED OR IMPLIED (INCLUDING, WITHOUT LIMITATION, ANY IMPLIED WARRANTY OF MERCHANTABILITY), LAST TWO YEARS FROM THE DATE OF ORIGINAL PURCHASE OR UNTIL THE ORIGINAL PURCHASER OF THE PRODUCT SELLS OR TRANSFERS THE PRODUCT, WHICHEVER FIRST OCCURS AND IN NO EVENT SHALL LASKO'S LIABILITY UNDER ANY EXPRESS OR IMPLIED WARRANTY INCLUDE (I) INCIDENTAL OR CONSEQUENTIAL DAMAGES FROM ANY CAUSE WHATSOEVER, OR (II) REPLACEMENT OR REPAIR OF ANY HOUSE FUSES, CIRCUIT BREAKERS OR RECEPTACLES. NOTWITHSTANDING ANYTHING TO THE CONTRARY, IN NO EVENT SHALL LASKO'S LIABILITY UNDER ANY EXPRESS OR IMPLIED WARRANTY EXCEED THE PURCHASE PRICE OF THE PRODUCT AND ANY SUCH LIABILITY SHALL TERMINATE UPON THE EXPIRATION OF THE WARRANTY PERIOD.**

Some states and provinces do not allow limitations on how long an implied warranty lasts, or the exclusion or limitation of incidental or consequential damages, so these exclusions or limitations may not apply to you. This warranty gives you specific legal rights. You may also have other rights which vary from state to state and province to province.

Proof of purchase is required before a warranty claim will be accepted.

For more information, please visit our website:

[www.laskoproducts.com](http://www.laskoproducts.com)

Customer Service is available to assist you with product questions and replacement parts. Call toll-free 1-800-233-0268 Monday thru Friday 8am-5pm EST.

COVERED BY ONE OR MORE OF THE FOLLOWING US PATENTS:  
6,120,248; 6,309,192 B1; D407,478; D413,685; D416,996 AND/OR OTHER PATENTS PENDING

IMPORTANT SAFETY INSTRUCTIONS / READ AND SAVE