

WORX®

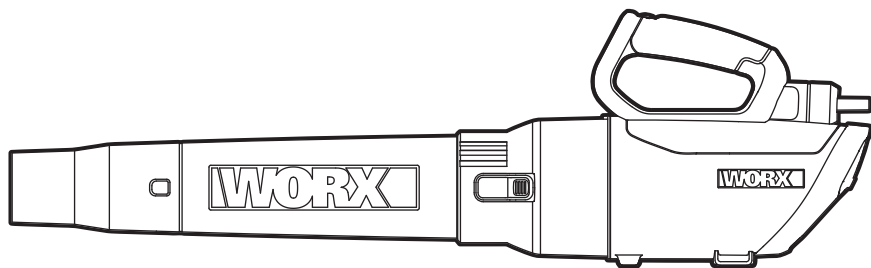

7.5A Electric Blower

EN

P05

Souffeuse électrique 7,5A

F

P09

Soplador eléctrico de 7,5A

ES

P14



HELPLINE NUMBER
NUMERO DU SERVICE D'ASSISTANCE
NUMERO DE LINEA DE AYUDA
1-866-354-WORX (9679)

WG519



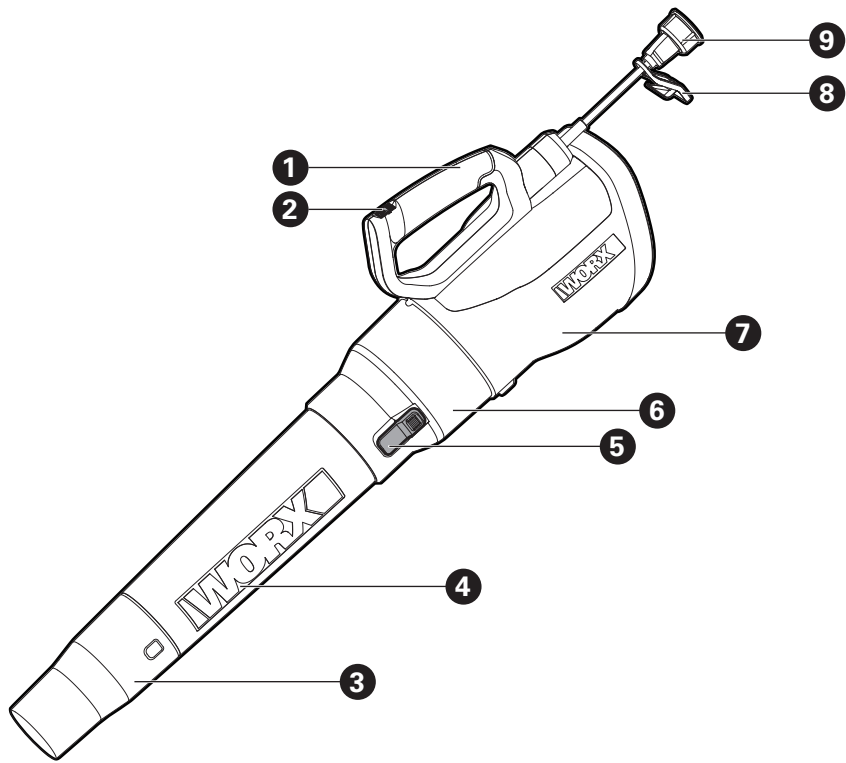

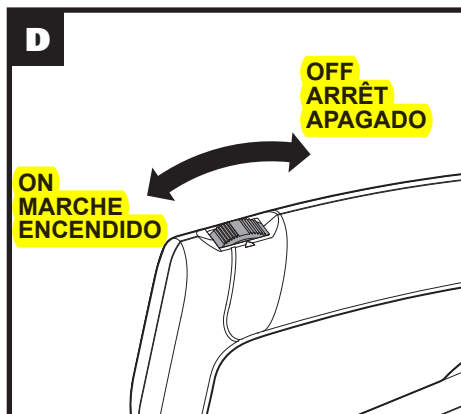
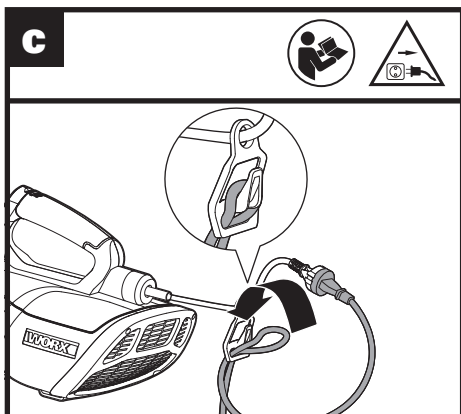
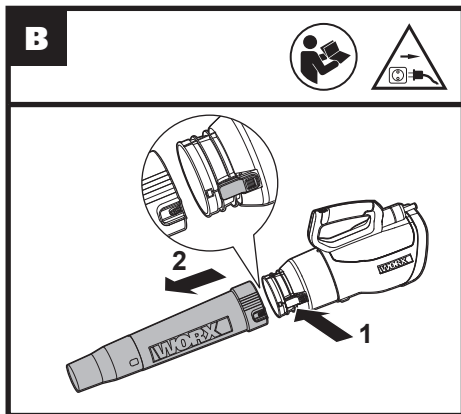
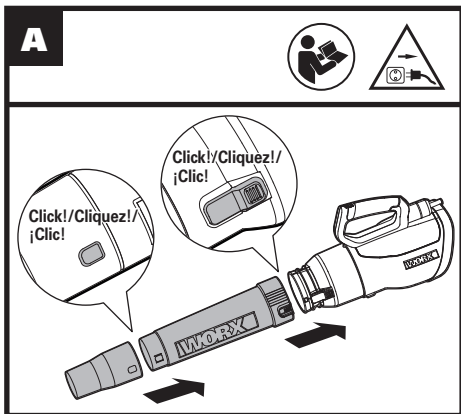

F

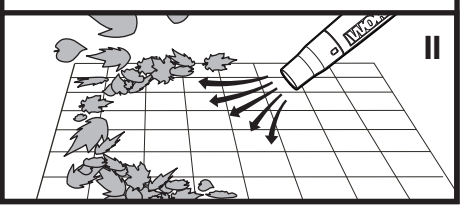
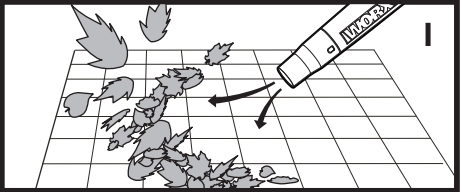
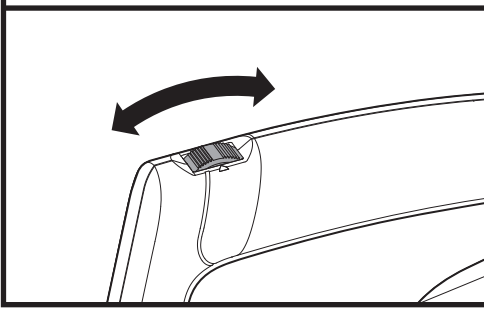

1. HANDLE
2. ON/OFF SWITCH/2-SPEED SWITCH
3. LOWER BLOWER TUBE
4. UPPER BLOWER TUBE
5. TUBE RELEASE BUTTON
6. FAN HOUSING
7. MOTOR HOUSING
8. EXTENSION CORD RETAINER
9. POWER PLUG

* Not all the accessories illustrated or described are included in standard delivery.

TECHNICAL DATA

Type **WG519** (5-designation of machinery, representative of Electric Blower Vacuum)

Rated Voltage	120V~60Hz
Rated power	7.5A
Speed control	2- Speed
6 Air speed	60mph(97km/h) - 120mph(193km/h)
Airflow	225cfm(6.4m ³ /min) - 450cfm(12.7m ³ /min)
Machine weight	6.4lbs(2.9kg)
Protection degree	□/II

Only use the appropriate accessories intended for this tool. Accessory information can be found on the product packaging, at a WORX retailer or on our website at www.worx.com.

PRODUCT SAFETY



WARNING: Some dust created by power sanding, sawing, grinding, drilling and other construction activities contains chemicals known to the state of California to cause cancer, birth defects or other reproductive harm. Some examples of these chemicals are:

- **Lead from lead-based paints;**
- **Crystalline silica from bricks and cement and other masonry products and**
- **Arsenic and chromium from chemically-treated lumber.**

Your risk from these exposures varies, depending on how often you do this type of work. To reduce your exposure to these chemicals: work in a well ventilated area, and work with approved safety equipment, such as those dust masks that are specially designed to filter out microscopic particles.



WARNING: This product maybe contains lead, phthalate or other chemicals known to the State of California to cause cancer, birth defects and other reproductive harm. Please wash your hands after use.

IMPORTANT SAFETY INSTRUCTIONS



WARNING: When using electric gardening appliances, basic safety precautions should always be followed to reduce the risk of fire, electric shock, and personal injury, including the following:



WARNING: Read all instructions

FOR ALL APPLIANCES

- 1) Avoid Dangerous Environment** - Don't use appliances in damp or wet locations.
- 2) Don't Use In Rain.**
- 3) Keep Children Away** - All visitors should be kept at a distance from work area.
- 4) Dress Properly** - Do not wear loose clothing or jewelry. They can be caught in moving parts. Use of rubber gloves and substantial footwear is recommended when working outdoors. Wear protective hair covering to contain long hair.
- 5) Use Safety Glasses** - Always use face or dust mask if operation is dusty.
- 6) Use Right Appliance** - Do not use appliance for any job except that for which it is intended.
- 7) Ground Fault Circuit Interrupter (GFCI) protection should be provided on the circuit(s) or outlet(s) to be used for the gardening appliance.** Receptacles are available having built-in GFCI protection and may be used for this measure of safety.
- 8)  WARNING** - To reduce the risk of electric shock, use only with an extension cord intended for outdoor use, such as an

extension cord of cord type SW-A, SOW-A, STW-A, STOW-A, SJW-A, SJOW-A, SJTW-A. or SJTOW-A.

- 9) Extension Cord** - Make sure your extension cord is in good condition. When using an extension cord, be sure to use one heavy enough to carry the current your product will draw. An undersized extension cord will cause a drop in line voltage resulting in loss of power and overheating. Table 1 shows the correct size to use depending on cord length and nameplate ampere rating. If in doubt, use the next heavier gage. The smaller the gage number, the heavier the cord. To reduce the risk of disconnection of appliance cord from the extension cord during operating:
 - Make a knot as shown in Figure 1; or
 - Use one of the plug-receptacle retaining straps or connectors described in this manual.
- 10) Avoid Unintentional Starting** - Don't carry plugged-in appliance with finger on switch. Be sure switch is off when plugging in.
- 11) Don't Abuse Cord** - Never carry appliance by cord or yank it to disconnect from receptacle. Keep cord from heat, oil, and sharp edges.
- 12) Don't Force Appliance** - It will do the job better and with less likelihood of a risk of injury at the rate for which it was designed.
- 13) Don't Overreach** - Keep proper footing and balance at all times.
- 14) Stay Alert** - Watch what you are doing. Use common sense. Do not operate appliance when you are tired.
- 15) Disconnect Appliance** - Disconnect the appliance from the power supply when not in use, before servicing, when changing accessories such as blades, and the like.
- 16) Store Idle Appliances Indoors** - When not in use, appliances should be stored indoors in dry, and high or locked-up place - out of reach of children.
- 17) Maintain Appliance With Care** - Keep cutting edge sharp and clean for best performance and to reduce the risk of injury. Follow instructions for lubricating and changing accessories. Inspect appliance cord periodically, and if damaged, have it repaired by an authorized service facility. Inspect extension cords periodically and replace if damaged. Keep handles dry, clean, and free from oil and grease.
- 18) Check Damaged Parts** - Before further use of the appliance, a guard or other part that is damaged should be carefully checked to determine that it will operate properly and perform its intended function. Check for alignment of moving parts, binding of moving parts, breakage of parts, mounting, and any other condition that may affect its operation. A guard or other part that is damaged should be properly repaired or replaced by an authorized service center unless indicated elsewhere in this manual.

Table 1
Minimum gauge for extension cords

Ampere rating				
More than, A		Not more than, A		
6		10		
Volts	Total length of cord			
	7.62 m (25ft)	15.24 m (50ft)	30.48 m (100ft)	45.72 m (150ft)
120V	mm ² (AWG)			
--	0.82 (18)	1.3 (16)	2.1 (14)	3.3 (12)

Method of securing extension cord

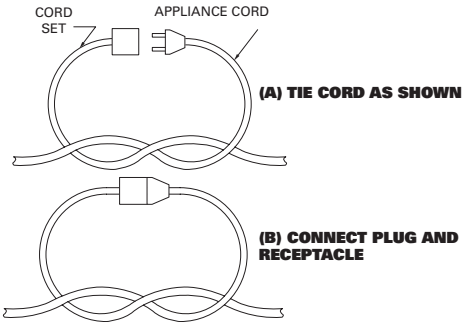

8

FOR ALL DOUBLE-INSULATED APPLIANCES

1) Replacement Parts

When servicing use only identical replacement parts.

2) Polarized Appliance Connections

To reduce the risk of electric shock, this appliance has a polarized plug (one blade is wider than the other) and will require the use of a polarized extension cord. The appliance plug will fit into a polarized extension cord only one way. If the plug does not fit fully into the extension cord, reverse the plug. If the plug still does not fit, obtain a correct polarized extension cord. A polarized extension cord will require the use of a polarized wall outlet. This plug will fit into the polarized wall outlet only one way. If the plug does not fit fully into the wall outlet, reverse the plug. If the plug still does not fit, contact a qualified electrician to install the proper wall outlet. Do not change the equipment plug, extension cord receptacle, or extension cord plug in any way.

ADDITIONAL SAFETY WARNINGS

IMPORTANT SAFETY INSTRUCTIONS

When using an electrical appliance, basic precautions should always be followed, including the following:

READ ALL INSTRUCTIONS BEFORE USING THIS APPLIANCE

WARNING - To reduce the risk of fire, electric shock, or injury:

- 1) Do not leave appliance when plugged in. Unplug from outlet when not in use and before servicing.
- 2) To reduce the risk of electric shock – Do not use on wet surfaces. Do not expose to rain. Store indoors.
- 3) Do not allow to be used as a toy. Close attention is necessary when used by or near children.
- 4) Use only as described in this manual. Use only manufacture's recommended attachments.
- 5) Do not use with damaged cord or plug. If appliance is not working as it should, has been dropped, damaged, left outdoors, or dropped into water, return it to a service center.
- 6) Do not pull or carry by cord, use cord as a handle, close a door on cord, or pull cord around sharp edges or corners. Do not run appliance over cord. Keep cord away from heated surfaces.
- 7) Do not handle plug or appliance with wet hands.
- 8) Do not put any object into openings. Do not use with any opening blocked; keep free of dust, lint, hair, and anything that may reduce air flow.
- 9) Keep hair, loose clothing, fingers, and all parts of body away from power openings and moving parts.
- 10) Turn off all controls before unplugging.
- 11) Use extra care when cleaning on stairs.
- 12) Do not unplug by pulling on cord. To unplug, grasp the plug, not the cord.
- 13) This appliance is provided with double insulation. Use only identical replacement parts. See instructions for Servicing of Double-Insulated Appliances.

ADDITIONAL SAFETY RULES FOR EXTENSION CORD

- 1) Warning –To reduce the risk of personal injury due to loose electrical connection between the appliance's plug and extension cord, firmly and fully attach the appliance plug to the extension cord. Periodically check the connection while operating to ensure it is fully attached, Do not use an extension cord that provides a loose connection. A loose connection may result in overheating, fire, and increases the risk of a burning.
- 2) To reduce the risk of disconnection of the appliance cord from the extension cord during operating, secure the extension cord to the appliance plug as shown or described in the Operating Instructions.

SAVE THESE INSTRUCTIONS
SERVICING OF DOUBLE-INSULATED APPLIANCES









A double-insulated appliance is marked with one or

more of the following: The words “DOUBLE INSULATION” or “DOUBLE INSULATED” or the double insulation symbol (square within a square).



In a double-insulated appliance, two systems of insulation are provided instead of grounding. No grounding means is provided on a double-insulated appliance, nor should a means for grounding be added to the appliance. Servicing a double-insulated appliance requires extreme care and knowledge of the system, and should be done only by qualified service personnel. Replacement parts for a double-insulated appliance must be identical to the parts they replace.

SYMBOLS

	To reduce the risk of injury, user must read instruction manual
	Wear eye protection
	Wear ear protection
	Warning
	Double insulation
	Before any work on the machine itself, pull the power plug from the outlet.
	Keep bystanders away
	Warning of hazard



Do not use in the rain or leave outdoors while it is raining.

OPERATION

INTENDED USE:

The blower is intended for residential use only. Use the blower outdoors to move yard debris as needed.



WARNING! To avoid injury from unexpected starting or electrical shock during assembly or adjustment, do not plug the power cord into a source of power.

ASSEMBLY AND OPERATION

ACTION	FIGURE
Assembly	
Assembling & disassembling the Blower Tube	See Fig. A&B
Attaching the Extension Cord	See Fig. C
Operation	
Starting & Stopping	See Fig. D
Using the Blower	See Fig. E
Adjusting the Blowing Speed with 2-Speed Switch	See Fig. F

9

MAINTENANCE

Remove the plug before carrying out any adjustment, servicing or maintenance.

There are no user serviceable parts in your blower. Never use water or chemical cleaners to clean your blower. Wipe clean with a dry cloth. Keep the motor ventilation slots clean. Keep all working controls free of dust.

If the replacement of the supply cord is necessary, this has to be done by the manufacturer or his agent in order to avoid a safety hazard.

STORAGE

Store the blower and extension cord indoors, in a cool dry location, out of reach of children and animals.

WORX
it's your nature
www.worx.com

Copyright © 2016, Positec. All Rights Reserved.

Copyright © 2016, Positec. Tous droits réservés.

© Derechos reservados 2016, Positec. Todos los derechos reservados.