

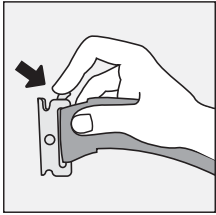

## CONNECTING X-TRACK / E-TRACK ACCESSORY

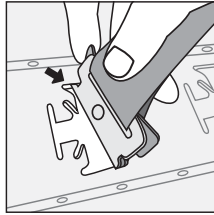

**STEP 1:**  
PRESS BACK  
LOCKING  
LEVER.



**STEP 2:**  
WITH LOCKING  
LEVER PRESSED  
BACK, INSERT  
LEVER END  
INTO X-TRACK /  
E-TRACK SLOT.

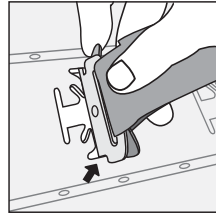

**STEP 3:**  
INSERT OTHER  
END INTO  
X-TRACK  
/ E-TRACK  
SLOT.

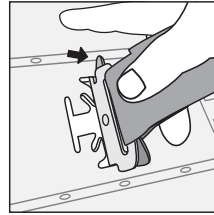

**STEP 4:**  
RELEASE  
LOCKING  
LEVER.

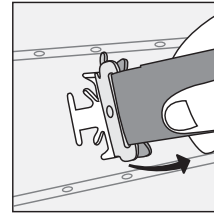

**STEP 5:**  
PULL ON  
ATTACHMENT  
TO ENSURE  
THAT IT HAS  
LOCKED  
SECURELY.

## DISCONNECTING X-TRACK / E-TRACK ACCESSORY

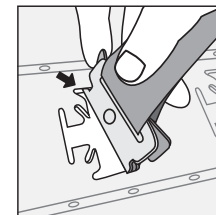

**STEP 1:**  
PRESS LOCKING  
LEVER AND  
PUSH TOWARD  
LOCKING  
LEVER END  
OF SLOT.

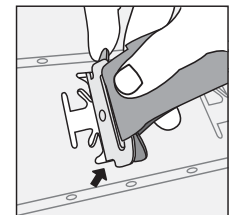

**STEP 2:**  
LIFT  
ACCESSORY  
OUT OF SLOT  
AT ANGLE  
TO REMOVE.