

Retriever

PORTABLE KENNEL INSTRUCTION MANUAL

1201551

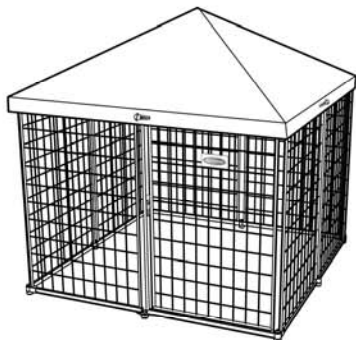

Distributed by:
TRACTOR SUPPLY COMPANY
501 VIRGINIA AVE
BENTONVILLE, TN 37027
For customer support
Call 1-888-376-9601
www.tractorsupply.com

PARTS LIST

- | | |
|-------------------------------|--------------------------------|
| A 1 x Portable Kennel | C 4 x Roof Support Arms |
| D 1 x Roof Support Hub | E 4 x Bungee Cords |
| B 1 x Roof Cover | F 8 x Ground Stakes |
| H 1 x Stabilizing Bar | G 1 x Tote Bag |

TIPS BEFORE YOU START:

1. Ensure that all parts are present prior to assembly.
2. Check all packing material carefully before discarding, as some parts may be encased in the packing material.
3. For ease and speed of assembly, it is recommended that prior to each step, all parts be identified.
4. Ensure that you have sufficient space and people to assemble safely.
5. It is recommended that the kennel be staked to the ground when in use.
6. It is recommended to set up on a flat level surface.
7. Please keep the instruction manual for future reference.

ASSEMBLY INSTRUCTIONS

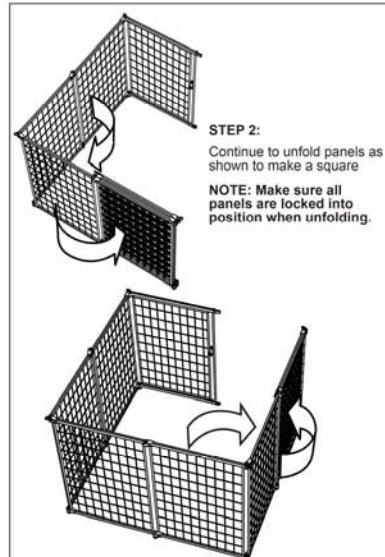
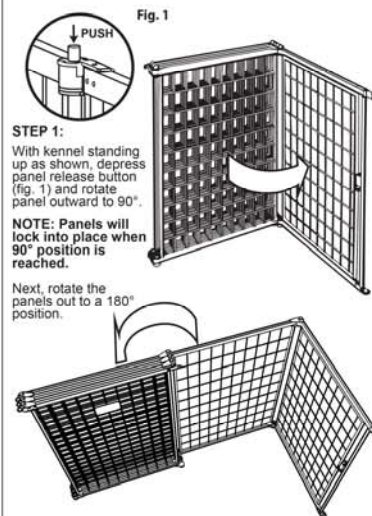

STEP 3:

With two end panels aligned, lift left panel slightly and place bottom ring over pin at the base of the right panel (fig. 2). Next, align the top of both panels and slide lock-bar into position. Rotate lock retainer hook over slide bar knob as shown in fig. 3.

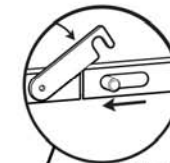

Roof Assembly

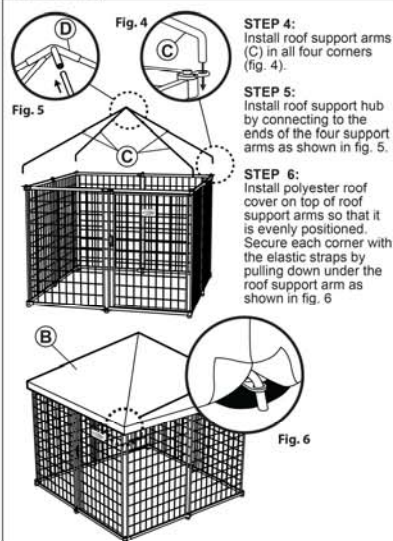

STEP 7: Complete the roof cover assembly by installing four bungee cords (one on each side). Insert the bungee cord through the grommet and stretch around frame. Pull through the adjacent grommet and stretch over the attached ball as in figure 7.

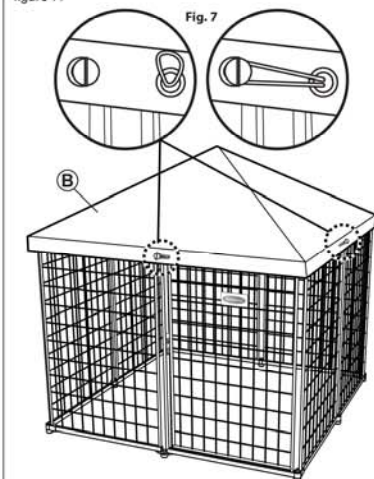

Staking to the ground

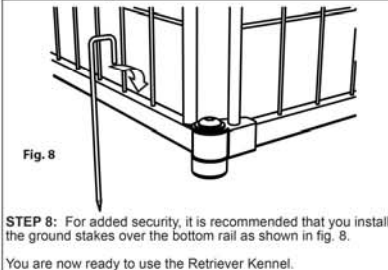

Transportation and Storage

To break down the portable kennel for storage and transportation, reverse steps 1-8. Use the cinch strap to secure panels together (fig. 9).

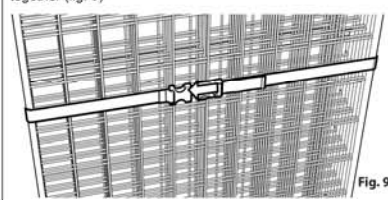

Instructions for joining two kennels

STEP 1: Rotate the two end panels to the 180° position as shown in fig. 10.

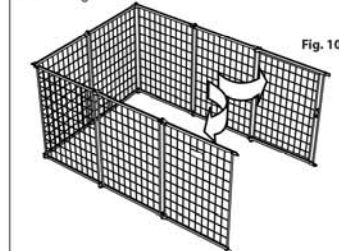

STEP 2: With second retriever kennel open to the same configuration as fig. 10, slide both panels together and secure using the slide lock-bar and lock retainer.

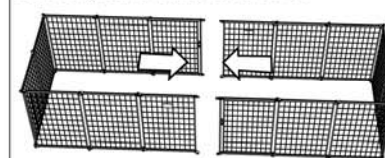

STEP 3: Install the stabilizing bars by depressing the button and sliding until it clicks into the fully extended position.

STEP 4: Place the stabilizing bar onto the panel lock release buttons as shown in fig. 11.

