

**PARTS INCLUDED**

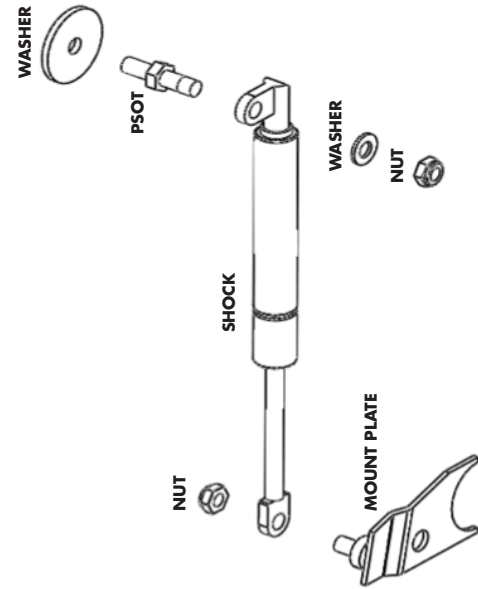

**PARTS LIST**

SHOCK  
POST  
LARGE WASHER  
SMALL WASHER  
MOUNT PLATE  
NUT

**TOOLS REQUIRED:**  
13MM WRENCH

**STEP 1**

**\*NOTE: THIS PRODUCT CAN ONLY BE INSTALLED ON THE DRIVER'S SIDE.**

Using a 13mm wrench or socket, remove the bolt by the tailgate pivot.



**STEP 2**

Install the shock mount plate using the bolt removed in the previous step.



**STEP 3**

Remove the cable from the cable bolt. Using a 13mm wrench/socket, remove the cable bolt.



**STEP 4**

Install the post stud and large washer where the cable bolt was removed. The fully threaded end installs into the truck. Tighten with a 13mm wrench.



**STEP 6**

A Mylar sheet has been provided to help prevent components from rubbing against the truck bed and tailgate in the event that any part becomes loose. Using scissors, cut the mylar to the size needed. Apply the mylar to the truck bed and tailgate where tailgate assist components will be in close proximity during opening/closing. The red lines show the area where the mylar has been installed.



The vehicle shown is an example of how the mylar can be installed. Your vehicle may differ from the vehicle shown.



**STEP 5**

Place the tailgate cable on the bolt stud.



**STEP 6**

Place the shock on the bottom mount and top mount as shown. Install a washer and nylock nut on the top post. Install a nylock nut on the mount plate stud. The nuts must be tight enough for the thread to engage the nylon ring in the nut, but not too tight that they prevent the parts from moving freely around the stud.



## FAQ's

### Can the Tailgate Assist be installed on the passenger's side?

No. The unit will not work on the passenger side of the truck bed. Installing the tailgate assist on the passenger side can cause the tailgate to come off the truck.

### Are there installation videos?

Yes. All installation videos can be viewed at: [www.deezee.com/tailgateassist](http://www.deezee.com/tailgateassist)

## DEE ZEE, INC. WARRANTY COVERAGE

Dee Zee, Inc. guarantees the original purchaser a limited warranty against manufacturer defects in materials, workmanship, and design under normal use.

Tailgate Assist has a 3-year limited warranty. Operational and wear items such hardware have a one-year (1) warranty. To read the complete warranty policy for your product visit: [www.deezee.com/warranty](http://www.deezee.com/warranty)

Buyer assumes all risk, liability, and cost for the installation and use of Dee Zee products. Dee Zee, Inc. assumes no liability for injury, loss, incidental or consequential damages in the event of an accident.

## WARRANTY & RETURN SUBMISSION PROCEDURE

Please contact the original point of purchase for: shipping damage, returns, or warranty claims. Contact Dee Zee directly for missing parts or hardware.

All warranty claims will be initiated at the place of purchase. The original purchaser will be required to present the original sales receipt with purchase date shown and provide photographs of the defect.

## DZ 43100 CHEVY TAILGATE ASSIST 1999-2007 (07 CLASSIC ONLY)



**INSPECT YOUR PRODUCT FOR DAMAGE & MISSING PARTS BEFORE PROCEEDING TO INSTALLATION**

# 1-800-779-2102

**Mon – Thurs: 8:00am - 5:00pm | Friday: 8:00am - 4:00pm (CST)**

**[WWW.DEEZEE.COM](http://WWW.DEEZEE.COM)**

**REGISTER YOUR PRODUCT ONLINE: [www.deezee.com/registration](http://www.deezee.com/registration)  
VIEW INSTRUCTIONS ONLINE: [www.deezee.com/instructions](http://www.deezee.com/instructions)**

**⚠️ WARNING: Cancer and Reproductive Harm**  
[www.P65Warnings.ca.gov](http://www.P65Warnings.ca.gov)