

**Step 5** Place assembled Hose Reel Drum (E) onto the top of the U-Shape Frame (A). Ensure the water inlet (with the bearing Bracket) is on the same end of the cart as the Front Axle (C). Place Bearing Bracket (F) onto the other end of the Drum Assembly (E) and secure using four M6 x 22mm Screw, Nut & Washers (K).

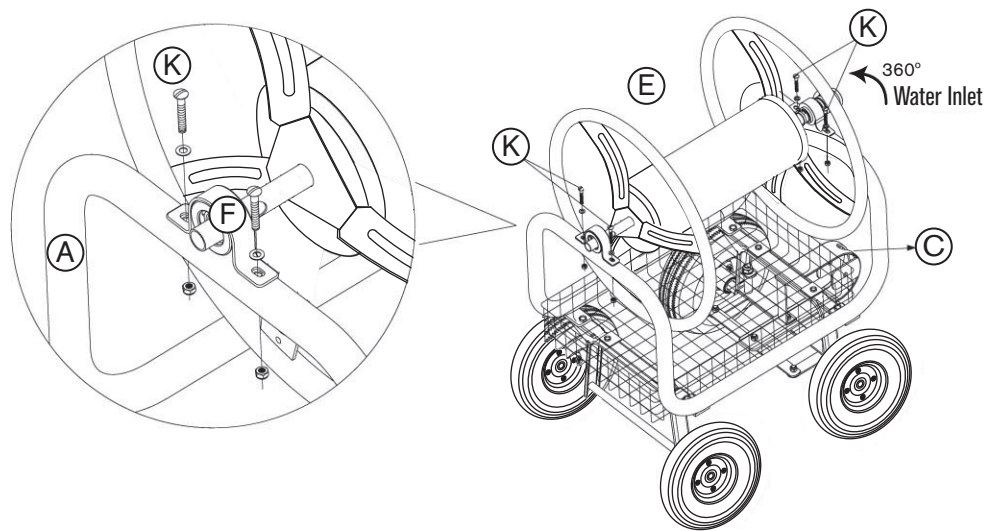

**Step 6** Insert Crank Handle (G) onto the hub of the Rear Axle (B). Align holes for proper placement and secure using one M6 x 30mm Screw, Nut & Washer set (J) as shown.

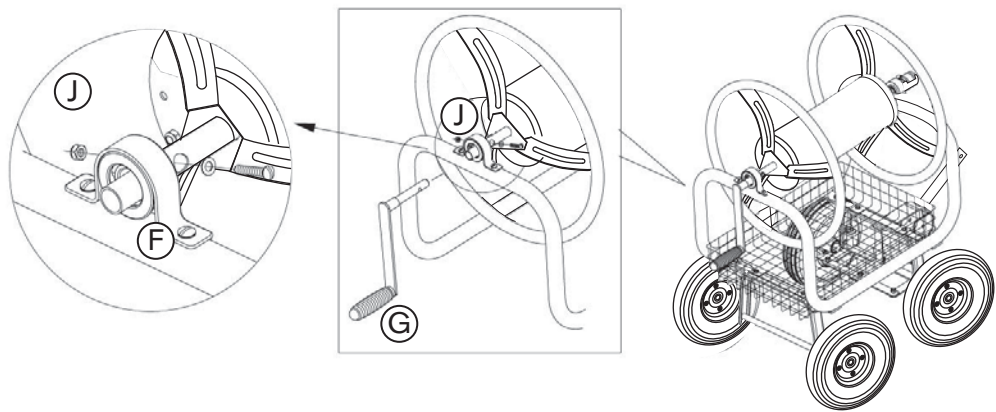

**Step 7** Connect Longer Handle "H" with Short Handle Bar with Screw & Nut and Washer "J".

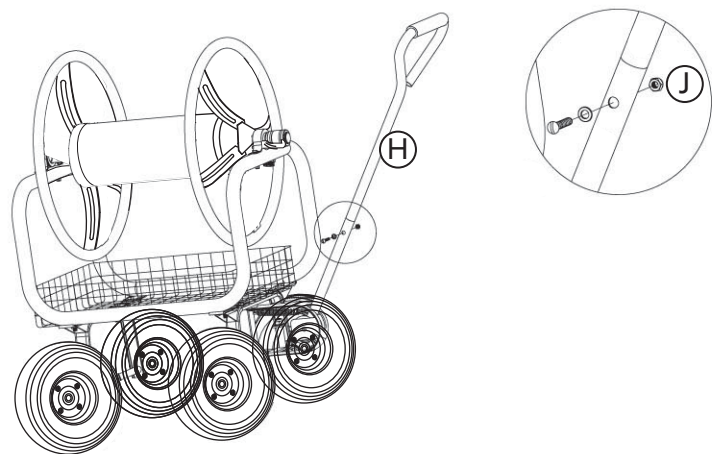

**Step 8** Attach male coupling end of Leader Hose (R) to Water Inlet Coupling (E1) as shown and tighten firmly.

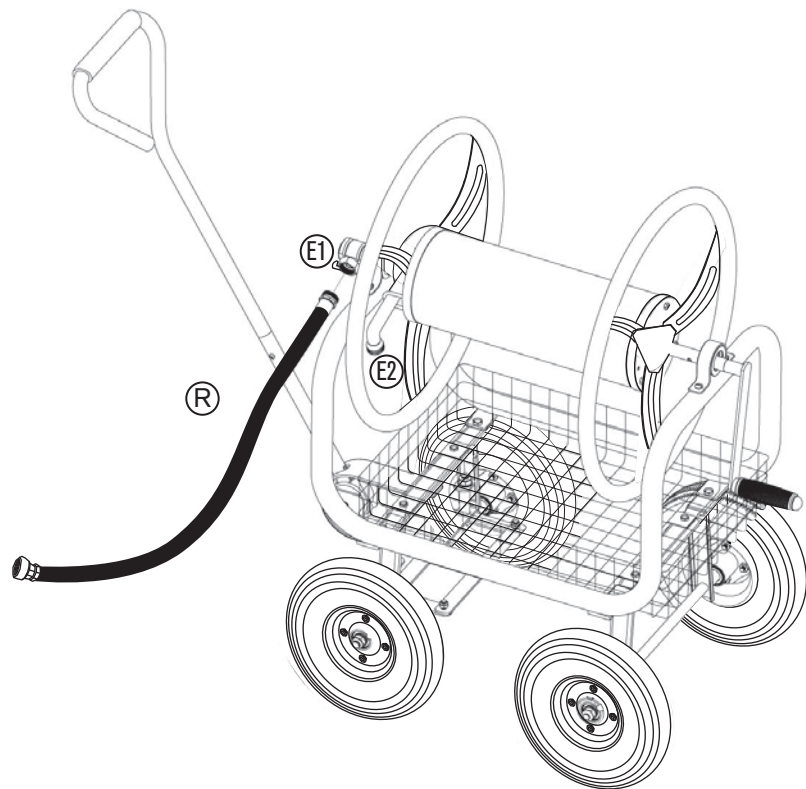



1099219

# Hose Reel Cart

HOLDS UP TO **400 ft.** 5/8 in. HOSE

## INSTRUCTION MANUAL



HOLDS UP TO 400 ft. (121.92 m) 5/8 in. HOSE

**IMPORTANT INFORMATION:**  
Please read all instructions and precautions before use of this product

Distributed by:  
TRACTOR SUPPLY COMPANY  
5401 VIRGINIA WAY  
BRENTWOOD, TN 37027  
For customer support,  
call: 1-888-376-9601  
www.TractorSupply.com  
MADE IN CHINA

## PARTS LIST

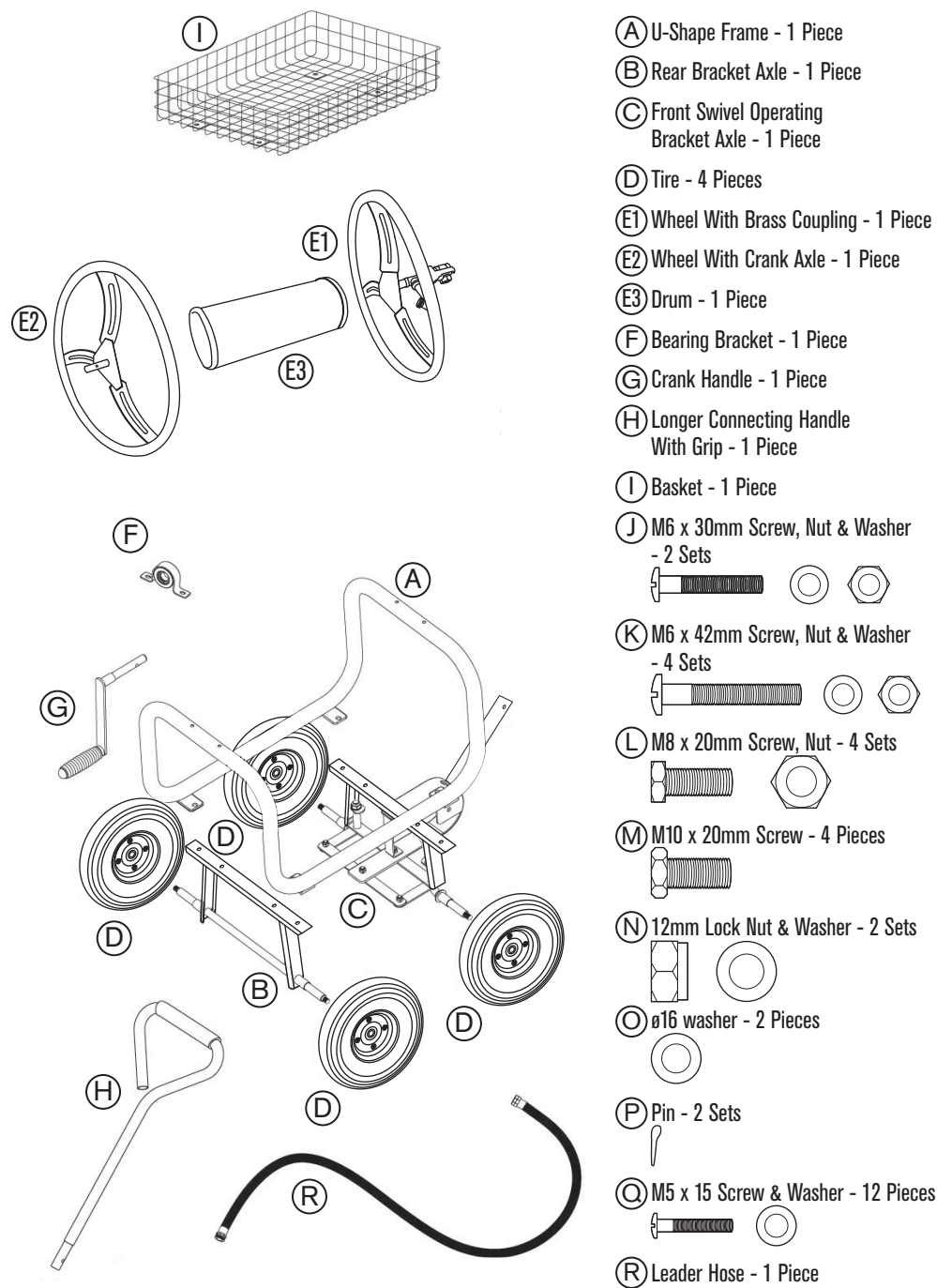

## ASSEMBLY INSTRUCTIONS

Required tools and helpful hints:  
One straight slotted screwdriver and one adjustable wrench.

Always assemble in a clean and flat area. Read these instructions completely before beginning assembly. Carefully remove all parts from the box and identify and organize all parts and tools prior to assembly

**Step 1** Attach Rear Bracket Axle (B) to U-Shape Frame (A) as shown and tighten using two M10 x 20mm Screws (M). Then, attach Front Axle (C) to U-Shape Frame (A) as shown using two M10 x 20mm Screws (M)

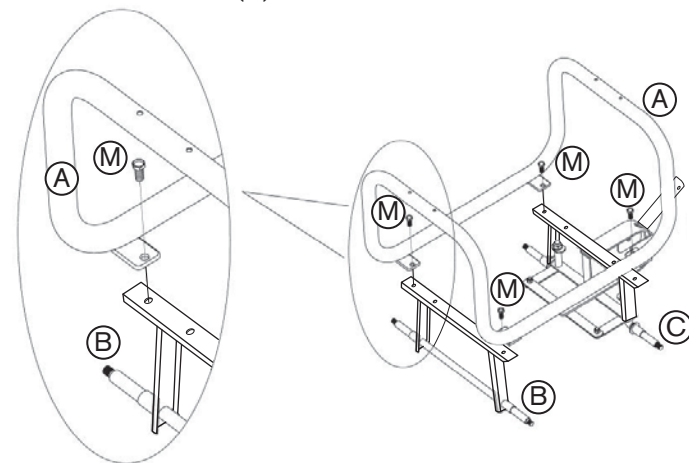

### Step 2

Slide 2 Pneumatic Tires (D) onto the Front Axle (C), ensuring the wheel valve stem is facing outward. Tighten with two 12mm Lock Nuts & Washers (N). Next, slide 2 Pneumatic Tires (D) onto the Rear Axle (B) and ensure the wheel valve stem is facing outward. Secure in place with one Washer (O) and one Pin (P) on each side.

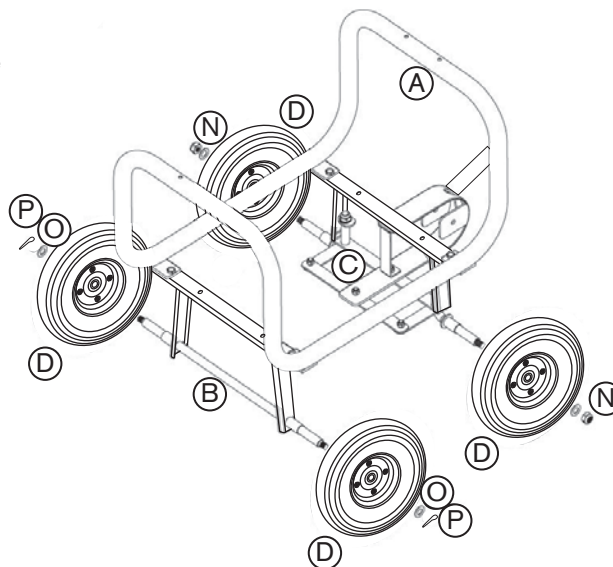

**Step 3** Place basket (I) on top surface of Front Axle (C) and Rear Axle (B) evenly, tighten with four M8 x 20mm Screws & Nuts (L) as shown.

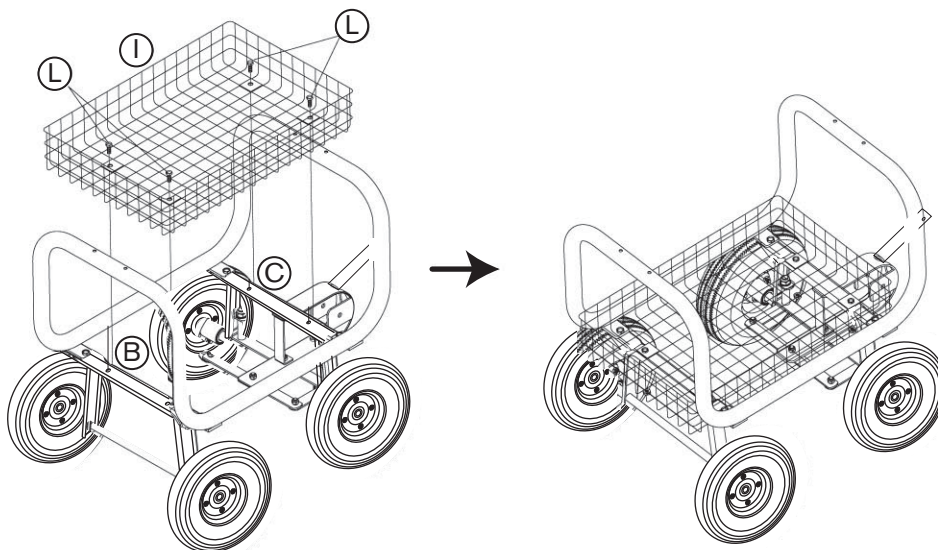

**Step 4** Attach Hose Reel (E1 & E2) to Drum (E3) using M5 x 15mm Screws & Washers (Q) as shown.

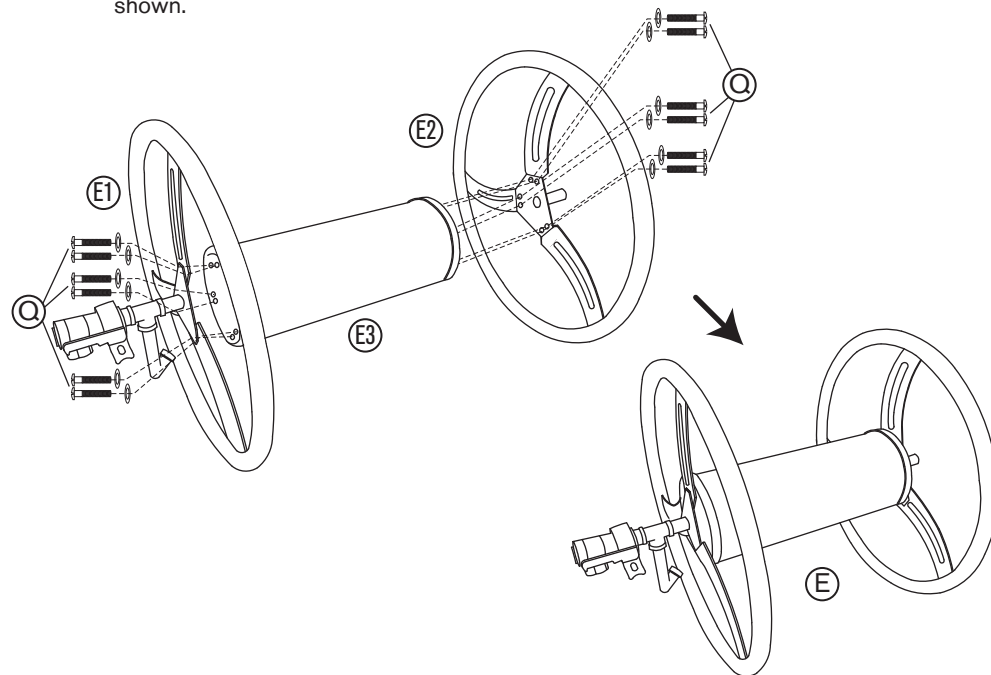

	ITEM NUMBER:	1099219
	DESCRIPTION:	400 ft Hose Reel Cart
	INSTRUCTION MANUAL SIZE:	297mm(W) x 210mm(H)
	COLOR:	1C + 1C
	MATERIAL:	80gsm Woodfree Paper (80磅書紙)
<div>CMYK <input type="checkbox"/> <input type="checkbox"/> <input type="checkbox"/> <input type="checkbox"/></div> <div>PANTONE <input type="checkbox"/> --- <input type="checkbox"/> --- <input type="checkbox"/> --- <input type="checkbox"/> ---</div>	FINISHING:	---
	DATE:	Oct 24, 2014
	VERSION:	1.4
	RELEASED DATE:	---