

You Must Read all the Instructions before starting the Assembly

STOP! Before You Assemble This House You Must Have the EXRP19 Pole by S&K MFG Inc

Step 1. Purchase The EXRP19 Pole by S&K Mfg. Inc. A Strong Heavy Gauge Galvanized Steel Pole

Step 2. Receive your EXRP19

Step 3. Remove the Topper & Rope out of the EXRP19 Pole Box

Step 4. Get the Roof Ready for the EXRP19 Pole
Remove the Roof from the bird house box. Turn the Roof inside out so that the shingle design is on the outside. The hole in the roof will be covered by the Topper (included with the EXRP19) when installed on the EXRP19 Pole. (pole sold separately)

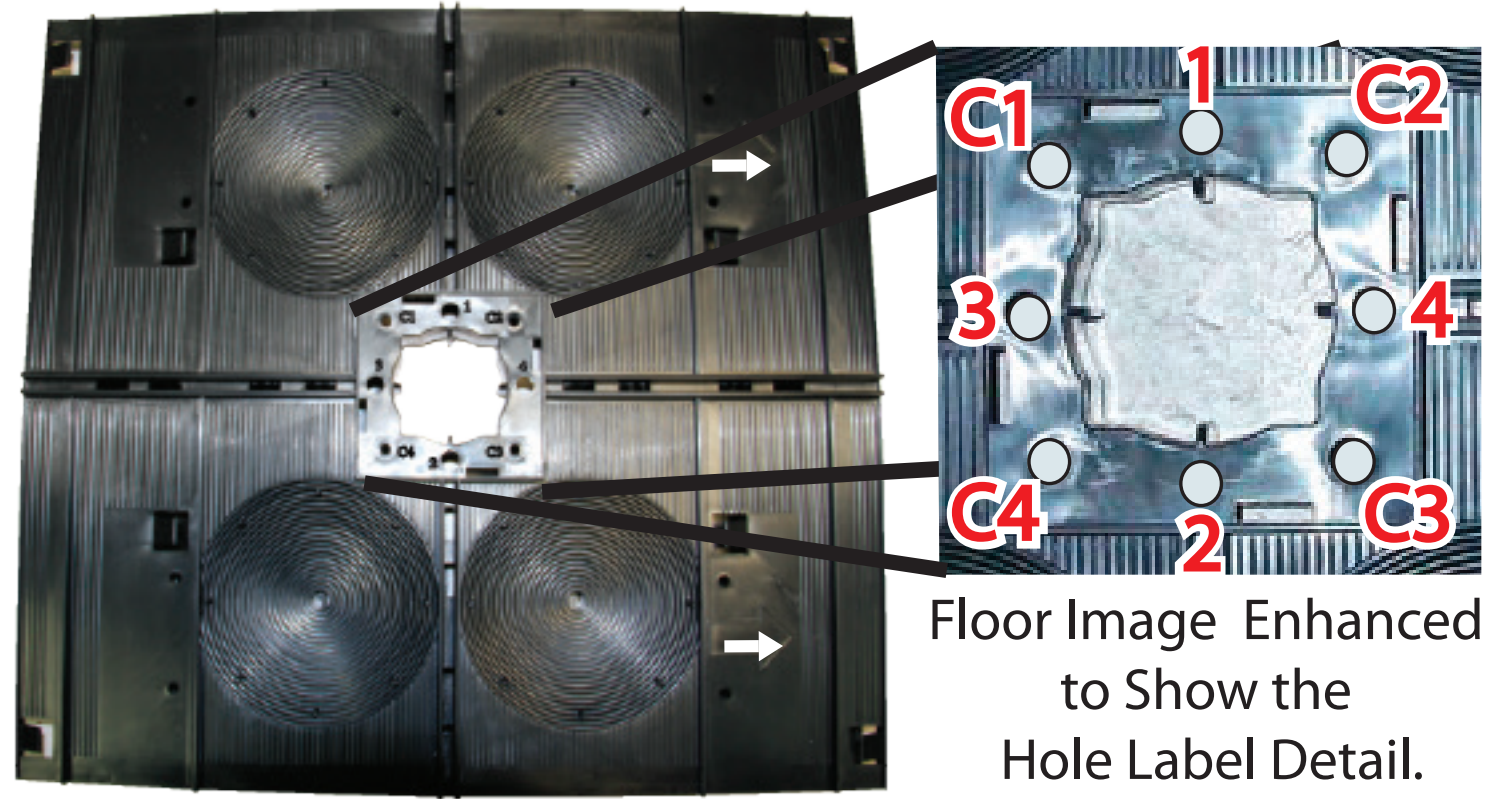
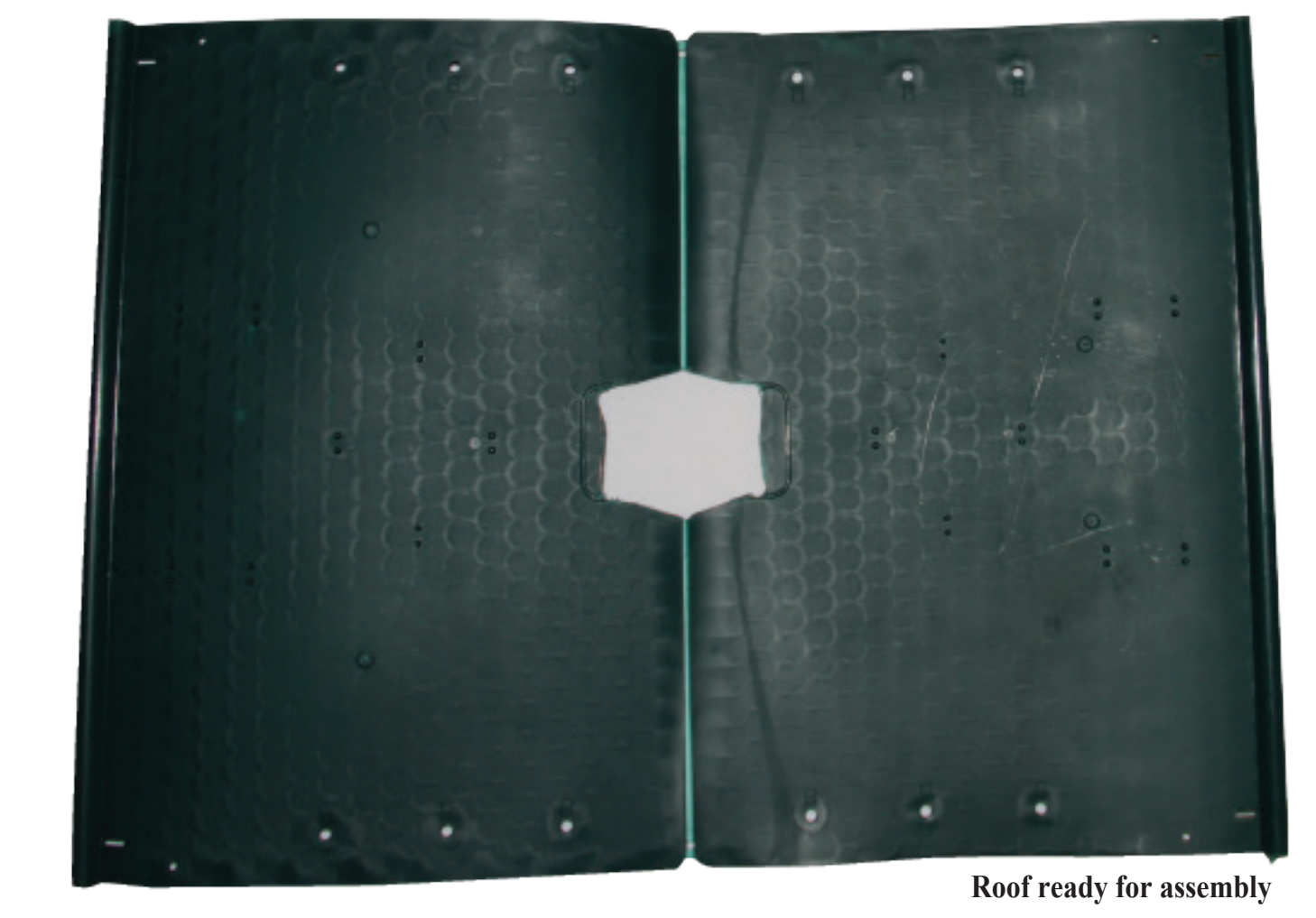

Scan Here to call Us **1-800-764-8688** Scan Here for Website

S&K MANUFACTURING, INC. MISSOURI

www.skmfg.com

Step 5. Feed the Rope Through the Topper

Pull one end of the rope through pole topper (Fig. 1). Keep rope tangle free. Take the two ends of the rope and put them through the roof top opening (Fig. 2). Then continue through the attic floor (Fig. 3). Ensure the two floor sections face in the same direction. Run one end of the rope through Hole (1) on the 2nd floor (Fig. 4a) and the other end of the other rope through hole (2) on the 2nd floor (Fig. 4a) and the other end of the other rope through hole (2) on the 1st floor (Fig. 4b) as they did on the 2nd floor (Fig. 4a), separate the ropes and make sure they are not tangled. Take the rope from hole (1) on the 2nd floor (Fig. 4a) and insert it into Hole (1) of the 1st floor (Fig. 4b). Now take the rope hole (2) from the 2nd floor (Fig. 4a) and insert it into hole (2) of the 1st floor (Fig. 4b). Ensure plenty of rope has been pulled through each hole. Then separate the two floors. Tie the two ends of rope with a loose double knots below the bottom floor (Fig. 5). This way the rope will not pull back through the floors during the rest of the assembly process.

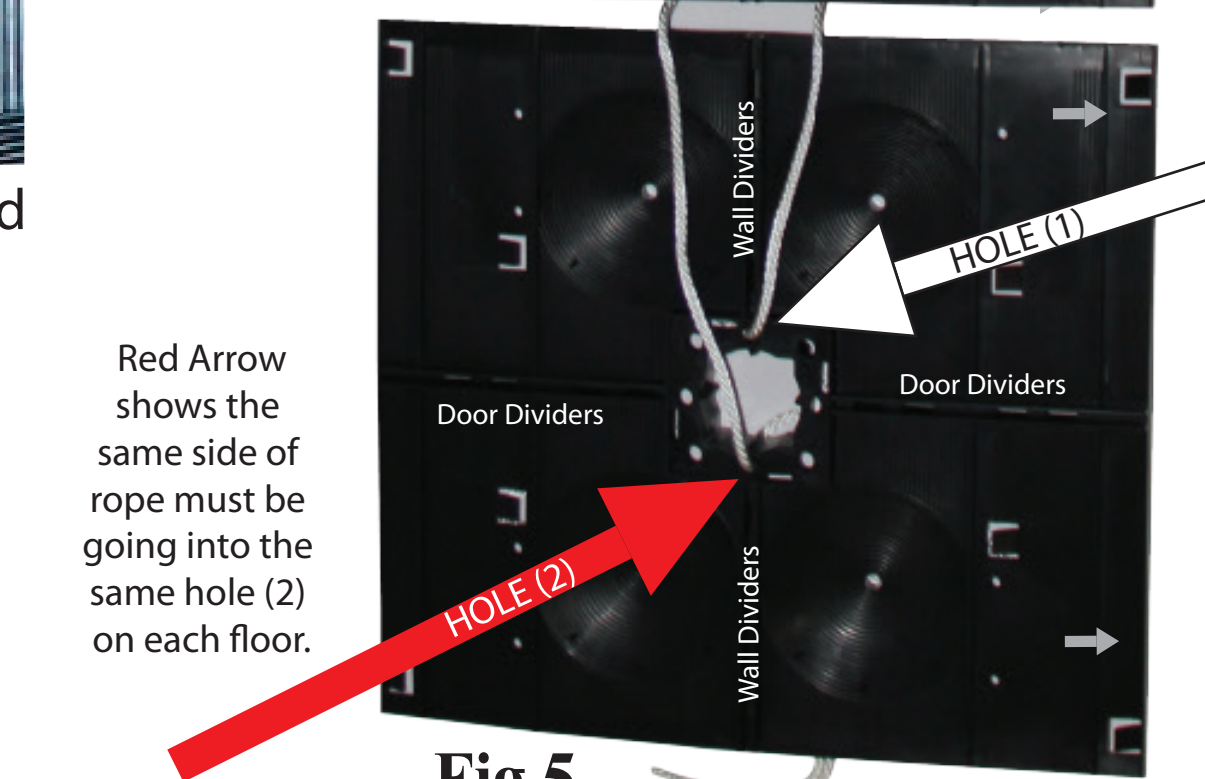
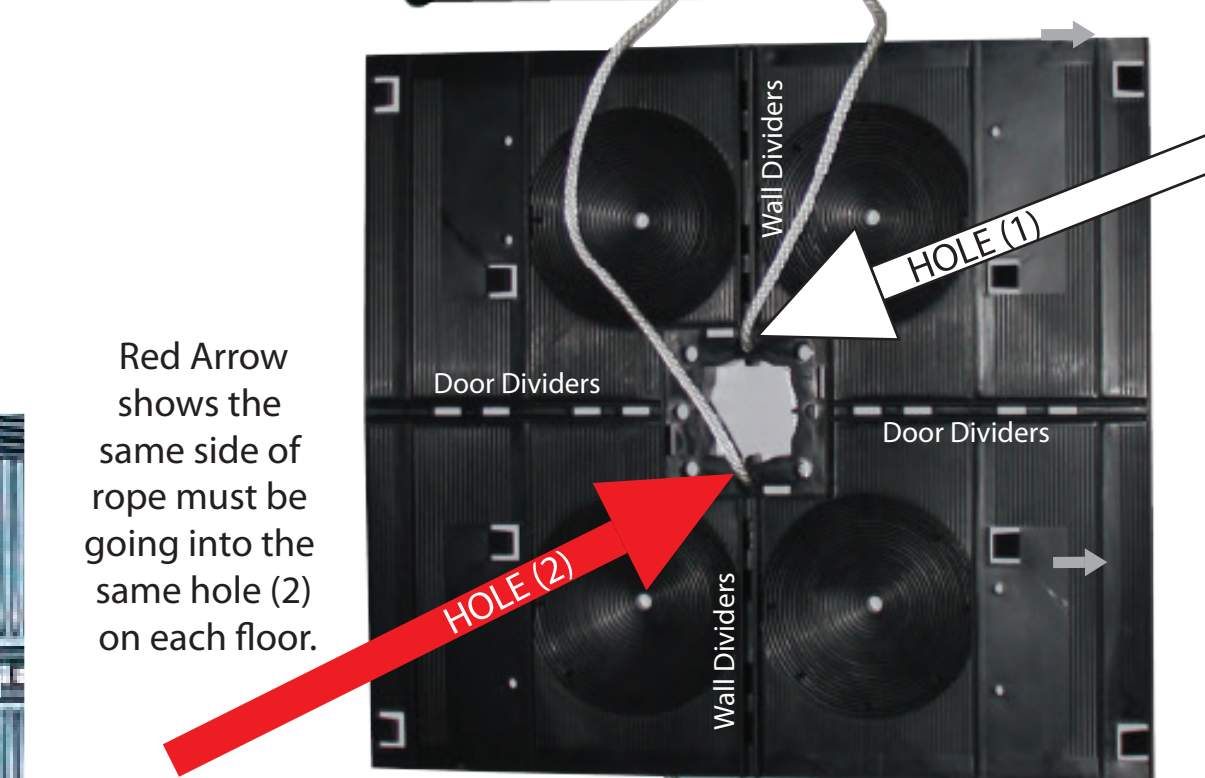
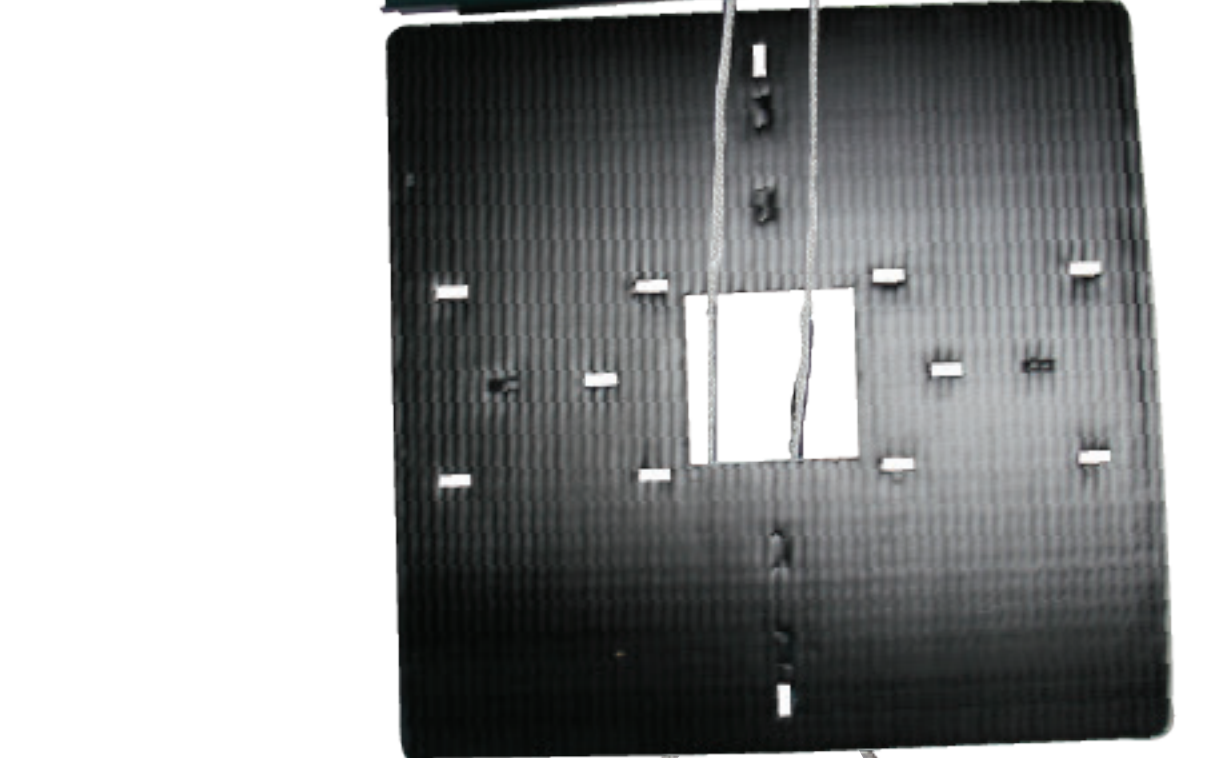

• 2 Pillar Dividers

Special Note: The ropes must be inside the pillar. Wrap the Pillar around the Ropes

Step 6: Fold the Pillar into a square, they lock in place.
NOTE: The "UP" arrow goes on the OUTSIDE of the Pillar.

Step 7: The Pillar has tabs that will snap into the center section of both floors. Together

Step 8: Insert the tabs into the corresponding holes in the floor until they lock into place.

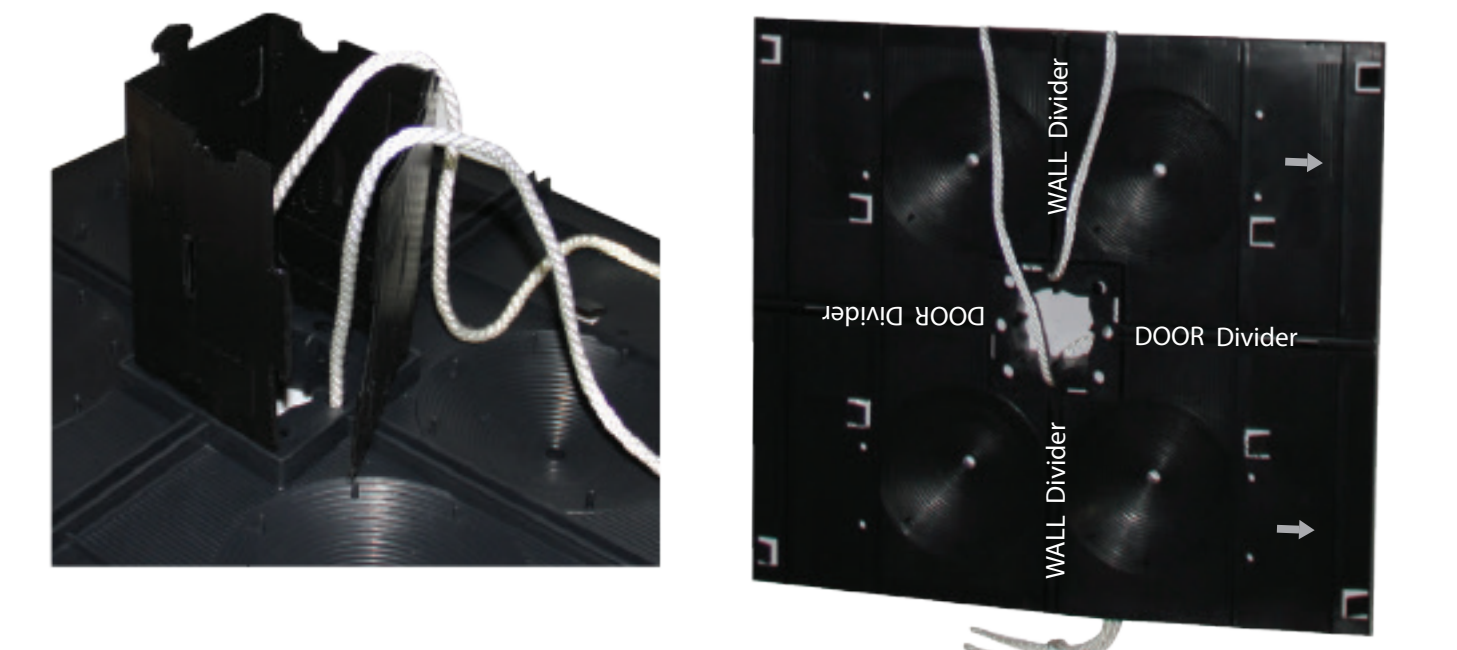

Step 9: Take a wall divider and locate the bottom tabs as shown and the corresponding holes on the floor and the Pillar.

Insert the two dividers as shown. Ensure the tabs are locked into the corresponding holes on the floor and the pillar.

• 4 Wall Dividers

• 4 Door Dividers

Step 10: The door dividers will snap into the entrance side of the floor. (NOTE the tabs and the arrows in the floor indicate the entrances of the house.)

Remove the Right Side of Door Divider with Scissors.

Separate the door dividers at the perforation.
Note: The side with the "UP" mark is for Step 10.
The right side may be saved to become a porch divider, if desired.

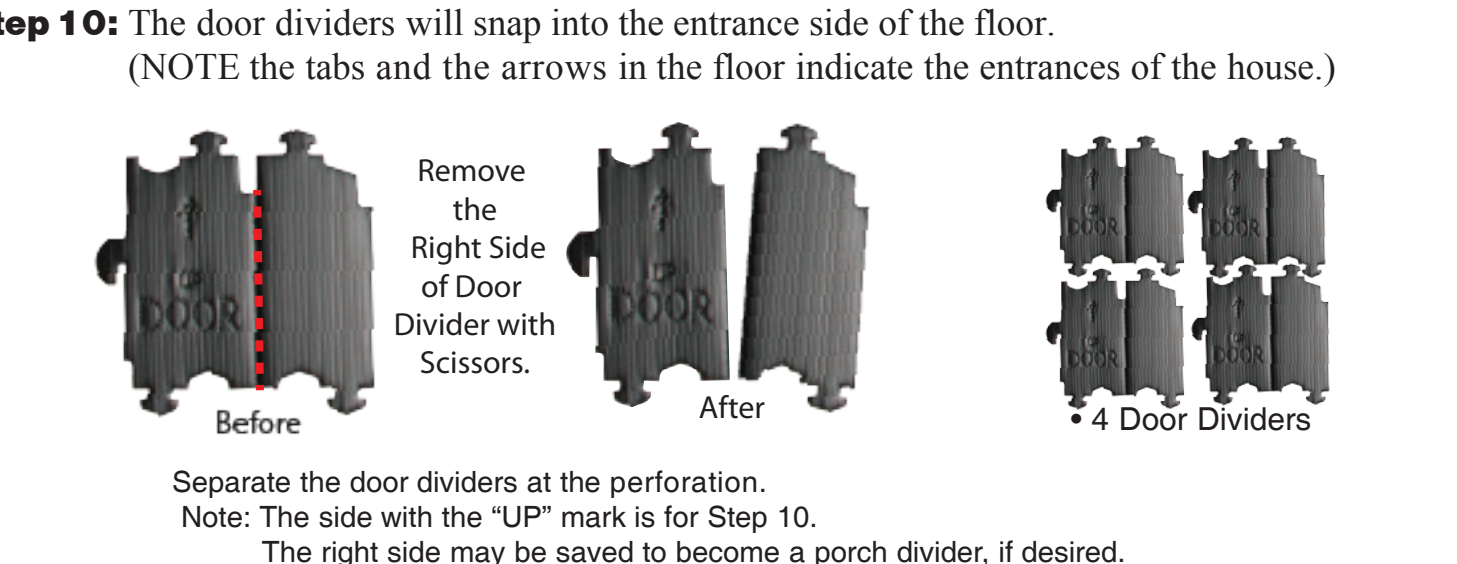

Step 11: Place the second floor a top the dividers. Be sure the floors are turned in the same direction. Push the tabs of the standing dividers into the corresponding holes. Insert the second Pillar (around ropes as in step 1) add dividers on the second floor exactly as the first floor (Steps 6-10).



Step 12: The attic floor fits over the top Pillar, and allows the corresponding tabs from the dividers on the second floor to be pushed in place on the attic floor.
NOTE: If the House appears **WARPED** at this point, do not worry. It will straighten during the following steps.

Step 13: The two "Attic Bell Curved Side Walls" are inserted by pushing the tabs into the corresponding holes in the attic floor. Then snap in the "Attic Room Dividers". See below.

Attic Bell Curve Side Walls

Attic Room Dividers



Step 14: Turn barn on its side. Take one house side with the textured side facing out and place it on the side of the house. Line up the holes on the house wall with the corresponding holes in the floors of the house.

WARNING: YOU MUST LINE UP THE HOLES BEFORE INSERTING THE WHITE SNAPS.

Step 15: Be sure the corresponding holes in the side walls and the floors are lined up before inserting snaps. (Shown in the next step). The smaller holes are where the perches are to be inserted.

Step 16: Ten snaps go into each side of the house. Be sure to push the snaps in all the way. Do the same as explained in steps 14, 15, and 16 on the opposite side wall.



Note: The roof is folded inside out for packaging and enhancement of the structure of the roof. Unfold the roof before installing.

Step 17: With the Barn upright, take the roof and place it over the house. At each corner of the roof, you will find an alignment hole that corresponds with a slide tab. Push the small tab through the pre-cut hole to attach the corner of the roof (all 4 corners) and slide into place.

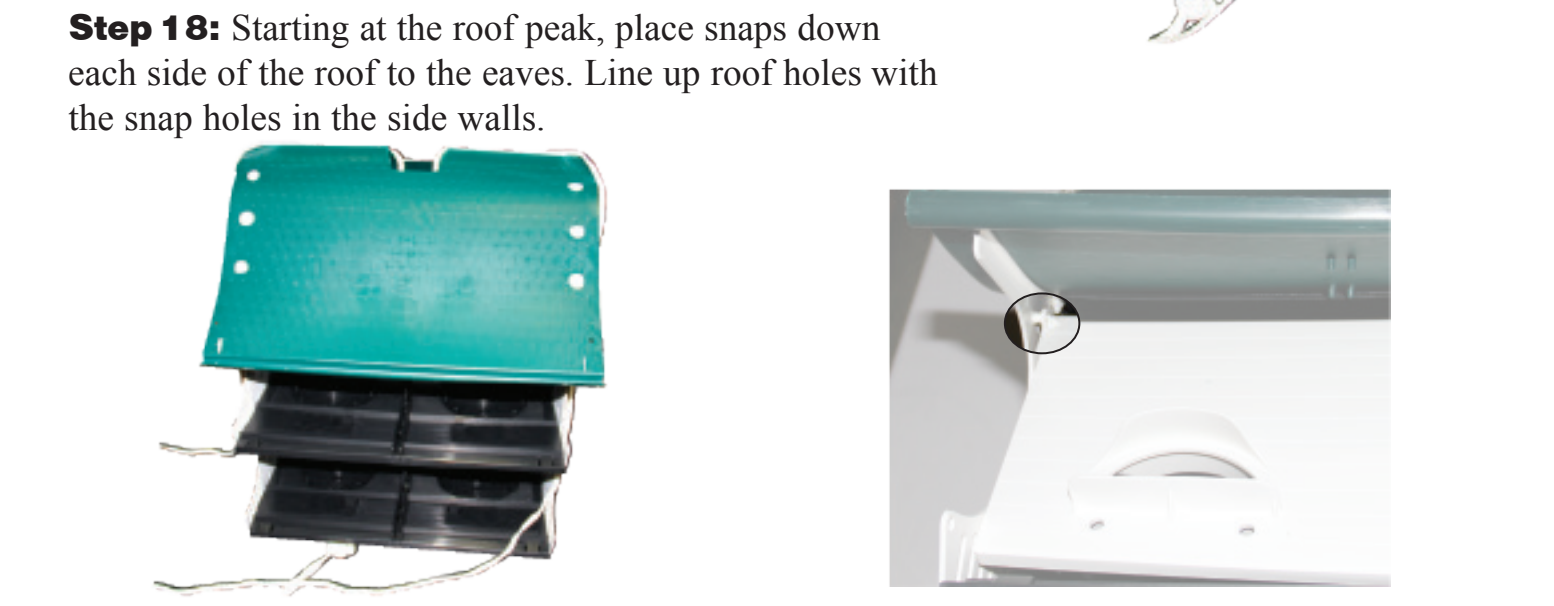

Step 18: Starting at the roof peak, place snaps down each side of the roof to the eaves. Line up roof holes with the snap holes in the side walls.

Step 19: The four door panels are attached by inserting the end tabs through the molded holes in the side panel as shown. The door panels will swing up. Press the floor tabs behind each door panel until they snap into place.

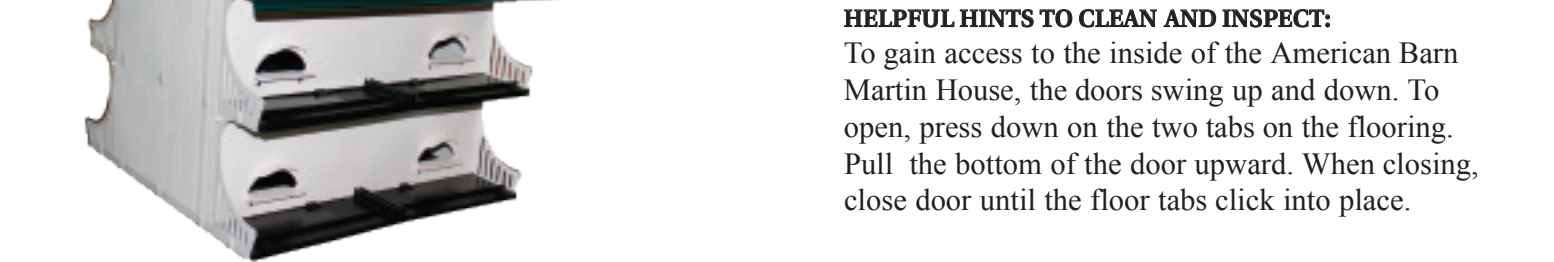

20. You Have Finished The Assembly of the American Barn Martin House for the EXRP19 See Pole instructions for Assembly of pole and mounting of House.

HELPFUL HINTS TO CLEAN AND INSPECT:
To gain access to the inside of the American Barn Martin House, the doors swing up and down. To open, press down on the two tabs on the flooring. Pull the bottom of the door upward. When closing, close door until the floor tabs click into place.